

7 LOWER NEWPORT ROAD,
ALDERSHOT, HAMPSHIRE

REPORT ON
ARCHAEOLOGICAL
WATCHING BRIEF

REPORT NO: R123957

MARCH 2016

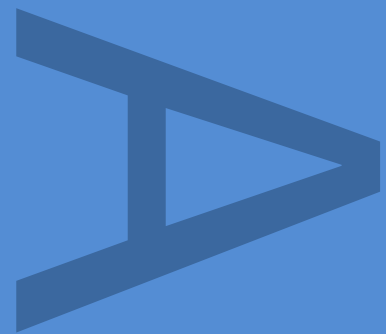

PRE-CONSTRUCT ARCHAEOLOGY

**7 LOWER NEWPORT ROAD, ALDERSHOT, HAMPSHIRE, GU12 4QB
ARCHAEOLOGICAL WATCHING BRIEF REPORT**

Issue 1: Issued For Approval
Local Planning Authority: Rushmoor Borough Council
Planning Ref: 13/00360/FUL
NGR: 487899 150096
Site Code: LNRA15

Client: Mr Michael Ashworth
Prepared By: Pre-Construct Archaeology Ltd (West)

Pre-Construct Archaeology Ltd (West)

Block 4, Chilcomb House, Chilcomb Lane, Winchester, Hampshire, SO23 8RB

Tel: 01962 849 549 Mob: 07714 134 099

E-mail: pmcculloch@pre-construct.com

Web: www.pre-construct.com

© Pre-Construct Archaeology Ltd

March 2016

© The material contained herein is and remains the sole property of Pre-Construct Archaeology Limited and is not for publication to third parties without prior consent. Whilst every effort has been made to provide detailed and accurate information, Pre-Construct Archaeology Ltd cannot be held responsible for errors or inaccuracies herein contained.

Report R12395

DOCUMENT VERIFICATION

7 Lower Newport Lane, Aldershot, Hampshire

Archaeological Evaluation

Report Ref R12395

Quality Control

Pre-Construct Archaeology Limited Project Code			K3829
	Name & Title	Signature	Date
Text Prepared by:	S Hubbard		06/03/2016
Graphics Prepared by:	J Simonson		15/03/2016
Graphics Checked by:			
Project Manager Sign-off:	P McCulloch		21/03/2016

Revision No.	Date	Checked	Approved

CONTENTS

1	ABSTRACT.....	1
2	INTRODUCTION.....	2
2.1	Project Background	2
2.2	Location, Topography and Geology.....	2
2.3	Archaeological and Historical Background	2
3	AIM.....	2
3.1	Archaeological Watching Brief	2
4	RESULTS.....	3
4.1	Introduction	3
4.2	Observation	3
4.3	Conclusion.....	3
5	ACKNOWLEDGEMENTS.....	4
	APPENDIX 1: PLATES	5
	APPENDIX 2: OASIS RECORD.....	8

Plates (Appendix 1):

Plate 1: General view to the north-east.

Plate 2: Section of foundation trench, view to south-west.

Plate 3: Section of foundation trench, view to north-east.

Figures:

Figure 1: Detailed Site Location

Figure 2: Trench Location

1 ABSTRACT

Pre-Construct Archaeology Ltd was appointed by Michael Ashworth to undertake an archaeological watching brief at 7 Lower Newport Road, Aldershot, Hampshire, GU12 4QB (NGR 487899 150096). The Site is the subject of a development to replace a swimming pool with a new outbuilding. This document provides a report on the watching brief, which was carried out on the 12th and 13th of October 2015.

The watching brief demonstrated that the proposed new footprint lies in modern fill on the site of a former swimming pool. No archaeological deposits or finds were observed. The Site appears to retain no archaeological resource potential.

2 INTRODUCTION

2.1 Project Background

- 2.1.1 Pre-Construct Archaeology Ltd (PCA) was appointed by Michael Ashworth to undertake an archaeological watching brief at 7 Lower Newport Road, Aldershot, Hampshire, GU12 4QB (**Figure 1**). The Site is the subject of a development to replace a swimming pool with a new outbuilding. This document provides a report on the watching brief, which was carried out on the 12th and 13th of October 2015.
- 2.1.2 The watching brief was a requirement of Condition 5 of planning permission for the development granted by the Local Planning Authority Rushmoor Borough Council (Planning reference 13/00360/FUL) in July 2013 and was based on the advice of the Council's archaeological advisor Hannah Fluck, Senior Archaeologist, Hampshire County Council.
- 2.1.3 This document provides a report on the watching brief, which comprised the monitoring of groundwork for the proposed development. This included initial clearance of the existing swimming pool, new foundation trenches, and the laying of services.
- 2.1.4 This document has been prepared in accordance with the Chartered Institute for Archaeologists standard and guidance for archaeological watching briefs (ClfA 2014) and *Management of Research Projects in the Historic Environment* (Historic England 2015).

2.2 Location, Topography and Geology

- 2.2.1 The Site (NGR 487899 150096) is located to the north of Lower Newport Road, Aldershot and comprises a house and garden within a roughly square plot.
- 2.2.2 The Site lies on the eastern side of the 19th century new town of Aldershot, which developed around two military camps. The Site lies in a residential area c. 300m west of the Blackwater River. The Site lies at approximately 70m above Ordnance Datum.
- 2.2.3 The Site lies on superficial deposits of sand and gravel, which overlie outcrops of bedrock London Clay and Reading Beds <http://mapapps.bgs.ac.uk/geologyofbritain/home.html>.

2.3 Archaeological and Historical Background

- 2.3.1 The Site lies in an area of few archaeological monuments, sites and findspots. This is almost certainly because the development of 19th and 20th century Aldershot took place before systematic archaeological records were compiled. For antecedents of the modern town, historical records and maps suggest the 12th century Church St Michael the Archangel and the later medieval and post-medieval manor that lay 80m north of the Church and now within Aldershot Manor Park, formed a focus of settlement some 750m west of the site.
- 2.3.2 What limited archaeological evidence that has been recorded in Aldershot includes a Mesolithic transept axe, finds of medieval 14th century pottery from Newport Road and the remains of a post-medieval pottery kiln found in Redan Gardens, some 750m west of the site.

3 AIM

3.1 Archaeological Watching Brief

- 3.1.1 The aim of the watching brief was to monitor ground work for the proposed development for the presence of archaeological resources, in particular evidence of pottery manufacture, and, if present, investigate and preserve by record the resources, determining, where possible, their character, including their date, nature and extent.

- 3.1.2 This report aims to provide an account of the watching brief and to be sufficient to demonstrate to the Local Planning Authority that the watching brief was carried out in accordance with the approved Written Scheme of Investigation.

4 RESULTS

4.1 Introduction

- 4.1.1 The following summary is based on the Site archive, comprising written and photographic records. The archive is held at PCA's Winchester office under the site code **LNRA15** and will ultimately be deposited with the Hampshire Cultural Trust, Winchester. Images of the watching brief are provided in **Appendix 1 – Plates 1-3**.

- 4.1.2 The watching brief was carried out on the 12th and 13th of October 2015.

4.2 Observation

- 4.2.1 The watching brief monitored the hand excavation of the foundation trench for the proposed new building (**Figure 2**). The depth of the foundation trench ranged from .65m to 1.05m below the existing garden surface.

- 4.2.2 The foundation trench was formed entirely within garden soil, which contained layers of reddish or yellowish sandy deposits. The observed deposits can be attributed to infill of the former swimming pool that was previously located on the proposed new footprint. The observed deposits were all of modern date, as shown by the presence of modern ceramics and brick rubble. All finds were discarded.

4.3 Conclusion

- 4.3.1 The watching brief demonstrated that the proposed new footprint lies in modern fill on the site of a former swimming pool. No archaeological deposits or finds were observed. The Site appears to retain no archaeological resource potential.

5 ACKNOWLEDGEMENTS

Pre-Construct Archaeology would like to thank Mr. Michael Ashworth for commissioning the watching brief.

The watching brief was conducted by Steven Hubbard, who also prepared this report. The project was managed for PCA by Paul McCulloch.

APPENDIX 1: PLATES



Plate 1: General view to the north-east.



Plate 2: Section of foundation trench, view to south-west.



Plate 3: Section of foundation trench, view to north-east.

APPENDIX 2: OASIS RECORD

OASIS ID: preconst1-245129

Project details

Project name	7 Lower Newport Road Aldershot Hampshire
Short description of the project	Watching brief on new foundations in rear garden of single house. Site in the vicinity of documented post-medieval potteries but no evidence for pottery manufacture, or anything else, was found in the watching brief.
Project dates	Start: 12-10-2015 End: 13-10-2015
Previous/future work	No / No
Any associated project reference codes	13/00360/FUL - Planning Application No.
Any associated project reference codes	LNRA15 - Sitecode
Type of project	Recording project
Site status	None
Monument type	NONE None
Monument type	NONE None
Significant Finds	NONE None
Significant Finds	NONE None
Investigation type	"Watching Brief"
Prompt	Planning condition
Project location	
Country	England
Site location	HAMPSHIRE RUSHMOOR ALDERSHOT 7 Lower Newport Lane
Postcode	GU12 4QB
Study area	100 Square metres
Site coordinates	SU 487899 150096 50.9319203546 -1.305631533494 50 55 54 N 001 18 20 W Point
Lat/Long Datum	Unknown
Height OD / Depth	Min: 70m Max: 70m
Project creators	
Name of Organisation	PCA West
Project brief	Hampshire County Council

originator

Project design
originator Paul McCulloch

Project
director/manager Paul McCulloch

Project supervisor Steven Hubbard

Type of
sponsor/funding
body Client

Project archives

Physical Archive
Exists? No

Digital Archive
recipient Hampshire Cultural Trust

Digital Media
available "Images raster / digital photography", "Text"

Paper Archive
Exists? No

Paper Archive
recipient Hampshire Cultural Trust

Paper Media
available "Diary", "Notebook - Excavation", ' Research', ' General
Notes', "Report"

Entered by Paul McCulloch (pmcculloch@pre-construct.com)

Entered on 9 March 2016

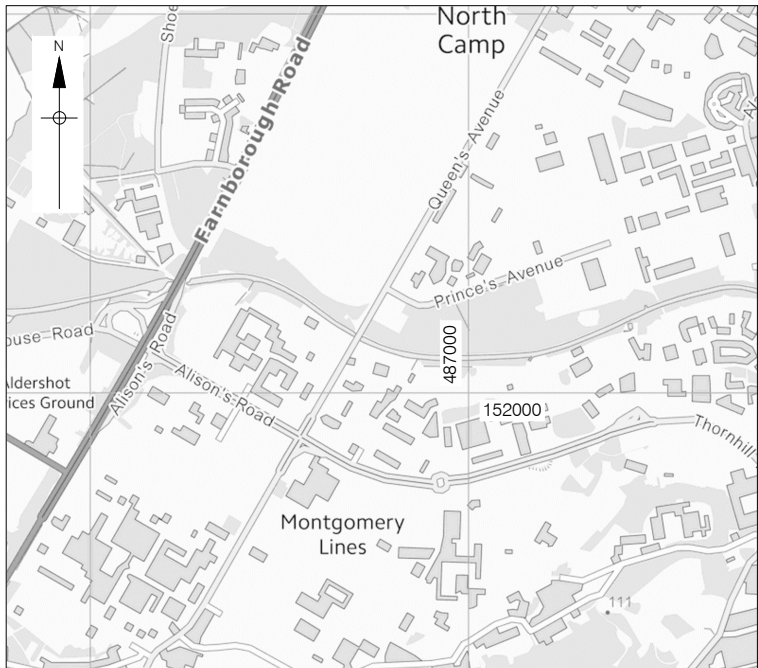

Contains Ordnance Survey data © Crown copyright and database right 2014
 © Pre-Construct Archaeology Ltd 2016
 15/03/16 JS

Figure 1
 Site Location
 1:2,000,000 and 1:20,000 at A4

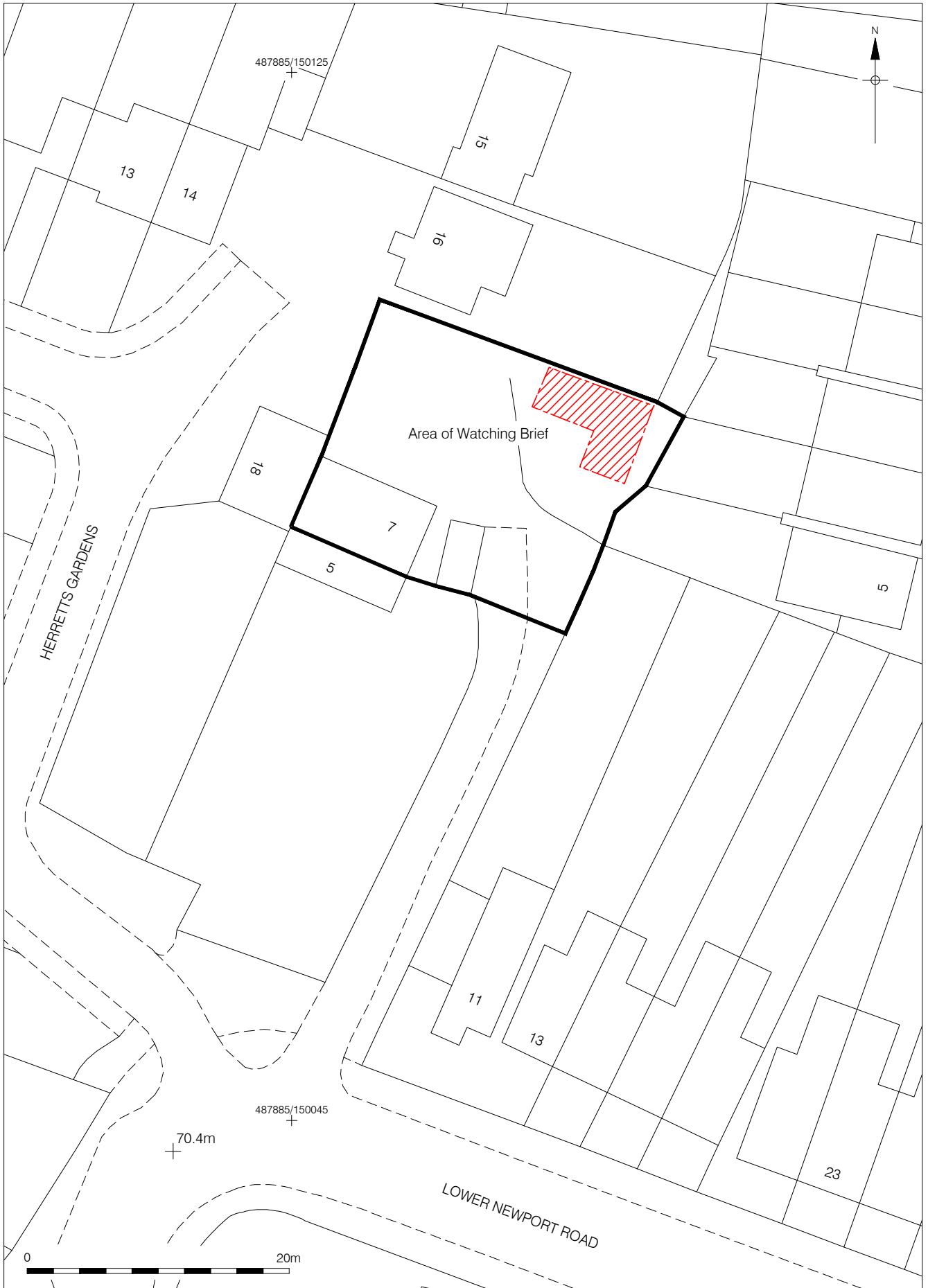

PCA

PCA SOUTH

UNIT 54
BROCKLEY CROSS BUSINESS CENTRE
96 ENDWELL ROAD
BROCKLEY
LONDON SE4 2PD
TEL: 020 7732 3925 / 020 7639 9091
FAX: 020 7639 9588
EMAIL: info@pre-construct.com

PCA NORTH

UNIT 19A
TURSDALE BUSINESS PARK
DURHAM DH6 5PG
TEL: 0191 377 1111
FAX: 0191 377 0101
EMAIL: info.north@pre-construct.com

PCA CENTRAL

THE GRANARY, RECTORY FARM
BREWERY ROAD, PAMPISFORD
CAMBRIDGESHIRE CB22 3EN
TEL: 01223 845 522
FAX: 01223 845 522
EMAIL: info.central@pre-construct.com

PCA WEST

BLOCK 4
CHILCOMB HOUSE
CHILCOMB LANE
WINCHESTER
HAMPSHIRE SO23 8RB
TEL: 01962 849 549
EMAIL: info.west@pre-construct.com

PCA MIDLANDS

17-19 KETTERING RD
LITTLE BOWDEN
MARKET HARBOROUGH
LEICESTERSHIRE LE16 8AN
TEL: 01858 468 333
EMAIL: info.midlands@pre-construct.com

