

**AN ARCHAEOLOGICAL
WATCHING BRIEF WITHIN
THE CRYPT, ST PAUL'S
CATHEDRAL, CITY OF
LONDON, EC4**

SITE CODE: PCC16

REPORT NO: R12425

MARCH 2016



**PRE-CONSTRUCT
ARCHAEOLOGY**

**AN ARCHAEOLOGICAL WATCHING BRIEF WITHIN THE CRYPT, ST PAUL'S
CATHEDRAL, CITY OF LONDON, EC4**

Site Code: PCC16

Central National Grid Reference: TQ 32017 81187

Written and Researched by Neil Hawkins

Pre-Construct Archaeology Limited, March 2016

Project Manager: Helen Hawkins MCIfA

**Commissioning Client: John Schofield, Cathedral Archaeologist, on behalf of
the Dean and Chapter of St Paul's Cathedral**

Planning Application Number: n/a

Contractor:

Pre-Construct Archaeology Limited

Unit 54

Brockley Cross Business Centre

96 Endwell Road

Brockley

London

SE4 2PD

Tel: 020 7732 3925

Fax: 020 7732 7896

Email: hhawkins@pre-construct.com

Web: www.pre-construct.com

© Pre-Construct Archaeology Limited

March 2016

© The material contained herein is and remains the sole property of Pre-Construct Archaeology Limited and is not for publication to third parties without prior consent. Whilst every effort has been made to provide detailed and accurate information, Pre-Construct Archaeology Limited cannot be held responsible for errors or inaccuracies herein contained.

DOCUMENT VERIFICATION

THE CRYPT, ST PAUL'S CATHEDRAL, CITY OF LONDON, EC4
Type of project
AN ARCHAEOLOGICAL WATCHING BRIEF
Quality Control

Pre-Construct Archaeology Limited Project Code			K4329
	Name	Signature	Date
Text Prepared by:	N Hawkins		21.3.16
Graphics Prepared by:	R Murphy		29.3.16
Graphics Checked by:	J Brown	<i>Josephine Brown</i>	31.3.16
Project Manager Sign-off:	H Hawkins		31.3.16

Revision No.	Date	Checked	Approved

Pre-Construct Archaeology Ltd
Unit 54
Brockley Cross Business Centre
96 Endwell Road
London
SE4 2PD

CONTENTS

1	INTRODUCTION	2
2	TRENCH SUMMARY	3
3	CONCLUSIONS	4
4	BIBLIOGRAPHY	5
5	PLATES	6
	APPENDIX 1: OASIS FORM	10

Figures

Figure 1: Site Location	10
Figure 2: Detailed Site Location	11
Figure 3: Trench Locations.....	12

1 INTRODUCTION

- 1.1 The following report details the results of an archaeological watching brief within The Crypt, St Paul's Cathedral, City of London, EC4 (site code PCC 16). Pre-Construct Archaeology Limited was commissioned by John Schofield, Cathedral Archaeologist, on behalf of the Dean and Chapter of St Paul's Cathedral, to undertake the aforementioned archaeological watching brief. The original proposal, as detailed in the Written Scheme of Investigation (Hawkins 2015), consisted of groundworks associated with the improvement of the toilet facilities. In practise this consisted of the archaeological monitoring of five trenches within the toilet area to install new drainage and also connect to existing drainage (Figure 2), the results of which are detailed below. The work was carried out on 17th and 18th March 2016.
- 1.2 The archaeological watching brief recorded no archaeological features, deposits or artefacts, encountering exclusively modern deposits. Within Trench 3 however, a considerable assemblage of disarticulated human bone was recovered from the backfill of a service trench previously excavated in 1994. This assemblage represented the quantified remains recovered during an earlier phase of archaeological work in the crypt and thereafter reburied. A reference to this reburial can be found within the report for the associated watching brief (Thomas 1995, 67). A Desk-Based Assessment for the Crypt area (Schofield 2015) illustrates the location of the previously undertaken archaeological watching brief in 1994 to be predominantly in the locations of the watching brief trenches monitored during this work, accounting for the exclusively modern deposits encountered.

2 TRENCH SUMMARY

2.1 Trench locations are shown in Figure 3.

2.2 Trench 1

2.2.1 Trench 1 recorded modern made ground at 0.68m below ground level, 12.77m OD, located next to previous drainage pipes and a man hole. This deposit was sealed by the modern concrete representing the Crypt floor.

2.3 Trench 2

2.3.1 Trench 2 only recorded a modern pipe, located at approximately 0.75m below ground level, 12.70m OD, sealed by the modern concrete of the Crypt floor.

2.4 Trench 3

2.4.1 Trench 3 recorded a modern pipe, set in concrete, running throughout the trench c. 0.75m below ground level, 12.70m OD. Backfilled upon this modern service was a deposit of mixed clay silt and a loose gravel. Both deposits represent the re-deposition of material previously excavated during the archaeological watching brief undertaken in 1994. Within the gravel was recovered the aforementioned assemblage of disarticulated human bone which had been first excavated in 1994 and subsequently quantified and re-buried.

2.5 Trench 4

2.5.1 Trench 4 recorded a modern pipe, located at c. 0.50m below ground level, 12.95m OD, sealed by the modern concrete of the Crypt floor.

2.6 Trench 5

2.6.1 Trench 5 recorded modern concrete and stone rubble to 0.50m below ground level, 12.95m OD, sealed by the concrete of the Crypt floor.

3 CONCLUSIONS

- 3.1 The archaeological watching brief was carried out wholly within areas previously excavated for service runs in 1994. The original service runs were subject to archaeological monitoring at the time.
- 3.2 Human remains encountered during the current watching brief were those previously reburied in the drainage run. No other undisturbed archaeological remains or features were seen during the current watching brief.
- 3.3 The human remain will be reburied in a location to be confirmed by the Dean and Chapter of St Paul's Cathedral.

4 BIBLIOGRAPHY

Hawkins, H 2015 *The Crypt, St Paul's Cathedral, City Of London, EC4* Written Scheme Of Investigation For Archaeological Watching Brief unpublished client report

Schofield, J 2015 *Crypt WCs and mezzanine level works, St Paul's Cathedral (SPC248) Archaeological Assessment* unpublished client report

Thomas, T, 1995 *West Crypt, St Paul's Cathedral, London EC4*, Museum of London Archaeology Service excavation report

5 PLATES



Plate 1: Trench 1 facing northwest, 0.5m scale



Plate 2: Trench 2 facing east



Plate 3: Trench 3 facing west, 0.5m scale



Plate 4: Trench 4 facing east



Plate 5: Trench 5 facing northeast

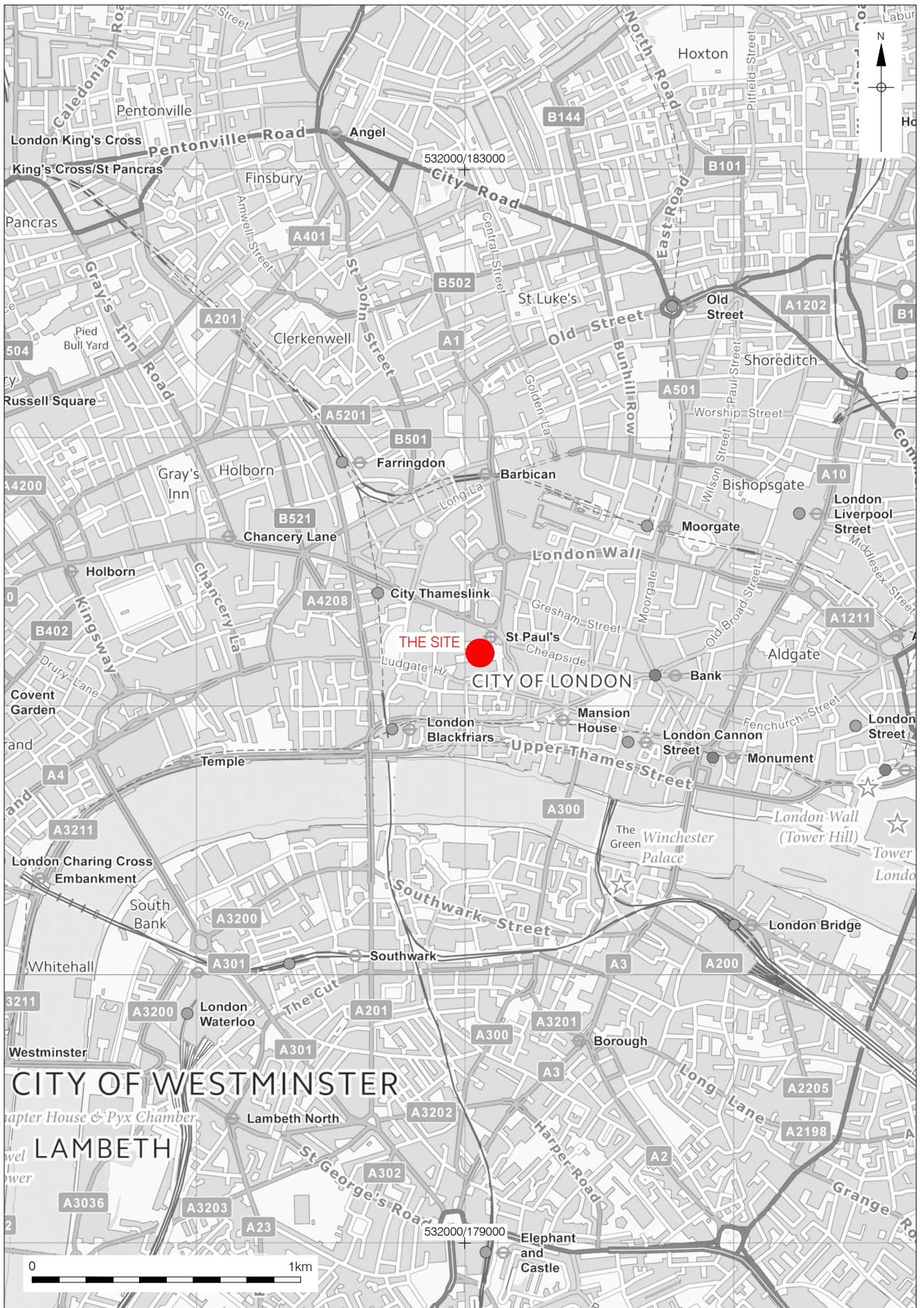

Contains Ordnance Survey data © Crown copyright and database right 2016

© Pre-Construct Archaeology Ltd 2016

16/03/16 RM

Figure 1
Site Location
1:20,000 at A4

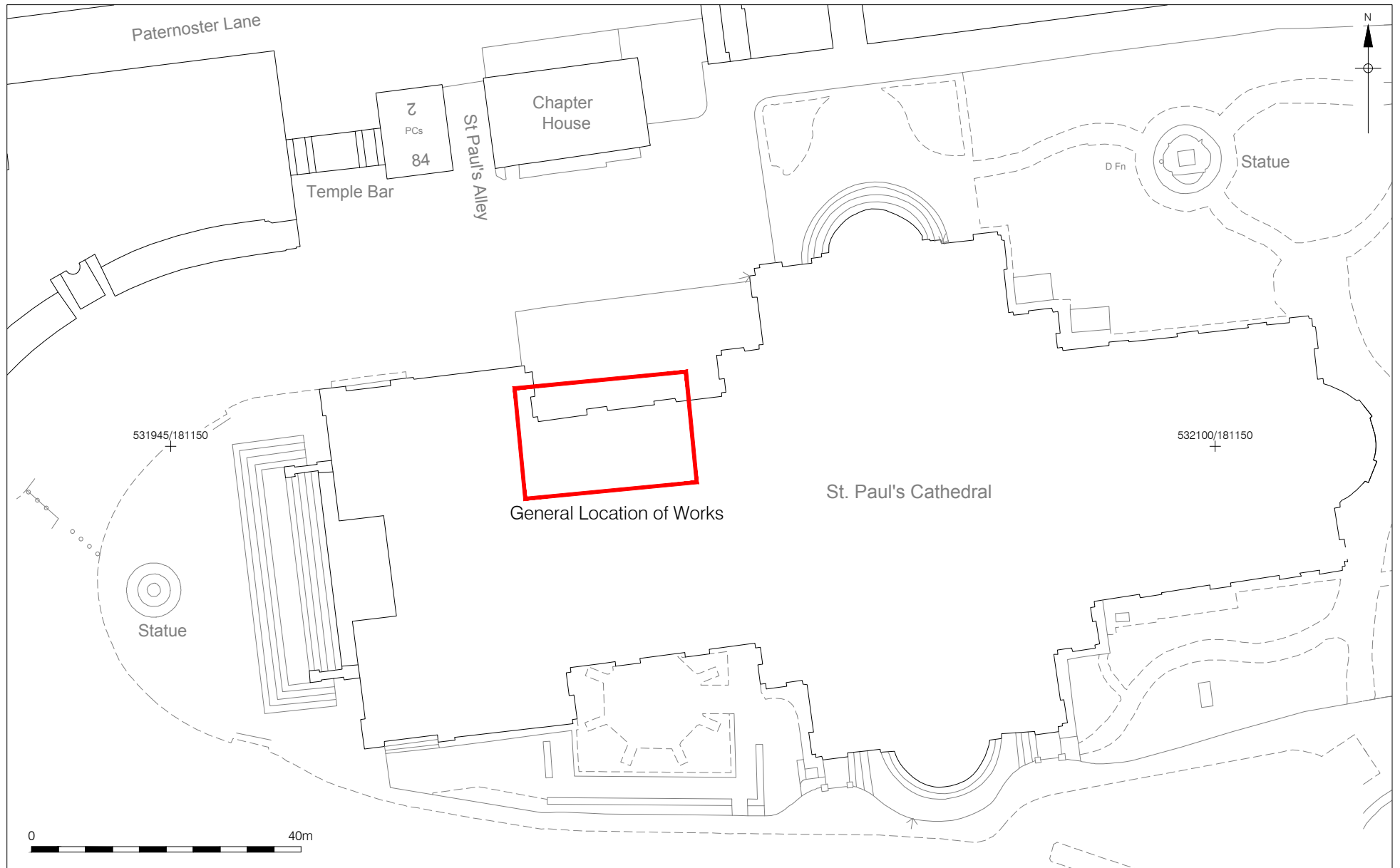

© Crown copyright 2016. All rights reserved. License number PMP36110309
 © Pre-Construct Archaeology Ltd 2016
 30/03/16 RM

Figure 2
 Detailed Site Location
 1:800 at A4

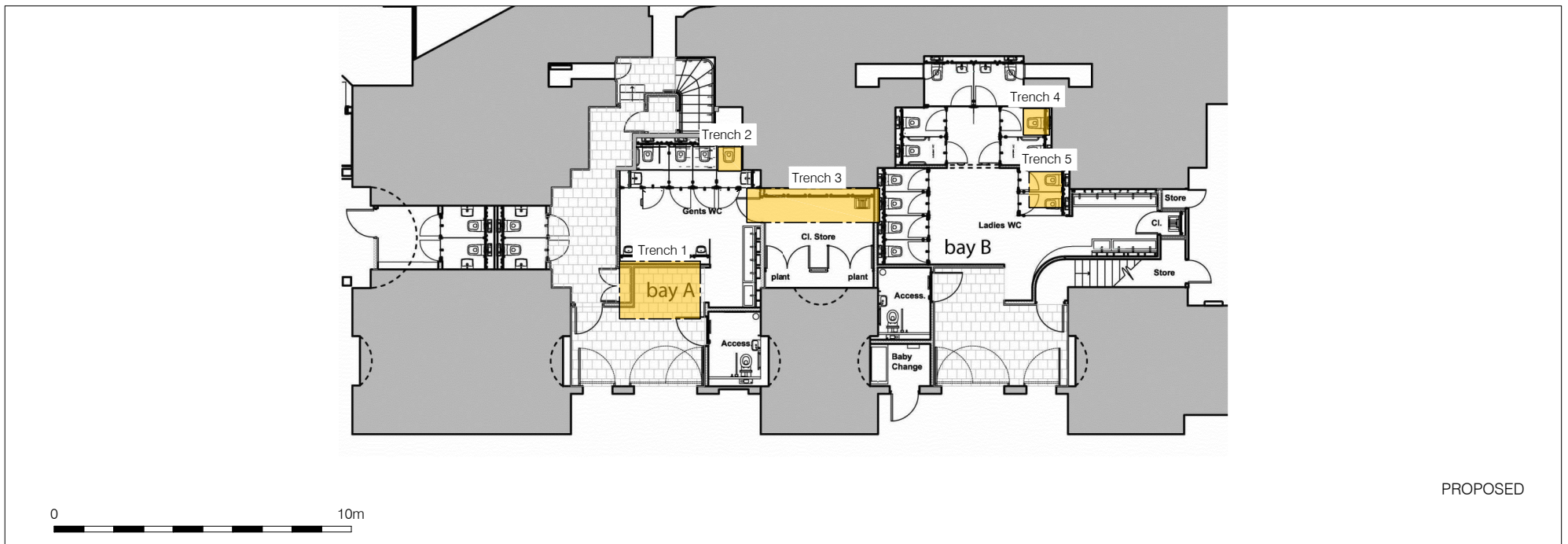
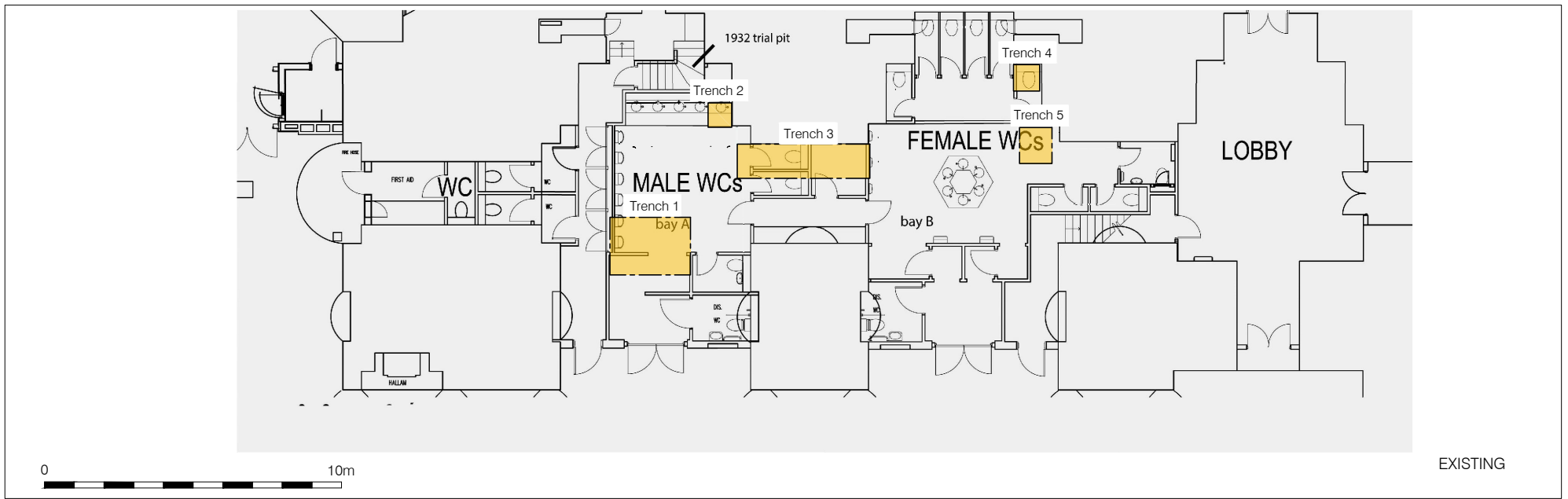

Reproduced from drawings by Caroe Architecture SPC248-210 & SPC243-250 (April 2014)
 © Pre-Construct Archaeology Ltd 2016
 29/03/16 RM

Figure 3
 Trench Location
 Overlain onto existing and proposed basement plans
 1:200 at A4

APPENDIX 1: OASIS FORM

OASIS ID: preconst1-246767

Project details

Project name THE CRYPT, ST PAUL'S CATHEDRAL, CITY OF LONDON, EC4

Short description of the project An archaeological watching brief was carried out in the toilets of the Crypt, St Paul's Cathedral. The work monitored the re-excavation of current service runs to allow new services to be attached. Human remains, reburied after the services were originally excavated in 1994, were re-exposed and recorded. No other archaeological features or finds were noted.

Project dates Start: 17-03-2016 End: 18-03-2016

Previous/future work Yes / Not known

Any associated project reference codes PCC16 - Sitecode

Type of project Recording project

Site status Scheduled Monument (SM)

Current Land use Other 2 - In use as a building

Monument type NONE None

Significant Finds HUMAN BONE Early Medieval

Investigation type "Watching Brief"

Prompt Faculty jurisdiction

Project location

Country England

Site location GREATER LONDON CITY OF LONDON CITY OF LONDON St Paul's Cathedral Crypt

Postcode EC4M8AE

Study area	400 Square metres
Site coordinates	TQ 32017 81187 51.513664975994 - 0.097255511142 51 30 49 N 000 05 50 W Point
Height OD / Depth	Min: 0m Max: 0m

Project creators

Name of Organisation	Pre-Construct Archaeology Limited
Project brief originator	John Schofield
Project design originator	John Schofield
Project director/manager	Helen Hawkins
Project supervisor	Neil Hawkins
Type of sponsor/funding body	Church
Name of sponsor/funding body	Dean and Chapter of St Paul's Cathedral

Project archives

Physical Archive recipient	reburial
Physical Archive ID	PCC16
Physical Contents	"Human Bones"
Digital Archive recipient	LAARC
Digital Archive ID	PCC16
Digital Contents	"none"
Digital Media	"Images raster / digital photography", "Text"

available

Paper Archive LAARC
recipient

Paper Archive ID PCC16

Paper Contents "none"

Paper Media "Context
available sheet", "Photograph", "Plan", "Report", "Unpublished
Text"

**Project
bibliography 1**

Publication type Grey literature (unpublished document/manuscript)

Title AN ARCHAEOLOGICAL WATCHING BRIEF
WITHIN THE CRYPT, ST PAUL'S CATHEDRAL,
CITY OF LONDON, EC4

Author(s)/Editor(s) Hawkins, N

Date 2016

Issuer or PCA
publisher

Place of issue or London
publication

PCA

PCA SOUTH

UNIT 54
BROCKLEY CROSS BUSINESS CENTRE
96 ENDWELL ROAD
BROCKLEY
LONDON SE4 2PD
TEL: 020 7732 3925 / 020 7639 9091
FAX: 020 7639 9588
EMAIL: info@pre-construct.com

PCA NORTH

UNIT 19A
TURSDALE BUSINESS PARK
DURHAM DH6 5PG
TEL: 0191 377 1111
FAX: 0191 377 0101
EMAIL: info.north@pre-construct.com

PCA CENTRAL

7 GRANTA TERRACE
STAPLEFORD
CAMBRIDGESHIRE CB22 5DL
TEL: 01223 845 522
FAX: 01223 845 522
EMAIL: info.central@pre-construct.com

PCA WEST

BLOCK 4
CHILCOMB HOUSE
CHILCOMB LANE
WINCHESTER
HAMPSHIRE SO23 8RB
TEL: 01962 849 549
EMAIL: info.west@pre-construct.com

PCA MIDLANDS

17-19 KETTERING RD
LITTLE BOWDEN
MARKET HARBOROUGH
LEICESTERSHIRE LE16 8AN
TEL: 01858 468 333
EMAIL: info.midlands@pre-construct.com

