

**LAND AT ELMBANK,
BARNET, EN5 3DS: AN
ARCHAEOLOGICAL
EVALUATION**

SITE CODE: EBK16

REPORT NO: R12433

APRIL 2016



**PRE-CONSTRUCT
ARCHAEOLOGY**

DOCUMENT VERIFICATION

LAND AT ELMBANK, BARNET, EN5 3DS

Type of project
ARCHAEOLOGICAL EVALUATION
Quality Control

Pre-Construct Archaeology Limited Project Code			K4454
	Name	Signature	Date
Text Prepared by:	I Cipin		4.4.16
Graphics Prepared by:	M Roughly		4.4.16
Graphics Checked by:	J Brown	<i>Josephine Brown</i>	5.4.16
Project Manager Sign-off:	H Hawkins		5.4.16

Revision No.	Date	Checked	Approved

Pre-Construct Archaeology Ltd
Unit 54
Brockley Cross Business Centre
96 Endwell Road
London
SE4 2PD

LAND AT ELMBANK, BARNET, EN5 3DS: AN ARCHAEOLOGICAL EVALUATION

Site Code: EBK 16

Central NGR: TQ 23328 96198

Local Planning Authority: London Borough of Barnet

Planning Reference: 15/03343/FUL

Commissioning Client: CGMS Consulting

Written/Researched by: Ian Cipin
Pre-Construct Archaeology Limited

Project Manager: Helen Hawkins (MCIfA)

Contractor: Pre-Construct Archaeology Limited
Unit 54 Brockley Cross Business Centre
96 Endwell Road
Brockley
London SE4 2PD

Tel: 020 7732 3925
Fax: 020 7732 7896
E-mail: hhawkins@pre-construct.com
Web: www.pre-construct.com

© Pre-Construct Archaeology Limited

April 2016

© The material contained herein is and remains the sole property of Pre-Construct Archaeology Limited and is not for publication to third parties without prior consent. Whilst every effort has been made to provide detailed and accurate information, Pre-Construct Archaeology Limited cannot be held responsible for errors or inaccuracies herein contained.

CONTENTS

1	ABSTRACT	3
2	INTRODUCTION.....	4
3	ARCHAEOLOGICAL BACKGROUND.....	5
4	RESEARCH FRAMEWORK	6
5	ARCHAEOLOGICAL METHODOLOGY	7
6	ARCHAEOLOGICAL SEQUENCE BY PHASE	8
7	DISCUSSION AND CONCLUSIONS.....	10
8	ACKNOWLEDGEMENTS	11
9	BIBLIOGRAPHY	12

APPENDICES

Appendix 1: Plates	17
Appendix 2: Phased Matrix	19
Appendix 3: Context Index	20
Appendix 4: Oasis Form.....	21
Appendix 4: CBM report.....	24
Appendix 5: pottery report.....	25

FIGURES

Figure 1: Site Location	13
Figure 2: Trench Location	14
Figure 3: Plan & Section of Trench 2	15
Figure 4: Plan & Section of Trench 3	16

1 ABSTRACT

- 1.1 Pre-Construct Archaeology Ltd were commissioned by CgMs Consulting to carry out an archaeological evaluation on land at Elmbank, Barnet, EN5 3DS in the London Borough of Barnet.
- 1.2 A total of three trenches were excavated (with one trench being divided into two smaller segments).
- 1.3 The archaeological evaluation revealed a sequence of natural deposits with a series of 19th century drainage ditches, planting beds and made ground both cut into and overlying the natural deposits. The 19th century deposits were in turn overlain by 20th century made ground and modern deposits.
- 1.4 No archaeological features or deposits pre-dating the 19th century were found during the archaeological evaluation.
- 1.5 The 19th century features and deposits are assumed to relate to the considerable landscaping of the grounds during the construction of Elmbank House during the 19th century.
- 1.6 No evidence for medieval pottery production was found during the archaeological evaluation.
- 1.7 Upon completion of the project the archive and all associated materials will be deposited with the London Archaeological Archive and Research Centre (LAARC) using the unique site code EBK 16.

2 INTRODUCTION

- 2.1 Pre-Construct Archaeology Ltd were commissioned by CgMs Consulting, on behalf of Linden Homes (Chiltern) Ltd, to carry out an archaeological evaluation on land at Elmbank, Barnet, EN5 3DS in the London Borough of Barnet.
- 2.2 The archaeological evaluation was necessary in order to fulfil an archaeological condition attached to planning application number 15/03343/FUL, in advance of the proposed redevelopment of the site.
- 2.3 A Written Scheme of Investigation (WSI, Smalley 2015) was prepared for the site which outlined the proposed scope of archaeological works. The WSI allowed for the excavation of three 30m x 2m trenches located in positions deemed most likely to provide suitable answers to the research framework (Smalley, 2015, p6) and in areas currently free from development.
- 2.4 Owing to the identification of live services it was necessary to relocate Trench 1 and split it into two smaller trenches, while Trenches 2 and 3 were excavated in accordance with the Trench Plan attached to the Method Statement prepared for the site (Hawkins 2016).
- 2.5 The works were carried out between 21st and 23rd March 2016. They were supervised by the author and project managed by Helen Hawkins, both of Pre-Construct Archaeology Ltd. The works were overseen by Richard Smalley of CgMs, the client's archaeological consultant, and were monitored by Sandy Kidd of Historic England, on behalf of the London Borough of Barnet.
- 2.6 Upon completion of the project the archive and all associated materials will be deposited with the London Archaeological Archive and Research Centre (LAARC) using the unique site code EBK 16.

3 ARCHAEOLOGICAL BACKGROUND

- 3.1 The archaeological background below is taken from the Written Scheme of Investigation (Smalley 2015).
- 3.2 The HER records no evidence of archaeological activity on the study site itself with the closest archaeological asset being a findspot of Mesolithic flint tools located approximately 60m to the west of the study site.
- 3.3 A medieval kiln is also recorded in close proximity of the study site, located approximately 78m to the north-east.
- 3.4 The study site is located approximately 60m south of the Galley Lane Archaeological Priority Area (APA). A medieval kiln was discovered in the Kings Road part of the APA, together with associated domestic rubbish and kiln fire bars which can be dated to the 13th century.
- 3.5 The Chipping Barnet APA is recorded approximately 585m east of the study site. Archaeological evidence in this area revealed Roman finds, including pottery sherds, and it has been suggested that the Roman station of *Sullioniacus* may be located here along with a 1st century mansion.
- 3.6 The majority of assets recorded in the wider study area are of a post-medieval nature and relate primarily to built heritage features such as churches, houses and hospitals. However, an archaeological evaluation undertaken off Wood Street identified a medieval ditch approximately 500m to the east of the study site.
- 3.7 Historic mapping shows that the study site comprised agricultural land and gardens related to the residential property known as 'Elmbank' from the mid-late 19th century with further residential development taking place during the mid-20th century.

4 RESEARCH FRAMEWORK

4.1 The specific aims of this project, as stated in the WSI, were:

- To establish the presence/absence, extent and character of any archaeological features on the site and to consider the archaeological interest of these in the context of the regional archaeological framework
- To examine any available evidence for economic activity and environmental conditions
- To generate an archive which will allow future research of the evidence to be undertaken if appropriate
- To disseminate the results of the work in a format and manner proportionate to the significance of the findings.

5 ARCHAEOLOGICAL METHODOLOGY

- 5.1 Trench positions were located by the client's contractor using GPS, prior to PCA's arrival on site.
- 5.2 Trench 1 had to be relocated and split into two (Trench 1A & 1B) owing to the identification of live services (gas and electricity) prior to excavation. Trench 1A had dimensions of 5.80m x 1.5 m while Trench 1B had dimensions of 7.5m x 1.5m. Trenches 2 and 3 were excavated in accordance with the Trench Plan outlined in the WSI (Smalley 2015).
- 5.3 Machining was undertaken by use of a JCB excavator and driver provided by PCA, using a toothless ditching bucket with spoil being mounded a safe distance from the trench edges.
- 5.4 Machine excavation was carried out in spits of 100mm until either modern services, significant archaeological deposits or natural deposits were reached.
- 5.5 Following machine excavation, all relevant faces of trenches requiring further examination were cleaned using appropriate hand tools.
- 5.6 All archaeological features and deposits were recorded in plan at either 1:20 or 1:50 and in section at a scale of 1:10 with all recording being done using pro forma sheets in a format widely used and accepted within the area.
- 5.7 Heights were recorded using Temporary Benchmarks extracted from a topographical survey drawing provided by the client.
- 5.8 Upon completion of the works and with the approval of the Archaeological Advisor, the trenches were backfilled to ground level.

6 ARCHAEOLOGICAL SEQUENCE BY PHASE

6.1 Phase 1 - Natural Deposits

- 6.1.1 Natural clay was encountered in Trenches 1A, 2 and 3. It was mid yellow-brown in colour and in Trench 1A had moderate inclusions of small round and sub angular pebbles that were noticeably absent in Trenches 2 and 3. The natural clay [8, 23 & 27] was seen at heights of 123.27m OD (Trench 1A), 122.94m OD (Trench 2) and 120.52m OD (Trench 3) suggesting that the natural deposits slope from the north – west towards the south – east, which is in keeping with the natural topography of the site.
- 6.1.2 More sandy silty clay natural deposits (patches of brickearth) were noted in Trenches 2 [22] and 3 [6 & 7] that, where present, directly overlaid the natural clay, at heights of between 123.56m OD in Trench 2 and 120.48m OD in Trench 3.

6.2 Phase 2 – 19th Century

- 6.2.1 In Trench 1A the 19th century was represented by a layer of made ground [26] comprising moderately compact mid-dark greyish brown sandy silt with occasional inclusions of small round and sub angular pebbles and cbm. There was also a 19th century field drain running through this layer. This layer, which sealed the natural gravel, was visible across the entire trench, was 0.18m thick and was seen at a height of 123.45m OD.
- 6.2.2 In Trench 2 this phase was represented by a layer of what was considered to be either plough or garden soil [19] comprising of moderately soft mid brown sandy silt that was 0.36m thick and seen at a height of between 123.66m and 123.72m OD.
- 6.2.3 Cut into layer [19] was a 19th century field drain [20 & 21] that was in turn sealed by a layer of 19th century made ground [18] comprising firm dark brown clayey sandy silt with occasional inclusions of cbm and flint pebbles. This layer was 0.20m thick and was seen at a height of 123.86m OD.
- 6.2.4 In Trench 3, four drainage ditches were recorded that were cut into the natural deposits [6 & 7]. These drainage ditches [4 & 5, 11 & 12, 13 & 14, 15 & 16] were rectilinear in shape and were seen at heights of between 120.75m and 121.01m OD. Trench 3 was noticeably positioned on a raised bank to the rear of Elmbank House. It is therefore assumed that these drainage ditches were set out at the time of the landscaping of the grounds during the 19th century.
- 6.2.5 These drainage ditches were sealed by a layer of 19th century made ground [3] comprising of soft mid brown sandy silt, that was 0.29m thick and seen at a height of between 120.94m and 121.01m OD.

6.3 Phase 3 – 20th Century

- 6.3.1 In Trench 1A this phase was represented by a soil horizon [25] comprising moderately firm mid brown sandy silt with moderate inclusions of small round and sub angular pebbles. This layer was 0.74m thick and was seen at a height of 124.20m OD.
- 6.3.2 Layer [25] was sealed by a layer of topsoil [26] comprising moderately soft mid greyish brown sandy silt with occasional inclusions of small round and sub angular pebbles and cbm fragments. This layer was 0.32m thick and was seen at a height of 124.57m OD.
- 6.3.3 In Trench 2, the entire trench was sealed by a layer of 20th century made ground [17] comprising compact dark grey sandy silt and building rubble. This layer was 0.15m thick and was seen at a height of 124.01m OD.
- 6.3.4 In Trench 3 a 20th century planting bed was recorded [9 & 10] that is believed to relate to the garden of Elmbank House. Broadly square in nature, it had dimensions of 0.75m east-west x 0.75m north-south and was 0.55m deep. It was filled with [9] firm light yellowish brown silty clay and was seen at a height of 121.01m OD.
- 6.3.5 Sealing planting bed [10] was a layer of 20th century made ground [2] comprising firm mid yellowish grey sandy silty clay that was 0.25m thick and seen at a height of 121.27m OD.

- 6.3.6 Sealing the whole of Trench 3 was a layer [1] of 20th century made ground comprising of compact dark grey sandy silt and building rubble that was 0.45m thick and seen at a height of 121.57m OD.
- 6.3.7 Trench 1B, when excavated, revealed nothing other than modern deposits comprising electricity cables, water mains and a substantial cut for a modern sewer, with no archaeological deposits or features being seen.

7 DISCUSSION AND CONCLUSIONS

- 7.1 The archaeological evaluation revealed a series of natural deposits, 19th century field drains and layers and 20th century made ground.
- 7.2 A primary objective of the archaeological evaluation was to establish the presence or absence of any evidence for medieval pottery production on the site. No archaeological deposits or features pre-dating the 19th century were noted during these works.
- 7.3 The majority, if not all, of the 19th century features and deposits recorded during the evaluation are likely to relate to Elmbank House and the associated landscaping of its grounds. This is particularly evident in Trench 3 where the trench was located within a discernable raised bank, visible to the rear of the property, that should be interpreted as a garden terrace with associated planting beds.
- 7.4 It is worth noting that all layers and deposits were particularly sterile of material culture. This would support the argument that the site was previously open fields and gardens with very little human activity having taken place. Should there have been medieval pottery production on the site then it seem implausible that all traces of it would have been removed during 19th century landscaping. The fact there is not even residual pottery present gives rise to the conclusion that the medieval pottery production identified in the Galley Lane APA did not extend as far as the study site.

8 ACKNOWLEDGEMENTS

- 8.1 Pre-Construct Archaeology Ltd would like to thank Richard Smalley of CgMs for commissioning the works on behalf of Linden Homes (Chiltern) Ltd. Thanks also go to Sandy Kidd (Archaeology Advisor at GLAAS) for monitoring the works on behalf of the London Borough of Barnet.
- 8.2 The author would like to thank Helen Hawkins for her project management, Mark Roughley for preparing the drawings, Tibi Nica for logistical support and last but not least, Corso Dominici for his work on site.

9 BIBLIOGRAPHY

Hawkins H, 2016, *Land at Elmbank, Barnet: Method Statement for Archaeological Evaluation*, PCA unpublished client report

Smalley R, 2015, *Archaeological Written Scheme of Investigation: Land at Elmbank, Barnet, Greater London, EN5 3DS*, CgMs unpublished client report

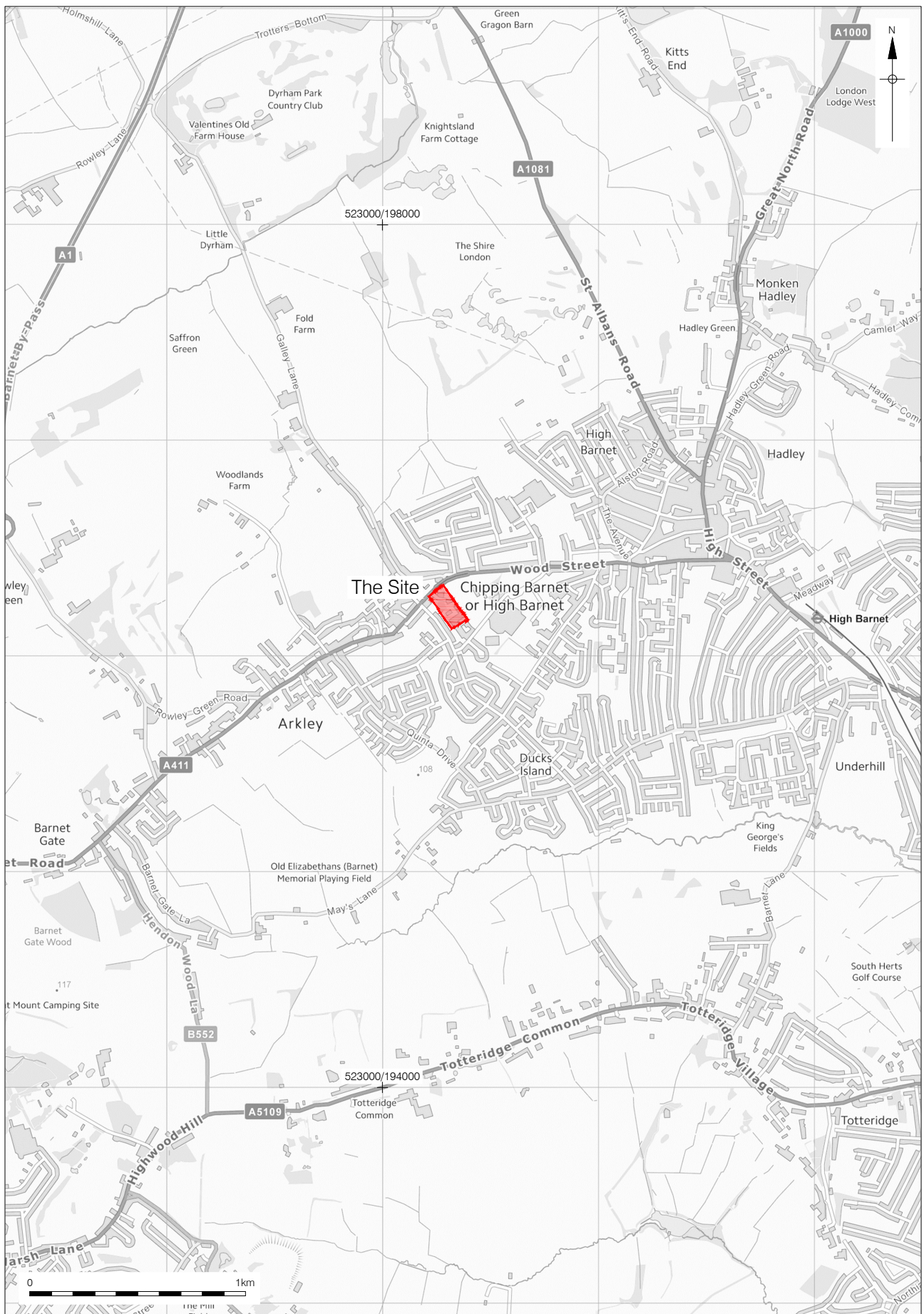

Contains Ordnance Survey data © Crown copyright and database right 2016

© Pre-Construct Archaeology Ltd 2016

05/04/16 MR

Figure 1
Site Location
1:25,000 at A4

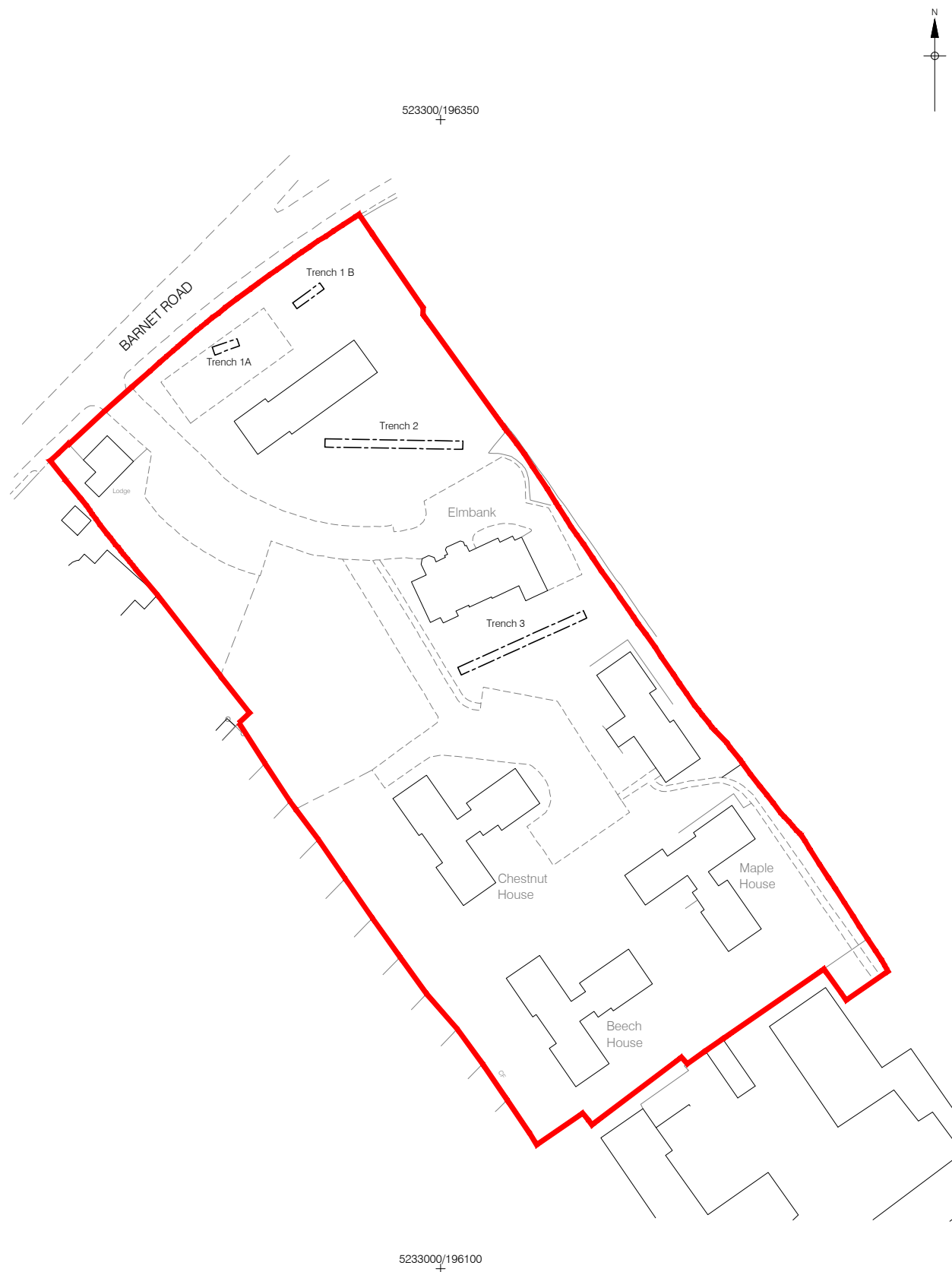

0 50m

Figure 2
 Detailed Site Location
 1:1,250 at A4



Trench 2

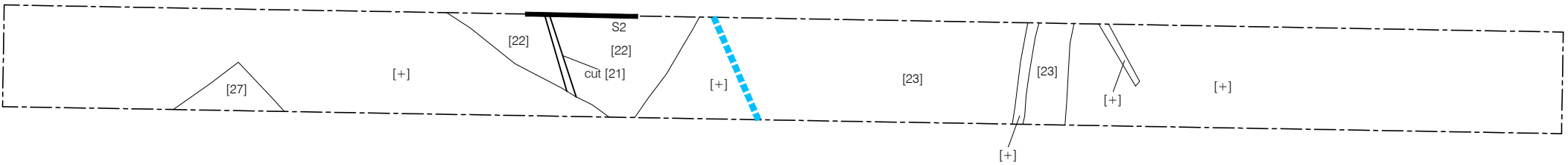

 Electrical Cable

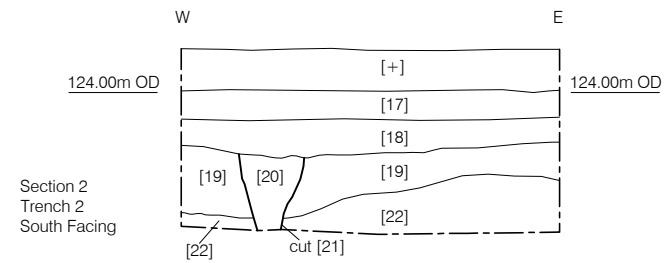

Figure 3
Plan and Section of Trench 2
Plan 1:100 and Section 1:40 at A4

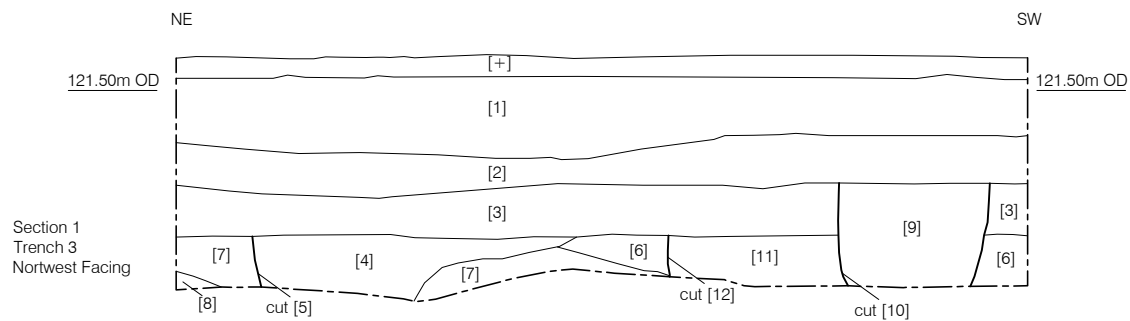
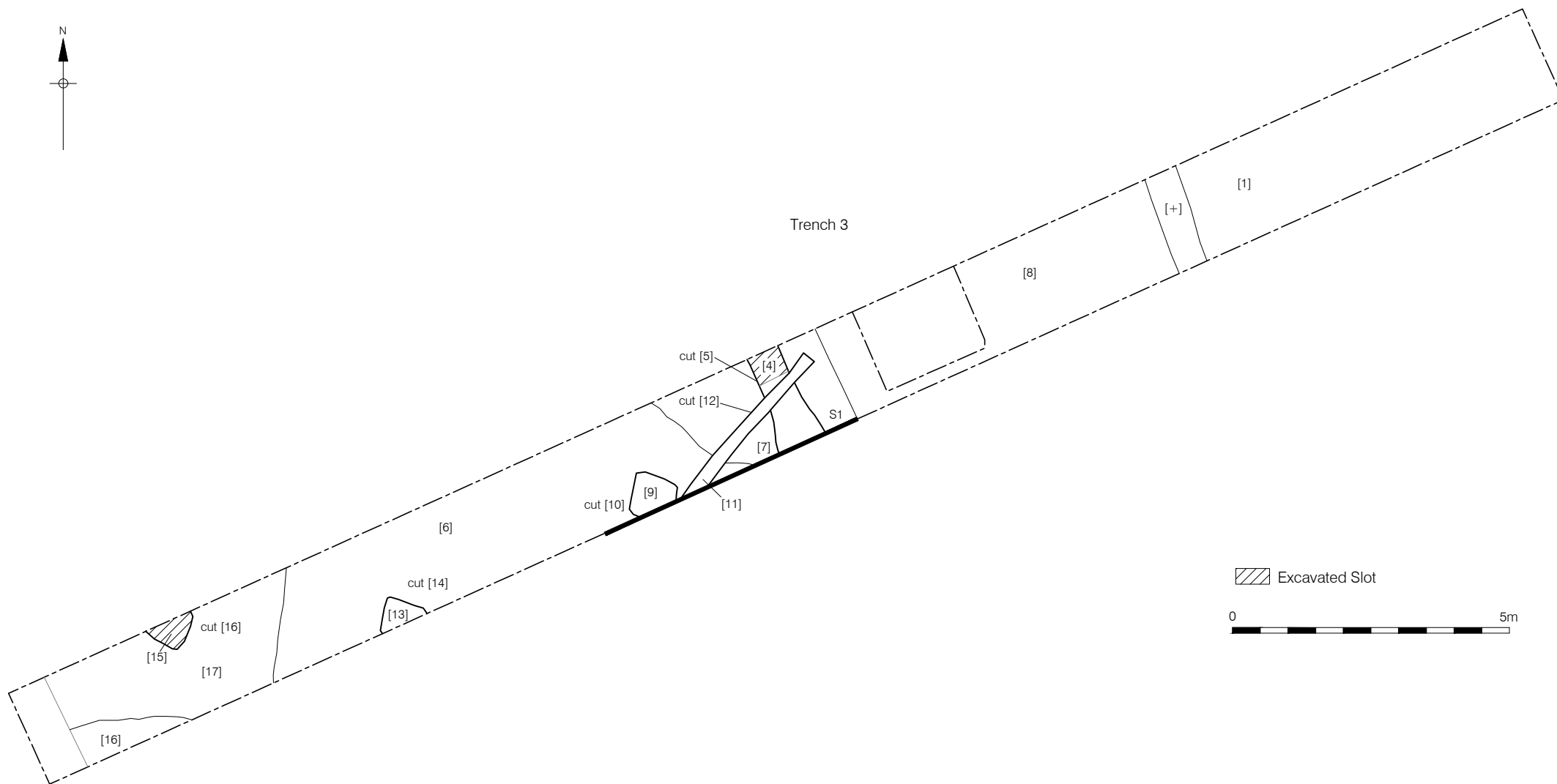

Figure 4
Plan and Section of Trench 3
Plan 1:100 and Section 1:40 at A4

APPENDIX 1: PLATES

Plate 1: Trench 1A: View West



Plate 2: Trench 2: Western End – View East



Plate 3: Trench 3: View North East



APPENDIX 2: PHASED MATRIX

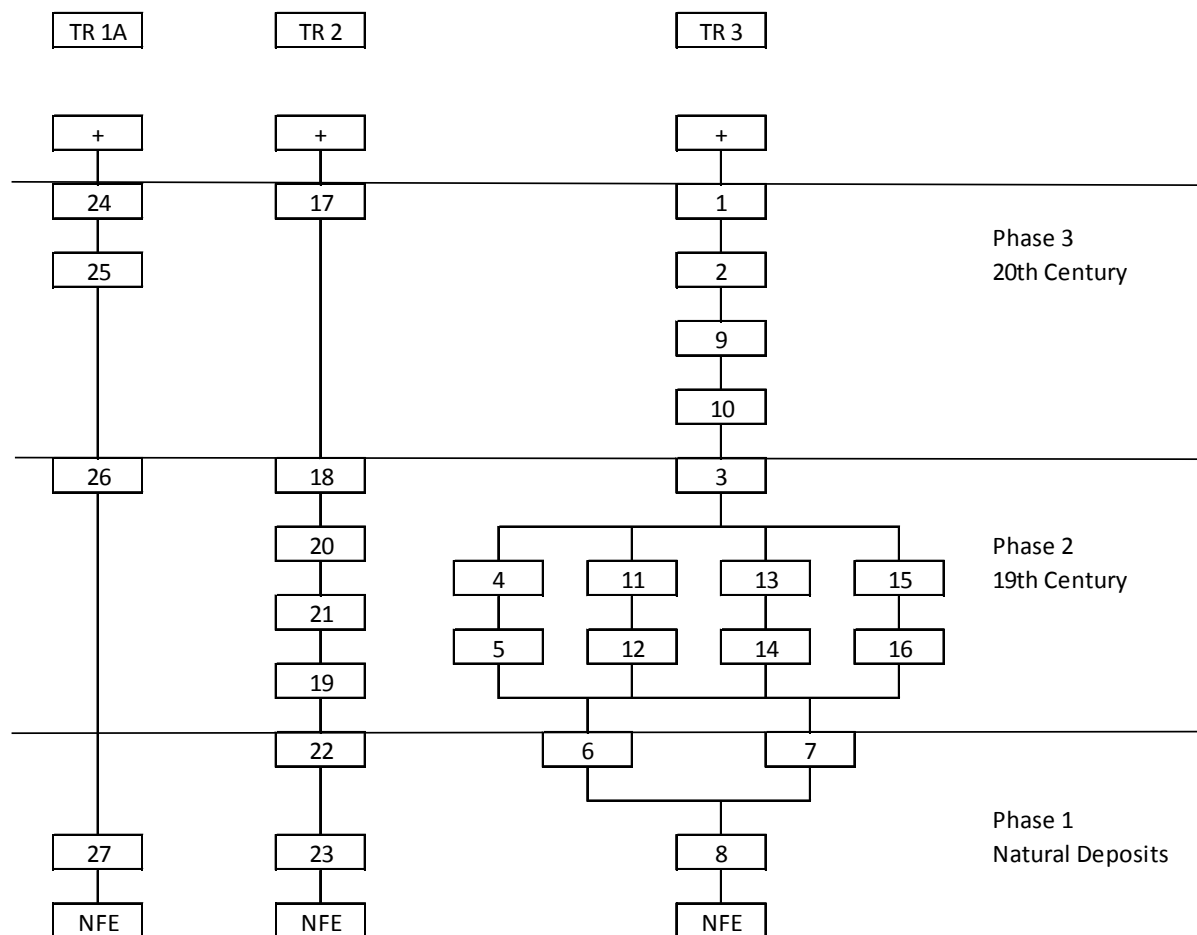

APPENDIX 3: CONTEXT INDEX

Site Code	Context No.	Trench No.	Plan	Section	Type	Highest Level	Lowest Level	Description
EBK 16	1	TR 3	TR 3	S. 1	Layer	121.57	121.57	Modern Made Ground
EBK 16	2	TR 3		S. 1	Layer	121.27	121.11	Levelling Layer
EBK 16	3	TR 3		S. 1	Layer	121.01	120.14	19th C Soil Horizon
EBK 16	4	TR 3	TR 3	S. 1	Fill	120.75	120.75	Fill of [5]
EBK 16	5	TR 3	TR 3	S. 1	Cut	120.75	120.23	Drainage Ditch
EBK 16	6	TR 3	TR 3	S. 1	Layer	120.48	120.39	Plough Soil
EBK 16	7	TR 3	TR 3	S. 1	Layer	120.48	120.47	Natural
EBK 16	8	TR 3	TR 3	S. 1	Layer	120.52	120.52	Natural Clay
EBK 16	9	TR 3	TR 3	S. 1	Fill	121.01	121.01	Fill of [10]
EBK 16	10	TR 3	TR 3	S. 1	Cut	121.01	120.39	Planting Bed
EBK 16	11	TR 3	TR 3	S. 1	Fill	120.74	120.74	Fill of [12]
EBK 16	12	TR 3	TR 3	S. 1	Cut	120.74	120.29	Field Drainage Ditch
EBK 16	13	TR 3	TR 3		Fill	121.01	121.01	Fill of [14]
EBK 16	14	TR 3	TR 3		Cut	121.01	120.43	Drainage Ditch
EBK 16	15	TR 3	TR 3		Fill	120.76	120.76	Fill of [16]
EBK 16	16	TR 3	TR 3		Cut	120.76	120.36	Drainage Ditch
EBK 16	17	TR 2		S. 2	Layer	124.01	124.01	Levelling Layer
EBK 16	18	TR 2		S. 2	Layer	123.86	123.86	Levelling Layer
EBK 16	19	TR 2		S. 2	Layer	123.72	123.66	Plough Soil
EBK 16	20	TR 2	TR 2	S. 2	Fill	123.67	123.65	Fill of [21]
EBK 16	21	TR 2	TR 2	S. 2	Cut	123.67	123.30	Field Drain
EBK 16	22	TR 2	TR 2	S. 2	Layer	123.56	123.24	Natural Brickearth
EBK 16	23	TR 2	TR 2		Layer	122.94	122.94	Natural Clay
EBK 16	24	TR 1A		S. 3	Layer	124.57	124.52	Topsoil
EBK 16	25	TR 1A		S. 3	Layer	124.20	124.20	20th C Soil Horizon
EBK 16	26	TR 1A		S. 3	Layer	123.45	123.45	19th C Soil Horizon
EBK 16	27	TR 1A	TR 1A	S. 3	Layer	123.27	123.27	Natural

APPENDIX 4: OASIS FORM

OASIS ID: preconst1-247359

Project details

Project name	Land at Elmbank Barnet, EN5 3DS: An Archaeological Evaluation
Short description of the project	An archaeological evaluation was carried out on land at Elmbank, Barnet, EN5 3DS in the London Borough of Barnet. Three trenches were excavated with one trench being sub divided into two segments. No features were found pre-dating the 19th century. During the 19th century, the site was heavily landscaped as part of the construction of Elmbank House. There was no evidence for medieval pottery production as found nearby.
Project dates	Start: 21-03-2016 End: 23-03-2016
Previous/future work	No / Not known
Any associated project reference codes	EBK 16 - Sitecode
Any associated project reference codes	15/03343/FUL - Planning Application No.
Type of project	Field evaluation
Site status	None
Current Land use	Vacant Land 1 - Vacant land previously developed
Monument type	DRAINAGE DITCHES Post Medieval
Monument type	PLANTING BEDS Post Medieval
Significant Finds	NONE None
Significant Finds	NONE None
Methods & techniques	""Targeted Trenches""
Development type	Urban residential (e.g. flats, houses, etc.)
Prompt	Planning condition
Position in the planning process	After full determination (eg. As a condition)

Project location

Country	England
---------	---------

Site location GREATER LONDON BARNET BARNET Land at Elmbank, Barnet, EN5 3DS

Postcode EN5 3DS

Study area 1.28 Hectares

Site coordinates TQ 23328 96198 51.650551920054 -0.217148070665 51 39 01 N 000 13 01 W Point

Height OD / Depth Min: 120.47m Max: 123.56m

Project creators

Name of Organisation Pre-Construct Archaeology Limited

Project brief originator Greater London Archaeological Advisory Service

Project design originator CgMs Consulting

Project director/manager Helen Hawkins

Project supervisor Ian Cipin

Type of sponsor/funding body House builder

Name of sponsor/funding body Linden Homes (Chiltern) Ltd

Project archives

Physical Archive recipient LAARC

Physical Archive ID EBK16

Physical Contents "Ceramics"

Digital Archive recipient LAARC

Digital Archive ID EBK16

Digital Contents "Ceramics"

Digital Media available "Database", "Images raster / digital photography", "Text", "Survey"

Paper Archive recipient	LAARC
Paper Archive ID	EBK16
Paper Contents	"none"
Paper Media available	"Context sheet", "Drawing", "Photograph", "Plan", "Report", "Section", "Unpublished Text"

**Project
bibliography 1**

Publication type	Grey literature (unpublished document/manuscript)
Title	Land at Elmbank, Barnet, EN5 3DS: An Archaeological Evaluation
Author(s)/Editor(s)	Cipin, I
Date	2016
Issuer or publisher	Pre-Construct Archaeology Ltd
Place of issue or publication	London
Description	An A4 ring bound client document
Entered by	archive (archive@pre-construct.com)

APPENDIX 4: CBM REPORT

Review of Ceramic Building Material, Land at Elmbank, Barnet (EBL16)

Amparo Valcarcel

Central National Grid Reference: TQ 23328 96198

BUILDING MATERIALS SPOT DATES

Context	Fabric	Form	Size	Date range of material		Latest dated material		Spot date	Spot date with mortar
6	2281	Post med drain pipe	1	1700	1950	1700	1950	1700-1950	No mortar
7	2281	Post med drain pipe	1	1700	1950	1700	1950	1700-1950	No mortar
11	2281	Whole post med drain pipe	1	1700	1950	1700	1950	1700-1950	No mortar
15	3032R; 2281	Abraded post great fire brick; post med drain pipe	2	1666	1950	1700	1950	1700-1950	No mortar

Review

The small assemblage (5 fragments, 1.04 kg) consists mainly of small pieces of fragmentary late post medieval ceramic building material (drain pipes and post great fire brick).

The building material assemblage reflects the later post medieval (18th -20th centuries) development of this site and none of the material is of intrinsic interest. No further work recommended.

APPENDIX 5: POTTERY REPORT

Pottery assessment (EBK16)

Chris Jarrett

A single sherd of pottery (4g) was recovered from the archaeological investigation and was found in context [15]. The sherd is in a good condition and was probably deposited soon after deposition and consists of refined whiteware with under-glaze transfer-printed 'flow blue' decoration (TPW FLOW), dated c.1830–1900. The form the sherd was recovered from is uncertain, although it is most likely to be from a closed one. The external decoration is of a floral type encompassing a large flower head. There are no recommendations for further work on the sherd as it has no significance and its only potential is to date the deposit it was recovered from. As the pottery is of a type frequently found in the London area and as it is fully recorded, then it can be discarded.

PCA

PCA SOUTH

UNIT 54
BROCKLEY CROSS BUSINESS CENTRE
96 ENDWELL ROAD
BROCKLEY
LONDON SE4 2PD
TEL: 020 7732 3925 / 020 7639 9091
FAX: 020 7639 9588
EMAIL: info@pre-construct.com

PCA NORTH

UNIT 19A
TURSDALE BUSINESS PARK
DURHAM DH6 5PG
TEL: 0191 377 1111
FAX: 0191 377 0101
EMAIL: info.north@pre-construct.com

PCA CENTRAL

THE GRANARY, RECTORY FARM
BREWERY ROAD, PAMPISFORD
CAMBRIDGESHIRE CB22 3EN
TEL: 01223 845 522
FAX: 01223 845 522
EMAIL: info.central@pre-construct.com

PCA WEST

BLOCK 4
CHILCOMB HOUSE
CHILCOMB LANE
WINCHESTER
HAMPSHIRE SO23 8RB
TEL: 01962 849 549
EMAIL: info.west@pre-construct.com

PCA MIDLANDS

17-19 KETTERING RD
LITTLE BOWDEN
MARKET HARBOROUGH
LEICESTERSHIRE LE16 8AN
TEL: 01858 468 333
EMAIL: info.midlands@pre-construct.com

