

**AN ARCHAEOLOGICAL WATCHING BRIEF THE LAND TO THE REAR OF
56-58 SHOOTERS HILL ROAD, LONDON BOROUGH OF GREENWICH.**

Site Code: SOD 07

Central National Grid Reference: TQ 4052 7695

**Written and Researched by Ireneo Grosso
Pre-Construct Archaeology Limited, June 2007**

Project Managers: Tim Bradley and Chris Mayo

Commissioning Client: Wilkins Estates Co. Ltd.

**Contractor:
Pre-Construct Archaeology Limited
Unit 54 Brockley Cross Business Centre
96 Endwell Road
Brockley
London
SE4 2PD**

**Tel: 020 77323925
Fax: 020 77327896
E-mail: tbradley@pre-construct.com
Web: www.pre-construct.com**

**© Pre-Construct Archaeology Limited
June 2007**

© The material contained herein is and remains the sole property of Pre-Construct Archaeology Limited and is not for publication to third parties without prior consent. Whilst every effort has been made to provide detailed and accurate information, Pre-Construct Archaeology Limited cannot be held responsible for errors or inaccuracies herein contained.

CONTENTS

1	Abstract	3
2	Introduction	4
3	Archaeological and Historical Background	7
4	Geography and Topography	7
5	Archaeological Methodology	8
6	Archaeological Discription	9
7	Conclusion	12
8	Acknowledgements	13
Appendix 1		
	Context Index	14
Appendix 2		
	Oasis Data Collection Form	15
	Figure 1: Site Location.....	5
	Figure 2: Trench Location.....	6
	Figure 3: Sections 1 and 5.....	11

1 ABSTRACT

- 1.1 This report details the results and working methods of an archaeological watching brief undertaken by Pre-Construct Archaeology Limited at the land to the rear of 56-58 Shooters Hill Road, London Borough of Greenwich. The watching brief was undertaken on the 24th and 25th of May 2007, and was commissioned by Wilkins Estates Co. Ltd.
- 1.2 Four foundation trenches associated with the construction of three new houses, one garage and a parking bay, were excavated across the site, which is located at the southern end of existing back gardens of 56-58 Shooters Hill Road. The first trench to be excavated measured 15.75m north-south by 0.60m east-west, and represented the western side of the foundation trench for the new development. This trench was excavated to depths of between 1.10m and 0.95m from ground level. The other three trenches, all measuring 12m east-west by 0.60m north-south, and were excavated to depths between 1.10m and 0.95m. These trenches represented the foundation trenches dividing the three proprietaries.
- 1.3 The earliest deposit observed across the site was natural sandy gravel recorded in all the foundation trenches. This natural deposit was sealed by dark brown gravelly sandy silt interpreted as modern garden soil. No archaeological features were observed in any of the foundation trenches.

2 INTRODUCTION

- 2.1 An archaeological watching brief was conducted on the excavation of the foundation trenches for three new houses at the southern end of existing back gardens of 56-58 Shooters Hill Road, London Borough of Greenwich.
- 2.2 The site is located within an Archaeological Priority Area as defined by the Unitary Development Plan for the Borough in respect of the suspected location (and possible divergence) of a Roman road in the vicinity of the site. The watching brief was conducted on the 24th and 25th of May 2007 and was commissioned by Wilkins Estates Co. Ltd.
- 2.3 The site is located on the north east side of the junction of Shooters Hill Road and Kidbrooke Park Road, and is bounded by Rosse Mews to the south, Kidbrooke Park Road to the west, and residential gardens to the north and east.
- 2.4 The watching brief was project managed for Pre-Construct Archaeology by Tim Bradley and Chris Mayo and was supervised by the author. The site was monitored by Mark Stevenson, English Heritage (GLAAS), on behalf of the London Borough of Greenwich.
- 2.5 The site central National Grid Reference was TQ 4052 7695.
- 2.6 The site was given the code SOD 07.

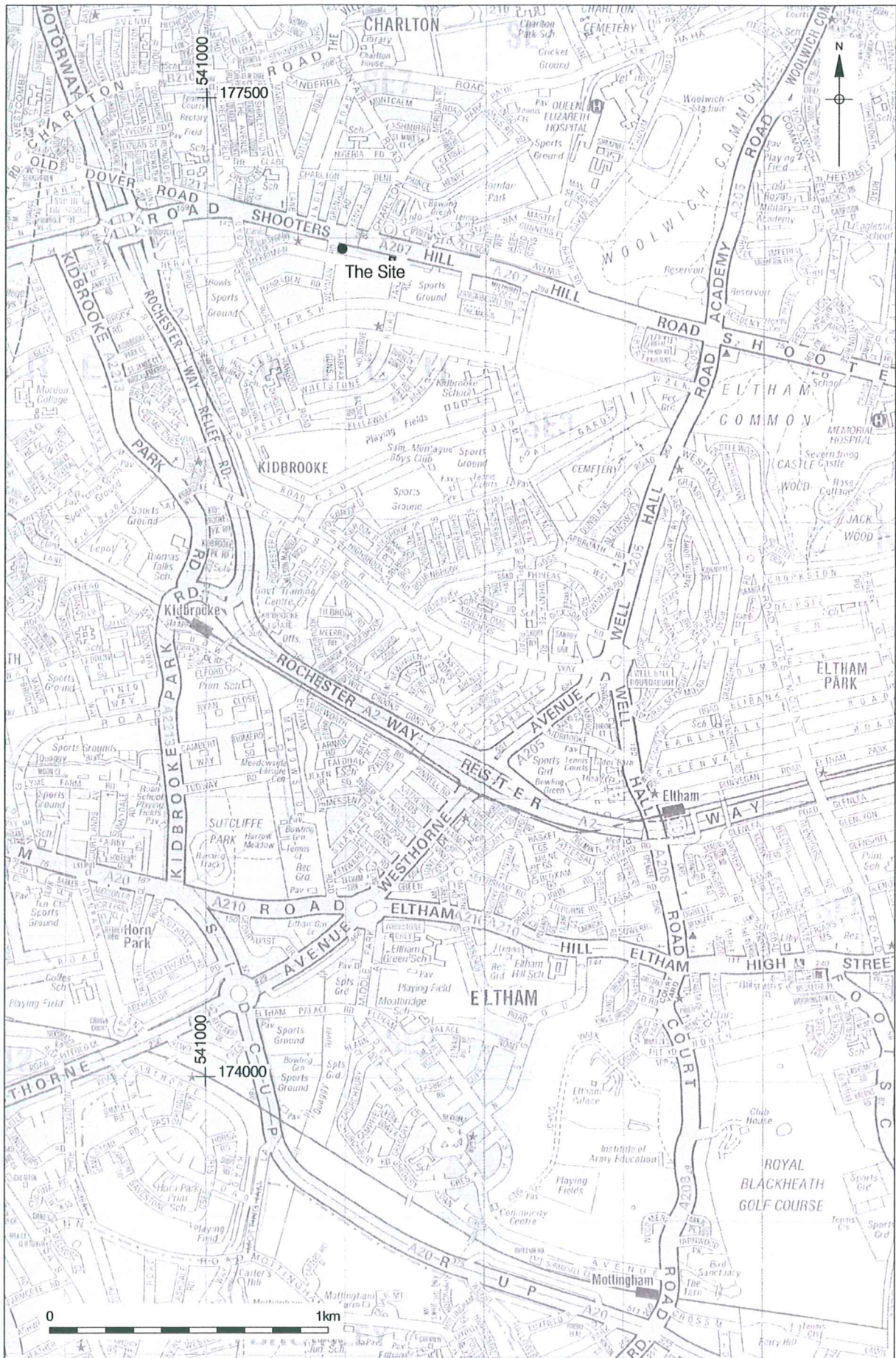

© Pre-Construct Archaeology Ltd. 2007.

Figure 1
Site Location
1:20,000 at A4

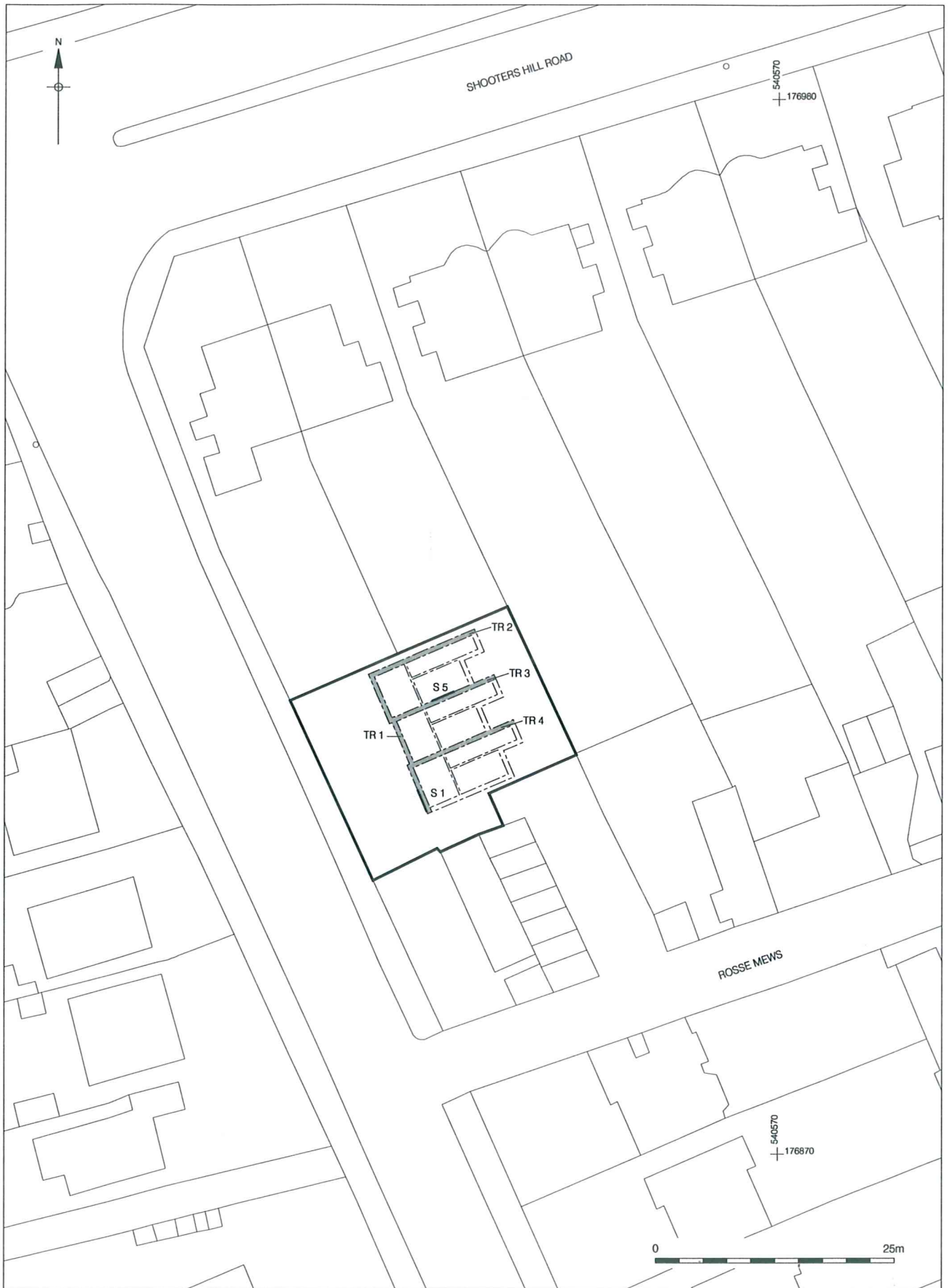

© Crown copyright 2007. All rights reserved. License number PMP36110309

© Pre-Construct Archaeology Ltd. 2007

Figure 2
Trench Location
1:500 at A3

3 ARCHAEOLOGICAL AND HISTORICAL BACKGROUND

- 3.1 Shooters Hill Road forms part of the Roman Road, Watling Street, which ran from Dover to London (as such, the Unitary Development Plan for Greenwich labels this site as within an Area of Archaeological Potential). Roman activity has been concentrated along the line of the Roman road, which has itself been excavated revealing compacted gravels and a road-side ditch.

4 GEOLOGY AND TOPOGRAPHY

- 4.1 The drift geology of the site is shown on the British Geological Survey South London map as sand and flint pebbles beds, with the land sloping downwards from the high Harwich formations of Greenwich to the north-west.

5 ARCHAEOLOGICAL METHODOLOGY

- 5.1 The four trenches were reduced by mechanical excavator fitted with a flat bladed ditching bucket under archaeological supervision.
- 5.2 One N-S orientated trench (Trench 1) was situated to the west of the site with a maximum length of 15.75m a width of about 0.60m and a maximum depth of 1.10m from ground level.
- 5.3 Three E-W orientated trenches (Trenches 2, 3 and 4) were located within the footprint of the building and represented the foundation trenches dividing the three proprietaries. They were of equal dimensions, each measuring 12m E-W by 0.60m wide. Their depth was between 1.10m and 0.95.
- 5.4 Following mechanical excavation all modern and natural deposits exposed were cleaned by hand, drawn either in plan at 1:50 or in section at 1:10, and recorded on *pro forma* context sheets. A photographic record was also compiled during the watching brief, employing colour transparency and black and white print formats.
- 5.5 The completed archive, comprising written, drawn and photographic records, will be deposited with the London Archaeological Archive Research Centre (LAARC).

6 ARCHAEOLOGICAL DESCRIPTION

6.1 Trench 1

This trench formed the western N-S foundation trench for the building and measured 15.75m by 0.60m wide.

The earliest deposit encountered was a mid orangey yellowish sandy clay gravel [1], observed across the trench at a maximum depth of 0.30m from ground level. It had a maximum thickness of 0.97m and was interpreted as natural deposit. Natural gravel [1] was truncated by a modern intrusion located in the SW area of the site and measuring 1.90m N-S by 0.60m E-W and 0.90m deep. The modern backfill of this intrusion was in turn sealed by a 0.17m thick deposit of dark brown gravelly silt interpreted as modern garden soil.

6.2 Trench 2

This trench was located within the footprint of the new building, followed an E-W alignment and measured 0.60m N-S by 12m E-W. The trench covered the entire width of the new building.

The earliest deposit observed across this trench was a mid orangey yellowish sandy clay gravel [1]. This gravel had at a maximum depth of 0.25m from ground level to the west and 0.15m to the east, with a maximum thickness of 0.87m, and was interpreted as natural deposit. Natural gravel [1] was sealed by dark brown silty gravel deposit which was 0.25m thick towards the west and 0.15m towards the east, and was interpreted as modern garden soil.

6.3 Trench 3

This trench was located south of Trench 2 and north of Trench 4 within the footprint of the new building. It followed an E-W alignment and measured 0.60m N-S by 12m E-W and covered the whole width of the new building.

The earliest deposit observed across this trench, at a maximum depth of 0.25m from ground level, was mid orangey yellowish sandy clay gravel [1] with a maximum thickness of 0.70m. This deposit was interpreted as a natural deposit. Gravel [1] was sealed by a dark brown silty gravel deposit 0.25m thick, interpreted as modern garden soil.

6.4 Trench 4

This trench was located south of Trench 3 and within the footprint of the new building. It followed an E-W alignment, measured 0.60m N-S by 12m E-W and covered the whole width of the new building.

The earliest deposit observed across this trench was mid orangey yellowish sandy clay gravel [1], recorded at a depth of 0.35m from ground level and with a maximum thickness of 0.60m. This layer was interpreted as natural deposit. Natural gravel [1] was sealed by a dark brown silty gravel deposit, which was 0.35m thick and was interpreted as modern garden soil.

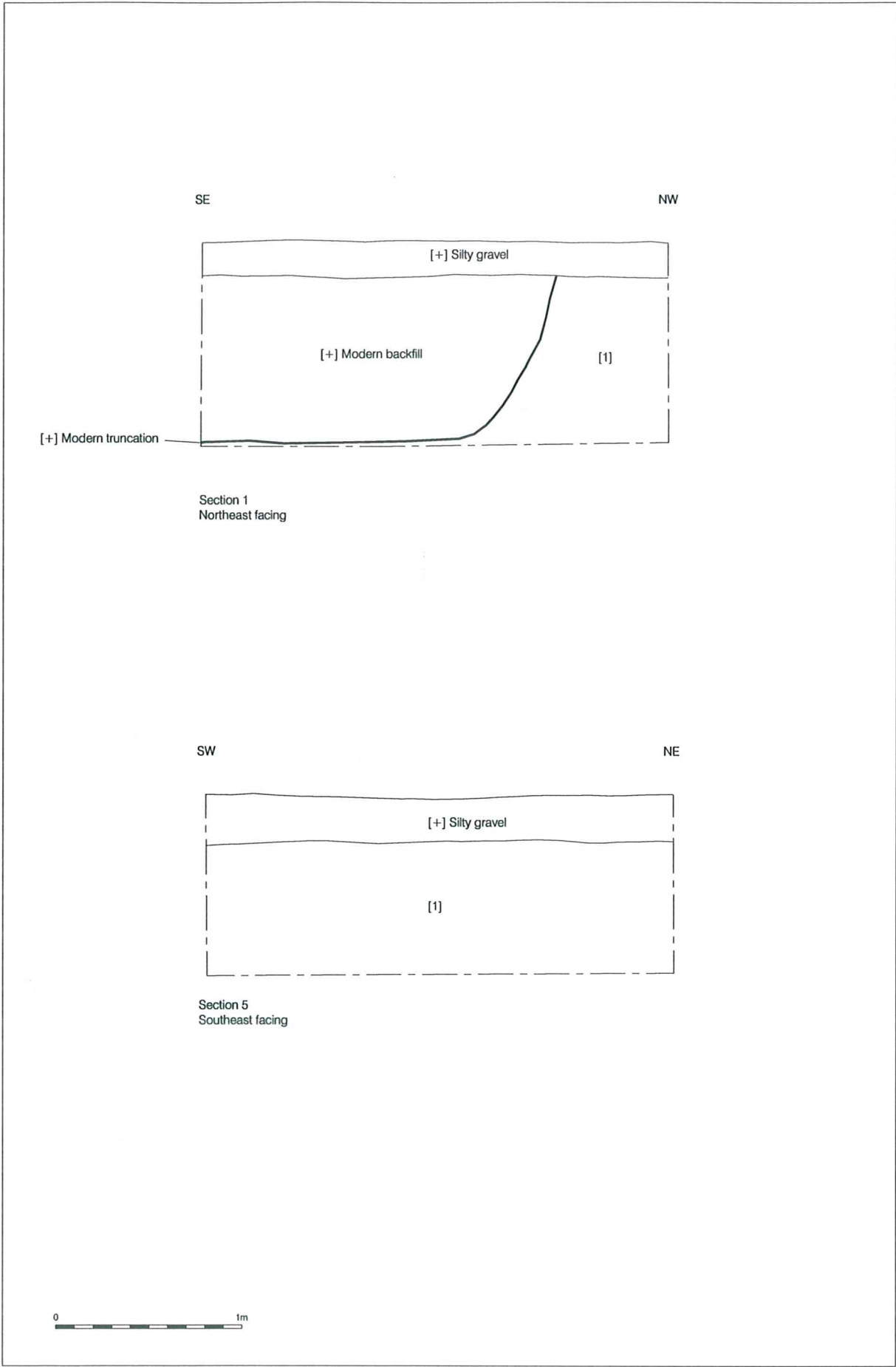

© Pre-Construct Archaeology Ltd.2007

Figure 3
Sections 1 & 5
1:30 at A4

7 CONCLUSIONS

- 7.1 One of the principal objectives of the watching brief was to determine the presence of any surviving archaeological remains liable to be threatened by the new development, particularly relating to the Roman road known to have been situated in the vicinity of the site. No archaeological features, structures, deposits or finds were recorded during the excavation of the foundation trenches. The only feature recorded during the monitoring of the excavations was a modern intrusion located in the SW corner of the development area. Natural sandy clay gravel was observed across the site at depths between 0.35m and 0.15m below ground level, with a maximum excavated thickness of 0.97m.

8 ACKNOWLEDGEMENTS

- 8.1 Pre-Construct Archaeology Limited would like to thank Wilkins Estates Co. Ltd. for commissioning the project and Mark Stevenson of English Heritage (GLAAS) for monitoring the work.

- 8.2 The author would like to thank Tim Bradley and Chris Mayo for project managing the watching brief and editing the present report and Dave Harris for the illustrations.

APPENDIX 1: CONTEXT INDEX

Context	Type	Description
1	Deposit	Natural sandy clay gravel

APPENDIX 2

Oasis Data Collection Form

1.3 OASIS ID: preconst1-28437

Project details

Project name 56-58 Shooters Hill Road

Short description of the project Four foundation trenches associated with the construction of three new houses, one garage and a parking bay, were excavated across the site, which is located at the southern end of existing back gardens of 56-58 Shooters Hill Road. The first trench to be excavated measured 15.75m north-south by 0.60m east-west, and represented the western side of the foundation trench for the new development. This trench was excavated to depths of between 1.10m and 0.95m from ground level. The other three trenches, all measuring 12m east-west by 0.60m north-south, and were excavated to depths between 1.10m and 0.95m. These trenches represented the foundation trenches dividing the three properties. The earliest deposit observed across the site was natural sandy gravel recorded in all the foundation trenches. This natural deposit was sealed by dark brown gravelly sandy silt interpreted as modern garden soil. No archaeological features were observed in any of the foundation trenches.

Project dates Start: 24-05-2007 End: 25-05-2007

Previous/future work No / No

Type of project Recording project

Site status Area of Archaeological Importance (AAI)

Current Land use Other 5 - Garden

Investigation type 'Watching Brief'

Prompt Direction from Local Planning Authority - PPG16

Project location

Country	England
Site location	GREATER LONDON GREENWICH GREENWICH 56-58 Shooters Hill Road, London Borough of Greenwich
Postcode	SE3 7BG
Study area	500.00 Square metres
Site coordinates	TQ 4052 7695 51.4735319522 0.02353016969860 51 28 24 N 000 01 24 E Point

Project creators

Name of Organisation	Pre-Construct Archaeology Ltd
----------------------	-------------------------------

Project brief originator	English Heritage
--------------------------	------------------

Project design originator	Pre-Construct Archaeology Ltd
---------------------------	-------------------------------

Project director/manager	Tim Bradley / Chris Mayo
--------------------------	--------------------------

Project supervisor	Ireneo Grosso
--------------------	---------------

Type of sponsor/funding body	Building contractor
------------------------------	---------------------

Name of sponsor/funding body	Wilkins Estates Co. Ltd
------------------------------	-------------------------

Project archives

Physical Archive Exists?	No
--------------------------	----

Digital Archive recipient	LAARC
---------------------------	-------

Digital Contents	'Stratigraphic'
Digital Media available	'Text'
Paper Archive recipient	LAARC
Paper Media available	'Photograph','Plan','Report','Section','Unpublished Text'
Entered by	Tim Bradley (tbradley@pre-construct.com)
Entered on	10 July 2007