

**CHERRY HILL PARK PLAY AREA,
ELY, CAMBRIDGESHIRE:
ARCHAEOLOGICAL MONITORING**

PCA REPORT NO: R12804

SITE CODE: ECB4986

FEBRUARY 2017

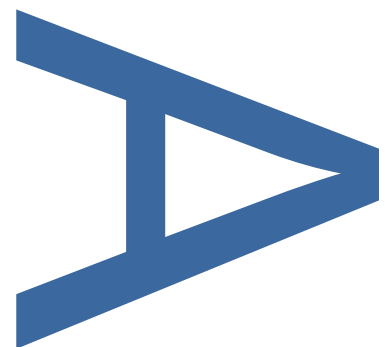
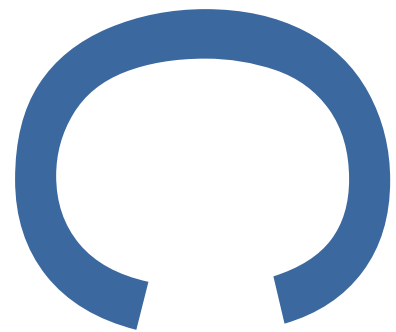

PRE-CONSTRUCT ARCHAEOLOGY

Cherry Hill Park Play Area, Ely, Cambridgeshire: Archaeological Monitoring

Local Planning Authority: City of Ely Council

National Grid Reference: TL 5479 2895

Site Code: ECB4986

Planning Reference: N/A

Report No. R12804

Written and researched by: Mary-Anne Slater
Pre-Construct Archaeology Ltd

Project Manager: Mark Hinman

Commissioning Client: Roland Harris

Contractor: Pre-Construct Archaeology Ltd
Central Office
The Granary
Rectory Farm
Brewery Road
Pampisford
Cambridgeshire
CB22 3EN

Tel: 01223 845522

E-mail: mhinman@pre-construct.com

Website: www.pre-construct.com

©Pre-Construct Archaeology Ltd
February 2017

The material contained herein is and remains the sole property of Pre-Construct Archaeology Ltd and is not for publication to third parties without prior consent. Whilst every effort has been made to provide detailed and accurate information, Pre-Construct Archaeology Ltd cannot be held responsible for errors or inaccuracies herein contained.

CONTENTS

CONTENTS	2
ABSTRACT.....	3
1 INTRODUCTION	4
2 GEOLOGY AND TOPOGRAPHY	5
3 ARCHAEOLOGICAL BACKGROUND	6
4 METHODOLOGY.....	7
5 RESULTS	8
6 CONCLUSIONS.....	9
7 ACKNOWLEDGEMENTS	10
8 BIBLIOGRAPHY	11
9 APPENDIX 1: PLATES	15
10 APPENDIX 2: CONTEXT INDEX.....	18
11 APPENDIX 3: OASIS FORM.....	19
FIGURE 1 SITE LOCATION	12
FIGURE 2 DETAILED SITE LOCATION.....	13
FIGURE 3 SECTIONS	14
PLATE 1: AREA OF TEST PITS 1-6, VIEW EAST	15
PLATE 2: AREA OF TEST PITS 7-10, VIEW NORTH-EAST.....	15
PLATE 3: AREA OF TEST PITS 11-20, VIEW WEST.....	16
PLATE 4: TEST PIT 1, VIEW NORTH-WEST	16
PLATE 5: TEST PIT 6, VIEW NORTH-WEST.....	17
PLATE 6: TEST PITS 14-15, VIEW NORTH-WEST	17

ABSTRACT

This report describes the results of archaeological monitoring carried out by Pre-Construct Archaeology at Cherry Hill Park Play Area, Ely, Cambridgeshire (centred on NGR TL 5479 2895) on 14th-15th February 2017. Monitoring of three areas of foundation holes was undertaken as part of a refurbishment of Cherry Hill Park Play Area. The aim of the work was to monitor and record any archaeological remains which would be damaged or destroyed by the new development.

No archaeological features were observed during monitoring of the 20 test pits in Cherry Hill Park Play Area.

1 INTRODUCTION

- 1.1 Archaeological monitoring was undertaken by Pre-Construct Archaeology Ltd (PCA) at Cherry Hill Park Play Area, Ely, Cambridgeshire (centred on Ordnance Survey National Grid Reference (NGR) TL 5479 2895) on 14th-15th February 2017 (Figure 1; Plate 1).
- 1.2 The Cherry Hill Park Play Area is located to the west of Broad Street, 180m east of Cherry Hill Motte and Bailey and 300m south-east of Ely Cathedral.
- 1.3 Monitoring of three areas of foundations was undertaken as part of a refurbishment of Cherry Hill Park Play Area.
- 1.4 The aim of the monitoring was to characterise the nature, extent, date, state of preservation and significance of any archaeological features or deposits within the areas affected by the ground reduction.
- 1.5 The monitoring identified no archaeological features.
- 1.6 This report describes the results of the archaeological monitoring at Cherry Hill Park Play Area, Ely. The site archive will be deposited at Cambridgeshire County Archaeological Store.

2 GEOLOGY AND TOPOGRAPHY

- 2.1 The geology of the site is Kimmeridge Clay Formation - Mudstone, sedimentary bedrock formed approximately 151 to 156 million years ago in the Jurassic Period (British Geological Survey 2017; Website 1). No superficial deposits are recorded for this area.
- 2.2 The site is at an elevation of approximately 6m above Ordnance Datum. Ely occupies the highest land in the fens and, before fen drainage, was an 'island' surrounded by low-lying wetlands. The site lies on the slope between the high ground where Ely Cathedral is situated and the low ground to the east by the River Great Ouse.

3 ARCHAEOLOGICAL BACKGROUND

- 3.1 The following material has been derived from a search of the CHER.
- 3.2 The Cherry Hill Park Play Area lies 180m east of Cherry Hill Castle Mound, a small motte and bailey thought to be built in the late 11th century by William I after the submission of the Isle of Ely (CHER 01764). In the years following the Norman Conquest the Isle of Ely became the focus of groups hostile to the Normans. In AD 1070 the Danish fleet moved south from the Humber to the Wash, where it was joined by local groups, and a joint Anglo-Danish force attacked Peterborough. William I made a treaty with the Danish, but a nucleus of native resistance remained in Ely under the leadership of Hereward. This group was joined by Earl Morcar in AD 1071, and William moved to blockade Ely in the same year. The motte and bailey is thought to date from this period, but it is not certain that it does.
- 3.3 Excavations in Cherry Hill Park between 1974 and 1977 revealed the base of an 18th century windmill and timber posts relating to a 19th century summerhouse (CHER 01764). There are no records for any excavations of the motte or bailey earthworks.
- 3.4 Excavations at Forehill and Lisle Lane, to the north-east of the site, confirmed the survival of more than 1.2m of archaeological stratigraphy dating to the 12th-19th centuries along most of the Forehill frontage (CHER 11858). Recovery of pottery wasters and kiln furniture suggests the presence of a 14th century kiln and pottery production workshop in the vicinity.

4 METHODOLOGY

- 4.1 The archaeological monitoring observed the excavation of footings for new park equipment to a depth of c.0.6-1m.
- 4.2 Ground reduction was carried out under archaeological supervision using a 2-ton tracked mini excavator with ditching bucket.
- 4.3 Deposits or the removal of deposits judged by the excavating archaeologist to constitute individual events were each assigned a unique record number (often referred to within British archaeology as 'context numbers') and recorded on individual pre-printed forms (Taylor and Brown 2009). Archaeological processes recognised by the deposition of material are signified in this report by round brackets (thus), while events constituting the removal of deposits are referred to here as 'cuts' and signified by square brackets [thus]. The record numbers assigned to cuts and deposits are entirely arbitrary and in no way reflect the chronological order in which events took place. All features and deposits recorded during the evaluation are listed in Appendix 2. Artefacts recovered during excavation were assigned to the record number of the deposit from which they were retrieved.
- 4.4 High-resolution digital photographs were taken of all relevant features and deposits, and were used to keep a record of the excavation process.

5 RESULTS

- 5.1 20 test pits were monitored, between depths of 0.6-0.9m deep. The bottom layer in each test pit was not fully excavated.
- 5.2 Test Pits 1-4 (Figure 2, Section 1) were between 0.82 and 0.90m deep, through topsoil (100), subsoil (101) and a mid-greyish brown silty clay deposit (102) which was 0.50m+ thick. No finds were present.
- 5.3 Test Pit 5 (Figure 2, Section 2) was 0.90m deep. Underneath the topsoil and subsoil were two deposits: a mid orange/grey brown silty clay with chalk and gravel (103) which was 0.24m thick, and a dark greyish-brown silty clay (106) which was 0.18m+ thick. No finds were present.
- 5.4 Test Pit 6 (Figure 2, Section 3) was 0.84m deep. A layer of modern gravel (104) was seen within the topsoil, which appeared to be related to the construction of the play area. Underneath the topsoil was a dark greyish-brown silty clay with chalk and gravel (105) which was 0.32m+ thick. No finds were present.
- 5.5 Test Pits 7-10 (Figure 2, Section 4) were between 0.84 and 0.89m deep, through topsoil, subsoil and a mid orange/grey brown silty clay with occasional CBM flecks (105) which was 0.42m+ thick. No finds were present.
- 5.6 Test Pits 11-20 (Figure 2, Section 5) were 0.60m deep, through modern play park bracken (108) and modern deposited mid-greenish/yellow grey clay (109) which was 0.40m+ thick. These modern deposits appeared to be related to the original construction of the play area. No finds were present.

6 CONCLUSIONS

- 6.1 Monitoring of the twenty foundation footing trenches in Cherry Hill Park Play Area revealed no archaeological features. The test pits revealed modern deposits associated with the construction of the play area and layers of silty clay which contained no finds so were unable to be dated.
- 6.2 These results are of local significance.

7 ACKNOWLEDGEMENTS

- 7.1 Pre-Construct Archaeology Ltd would like to thank Dr Roland Harris at Ely Cathedral, for his help in this project. The project was managed for PCA by Mark Hinman. Figures accompanying this report were prepared by PCA's CAD Department.

8 BIBLIOGRAPHY

British Geological Survey Geology of Britain Viewer
<http://mapapps.bgs.ac.uk/geologyofbritain/home.html> Accessed 16/02/2017



© Crown copyright 2006. All rights reserved. License number 36110309

© Pre-Construct Archaeology Ltd 2017

28/02/17 RM

Figure 1
Site Location
1:20,000 at A4

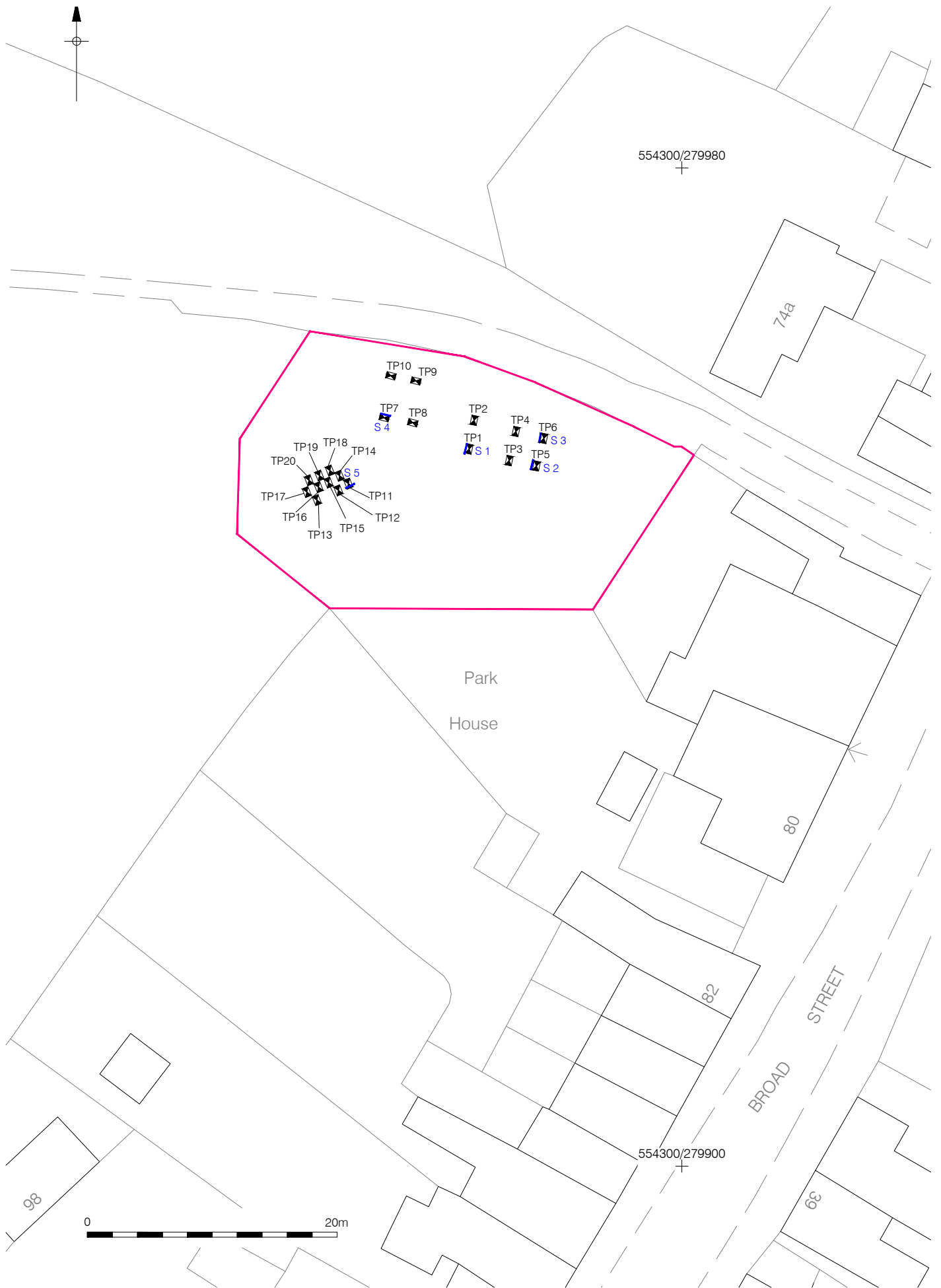
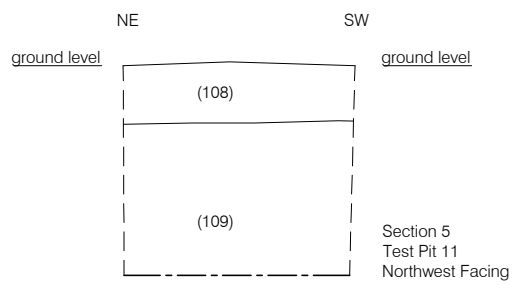
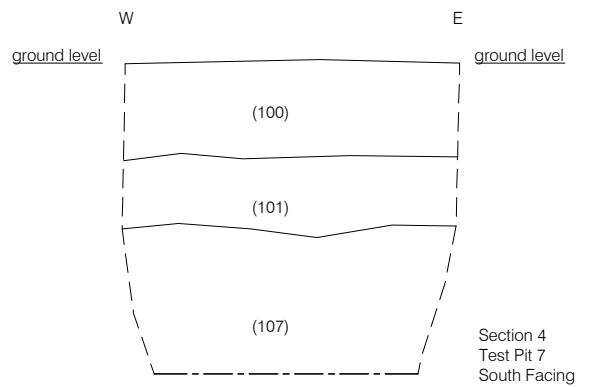
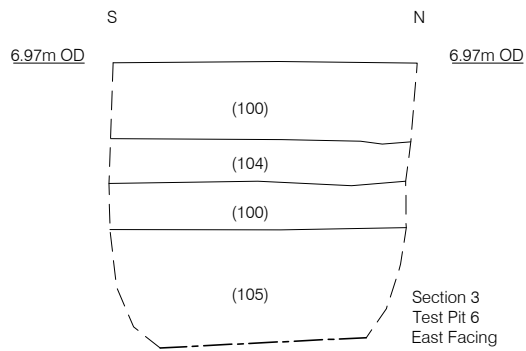
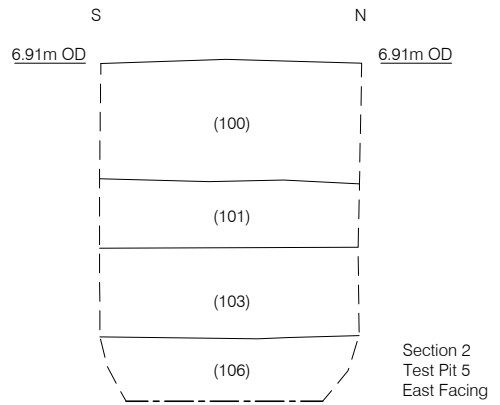
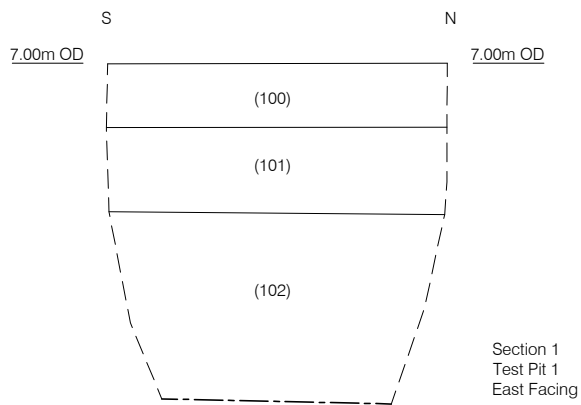

Figure 2
 Detailed Site Location
 1:400 at A4



9 APPENDIX 1: PLATES



Plate 1: Area of Test Pits 1-6, view east



Plate 2: Area of Test Pits 7-10, view north-east



Plate 3: Area of Test Pits 11-20, view west



Plate 4: Test Pit 1, view north-west



Plate 5: Test Pit 6, view north-west



Plate 6: Test Pits 14-15, view north-west

10 APPENDIX 2: CONTEXT INDEX

Context	Cut	Type	Interpretation
100	N/A	Overburden	Topsoil
101	N/A	Overburden	Subsoil
102	N/A	Layer	Silty clay deposit in Test Pit 1
103	N/A	Layer	Silty clay and chalk deposit in Test Pit 5
104	N/A	Layer	Modern gravel in Test Pit 6
105	N/A	Layer	Silty clay deposit with gravel and clay in Test Pit 6
106	N/A	Layer	Silty clay deposit in Test Pit 5
107	N/A	Layer	Silty clay deposit in Test Pit 7
108	N/A	Overburden	Bracken in Test Pits 11-20
109	N/A	Made ground	Modern clay in Test Pits 11-20

11 APPENDIX 3: OASIS FORM

OASIS ID: preconst1-277215

Project details

Project name	Cherry Hill Park Play Area, Ely, Cambridgeshire: Archaeological Monitoring
Short description of the project	This report describes the results of archaeological monitoring carried out by Pre-Construct Archaeology at Cherry Hill Park Play Area, Ely, Cambridgeshire (centred on NGR TL 5479 2895) on 14th-15th February 2017. Monitoring of three areas of foundation holes was undertaken as part of a refurbishment of Cherry Hill Park Play Area. The aim of the work was to monitor and record any archaeological remains which would be damaged or destroyed by the new development. No archaeological features were observed during monitoring of the 20 test pits in Cherry Hill Park Play Area.
Project dates	Start: 14-02-2017 End: 15-02-2017
Previous/future work	No / Not known
Any associated project reference codes	ECB4986 - Sitecode
Type of project	Recording project
Site status	None
Current Land use	Other 14 - Recreational usage
Monument type	NONE None
Significant Finds	NONE None
Investigation type	"Watching Brief"
Prompt	Planning condition

Project location

Country	England
Site location	CAMBRIDGESHIRE EAST CAMBRIDGESHIRE ELY Cherry Hill Park Play Area, Ely

Postcode	CB7 4BG
Study area	0 Square metres
Site coordinates	TL 5479 2895 51.9370329082 0.251952379716 51 56 13 N 000 15 07 E Point

Project creators

Name of Organisation	Pre-Construct Archaeology Limited
----------------------	-----------------------------------

Project brief originator	none
--------------------------	------

Project design originator	None
---------------------------	------

Project director/manager	Mark Hinman
--------------------------	-------------

Project supervisor	Mary-Anne Slater
--------------------	------------------

Project archives

Physical Archive Exists?	No
--------------------------	----

Digital Archive recipient	Cambridgeshire County Council Archaeology Store
---------------------------	---

Digital Archive ID	ECB4986
--------------------	---------

Digital Contents	"none"
------------------	--------

Digital Media available	"Database","Images raster / digital photography","Survey","Text"
-------------------------	--

Paper Archive recipient	Cambridgeshire County Council Archaeology Store
-------------------------	---

Paper Archive ID	ECB4986
------------------	---------

Paper Contents	"none"
----------------	--------

Paper Media available	"Context sheet","Notebook - Excavation',' Research',' General Notes","Report","Section"
-----------------------	---

Project bibliography

1

	Grey literature (unpublished document/manuscript)
Publication type	
Title	Cherry Hill Park Play Area, Ely, Cambridgeshire: Archaeological Monitoring
Author(s)/Editor(s)	Slater, M.
Date	2017
Issuer or publisher	Pre-Construct Archaeology Limited
Place of issue or publication	Cambridge

PCA

PCA SOUTH

UNIT 54
BROCKLEY CROSS BUSINESS CENTRE
96 ENDWELL ROAD
BROCKLEY
LONDON SE4 2PD
TEL: 020 7732 3925 / 020 7639 9091
FAX: 020 7639 9588
EMAIL: info@pre-construct.com

PCA NORTH

UNIT 19A
TURSDALE BUSINESS PARK
DURHAM DH6 5PG
TEL: 0191 377 1111
FAX: 0191 377 0101
EMAIL: info.north@pre-construct.com

PCA CENTRAL

THE GRANARY, RECTORY FARM
BREWERY ROAD, PAMPISFORD
CAMBRIDGESHIRE CB22 3EN
TEL: 01223 845 522
FAX: 01223 845 522
EMAIL: info.central@pre-construct.com

PCA WEST

BLOCK 4
CHILCOMB HOUSE
CHILCOMB LANE
WINCHESTER
HAMPSHIRE SO23 8RB
TEL: 01962 849 549
EMAIL: info.west@pre-construct.com

PCA MIDLANDS

17-19 KETTERING RD
LITTLE BOWDEN
MARKET HARBOROUGH
LEICESTERSHIRE LE16 8AN
TEL: 01858 468 333
EMAIL: info.midlands@pre-construct.com

