

**SOUTH STREET, STRATTON-ON-THE  
FOSSE, RADSTOCK, SOMERSET**

**ARCHAEOLOGICAL EVALUATION  
REPORT**

**PCA REPORT NO: 13276**

**SITE CODE: SOFS18**

**MAY 2018**

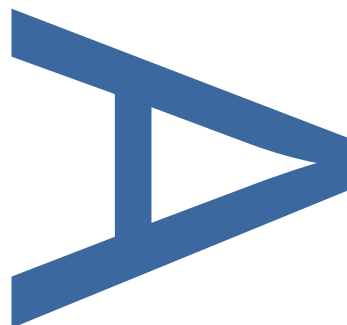

**PRE-CONSTRUCT ARCHAEOLOGY**

**SOUTH STREET, STRATTON-ON-THE FOSSE, RADSTOCK, SOMERSET:  
ARCHAEOLOGICAL EVALUATION REPORT**

---

**Issue 1:** Issued for approval

**Site Code:** SOFS18

**Central NGR:** E365813 N150717

**Commissioning Client:** Aster Group Ltd

**Written/Researched by:** Dominic McAtomey

**Project Manager:** Paul McCulloch

**Pre-Construct Archaeology Ltd (Winchester)**

**5 Red Deer Court, Elm Road,**

**Winchester, Hampshire SO22 5LX**

**Tel. 01962 849 549 & Mobile 07714 134 099**

**E-mail: [pmcculloch@pre-construct.com](mailto:pmcculloch@pre-construct.com)**

**Web: [www.pre-construct.com](http://www.pre-construct.com)**

---

**© Pre-Construct Archaeology Limited**

**May 2018**

© The material contained herein is and remains the sole property of Pre-Construct Archaeology Limited and is not for publication to third parties without prior consent. Whilst every effort has been made to provide detailed and accurate information, Pre-Construct Archaeology Limited cannot be held responsible for errors or inaccuracies herein contained.

## DOCUMENT VERIFICATION

**Site Name:** South Street, Stratton-on-the-Fosse, Radstock, Somerset

**Type of project:** Archaeological Evaluation

**Report:** R13276

<b>PCA Project Code:</b>		<b>K5429</b>
Text Prepared by:	D McAtominey	23/05/2018
Graphics Prepared by:	H Baxter	25/05/2018
Graphics Checked by:	J Brown	25/05/2018
Project Manager:	P McCulloch	30/05/2018

<b>Revision No.</b>	<b>Date</b>	<b>Checked</b>	<b>Approved</b>

**CONTENTS**

**1 ABSTRACT ..... 4**

**2 INTRODUCTION..... 5**

**3 AIM ..... 6**

**4 RESULTS ..... 6**

**5 ARCHIVE PRERARATION AND DEPOSITION ..... 8**

**6 ACKNOWLEDGEMENTS ..... 9**

**7 REFERENCES..... 10**

**APPENDIX 1: TRENCH 1 LIST OF CONTEXTS ..... 11**

**APPENDIX 2: PLATES..... 12**

**APPENDIX 3: OASIS RECORD ID PRECONST1-318475 ..... 13**

**FIGURES**

- Figure 1: Site Location**
- Figure 2: Detailed Site Location**
- Figure 3: Plan of Trench 1**
- Figure 4: Sections 5 A & B, 6 A & B, 7**

## **1 ABSTRACT**

Pre-Construct Archaeology Ltd (PCA) was appointed by Tony Langridge Consulting Ltd on behalf of Aster Group Ltd to undertake an archaeological trial trench evaluation on land at South Street, Stratton-on-the-Fosse, Radstock, Somerset. The Site is the subject of a development proposal comprising the erection of a single dwelling.

The archaeological evaluation was required by Mendip District Council, acting on the advice Steven Membrey, Senior Historic Environment Officer, South West Heritage, and in keeping with NPPF Section 12 and Local Plan Policy.

The evaluation was carried out in accordance with a Written Scheme of Investigation on the 30<sup>th</sup> April and 1<sup>st</sup> May 2018.

The evaluation revealed a single archaeological feature, most probably a boundary ditch, of post-medieval date. The absence of any other archaeological remains appears to demonstrate that the Site retains no significant archaeological potential.

## **2 INTRODUCTION**

### **2.1 Project Background**

2.1.1 Pre-Construct Archaeology Ltd (PCA) was appointed by Tony Langridge Consulting Ltd on behalf of Aster Group Ltd to undertake an archaeological trial trench evaluation on land at South Street, Stratton-on-the-Fosse, Radstock, Somerset (NGR 365813 150717), hereafter 'the Site' (**Figure 1**). The Site is the subject of a development proposal comprising the erection of a single dwelling.

2.1.2 The archaeological evaluation was required by the Local Planning Authority Mendip District Council, acting on the advice of their archaeological advisor Steven Membery, Senior Historic Environment Officer, South West Heritage, and in keeping with NPPF Section 12 and Local Plan Policy. The evaluation was intended to provide information toward understanding the archaeological implications of the proposed development and toward determination of the subsequent treatment (mitigation) of any archaeological remains found within it, should an application for the development proposal obtain consent.

### **2.2 Location, Topography and Geology**

2.2.1 The Site is located in the village of Stratton-on-the-Fosse, off South Street, east of the main road through the village, the A367 Fosseway and south of Church Lane. The Site lies on level ground at approximately 170m above Ordnance Datum.

2.2.2 The geology of the Site comprises Triassic era sandstone and conglomerate, (British Geological Survey <http://mapapps.bgs.ac.uk/geologyofbritain/home.html>).

### **2.3 Archaeological and Historical Background**

2.3.1 The Site lies in an area of known archaeological sites, find spots and monuments and in the historic village of Stratton-on-the-Fosse, a settlement that straddles the line of the Roman road linking the Roman towns at Exeter and Bath, part of the 'Fosseway', that lies some 50m to the west. An Area of High Archaeological Potential has been defined by the Retained Mendip District Council Local Plan Policy and this includes the Site.

2.3.2 An archaeological watching brief (Broomhead, 2015) carried out next to the Site during development of the former British Legion Club (now No. 4, The Poppies) recovered limited archaeological evidence but this included Roman box-flue tile and might indicate, along with a possible limestone rubble wall, evidence for a Roman structure; box-flue tiles are associated with heating Roman houses, including bath houses, and other structures. Medieval pottery was also recovered during the watching brief.

### **3 AIM**

#### **3.1 Archaeological Evaluation**

- 3.1.1 The aim of the archaeological evaluation is to determine the character, extent, date, condition and significance of archaeological remains that may survive within the Site, taking account of their potential to contain biological and palaeo-environmental remains.
- 3.1.2 This document reports on the results of the evaluation will aim to provide sufficient information so that the future treatment of any archaeological remains within the Site, in respect of the proposed development, may be determined.

### **4 RESULTS**

#### **4.1 Introduction**

- 4.1.1 The following provides a summary of the evaluation results based upon the Site archive, which comprises a Site diary, trench recording sheets, drawings, digital photographs electronic survey data and a small finds assemblage. The archive is held at PCA's Winchester office under the site code **SOFS18** and will in due course be deposited with the Hampshire Cultural Trust. A context index is provided in **Appendix 1** and **Plates** in **Appendix 2**.

#### **4.2 Methodology**

- 4.2.1 The evaluation comprised the excavation of 1no 12m X 2m trench (Trench 1) (**Figure 2, Plate 1**) located within the footprint of the proposed dwelling. The trench was mechanically excavated using a 3-ton 360° tracked excavator fitted with a wide toothless blade bucket. All mechanical excavation was supervised by PCA.
- 4.2.2 Archaeological features and deposits were cleaned by hand and sampled to meet the objectives of the evaluation. The trench and archaeological features were recorded on PCA *pro forma* Trench Recording Sheets. Plans and a representative section of the trench were drawn on polyester based drafting film. All trenches and sections were digitally photographed.

#### **4.3 Summary of Deposition Sequence**

- 4.3.1 The natural reddish brown silt clay (101) was encountered between 0.21m below ground level (BGL) in the north of the trench and 1.14m BGL in the south of the trench. A single archaeological feature was cut into (103) and was, at the southern end of the trench sealed a modern capping/levelling layer (106) of mid reddish brown silty clay, in turn covered by modern gravel surfacing (100).

#### **4.4 Archaeological Feature**

- 4.4.1 The trench revealed a single archaeological linear feature [103] running north-west to south east for the length of the trench and cut into the underlying natural clay (**Figure 3 & 4 and Plate 2**). Two hand-dug sections through the feature revealed its cut to have a sloped eastern side falling to the west, beyond the western trench edge; the full depth and profile of the feature was not exposed. Its fills comprised a lower layer (107) of orangey clay, an upper fill of reddish charcoal flecked brown silty clay, (104) and (105), and a band of sandstone rubble (102) possibly capping the feature
- 4.4.2 A small assemblage of stratified finds was recovered from fill (104)/(105), and included three small sherds of 19th century transfer printed white ware, 448gm of fragmented animal bone, burnt, undressed sandstone fragments and a single iron nail.

#### **4.5 Conclusion**

- 4.5.1 The evaluation revealed a single archaeological feature, most probably a boundary ditch of post-medieval date. The absence of any other archaeological remains appears to demonstrate that the Site retains no significant archaeological potential.



## **5 ARCHIVE PRERARATION AND DEPOSITION**

### **5.1 The Site Archive**

- 5.1.1 The Site archive, to include all project records and cultural material produced by the project, will be prepared in accordance with 'Guidelines for the Preparation of Excavation Archives for Long-term Storage' (UKIC 1990) and the Institute for Archaeologists 'Standard and Guidance for the creation, compilation, transfer and deposition of archaeological archives' (CIfA 2014). On completion of the project PCA will arrange for the archive to be deposited with the relevant repository/museum.

### **5.2 Copyright**

- 5.2.1 The full copyright of the written/illustrative archive relating to the site will be retained by Pre-Construct Archaeology Ltd under the Copyright, Designs and Patents Act 1988 with all rights reserved. Further distribution and uses of the report either in its entirety or part thereof in paper or electronic form is prohibited without the prior consent of Pre-Construct Archaeology Ltd.
- 5.2.2 The licence extends to the use of all documents arising from this project in all matters relating directly to the project, as well as for bona fide research purposes.
- 5.2.3 Pre-Construct Archaeology Ltd has made every effort to ensure the accuracy of the content of this report. However, Pre-Construct Archaeology Ltd cannot accept any liability in respect of, or resulting from, errors, inaccuracies or omissions this report contains.

## **6           ACKNOWLEDGEMENTS**

Pre-Construct Archaeology is grateful to Tony Langridge Consulting Ltd for commissioning the evaluation on behalf of the Aster Group Lt and to Steven Membrey, Senior Historic Environment Officer, South-West Heritage, for his advice.

The evaluation was supervised by Dominic McAtomey, assisted by Cameron Hardie.  
This report was prepared by Katherine Marshall with Illustrations prepared Anna Tonelli. The project was managed for PCA by Paul McCulloch.

## **7 REFERENCES**

Broomhead, R. A., 2015, '*Site of the former British Legion Club, South Street, Stratton on the Fosse, Somerset: archaeological observations*', RAB/04/15.

PCA, 2018, '*South Street, Stratton on the Fosse, Radstock, Somerset, BA3 4RA: Written Scheme of Investigation for an Archaeological Evaluation*'.

## APPENDIX 1: TRENCH 1 LIST OF CONTEXTS

Context No.	Type	Description	Interpretation
100	Layer	Loose grey gravel	Modern surfacing
101	Layer	Mid brown/red silty clay	Natural
102	Fill	Band of sandstone rubble	Fill of ditch [103]
103	Cut	NW-SE aligned linear cut	Cut of ditch – boundary ditch?
104	Fill	Dark brown/red silty clay. Same as (105)	Fill of [103]
105	Fill	Dark brown/red silty clay. Same as (104)	Fill of [103]
106	Layer	Mid brown/red silty clay	Re-deposited natural used as make-up
107	Fill	Mid-orange clay	Lower fil of ditch cut [103]

## APPENDIX 2: PLATES



**Plate 1: General view of site and Trench 1 looking south**



**Plate 2: Trench 1, Linear feature (103) and excavated sections. Scales 1m & 2m**

### APPENDIX 3: OASIS RECORD ID PRECONST1-318475

#### Project details

Project name	South Street, Stratton on the Fosse, Somerset
Short description of the project	An archaeological evaluation comprising one 12m X 2m trench on the site of a proposed dwelling revealed a linear feature containing 19th century pottery. No other archaeological features, deposits or datable finds were found.
Project dates	Start: 30-04-2018 End: 01-05-2018
Previous/future work	Yes / Not known
Associated project reference codes	RAB/04/15 - Sitecode
Associated project reference codes	HER32728 - HER event no.
Type of project	Field evaluation
Site status	None
Monument type	DITCH Post Medieval
Significant Finds	POTTERY Post Medieval
Methods & techniques	"Sample Trenches"
Development type	Small-scale (e.g. single house, etc.)
Prompt	National Planning Policy Framework - NPPF
Position in the planning process	Pre-application
Project location	
Country	England
Site location	SOMERSET MENDIP STRATTON ON THE FOSSE South Street
Postcode	BA3 4RA
Study area	150 Square metres
Site coordinates	ST 365813 150717 50.931054872992 -2.902549132095 50 55 51 N 002 54 09 W Point
Height OD / Depth	Min: 167.89m Max: 168.08m
Project creators	
Organisation	PCA Winchester
Project brief	South West Heritage
Project design	Paul McCulloch

Project director/manager	Paul McCulloch
Project supervisor	Dominic McAtominey
Type of sponsor/funding body	Developer
Name of sponsor/funding body	Aster Group Ltd
Project archives	
Physical Archive Exists?	No
Digital Archive recipient	PCA
Digital Contents	"none"
Digital Media available	"Database","Images raster / digital photography","Survey","Text"
Paper Archive recipient	PCA
Paper Contents	"Animal Bones","Ceramics","Metal","Stratigraphic","Survey","other"
Paper Media available	"Context sheet","Correspondence","Diary","Drawing","Notebook - Excavation',' Research',' General Notes","Plan","Report","Section","Survey "
Project Biblio 1	
Publication type	Grey literature (unpublished document/manuscript)
Title	South Street, Stratton on the Fosse, Somerset
Author(s)/Editor(s)	McAtominey, D
Other biblio	R13276
Date	2018
Issuer or publisher	PCA Winchester
Place of issue	Winchester
Description	A4, 20 pages incl. covers text 2 plates and 4 figs. Hard and electronic versions.
Entered by	Paul McCulloch (pmcculloch@pre-construct.com)
Entered on	31 May 2018



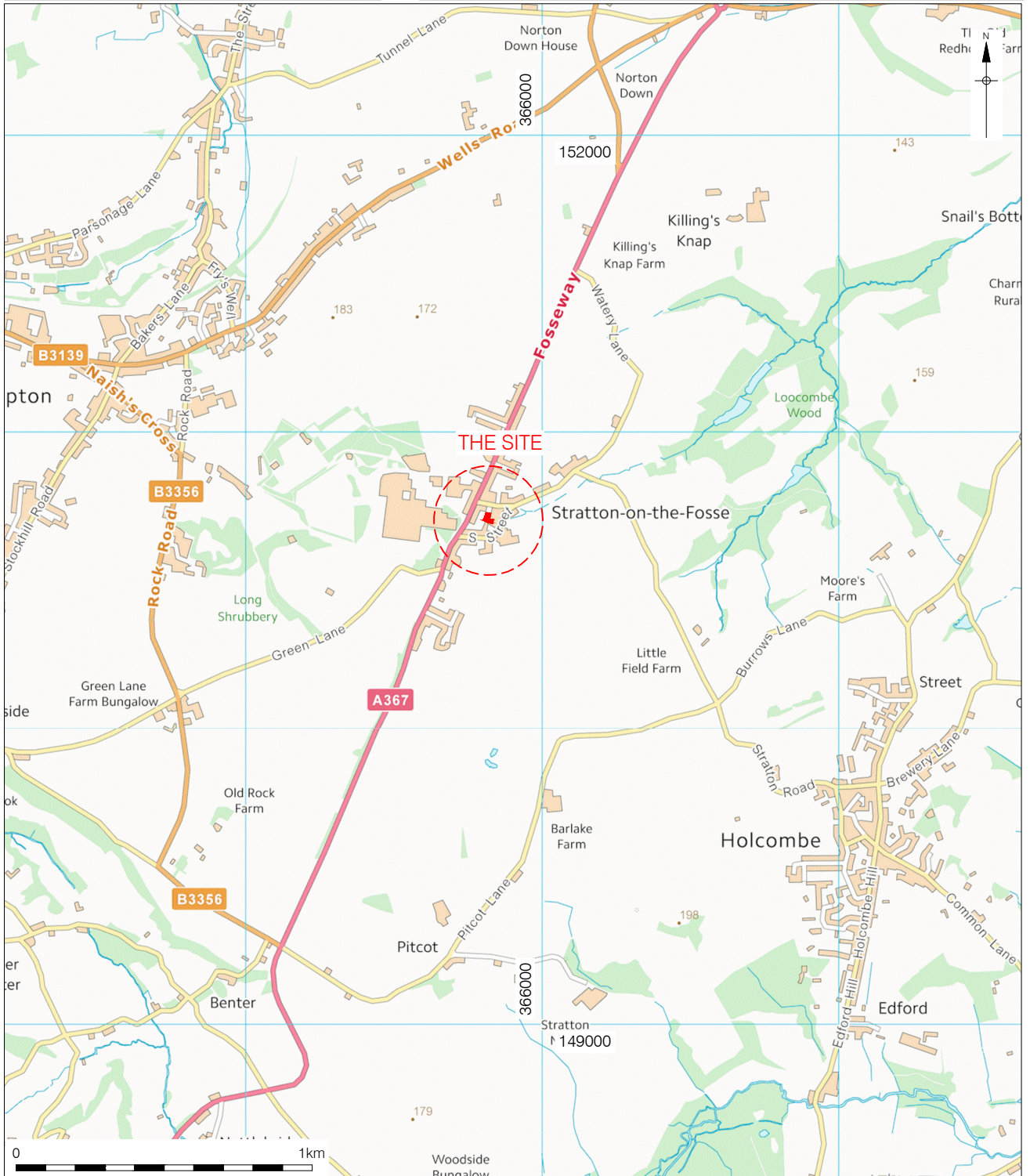
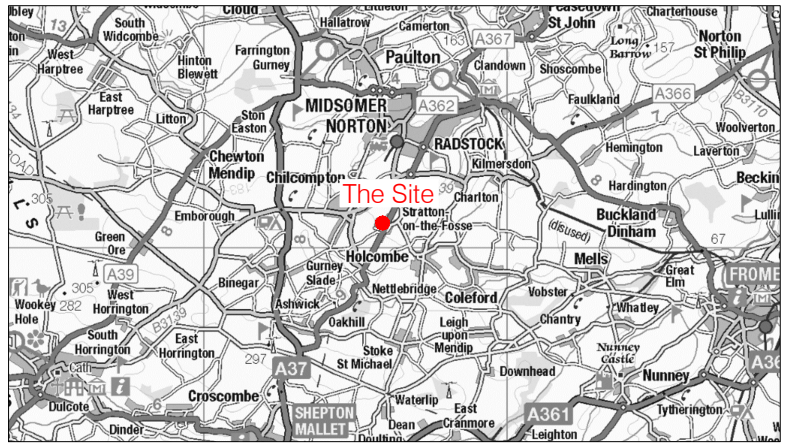
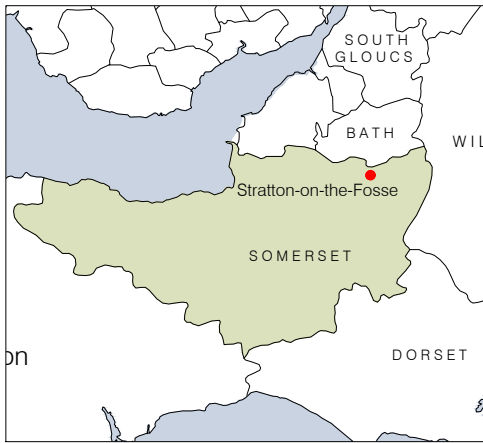



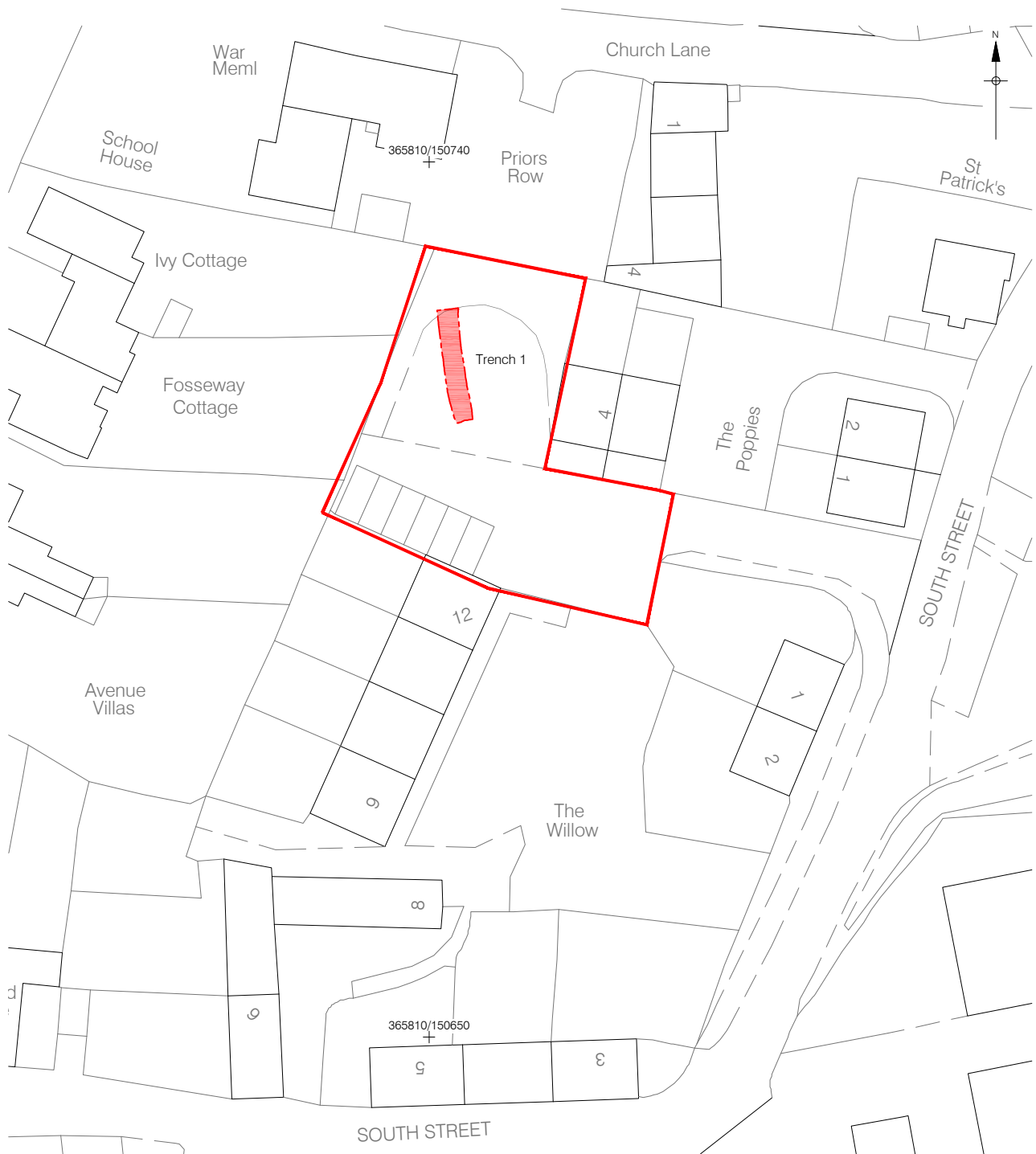

0 25m

© Crown copyright 2018. All rights reserved. License number PMP36110309  
 © Pre-Construct Archaeology Ltd 2018  
 11/05/18 AT

Figure 2  
 Detailed Trench Location  
 1:625 at A4

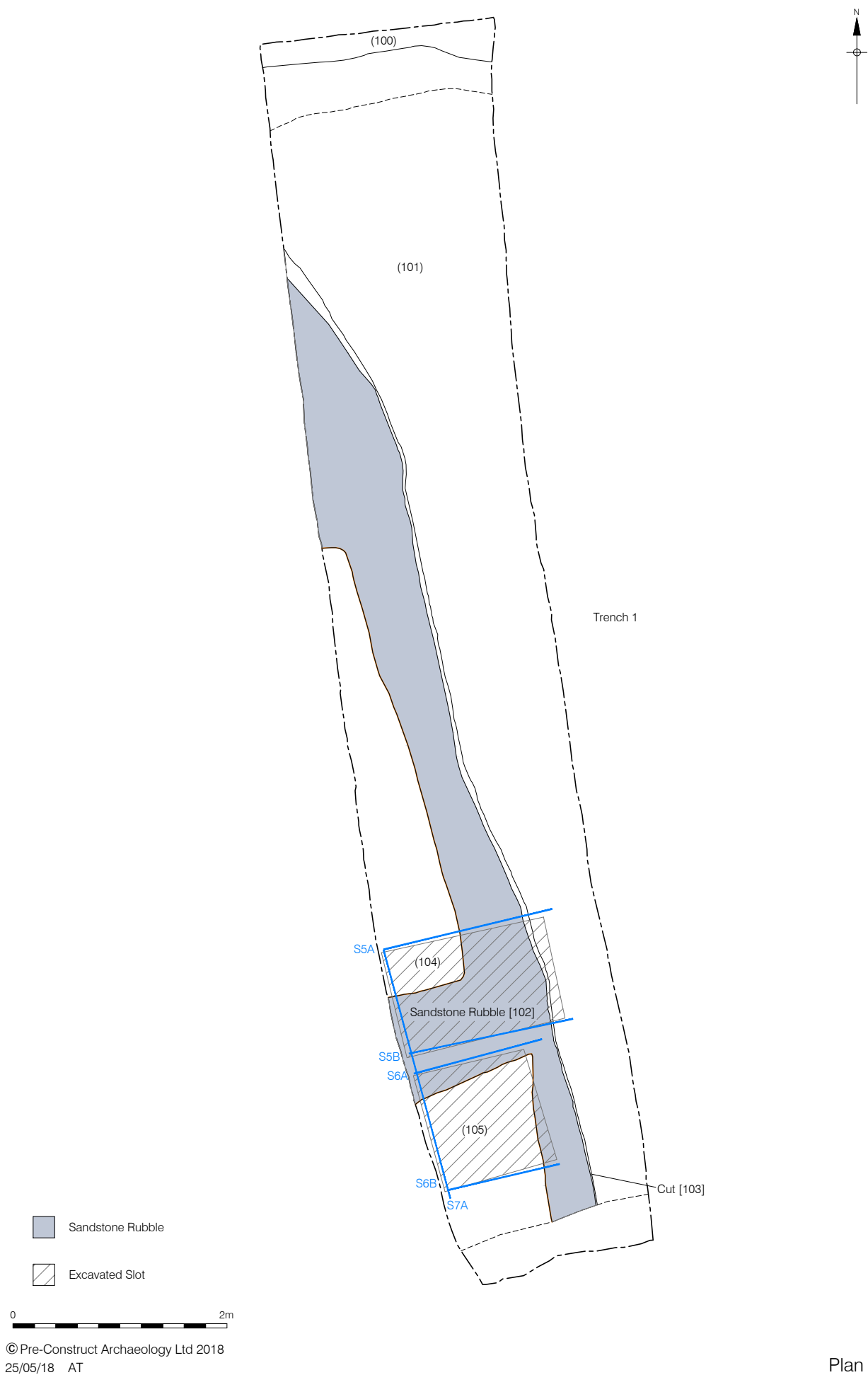
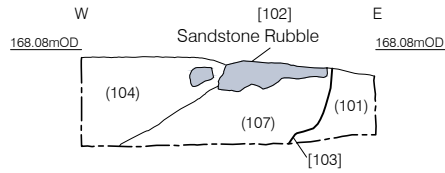
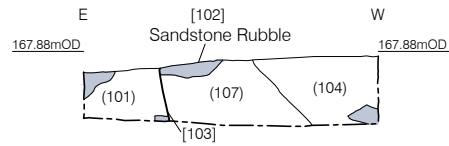

Figure 3  
Plan of Trench 1  
1:50 at A4



Section 5A  
South facing  
Northern Sondage



Section 5B  
North facing  
Northern Sondage

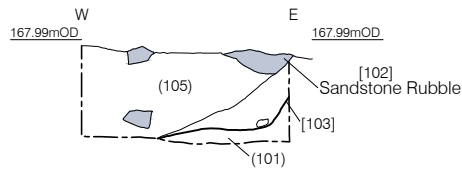

Section 6A  
South facing  
Southern Sondage

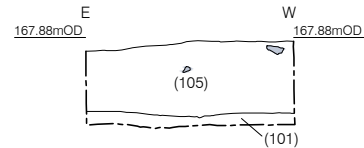

Section 6B  
North facing  
Southern Sondage

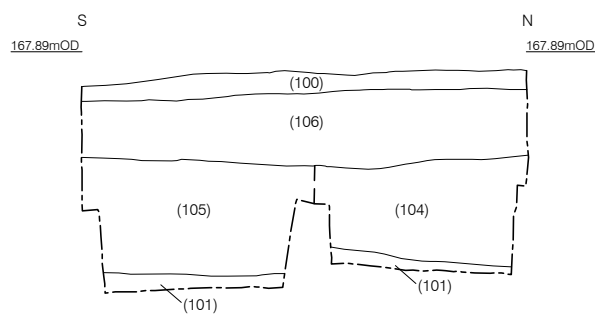

Section 7A  
East facing  
Sondages



# PCA

## **PCA CAMBRIDGE**

THE GRANARY, RECTORY FARM  
BREWERY ROAD, PAMPISFORD  
CAMBRIDGESHIRE CB22 3EN  
t: 01223 845 522  
e: [cambridge@pre-construct.com](mailto:cambridge@pre-construct.com)

## **PCA DURHAM**

UNIT 19A, TURSDALE BUSINESS PARK  
TURSDALE  
DURHAM DH6 5PG  
t: 0191 377 1111  
e: [durham@pre-construct.com](mailto:durham@pre-construct.com)

## **PCA LONDON**

UNIT 54, BROCKLEY CROSS BUSINESS CENTRE  
96 ENDWELL ROAD, BROCKLEY  
LONDON SE4 2PD  
t: 020 7732 3925  
e: [london@pre-construct.com](mailto:london@pre-construct.com)

## **PCA NEWARK**

OFFICE 8, ROEWOOD COURTYARD  
WINKBURN, NEWARK  
NOTTINGHAMSHIRE NG22 8PG  
t: 01636 370410  
e: [newark@pre-construct.com](mailto:newark@pre-construct.com)

## **PCA NORWICH**

QUARRY WORKS, DEREHAM ROAD  
HONINGHAM  
NORWICH NR9 5AP  
T: 01223 845522  
e: [cambridge@pre-construct.com](mailto:cambridge@pre-construct.com)

## **PCA WARWICK**

UNIT 9, THE MILL, MILL LANE  
LITTLE SHREWLEY, WARWICK  
WARWICKSHIRE CV35 7HN  
t: 01926 485490  
e: [warwick@pre-construct.com](mailto:warwick@pre-construct.com)

## **PCA WINCHESTER**

5 RED DEER COURT, ELM ROAD  
WINCHESTER  
HAMPSHIRE SO22 5LX  
t: 01962 849 549  
e: [winchester@pre-construct.com](mailto:winchester@pre-construct.com)

