

**53 ST CROSS ROAD, WINCHESTER,
HAMPSHIRE, SO23 9RE**

**ARCHAEOLOGICAL EVALUATION
REPORT**

PCA REPORT NO: 13441

SITE CODE: AY660

OCTOBER 2018

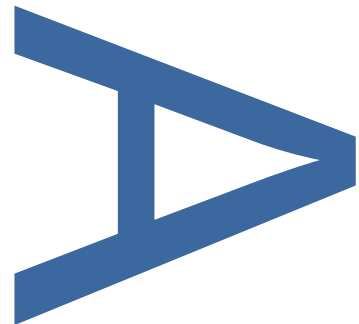
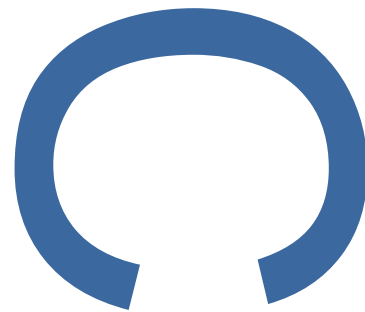

PRE-CONSTRUCT ARCHAEOLOGY

**53 ST CROSS ROAD, WINCHESTER, HAMPSHIRE, SO23 9RE:
ARCHAEOLOGICAL EVALUATION REPORT**

Local Planning Authority: Winchester City Council
Planning Ref: Pre-planning

Site Code: AY660
Central NGR: SU 47602 28141

Commissioning Client: Blue Fish Construction Ltd

Written by: Dominic McAtominey, PCA
Project Manager: Paul McCulloch, PCA

**Pre-Construct Archaeology Ltd (Winchester)
5 Red Deer Court
Elm Road
Winchester
Hampshire SO22 5LX**

Tel: 01962 857330
E-mail: pmcculloch@pre-construct.com
Web: www.pre-construct.com

**© Pre-Construct Archaeology Limited
October 2018**

© The material contained herein is and remains the sole property of Pre-Construct Archaeology Limited and is not for publication to third parties without prior consent. Whilst every effort has been made to provide detailed and accurate information, Pre-Construct Archaeology Limited cannot be held responsible for errors or inaccuracies herein contained.

DOCUMENT VERIFICATION

Site Name: 53 St Cross Road, Winchester, Hampshire

Type of project: Evaluation

Report: R13441

Quality Control

Pre-Construct Archaeology Limited Project Code		K5476
	Name & Title	Date
Written by:	D. McAtominey, Supervisor	22/10/2018
Graphics by:	D Valk, CAD	26/09/2018
Graphics checked:	J. Brown, Director	26/09/2018
Project Manager:	P. McCulloch, Regional Manager	23/10/2018

Revision No.	Checked	Approved	Date

CONTENTS

1	Abstract	4
2	Introduction	5
3	Aim	8
4	Results	9
5	Archive Prerparation and Deposition	11
6	Acknowledgements	12
7	References	13
	Appendix 2: Photographs (Plates 1, 2, 3)	16
	Appendix 3: Oasis Record	18

Figure 1: Site Location

Figure 2: Detailed Site Location

Figure 3: Trenches with Representative Section Locations and Detail of Trench 4

Figure 4: Representative Sections From Trenches 1, 3, and 6

1 ABSTRACT

Pre-Construct Archaeology Ltd was appointed by Blue Fish Construction Ltd. to undertake an archaeological evaluation at Goodworth House, 53, St Cross Road, Winchester, Hampshire. The Site is the subject of a proposed development comprising the erection of six houses.

The evaluation was carried out in order to inform a Heritage Statement that will accompany a planning application for the proposed development to be submitted to the Local Planning Authority Winchester City Council. The evaluation was carried out in accordance with a written Scheme of Investigation that was approved in advance by the Council's Historic Environment Team Archaeologist.

The evaluation, comprising six 10m By 1.8m wide trenches located on the proposed house footprints, revealed no significant archaeological deposits or features and appears to have demonstrated that the Site retains no significant archaeological potential.

2 INTRODUCTION

2.1 Project Background

2.1.1 Pre-Construct Archaeology Ltd (PCA) was appointed by Blue Fish Construction Ltd to undertake an archaeological evaluation at Goodworth House, 53 St Cross Road, Winchester, Hampshire, (NGR SU 47602 28141) hereafter 'the Site' (**Figures 1 & 2**). The Site is the subject of a development proposal comprising the erection of six houses. This document provides a report on the evaluation.

2.1.2 The evaluation was carried out in order to inform a Heritage Statement that will accompany a planning application for the proposed development to be submitted to the Local Planning Authority Winchester City Council, in keeping with NPPF Section 12 and Local Plan Policy. The evaluation was carried out in accordance with a Written Scheme of Investigation (PCA, 2018a) that was approved in advance by the Council's Historic Environment Team Archaeologist (HETA). The archaeological evaluation strategy set out in the WSI was informed by a desk-based assessment (PCA, 2018b).

2.1.3 This document provides the results of the trial trench evaluation, which comprised six 10m X 1.8m trial trenches. This document has been prepared in accordance with the Chartered Institute for Archaeologists standard and guidance for archaeological field evaluation (CIfA 2014) and *Management of Research Projects in the Historic Environment* (Historic England, 2015).

2.2 Location, Topography and Geology

2.2.1 The Site is located along the eastern side of St Cross Road, which, following the line of a Roman road, remains one of the oldest routes extending south from Winchester towards Southampton. The Site lies to the north of Cripstead Lane (formerly known as Water Lane), which progresses eastwards from St Cross Road towards water meadows and the River Itchen. The Site is presently an area of open gardens belonging to Goodworth House, a Grade II Listed building of early 19th century date.

2.2.2 The Site extends to the rear of Goodworth House, from its westernmost boundary with St Cross Road to its eastern boundary along St Faith's Road and lies to the rear of buildings fronting onto Cripstead Lane, including no. 3 Cripstead Lane, a small detached 19th century, or earlier, house and a series of outbuildings presently in use as car repair workshops. A 19th century brick wall along St Faith's Road forms the boundary of the Site, while various brick and brick and flint rubble walls line Cripstead Lane. The boundary of the Site along St Cross Road comprises vertical lap boarded fencing. To the east, the garden is bordered along its northern side by St Faith's Church of England Primary School and to the north by the boundary with the adjacent property no. 51 St Cross Road.

- 2.2.3 The garden area immediately east of Goodworth House is laid to lawn and appears to have been levelled. The lawn has a tall flint rubble wall on its north side with round coping bricks. Another lawn to the north of the flint rubble wall also appears to have been levelled and to the north of a hedge lies an area of garden with a swimming pool and a row of solar panels. The Site contains a number of mature, protected trees.
- 2.2.4 The Site is located on the western edge of the River Itchen valley floor on ground falling gently from St Cross Road towards the river, which flows in managed watercourses some 150m to the east. To the west, the land rises gently, forming the western valley side, below rising ground and the modern suburb of Stanmore. The Site lies at approximately 32m OD.
- 2.2.5 According to the British Geological Survey (BGS online viewer) the underlying geology of the area comprises New Pit Chalk Formation, a sedimentary bedrock formed approximately 90 to 94 million years ago in the Cretaceous Period. The chalk bedrock is overlain by superficial deposits of River Terrace Deposits of sand and gravel deposited by the River Itchen; depending on local circumstances, the superficial deposits may be found at a depth of between 0.5m and 1m below ground level.

2.3 Archaeological and Historical Background

- 2.3.1 The archaeological and historical background to the Site was set out in a historic environment desk-based assessment prepared in respect of the Site's proposed development (PCA 2018 a) and is not repeated here in detail. In considering the Site's potential to contain archaeological remains, the assessment concluded:

*'The archaeological background, location and underlying geology of the Site suggests that there is potential for early prehistoric activity in the area with an increased potential for later prehistoric deposits and remains. The site lies within an area covered by the Itchen River Terrace 1, noted for its potential for important early prehistoric Palaeolithic archaeological remains and Pleistocene deposits within the Terrace Gravels. Deep excavation or terracing within the Site might adversely impact these deposits. Based on the results of this assessment, it is considered that the site has a **low-moderate** potential for archaeological remains of prehistoric date and that these remains would be of local to regional significance.*

*The site is located alongside and just to the east of the Roman Road extending south from Winchester. Whilst no definite focus for settlement in the St Cross area has been established, the evidence points towards activity alongside or in the general area of the Roman Road and accordingly it is considered that the site has a **moderate** potential for archaeological remains of Roman date, which would be of local to regional significance.*

Archaeological remains found at several locations in the area of St Cross Road, Cripstead Lane and Back Street suggest that the historic settlement of St Cross originated in the Late Saxon period. Given the character and extent of the settlement evidence it is thought that the site has a **moderate** to **high** potential for Saxon remains, which would be of regional significance.

The area takes its name from the Hospital of St Cross founded in 1136 by Bishop of Winchester Henry de Blois, half-brother of King Stephen. The evidence for medieval activity in the area and the proximity of the Site to the medieval St Cross Road suggest that the Site lies within or along the northern edge of the medieval settlement of St Cross. It is considered that the Site has a **moderate** to **high** potential for medieval settlement remains, which would be of regional significance.

The majority of entries in the HER within the study area relate to the post-medieval period and specifically to houses along St Cross Road built during the 18th and 19th centuries. Cartographic evidence shows that the majority of the Site has remained as undeveloped land, as gardens or open fields/enclosures since the late 19th century. Despite some boundary rearrangement, some lawn levelling and the excavation of a swimming pool, it has remained relatively unaltered up to present day, with no evidence of gravel extraction and low levels of modern impacts. Therefore, it is considered that there is a **moderate** potential for post-medieval boundary and settlement remains, which would be of local significance.'

3 AIM

3.1 Archaeological Evaluation

3.1.1 The aim of the archaeological evaluation was to establish, within the strategy of trenching that was proposed, the character, extent, date, condition and significance of archaeological remains within the Site, taking account of their potential to contain biological and palaeo-environmental remains.

3.1.2 This report on the results of the evaluation aims to provide sufficient information so that future decisions on archaeological matters raised by the proposed development may be made.

4 RESULTS

4.1 Introduction

4.1.1 The following presents a summary of the evaluation results based upon the Site archive, which comprises a Site diary, trench recording sheets, drawings and digital photographs. A summary of recorded contexts is provided in a Trench Index in **Appendix 1** and photographs of the trenches in **Appendix 2**. The archive is held at PCA's Winchester office under the site code **AY660** and will in due course be deposited with the Hampshire Cultural Trust.

4.2 Methodology

4.2.1 The archaeological evaluation was undertaken following the methodology that was detailed in the Written Scheme of Investigation (PCA 2018a), which was approved by Winchester City Council's HETA.

4.3 The evaluation was carried out between 6th and 9th August 2018 and comprised the excavation of 6no 10m X 2m trenches (**Figure 2**). The trenches were set out using a GPS device to ensure their pre-determined location was achieved accurately. The trenches were then mechanically excavated using a 360° tracked excavator fitted with a wide toothless blade bucket. All mechanical excavation was supervised by a suitably qualified archaeologist familiar with the ground conditions anticipated on the Site.

4.4 Summary of Deposition Sequence

4.4.1 The deposition sequence was seen to vary across the site with a topsoil depth between 0.1m and 0.35m (**Figure 3**). The natural deposits also varied, in Trench 1 comprising a mid-brown reddish clay, in Trench 2 a mixed light grey and yellow clay and, in the remaining trenches, chalk and flint (e.g. Trench 5 **Plate 1**). Various modern levelling layers were seen in trenches 1, 2 (**Plate 2**) and 4. A possible buried subsoil was observed in trenches 1 and 6 (**Plate 3**), and this was a mid-brown and grey silty clay layer lying over the natural deposit. Trench depths varied and are set out in **Appendix 1**.

4.5 Archaeological Features

4.5.1 Possible archaeological features were recorded in Trench 4 and Trench 6

4.5.2 Trench 4 contained two possible features (**Figure 3**). [405] was a sub circular feature measuring 0.5m by 0.32m and 0.37m deep, with concave sides and an uneven base, filled with (406) a dark greyish brown clay/ sandy clay. [407] was a sub rectangular feature which measured 0.92m by 0.74m and 0.62m deep, with concave sides and an irregular base, filled with (408) a dark orange, mottled with mid grey, clay. No finds were recovered from either of these features.

4.5.3 Trench 6 (**Figures 3 & 4**) contained a single possible feature [605] was visible in the west section of the trench and was seen to be truncated by modern intrusions (not shown on figures). It contained a single fill (606) a mid greyish orange clay with sparse flint inclusions. No datable finds were recovered from the feature. Otherwise the trench revealed a sequence of chalk natural (603) beneath subsoils (602) and (604).

4.6 Conclusion

4.6.1 The features recorded in Trenches 4 and 6 were not datable and appear to be of very low archaeological significance, the two small pits in Trench 4 conceivably evidence of former planting in what has been an orchard and the feature in Trench 6 possibly a natural anomaly.

4.6.2 The very low archaeological potential of the Site that is indicated by the evaluation would appear to contrast with evidence for medieval activity in the vicinity of the Site. However, the Site appears to have undergone episodes of landscaping in the 19th century and modern era and this may have impacted any archaeological potential the Site had. Another factor may be indicated by the varied natural deposits that were recorded; this may indicate locally unfavourable ground conditions.

4.6.3 It is concluded that the Site is unlikely to retain any significant archaeological potential.

5 ARCHIVE PRERARATION AND DEPOSITION

5.1 The Site Archive

5.1.1 The Site archive, to include all project records and cultural material produced by the project, will be prepared in accordance with 'Guidelines for the Preparation of Excavation Archives for Long-term Storage' (UKIC 1990) and the Institute for Archaeologists 'Standard and Guidance for the creation, compilation, transfer and deposition of archaeological archives' (ClfA 2014). On completion of the project PCA will arrange for the archive to be deposited with Hampshire Cultural Trust, on behalf of Hampshire County Council

5.2 Copyright

5.2.1 The full copyright of the written/illustrative archive relating to the site will be retained by Pre-Construct Archaeology Ltd under the Copyright, Designs and Patents Act 1988 with all rights reserved. Hampshire Cultural Trust however, will be granted an exclusive licence for the use of the archive for educational purposes, including academic research, providing that such use shall be non-profitmaking, and conforms to the Copyright and Related Rights regulations 2003. Further distribution and uses of the report either in its entirety or part thereof in paper or electronic form is prohibited without the prior consent of Pre-Construct Archaeology Ltd.

5.2.2 The licence extends to the use of all documents arising from this project in all matters relating directly to the project, as well as for bona fide research purposes (which includes Winchester Urban Archaeological Database & Historic Environmental Record).

5.2.3 Pre-Construct Archaeology Ltd has made every effort to ensure the accuracy of the content of this report. However, Pre-Construct Archaeology Ltd cannot accept any liability in respect of, or resulting from, errors, inaccuracies or omissions this report contains.

6 ACKNOWLEDGEMENTS

Pre-Construct Archaeology is grateful to Blue Fish Construction Ltd for commissioning the Evaluation and acknowledges the advice of Tracy Mathews, HETA, Winchester City Council.

The evaluation was supervised by Ryan Wolfe with assistance from Callum Paisnel and James Bannister. This report was prepared by Dominic McAtominey with Illustrations prepared by Diana Valk. The project was managed for PCA by Paul McCulloch.

7 REFERENCES

PCA 2018 a, '*53 St Cross Road, Winchester, Hampshire: WSI for an Archaeological Evaluation*'.

PCA 2018 b, '*An Historic Environment Desk-based Assessment of No. 53 St Cross Road, Winchester, Hampshire, SO23 9RE*', Ref R13205.

Appendix 1: Trench Index

Trench	Context Number	Type	Interpretation	Depth (m) BGL
TR1	101	Layer	Topsoil	0 - 0.1
TR1	102	Layer	Subsoil	0.1 - 0.25
TR1	103	Layer	Natural (Clay)	1.24 +
TR1	104	Layer	Post-Medieval layer beneath subsoil	0.25 - 0.73
TR1	105	Layer	Post-Medieval layer above buried subsoil	0.73 - 1.06
TR1	106	Layer	Buried subsoil	1.06 - 1.24
TR2	201	Layer	Topsoil	0 - 0.18
TR2	202	Layer	Subsoil	0.18 - 0.50
TR2	203	Layer	Natural (Clay)	1.20 +
TR2	204	Layer	Leveling layer for garden	0.5 - 0.61
TR2	205	Layer	Possible watercourse	0.61 - 0.91
TR2	206	Layer	Possible flint base of 205	0.91 - 1.20
TR3	301	Layer	Topsoil	0 - 0.15
TR3	302	Layer	Subsoil	0.15 - 0.59
TR3	303	Layer	Natural (Chalk)	0.59 +
TR4	401	Layer	Topsoil	0 - 0.12
TR4	402	Layer	Subsoil	0.12 - 0.45
TR4	403	Layer	Natural (Chalk)	0.84 +
TR4	404	Layer	Clay levelling layer	0.45 - 0.75
TR4	405	Cut	Cut of undated pit	0.92 - 1.29
TR4	406	Fill	Fill of pit 405, undated	0.92 - 1.29
TR4	407	Cut	Cut of possible natural feature	0.92 +
TR4	408	Fill	Fill of 407	0.92 +
TR4	409	Layer	Clay levelling layer	0.75 - 0.84
TR5	501	Layer	Topsoil	0 - 0.35
TR5	502	Layer	Subsoil	0.35 - 0.5
TR5	503	Layer	Natural (Chalk)	0.5 +
TR6	601	Layer	Topsoil	0 - 0.34

TR6	602	Layer	Subsoil	0.34 - 0.41
TR6	603	Layer	Natural (Chalk)	1.06 +
TR6	604	Layer	Buried subsoil	0.41 - 0.75
TR6	605	Cut	Cut of undated pit	0.90 - 1.06
TR6	606	Fill	Fill of pit 605, undated	0.90 - 1.06

Appendix 2: Photographs (Plates 1, 2, 3)



Plate 1. Trench 5, view to east, scale 1m



Plate 2. Representative section of trench 2, view to north, scale 1m



Plate 3. Representative section Trench 6, view to west, scale 1m

Appendix 3: Oasis Record

8 OASIS ID: preconst1-331582

Project details

Project name	53 St Cross Road, Winchester, Hampshire
Short description of the project	Pre-Construct Archaeology Ltd (PCA) was appointed by Blue Fish Construction Ltd. to undertake an archaeological evaluation at Goodworth House, 53, St Cross Road, Winchester, Hampshire. The Site is the subject of a development proposal comprising the erection of six houses. The evaluation was required by the Local Planning Authority, Winchester City Council regarding the potential for the development to impact archaeological remains. The evaluation was intended to ensure that, in the event archaeological remains are encountered, they are to be recognised, characterised and recorded. The evaluation revealed no archaeological deposits or features and appears to have demonstrated that the Site retains very little archaeological potential.
Project dates	Start: 06-08-2018 End: 09-08-2018
Previous/future work	No / No
Any associated project reference codes	AY660 - Sitecode
Type of project	Field evaluation
Current Land use	Other 5 - Garden
Monument type	PIT Uncertain
Methods & techniques	"Sample Trenches"
Development type	Urban residential (e.g. flats, houses, etc.)
Prompt	National Planning Policy Framework - NPPF
Position in the planning process	Pre-application

Project location

Country	England
Site location	HAMPSHIRE WINCHESTER WINCHESTER 53 St Cross Road, Winchester
Postcode	SO23 9RE
Study area	0 Square metres
Site coordinates	SU 447625 128106 50.912471907343 -1.363214766226 50 54 44 N 001 21 47 W Point

Project creators

Name of Organisation	PCA Winchester
----------------------	----------------

Project brief originator	Blue Fish Construction Ltd
Project design originator	Paul McCulloch
Project director/manager	Paul McCulloch
Project supervisor	Ryan Wolfe

Project archives

Physical Archive Exists?	No
Physical Archive recipient	Hampshire Cultural Trust
Digital Archive recipient	Hampshire Cultural Trust
Digital Media available	"Database","Images raster / digital photography","Spreadsheets","Survey","Text"
Paper Archive recipient	Hampshire Cultural Trust
Paper Media available	"Context sheet","Drawing","Photograph","Report","Section","Survey "

Project bibliography 1

Publication type	Grey literature (unpublished document/manuscript)
Title	53 St Cross Road, Winchester, Hampshire: WSI for an Archaeological Evaluation
Author(s)/Editor(s)	PCA Winchester
Date	2018
Issuer or publisher	PCA Winchester
Place of issue or publication	Winchester

Project bibliography 2

Publication type	Grey literature (unpublished document/manuscript)
Title	An Historic Desk Based Assessment of no 53 St Cross Road, Winchester, Hampshire, SO23 9RE
Author(s)/Editor(s)	Pre-Construct Archaeology
Other bibliographic details	R13205
Date	2018
Issuer or publisher	Pre-Construct Archaeology Winchester

Place of issue or
publication Winchester

Entered by Dominic McAtominey (dmcatominey@pre-construct.com)

Entered on 22 October 2018



Contains Ordnance Survey data © Crown copyright and database right 2018
 © Pre-Construct Archaeology Ltd 2018
 13/07/18 RM

Figure 1
 Site Location
 1:2,000,000 & 1:250,000 & 1:25,000 at A4





© Pre-Construct Archaeology Ltd 2018
 26/09/18 DV

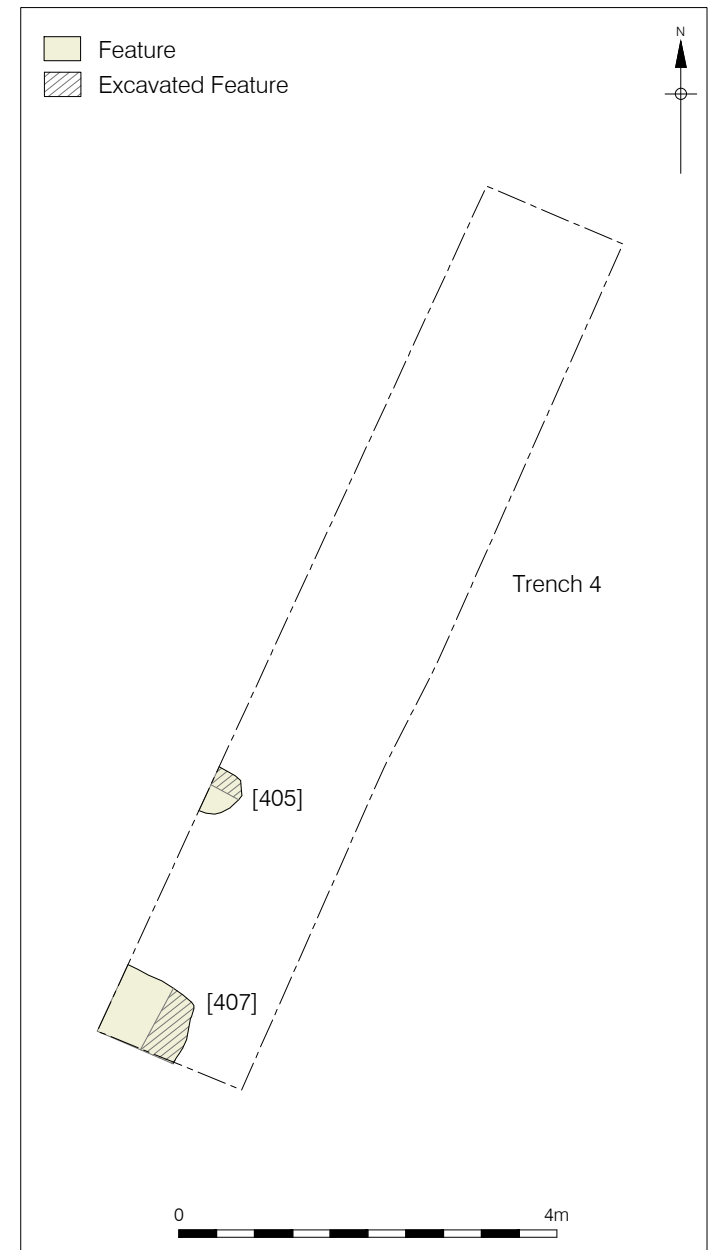
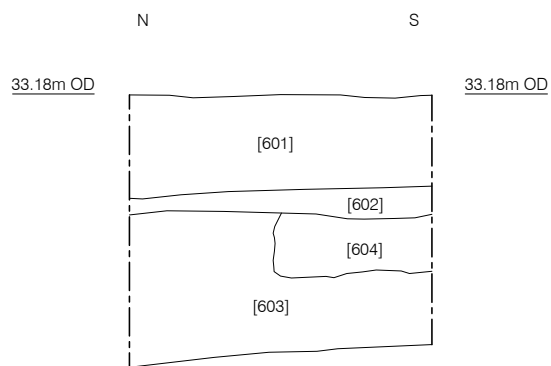
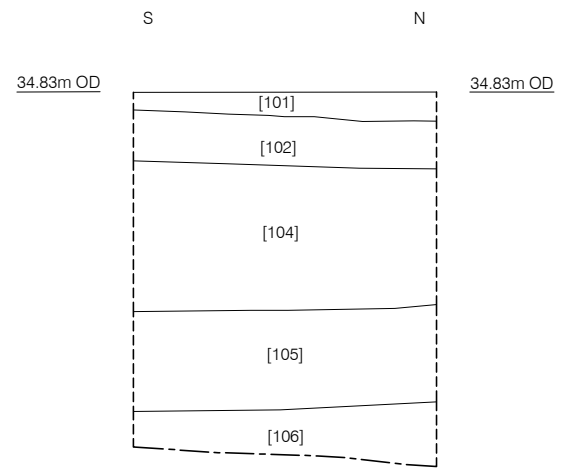

Figure 3
 Trenches with Representative Section Locations and Detail of Trench 4
 1:500, detail at 1:80 at A4



Section 1A
West Facing
Trench 6



Section 2A
East Facing
Trench 1

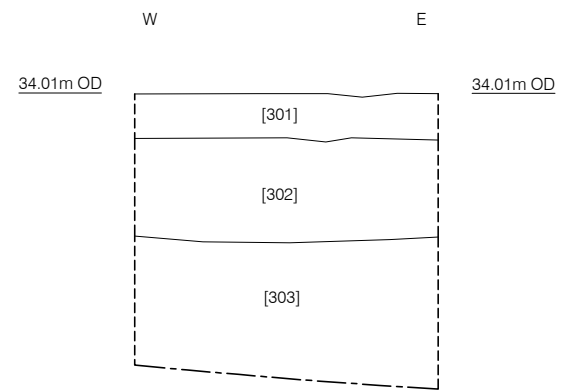

Section 2C
South Facing
Trench 3



Figure 4
Representative Sections From Trenches 1, 3, and 6
1:25 at A4

PCA

PCA CAMBRIDGE

THE GRANARY, RECTORY FARM
BREWERY ROAD, PAMPISFORD
CAMBRIDGESHIRE CB22 3EN
t: 01223 845 522
e: cambridge@pre-construct.com

PCA DURHAM

UNIT 19A, TURSDALE BUSINESS PARK
TURSDALE
DURHAM DH6 5PG
t: 0191 377 1111
e: durham@pre-construct.com

PCA LONDON

UNIT 54, BROCKLEY CROSS BUSINESS CENTRE
96 ENDWELL ROAD, BROCKLEY
LONDON SE4 2PD
t: 020 7732 3925
e: london@pre-construct.com

PCA NEWARK

OFFICE 8, ROEWOOD COURTYARD
WINKBURN, NEWARK
NOTTINGHAMSHIRE NG22 8PG
t: 01636 370410
e: newark@pre-construct.com

PCA NORWICH

QUARRY WORKS, DEREHAM ROAD
HONINGHAM
NORWICH NR9 5AP
T: 01223 845522
e: cambridge@pre-construct.com

PCA WARWICK

UNIT 9, THE MILL, MILL LANE
LITTLE SHREWLEY, WARWICK
WARWICKSHIRE CV35 7HN
t: 01926 485490
e: warwick@pre-construct.com

PCA WINCHESTER

5 RED DEER COURT, ELM ROAD
WINCHESTER
HAMPSHIRE SO22 5LX
t: 01962 849 549
e: winchester@pre-construct.com

