

**50-52 UNION STREET,
SOUTHWARK,
LONDON, SE1 1TD**

**AN ARCHAEOLOGICAL
WATCHING BRIEF ON
GEOTECHNICAL
SITE INVESTIGATION**

SITE CODE: UIO18

FEBRUARY 2019

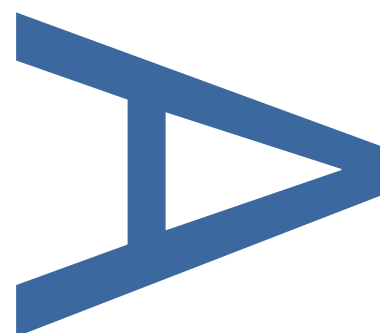
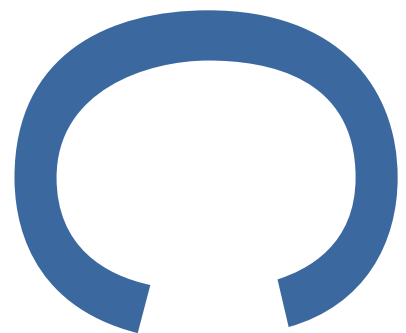

PRE-CONSTRUCT ARCHAEOLOGY

DOCUMENT VERIFICATION

50-52 UNION STREET, SOUTHWARK, LONDON, SE1 1TD

Type of project

ARCHAEOLOGICAL WATCHING BRIEF ON GEOTECHNICAL SITE INVESTIGATION

Quality Control

Pre-Construct Archaeology Limited Project Code			K5887
	Name	Signature	Date
Text Prepared by:	J Brooks		01.02.2019
Graphics Prepared by:	D Valk		06.02.2019
Graphics Checked by:	M Roughley		06.02.2019
Project Manager Sign-off:	Z Pozorski		08.02.2019

Revision No.	Date	Checked	Approved
1	11.02.2019	ZP	RR

Pre-Construct Archaeology Ltd
Unit 54
Brockley Cross Business Centre
96 Endwell Road
London
SE4 2PD

50-52 UNION STREET, SOUTHWARK, LONDON, SE1 1TD
AN ARCHAEOLOGICAL WATCHING BRIEF ON GEOTECHNICAL SITE
INVESTIGATION

SITE CODE:	UIO18
LOCAL PLANNING AUTHORITY:	LONDON BOROUGH OF SOUTHWARK
PLANNING REFERENCE:	18/AP/1781
CENTRAL NGR:	TQ 32359 80064
WRITTEN BY:	JOE BROOKS PRE-CONSTRUCT ARCHAEOLOGY LIMITED
PROJECT MANAGER:	ZBIGNIEW POZORSKI PRE-CONSTRUCT ARCHAEOLOGY LIMITED
COMMISSIONING CLIENT:	ARCHAEOLOGY COLLECTIVE
VERSION:	2.0 WITH ARCHAEOLOGY COLLECTIVE COMMENTS

Contractor:	Pre-Construct Archaeology Limited Unit 54, Brockley Cross Business Centre 96 Endwell Road, Brockley London SE4 2PD
Tel:	020 7358 8950 020 7732 3925
Email:	zpozorski@pre-construct.com
Website:	www.pre-construct.com

© Pre-Construct Archaeology Limited

February 2019

© The material contained herein is and remains the sole property of Pre-Construct Archaeology Limited and is not for publication to third parties without prior consent. Whilst every effort has been made to provide detailed and accurate information, Pre-Construct Archaeology Limited cannot be held responsible for errors or inaccuracies herein contained.

CONTENTS

1	ABSTRACT	3
2	INTRODUCTION	4
3	PLANNING BACKGROUND	5
4	RESEARCH DESIGN	9
5	GEOLOGICAL AND TOPOGRAPHIC BACKGROUND	10
6	ARCHAEOLOGICAL AND HISTORICAL BACKGROUND	10
7	METHODOLOGY	11
8	ARCHAEOLOGICAL SEQUENCE.....	12
9	INTERPRETATION AND CONCLUSIONS	16
10	RESEARCH OBJECTIVES	16
11	PLATES	17
12	ACKNOWLEDGEMENTS.....	21
13	BIBLIOGRAPHY	21
	APPENDIX 1: CONTEXT INDEX	22
	APPENDIX 2: STRATIGRAPHIC MATRIX.....	23
	APPENDIX 3: OASIS REPORT	24

FIGURES

FIGURE 1: SITE LOCATION	7
FIGURE 2: DETAILED SITE LOCATION	8
FIGURE 3: TEST PITS LOCATIONS	14
FIGURE 4: SECTIONS	15

1 ABSTRACT

- 1.1 This report details the results of an archaeological watching brief undertaken by Pre-Construct Archaeology Limited (PCA) at 50-52 Union Street, Southwark, London SE1 1TD. The site is located within basement of the standing office building on the site and is centred at National Grid Reference TQ 32359 80064.
- 1.2 The archaeological investigation was conducted on the 28th November 2018 and comprised the inspection and recording of seven geotechnical test pits. The test pits were located against the internal walls of the basement of 50-52 Union Street. The test pits were hand excavated by the attending groundworkers to determine the depths and condition of the building's existing footings.
- 1.3 The investigation recorded natural alluvium in the base of all seven test pits. In two of the test pits the natural deposits were truncated by post-medieval waste disposal pits, in the other pits post-medieval dump layers sealed the natural. The foundations of the extant late 19th century building truncated the archaeological deposits. In all of the test pits the archaeological deposits were sealed by a modern levelling layer which was capped by a concrete slab forming the basement floor of the extant building.

2 INTRODUCTION

- 2.1 This report details the results of an archaeological watching brief undertaken by Pre-Construct Archaeology Limited (PCA) at 50-52 Union Street, Southwark, London SE1 1TD. The site is located within basement of the standing office building on the site and is centred at National Grid Reference TQ 32359 80064.
- 2.2 The site is located in the London Borough of Southwark and is bounded by Union Street to the south, O'Meara Street to the west, a church to the north and an educational institute to the east (Figure 2)
- 2.3 The monitoring took place on the 28th of November 2018.
- 2.4 An Archaeological Desk-Based Assessment was prepared for the site (Archaeology Collective 2018) to support the planning submission. The assessment identified that there are no designated or non-designated heritage assets within the site. However, the site is located within the Borough, Bermondsey and Riverside Archaeological Priority Zone (APZ) (DLO35765), which has been designated in recognition of the Roman archaeology of the area. The assessment identified a low potential for prehistoric remains; and high potential for Roman, medieval and post-medieval remains.
- 2.5 A Written Scheme of Investigation (WSI) was prepared for the project (Archaeology Collective 2018b), which defined a pro-active programme of observation and recording during the groundworks. The WSI followed confirmation from Gillian King, Senior Planner Archaeology for Southwark Council, that an archaeological watching brief would need to be maintained during the ground investigation works, as well as during all groundworks associated with the proposed development, including any new drainage and any below ground impacts.
- 2.6 The investigation was conducted by Pre-Construct Archaeology Limited under the supervision of Bruce Ferguson, and the project management of Zbigniew Pozorski. The archaeological work was commissioned by Archaeology Collective on behalf of the overall client.
- 2.7 The site was allocated the unique site code UIO18. The complete archive comprising written, drawn, and photographic records and artefacts will be deposited with the London Archaeological Archive and Research Centre (LAARC).
- 2.8 All works were undertaken in accordance with the following documents:
- *Written Scheme of Investigation: Archaeological Watching Brief. 50-52 Union Street, London, SE1 1TD* (Archaeology Collective 2018)
 - *Management of Research Projects in the Historic Environment* (MoRPHE) (Historic England 2016)
 - Historic England Greater London Archaeology Advisory Service: Guidelines for Archaeological Projects in Greater London (HE GLAAS 2015)

- *Standard and guidance for an archaeological watching brief* (Chartered Institute for Archaeologists (CIfA) 2014).
- Taylor, J & Brown, G. 2009, *Fieldwork Induction Manual: Operations Manual*, Pre-Construct Archaeology Limited.

3 PLANNING BACKGROUND

3.1 Planning permission (Southwark Borough Council Ref. 18/AP/1781) was granted for the “substantial demolition, rebuild and extension of existing office/educational building (Use Class B1/D1) including side extensions at first, second and third floor to O'Meara Street, provision of additional fourth floor extension and retention of selected existing façades including to Union Street, to provide a 5 storey (height 18.4m AOD) mixed use building comprising additional 167sqm of office (Use Class B1a) and 1x two bedroom flat (Use Class C3) with roof terrace.

3.2 Condition 5 -7 and 16 attached to the permission stipulated:

Condition 5

Before any work hereby authorised begins, the applicant shall secure the implementation of a programme of archaeological mitigation works in accordance with a written scheme of investigation, which shall be submitted to and approved in writing by the Local Planning Authority.

Reason

In order that the details of the programme of works for the archaeological mitigation are suitable with regard to the impacts of the proposed development and the nature and extent of archaeological remains on site in accordance with Strategic Policy 12 - Design and Conservation of The Core Strategy 2011, Saved Policy 3.19 Archaeology of the Southwark Plan 2007 and the National Planning

Policy Framework 2018.

Condition 6

Before any work hereby authorised begins, a detailed scheme showing the complete scope and arrangement of the foundation design and all ground works shall be submitted to and approved in writing by the Local Planning Authority and the development shall not be carried out otherwise than in accordance with any such approval given.

Reason

In order that details of the foundations, ground works and all below ground impacts of the proposed development are detailed and accord with the programme of archaeological mitigation works to ensure the preservation of archaeological remains by record and in situ in accordance with Strategic Policy 12 – Design and Conservation of The Core Strategy 2011, Saved Policy 3.19 Archaeology of the Southwark Plan 2007 and the National Planning Policy Framework 2018.

Condition 7

Before any work hereby authorised begins, the applicant shall secure the implementation of a programme of archaeological evaluation works in accordance with a written scheme of investigation shall be submitted to and approved in writing by the Local Planning Authority.

Reason

In order that the applicants supply the necessary archaeological information to ensure suitable mitigation measures and/or foundation design proposals be presented in accordance with Strategic Policy 12 - Design and Conservation of The Core Strategy 2011, Saved Policy 3.19 Archaeology of the Southwark Plan 2007 and the National Planning Policy Framework 2018.

Condition 16

Within six months of the completion of archaeological site works, an assessment report detailing the proposals for post-excavation works, publication of the site and preparation of the archive shall be submitted to and approved in writing by the Local Planning Authority and that the works detailed in this assessment report shall not be carried out otherwise than in accordance with any such approval given.

Reason

In order that the archaeological interests of the site are secured with regard to the details of the post-excavation works, publication and archiving to ensure the preservation of archaeological remains by record in accordance with Strategic Policy 12 - Design and Conservation of The Core Strategy 2011, Saved Policy 3.19 Archaeology of the Southwark Plan 2007 and the National Planning Policy Framework 2018.

- 3.3 In advance of the project a Written Scheme of Investigation was prepared by Archaeology Collective and approved by the Gillian King.

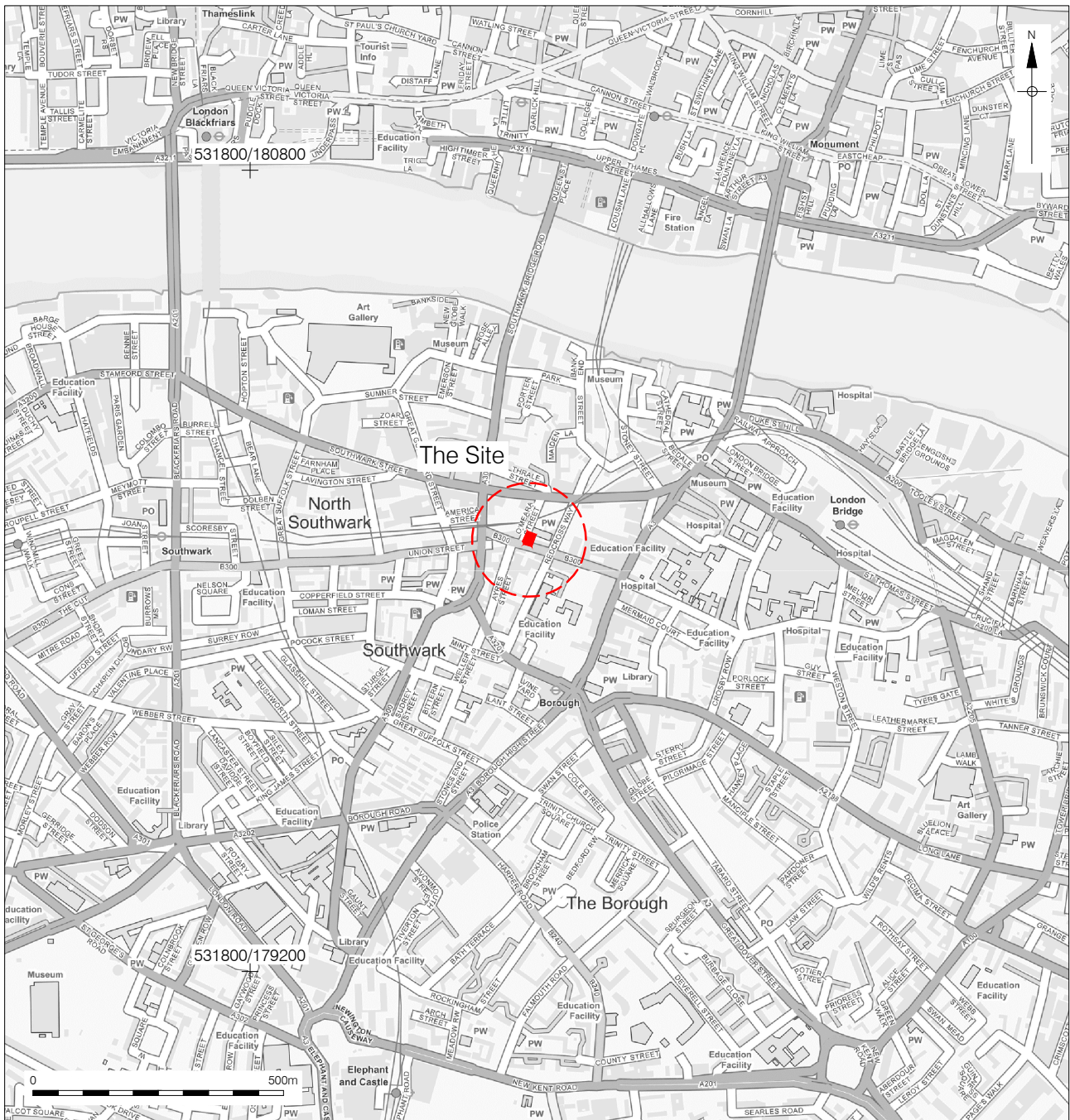
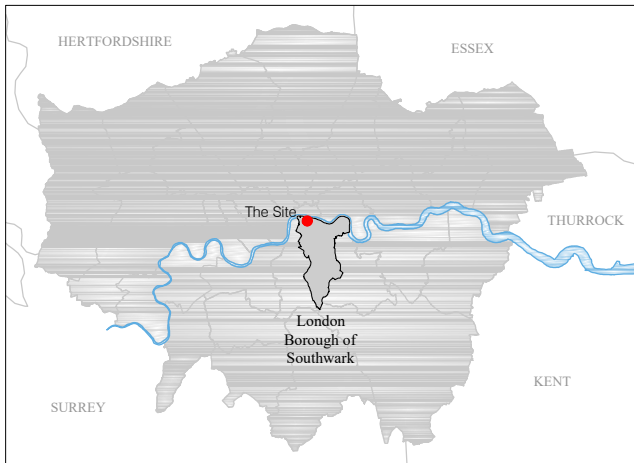

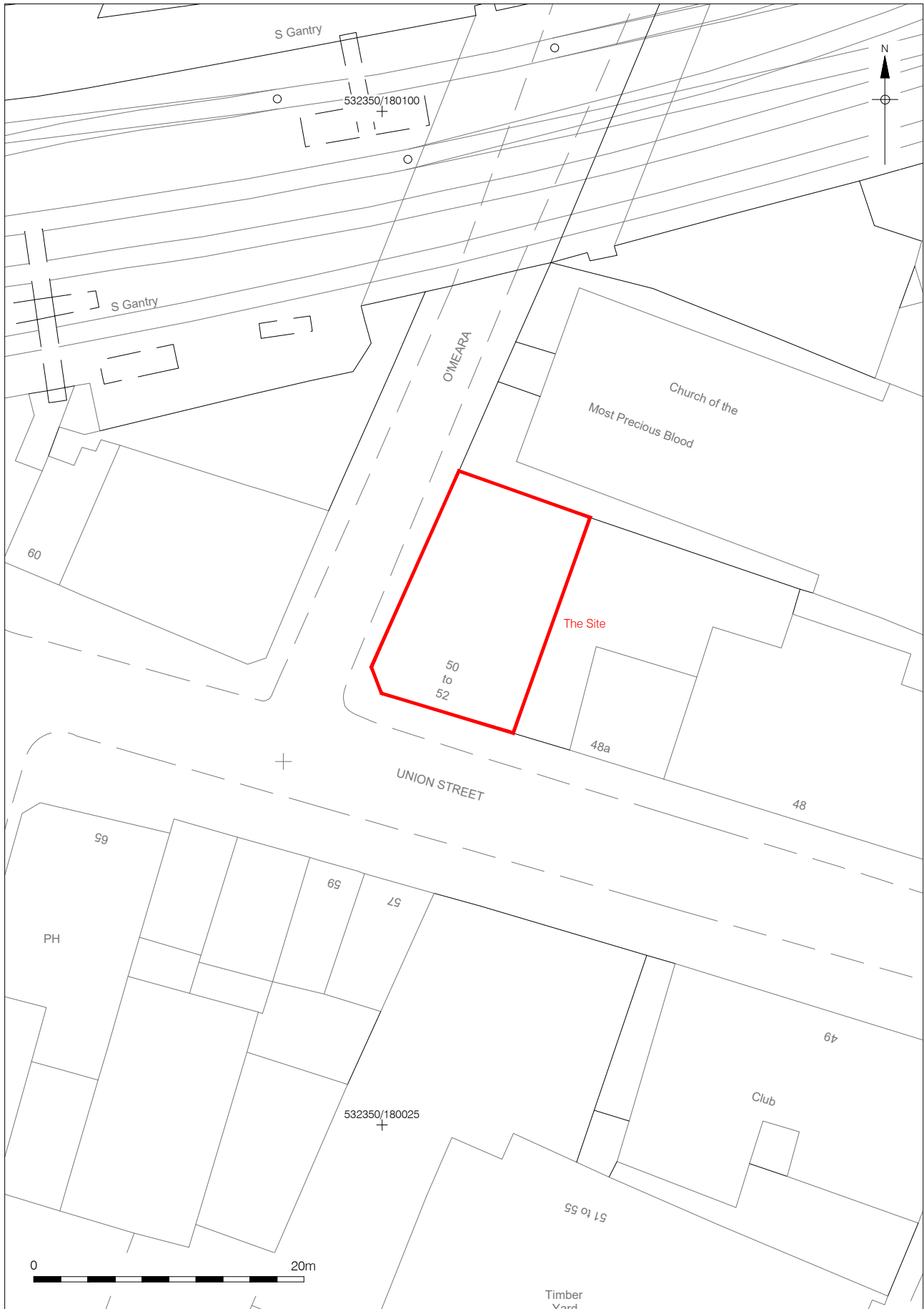

4 RESEARCH DESIGN

4.1 In line with the approved WSI (Archaeology Collective 2018b) the general aims of the watching brief were:

- to determine the presence or absence of archaeological deposits or remains;
- to record the character, date location and preservation of any archaeological remains on site; and
- to record the nature and extent of any previous damage to archaeological deposits or remains on site.

4.2 The project also has the potential to contribute to the following objectives of a research framework for London archaeology:

- Roman period: defining the economic character of different parts of the region through time – focussing on production, consumption and distribution;
- Roman period: Examining the reasons for and characteristics of contraction, decline and abandonment of the urban settlement;
- Roman period: Defining the relationships between landscape, river and settlement;
- Saxon period: Studying the transitions between late Roman and early Saxon, including the reasons and implications for shifting settlement patterns;
- Saxon period: Studying data from Southwark, in order to be able to characterise the nature of the settlement there; and
- Medieval period: Understanding the relative and evolving character of development in Westminster, along the Strand between Westminster and the City, and Southwark, and comparison with other riverine settlements beyond London.

5 GEOLOGICAL AND TOPOGRAPHIC BACKGROUND

- 5.1 The British Geological Survey identifies the solid geology on the site as London Clay Formation, of clay and silt, a sedimentary bedrock formed in the Palaeogene Period, which indicates a local environment previously dominated by deep seas. The solid geology is overlain by alluvium deposits of clay, silt, sand and peat which are fluvial in origin.
- 5.2 The site is located at 4.5m to 4.8m above Ordnance Datum (m OD).

6 ARCHAEOLOGICAL AND HISTORICAL BACKGROUND

- 6.1 A detailed background to the site was provided in the Archaeological Desk Based Assessment prepared by Archaeology Collective (2018a). In summary:
- 6.2 There are no designated or non-designated heritage assets within the Site. However, the Site is located within the Borough, Bermondsey and Riverside Archaeological Priority Zone (APZ) (DLO35765), which has been identified as such in relation to the Roman archaeology of the area.
- 6.3 There are 21 assets of prehistoric date recorded within the study area, including evidence of Mesolithic (MLO42728, MLO820, MLO8720 & MLO8806), Neolithic (MLO19062, MLO23174, MLO22227 & MLO2124), Bronze Age (MLO19073, MLO19964, MLO19965, MLO19946 & MLO11575) and Iron Age (MLO11576, MLO36355, MLO36320 & MLO77366), as well as evidence of activity which has not been dated to a specific prehistoric period (MLO36587, MLO23828 & MLO9172).
- 6.4 The Roman period is the best represented within the study area, and 250 assets dating to this period have been recorded within the study area. Part of the study area lies in an area which was formed by lower lying marshes (MLO4348) and water channels (e.g. MLO77377) and evidence recorded within the study area includes that the area was reclaimed and watercourses were controlled to allow Roman occupation and settlement. Evidence of intensive Roman settlement across the study area comprises evidence of buildings and cellars (e.g. MLO36377), yards (e.g. MLO30436), remains of walls and floors (e.g. MLO4224), as well as larger areas of occupation evidence (e.g. MLO4294). There is also evidence of Roman industrial activity and burial practices recorded within the study area.
- 6.5 There are eight assets of early medieval date recorded within the study area, although very little is known about the occupation of the Southwark area during the early medieval period. These assets comprise pits and a well (MLO53673), levelling dumps, rubbish pits and a possible clay and timber building (MLO103856), unspecified features (MLO67123 & MLO20083), areas of dark earth (MLO19162 & MLO36340) and the findspots of artefacts (MLO11500 & MLO23832).

- 6.6 There are 37 assets of medieval date recorded within the study area, including remains of pits (e.g. MLO8798), evidence of buildings (e.g. MLO22229), a burial ground (MLO7783) and other burial evidence (MLO4262) and ditches and channels (e.g. MLO23846). The location of two prisons (MLO4258 & MLO5954) and the gardens associated with the palace of the Bishops of Winchester (MLO0004) also extend into the study area. During the medieval period Southwark became established as a burh, mint and port.
- 6.7 There are 66 assets of post-medieval and modern date recorded within the study area, the majority of which relate to the industrial growth of the area, as well as the associated increase of domestic and social structures, including warehouses, factories and workshops (e.g. MLO74674), evidence of buildings and houses (e.g. MLO8780) and cemeteries (e.g. MLO16059). The study area was subject to a high number of bombings during World War Two, including two close to the junction of O'Meara Street and Union Street, at which the site is located.
- 6.8 Cartographic evidence suggests that the site was developed upon from at least the mid-18th century and was subsequently redeveloped during the post-medieval and modern periods.

7 METHODOLOGY

- 7.1 The proposed methodology of the archaeological work was detailed in the site-specific Written Scheme of Investigation (Archaeology Collective 2018b) and comprised the archaeological monitoring of seven geotechnical pits located within basement of the office building on the site (Figure 3).
- 7.2 Any potential archaeological features or deposits encountered within the test pits were cleaned and investigated by hand and recorded by the attending archaeologist. However, investigation of the archaeological features and deposits was restricted due to the limited dimensions of the test pits.
- 7.3 All recording systems adopted during the investigation were fully compatible with those most widely used elsewhere in London Borough of Southwark; presented in PCAs *Operations Manual 1* (Taylor & Brown 2009, updated 2018). A selective section of each test pit was drawn by hand at a scale of 1:10 in order to illustrate the observed sequences, modern disturbance and current ground level. In addition to a series of digital photographs recording the encountered deposits a written record of each deposit was also produced. Location of the section drawing was located by offsetting from the internal walls and plotted onto OS mapping data by CAD.
- 7.4 Following the completion of all phases of fieldwork and reporting the project archive will be deposited in its entirety with the London Archaeological Archive and Research Centre (LAARC) with the unique site code UIO 18.

8 ARCHAEOLOGICAL SEQUENCE

8.1 The following section describes the deposits recorded during the investigation by archaeological phase.

8.2 Phase 1: Natural

8.2.1 The earliest deposit encountered on the site was a layer of loose brownish orange sandy clay [6] probably representing alluvium overlying the London clay. Natural sandy clay [6] was recorded as the basal layer in all seven of the test pits. The following table describes the maximum level at which natural sandy clay [6] was recorded:

	TP1	TP2	TP3	TP4	TP5	TP6	TP7
Level (m OD)	0.82	1.2	1.24	1.23	1.38	0.84	1.23

8.3 Phase 2: Post-Medieval

8.3.1 In Test Pit 1 the natural sandy clay was truncated by a 0.08m deep pit [2], recorded at a maximum level of 1.28m OD. The pit [2] was filled with friable mottled brownish orange and brownish grey sandy clay [1] containing fragments of ceramic building material and glass.

8.3.2 A 0.40m deep pit [4], recorded at a maximum level of 1.20m OD, with vertical sides and a flat base, was observed in Test Pit 2. The pit [4] was filled with loose brown sandy clay [3] with frequent fragments of ceramic building material, glass and pottery.

8.3.3 In Test Pits 3, 6 and 7 the natural sandy clay [6] was sealed by a layer of friable brownish grey sandy clay made ground [5] with frequent flecks of chalk, charcoal, mortar, bone and rounded pebbles.

8.3.4 The table below describes the thickness and maximum level that layer [5] was recorded at in each Test Pit:

	TP1	TP2	TP3	TP4	TP5	TP6	TP7
Level (m OD)	-	-	1.54	-	-	1.53	1.44
Thickness (m)	-	-	0.25	-	-	0.7	0.2

8.4 Phase 3: Modern

8.4.1 The foundations of the extant building – constructed with stepped orangey pink brick footings stood on concrete footings up to 0.50m thick – were recorded in Test Pits 1, 2, 4 and 5.

8.4.2 In all the Test Pits the earlier deposits were sealed by a layer of made ground providing a base for a concrete slab forming the floor of the basement. The current level of the basement floor is tabulated below:

	TP1	TP2	TP3	TP4	TP5	TP6	TP7
Level (m OD)	1.83	1.8	1.83	1.83	1.83	1.82	1.84

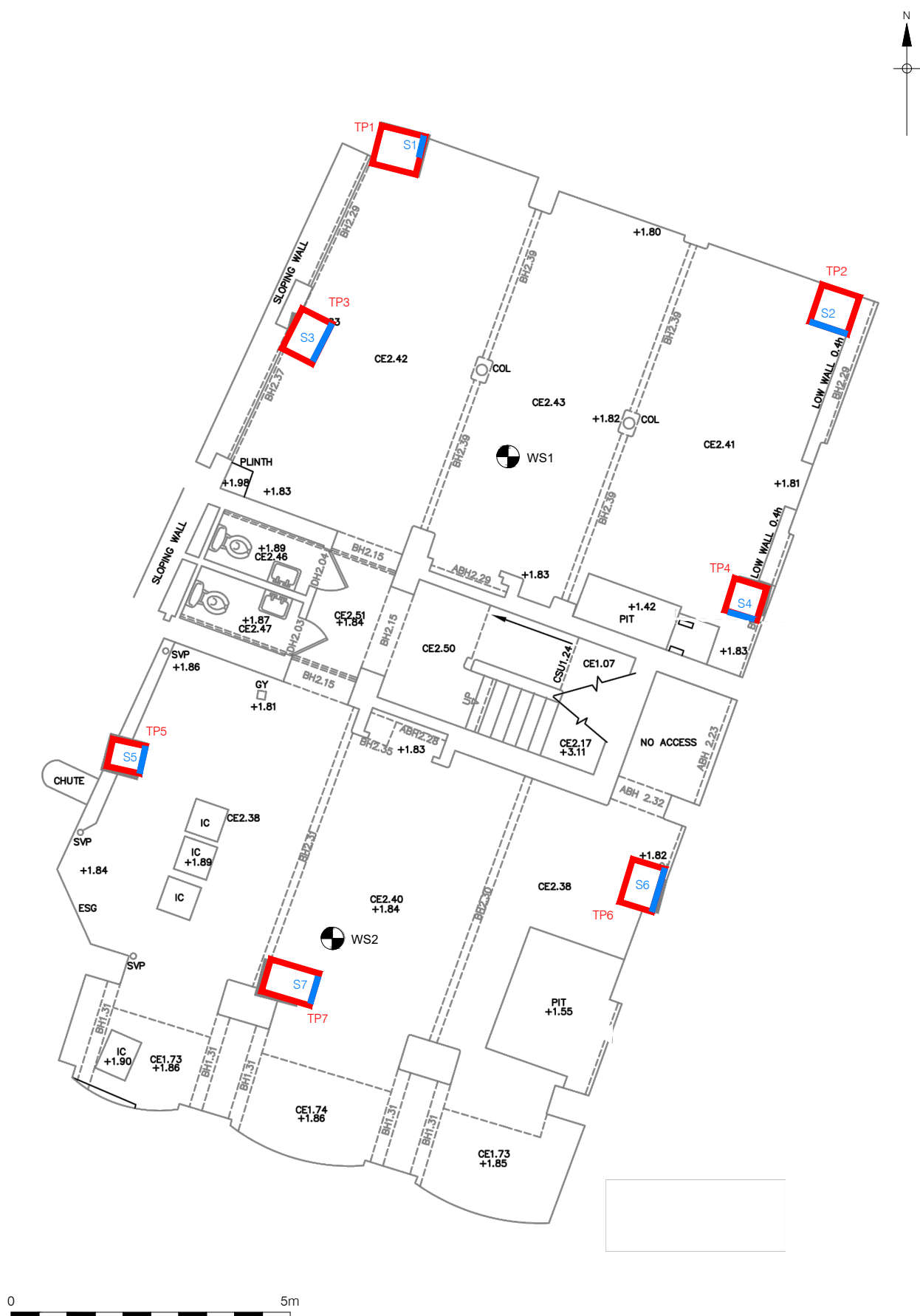

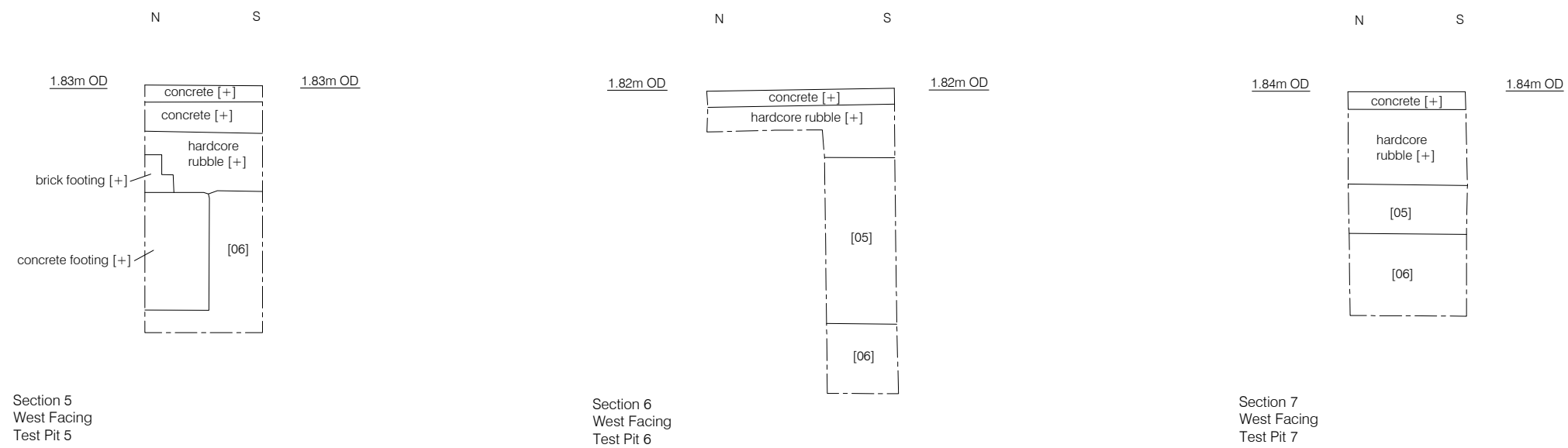
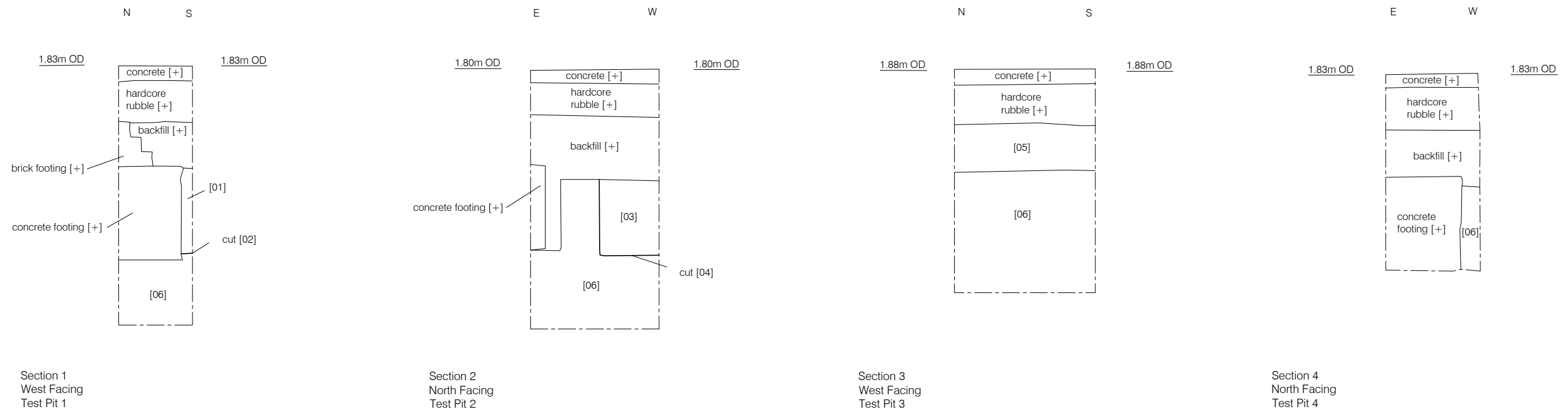

0 1m

9 INTERPRETATION AND CONCLUSIONS

9.1 Natural Topography (Phase 1)

- 9.1.1 The earliest deposit encountered on the site was natural sandy clay, representing alluvial deposits of fluvial origin. Levels taken across the site at the surface of the natural deposits that were not truncated suggest that the natural topography was relatively flat, lying at a level of c. 1.23m OD.

9.2 Post-Medieval (Phase 2)

- 9.2.1 Two cut features, probably representing waste disposal pits dated to the post-medieval period, were identified in Test Pits 1 and 2. The existence of these features, and the presence of a made ground layer recorded in Test Pits 3, 4 and 7 indicates landscaping activity and waste disposal on the site during the post-medieval period. However, it is difficult to characterise the exact nature of post-medieval occupation in much detail due to the limited scope of the investigation.

9.3 Modern (Phase 3)

- 9.3.1 The footings for the extant building, constructed in the late 19th century, were sealed by a bedding layer for the concrete slab which forms the current basement floor at a level of c. 1.83m OD.

10 RESEARCH OBJECTIVES

- 10.1 A number of site-specific research aims and objectives were raised and addressed for the investigation:

10.2 To determine the presence or absence of archaeological deposits or remains:

- 10.2.1 Archaeological remains dating to the post-medieval period were present on the site.

10.3 To record the character, date location and preservation of any archaeological remains on site:

- 10.3.1 The post-medieval remains discovered on the site were characterised as being well preserved where intact and represented waste disposal and landscaping events.

10.4 To record the nature and extent of any previous damage to archaeological deposits or remains on site:

- 10.4.1 Late 19th century foundations for the extant building had caused significant truncation to the archaeological deposits.

- 10.5 No archaeological evidence related to the occupation of the site in the Roman, Saxon or medieval periods was discovered during the watching brief.

11 PLATES



Plate 1: North facing photograph of Test Pit 1 (Scale: 0.20m)



Plate 2: South facing photograph of Test Pit 2 (Scale: 0.20m)



Plate 3: West facing photograph of Test Pit 3 (Scale: 0.20m)



Plate 4: South facing photograph of Test Pit 4 (Scale: 0:20m)



Plate 5: North facing photograph of Test Pit 5 (Scale: 0.20m)



Plate 6: North facing photograph of Test Pit 6 (Scale: 0.20m)



Plate 7: East facing photograph of test Pit 7 (Scale: 0.20m)

12 ACKNOWLEDGEMENTS

- 12.1 Pre-Construct would like to thank Rebecca Ryan of Archaeology Collective for commissioning the work on behalf of the overall client. We also thank the Senior Planner Archaeology, Southwark Council for her input and advice to the project.
- 12.2 The author would also like to thank Bruce Ferguson for supervising the watching brief, Zbigniew Pozorski for his project management and editing this report, and Diana Valk for the illustrations.

13 BIBLIOGRAPHY

Archaeology Collective, 2018a, Archaeological Desk Based Assessment: *50-52 Union Street, London SE1 1TD*, unpublished report

Archaeology Collective, 2018b, *Written Scheme of Investigation: Archaeological Watching Brief 50-52 Union Street, London SE1 1TD*, unpublished report

Chartered Institute for Archaeologists, 2014 Standard and guidance for an archaeological watching brief ClfA 2014

Historic England Greater London Archaeology Advisory Service, 2015, *Standards for Archaeological Work*

Historic England, 2016, Management of Research Projects in the Historic Environment MoRPHE

Taylor, J. with Brown, G. 2009, updated 2018, *Fieldwork Induction Manual: Operations Manual 1*, Pre-Construct Archaeology Limited

APPENDIX 1: CONTEXT INDEX

Context	CTX_Type	Trench	CTX Interpretation	CTX_Category	CTX_Length	CTX_Width	CTX_Depth	CTX_Levels_high	CTX_Levels_low	Phase
1	Fill	TP1	Backfill of waste disposal pit	Backfill	0.8	0.05	0.08	1.28	1.28	UIO18-PH2
2	Cut	TP1	Cut of waste disposal pit	Pit	0.8	0.05	0.08	1.28	0.82	UIO18-PH2
3	Fill	TP2	Backfill of waste disposal pit	Backfill	0.7	0.33	0.4	1.2	1.2	UIO18-PH2
4	Cut	TP2	Waste disposal pit	Pit	0.7	0.33	0.4	1.2	0.8	UIO18-PH2
5	Layer	Tp 3, 6 & 7	Made ground	Make-up			0.7	1.54	1.44	UIO18-PH2
6	Natural	TP 1 - 7	Natural sandy clay alluvium	Natural			0.85	1.38	0.82	UIO18-PH1

APPENDIX 2: STRATIGRAPHIC MATRIX

Phase 3: modern

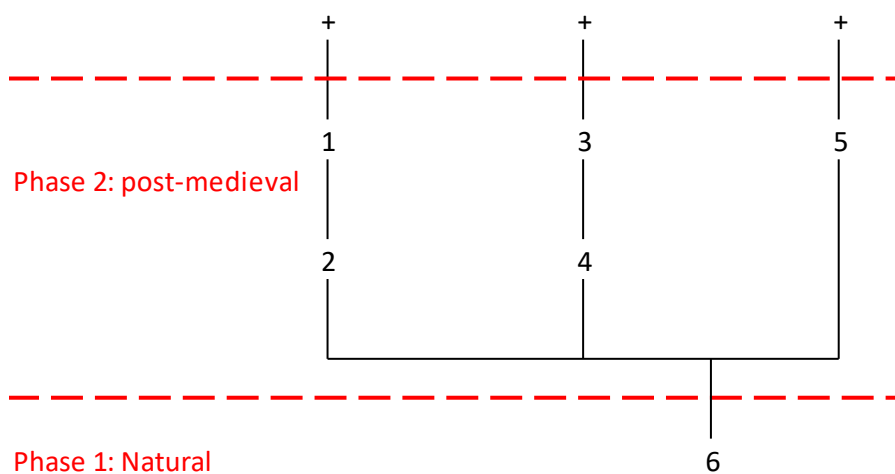

APPENDIX 3: OASIS REPORT

13.1 OASIS ID: preconst1-336622

Project details

Project name	50-52 Union Street, Southwark, watching brief
Short description of the project	an archaeological watching brief was conducted by Pre-Construct Archaeology Limited (PCA) at 50-52 Union Street, Southwark, London SE1 1TD. The site is located within an Archaeological Priority Zone as defined by the London Borough of Southwark and is centred at National Grid Reference TQ 32359 80064. The archaeological investigation was conducted on the 28th November 2018 and comprised the inspection and recording of seven geotechnical test pits. The test pits were located against the internal walls of the basement of 50-52 Union Street. The test pits were hand excavated by the attending groundworkers to determine the depths and condition of the buildings' existing footings. The investigation recorded post-medieval dump layers for levelling purposes and fills of possible waste disposal pits.
Project dates	Start: 28-11-2018 End: 28-11-2018
Previous/future work	No / Not known
Type of project	Field evaluation
Site status	Local Authority Designated Archaeological Area
Current Land use	Industry and Commerce 2 - Offices
Monument type	PIT Post Medieval
Methods & techniques	"Test Pits"
Development type	Building refurbishment/repairs/restoration
Prompt	National Planning Policy Framework - NPPF
Position in the planning process	Not known / Not recorded

Project location

Country	England
Site location	GREATER LONDON SOUTHWARK SOUTHWARK 50-52 Union Street, London, SE1 1TD

Postcode	SE1 1TD
Study area	0 Square metres
Site coordinates	TQ 32354 80061 51.503466038563 -0.092823983286 51 30 12 N 000 05 34 W Point
Height OD / Depth	Min: 0.75m Max: 1.84m

Project creators

Name of Organisation	PCA
Project brief originator	Archaeology Collective
Project design originator	Zbigniew Pozorski
Project director/manager	Zbigniew Pozorski
Project supervisor	Bruce Ferguson
Type of sponsor/funding body	THB Property

Entered by	Zbigniew Pozorski (zpozorski@pre-construct.com)
Entered on	12 December 2018

PCA

PCA CAMBRIDGE

THE GRANARY, RECTORY FARM
BREWERY ROAD, PAMPISFORD
CAMBRIDGESHIRE CB22 3EN
t: 01223 845 522
e: cambridge@pre-construct.com

PCA DURHAM

UNIT 19A, TURSDALE BUSINESS PARK
TURSDALE
DURHAM DH6 5PG
t: 0191 377 1111
e: durham@pre-construct.com

PCA LONDON

UNIT 54, BROCKLEY CROSS BUSINESS CENTRE
96 ENDWELL ROAD, BROCKLEY
LONDON SE4 2PD
t: 020 7732 3925
e: london@pre-construct.com

PCA NEWARK

OFFICE 8, ROEWOOD COURTYARD
WINKBURN, NEWARK
NOTTINGHAMSHIRE NG22 8PG
t: 01636 370410
e: newark@pre-construct.com

PCA NORWICH

QUARRY WORKS, DEREHAM ROAD
HONINGHAM
NORWICH NR9 5AP
T: 01223 845522
e: cambridge@pre-construct.com

PCA WARWICK

UNIT 9, THE MILL, MILL LANE
LITTLE SHREWLEY, WARWICK
WARWICKSHIRE CV35 7HN
t: 01926 485490
e: warwick@pre-construct.com

PCA WINCHESTER

5 RED DEER COURT, ELM ROAD
WINCHESTER
HAMPSHIRE SO22 5LX
t: 01962 849 549
e: winchester@pre-construct.com

