

**21 EASTGATE STREET,  
WINCHESTER, HAMPSHIRE,  
SO23 8EB**

**ARCHAEOLOGICAL EVALUATION  
REPORT**

**LOCAL PLANNING AUTHORITY:  
WINCHESTER CITY COUNCIL**

**PLANNING APPLICATION NUMBERS:  
19/01591/HOU**

**PCA REPORT NO: 14009**

**SITE CODE: AY707**

**FEBRUARY 2020**

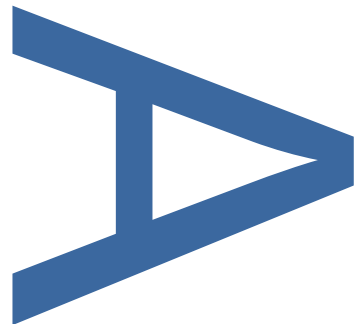
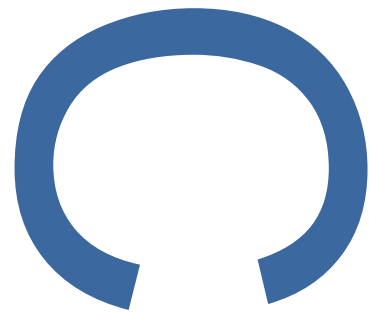

**PRE-CONSTRUCT ARCHAEOLOGY**

**21 EASTGATE STREET, WINCHESTER, HAMPSHIRE, SO23 8EB**  
**ARCHAEOLOGICAL EVALUATION REPORT**

---

**Issue 1:** Issued for Approval

**Local Planning Authority:** Winchester City Council

**Planning Reference:** 19/01591/HOU

**Site Code:** AY707

**Central NGR:** SU 48553 29450

**Commissioning Client:** Guy Lund

**Written/Researched by:** Gareth Howland

**Project Manager:** Paul McCulloch BA (Hons), MCIfA

**Contractor:** Pre-Construct Archaeology Ltd (Winchester)  
5 Red Deer Court  
Elm Road  
Winchester  
Hampshire  
SO22 5LX

**Tel:** 01962 849 549  
**E-mail:** pmcculloch@pre-construct.com  
**Web:** [www.pre-construct.com](http://www.pre-construct.com)

---

**© Pre-Construct Archaeology Limited**  
**February 2020**

© The material contained herein is and remains the sole property of Pre-Construct Archaeology Limited and is not for publication to third parties without prior consent. Whilst every effort has been made to provide detailed and accurate information, Pre-Construct Archaeology Limited cannot be held responsible for errors or inaccuracies herein contained.

## DOCUMENT VERIFICATION

**Site Name: 21 Eastgate Street, Winchester, Hampshire, SO23 8EB**

**Type of project: Archaeological Evaluation Report**

**Report: R14009**

|   |             |              |
|---|-------------|--------------|
| <b>Pre-Construct Archaeology Limited Project Code</b> |             | <b>K6463</b> |
| Text Prepared by:                                     | G Howland   | 03/2/2020    |
| Graphics Prepared by:                                 | D Valk      | 03/2/2020    |
| Graphics Checked by:                                  | M Roughley  | 03/2/2020    |
| Project Manager:                                      | P McCulloch | 07/02/2020   |

| <b>Revision No.</b> | <b>Date</b> | <b>Checked</b> | <b>Approved</b> |
|---------------------|-------------|----------------|-----------------|
|                     |             |                |                 |
|                     |             |                |                 |
|                     |             |                |                 |

## CONTENTS

|          |   |           |
|----------|---|-----------|
| <b>1</b> | <b>NON-TECHNICAL SUMMARY .....</b>              | <b>4</b>  |
| <b>2</b> | <b>INTRODUCTION .....</b>                       | <b>5</b>  |
| <b>3</b> | <b>AIM.....</b>                                 | <b>7</b>  |
| <b>4</b> | <b>RESULTS .....</b>                            | <b>8</b>  |
| <b>5</b> | <b>ARCHIVE PREPARATION AND DEPOSITION .....</b> | <b>10</b> |
| <b>6</b> | <b>ACKNOWLEDGEMENTS .....</b>                   | <b>11</b> |
| <b>7</b> | <b>REFERENCES .....</b>                         | <b>12</b> |
|          | <b>APPENDIX 1 : PLATES .....</b>                | <b>13</b> |
|          | <b>APPENDIX 2: CONTEXT INDEX .....</b>          | <b>14</b> |
|          | <b>APPENDIX 3: OASIS RECORD.....</b>            | <b>15</b> |

## FIGURES

**Figure 1: Site Location**

**Figure 2: Detailed Site Location**

**Figure 3: Section**

## **1 NON-TECHNICAL SUMMARY**

Pre-Construct Archaeology Ltd was appointed by Guy Lund, to carry out an archaeological evaluation, at 21 Eastgate Street, Winchester, Hampshire SO23 8EB, hereafter. The Site is the subject of a development proposal including a single storey rear extension.

The evaluation was designed in discussion with the Local Planning Authority's Historic Environment Team Archaeologist and reflected the potential of the Site to contain archaeological resources that may be affected by the proposed development.

The evaluation comprised the excavation of one 1.5m by 1.4m test pit, to a total depth of no more than 1m (the proposed depth of foundations for the rear extension).

No significant archaeological features or finds were identified during the course of this evaluation. As such it is considered that the proposed development will not affect any significant archaeological resources.

## **2 INTRODUCTION**

### **2.1 Project Background**

2.1.1 Pre-Construct Archaeology Ltd (PCA) was appointed by Guy Lund, to carry out an archaeological evaluation, at 21 Eastgate Street, Winchester, Hampshire SO23 8EB, hereafter 'the Site', NGR SU 48553 29450 (**Figure 1**). The Site is the subject of a development proposal including a single-story rear extension.

2.1.2 The archaeological evaluation was a requirement of the Local Planning Authority (LPA), Winchester City Council, that has granted planning consent for the development (planning reference 19/01591/HOU). The evaluation was designed in discussion with the LPA's Historic Environment Team Archaeologist (HETA) and reflected the potential of the Site to contain archaeological remains that may be affected by the proposed development; it is intended to address conditions 2 and 3 of planning consent.

2.1.3 This document provides a report on the results of the evaluation, carried out on the 27<sup>th</sup> and 28<sup>th</sup> of January 2020, and has been prepared in accordance with the Chartered Institute for Archaeologists standard and guidance for an archaeological evaluation (CIfA 2014) and Management of Research Projects in the Historic Environment (Historic England, 2015). PCA is a CIfA Registered Archaeological Organisation and is bound by its code of conduct

### **2.2 Location, Topography and Geology**

2.2.1 The Site, which comprises a house and rear garden forming part of a terrace built in 1849, lies in the historic core of Winchester on the west side of Eastgate Street, 50m west of the line of the City's historic defences and the River Itchen. Eastgate Street, which runs north-south and parallel with the river occurs at approximately 37m above Ordnance Datum. The immediate topography is level, typical of its location on the River Itchen valley floor and is typically urban in character, comprising mainly Victorian and later 20th century building stock.

2.2.2 The bedrock geology of the Site is mapped as Seaford Chalk Formation, with superficial deposits likely to include gravel beneath alluvial deposits.

### **2.3 Archaeological and Historical Background**

2.3.1 The Site lies in an area of the historic core of Winchester where archaeological remains of prehistoric, Romano-British, Saxon, medieval and post-medieval date are known to be deeply stratified and potentially, at depth, waterlogged. The line of Eastgate Street runs inside the course of the City's Roman and medieval defences between the site of Durn Gate and the site of the east gate and was laid out over the former Blackfriars precinct.

2.3.2 In providing the advice on the planning application for the proposed rear extension, the Historic Environment Team Archaeologist commented on the archaeological background as follows:

- *The proposed development site lies in an area of high archaeological potential just to the west of the line of the historic city defences, within the area of the medieval Blackfriars precinct and within an area occupied during the Roman and Late Saxon / earlier medieval periods.*
- *Very little archaeological investigation has been carried out in the area of the proposal site, however archaeological investigations undertaken ahead of development on the eastern side of Eastgate Street in 1989 and 1999 identified remains associated with the Blackfriars, a Late Saxon intramural street just inside the city defences and remains of the Roman defences and robbed traces of the medieval city wall. Here archaeological remains were identified at shallow depths of between 0.4 – 1m below ground level. It is uncertain whether a similar depth of cover exists over buried archaeological remains that may be present below the proposal site.*

### **3 AIM**

#### **3.1 Archaeological Evaluation**

- 3.1.1 The aim of the archaeological evaluation was to determine the presence or absence of archaeological remains within the below-ground impact of the proposed development and, if present, establish the character, extent, date, condition and significance of the remains, taking account of their potential to contain biological and palaeo-environmental evidence.
- 3.1.2 A further aim was to prepare an archive of the results of the investigations leading to the preparation of this final report, so that the future treatment of any archaeological resources beneath the Site, in respect of the proposed development, may be determined.



## 4 RESULTS

### 4.1 Introduction

4.1.1 The following presents a summary of the evaluation results based upon the Site archive, which comprises a Site diary, digital photographs. Photographs of the site appear in **Appendix 1**. The archive of all stages of the archaeological work is held at PCA's Winchester office under the site code AY707 and will in due course be deposited with the Hampshire Cultural Trust.

### 4.2 Methodology

4.2.1 The archaeological evaluation was undertaken following the methodology detailed in the Written Scheme of Investigation (PCA 2019), which was approved by the Local Planning Authority in advance of the works and on the advice of the HETA.

4.2.2 The evaluation comprised the excavation of one 1.5m by 1.4m test pit, to a total depth of no more than 1m (the proposed depth of foundations) or to the depth at which archaeology was encountered. The test pit was located within the southern half of the existing patio area and was adjusted to avoid services (**Figure 2** and **Plate 1**).

### 4.3 Results

4.3.1 Test Pit 1 was excavated to a total depth of 1.04m, c. 35.57m above ordnance datum (aOD) at the base. No natural deposits were encountered, and no significant archaeological features or finds were observed.

4.3.2 The following deposition sequence was observed (**Figure 3** and **Plate 2**):

- Paving (+) – 0.00-0.05m BGL
- Modern garden soil (context 001) – 0.05m-0.24m BGL
- Mid yellow grey sandy clay (002) – 0.24m-0.43m BGL
- Dark grey clay (003) – 0.43m-0.78m BGL
- Mid grey clay (004) – 0.78m-1.04m+ BGL

4.3.3 The earliest layer uncovered was (004) a mid-grey sandy clay measuring 0.26m+ thick, this layer was overlain by (003) a darker layer of grey sandy clay measuring 0.35m thick. Both contained a mix of post-medieval and late medieval finds, including pottery, ceramic building material (CBM), clay pipe and oyster shell.

4.3.4 Overlying (003) was (002) a layer of mid yellow grey sandy clay measuring 0.19m thick, it contained frequent chalk and flint rubble along with post-medieval pottery and CBM.

4.3.5 Overlying (002) was (001) a layer of modern garden soil which measured 0.19m thick.

4.3.6 Capping (001) were paving slabs which formed the existing patio area. The slabs measured 0.05m thick.

#### **4.4 Finds**

- 4.4.1 Both of the lower layers of the test pit, contexts (003) and (004) contained sherds of pottery dating from late medieval through to the 20<sup>th</sup> century along with building rubble, clay pipe and oyster shell. The earlier material was considered to be residual, so the assemblage is of limited archaeological significance.
- 4.4.2 Layer (003) contained five pottery sherds (63g total) of late medieval pottery, and 12 pottery sherds (95g total) of 19<sup>th</sup> – 20<sup>th</sup> century date. Layer (004) contained four sherds (43g total) of late medieval pottery and three sherds (13g total) of 12<sup>th</sup>-20<sup>th</sup> century pottery.
- 4.4.3 Of note, layer (004) produced a medieval encaustic floor tile of Wessex fabric and typical of 13<sup>th</sup>-14<sup>th</sup> century date. Although clearly a residual find in a deposit of later date, the tile may derive from a medieval building in the vicinity, conceivably within the Black Friars precinct, which stood close to the East Gate of the town

#### **4.5 Conclusion**

- 4.5.1 No significant archaeological features or finds were identified during the course of the evaluation. Furthermore, the presence of post-medieval layers extending to greater depth than the test pit indicates that it is highly unlikely any significant archaeological resources will be present at the level at which the proposed rear extension foundations will be formed. As such it can be considered that the proposed development will not affect any significant archaeological resources.

## **5 ARCHIVE PREPARATION AND DEPOSITION**

### **5.1 The Site Archive**

5.1.1 The Site archive, to include all project records and cultural material produced by the project, will be prepared in accordance with 'Guidelines for the Preparation of Excavation Archives for Long-term Storage' (UKIC 1990) and the Institute for Archaeologists 'Standard and Guidance for the creation, compilation, transfer and deposition of archaeological archives' (ClfA 2014). On completion of the project PCA will arrange for the archive to be deposited with the Hampshire Cultural Trust.

### **5.2 Copyright**

5.2.1 The full copyright of the written/illustrative archive relating to the site will be retained by Pre-Construct Archaeology Ltd under the Copyright, Designs and Patents Act 1988 with all rights reserved. Hampshire Cultural Trust, however, will be granted an exclusive licence for the use of the archive for educational purposes, including academic research, providing that such use shall be non-profitmaking, and conforms to the Copyright and Related Rights regulations 2003. Further distribution and uses of the report either in its entirety or part thereof in paper or electronic form is prohibited without the prior consent of Pre-Construct Archaeology Ltd.

5.2.2 The licence extends to the use of all documents arising from this project in all matters relating directly to the project, as well as for bona fide research purposes (which includes the Winchester HER).

5.2.3 Pre-Construct Archaeology Ltd has made every effort to ensure the accuracy of the content of this report. However, Pre-Construct Archaeology Ltd cannot accept any liability in respect of, or resulting from, errors, inaccuracies or omissions this report contains.

## **6 ACKNOWLEDGEMENTS**

Pre-Construct Archaeology Ltd. Is grateful to Guy Lund for commissioning the archaeological evaluation and to Tracy Matthews, Winchester City Council Historic Environment Team Archaeologist, for her advice.

The evaluation was undertaken by Gareth Howland and Tom Warburton. The report was prepared by Gareth Howland and the report illustrations were prepared by Diana Valk. The project was managed for PCA by Paul McCulloch.

## **7 REFERENCES**

Eames, E (1976). '*Medieval Tiles, A Handbook*'. London: British Museum Publications Ltd.

PCA (2019). '*21 Eastgate Street, Winchester, Hampshire, SO23 8EB: Written Scheme of Investigation for Archaeological Evaluation*'

## APPENDIX 1: PLATES



Plate 1. Overview of test pit 1, looking south east. Scale 1m.



Plate 2. East facing section of test pit 1, looking west. Scale 1m.

## APPENDIX 2: CONTEXT INDEX

| <b>Context Number</b> | <b>Description</b>  | <b>Type</b> | <b>Date</b> | <b>Interpretation</b> | <b>Depth Bellow Ground Level (m)</b> |
|-----------------------|---|-------------|-------------|-----------------------|--------------------------------------|
| +                     | Paving Slabs  | -           | modern      | Patio                 | 0-0.05                               |
| 001                   | Loose, dark grey/black brown, sandy silt, infrequent chalk flecks | Layer       | modern      | garden soil           | 0.05-0.24                            |
| 002                   | Loose, mid yellow grey, sandy clay, frequent flint + chalk        | Layer       | post med    | made ground           | 0.24-0.43                            |
| 003                   | Loose, dark grey, sandy clay, infrequent chalk flecks             | Layer       | post med    | made ground           | 0.43-0.78                            |
| 004                   | Loose, light/mid grey, sandy clay, frequent flint + chalk         | Layer       | post med    | made ground           | 0.78-1.04+                           |

## APPENDIX 3: OASIS RECORD

### OASIS ID: preconst1-383339

#### Project details

|  |  |
|--|--|
| Project name                           | 21 Eastgate Street, Winchester, Hampshire, SO23 8EB Archaeological Evaluation Report   |
| Short description of the project       | Pre-Construct Archaeology Ltd (PCA) was appointed by Guy Lund, to carry out an archaeological evaluation, at 21 Eastgate Street, Winchester, Hampshire SO23 8EB, hereafter. The Site is the subject of a development proposal including a single story rear extension. The evaluation was designed in discussion with the LPA's Historic Environment Team Archaeologist (HETA) and reflected the potential of the Site to contain archaeological resources that may be affected by the proposed development. The evaluation comprised the excavation of one 1.5m by 1.4m test pit, to a total depth of no more than 1m (the proposed depth of foundations). No significant archaeological features or finds were identified during the course of this evaluation. As such it can be considered that the proposed development will not affect any archaeological resources. |
| Project dates                          | Start: 27-01-2020 End: 28-01-2020  |
| Previous/future work                   | No / Not known   |
| Any associated project reference codes | AY707 - Sitecode   |
| Any associated project reference codes | 19/01591/HOU - Planning Application No.  |
| Type of project                        | Field evaluation   |
| Current Land use                       | Residential 1 - General Residential  |

#### Project location

|                  |   |
|------------------|---|
| Country          | England   |
| Site location    | HAMPSHIRE WINCHESTER WINCHESTER 21 Eastgate Street, Winchester              |
| Postcode         | SO238EB   |
| Study area       | 0 Square metres   |
| Site coordinates | SU 48553 29450 51.061797456992 -1.307071369795 51 03 42 N 001 18 25 W Point |

#### Project creators

|                           |   |
|---------------------------|---|
| Name of Organisation      | PCA West  |
| Project brief originator  | Historic Environment Officer at Winchester City Council |
| Project design originator | Paul McCulloch  |



|                              |                |
|------------------------------|----------------|
| Project director/manager     | Paul McCulloch |
| Project supervisor           | Gareth Howland |
| Type of sponsor/funding body | Client         |
| Name of sponsor/funding body | Guy Lund       |

---

### Project archives

|                            |   |
|----------------------------|---|
| Physical Archive recipient | Hampshire Cultural Trust  |
| Physical Archive ID        | WINCM: AY707  |
| Physical Contents          | "Ceramics", "Glass", "Animal Bones"                                     |
| Digital Archive recipient  | Hampshire Cultural Trust  |
| Digital Archive ID         | WINCM: AY707  |
| Digital Contents           | "Stratigraphic"   |
| Digital Media available    | "Images raster / digital photography", "Spreadsheets", "Survey", "Text" |
| Paper Archive recipient    | Hampshire Cultural Trust  |
| Paper Archive ID           | WINCM: AY707  |
| Paper Contents             | "Stratigraphic"   |
| Paper Media available      | "Context sheet", "Drawing", "Photograph", "Report"                      |

---

### Project bibliography 1

|                               |   |
|-------------------------------|---|
| Publication type              | Grey literature (unpublished document/manuscript)                                   |
| Title                         | 21 Eastgate Street, Winchester Hampshire, SO23 8EB Archaeological Evaluation Report |
| Author(s)/Editor(s)           | Howland, G. McCulloch, p.   |
| Other bibliographic details   | R14009  |
| Date                          | 2020  |
| Issuer or publisher           | PCA   |
| Place of issue or publication | Winchester  |

---

|            |   |
|------------|---|
| Entered by | Gareth Howland (GHowland@pre-construct.com) |
| Entered on | 31 January 2020                             |

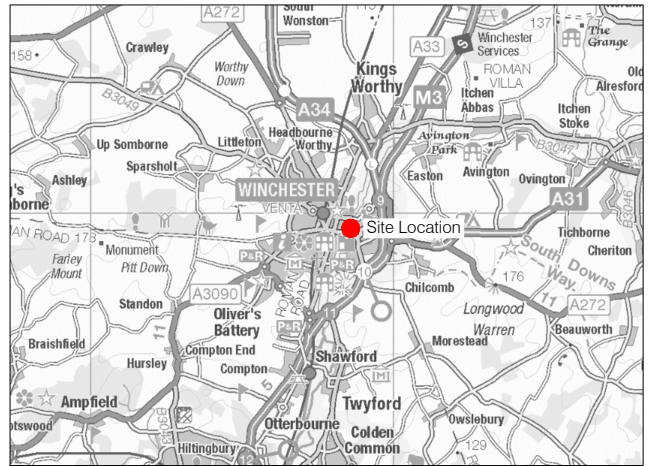

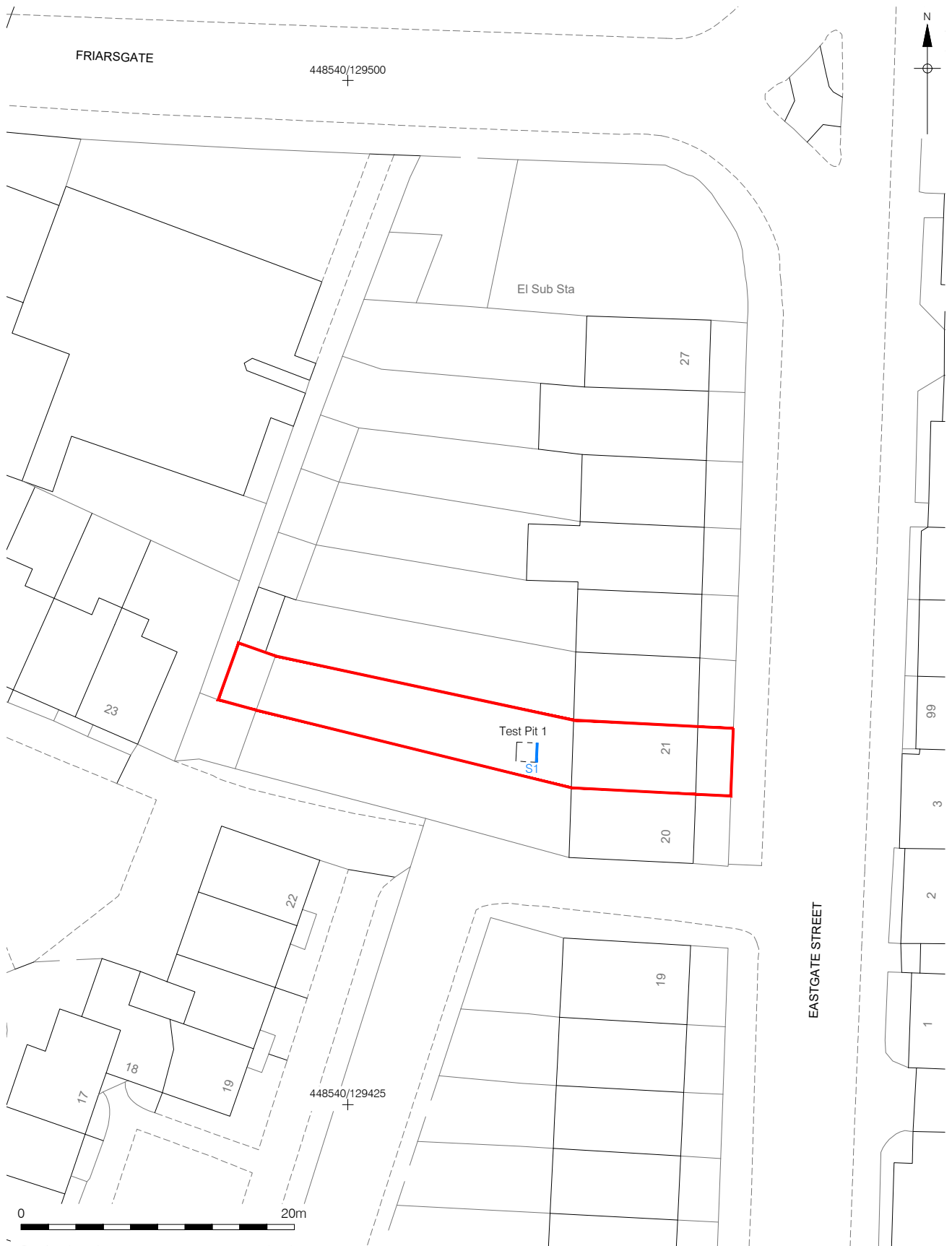

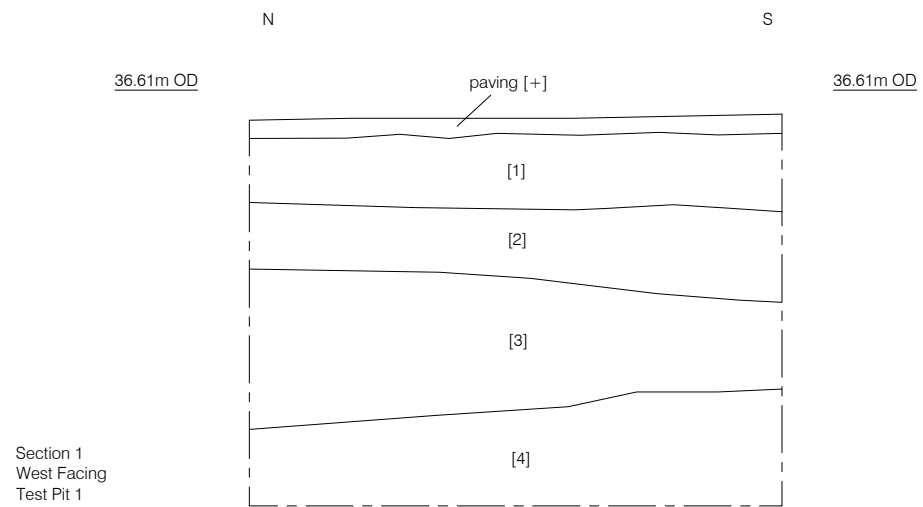

# PCA

## **PCA CAMBRIDGE**

THE GRANARY, RECTORY FARM  
BREWERY ROAD, PAMPISFORD  
CAMBRIDGESHIRE CB22 3EN

t: 01223 845 522

e: [cambridge@pre-construct.com](mailto:cambridge@pre-construct.com)

## **PCA DURHAM**

THE ROPE WORKS, BROADWOOD VIEW  
CHESTER-LE-STREET  
DURHAM DH3 3AF

t: 0191 377 1111

e: [durham@pre-construct.com](mailto:durham@pre-construct.com)

## **PCA LONDON**

UNIT 54, BROCKLEY CROSS BUSINESS CENTRE  
96 ENDWELL ROAD, BROCKLEY  
LONDON SE4 2PD

t: 020 7732 3925

e: [london@pre-construct.com](mailto:london@pre-construct.com)

## **PCA NEWARK**

OFFICE 8, ROEWOOD COURTYARD  
WINKBURN, NEWARK  
NOTTINGHAMSHIRE NG22 8PG

t: 01636 370 410

e: [newark@pre-construct.com](mailto:newark@pre-construct.com)

## **PCA NORWICH**

QUARRY WORKS, DEREHAM ROAD  
HONINGHAM  
NORWICH NR9 5AP

T: 01603 863 108

e: [norwich@pre-construct.com](mailto:norwich@pre-construct.com)

## **PCA WARWICK**

UNIT 9, THE MILL, MILL LANE  
LITTLE SHREWLEY, WARWICK  
WARWICKSHIRE CV35 7HN

t: 01926 485 490

e: [warwick@pre-construct.com](mailto:warwick@pre-construct.com)

## **PCA WINCHESTER**

5 RED DEER COURT, ELM ROAD  
WINCHESTER  
HAMPSHIRE SO22 5LX

t: 01962 857 330

e: [winchester@pre-construct.com](mailto:winchester@pre-construct.com)

