

DOCUMENT VERIFICATION

Chatham Maritime Zones D1 & D2
Chatham
Kent

Archaeological Watching Brief

Quality Control

Pre-Construct Archaeology Limited Project Code			K757
	Name & Title	Signature	Date
Text Prepared by:	Ireneo Grosso		November 2004
Graphics Prepared by:	Adrian Nash		November 2004
Graphics Checked by:	Josephine Brown	<i>J. Brown</i>	November 2004
Project Manager Sign-off:	Jon Butler	<i>J. Butler</i>	November 2004

Revision No.	Date	Checked	Approved

Pre-Construct Archaeology Ltd
Unit 54
Brockley Cross Business Centre
96 Endwell Road
London
SE4 2PD

**AN ARCHAEOLOGICAL WATCHING BRIEF AT CHATHAM MARITIME,
ZONES D1 & D2, CHATHAM, KENT**

Site Code: KCMZ 04

Central National Grid Reference: TQ 772 695

**Written and Researched by Ireneo Grosso
Pre-Construct Archaeology Limited, November 2004**

Project Managers: Jonathan Butler and Tim Bradley

**Commissioning Client: CgMs Consulting on behalf of the Kent
Constabulary**

**Contractor:
Pre-Construct Archaeology Limited
Unit 54 Brockley Cross Business Centre
96 Endwell Road
Brockley
London
SE4 2PD**

Tel: 020 7732 3925

Fax: 020 7732 7896

E-mail: jbutler@pre-construct.com

Web: www.pre-construct.com

**© Pre-Construct Archaeology Limited
November 2004**

© The material contained herein is and remains the sole property of Pre-Construct Archaeology Limited and is not for publication to third parties without prior consent. Whilst every effort has been made to provide detailed and accurate information, Pre-Construct Archaeology Limited cannot be held responsible for errors or inaccuracies herein contained.

CONTENTS

1	Abstract	3
2	Introduction	4
3	Archaeological and Historical Background	7
4	Geography and Topography	8
5	Archaeological Methodology	9
6	Archaeological Sequence	10
7	Conclusion	13
8	Acknowledgements	14

Appendices

Appendix 1	Context Index	15
Appendix 2	Oasis Data Collection Form	16

Illustrations

Figure 1:	Site Location	5
Figure 2:	Trenches Location	6
Figure 3:	Sections 1 to 5	11
Figure 4:	Pile Sections	12

1 ABSTRACT

- 1.1 This report details the results and working methods of an archaeological watching brief undertaken by Pre-Construct Archaeology Limited at Chatham Maritime, Zones D1 & D2, Chatham, Kent. The watching brief was undertaken between the 31st of August and the 22nd of September 2004 and was commissioned by CgMs Consulting.
- 1.2 A sample of the piling and the excavation for the of ground beam locations between the piles were monitored.
- 1.3 Natural chalk covered by alluvial deposits was observed during the monitoring of the piling.
- 1.4 A sequence of modern and late post-medieval deposits was observed across the site but no sensitive archaeological features or deposits were found within the groundbeam trenches.

2 INTRODUCTION

- 2.1 An archaeological watching brief was conducted on the piling and associated ground preparation of Zones D1 & D2 which are situated immediately to the south of the A289 within the Chatham Maritime Development Area (Fig.1). It was conducted between the 31st of September 2004 and the 22nd of October 2004 and was commissioned by Richard Meager of CgMs Consulting on behalf of the Kent Constabulary.
- 2.2 Site D1 is approximately 0.97 hectares in size, and Site D2 is 0.99 hectares in size.
- 2.3 The site was given the code KCMZ 04.
- 2.4 The watching brief was project managed for Pre-Construct Archaeology by Jonathan Butler and Tim Bradley and carried out by the author. The site was monitored by Simon Mason of Kent County Council.

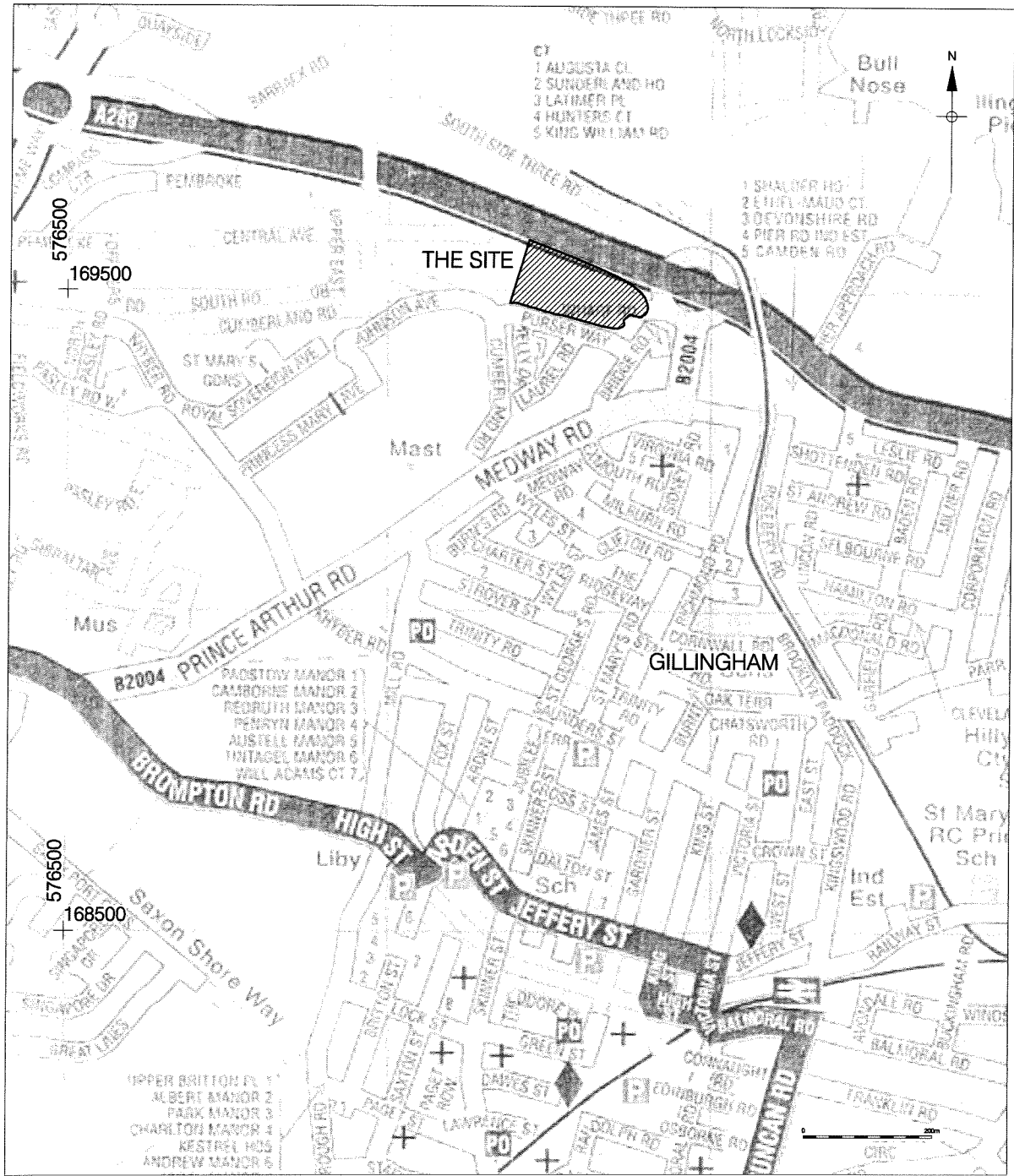

Figure 1
Site Location
1:10,000

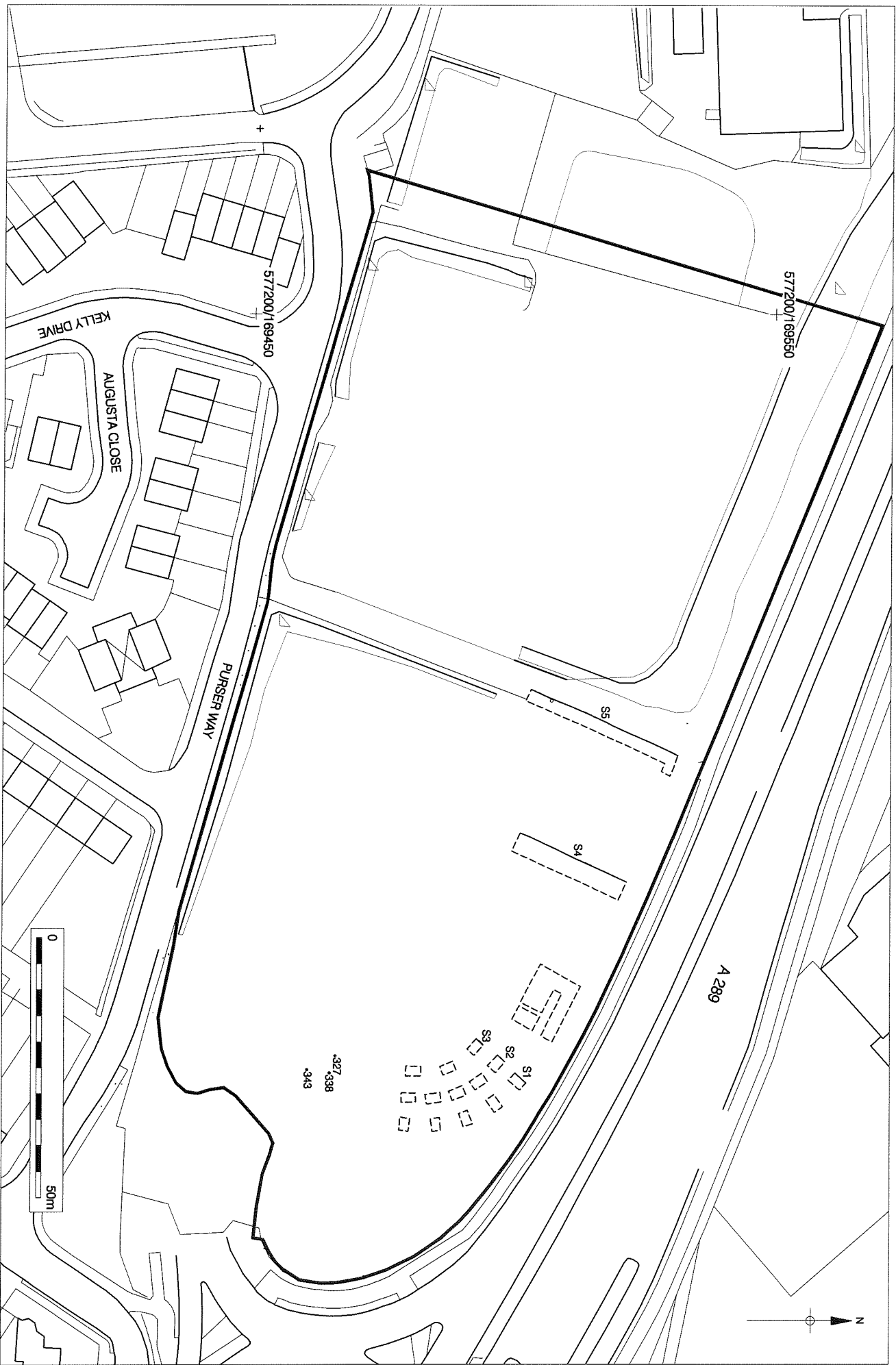

Figure 2
Area of watching brief
1:1000

3 ARCHAEOLOGICAL AND HISTORICAL BACKGROUND

- 3.1 An Archaeological Desk Based Assessment produced by CgMs Consulting¹ gives a detailed archaeological and historical background to the site. The following briefly summarises the salient facts.
- 3.2 Numerous findspots of Lower and Upper Palaeolithic material, including flint tools and weapons and faunal remains are recorded within 1500m of the site. Few findspots of Mesolithic and Neolithic Age are recorded within 1500m of the site. However, the topographical location of the site at the interface of the floodplain and chalk bluffs suggested a good potential for these periods.
- 3.3 During the Bronze Age the area of the site may have lain within a highly developed agrarian and ritual landscape. The Medway floodplain is likely to have been exploited for summer pasture, for wildfowling, fishtrapping and the collection of rushes and sedges. Timber trackways may have given access to the marshes. Numerous Bronze Age weapons have been recovered from dredging the river Medway. Bronze Age campsites were revealed during the construction of the Medway Tunnel eastern approach and numerous finds have been made on the higher ground.
- 3.4 Iron Age activity in the area is attested by the settlement at the Medway Tunnel eastern approach and several high status stray finds from the vicinity.
- 3.5 The nearest Roman settlement was at Rochester and settlement activity was revealed from the first and second century AD at the Medway Tunnel eastern approach. There was a dramatic rise in sea levels in the late second and third centuries AD which led to the flooding of marginal land and the abandoning of settlements near it often until the 12th century.
- 3.6 In the Saxon and medieval periods it is thought that the site lay within open and marsh land.
- 3.7 Areas D1 and D2 became part of the Royal Dockyard complex in the late 19th century. D1 was occupied by a victualling depot and D2 later by stores buildings

¹ Hawkins, D. & Meager, R., August 2003, Archaeological Desk Based Assessment: Land at Chatham Maritime Areas D1 and D2, CgMs Consulting unpublished report.

4 GEOLOGY AND TOPOGRAPHY

- 4.1 The archaeological desk based assessment produced by CgMs Consulting² gives a detailed geological and topographical background to the site. The following briefly summarises the salient facts.
- 4.2 The sites are located at the interface of the Medway floodplain and the chalk bluffs. The northern half of the sites are within the floodplain and the rest within the bluffs.
- 4.3 A Ground Conditions report undertaken in 2002 revealed at D1 0.2m-1.8m of made ground overlying 1.6m-3.85m of alluvial deposits overlying the Thanet Beds varying from 0.95m to 3.3m thick. At D2 0.1m-3.7m of made ground overlay 3.3m-5.3m of alluvial deposits which covered the Thanet Beds which were between 2.2m and 4.0m thick.

² Hawkins, D. & Meager, R., August 2003, Archaeological Desk Based Assessment: Land at Chatham Maritime Areas D1 and D2, CgMs Consulting unpublished report.

5 ARCHAEOLOGICAL METHODOLOGY

- 5.1 After the demolition and removal of the existing building in areas D1 and D2, the excavation of pile locations for obstructions by mechanical excavator was monitored by an archaeologist . The pile probing excavation was deep enough to reach the natural chalk bedrock.
- 5.2 After the piling of areas D1 and D2 the excavation of large areas between the piling to a depth of approximately 2.00 m from ground level was carried out was also monitored in sample areas (Fig.2).
- 5.3 All the archaeological deposits and features were cleaned and excavated by hand, where safety permitted, with notes and sketches being taken from the top of the trench where depth of the excavations precluded entry into the trench. The archaeological deposits were drawn either in plan at 1:20 or in section at 1:10 and recorded on *pro forma* context sheets.

6 ARCHAEOLOGICAL SEQUENCE

6.1 Natural Chalk

- 6.1.1 Natural chalk [09] was observed in three pile locations (Fig.4) at a depth between 4.50m (1.95m OD) and 5.50m (0.86m OD) below ground level.

6.2 Alluvial Deposits

- 6.2.1 This was covered in one pile location P338 by a 1m thick deposit of orange sandy clay [08] at 1.86m OD, which was then sealed by a 4m thick deposit of mid orange brown clayey silt [07] with a top height of 5.95m OD. A similar thickness of this deposit was revealed in the other pile locations. These deposits were interpreted as alluvial in nature.

6.3 Post-Medieval

- 6.3.1 A silty clay alluvial type deposit 1.85m thick [03], with very occasional 19th to 20th century brick fragments and flakes, was observed across the site at various depths (see Figs.3 & 4). This deposit [03] was the same as that observed in the piling but was observed to be mixed with post-medieval material on closer inspection. It was overlaid by a 0.20 m thick 20th century red brick made ground [04] and 0.20 m thick tarmac [05] both located to north and east of the site. Overlying made ground [04] was observed a 0.25 m thick modern concrete slab [02] located to the north east of the site. Overlying the modern concrete [02] was the modern made ground [01] which covered the whole of area D1 and D2.

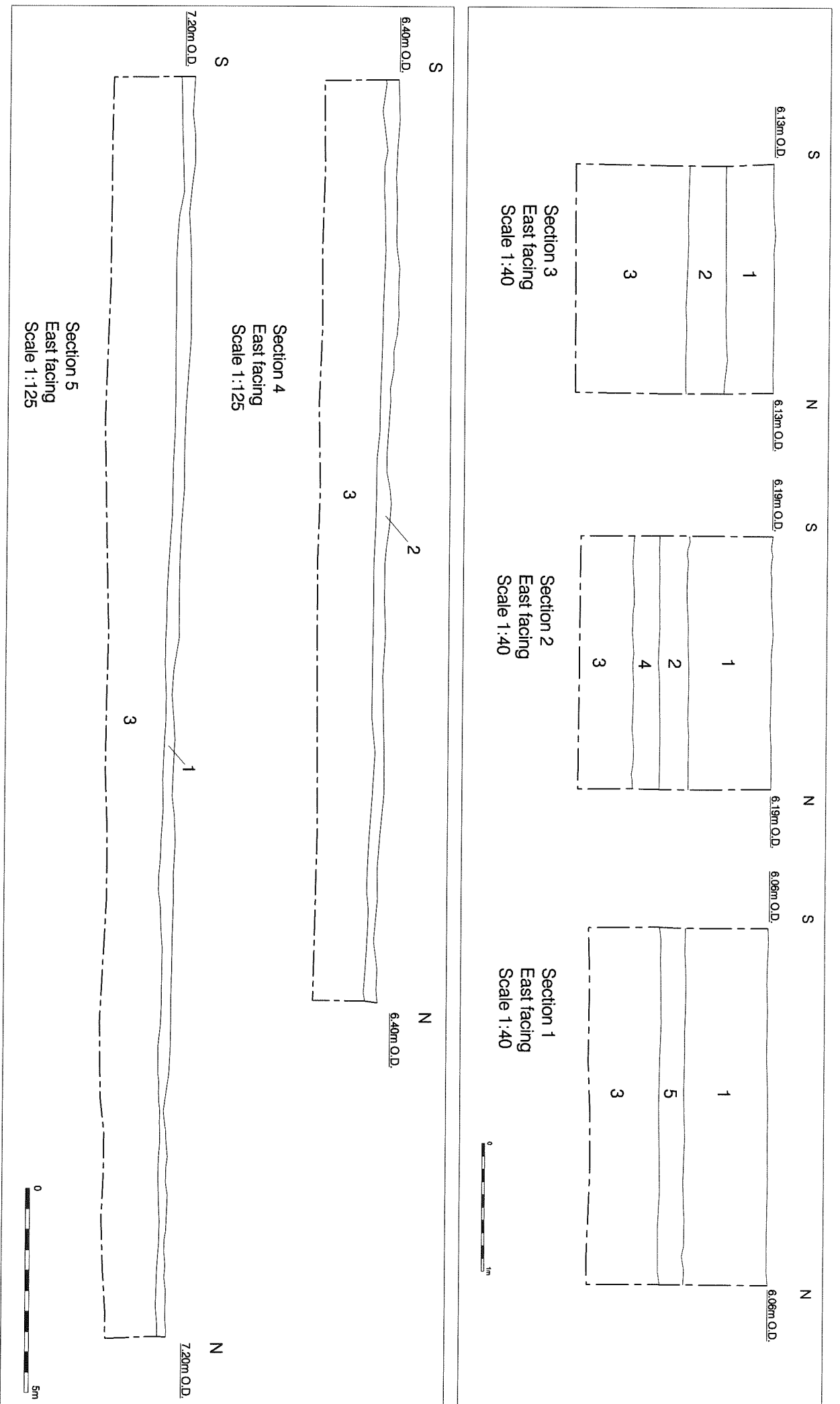

Figure 3
Sections 1-5

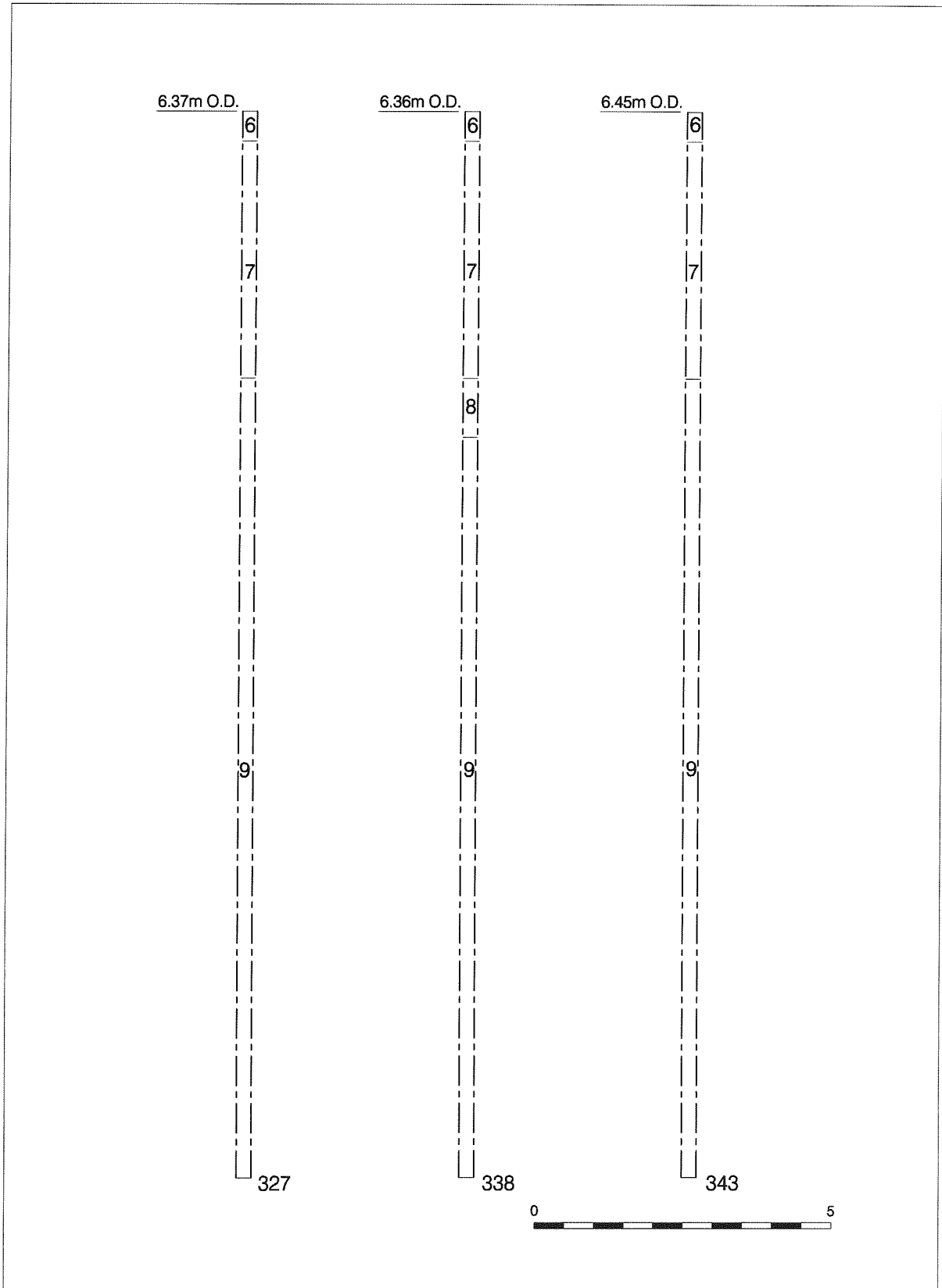

Figure 4
Boreholes 327, 338 and 343
1:100

7 CONCLUSION

- 7.1 Natural chalk covered by up to 5m of alluvial deposits was observed during the monitoring of the piling.

- 7.2 The watching brief conducted on the excavation of trenches for groundbeams between the piles revealed a sequence of late 19th to 20th century deposits and made ground. No sensitive features or archaeological deposits were observed during the watching brief as the excavation for groundbeams did not penetrate through the late post-medieval alluvial and made ground.

8 ACKNOWLEDGEMENTS

- 8.1 Pre Construct Archaeology would like to thank Richard Meager of CgMs Consulting for commissioning the work on behalf of Kent Constabulary and Simon Mason of Kent County Council for monitoring the work

- 8.2 The author would like to thank Jonathan Butler and Tim Bradley for project managing the watching brief and editing the present report, and Adrian Nash for the illustrations.

APPENDIX 1: CONTEXT INDEX

Context	Type	Description
1	Layer	Modern made ground
2	Masonry	Modern concrete
3	Layer	Mixed Alluvial deposit
4	Layer	Made ground for concrete [02]
5	Layer	Modern tarmac
6	Layer	Made ground
7	Layer	Alluvial clay
8	Layer	Alluvial clay
9	Layer	Natural chalk

APPENDIX 2

Oasis Data Collection Form

1.4 OASIS ID: preconst1-4507

Project details

Project name Chatham Maritime, Zones D1 and D2

Short description of the project An archaeological watching brief was conducted by Pre Construct Archaeology on the piling and associated ground preparation of zones D1 and D2 situated immediately to the south of the A289 within the Chatham Maritime Development Area. It was conducted between the 31/08/2004 and 22/09/2004. The watching brief revealed a sequence of late 19th to 20th century deposit and made ground. No sensitive feature or archaeological deposit were observed during the watching brief.

Project dates Start: 31-08-2004 End: 22-09-2004

Previous/future work No / Not known

Any associated project reference codes kcmz04 - Sitecode

Type of project Recording project

Site status None

Current Land use Vacant Land 1 - Vacant land previously developed

Investigation type 'Watching Brief'

Prompt Direction from Local Planning Authority - PPG16

Project location

Country England

Site location KENT MEDWAY CHATHAM Chatham Maritime Zones D1 and D2, Chatham, Kent

Study area 1.96 Hectares

National grid reference TQ 772 695 Point

Project creators

Name of Organisation Pre-Construct Archaeology Ltd

Project brief originator Consultant

Project design originator Jon Butler

Project director/manager Jon Butler

Project supervisor Ireneo Grosso

Sponsor or funding body Kent Constabulary

Project archives

Physical Archive recipient Local museum

Physical Archive Exists? Yes

Digital Archive recipient Local museum

Digital Contents 'Stratigraphic'

Digital Media available 'Database', 'Spreadsheets', 'Text'

Digital Archive Exists? Yes

Paper Archive recipient Local Museum

Paper Contents 'Stratigraphic'

Paper Media available 'Context sheet', 'Correspondence', 'Drawing', 'Matrices', 'Plan', 'Report', 'Section', 'Unpublished Text'

Paper Archive
Exists? Yes

Project
bibliography 1

Publication type An unpublished document/manuscript

Title An archaeological watching brief at Chatham Maritime, Zones D1 and D2.
Chatham, Kent

Author(s)/Editor(s) Grosso, I.

Date 2004

Issuer or
publisher Pre Construct Archaeology Ltd

Place of issue or
publication Brockley

Entered by Tiziana Vitali (archive@pre-construct.com)

Entered on 27 October 2004