

**LAND AT THE HARROW, SLADE
GREEN, LONDON BOROUGH OF
BEXLEY DA8 2BS**

**AN ARCHAEOLOGICAL WATCHING
BRIEF**

**PLANNING APPLICATION NUMBER:
09/01697/OUTM**

**LOCAL PLANNING AUTHORITY:
LONDON BOROUGH OF BEXLEY**

OCTOBER 2010

PRE-CONSTRUCT ARCHAEOLOGY



DOCUMENT VERIFICATION

**LAND AT THE HARROW, SLADE GREEN,
LONDON BOROUGH OF BEXLEY DA8 2BS**

AN ARCHAEOLOGICAL WATCHING BRIEF

Quality Control

Pre-Construct Archaeology Limited			K2368
	Name & Title	Signature	Date
Text Prepared by:	Guy Seddon		October 2010
Graphics Prepared by:	Jennifer Simonson		October 2010
Graphics Checked by:	Josephine Brown		October 2010
Project Manager Sign-off:	Chris Mayo		October 2010

Revision No.	Date	Checked	Approved

Pre-Construct Archaeology Ltd
Unit 54
Brockley Cross Business Centre
96 Endwell Road
London
SE4 2PD

Land at The Harrow, Slade Green, London Borough of Bexley DA8 2BS
An Archaeological Watching Brief

Planning Application Number: 09/01697/OUTM
Local Planning Authority: London Borough of Bexley

Site Code: NND10
Central National Grid Reference: TQ51637655

Commissioning Client: CgMs Consulting

Written by: Guy Seddon, Pre-Construct Archaeology Limited
October 2010

Project Manager: Chris Mayo

Contractor: Pre-Construct Archaeology Limited
Unit 54, Brockley Cross Business Centre
96 Endwell Road
Brockley
London SE4 2PD

Tel: 020 7732 3925
Fax: 020 7732 7896
E-mail: cmayo@pre-construct.com
Web: www.pre-construct.com

© Pre-Construct Archaeology Limited

October 2010

© The material contained herein is and remains the sole property of Pre-Construct Archaeology Limited and is not for publication to third parties without prior consent. Whilst every effort has been made to provide detailed and accurate information, Pre-Construct Archaeology Limited cannot be held responsible for errors or inaccuracies herein contained.

CONTENTS

1	Abstract	3
2	Introduction.....	4
3	Planning Background	7
4	Geology and Topography.....	10
5	Archaeological and Historical Background.....	10
6	Methodology.....	11
7	Archaeological Sequence.....	12
8	Conclusions	14
9	Acknowledgements	15
10	Bibliography.....	15

APPENDICES

11	Appendix 1: Context Index	16
12	Appendix 2: Site Matrix	17
13	Appendix 3: OASIS Form	18

ILLUSTRATIONS

Figure 1: Site Location	5
Figure 2: Trench Location	6
Figure 3: Sections	13

1 ABSTRACT

- 1.1 This report details the working methods and results of an archaeological watching brief conducted during groundworks associated with a development on land at The Harrow, Slade Green, London Borough of Bexley DA8 2BS (Figure 1). The watching brief, commissioned by CgMs Consulting on behalf of P. J. Mullan & Sons Ltd, was undertaken by Pre-Construct Archaeology Ltd. between the 4th and 11th of October 2010.
- 1.2 The work was required by a condition attached to outline planning permission (application number 09/01697/OUTM) for the development.
- 1.3 The earliest deposit encountered during the excavation was natural Crayford Silt, (Brickearth), which was overlain by a subsoil deposit dating to the early 20th century. This had been truncated in a localised area by a cellar for The Harrow pub which previously stood on the site. The site was sealed by a layer of modern made ground. No finds or features of archaeological significance were observed.

2 INTRODUCTION

- 2.1 This report details the results and working methods of an archaeological watching brief undertaken by Pre-Construct Archaeology Ltd on land at The Harrow, Slade Green, London Borough of Bexley DA8 2BS (Figure 1).
- 2.2 The fieldwork was undertaken between the 4th and 11th of October 2010, and was commissioned by CgMs Consulting on behalf of P. J. Mullan & Sons Ltd.
- 2.3 The archaeological works were in response to a planning condition attached to outline planning permission (application number 09/01697/OUTM) for the development.
- 2.4 CgMs Consulting had previously undertaken an Archaeological Impact Assessment for the site (Darton 2009) which researched the sites archaeological potential. This was followed by a Specification (Darton 2010), approved by the Local Planning Authority, which detailed the methodology for this recording work by Pre-Construct Archaeology Ltd.
- 2.5 The archaeological work consisted of the monitoring and recording of foundation trenches excavated for new residential units across the western half of the site (Figure 2).
- 2.6 The site is centred at National Grid Reference is TQ51637655. It is c. 0.28 hectares in extent and is bounded to the north and east by houses and their gardens, to the south by a car park, and to the west by Northend Road.
- 2.7 The site was given the unique Museum of London site code NND 10.
- 2.8 The earliest deposit encountered during the excavation was natural Crayford Silt, (Brickearth), which was overlain by a subsoil deposit dating to the early 20th century. This had been truncated in a localised area by a cellar for The Harrow pub which previously stood on the site. The site was sealed by a layer of modern made ground. No finds or features of archaeological significance were observed.

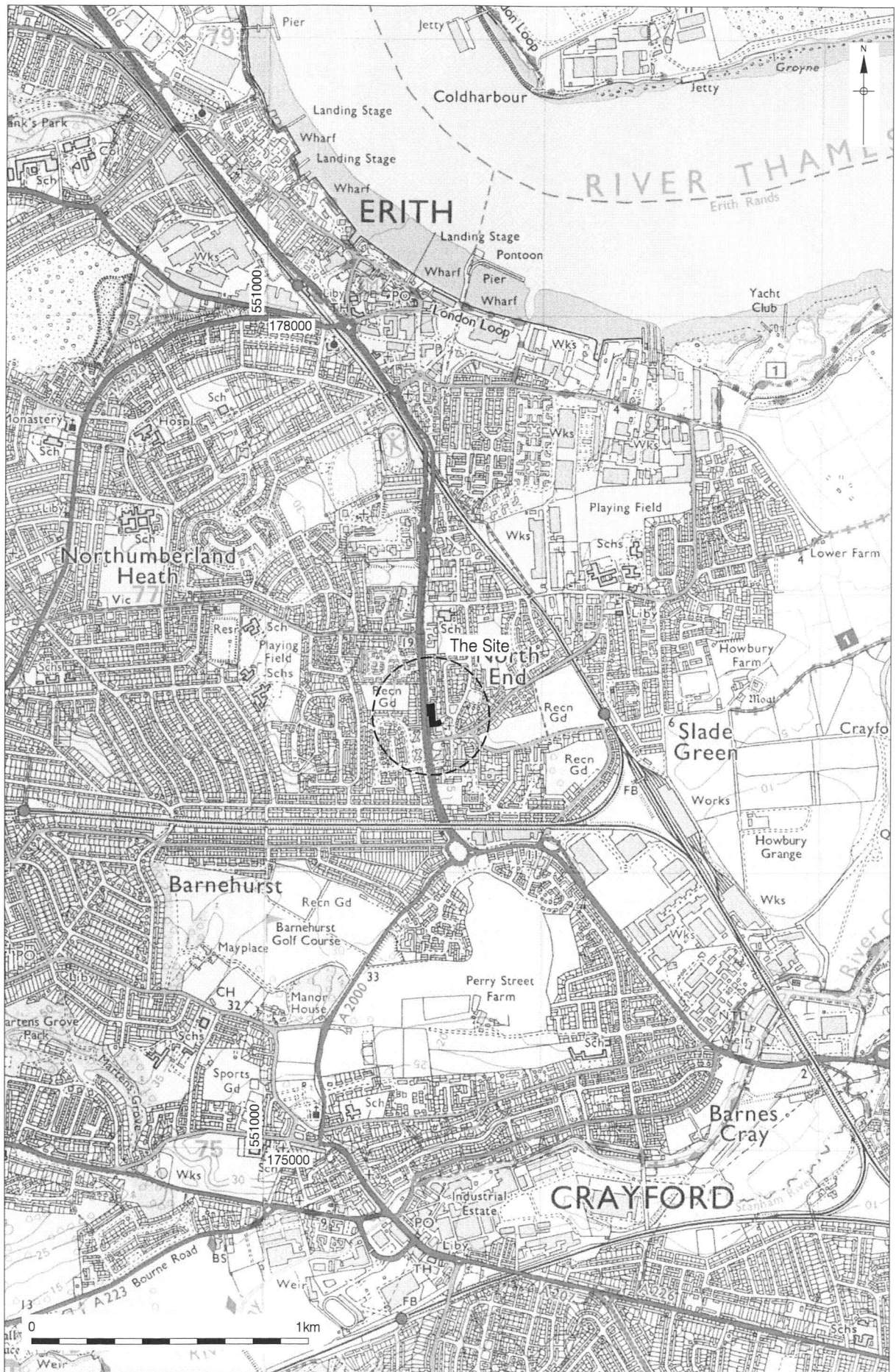

© Crown copyright 2006. All rights reserved. License number 36110309
 © Pre-Construct Archaeology Ltd 2010

Figure 1
 Site Location
 1:20,000 at A4

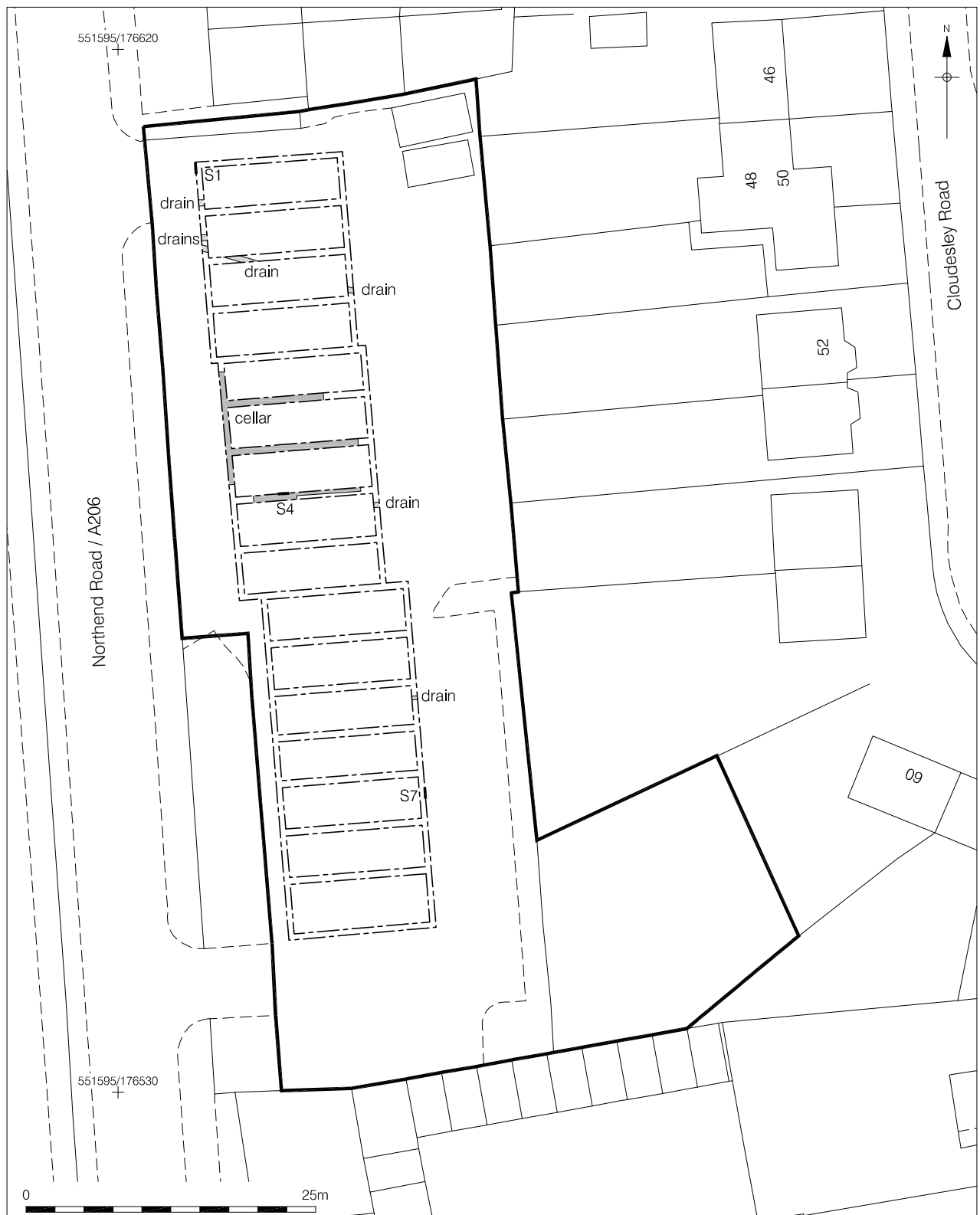

© Crown copyright 2010. All rights reserved. License number PMP36110309
 © Pre-Construct Archaeology Ltd 2010

Figure 2
 Trench Location
 1:500 at A4

3 PLANNING BACKGROUND

3.1 National Policy: Planning Policy Statement (PPS5)

- 3.1.1 In March 2010 the Department for Communities and Local Government issued Planning Policy Statement 5: Planning for the Historic Environment (PPS5), which provides guidance for planning authorities, property owners, developers and others on the investigation and preservation of
- 3.1.2 In considering any planning application for development, the local planning authority will be guided by the policy framework set by government guidance, in this instance PPS5, by current Local Plan policy and by other material considerations.
- 3.1.3 PPS5 replaced Planning Policy Guidance 16, under which the archaeological condition attached to the planning permission was issued.

3.2 Regional Policy

- 3.2.1 The Strategic Development Plan Strategy for Greater London (February 2008) includes the following policies relating to archaeology:

POLICY 4B.15 ARCHAEOLOGY

THE MAYOR, IN PARTNERSHIP WITH ENGLISH HERITAGE, THE MUSEUM OF LONDON AND BOROUGHs, WILL SUPPORT THE IDENTIFICATION, PROTECTION, INTERPRETATION AND PRESENTATION OF LONDON'S ARCHAEOLOGICAL RESOURCES. BOROUGHs IN CONSULTATION WITH ENGLISH HERITAGE AND OTHER RELEVANT STATUTORY ORGANISATIONS SHOULD INCLUDE APPROPRIATE POLICIES IN THEIR DPDS FOR PROTECTING SCHEDULED ANCIENT MONUMENTS AND ARCHAEOLOGICAL ASSETS WITHIN THEIR AREA.

POLICY 4B.12 HERITAGE CONSERVATION

BOROUGHs SHOULD:

- ENSURE THAT THE PROTECTION AND ENHANCEMENT OF HISTORIC ASSETS IN LONDON ARE BASED ON AN UNDERSTANDING OF THEIR SPECIAL CHARACTER, AND FORM PART OF THE WIDER DESIGN AND URBAN IMPROVEMENT AGENDA, INCLUDING THEIR RELATIONSHIP TO ADJOINING AREAS, AND THAT POLICIES RECOGNISE THE MULTI-CULTURAL NATURE OF HERITAGE ISSUES
- IDENTIFY AREAS, SPACES, HISTORIC PARKS AND GARDENS, AND BUILDINGS OF SPECIAL QUALITY OR CHARACTER AND ADOPT POLICIES FOR THEIR PROTECTION AND THE IDENTIFICATION OF OPPORTUNITIES FOR THEIR ENHANCEMENT, TAKING INTO ACCOUNT THE STRATEGIC LONDON

CONTEXT

- ENCOURAGE AND FACILITATE INCLUSIVE SOLUTIONS TO PROVIDING ACCESS FOR ALL, TO AND WITHIN THE HISTORIC ENVIRONMENT AND THE TIDAL FORESHORE.

POLICY 4B.13 HISTORIC CONSERVATION-LED REGENERATION

THE MAYOR WILL, AND BOROUGHs SHOULD, SUPPORT SCHEMES THAT MAKE USE OF HISTORIC ASSETS, INCLUDING THE WATERWAYS HERITAGE, AND STIMULATE ENVIRONMENTAL, ECONOMIC AND COMMUNITY REGENERATION WHERE THEY:

- BRING REDUNDANT OR UNDER-USED BUILDINGS AND SPACES INTO APPROPRIATE USE
- SECURE THE REPAIR AND RE-USE OF BUILDINGS AT RISK

- HELP TO IMPROVE LOCAL ECONOMIES AND COMMUNITY COHESION
- FIT IN WITH WIDER REGENERATION OBJECTIVES
- PROMOTE INCLUSIVENESS IN THEIR DESIGN
- RESPECT AND ENHANCE WATERSIDE HERITAGE INCLUDING THE TIDAL FORESHORE.

POLICY 4B.14 WORLD HERITAGE SITES

THE MAYOR WILL WORK WITH THE RELEVANT BOROUGHs, ENGLISH HERITAGE AND SITE OWNERS AND OCCUPIERS TO AGREE AND TO IMPLEMENT MANAGEMENT PLANS FOR LONDON'S WORLD HERITAGE SITES. DPDS AND MANAGEMENT PLANS SHOULD CONTAIN POLICIES THAT PROTECT THEIR HISTORIC SIGNIFICANCE AND SAFEGUARD, AND WHERE APPROPRIATE ENHANCE THEIR SETTINGS. IN CONSIDERING PLANNING APPLICATIONS THE MAYOR WILL, AND BOROUGHs SHOULD, TAKE ACCOUNT OF, AND GIVE APPROPRIATE WEIGHT TO, THE PROVISIONS OF THE WORLD HERITAGE SITE MANAGEMENT PLANS.

3.3 Local Policy

- 3.3.1 The London Borough of Bexley Unitary Development Plan, was adopted in April 2004 and the Districts Saved policies relating to archaeology state:

POLICY ENV56

IN AREAS OF ARCHÆOLOGICAL SEARCH AND OTHER AREAS WHERE FINDS ARE LIKELY TO OCCUR AND IN CERTAIN HISTORIC STANDING BUILDINGS WHERE DEVELOPMENT PROPOSALS MAY AFFECT ARCHÆOLOGICAL REMAINS OR HISTORICAL EVIDENCE, THE COUNCIL WILL EXPECT APPLICANTS TO HAVE PROPERLY ASSESSED AND PLANNED FOR THE ARCHÆOLOGICAL IMPLICATIONS. THE COUNCIL MAY REQUIRE A PRELIMINARY ARCHÆOLOGICAL SITE EVALUATION BEFORE PROPOSALS ARE CONSIDERED.

POLICY ENV57

WHERE SITES OF ARCHÆOLOGICAL SIGNIFICANCE OR POTENTIAL ARE DISCOVERED THE COUNCIL WILL SEEK TO ENSURE THAT:

1. THE MOST IMPORTANT ARCHÆOLOGICAL REMAINS AND THEIR SETTINGS ARE PRESERVED IN SITU (IF APPROPRIATE FOR PUBLIC ACCESS AND DISPLAY) AND THAT WHERE APPROPRIATE THEY ARE GIVEN STATUTORY PROTECTION; AND
2. SITES NOT REQUIRING PRESERVATION IN SITU SHALL BE MADE AVAILABLE FOR AN APPROPRIATE LEVEL OF ARCHÆOLOGICAL INVESTIGATION AND EXCAVATION BY A RECOGNISED ARCHÆOLOGICAL ORGANISATION BEFORE DEVELOPMENT BEGINS.

POLICY ENV58

THERE WILL BE A PRESUMPTION AGAINST ANY DEVELOPMENT, WHICH WOULD ADVERSELY AFFECT ANY SCHEDULED ANCIENT MONUMENT OR OTHER NATIONALLY IMPORTANT ARCHÆOLOGICAL SITES AND MONUMENTS AND THEIR SETTINGS.

- 3.3.2 The site does not lie within a conservation area nor do any Scheduled Ancient Monuments lie on the site, as shown on the proposals map. However, the study site lies within land marked as an Area of Archaeological Search, as shown on the proposals map (Darton 2009).

3.4 Planning Permission

- 3.4.1 Outline planning consent was granted (09/01697/OUTM), subject to the completion of a programme of archaeological work. Bexley Council attached the following planning condition (no 20) to the planning consent:

No development shall take place within the site until the applicant has secured the implementation of a programme of archaeological work in accordance with a written scheme of investigation which has been submitted by the applicant and approved in writing by the Local Planning Authority.

4 GEOLOGY AND TOPOGRAPHY

4.1 Geology

- 4.1.1 The solid geology is Upper Chalk, as shown by British Geological Survey (England and Wales Sheet 271, Dartford, 1998).
- 4.1.2 The drift geology of the site is Crayford Silt, (Brickearth) overlying Taplow Terrace Gravels, as shown by the British Geological Survey map.

4.2 Topography

- 4.2.1 The study site is situated on the top of a leveled terrace, covering c. 2800m². It is bounded to the north and east by houses and their gardens, to the south by a car park and to the west by Northend Rd (Darton 2009).
- 4.2.2 The natural topography of the site formed a gradual slope, sloping from a height of c.17.30m AOD in the north-west on the Northend Road down to the c. 16.90m AOD south-eastern corner (Darton 2009).
- 4.2.3 The site lies c.1.5km south of the River Thames and 1.75km west of the River Darent (Darton 2009).

5 ARCHAEOLOGICAL AND HISTORICAL BACKGROUND

- 5.1 The archaeological and historical background of the site is studied in the Archaeological Impact Assessment (Darton 2009), from which the following summary is drawn.
- 5.2 There are several find-spots of early Prehistoric within 750m radius of the site, as extensive brick pits were dug in the 19th century revealing Palaeolithic flint implements and Pleistocene animal remains.
- 5.3 Evidence for a possible Roman cemetery was uncovered in brick extraction pits in Slade Green.
- 5.4 During the Post-medieval period the site lay within fields south of Northend, until The Harrow public house was constructed on the study site in the late 19th century.

6 METHODOLOGY

- 6.1 All work was undertaken in accordance with an approved Specification (Darton 2010). The monitoring was undertaken between the 4th and 11th of October 2010.
- 6.2 An attendant archaeologist from Pre-Construct Archaeology Ltd supervised and monitored the excavation of all footings, which were excavated using a 360° mechanical excavator fitted with a toothless grading bucket (Figure 2). Earth was removed in spits of no more than 200mm.
- 6.3 Exposed sections were archaeologically cleaned and sample sections were drawn at a scale of 1:10. Trench locations were recorded on variably scaled site plans. All written data was entered on proforma sheets following standard 'single-context' recording methods, and a photographic record using digital and film format photography was made as appropriate.
- 6.4 Relevant plans and sections were drawn and context descriptions recorded on pro-forma sheets.
- 6.5 Levels for the site work were calculated from approximate spot heights for the site given in the Archaeological Impact Assessment and contractors plans.

7 ARCHAEOLOGICAL SEQUENCE

7.1 Phase 1: Natural

7.1.1 The earliest deposit observed on site was firmly compacted, light yellowish brown Crayford Silts [2], with a thickness of at least 0.6m, which was present across the entire site at a level of approximately 16m OD (Figure 3).

7.2 Phase 2: 19th- 20th Century

7.3 Overlying the Crayford Silts was a firmly compacted, light-mid brown subsoil [1] which contained occasional-moderate amounts of small sub-rounded and sub-angular stones. It was recorded at a level of c.16.50m OD (Figure 3).

7.4 In the northern centre of the site was a large localised truncation, measuring at least 11.50m N-S by 11m E-W and with a depth of 1.50m from the ground surface (Figure 2). It is considered that this truncation was backfilled cellar to the previous public house which stood on the site.

7.5 Sealing the site was a deposit of made ground. The layer was a dark brown, re-worked sandy silt with moderate to frequent amounts of small sub-rounded and sub-angular stones. It also contained occasional sherds of pottery and fragments of ceramic building material. The pottery recovered dated from the late 19th-early 20th Century (pers comm Chris Jarrett) and probably relates to the use of the site as a pub.

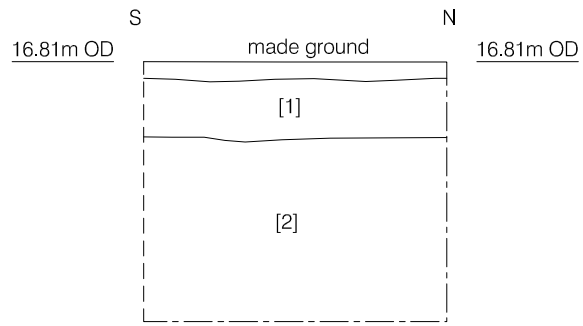

Section 1
East Facing

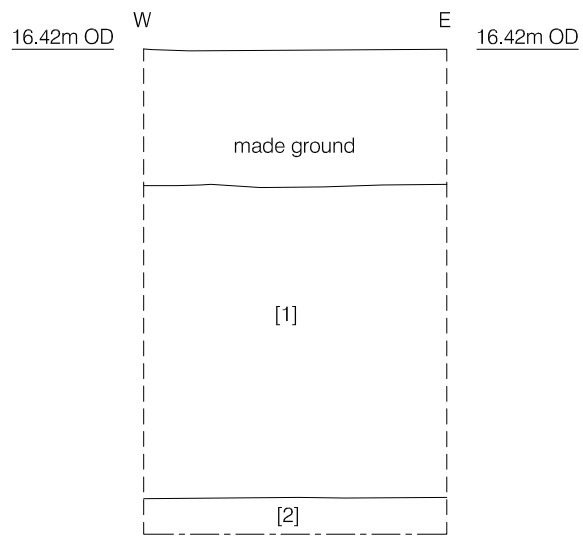

Section 4
South Facing

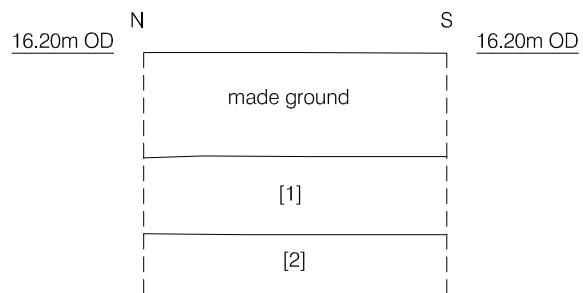

Section 7
West Facing



Figure 3
Sections
1:25 at A4

8 CONCLUSIONS

- 8.1 There was no evidence at the site of occupation or land use before the late 1800s. Since then the land has been in use as the site of The Harrow public house.
- 8.2 Although there is cartographic evidence for greenhouses on the site in the late 1800s no evidence was found of these, indicating that they were probably unfounded lightweight structures only.
- 8.3 The site was heavily truncated in a localised area by the cellar. Otherwise the presence of intact subsoil suggests that the site had escaped widespread historic impact. the absence of any archaeological features or finds implies that the site had been undeveloped and unutilised prior to the 19th century.
- 8.4 Pre-Construct Archaeology Ltd consider that the site investigation has fully recorded the invasive excavations at the site within the remit of best-practice, statutory guidelines and the Specification (Darton 2010).
- 8.5 No further work is considered necessary for the site. The archive will be deposited with the London Archaeological Archive and Research Centre under the site code NND10. Pre-Construct Archaeology Ltd will prepare a summary of the fieldwork for inclusion in the London Archaeologist Fieldwork Round-Up.

9 ACKNOWLEDGEMENTS

- 9.1 Pre-Construct Archaeology Limited would like to thank Lorraine Darton and Duncan Hawkins of CgMs Consulting for commissioning the work, and Mark Stevenson of GLAAS, English Heritage, for monitoring it.
- 9.2 The author would like to thank Chris Jarrett for commenting on the finds, Jenny Simonson for the illustrations and Chris Mayo for project management and editing.

10 BIBLIOGRAPHY

- Darton, L. 2009 'Archaeological Impact Assessment: The Harrow, Northend Road, Slade Green, London Borough Of Bexley' CgMs Consulting Unpublished Report.
- Darton, L. 2010 'An Archaeological Monitoring Exercise: The Harrow, Slade Green, London Borough Of Bexley', CgMs Consulting Unpublished Report.

11 APPENDIX 1: CONTEXT INDEX

Site Code	Context No.	Trench	Plan	Section / Elevation	Type	Description	Date	Phase
NND 10	1	*	*	1-7	Layer	Subsoil	20thC	2
NND 10	2	*	*	1-7	Layer	Natural Deposits	Natural	1

12 APPENDIX 2: SITE MATRIX

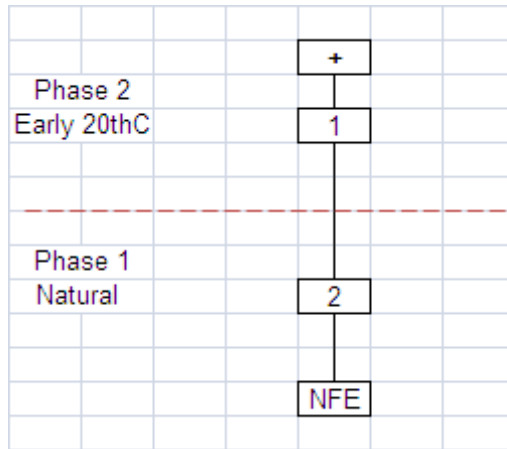

13 APPENDIX 3: OASIS FORM

OASIS ID: preconst1-84335

Project details

Project name	The Harrow, Slade Green, London Borough of Bexley
Short description of the project	An archaeological watching brief was conducted during groundworks associated with a development on land at The Harrow, Slade Green, London Borough of Bexley DA8 2BS. The watching brief, commissioned by CgMs Consulting on behalf of P. J. Mullan and Sons Ltd, was undertaken by Pre-Construct Archaeology Ltd. between the 4th and 11th of October 2010. The work was required by a condition attached to outline planning permission (application number 09/01697/OUTM) for the development. The earliest deposit encountered during the excavation was natural Crayford Silt, (Brickearth), which was overlain by a subsoil deposit dating to the early 20th century. This had been truncated in a localised area by a cellar for The Harrow pub which previously stood on the site. The site was sealed by a layer of modern made ground. No finds or features of archaeological significance were observed.
Project dates	Start: 04-10-2010 End: 11-10-2010
Previous/future work	No / No
Any associated project reference codes	NND10 - Sitecode
Type of project	Recording project
Site status	Local Authority Designated Archaeological Area
Current Land use	Vacant Land 1 - Vacant land previously developed
Monument type	NONE None
Significant Finds	POTTERY Modern
Investigation type	'Watching Brief'
Prompt	Planning condition

Project location

Country	England
Site location	GREATER LONDON BEXLEY BEXLEY The Harrow, Slade Green
Postcode	DA8 2BS
Study area	2800.00 Square metres
Site coordinates	TQ 5163 7655 51.4670617226 0.183225651076 51 28 01 N 000 10 59 E Point
Height OD / Depth	Min: 15.90m Max: 16.56m

Project creators

Name of Organisation	Pre-Construct Archaeology Ltd
Project brief originator	Local Planning Authority (with/without advice from County/District Archaeologist)
Project design originator	CgMs Consulting
Project director/manager	Chris Mayo
Project supervisor	Guy Seddon

Type of sponsor/funding body	Consultancy
Name of sponsor/funding body	CgMs Consulting

Project archives

Physical Archive Exists?	No
Physical Archive recipient	LAARC
Physical Contents	'Ceramics'
Digital Archive recipient	LAARC
Digital Contents	'Stratigraphic'
Digital Media available	'Database','Survey','Text','Images raster / digital photography'
Paper Archive recipient	LAARC
Paper Contents	'Stratigraphic','Survey'
Paper Media available	'Context sheet','Diary','Map','Miscellaneous Material','Plan','Report','Section','Survey','Unpublished Text'

Project bibliography 1

Publication type	Grey literature (unpublished document/manuscript)
Title	Land at The Harrow, Slade Green, London Borough of Bexley: An Archaeological Watching Brief
Author(s)/Editor(s)	Seddon, G
Date	2010
Issuer or publisher	Pre-Construct Archaeology Ltd
Place of issue or publication	London
Description	A4 document

Entered by	Chris Mayo (cmayo@pre-construct.com)
Entered on	4 November 2010

P C A

PRE-CONSTRUCT ARCHAEOLOGY LIMITED

UNIT 54

BROCKLEY CROSS BUSINESS CENTRE

96 ENDWELL ROAD

BROCKLEY

LONDON SE4 2PD

TEL: 020 7732 3925 020 7639 9091

FAX: 020 7639 9588

EMAIL: info@pre-construct.com

PRE-CONSTRUCT ARCHAEOLOGY LIMITED (NORTHERN OFFICE)

UNIT 19A

TURSDALE BUSINESS PARK

DURHAM DH6 5PG

TEL: 0191 377 1111

FAX: 0191 377 0101

EMAIL: info.north@pre-construct.com

