

NP Archaeology Ltd
2012

PROJECT: Low Levens Farm, Kendal
 SCALE: 1:50 000 at A4
 REPORT No: CP10159
 CLIENT: Cumbria County Council
 DRAWN BY: FW
 DATE: March 2012
 FIGURE: 1

KEY:

 Site Location



Reproduced by permission of Ordnance Survey on behalf of The Controller of Her Majesty Stationery Office. © Crown copyright. All rights reserved. Licence number 10001

Figure 1: Site Location

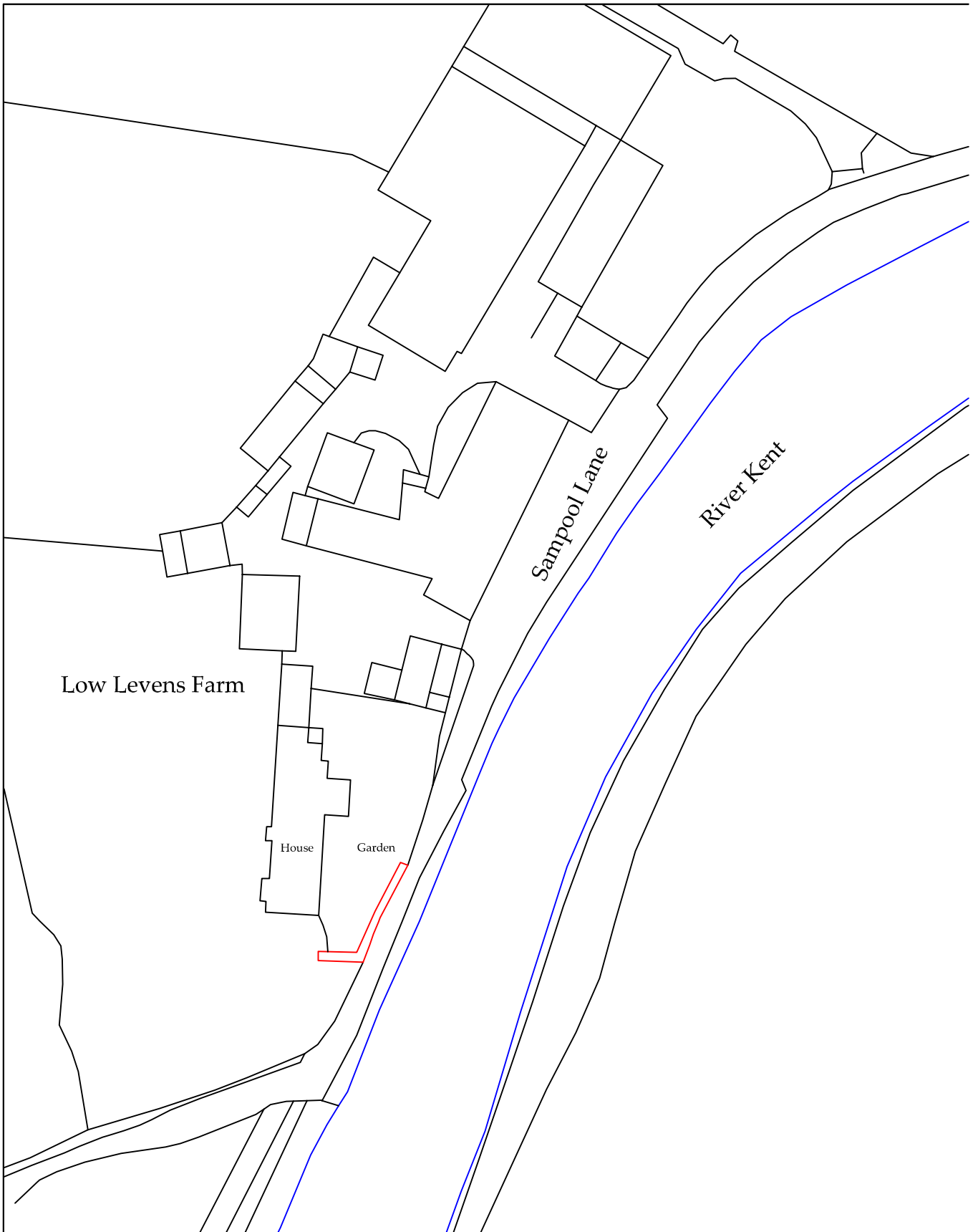

NP Archaeology Ltd
2012

PROJECT: Low Levens Farm, Kendal
 SCALE: 1:1000 at A4
 REPORT No: CP10159
 CLIENT: Cumbria County Council
 DRAWN BY: FW
 DATE: March 2012
 FIGURE: 2

KEY:



Medieval Wall



Reproduced by permission of Ordnance Survey on behalf of The Controller of Her Majesty Stationery Office. © Crown copyright. All rights reserved. Licence number 10001

Figure 2: Location of Medieval Wall





	<p>PROJECT: Low Levens Farm, Kendal</p> <p>SCALE: Not to Scale</p> <p>REPORT No: CP10159</p> <p>CLIENT: Cumbria County Council</p> <p>DRAWN BY: FW</p> <p>DATE: March 2012</p> <p>FIGURE: 3</p>	<p>KEY:</p> <p> Location of Low Levens Farm</p>	
---	---	--	---

Figure 3: Extract from Jefferys Map of Westmorland 1770



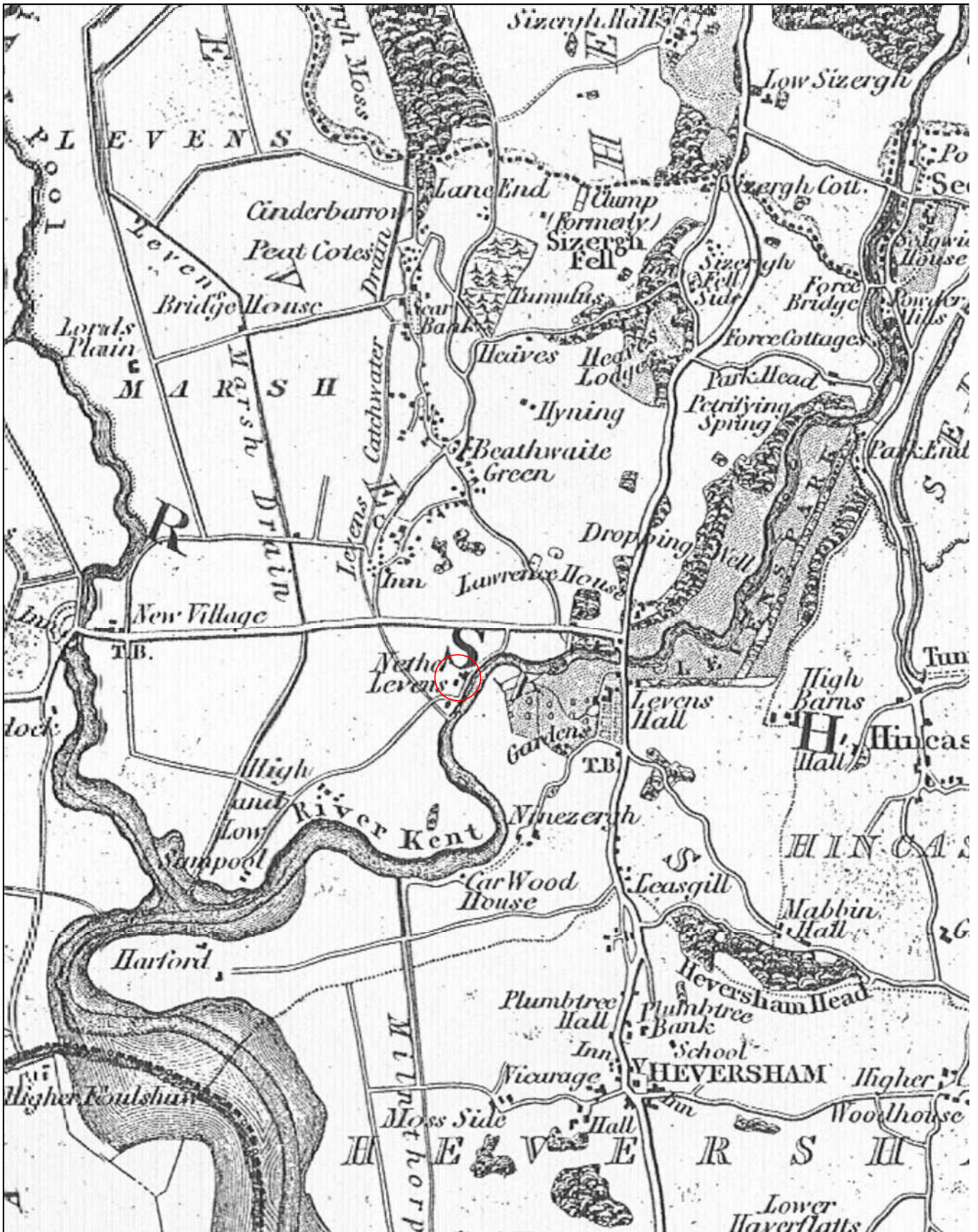

 <p>NP Archaeology Ltd 2012</p>	PROJECT:	Low Levens Farm, Kendal	KEY:	 Location of Low Levens Farm 
	SCALE:	Not to Scale		
	REPORT No:	CP10159		
	CLIENT	Cumbria County Council		
	DRAWN BY:	FW		
	DATE:	March 2012		
	FIGURE:	4		

Figure 4: Extract from Hodgson's Map of Westmorland 1823-1826

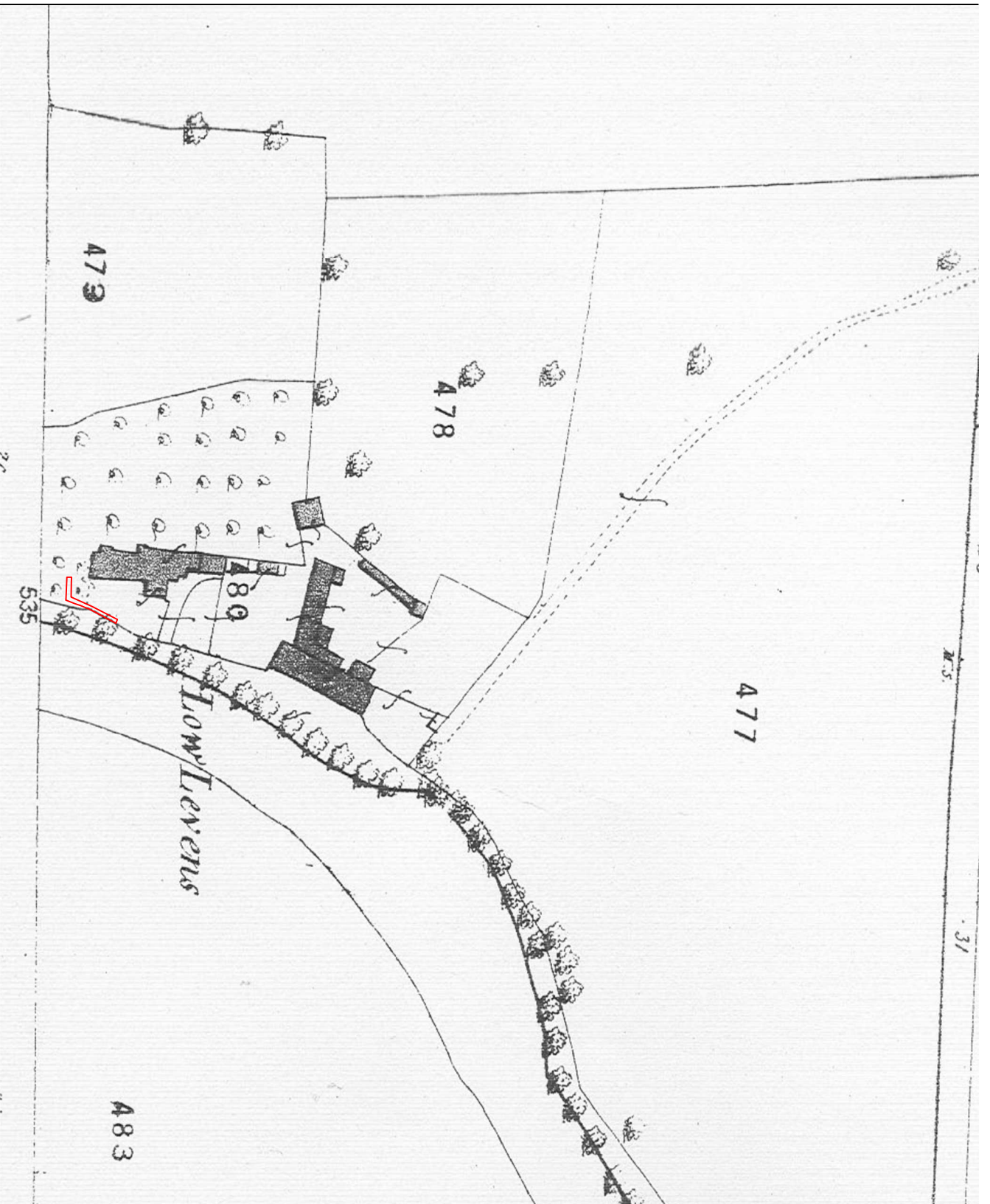



Figure 5: First Edition Ordnance Survey Map c.1865 (25" to 1 mile scale)

	<p>NP Archaeology Ltd 2012</p>	<p>Low Levens Farm, Levens, Kendal</p>	<p>CLIENT: Cumbria County Council</p>	<p>SCALE: 1:2000 at A4</p>	<p>DRAWN BY: FW</p>	<p>DATE: February 2012</p>	<p>KEY:  Location of Medieval Wall</p>	<p>Reproduced by permission of Ordnance Survey on behalf of The Controller of Her Majesty's Stationery Office. © Crown copyright. All rights reserved. Licence number 100014732</p>	<p>REPORT No: CP10159</p>	<p>FIGURE: 5</p>
--	------------------------------------	--	---	----------------------------	---------------------	----------------------------	---	---	-------------------------------	----------------------

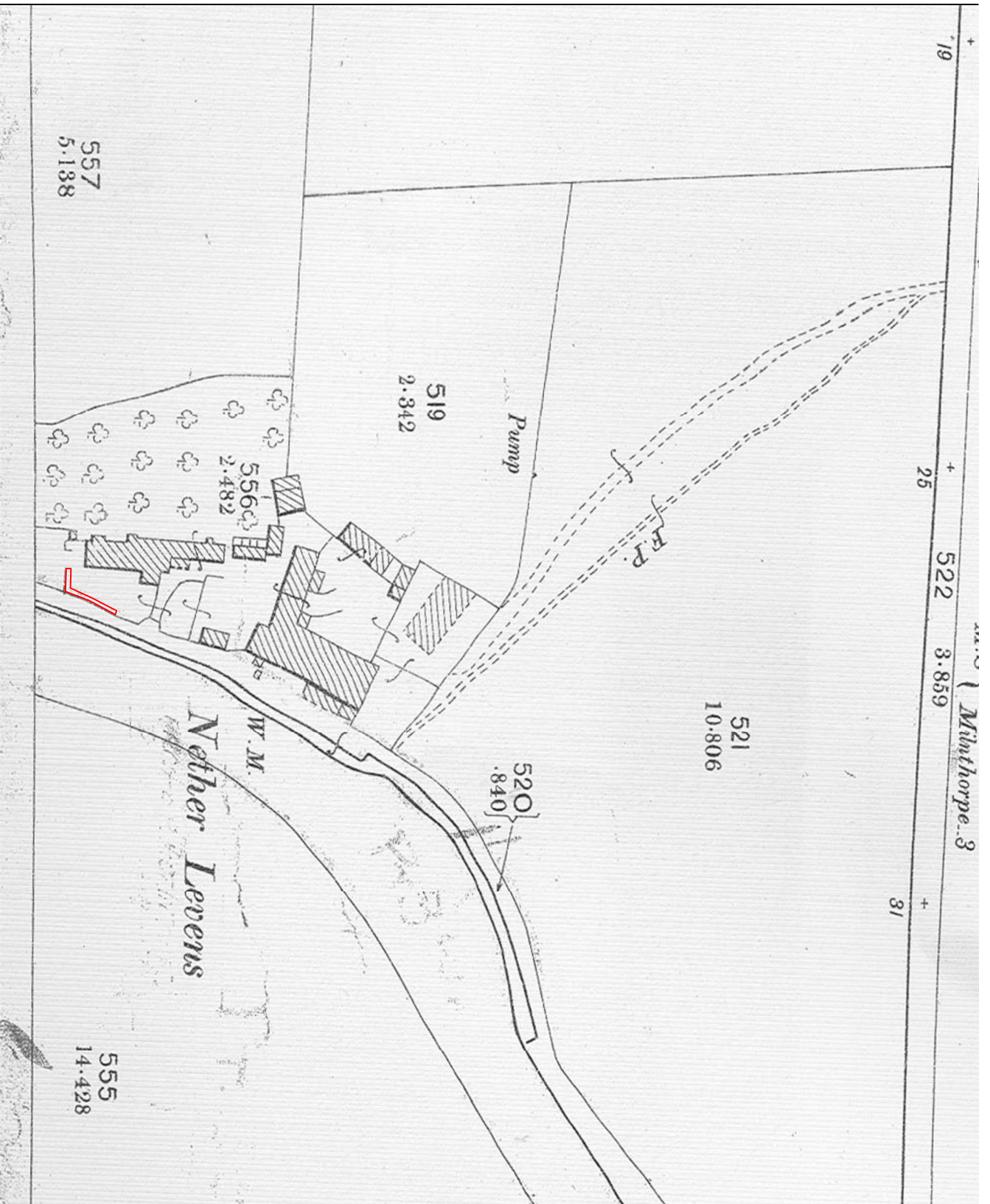

Figure 6: Second Edition Ordnance Survey Map 1898 (25" to 1 mile scale)

	<p>NP Archaeology Ltd 2012</p>
<p>Low Levens Farm, Levens, Kendal</p>	<p>CLIENT: Cumbria County Council</p>
<p>SCALE: 1:2000 at A4</p>	<p>DRAWN BY: FW DATE: March 2012</p>
<p>KEY: Location of Medieval Wall</p>	
<p>Reproduced by permission of Ordnance Survey on behalf of The Controller of Her Majesty's Stationery Office. © Crown copyright. All rights reserved. Licence number 100014732</p>	<p>REPORT No: CP10159</p>
<p>FIGURE: 6</p>	