

Dartmoor National Park Historic Environment Record

Civil Parish & District: Dean Prior, South Hams	National Grid Reference: SX 7129 6340	Number:
Subject: Archaeological evaluation and historical building recording at Moorshead, Deancombe, Devon.		Photo attached: Y
Planning Application no: 0135/11	Recipient museum: Plymouth Museum	
OASIS ID: oakforda1-122153	Museum Accession no: 2012.12	
Contractor's reference number/code: OA1036	Dates fieldwork undertaken: 08-03-2012	
<p>Description of works: An archaeological trench evaluation and historic building recording was undertaken by Oakford Archaeology in March 2012 in advance of development at Moorshead, Deancombe, Devon (SX 7129 6340). The site (Fig. 1) is part of a Dartmoor longhouse, probably built during the middle of the 15th century, and fallen into ruin during the 20th century. The work was required under a condition attached to the grant of planning permission (ref. 0135/11).</p> <p>Results (figs. 2-3, pl 1-2): Prior to commencing works the south-west elevation of the longhouse was drawn. Unfortunately this had been re-pointed in anticipation of the works. Little information could be gathered from this, other than that the south-east corner of the building had been partly re-built in recent years to support the roof over the garage.</p> <p>The evaluation comprised the excavation of a single E-W aligned trench, measuring 3.6m by 1 m, and 0.35m deep. Trench 1 was archaeologically sterile. The area had previously been reduced and infilled with concrete rubble and soil (101), thereby removing any potential archaeological remains.</p> <p>Discussion: The evaluation has demonstrated that the area of the proposed development is archaeologically sterile. No features or deposits were found to indicate archaeological activity within the trench. The area had been reduced by the previous owners sometime in the 1980's. The lack of pottery and lithics from the site, despite examination of spoil heaps, further indicates that the potential for significant archaeological survival is low. As a result, it was agreed with the DNPA Archaeologist that no further archaeological site work was necessary. This is the only report on these works.</p> <p>Project archive The site records have been compiled into a fully integrated site archive which is currently held at the offices of Oakford Archaeology under project number 1036, pending deposition at Plymouth Museum (2012.12).</p>		
Recorder: MFR Steinmetzer (Oakford Archaeology)		Date sent to HER:

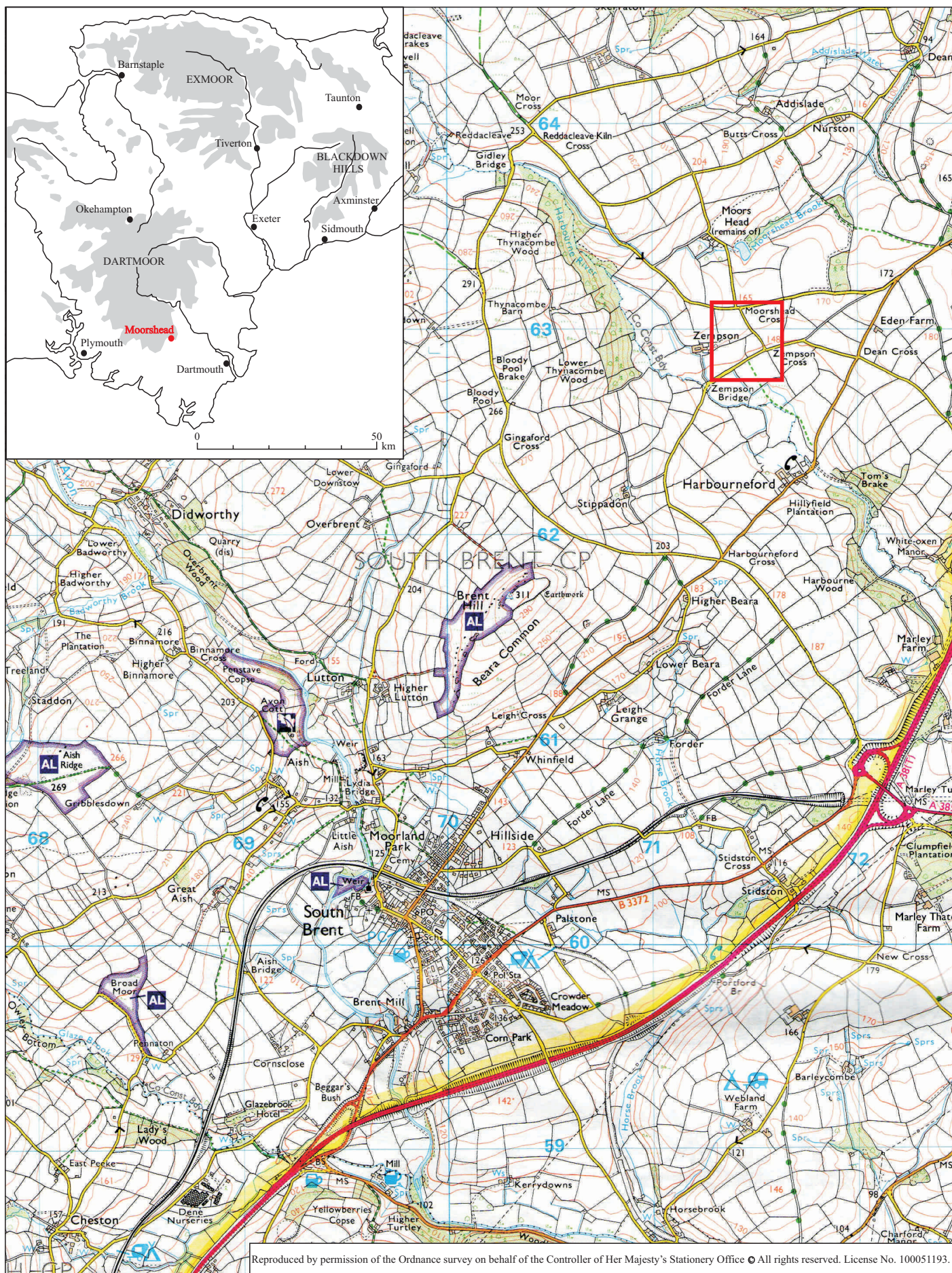

Fig. 1 Location of site

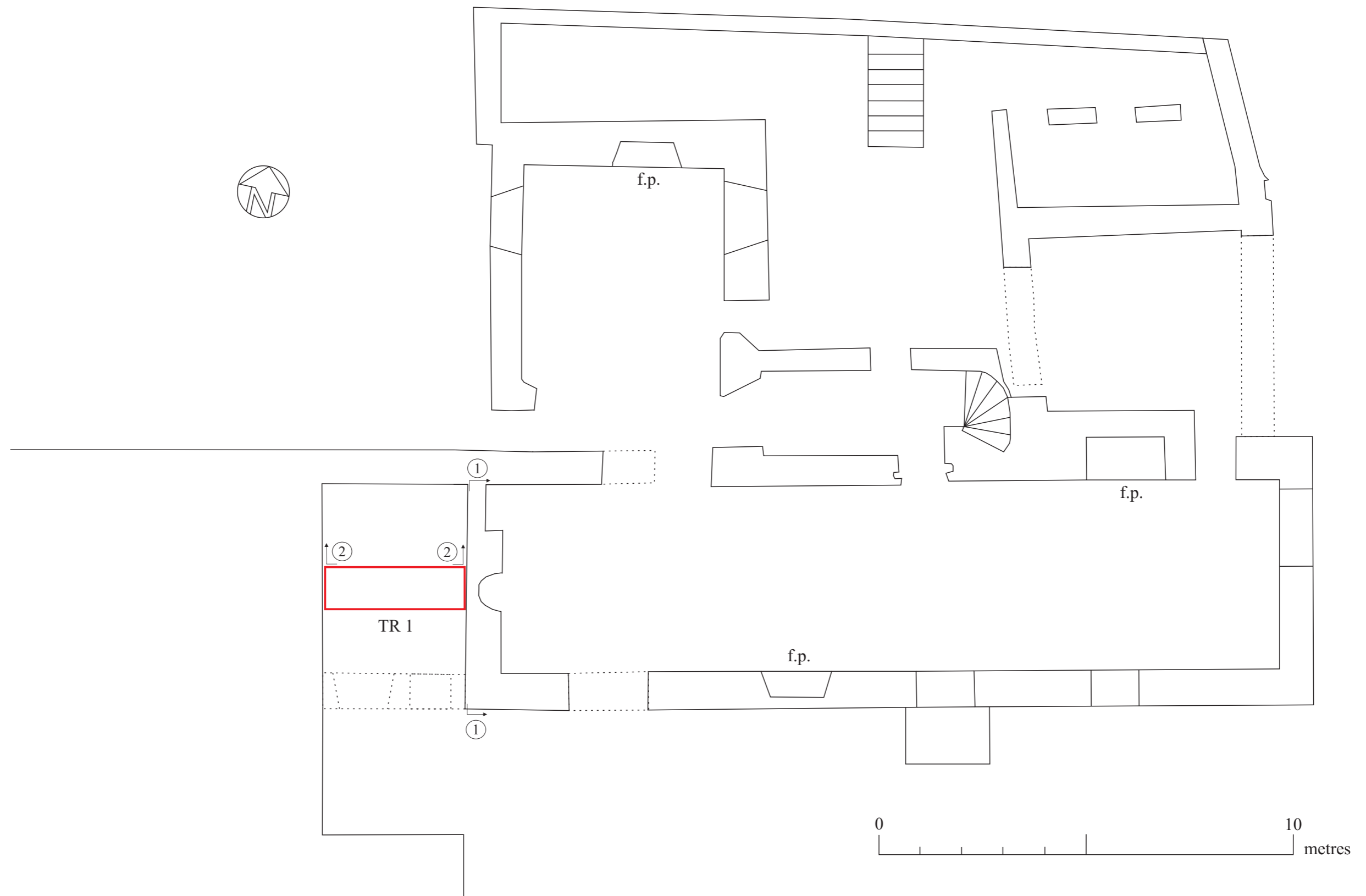
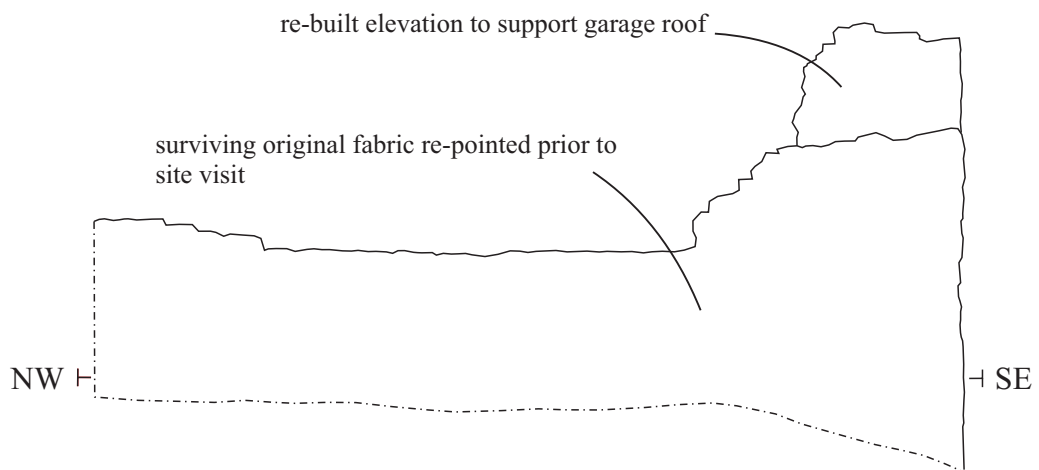
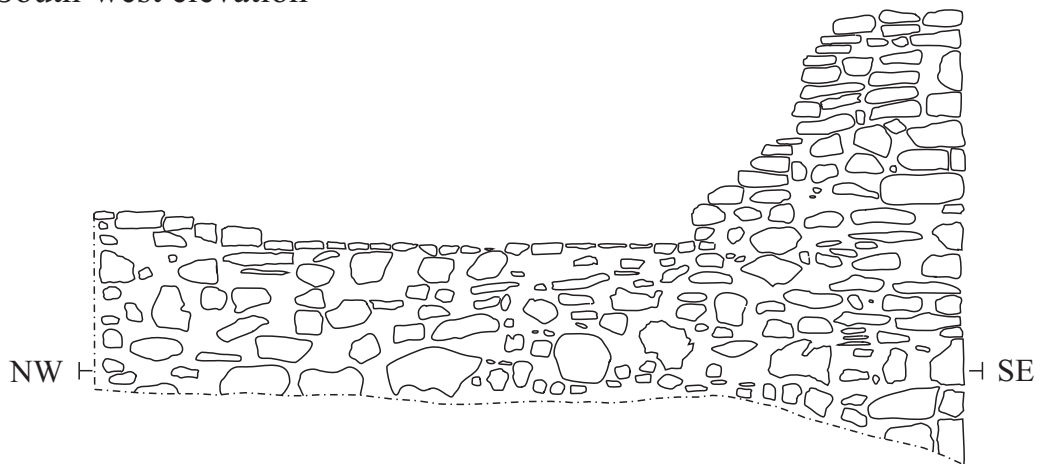

Fig. 2 Plan of Moorshead Manor House and location of building elevation and evaluation trench.

1
South-west elevation



2
Section

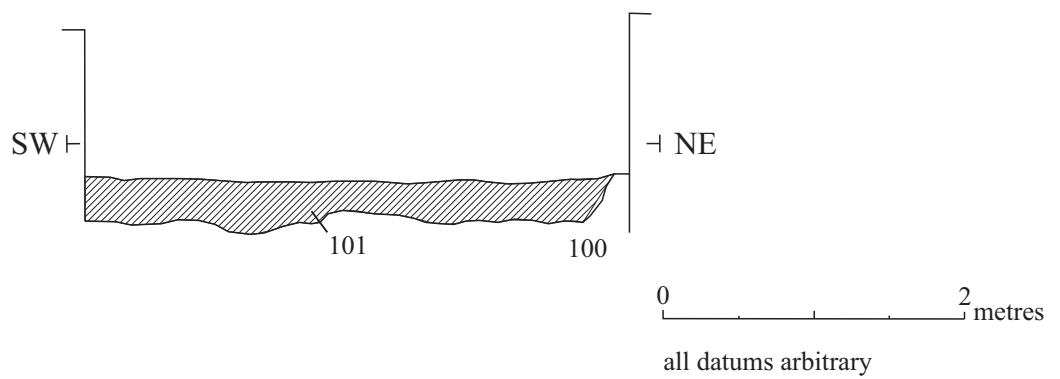

Fig. 3 South-west elevation of Moorshead longhouse and section through development area.



Pl. 1 General view of south-west manor house elevation to be obscured by development. 2m scale. Looking north.



Pl. 2 General view of evaluation trench 1 showing modern disturbance (101) in development area. 2m scale. Looking north.