

Dartmoor National Park Historic Environment Record

Civil Parish & District: Holne, Dartmoor	National Grid Reference: SX 7180 6916	Number:
Subject: Archaeological monitoring and recording at Shuttaford Farm, Holne, Devon.		Photo attached: Y
Planning Application no: 0132/17	Recipient museum: n/a	
OASIS ID: oakforda1-298533	Museum Accession no: n/a	
Contractor's reference number/code: OA1436	Dates fieldwork undertaken: 28/09 and 02/10/2017	
<p>Description of works: An archaeological watching brief was undertaken by Oakford Archaeology between September and October 2017 during building work at Shuttaford Farm, Holne, Devon (SX 7180 6916). The site (Fig. 1) is located to the west of the Grade II Listed farmhouse. The layout of the building perpetuates that of an earlier house which was first constructed as a three room and cross-passage house in the 16th century, with a later 17th century parlour wing and porch, and 20th century alterations. The work therefore had the potential to expose and destroy archaeological and artefactual deposits associated with this activity and was therefore required by the Dartmoor National Park Authority (DNPA).</p> <p>A watching brief was maintained during works associated with the removal of existing concrete floors and creation of multi-level interior. The ground reduction extended to a depth of 0.35-0.4m.</p> <p>Results: The removal of concrete floor exposed elements of an earlier cobbled surface (Fig. 2, pl. 1-2) inside the barn. Unfortunately, the modern concrete floor had been poured directly on top of the earlier surface resulting in its complete removal. The cobbled surface consisted of medium size worn stones on a bed of sand that overlay the natural subsoil. The barn is shown for the first time on the 1889 1st edition Ordnance Survey map and although no finds were recovered during the works it is likely that the floor is late 19th century in date.</p> <p>No deposits, features or dating evidence indicative of earlier archaeological activity was found following the removal of the cobbled floor.</p> <p>Project archive and OASIS entry Due to the limited nature of the findings a project archive will not be produced. A summary of the investigations has been submitted to the on-line archaeological database OASIS (Online Access to the Index of archaeological InterventionS).</p>		
Recorder: MFR Steinmetzer (Oakford Archaeology)		Date sent to HER:

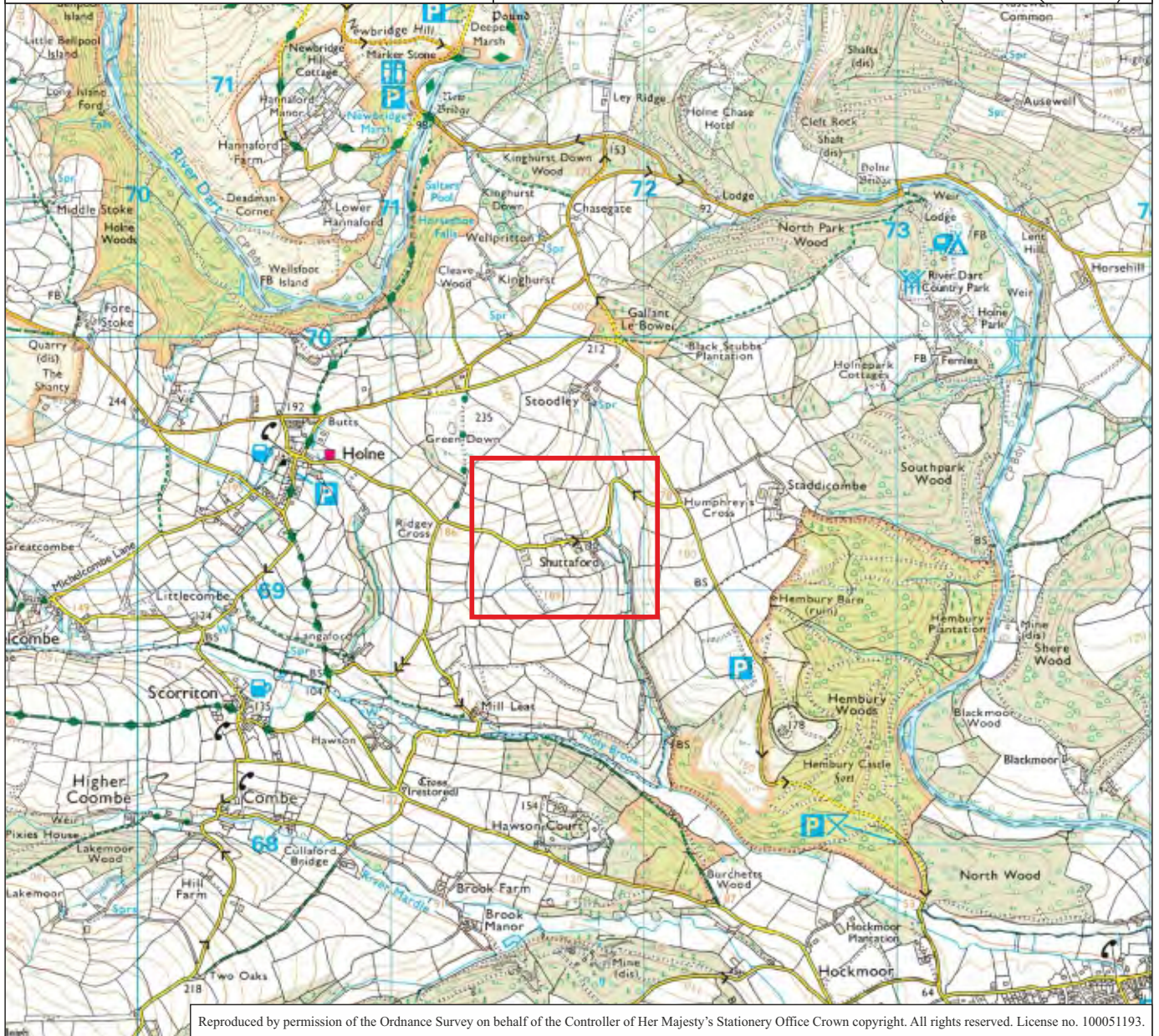
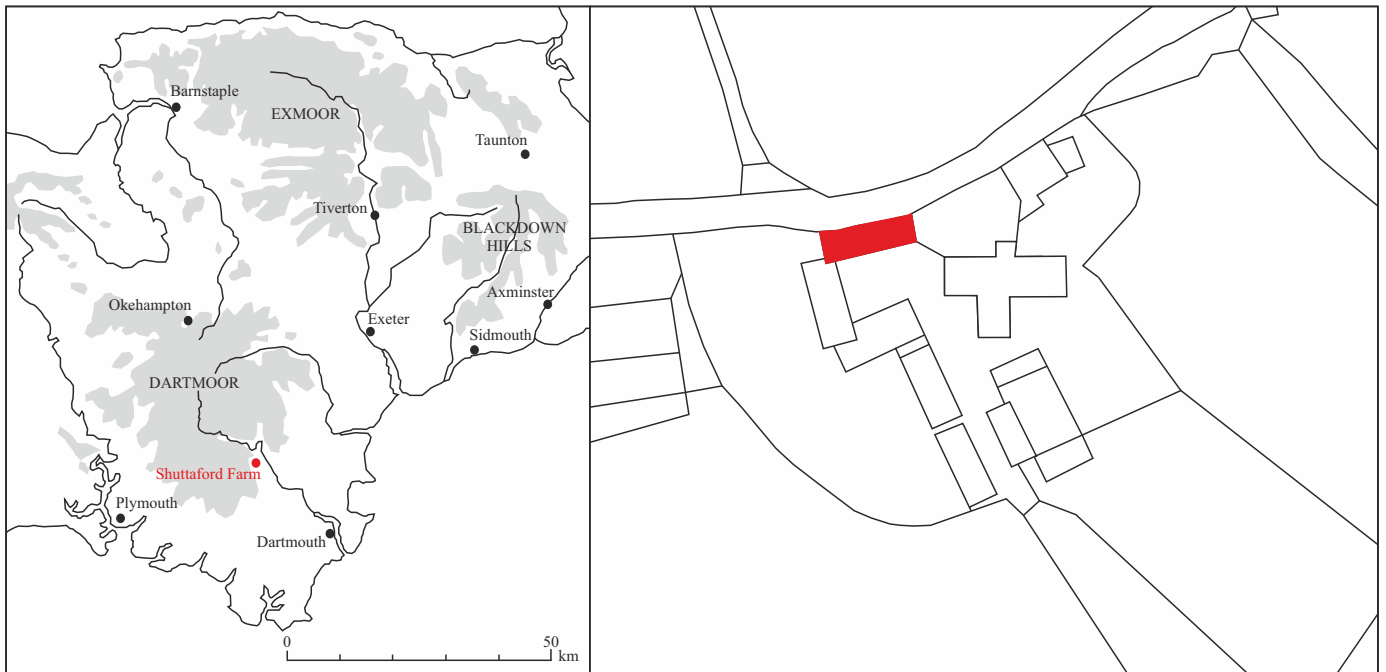

Reproduced by permission of the Ordnance Survey on behalf of the Controller of Her Majesty's Stationery Office Crown copyright. All rights reserved. License no. 100051193.

Fig. 1 Location of site.

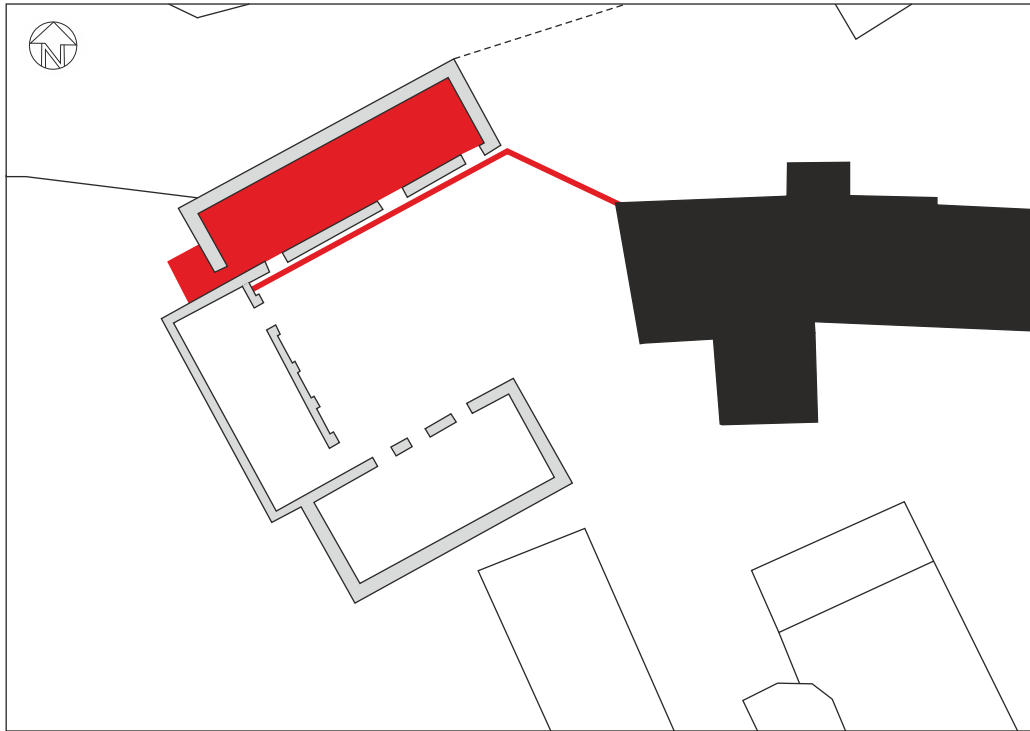

Fig. 2 Plan showing location of observations and photos showing barn (top) and reduced area (bottom).