

Devon County Council Historic Environment Record

Civil Parish & District: Broadhempston, Teignmouth	National Grid Reference: SX 8009 6632	Number:
Subject: Archaeological monitoring and recording at Chapel Cottage, Broadhempston, Devon.		Photo attached: Y
Planning Application no: 17/01380/FUL	Recipient museum: n/a	
OASIS ID: oakforda1-368050	Museum Reference no: n/a	
Contractor's reference number/code: OA1583	Dates fieldwork undertaken: 18/09-19/09/2019	
<p>Background</p> <p>An archaeological watching brief was undertaken by Oakford Archaeology for Mr Neil Tully in September 2019 on works associated with the erection of a single storey garden room extension and associated works at Chapel Cottage, Broadhempston, Devon (SX 8009 6632). The work was required by the local planning authority Teignbridge District Council (TDC), as advised by the Devon County Historic Environment Team (DCHET).</p> <p>The site (Fig. 1) is located within the historic core of the village of Broadhempston, a short distance to the north of the Grade I Listed 15th century parish church of St Peter and St Paul. The works are located at the rear of Chapel Cottage, a Grade II listed building dating to the 18th century.</p> <p>Description of the works</p> <p>A watching brief (Fig. 2, Pls. 1-2) was maintained during the excavation of the new foundations for the garden room extension. The works revealed a simple deposit sequence consisting of shale bedrock (104) at a depth of 0.45m below current ground level. This was overlain by a 0.15m thick mid-yellowish-brown silty clay subsoil (103). This was sealed by a 0.15m thick mid-to-dark brown silty clay topsoil (102). The surviving soil sequence was sealed along the northwestern edge of the works by a 0.05m thick layer of grey sub-angular aggregate (101) which was in turn sealed by a 0.1m thick layer of modern topsoil (100).</p> <p>A very small collection of archaeological material was recovered from the buried topsoil (102), including nine sherds of 18th-19th century South Somerset redware, two sherds of English stoneware (19th century) and 17 sherds of 18th-19th century industrial whitewares including cream ware and Staffordshire transfer printed ware.</p> <p>Conclusion:</p> <p>No deposits, features or dating evidence indicative of archaeological activity pre-dating the later post-medieval period was found. The lack of pottery and other artefacts from the site, despite examination of spoil heaps, further indicates that the site is archaeologically sterile. This is the only report on these works.</p> <p>OASIS entry</p> <p>Due to the limited nature of the findings a project archive will not be produced. A summary of the investigations has been submitted to the on-line archaeological database OASIS (Online Access to the Index of archaeological InterventionS).</p>		
Recorder: MFR Steinmetzer (Oakford Archaeology)		Date sent to HER:

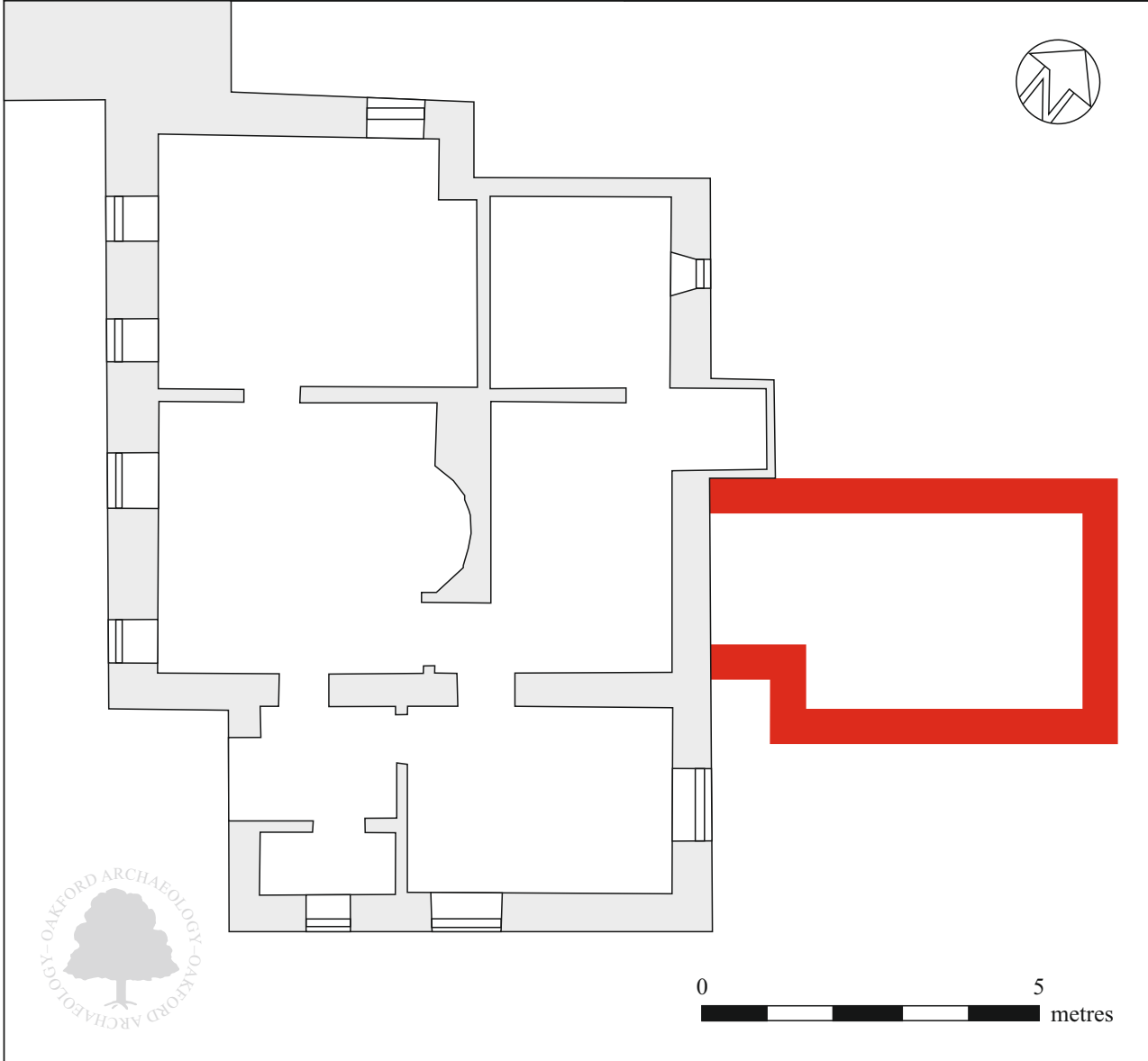
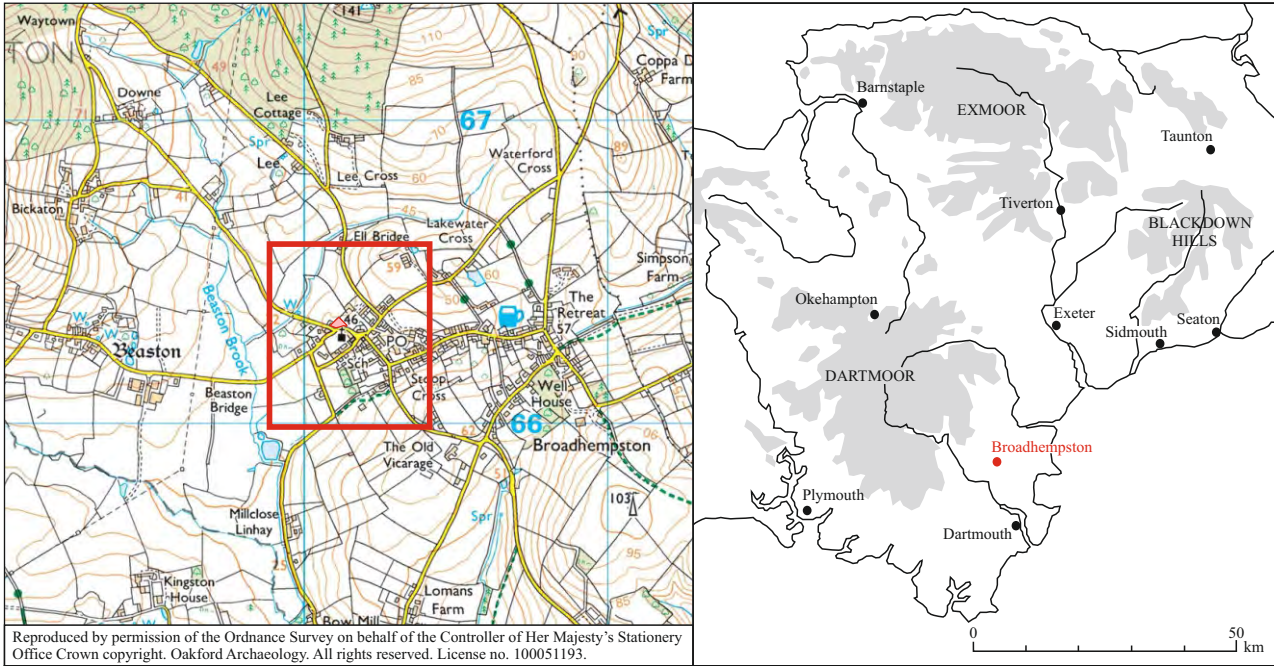

Fig. 1 Location of site.



Pl. 1 General view of excavations. 2m scale. Looking north.



Pl. 2 Section showing deposit sequence . 2m scale. Looking northwest.