

EDINBURGH TRAM SCHEME,
GOGAR CHURCH
DATA STRUCTURE REPORT



PROJECT 2600.2

carried out
on behalf of
Transport Initiative Edinburgh
and The City of Edinburgh Council

GUARD
Glasgow University Archaeological Research Division

Contents

1.0	Executive Summary	5
2.0	Introduction	5
3.0	Site Location, Topography and Geology	5
4.0	Archaeological Background	6
5.0	Aims and Objectives	6
6.0	Methodology	7
7.0	Results	7
8.0	Discussion	26
	8.1 Summary of the Fieldwork Results	
	8.2 Interpretive Issues	
9.0	Recommendations	26
10.0	Acknowledgements	27
11.0	Bibliography	27
12.0	Appendices	28
	12.1 List of Contexts	
	12.2 List of Finds	
	12.3 List of Samples	
	12.4 List of Drawings	
	12.5 List of Photographs	
	12.6 DES	
	12.7 Written Scheme of Investigation	

List of Figures

1	Site Location	4
2	Plan of Site 2A	9
3	Plan of Site 2B	17
4	Plan of Site 2C	20
5	Plan of Site 2D	25

List of Plates

Cover	View of Site 2A and mound being removed from Site 2B	
1	Site 2A from the west	7
2	Site 2A from the east	8
3	Cobbled surface (2003) and field drain (2005)	11
4	Corn-drying kiln	12
5	Possible well with tree roots	14
6	Post-Medieval linear feature [2256] cut into layer (2202)	15
7	Medieval linear feature [2237]	16
8	Rough cobbled surfaces in north-east corner of Site 2B from the west	16
9	Stone built well	18
10	The east part of Trench 2C	19
11	Rough cobbled surface (2208)	21
12	Areas of rough cobbles in east part of Site 2C	22
13	Wall in north-west corner of Trench 2C	22
14	Curving ditch [2288]	24



© Glasgow University 2008

This report is one of a series published
by GUARD, Gregory Building,
Lilybank Gardens, Glasgow, G12 8QQ

EDINBURGH TRAM SCHEME,
GOGAR CHURCH

DATA STRUCTURE REPORT

PROJECT 2600.2

by

Heather F James
and
Chris Bowles

This document has been prepared in accordance with GUARD standard operating procedures.

Approved by: Date: 29 October 2008
Dr John Atkinson



Project 2600.2
 Edinburgh Tram Scheme
 Sites 2A, 2B, 2C & 2D:
 Archaeological Excavations

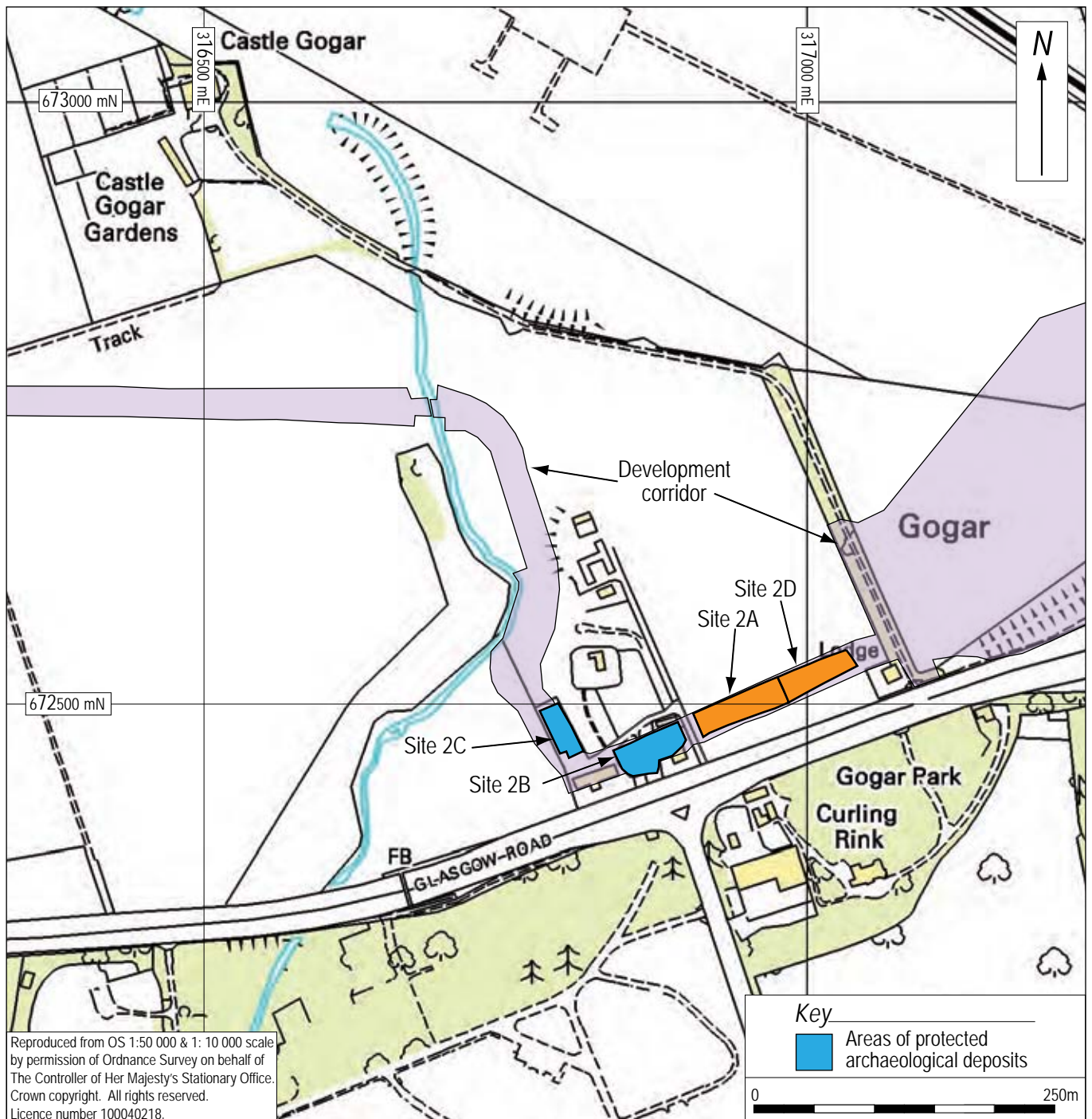
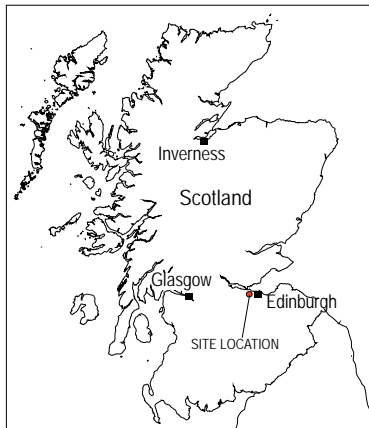

Figure 1: Location of Sites 2A, 2B, 2C & 2D.

1.0 Executive Summary

An archaeological evaluation of the corridor of the Edinburgh Tram Scheme in 2006 brought to light two particular areas which required further archaeological investigation (Sneddon & Will 2006). The first of these, Site 1 at Gogar Mains, is described in another report (James 2008). The second area, Site 2 at Gogar Church, is described in this report; it comprised remains of the Medieval village of Nether Gogar. These excavations were carried out by GUARD on behalf of Transport Initiative Edinburgh (TIE) and The City of Edinburgh Council, in advance of construction. Four large areas were opened in the vicinity of Gogar Church. These are described here as Sites 2A, B, C and D.

Site 2A consisted of a Medieval cobbled courtyard, which was initially noted during the evaluation phase. Other significant archaeological remains were also discovered, including a corn drying kiln, a complex Medieval ditch system (which contained numerous Medieval pottery sherds and a fragment of a copper alloy ring) and a possible Medieval well. These were cut by both stone-filled and ceramic field drains.

Site 2B had been occupied by buildings in the nineteenth- and twentieth-century and these had been demolished and replaced with a large mound of earth. Excavation in Site 2B revealed that the natural subsoil ranged in depth here from 0.5 m to 1.5 m below the surface. The deepest area was in the east, and here remnants of a rough cobbled surface were observed. Sherds of Medieval pottery and fragments of clay pipes were retrieved from the surface of the cobbles and from the layers above. A linear feature containing only Medieval pottery may be the remnants of a Medieval field or property boundary. The layers sealing the Medieval features consisted of re-deposited ploughsoil and building debris from the demolished nineteenth- and twentieth-century buildings. A well was found just outside the construction corridor; it was marked on a plan of the early nineteenth century, but had gone out of use by 1829. This well was drained and backfilled with gravel during these works.

Site 2C comprised what is probably a Medieval surface made of patches of rough cobbling at a depth of about 1.2 m below the surface. Several sherds of Medieval pottery and a late Medieval coin were also retrieved. This surface was sealed by deep deposits of re-deposited ploughsoil and building debris. The corner of a building was revealed, possibly the nineteenth-century village school.

Site 2D comprised a possible Medieval trackway with either drainage ditches or hedgerows to either side. Ruts cut into natural subsoil beneath were thought to be cart tracks. Remnants of a ring-ditch and an ephemeral curving ditch also indicate that there was further activity towards the northern edge of the site. The remaining features were predominantly either stone-filled field drains or ceramic field drains.

There were therefore remnants of the Medieval village of Nether Gogar in the form of an extensive cobbled surface, other patches of rough cobbling and a corn drying kiln, but no buildings were identified.

2.0 Introduction

The archaeological works at Gogar Church, Edinburgh, were conducted in advance of construction of the Edinburgh Tram Scheme, which will extend from Leith to Edinburgh Airport. This work was commissioned by Transport Initiative Edinburgh (TIE) and The City of Edinburgh Council, and was carried out between April 21st and July 14th 2008. The site had been initially identified during an archaeological evaluation carried out by GUARD in 2006 (GUARD Report 2235). The methodology for the archaeological works was established in a method statement prepared by GUARD and TIE and approved by the City of Edinburgh Council (see Appendix 12.7).

3.0 Site Location, Topography and Geology

Site 2 was located in the vicinity of Gogar Church, Edinburgh, and was divided into four areas (A-D). Site 2A was centred on NGR: NT 16950 72500, Site 2B centred on NT 16875 72463, Site 2C, centred on NT 16796 72480 and Site 2D was centred on NT 17010 72527 (see Figure 1).

The underlying drift geology consists of a mixture of glacio-fluvial sands and gravels and till (diamicton, stony, sandy to clayey) while the solid geology consists of Gullane Formation sandstone, grey and green

siltstone, mudstone and pebbly sandstone (British Geological Survey 1:63,600, Sheet 32W, Drift and Solid, 2007).

4.0 Archaeological Background

There are three previously known archaeological sites in the vicinity of Gogar. A possibly prehistoric settlement (NT17SE 57) has appeared as a cropmark at NGR: NT 1652 7250, and another cropmark (NT17SE 56) at NT 1664 7253 has been interpreted as a prehistoric fort. A previous field evaluation identified an enclosure (NT 17SE 197) at NGR: NT 1685 7271 (Reed 1999). Archaeological works prior to the construction of a bridge for the Royal Bank of Scotland Headquarters at Gogarburn have revealed significant Medieval and early Medieval remains associated with the settlement of Nether Gogar (Morrison 2002; Morrison 2003; Morrison *et al* 2007). A geophysical survey of Site 2A was also carried out by Headland Archaeology Ltd prior to this stage of the work; as it was thought to be the possible site of a Civil War skirmish, but no significant anomalies were recorded. Because of the previous excavations and the cropmarks in the vicinity, the route of the tram had been classified as archaeologically sensitive and at risk by the development by the City of Edinburgh Council Planning Authority.

The evaluation phase of this project, undertaken by GUARD in 2006, involved a total of 71 trenches along two sections of the tram corridor (referred to as Work Strand 3 and Work Strand 4, Trenches 1-29 and 101-142), (Sneddon & Will 2006). In Trench 6, a cobbled surface cut by a stone-built drain was found, as well as 12 sherds of Medieval pottery and fragments of animal bone. Trench 7 revealed two curvilinear features (each producing a sherd of Medieval pottery), a circular pit and two other linear features with no finds. The area around Trenches 6 and 7 was therefore identified as being of potential archaeological significance and was highlighted for further investigation work by Edinburgh City Council. This area was investigated as Site 2A, which was extended eastwards into Site 2D.

During the evaluation phase, the area to the south and south-west of Gogar Church, thought to be the site of Medieval Nether Gogar, was covered with two large mounds of earth which had been recently created and so was not available for evaluation. These areas were investigated as Sites 2B and 2C. The area to the west and north-west of the church was investigated with five trenches, which revealed that this area consisted of modern landfill to a depth of over 1.2 m.

A plan of the village of Nether Gogar, dated to about 1829, shows buildings along the main road frontage, corresponding to the south sides of Sites 2A and 2B and also at the east edge of 2C (see Sneddon & Will 2006, Figure 4). In the twentieth century there were more extensive buildings covering Site 2B, while the areas of Sites 2A and D were used for agriculture. The buildings were demolished during the Gogarburn Headquarters development and the areas of Sites 2B and 2C were used as temporary car parks. Two large mounds of topsoil and demolition debris were subsequently placed over the areas of Sites 2B and 2C.

5.0 Aims and Objectives

The aims of the archaeological excavations were:

- to determine the extent, character and date of the Medieval features revealed within evaluation trenches 6 and 7, and
- to determine whether there are any remains of a Medieval and post-Medieval settlement of Nether Gogar in the vicinity of Gogar Church.

The specific objectives were:

- to strip the topsoil from an area around the features encountered in the evaluation;
- to remove by hand any remaining overburden in order to expose the archaeological deposits;
- to record any features or structures in plan;
- to excavate 100% of all features, structures and deposits encountered (and to excavate 50% of linear features); in Sites 2B and C the archaeological horizon was to be reached but not excavated fully. The horizon was to be preserved *in situ* and protected with breathable geotextile (Terram);
- to record all archaeological features, and

- to sample deposits and features in order to gather information on the contemporary environment and on soil formation processes, as well as material for dating.

6.0 Methodology

Initially, Site 2A was stripped of topsoil and the two earth mounds over Sites 2B and 2C were removed. Site 2A initially measured 75 m by 20 m, but it was extended eastwards and westwards as archaeological features continued to be found at the edges of the trench; towards the end of the excavation, the trench was extended further to the east as Site 2D in order to establish the full extent of the archaeological remains in this area. Sites 2A and D together measured 138 m by 23 m. Site 2B was located on the west side of the track to Gogar Church and measured 58 m by 29 m. Site 2C was stripped in two phases, as it was necessary to maintain a routeway along the corridor. The east side was excavated and then backfilled before the west side was excavated. The deepest parts of Trench 2C were excavated in three wide slots, each 1.6 m wide. Site 2C measured 45 m by 18 m.

Topsoil was stripped using a mechanical excavator, fitted with a flat-bladed ditching bucket, under close archaeological supervision. The topsoil was removed to the surface of the subsoil or to the first archaeological horizon, whichever was encountered first. Exposed surfaces were cleaned first by hoe and then by trowel. All significant archaeological features discovered in the evaluation trenches were 50% excavated by hand, apart from those containing artefacts, which were 100% excavated. Sampling involved the routine recovery of up to 10L bulk samples from all archaeological features. Where fills were particularly rich in artefactual or archae-botanical remains, the greater proportion of the fill was recovered as bulk samples. A portion of fills which were not bulk sampled were screened for artefactual recovery through coarse sieving on site.

The recording of all archaeological features encountered followed conventional methodologies, including *pro forma* record sheets. Scaled plans were drawn by hand at 1:50 and 1:20 and sections at 1:10. Photography included black and white prints, colour prints and digital photographs. The site was surveyed into the national grid using a total station.

As instructed in the Method Statement, Sites 2C and 2B were stripped to the surface of the significant archaeological layers and were not excavated fully. The significant archaeological features in Sites 2C and 2B were to be preserved *in situ* and covered with breathable geotextile (Terram), as they were to be protected from the development. Conditions for the excavation varied between extremely warm and dry to very wet and windy.



Plate 1:
Site 2A from the west.

7.0 Results

7.1 Site 2A (Figure 2)

The topsoil on Site 2A was a mid-brown silty clay ploughsoil (2000) which varied in depth from 0.3 m in the higher area, towards the east end of the site, to 0.5 m in the lower part of the site to the west. The topsoil contained modern pottery. In the eastern part of the site, the subsoil (2001) consisted of red brown silty clay with numerous stone inclusions. In the western part of the site, the subsoil consisted of deposits which sloped down towards the west, with mottled orange-grey silty sand (2024) overlying mid-grey boulder clay (2042) which in turn overlay orange brown sand (2098).

After the topsoil was stripped, a number of features were visible in the underlying subsoils. These consisted of possible pits, post-holes, ditches and an extensive area of cobbling. Excavation of these features revealed

a Medieval corn drying kiln and a probable Medieval well. Contexts relating to the ditch system, the cobbled surface, the corn drying

kiln and the probable well have been grouped together for ease of discussion. Following this, additional features will be discussed.



*Plate 2:
Site 2A from the east.*

7.1.1 Ditch System

The eastern part of site 2A was crossed by a complex of Medieval ditches and possible field boundaries. Consistently dry conditions during the period of investigation made features difficult to identify because of the clay soil, which dried to a cement-like colour and consistency, similar to the sub-soil. The ditches have been grouped into two broad categories, based on their orientations. Those with a generally north-west to south-east orientation included: [2166], fill (2165); [2167], fill (2166); [2146], fill (2114); [2172], fill (2171); [2122], fill (2120); [2128], fill (2115); [2053]/[2054], fill (2007); [2158], fill (2147); [2131], fill (2090); [2125], fill (2105); [2124], fill (2104), and [2123], fill (2103). The features running east to west included: [2079], fill (2009); [2080], fill (2010); [2071], fill (2070); [2099], fill (2083); [2102], fill (2087); [2129], fill (2076); [2092], fill (2082); [2141], fill (2135); [2142], fill (2136), and [2064], fill (2133). The north-east to south-west orientated ditches included: [2157], (fill 2148), and [2253], fill (2154).

Where possible, it was demonstrated that the wider and deeper north/south ditches linked to the more ephemeral east/west ditches. These formed at least two sub-systems of major and minor drainage channels, discussed further below.

Excavation of the ditches focussed on establishing their dimensions and relationships and on maximising finds recovery by the use of slot trenches. These provided relational evidence for two interlinking ditch systems. The easternmost was formed by the north/south oriented features [2123], [2124], [2125] and possibly the south-easterly extension of [2080], which disappeared to the south due to later agricultural disturbance. Two of these ditches, [2124] and [2125], appeared to terminate in the north at what has been interpreted as a sump [2109], fill (2089). Ditch [2123] appeared to feed into [2124]. These north/south ditches connected to a series of ditches oriented east/west. Ditch [2099] extended to the west from the sump [2109], where it was difficult to ascertain a direct relationship. This may also have been the case for ditches [2092], [2141] and [2136]. The first of these appears in plan as an isolated feature, though shallower sections of the ditch may have been ploughed out. The relationships between the second and third and the sump were unclear due to the presence of a post Medieval ceramic drain [2081] that cut both the ditches and the western edge of the sump. Like [2092], ditch [2071] also appeared to be isolated and a function could not be assigned to it. An alternative explanation for the isolated ditches [2092], [2071] and [2064], located towards the south-eastern baulk of site 2A, are that they were structural. They were broadly parallel to one another in plan and could represent



Figure 2: Plan of Site 2A.

construction trenches for a large building on a north/south axis. This, however, is by no means certain and no other possible structural evidence (for example, post-holes) was located. Finally, ditch [2010] extended west to east around the northern edge of the sump [2109], where it curved to the south-east. This would seem to indicate the two were contemporary. Additionally, [2010] may originally have extended to the south, running parallel to ditch [2124], although this putative extension did not survive due to later disturbance.

The second ditch system principally consisted of seven north/south ditches: [2128], [2132], [2146], [2166], [2167], [2153]/[2154] and [2172]. These may have been connected at some point with the eastern ditch sub-system via the east/west ditches [2141] and [2136]. Two of the north/south ditches in the second sub-system [2148] and [2166] were connected and would have drained into the northern extension of [2146]. This area contained the largest number of finds from any of the ditches. It was unclear which of the ditches cut the other; however, it was apparent that they cut through an earlier ditch [2167] which could be seen in the slope where [2166] and [2146] met and in the probable terminal of [2167] along the eastern edge of [2146]. Additionally, both [2146] and [2132] to the east cut an earlier shallow ditch [2172] which was interpreted in the field as a connecting channel between the two ditches. The northern drain [2146] curved towards the west and down the hill, where it terminated just before the gully [2033] surrounding the corn drying kiln (discussed below).

A linear cut [2119] between the kiln and the gully may have been an extension of the ditch [2146] which has been truncated by the cut for the kiln [2035].

The two remaining features [2128] and [2053]/[2054] were separated by the possible well [2169] (discussed below), but may originally have formed one ditch. Excavation of the north terminal of [2128] failed to ascertain its relationship with [2169], and extensive cleaning of the southern extent of [2053]/[2054] did not locate a terminal or relationship with the well. It is possible that the well post-dates [2053]/[2054] and that [2128], the terminal of which may have respected the well, was therefore also a later feature. If the two ditches did originally form one feature prior to the construction of the well, then it is likely that [2128] was re-cut at the time the well was dug.

While several of the ditches truncated earlier features, there was no obvious phasing. It is likely that ditches were dug and re-dug in this area over a long period during the occupation of Nether Gogar village. However, the possibility that at least two of the ditches [2123] and [2158] formed a field system from a single phase is confirmed by the sharp corners and returns to the north-east at their south-western ends. In plan, both features appeared to lie on similar alignments to one another and therefore might represent changing boundaries over time. Both ditches were mostly ephemeral, with only the northern portion of [2123] surviving to any significant depth. Neither feature contained any finds. It is difficult to determine whether these features were earlier than, later than or contemporary with the other ditches in the area.

In terms of finds recovery, one ditch [2146] in particular yielded over 100 Medieval pottery sherds in two initial slot trenches. The excavation was extended between the two slots to recover more artefacts. The extended area proved to be at the intersection of ditches [2146], [2166] and [2167], and a large number of artefacts were recovered from the fills, including numerous sherds of Medieval pottery, a stone pot lid (SF 356) and a copper alloy finger ring (SF 377). Due to the depth of deposits and the large number of finds, ditch [2146] was interpreted in the field as a Medieval drainage ditch that had collected the runoff and agricultural silts from subsidiary channels. In addition to this, Medieval pottery came from the fills of features [2053]/[2054], [2064], [2079], [2125], [2128], [2132] and [2166].

<i>Context No</i>	<i>Type</i>	<i>Length (m)</i>	<i>Width (m)</i>	<i>Depth (m)</i>	<i>Interpretation</i>
2053/ 2054	Cut	7.8	0.6	0.3	Ditch
2064	Cut	5	0.9	0.5	Ditch
2071	Cut	4.5	0.8	0.1	Ditch
2079	Cut	4.5	0.6	0.1	Ditch
2080	Cut	10.1	0.6	0.1	Ditch
2091	Cut	3.4	0.2	0.1	Ditch
2092	Cut	3.9	0.8	0.2	Ditch
2102	Cut	8	0.1	0.2	Ditch

<i>Context No</i>	<i>Type</i>	<i>Length (m)</i>	<i>Width (m)</i>	<i>Depth (m)</i>	<i>Interpretation</i>
2109	Cut	4.2	3	0.4	Sump
2123	Cut	6	0.4	0.5	Ditch
2124	Cut	17	1.4	0.5	Ditch
2125	Cut	11	1.2	0.2	Ditch
2128	Cut	9.5	1.4	2.5	Ditch
2129	Cut	1.5	0.3	0.1	Ditch
2131	Cut	1.7	0.5	0.2	Ditch
2132	Cut	11.5	1.1	0.4	Ditch
2141	Cut	8.8	0.6	0.1	Ditch
2142	Cut	8.9	0.6	0.1	Ditch
2146	Cut	22.8	2	0.3	Ditch
2157	Cut	2.2	0.6	0.1	Ditch
2158	Cut	13.3	0.5	>0.1	Ditch
2166	Cut	8.5	1	0.3	Ditch
2167	Cut	1.3	0.7	0.17	Ditch truncated by [2166] and [2146]
2172	Cut	5	0.1	0.4	Ditch

7.1.2 Cobbled Surface



Plate 3:

Cobbled surface (2003) and field drain (2005).

One of the features initially recognised during the evaluation phase at Gogar Church was a cobbled surface (2003). This was exposed further and found to extend over a rectangular area which measured 10.0 m east/west and at least 16 m north/south. The cobbles extended northwards beyond the limits of the corridor. The cobbled surface consisted of rounded stones of differing sizes with some large boulders and a few patches where cobbles were absent. The cobbles sloped down towards the south-west corner and had been cut into the subsoil at the boundary between the mid-grey boulder clay (2042) and the orange brown sand (2098). This surface was interpreted in the field as a courtyard, but no associated structure was identified.

The cobbles were sealed by an extensive layer of mid grey-brown silty clay (2002) which tapered away to the east as the ground rose up towards the kiln and which continued to the west as (2028). Deposit (2002) was interpreted in the field as a spread of Medieval midden deposits associated with farming activity and occupation because of the dark organic matrix and the presence of Medieval pottery and mammal bone.

<i>Context No</i>	<i>Type</i>	<i>Length (m)</i>	<i>Width (m)</i>	<i>Depth (m)</i>	<i>Interpretation</i>
2002	Deposit	15	Approx. 10	0.07	Occupation debris/farmyard midden
2003	Surface	15	10	0.1	Cobbled surface
2028	Buried Soil	1	Unknown	0.3	Buried Medieval soil

7.1.3 *Corn Drying Kiln*



*Plate 4:
Corn-drying kiln.*

One of the first features identified during the machine stripping of Site 2A appeared as a sub-circular patch of dark soil (2004) on the sloping ground to the north-east of the cobbled surface. Several small boulders protruded from the feature on its eastern edge and it was thought at the time that they could be structural. Connected to this was a linear feature which extended to the west (2014). Fill (2004) was investigated by half-sectioning the deposit in two hand-excavated spits. It soon became apparent that the boulders observed on the surface overlay another course of stones below and that these formed the stone lining (2030) of a tear-shaped construction cut [2035] for a probable corn drying kiln. The matrix of the kiln's upper fill (2004) was organic and included several Medieval pottery sherds and pieces of mammal bone (including a cow jaw). This sealed a deposit (2032) with a similar dark organic matrix to (2004), but which included frequent red staining from heavily oxidised iron or small natural stones towards the base of the kiln. These fills led the excavator to suggest the deposit consisted of midden material dumped into the kiln after it had been abandoned. The remainder of (2004) was removed to reveal the full extent of the corn drying kiln.

The cut for the kiln [2035] was dug into the westerly sloping natural subsoil. It may also have truncated an earlier scoop or ditch [2119], fill (2112), connected to the ditch system to the east. The cut for the kiln had steeply sloping sides and a flat bottom. Into this was cut a smaller, sub-rectangular hollow [2117] with a steep side to the east, a flat base and a gradually rising slope to the west where the sides of the cut tapered inwards. From this point, the linear cut for the kiln's flue [2039] extended for approximately 2.5 m to the west towards the cobbled surface (2003). Lining the cut was a course of large stones (2065), which formed a linear channel for the flue below the base of the kiln, ending in a semi-circular terminal. The channel was filled with loose, mid-grey sandy silt (2063), attributed in the field to the post-abandonment phase of the kiln.

Above the flue was a flat floor, constructed from small to medium stones (2038). In the centre of the floor, and towards its western end, a number of stones showed signs of heat stress including blackening

and increased fragility, associated with firings in the kiln. Directly above and interspersed within the area of burning in (2038) was a circular lens of black soot (2034), interpreted as fuel waste. This deposit was 100% sampled for later analysis.

The wall of the kiln was constructed of medium to large stones (2030), the largest being towards the base, which were set into a loose, mid to dark brown clay silt (2116). The kiln's wall survived to a height of 0.6 m in the east but gradually sloped to a height of 0.2 m in the west where it met the flue (2039). The east wall of the kiln had a steep slope, while the northern and southern walls were typically straight sided. At approximately mid-point in the southern wall, a space between three of the stones seemed to form a boxed ledge, with a flat stone in the bottom and two upright stones on either side. These stones were adjacent to a slight linear cut or scoop extending to the south, part of the initial cut for the kiln [2035]. The cut and the space in the kiln wall may have formed a hatch for either ventilation or adding fuel and removing waste from the kiln floor. This was supported by the location of the firing evidence near the possible hatchway.

The cut of the flue [2117]/[2039] extended away from the kiln to the west. Cut [2039], fill (2014) was V-shaped with steep sides. The fill (2014) was composed of mid grey-brown silty clay which merged with (2063) and therefore represented post-abandonment silting. The flue was covered by a series of flat stones (2173). Some of these had fallen into the eastern end of flue [2039], but three remained in place. Near the flue and the kiln, a dark patch of staining (2048) in the natural subsoil was sampled. It was thought at the time that this may have been created by water overspill from the abandoned kiln and may therefore have contained carbonised grain.

There was evidence for a superstructure surrounding the corn drying kiln. This came in the form of a curvilinear, U-shaped ditch [2033], fill (2008) that extended from the northern baulk of Site 2A and arced around the eastern wall of the kiln. The ditch was interpreted in the field as a possible foundation trench for a wattle wall. In addition to this, a post-hole [2041], fill (2040) was located immediately to the west of the [2033] apex and east of the kiln. This was packed with large stones and contained two Medieval pottery sherds and a possible fragment of burnt daub. It was interpreted as a post-hole associated with the kiln superstructure.

<i>Context No</i>	<i>Type</i>	<i>Length (m)</i>	<i>Width (m)</i>	<i>Depth (m)</i>	<i>Interpretation</i>
2033	Cut		0.3	0.1	Foundation trench for wall
2035	Cut	3.5	1.8	0.6	Construction cut for the corn drying kiln
2039	Cut	2.5	0.3	0.2	Cut for flue
2041	Cut	0.9	0.7	0.1	Post-hole
2117	Cut	1	0.45	0.12	Cut for flue within kiln
2119	Cut	0.8	0.5	0.1	Cut of scoop or ditch

7.1.4 Well

The pre-excavation plan of the area between ditches [2128] and [2053]/[2054] showed what appeared to be the rounded northern terminal of ditch [2128]. The decision was made to investigate and determine if the ditch did terminate or continued on to join ditches [2053]/[2054]. It quickly became apparent that ditch [2128] terminated in a sub-square cut 0.5 m short of a sub-circular feature [2138], fill (2137) to the north. What was recognised in the pre-excavation plan as sub-circular was in fact staining of the natural subsoil between the two features.

Initially, the feature [2138] was thought to be a possible pit, and a half-section was excavated along its north-east to south-west axis. The fill continued to over 1 m depth, and the half-section was converted into a box slot in order to locate the north-east edge of the cut and improve access to the fill. This led to the discovery of a second, earlier, sub-ovoid cut [2169]. Cut [2138] was observed to truncate the upper fill (2143) of [2169]. While it was often hard to distinguish from the natural subsoil, the fill (2143) continued to a considerable depth of 1 m where it overlay a wet, organic silt (2168) sealing the large lower trunk and root system of a tree (2145). This deposit provided the only find, a sherd of Medieval pottery, from within the feature. The cut [2169] of the feature at this depth was regular and appeared to be hand-dug. It was sub-ovoid with a gentle slope from the top, becoming steep-sided and sub-circular where it met the tree trunk. Due to the regularity of the cut, the possibility that the feature was a tree-throw was excluded. Instead it was interpreted as either a well or a cess-pit. It soon became difficult to reach the lower deposits of the feature and so the box slot was



*Plate 5:
Possible well with tree roots.*

extended. The south-western edge of the cut was not distinguishable, possibly due to disturbance by the tree, and time constraints did not allow for more complete excavation by hand.

Following consultation with CECAS, a machine was brought in towards the end of the Site 2A excavations and the eastern half of the feature was removed so that cut [2169] could be seen in section. This showed the cut to be a wide pit with steeply sloping sides, becoming more gradual towards a rounded base. The lack of lower organic deposits or finds that might be associated with a cess-pit would suggest that the feature was a Medieval well rather than a cess-pit. When the well ceased to be used, a tree grew up inside it. At some point, the later feature [2138] was cut into the infill of the well [2143], possibly to remove the remains of the tree from the feature.

<i>Context No</i>	<i>Type</i>	<i>Length (m)</i>	<i>Width (m)</i>	<i>Depth (m)</i>	<i>Interpretation</i>
2138	Cut	1.4	0.4	0.3	Cut truncating fill (2143)
2169	Cut	2.4	1.6	1.4	Cut of probable well

7.1.5 *Additional Features*

There were a number of features investigated that included possible pits, post-holes and a number of post-Medieval field drains. The majority of features described as pits were either ephemeral or difficult to recognise in relation to the subsoil. The possible pits included: [2037], fill (2036); [2094], fill (2093); [2096], fill (2074); [2108], fill (2101); [2118], fill (2019), and [2134], fill (2130). The only pit definitively associated with other features was [2037], which lay adjacent to the curving apex of ditch [2093]. The fill (2036) contained one sherd of Medieval pottery. The only other pit containing finds was [2134], which contained a metal object of uncertain type (SF 364) in the fill (2130). The perfectly square shape of this pit, and the object found within it, suggests that this was a modern feature, possibly associated with the repair of a field drain [2106].

Like the possible pits in Site 2A, the potential post-holes were equally ephemeral or difficult to distinguish. These included the features: [2057] fill (2056), [2107] fill (2100), and [2121]. The only notable aspect of these features was the possible north-east to south-west alignment of [2057] and [2121] in plan. However, without further evidence to verify this alignment it is difficult to assert a correlation.

Three additional features were noteworthy. A small cluster of stones (2029) in the northern baulk near

the corn drying kiln may have been structural, perhaps related to a building extending to the north of the corridor. A curving linear feature [2158] was described as a possible ditch in the eastern third of the site. On investigation, it was apparent that the feature was ephemeral and that it was only detectable through staining of the natural subsoil.

Finally, Site 2A was marked by a number of post-Medieval field drains, generally extending north to south across the area and frequently truncating Medieval features. These included several ceramic drains: [2011], fill (2081); [2013]; [2027]; [2044], fill (2045); and [2150]. The remainder of the drains were stone filled. These included: [2050], fill (2023); [2049], fill (2025); [2047], fill (2026); [2005], [2060], [2097], [2062], and [2061]. These drains were thought to be post-Medieval in date, but it was noted that drain [2005] changed direction after it left the cobbles.

<i>Context No</i>	<i>Type</i>	<i>Length (m)</i>	<i>Width (m)</i>	<i>Depth (m)</i>	<i>Interpretation</i>
2029	Cairn	0.4	0.3	0.1	Possible cairn or structural wall
2037	Cut	0.6	0.6	0.1	Possible pit
2057	Cut	0.5	0.4	0.2	Possible post-hole
2094	Cut	0.55	0.55	0.3	Possible pit
2096	Cut	0.8	0.8	0.3	Possible pit
2107	Cut	0.9	0.8	0.1	Possible post-hole
2108	Cut	0.5	0.4	0.1	Possible pit
2118	Cut	0.5	0.4	0.1	Possible pit
2121	Cut	0.4	0.3	0.1	Possible post-hole
2134	Cut	0.5	0.5	0.2	Square pit or post-hole

Site 2A revealed a complex series of ditches which are interpreted as being Medieval in date, a Medieval corn drying kiln with a structure around it, a well and a cobbled surface that may have formed the courtyard of a structure located outside of the development corridor. The site was cut by a series of field drains, some of which were stone filled and some ceramic.

7.2 Site 2B (Figure 3)

A large mound of recently landscaped earth and demolition debris had to be removed before Site 2B could be investigated. The trench was limited on the east side by the road and on the west side by services for the Gogar Cabinetworks. The medieval horizon here was to be identified, recorded, preserved *in situ* and covered with terram.

Beneath the mound of earth, the uppermost layers consisted of modern building rubble and then a layer of red blase (2200), which together formed a deposit about 0.55 m deep across the whole site. Beneath this was a layer of olive green clay sand (2201) which was about 0.4 m deep at the east end and tapered away towards the west with the rising of the natural subsoil (2216). The natural subsoil occurred up to 1.5 m below the surface at the east end, and this area was covered with further modern deposits. Beneath the olive green clay sand (2201) was a layer of compact grey-brown clay (2202) which was 0.10 m deep and contained modern pottery. Cut into layer (2202) was a linear feature [2256] (see Plate 6) which contained a clay tobacco pipe bowl. Beneath layer (2203) was another layer (2204) which was up to 0.40 m deep and also contained a clay pipe bowl.



Plate 6:
Post-Medieval linear feature [2256]
cut into layer (2202).

In the west half of Site 2B, several modern drains had been cut through the modern layers into the subsoil below. At the west end a large mammal had been buried in a pit [2255], fill (2227), which also contained modern pottery. A small number of other features were cut into the subsoil. A linear feature [2237], fill (2211), was aligned north/south and contained 12 sherds of Medieval pottery (see Plate 7). The line of this



*Plate 7:
Medieval linear feature [2237].*

feature was initially thought to continue as the ephemeral features [2243], fill (2217) and [2361], fill (2215). However [2243] contained no finds and feature [2361] contained a clay pipe bowl and so was not Medieval in date. Two circular features were observed to the west of [2237]. These were [2250], fill (2251), which contained modern pottery and clay pipe, and feature [2218], fill (2254), which had no finds. Another linear feature [2248], fill (2228) contained no finds. There were four possible post-holes, none of which contained finds: [2244], fill (2231); [2245], fill (2230); [2247], fill (2232), and [2249], fill (2233).



*Plate 8:
Rough cobbled surfaces in north-east corner of Site 2B, from the west.*

In the south-east corner of the site was a stone-built drain (2265) which had been re-used with the insertion of a modern ceramic drain. This was probably eighteenth- or nineteenth-century in date. In the north-east corner of the site was a rough cobbled surface (2234/2239), on the surface of which Medieval pottery, a clay pipe bowl and a modern (probably intrusive) metal object were found (see Plate 8).

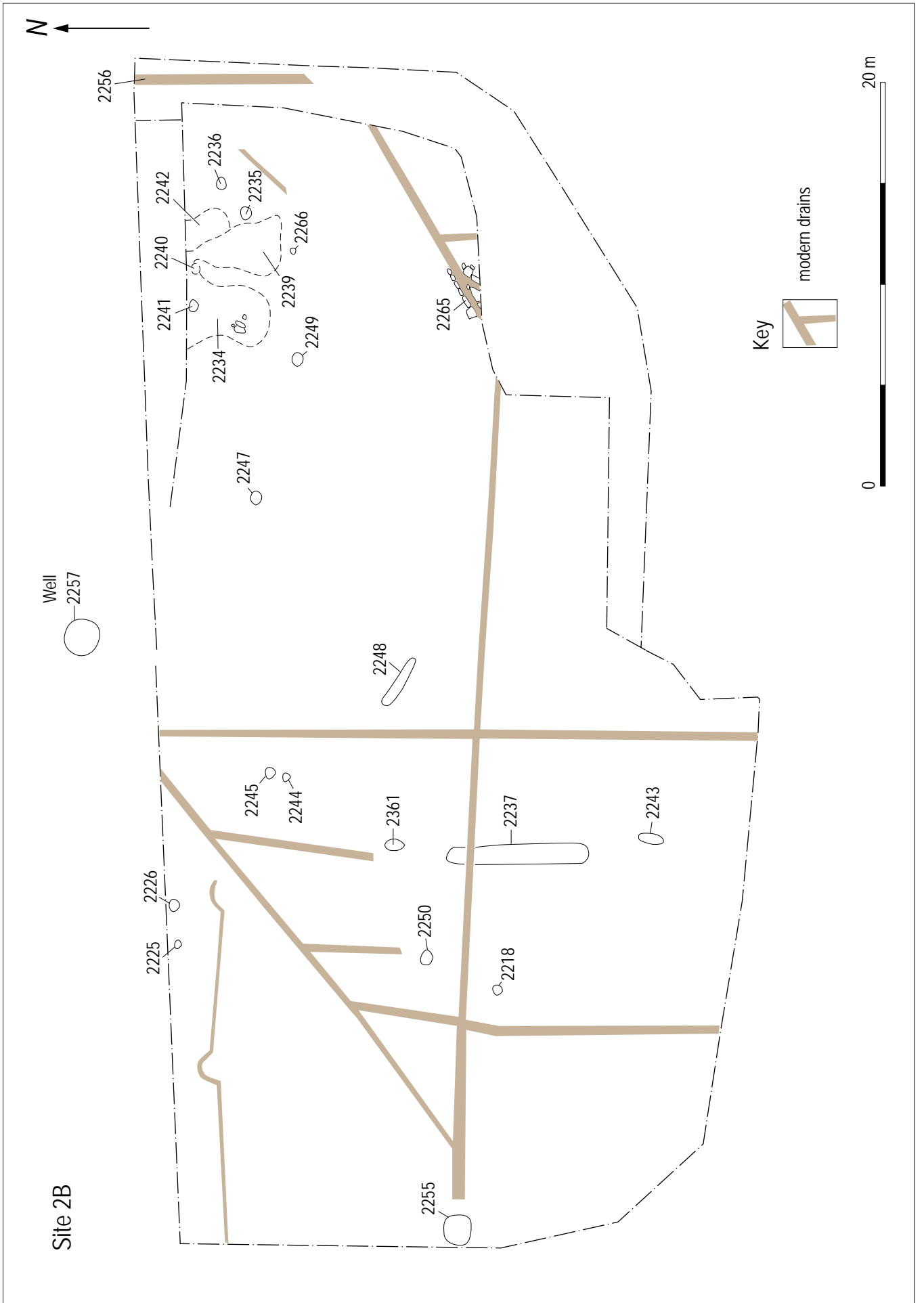

Figure 3: Plan of Site 2B.

Two circular features (2241) and (2240) were cut into this surface, but were not excavated. This cobbled surface may have continued as the rough stoney surface (2242) set within clay sand (2238), which contained Medieval and modern pottery and clay pipe fragments. To the east of this surface were an oval-shaped feature (2235), which contained Medieval pottery and clay pipe fragments, and a circular feature (2236). Medieval pottery was retrieved from the surface of feature (2236). To the south of the cobbles was a small, circular feature (2266) which was not excavated. A stone-filled linear feature was also partly exposed [2267], but was not excavated.

About 3 m to the north of Site 2B (outside the tram corridor), a stone-lined well (2257) was found. This had been capped with a large, re-used quernstone, which was broken into four pieces by the weight of the dumper trucks. The quernstone had a diameter of about 1.30 m. The well was drained of water and found to be at least 2.2 m deep and had an internal diameter of 1.5 m. It was constructed of approximately 14 courses of rough, angular stones with no mortar (see Plate 9). The broken quern stone was retrieved and the well backfilled with gravel.



Plate 9:
Stone-built well (2257).

<i>Context No</i>	<i>Type</i>	<i>Length (m)</i>	<i>Width (m)</i>	<i>Depth (m)</i>	<i>Interpretation</i>
2218	cut	0.43	0.43	0.10	Possible post-hole, fill (2254)
2235	cut	0.35	0.35	-	Not excavated
2236	fill	0.20	0.20	-	Not excavated
2237	cut	8.0	1.0	0.12	Medieval field boundary, fill (2211)
2240	fill	0.25	0.25	0.25	Not excavated
2241	fill	0.25	0.25	0.25	Not excavated
2244	cut	0.24	0.24	0.07	Possible post-hole, fill (2231)
2245	cut	0.50	0.50	0.07	Possible post-hole, fill (2230)
2247	cut	0.30	0.30	0.18	Possible post-hole, fill (2232)
2248	cut	3.0	0.50	0.05	Linear feature, fill (2228)
2249	cut	0.16	0.16	0.07	Possible post-hole, fill (2233)
2250	cut	0.77	0.75	0.20	Possible post-hole, fill (2251)
2266	fill	0.20	0.20	-	Not excavated
2267	cut	2.50	0.5	-	Field drain, not excavated

A rough cobbled surface was discovered in the north-east corner of Site 2B at a depth of 1.5 m below ground level which could be the remnants of a Medieval surface. The depth of the cobbling was not investigated as it was to be preserved *in situ*. Several sherds of Medieval pottery were found lying on the surface of the cobbling, while modern pottery and clay pipe fragments were found within the layer which immediately sealed the cobbles. The cobbling was therefore interpreted as a possible Medieval surface which had survived within a hollow. The level of this surface would have been at about the same level as the west end of Site 2A, on the other side of the access road from the Gogar Cabinetworks. There is therefore considerable made-up ground beneath this road.

The west side of Site 2B had been severely truncated, probably when the site was levelled for the construction of buildings in the nineteenth and twentieth centuries. The drains for these buildings were visible, cut into natural subsoil. The well found outside the corridor corresponds to a 'Pump' shown on a plan dating to the early nineteenth century (copy held by Gogar Cabinetworks). This well had presumably gone out of use by 1829, as it is not shown on a plan of Nether Gogar dated 1829 (Sneddon & Will 2006, Figure 4). The only possible Medieval feature in the west part of the site was a linear feature (2211). The alignment of this feature, at right angles to the main road, would suggest that it was a Medieval field or property boundary.

7.3 Site 2C (Figure 4)

After the layers of overburden were removed in two stages, initially over the east side (which was then backfilled) and then over the west side. The surface deposit extended across the whole area and consisted of modern building debris (2205) to a depth of about 0.4 m. Beneath this was a layer of red industrial blase (2206) which was 0.15 – 0.20 m deep, forming the surface of a modern car park.

In the east side of Trench 2C, the red blase (2206) sealed an homogenous layer of brown clay silt (2207) in the northern part of the site. In the southern part of the site was a layer of re-deposited natural (2223) which occurred a depth of 1.0 m from the surface and was up to 0.3 m deep. No features were observed cut into this layer and it was thought to be contemporary with layer (2207). The re-deposited natural (2223) sealed an L-shaped cut feature [2212], filled with angular stones which were laid flat and infilled with loose soil (2209/2210). There were no finds associated with this feature and it was interpreted as the rubble foundation for a post-Medieval building.



Plate 10:
The east part of Trench 2C.

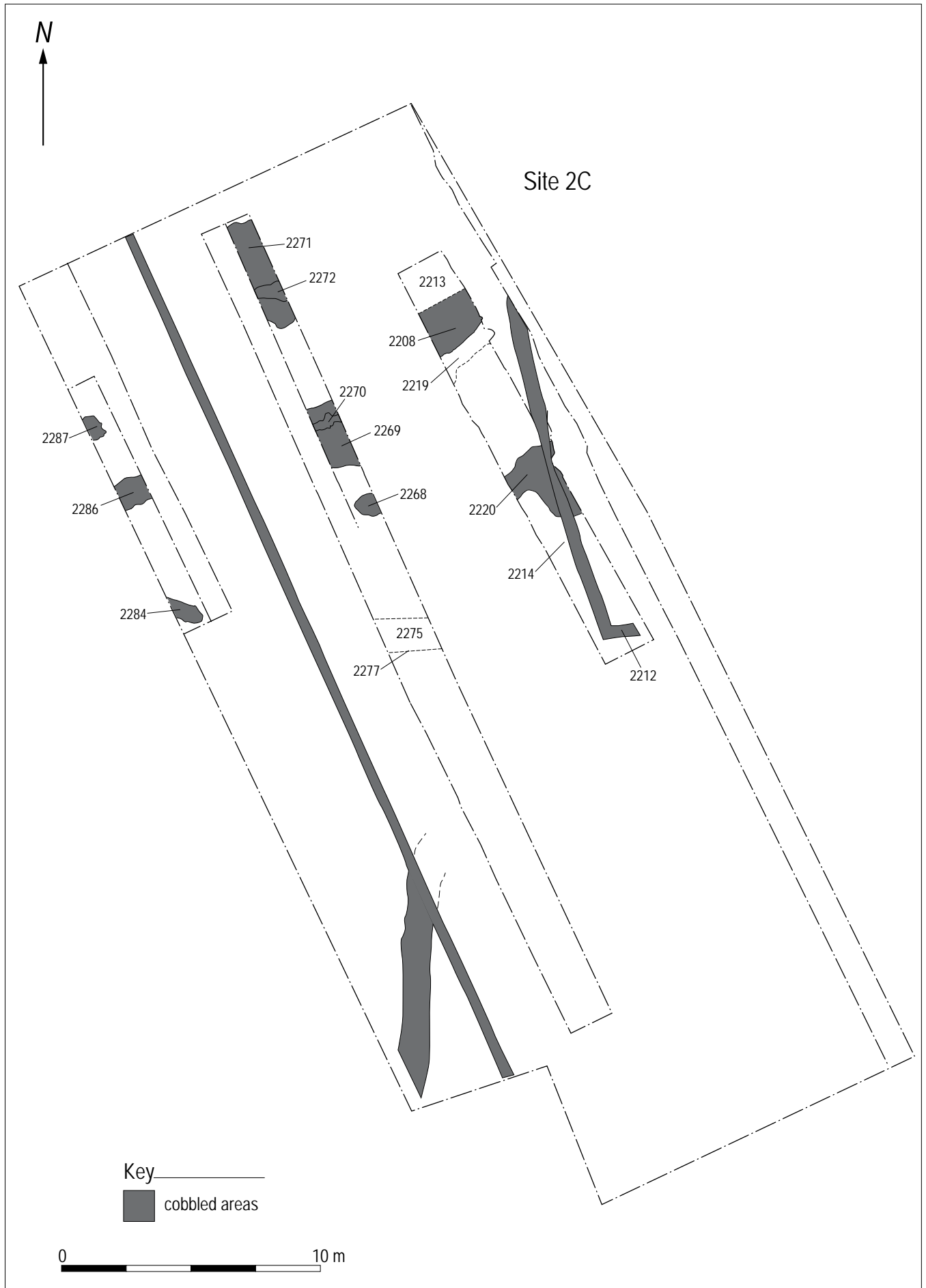

Figure 4: Plan of Site 2C.

The full depth of the brown clay silt (2207) was examined within Slot A. It was found to range in depth from 0.03 m in the south and north ends of the trenches and up to 0.60 m in the centre, infilling a hollow in the natural subsoil. It contained 18 sherds of Medieval pottery, a clay pipe bowl and two sherds of modern pottery.

Within the hollow (2213, 2214, 2224) and sealed by the brown clay silt (2207) were two patches of rough cobbling at a depth of about 1.2 m below the surface; cobbles (2208) lay in the north and cobbles (2220) lay in the south (see Figure 4 and Plate 10). Both areas of cobbles extended across the width of Slot A with a distance of c 5.0 m between them. The cobbles (2208) were 1.6 m wide and the cobbles (2220) were 1.8 m wide. Many of the Medieval pottery sherds recorded from layer 2207 were found sitting on top of these cobbled surfaces. There was a possible linear feature (2222) cut into the cobbles (2208), but this was not excavated. The cobbles (2220) had been cut by the foundation trench for the wall [2212] of the putative post-Medieval building.



*Plate 11:
Rough cobbled surface (2208).*

In the west side of Trench 2C, a square concrete pad, which had been the foundation for a mobile phone mast, occupied the south-west corner. Beneath the modern building rubble (2205) and blase (2206) was the layer of brown clay silt (2207). It was cut by a modern sewer pipe (2274), from which a possible late-Medieval coin was retrieved (SF 460).

Within Slot B, the brown clay silt (2207) was found to seal a compact layer of dark grey-brown clay (2276), which was between 0.05 and 0.10 m deep. The finds retrieved from layer (2276) included a clay pipe stem, Medieval and modern pot sherds, mammal bones and a fragment of glass. The dark grey-brown clay (2276) sealed three patchy areas of rough cobbling (see Figure 4 and Plate 11). In the south, this consisted of rough cobbles (2271) which extended for a distance of at least 4.6 m, with clay bonding (2283) beneath and a possible line of walling (2272). To the north of this was a further patch of rough cobbling (2269) and a possible drystone wall (2270). A further small patch of cobbling (2268) was found to the north of (2270/2269). At the north end of Slot B was a linear feature [2277] which was aligned north-west/south-east and was 1.2 m wide. It was 0.05 m deep and filled with light grey silt clay (2275); it contained no finds.

At the north end of Slot C was a wall (2284), aligned north-west/south-east and continuing for a distance of 1.70m. It consisted of one course of large drystone boulders within a cut [2285] in the natural subsoil (see Plate 13). Two sherds of modern pottery were retrieved from the walling (2284).



*Plate 12:
Areas of rough cobbles in west part of Site 2C.*

At a distance of 4.0 m to the south of wall (2284) was a small patch of rough cobbles (2286), 1.20 m wide. These cobbles lay between 0.10 m and 0.20 m deep over natural subsoil. At a distance of 2.6 m south of the cobbles (2286) were the remains of a possible wall (2287), which was 0.90 m wide and constructed of a single course of large boulders. Between the wall (2287) and the concrete pad was a linear feature [2282], filled with light grey silty clay (2281), with a maximum depth of 0.2 m. This feature was aligned south-west/north-east, was cut into natural subsoil and contained no finds. No similar hollow was noted within Slots B and C.



*Plate 13:
Wall in north-west corner of Trench 2C.*

<i>Context No</i>	<i>Type</i>	<i>Length (m)</i>	<i>Width (m)</i>	<i>Depth (m)</i>	<i>Interpretation</i>
2212	cut	13.70	0.55	0.40	Cut for wall foundation, fill (2209 & 2210)
2277	cut	5.0	1.40	0.05	Linear feature fill with 2275
2282	cut	9.40	1.00	0.20	Linear feature fill with (2281)
2285	cut	1.70	-	0.30	Cut for wall 2284

Site 2C revealed the presence of several patches of rough cobbling at a depth of about 1.2 m below the present surface. Two of these areas of cobbling had possible drystone walling associated with them [2272] and [2270]. Medieval pottery was retrieved from the surface of the cobbling, and so these surfaces have been interpreted as being Medieval in date. There were three possible wall lines crossing Site 2C, cut into natural subsoil; these have been interpreted as post-Medieval in date because of the finds retrieved from them. A deep, homogenous deposit (2207) sealed the Medieval surface, incorporating Medieval finds, but also containing modern artefacts. This layer was interpreted as a re-deposited ploughsoil used to level up the hollow. The L-shaped feature [2212] was interpreted as the corner of a nineteenth-century building, perhaps the School shown on the plan of Nether Gogar in 1829 (Sneddon & Will 2006, Figure 4).

7.4 Site 2D (Figure 5)

The topsoil across Site 2D (2359) ranged between 0.50 m deep in the west to 0.70 m deep in the east, above natural subsoil (2358/2360). The topsoil contained Medieval and modern pottery. Nine ceramic field drains were cut into the subsoil, aligned north/south and spaced about 5.5 m apart. These included (from west to east): [2319]; [2313]; [2312]; [2289]; [2296]; [2352], fill (2329); [2353], fill (2330); [2333], fill (2301), and [2349], fill (2331). There were also four stone-filled field drains which were aligned roughly south-west/north-east and included: [2322], fills (2321) and (2345); [2302]; [2303]; [2304]; [2305], and [2307]. Drain [2322], fill (2321) contained modern pottery and mammal bone and [2302] contained modern pottery. Two short remnants of field drains – [2328], fill (2327) and [2335], fills (2311) (2337) and 2338) – were aligned north/south and extended beyond the northern trench edge. Both (2327) and (2331) contained modern pottery. Where a stratigraphic relationship could be determined, the stone-filled drains were earlier than the ceramic drains. A small circular feature [2325], fill (2300) between drains [2352] and [2353] may have been a post-hole. Another circular feature [2324], fill (2310) contained modern pottery.

Extending for a considerable length across Site 2D were three linear features: [2332], fill (2278), [2350], fill (2348) and [2357], fill (2351). They ran parallel for some distance before feature [2332] merged with [2350]. The southern feature [2357] was severely truncated and survived as several segments. These linear features were investigated by means of seven slots. The fill of all three ditches contained a small amount of Medieval pottery and the fill of the middle ditch [2350] also contained an iron nail. Feature [2340], fill (2339) was a possible continuation of the linear feature [2357]. It contained no finds. In the base of the central linear feature [2348] were slight grooves cut into subsoil between 2.20 m and 2.4 m apart, which were interpreted in the field as a series of cart tracks. The flanking linear features may have been hedgerows or drainage ditches.

Emerging out of the northern trench edge was a shallow curving ditch [2288], fill (2279), which formed about 20% of the circumference of a circle with a diameter of about 14 m. No finds were retrieved from this feature. The ephemeral remains of a second linear feature were observed to the east of the curving ditch, consisting of a possible post-hole [2344], fill (2334), and a linear feature [2323/2326], fill (2280). The possible post-hole [2344] contained stones and charcoal. Neither of these features contained any finds.

The remaining contexts were either modern features or remnants of topsoil.

<i>Context No</i>	<i>Type</i>	<i>Length (m)</i>	<i>Width (m)</i>	<i>Depth (m)</i>	<i>Interpretation</i>
2288	cut	7.0	0.28	0.05	Ring ditch fill is (2279)
2323	cut	4.0	0.5	0.15	Possible ditch
2324	cut	0.70	0.70	0.70	Circular feature fill (2310)

<i>Context No</i>	<i>Type</i>	<i>Length (m)</i>	<i>Width (m)</i>	<i>Depth (m)</i>	<i>Interpretation</i>
2325	cut	0.34	0.30	0.10	Possible post-hole (fill 2300)
2332	cut	35	1.0	0.10	Ditch. Fill is (2278)
2340	cut	1.7	0.9	0.15	Possible ditch, fill (2339)
2344	cut	0.55	0.50	0.28	Possible post-hole (fill 2334)
2350	cut	55	3.0	0.25	Ditch. Fill is (2348)
2357	cut	49	1.0	0.20	Ditch. Fill is (2351)

The agricultural use of this area in the eighteenth to twentieth centuries explains the presence of more than one phase of field drains, which are necessary here because of the heavy clay subsoil.

The most archaeologically significant features in this trench were the three extensive linear features, and two curving ditches. The central linear feature has been interpreted as a trackway with either hedgerows or drainage ditches to either side. The Medieval pottery was confined to these linear features which were not contaminated with later material, and so are thought to be Medieval in date.

Only a very small part of the circumference of the curving ditch [2288] was uncovered within the trench, the remainder presumably surviving outside the corridor to the north. It may have been the foundation trench for a palisade enclosing further activity, such as a Medieval corn drying kiln (see Trench 2A) or perhaps a prehistoric structure. The curving linear feature [2323] may be the ephemeral remains of another structure.



*Plate 14:
Curving ditch [2288].*

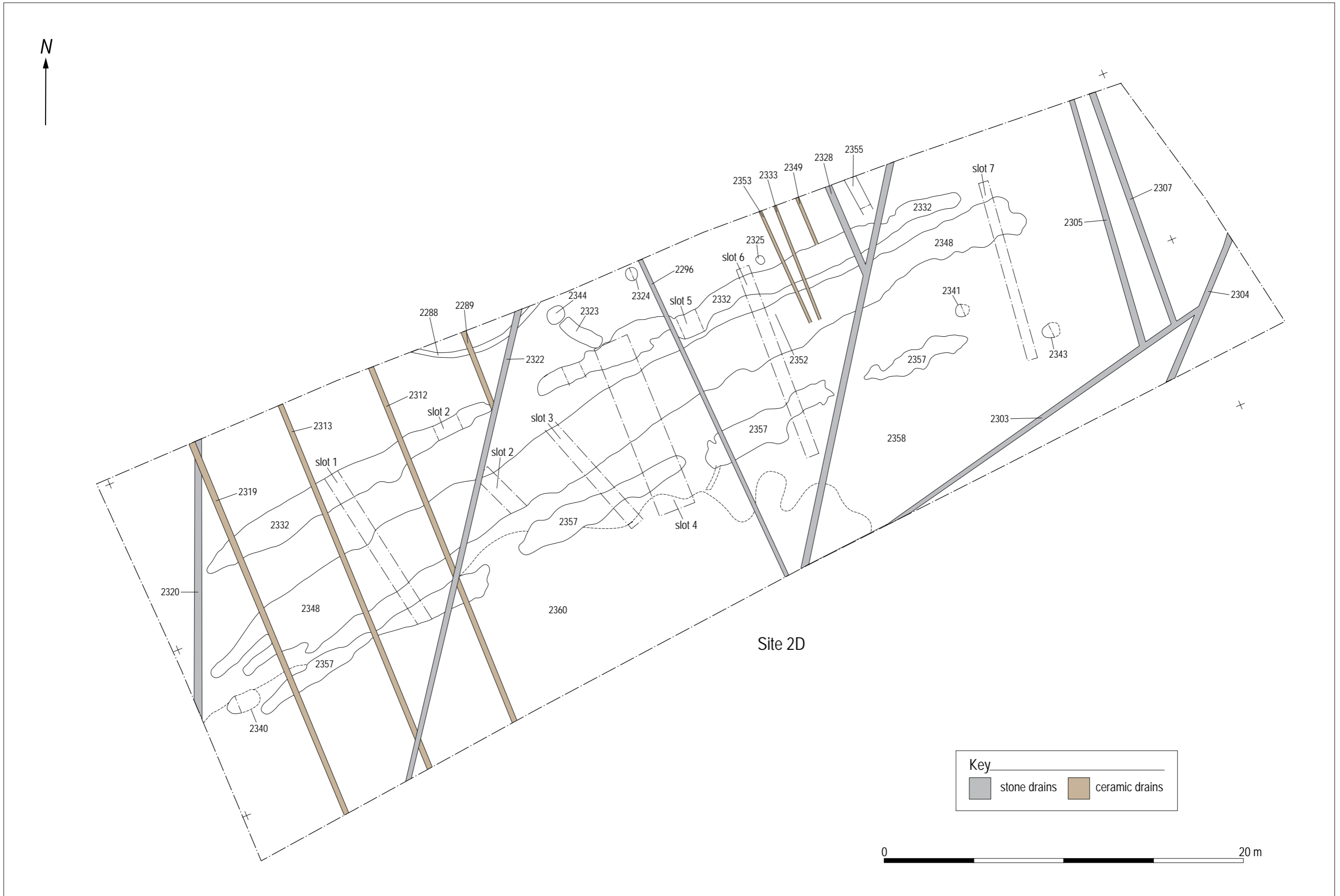

Figure 5: Plan of Site 2D.

8.0 Discussion

8.1 *Summary of the Fieldwork Results*

The excavations at Site 2, Gogar Church revealed significant archaeological remains relating to the Medieval settlement of Nether Gogar. They included a cobbled courtyard, a corn drying kiln, a trackway, a complex system of ditches and patches of rough cobbling. These features have been interpreted as Medieval in date because of the presence of both White Gritty Ware (dating from the twelfth to fifteenth centuries) and Reduced Redwares (dating from the fourteenth to sixteenth centuries). Unfortunately, no structures were identified; this may have been because of the narrow width of the corridor and the severely plough truncated nature of the site.

The Medieval horizon was sealed by ploughsoil which contained modern pottery and clay pipe fragments. This indicates that, although activity continued on the site in the post-Medieval period, much of the area examined within the corridor was used for agriculture rather than settlement. The excavated sites were criss-crossed with both stone-filled and ceramic field drains, reflecting this agricultural use. The buildings associated with the settlement of Gogar have still to be identified and they may well lie outside the corridor, either to the south nearer the main road or to the north, nearer the church.

Sites 2B and 2C were finally sealed by deep deposits of building debris from demolished buildings which fronted the main road in the nineteenth and twentieth centuries. While the historical records suggest that the site was cleared in the early nineteenth century, the archaeological and historic map evidence indicates that it was soon re-occupied to the south of the re-built church.

8.2 *Interpretive Issues*

Archaeological evidence for Medieval rural settlement is still remarkably sparse, thus increasing the value of any rural sites which are discovered and excavated. The few notable sites which have been found, such as Springwood Park (Dixon 1998) and Eldbotle (Dutton & Morrison), show that evidence for buildings in the Medieval period can consist of very ephemeral remnants of clay walls and post-holes as well as more substantial stone built foundations.

The historical records relating to the Medieval rural settlement of Nether Gogar have been examined in detail in a recent article describing the excavations at the Gogarbun Headquarters in an adjacent field (Morrison *et al* forthcoming). It has been suggested that, after a period of settlement during the twelfth to fourteenth centuries, the site was abandoned during the fifteenth and sixteenth centuries, perhaps because of warfare and plague, but was re-occupied by the seventeenth century and was finally cleared in the early nineteenth century. The analysis of the pottery, clay pipe fragments and soil samples from the current programme of works will help to establish whether this sequence applies to the whole site and to clarify the character of the activity which took place here.

The samples from the corn drying kiln in particular should provide carbonised grain, which will indicate what crops were being processed and when the kiln was in use. It will be very useful to compare the results from this corn drying kiln with the two probable prehistoric kilns found at Gogar Mains (Site 1, James 2008). There are thought to have been at least two mills in the vicinity of Gogar, one Medieval in date and one which was described as 'new' in the sixteenth century (Morrison *et al* forthcoming). It is possible that the large quernstone which was recovered from above the well in Site 2B belonged to the 'new' mill of Gogar, before it went out of use in the early nineteenth century, enabling it to be re-used as a well cover.

The dating of deposits and features from Nether Gogar will rely on radiocarbon dates from carbonised plant remains and on the presence of Medieval pottery, which has a very broad date range. There is plenty of evidence for residual Medieval material among the later clay pipes and modern pottery, such as the possible late-Medieval coin found in a modern sewer pipe trench. There is therefore a potential danger of wrongly assigning features to the Medieval period if they happened to contain Medieval pottery and no other material. Equally, there may be residual charcoal which, with the absence of pottery, may lead to the erroneous assignment of early dates. Wherever possible, radiocarbon dates and pottery will be combined to obtain secure dates with reasonable confidence.

9.0 Recommendations

No further fieldwork is recommended on these sites. The remainder of the tram corridor is to be covered

by a watching brief during topsoil stripping. A costed Post-excavation Research Design has been prepared for the samples and artefacts from this site and forms a separate report.

10.0 Acknowledgements

The project was managed for TIE by Phil Douglas and for the City of Edinburgh Council by John Lawson (CECAS). The project was managed for GUARD by Bob Will and Gavin MacGregor. It was directed by Heather F James and Dave Swan. The excavators included Chris Bowles, Ross Cameron, Eilidh Campbell, Tom Horne, Sean Lüttage, Maureen Kilpatrick, Mark MacDonald, Donna Maguire, Juha Martilla, Nicole Mheehan, Kevin Mooney, Paul Murtagh and Tessa Poller. Technical assistance was provided by Aileen Maule and John Kylie. The illustrations were provided by John Arthur, Gillian McSwan and Caitlin Evans. This report was edited by Olivia Lelong and DTP'd by Jen Cochrane. The authors would also like to thank Headland Archaeology Ltd for allowing us to see the forthcoming report on their work at Gogar.

11.0 Bibliography

James H F 2008 *Edinburgh Tram Scheme: Excavations at Gogar Mains* (GUARD Report 2600.1).

Morrison, J 2002, *Gogarburn Headquarters Project: An Archaeological Evaluation on Land formerly owned by the Church of Scotland*, Unpublished report by Headland Archaeology Ltd.

Morrison, J 2003, *Excavation of the Land to the North of the A8, Gogarburn Headquarters Project, Gogarburn Edinburgh*, Unpublished report by Headland Archaeology Ltd.

Morrison J 2007 'Gogar, Archaeological and Historical Evidence for a Lost Medieval parish near Edinburgh' *Proc Soc Antiq Scot* (in press).

Sneddon D & Will R 2006 *Edinburgh Tram Scheme Work Strands 3 and 4 Archaeological Evaluation. Data Structure Report*. Unpublished Report GUARD 2235.

12.0 Appendices

12.1 List of Contexts

<i>Area</i>	<i>Context</i>	<i>Description</i>	<i>Interpretation/Relationships</i>
2A	2000	Loose mid brown silty clay	Topsoil
2A	2001	Sticky red/brown silty clay	Subsoil
2A	2002	Mid grey/brown silty clay	Midden spread or occupation debris above (2003)
2A	2003	Cobbled surface below (2002)	Cobbled surface of courtyard
2A	2004	Medium-heavy compaction mid brown sandy silt	Upper fill in corn drying kiln
2A	2005	Linear stone structure	Stone field drain
2A	2006	Medium-heavy compaction dark grey/brown clay sand	Fill of linear feature, cut [2043]
2A	2007	Medium compaction dark grey/brown clay sand	Fill of 2053 & 2054
2A	2008	Compact mid brown clay silt	Fill of trench [2033] around corn-drying kiln
2A	2009	Medium/heavy compaction red/medium brown silty clay	Fill of linear ditch [2079]
2A	2010	Medium compaction dark grey/brown silt clay	Fill of linear cut [2080]
2A	2011	Grey/brown silty clay with charcoal flecks	Linear feature
2A	2012	Loose/medium compaction dark grey/brown sand/silt	Shallow linear scoop [2058]
2A	2013	Ceramic field drain	Post-medieval field drain
2A	2014	Medium compaction mid grey/brown silty clay	Fill of flue of corn-drying kiln
2A	2015	Compact light brown sandy silt	Fill of 2095.
2A	2016	Shallow deposit of dark brown soil	Topsoil
2A	2017	Medium compaction light brown/sand colour silt	= 2120, fill of 2132/2122
2A	2018	Medium-heavy compaction orange/brown gravel	Natural deposit
2A	2019	Medium-heavy compaction red/brown silt	Fill of 2118
2A	2020	Dark patch	Topsoil
2A	2021	Dark patch	Topsoil
2A	2022		Non archaeological
2A	2023	Large angular stones	Fill of field drain[2050]
2A	2024	Grey mottled silty sand	Natural subsoil
2A	2025	Loose-medium compaction light/mid brown sandy soil	Fill of field drain [2049]
2A	2026	Loose light brown sand/silt	Fill of field drain [2047]
2A	2027	Ceramic field drain	Post-medieval field drain
2A	2028	Compact light brown sandy silt	Buried medieval soil above (2024)
2A	2029	Rounded stones and small boulders	Possible small cairn
2A	2030	Sub-circular drystone structure	Stone lining of corn-drying kiln
2A	2031		Non archaeological

<i>Area</i>	<i>Context</i>	<i>Description</i>	<i>Interpretation/Relationships</i>
2A	2032	Medium-heavy compaction mid brown sandy silt	Lower fill of corn-drying kiln
2A	2033	Curvilinear cut	Foundation trench for structure surrounding corn-drying kiln
2A	2034	Loose black ash	Remnants of burning at base of corn-drying kiln
2A	2035	Pear-shaped cut	Construction cut for corn-drying kiln
2A	2036	Medium-heavy compaction dark grey/brown clay/sand	Fill of circular cut [2037]
2A	2037	Circular cut	Filled with 2036
2A	2038	Sub-circular drystone floor	Floor of corn-drying kiln
2A	2039	V-shaped cut	Possible flue of corn-drying kiln
2A	2040	Dark brown clay/silt	Fill of posthole [2041]
2A	2041	Circular cut	Cut of posthole, fill (2040) near to trench [2008]
2A	2042	Gray clay	Natural deposit
2A	2043	Linear cut	Fill (2006)
2A	2044	Linear cut	Cut for field drain
2A	2045	Loose-medium compaction light grey/brown sand/clay	Fill in field drain cut [2044]
2A	2046	Fractured granite	Natural bedrock
2A	2047	Linear cut	Cut of possible medieval field drain
2A	2048	Dark staining in subsoil adjacent to corn-drying kiln	Water over spill from kiln
2A	2049	Linear cut	Cut of field drain
2A	2050	Linear cut	Cut of field drain
2A	2051	Mid-brown silty clay	Deposit within cobbles (2052)
2A	2052	Layer of rough cobbles/large stones	Rough cobbled surface at west end of
<i>Area 2A</i>			
2A	2053	Linear cut	Filled with 2007; ditch
2A	2054	Linear cut	Filled with 2007; ditch
2A	2055		= 2055
2A	2056	Loose-medium compaction dark grey/brown sandy clay	Fill of oval cut [2057]
2A	2057	Circular/oval cut	Possible post hole, fill 2056
2A	2058	Shallow scoop	Fill 2012
2A	2059	Stone spread within 2002	Possible levelling deposit
2A	2060	Linear cut	Field drain
2A	2061	Linear cut	Field drain
2A	2062	Linear cut	Field drain
2A	2063	Loose mid grey gritty silt	Fill of [2014] kiln flue = 2048
2A	2064	Linear cut	Fill 2133
2A	2065	Two parallel lines of boulders and stones	Flue of kiln
2A	2066	Heavily compacted dark brown linear spread	Topsoil.
2A	2067	Orange/brown sandy silt	Possible linear feature
2A	2068	Loose-medium compaction dark grey soil	Field drain
2A	2069	Grey silt	Fill of a feature

<i>Area</i>	<i>Context</i>	<i>Description</i>	<i>Interpretation/Relationships</i>
2A	2070	Medium-heavy compaction grey/brown silty clay	Fill of linear cut [2071]
2A	2071	Linear cut	Linear feature, fill 2070
2A	2072	Medium-heavy compaction orange/brown silty clay	Upper fill of modern ditch [2078]
2A	2073	Medium compaction dark grey/brown sandy silt	= (2075); Fill of linear ditch [2091]=[2086]
2A	2074	Medium compaction mid brown silty sand	Fill of pit [2096]
2A	2075	Medium compaction gray/brown silty sand	= (2073)Fill of [2086]=[2091]
2A	2076	Medium compaction red/brown sandy silt	Fill of linear cut [2129]
2A	2077	Loose-medium compaction dark grey sandy clay	Lower fill of modern machine cut [2078]
2A	2078	Rectangular cut	Modern machine cut fills 2077 & 2072
2A	2079	Linear cut	Fill 2009, possible drain or field boundary
2A	2080	Linear cut	Fill 2010
2A	2081	Linear cut	Ceramic field drain
2A	2082	Heavily compacted orange/brown sand	Possible animal burrow
2A	2083	Medium compaction brown/orange sand with clay inclusions	Fill of 2099. Linear feature
2A	2084	Medium compaction grey/brown sandy silt	Fill of possible ditch [2085]
2A	2085	Linear cut	Possible ditch. May = [2091]
2A	2086	Curvilinear cut	= [2091]. Fill is (2075)
2A	2087	Medium compaction light-mid brown silty sand	Same as (2083). Fill of linear cut [2102]
2A	2088	Medium to loose orange/red/brown silt	Fill of linear cut [2125]/[2105]
2A	2089	Medium compaction mottled dark brown and yellow/brown silt	Upper fill of [2109]
2A	2090	Medium compaction red/brown sandy silt with occasional small pebbles	Fill of linear cut [2131]
2A	2091	Linear cut	= [2086]. Fill is 2073
2A	2092	Linear cut	Possible field boundary, fill 2082
2A	2093	Medium compaction grey/brown silty sand	Fill of pit [2094]
2A	2094	U-shaped cut	Pit with fill 2093
2A	2095		Natural
2A	2096	Circular cut	Possible pit
2A	2097	Linear cut	Stone-lined field drain
2A	2098	Orange/brown sand with frequent stones and boulders	Natural subsoil
2A	2099	Linear cut= [2102].	Fill is 2083
2A	2100	Medium compaction light brown/orange sandy silt	Fill of cut [2107]
2A	2101	Medium compaction light brown/ orange clayish sand	Fill of cut [2108]
2A	2102	Linear cut	Possible field boundary. Same as [2099]
2A	2103	Heavily compacted dark brown sandy silt	Fill of 2123
2A	2104	Medium compaction dark brown sandy silt	Fill of possible field boundary [2124]

<i>Area</i>	<i>Context</i>	<i>Description</i>	<i>Interpretation/Relationships</i>
2A	2105	Medium compaction dark brown sandy silt	Fill of possible field boundary [2125]
2A	2106	Ceramic field drain	Field drain
2A	2107	Oval shaped cut	Fill is 2100
2A	2108	Circular cut	Fill is 2101
2A	2109	Irregular shaped cut	Fill is 2089
2A	2110	Heavily compacted dark brown sandy clay	Possible animal burrow, fill of [2111]
2A	2111	Heavily compacted dark brown sandy clay	Possible animal burrow
2A	2112	Heavily compacted mid brown silty clay and frequent small stones	Fill of shallow scoop [2119]
2A	2113	Linear patch of heavily compacted dark brown sand	Possible topsoil
2A	2114	Medium compaction light/dark brown silt	= 2006, fill of 2146
2A	2115	Loose-medium compaction light brown/orange sand	Linear feature, possible continuation of 2007, fill of [2128]
2A	2116	Loose compacted mid/dark brown clay silt with coal inclusions	Re-deposited natural with some mixed midden material
2A	2117	Rectangular cut with linear extensions to east and west	Cut for fire flue within corn-drying kiln
2A	2118	Cut of oval shaped pit	Fill 2019, possible pit
2A	2119	Oval shaped cut	Shallow scoop, fill 2112
2A	2120	Loose medium compaction brown/orange sand	Fill of [2122]
2A	2121	Loose mid-brown silt in a circular cut	Possible post-hole
2A	2122	Linear cut	= [2132], fill is 2120,
2A	2123	Linear cut	Fill is 2103
2A	2124	Linear cut	Fill is 2104
2A	2125	Linear cut	Cut of possible field boundary, fills 2126 & 2105
2A	2126	Loose light grey sandy silt	Basal fill of 2125, below 2105
2A	2127	Linear cut	= 2146 & 2043, fills 2114 & 2006
2A	2128	Linear cut	Fill 2115
2A	2129	Linear cut	Fill 2076
2A	2130	Heavily compacted sandy clay	= 2134
2A	2131	Linear cut	Fill 2090
2A	2132	Cut of linear feature	= [2122], Fill 2120
2A	2133	Firm mid-grey/brown clay silt	Fill of [2064]
2A	2134	Square-shaped cut	Possibly modern
2A	2135	Heavily compacted mid grey/brown silty clay	Fill of possible drain [2141]
2A	2136	Heavily compacted mid grey/brown silty clay	Fill of [2142]
2A	2137	Moderate compact, dark-grey brown silty clay	Fill of pit [2138]
2A	2138	Oval-shaped cut	Fill is 2137
2A	2139	Oval- shaped cut	Natural
2A	2140	Heavily compacted dark brown sandy clay	Fill of [2139]
2A	2141	Linear cut	Possible drain, fill 2135
2A	2142	Linear cut	Possible drain or truncated rig & furrow
2A	2143	Moderate hard, dark grey brown silty clay	= 2168, fill of [2169]

<i>Area</i>	<i>Context</i>	<i>Description</i>	<i>Interpretation/Relationships</i>
2A	2144	Bowl-shaped cut	= 2169
2A	2145	Waterlogged tree trunk & roots	Within 2143 and cut
2A	2146	Linear cut	= 2127 & 2043, fill is 2114
2A	2147	Loose grey-brown silty clay	Fill of [2158]
2A	2148	Loose light brown sandy silt	Fill of [2157]
2A	2149	Pear-shaped hollow	Natural
2A	2150	Linear feature	Possible field drain
2A	2151	Oval-shaped hollow	Natural
2A	2152	Rectangular-shaped feature	Topsoil
2A	2153	Linear feature	Plough mark? Cuts 2105
2A	2154	Linear feature	Plough mark, cut [2253]
2A	2155	Not used	
2A	2156		Topsoil
2A	2157	Linear cut	Fill 2148
2A	2158	Curving ditch	Fill 2147
2A	2159	Possible pit	Non-archaeological
2A	2160	Possible post-hole	Non-archaeological
2A	2161	Possible post-hole	Non-archaeological
2A	2162	Possible post-hole	Non-archaeological
2A	2163	Possible post-hole	Non-archaeological
2A	2164	Possible post-hole	Non-archaeological
2A	2165	Medium compact dark brown sandy silt	Fill of [2166/2167]
2A	2166	Linear cut	Fill 2165
2A	2167	Linear cut	Fill 2165
2A	2168	Moderate compacted, very dark grey brown silty clay	Fill of [2169]
2A	2169	Bowl-shaped cut	Fill 2143, 2168
2A	2170	Oval-shaped feature	Non-archaeological
2A	2171	Loose light brown grey sandy silt	Fill of [2172]
2A	2172	Linear cut	Fill is 2171
2B	2200	Building debris & blase	Modern infill & car parks surface
2B	2201	Compact olive green/grey clay sand	Fill linear feature
2B	2202	Compact grey/brown clay	Post-medieval layer below 2201
2B	2203	Compact grey orange/brown clay silt	Fill of [2256]
2B	2204	Compact mid-grey clay	Post-medieval layer below 2202
2C	2205	Loose building rubble	Demolition debris below mound
2C	2206	Compact pink blase	Modern car park surface
2C	2207	Compact brown clay silt	Post-medieval layer below 2206
2C	2208	Rough cobbles	Medieval surface below 2207
2C	2209		= 2210
2C	2210	Angular stones	Fill of [2212]
2B	2211	Compact dark-grey brown sandy clay	Fill of [2237]
2C	2212	Foundation cut	Filled with 2210
2C	2213	Light yellow brown clay with stones	Natural subsoil
2C	2214	Light yellow brown clay with stones	Natural subsoil

<i>Area</i>	<i>Context</i>	<i>Description</i>	<i>Interpretation/Relationships</i>
2B	2215	Loose light grey brown silty clay	Possible continuation of 2211
2B	2216	Compact orange brown sandy gravel	Natural subsoil
2B	2217	Compact dark grey brown sandy clay	Fill of [2243]. Possible continuation of 2211
2B	2218	Circular cut	Filled by (2254)
2B	2219	Linear cut	Not archaeological
2C	2220	Rough cobbles	Medieval surface under 2207
2C	2221	Sub-circular feature within 2208	Not excavated
2C	2222	Linear feature within 2208	Not excavated
2C	2223	Mixed orange brown boulder clay	Re-deposited natural, over 2210
2C	2224	Orange brown boulder clay	Natural subsoil
2B	2225	Mottled grey orange sand silt	Non archaeological
2B	2226	Loose dark-grey brown silty clay	Modern feature
2B	2227	Loose grey-brown sandy clay	Fill of [2255]
2B	2228	Compact dark-grey sandy clay	Fill of [2248]
2B	2229	Compact dark grey gravel	Non archaeological
2B	2230	Loose dark grey brown silty clay	Fill of [2245]
2B	2231	Loose dark grey brown silty clay	Fill of [2244]
2B	2232	Compact mid-grey brown silty clay	Fill of [2247]
2B	2233	Compact dark grey brown sandy silt	Fill of [2249]
2B	2234	Rough cobbling	Medieval surface
2B	2235	Compact light grey brown clay	Fill of possible post-hole in 2238
2B	2236	Compact light grey brown clay	Fill of possible post-hole below 2204
2B	2237	Linear cut	Fill 2211
2B	2238	Compact grey brown clay sand	surface below 2234
2B	2239	Rough cobbled surface	Medieval surface below 2204
2B	2240	Compact dark grey brown sandy clay	Possible post-hole below 2204
2B	2241	Compact dark grey brown sandy clay	Possible post-hole below 2204
2B	2242	Rough cobbled surface	Medieval surface below 2204 above
2238			
2B	2243	Linear feature	Fill 2217
2B	2244	Cut of circular feature	Filled by (2231)
2B	2245	Cut of circular feature	Filled by (2230)
2B	2246	Circular feature	Non archaeological
2B	2247	Cut of sub-circular feature	Filled by (2232)
2B	2248	Cut of linear feature	Filled by (2228)
2B	2249	Cut of possible post hole, circular in plan	Filled by (2233)
2B	2250	Cut of sub-circular feature	Filled by (2251)
2B	2251	Hard compacted mid grey/brown sandy silt	Fill of [2250]
2A	2252	Ceramic drain	Field drain
2A	2253	Linear cut	Fill 2154
2B	2254	Hard compacted dark/grey brown gritty sandy clay	Fill of possible PH [2218]
2B	2255	Cut of ovoid shaped feature. Animal burrow	Filled by (2227), non archaeological
2B	2256	Cut of linear feature	Filled by (2203)

<i>Area</i>	<i>Context</i>	<i>Description</i>	<i>Interpretation/Relationships</i>
2B	2257	Stone lined well	Dry stone built well partially submerged with water
2B	2258	Modern ceramic field drain	
2B	2259	Modern ceramic field drain	
2B	2260	Modern ceramic field drain	
2B	2261	Modern ceramic field drain	
2B	2262	Modern ceramic field drain	
2B	2263	Modern ceramic field drain	
2B	2264	Modern ceramic field drain	
2B	2265	Modern stone lined drain	
2B	2266	Circular feature	Not excavated
2B	2267	Stone lined field drain	
2C	2268	Cobbled surface	
2C	2269	Cobbled surface	
2C	2270	Possible linear stone feature	
2C	2271	Cobbled surface	
2C	2272	Possible linear stone feature	
2C	2273	Cobbled surface	
2C	2274	Modern sewer	
2C	2275	Moderately compacted light grey/brown silty clay	Fill of [2277]
2C	2276	Hard compacted dark grey/brown clay	Clay covering (2271-2273)
2C	2277	Cut of linear feature	Fill is (2275)
2D	2278	Moderately compacted mid grey silty sand	Fill of [2332]
2D	2279	Moderately compacted dark brown/black sandy silt	Fill of [2288]
2D	2280	Moderately compacted dark brown/black sandy silt	Fill of [2323/2326]
2C	2281	Moderately compacted light grey/brown silty clay	Fill of [2282]
2C	2282	Cut of linear feature	Filled by (2281)
2C	2283	Hard compacted dark grey/blue clay	Possible bonding of cobbles (2271 & 2273)
2C	2284	Possible stone wall	
2C	2285	Cut of linear feature	Fill is 2284
2C	2286	Cobbled surface	
2C	2287	Possible walling	Badly robbed/disturbed wall
2D	2288	Cut of crescent shaped feature	Filled by (2279)
2D	2289	Modern ceramic field drain	
2D	2290	Natural stone	Non archaeological
2D	2291	Animal burrow	Non archaeological
2D	2292	Loosely compacted dark grey/brown silty sand	Fill of [2336]
2D	2293	Topsoil spread gathered around natural rock outcrop	Non archaeological
2D	2294	Spread filling natural depression	Non archaeological
2D	2295	Natural stone feature	Non archaeological

<i>Area</i>	<i>Context</i>	<i>Description</i>	<i>Interpretation/Relationships</i>
2D	2296	Modern field drain	
2D	2297	Topsoil spread within natural shallow	Non archaeological
2D	2298	Animal burrow	Non archaeological
2D	2299	Animal burrow	Non archaeological
2D	2300	Moderately compacted orange/brown sandy silt	Fill of [2325]
2D	2301	Moderately compacted dark grey/brown sandy silt	
2D	2302	Modern field drain	
2D	2303	Modern field drain	
2D	2304	Modern field drain	
2D	2305	Stone feature	Modern drain
2D	2306	Moderate to hard compacted grey brown/orange sandy silt	Fill of [2343]
2D	2307	Linear stone filled feature	Modern drain
2D	2308	Degraded stones	Non archaeological
2D	2309	Moderately compacted grey orange/brown sandy silt	Fill of [2341]
2D	2310	Moderate to hard compacted dark grey brown sandy silt	Fill of [2324]
2D	2311	Moderately compacted mottled brown/yellow orange sandy silt	Fill of [2335]
2D	2312	Modern ceramic field drain	
2D	2313	Modern ceramic field drain	
2D	2314	Degraded stones	Non archaeological
2D	2315	Modern field drain	
2D	2316	Modern field drain	= (2313)
2D	2317	Modern field drain	= (2313)
2D	2318	Linear feature	= (2348)[2350]
2D	2319	Modern field drain	
2D	2320	Modern field drain	
2D	2321	Moderately compacted dark brown sandy silt	Fill of [2322]
2D	2322	Cut of Linear feature drain	Filled by (2321) & rubble (2345). Field
2D	2323	Cut of crescent shaped feature	Filled by (2280) = [2326]
2D	2324	Cut of circular feature	Filled by (2310)
2D	2325	Cut of circular feature	Filled by (2300)
2D	2326	Cut of crescent shaped feature	= [2323]
2D	2327	Moderately compacted grey orange/brown sandy silt	Fill of [2328]
2D	2328	Cut of linear feature	Filled by (2327)
2D	2329	Hard compacted dark grey brown sandy silt	Fill of [2352]
2D	2330	Hard compacted dark grey/brown sandy silt	Fill of [2353]
2D	2331	Medium to hard compacted mid brown/grey sandy silt	Fill of [2349]
2D	2332	Cut of linear feature	Filled by (2278)
2D	2333	Cut of linear feature	Filled by (2301)

<i>Area</i>	<i>Context</i>	<i>Description</i>	<i>Interpretation/Relationships</i>
2D	2335	Cut of linear feature	Filled by (2311), (2337) & (2338)
2D	2334	Moderately compacted dark grey/brown sandy silt	Fill of [2344]
2D	2336	Ephemeral feature	Filled by (2292)
2D	2337	Loose to moderately compacted dark grey/brown silty sand	Fill of [2335]
2D	2338	Moderately compacted dark grey/brown clay with sand patches	Fill of [2335]
2D	2339	Hard compacted dark orange sand	Fill of [2340]
2D	2340	Cut of sub oval feature	Filled by (2339)
2D	2341	Cut of oval shaped feature	Filled by (2309). Modern feature
2D	2342	Natural depression/stone hole	Non archaeological
2D	2343	Cut of oval shaped feature	Filled by (2306), Modern
2D	2344	Cut of circular feature	Filled by (2334)
2D	2345	Linear stone structure/feature	Fill of [2322]
2D	2346	Stone hole	Non archaeological
2D	2347	Loosely compacted grey brown silty sand	Fill of stone hole 2346, non archaeological
2D	2348	Loose red/brown silty clay	Fill of linear feature 2350
2D	2349	Cut of linear feature	Filled by (2331)
2D	2350	Cut of linear feature	Possible trackway fill (2348)
2D	2351	Loose dark grey brown silty clay	Fill of linear feature [2357]
2D	2352	Cut of linear feature	Filled by (2329)
2D	2353	Cut of linear feature	Filled by (2330)
2D	2354		Unused
2D	2355		Unused
2D	2356		Unused
2D	2357	Cut of linear feature	Filled by (2351)
2D	2358	Hard compacted dark grey/orange clay with occasional sand patches	Natural subsoil
2D	2359	Moderate to hard compacted dark grey/brown silty clay	Topsoil and turf
2D	2360	Medium to firm compacted tallow/red silty clay with some large stone inclusions	Natural subsoil
2B	2361	Cut for 2215	Fill (2215)

12.2 List of Finds

<i>Exc. Code</i>	<i>SF no.</i>	<i>Context</i>	<i>Trench/Area</i>	<i>No. of SFs</i>	<i>Material Type</i>
2600	1	2002	2A 1	Bone	Mammal
2600	2	2002	2A 1	Bone	Mammal
2600	3	2002	2A 1	Bone	Mammal
2600	4	2002	2A 1	Ceramic	Medieval
2600	5	2002	2A 1	Ceramic	Medieval
2600	6	2002	2A 1	Ceramic	Medieval
2600	7	2002	2A 1	Ceramic	Medieval
2600	8	2002	2A 1	Ceramic	Medieval
2600	9	2002	2A 1	Ceramic	Medieval
2600	10	2002	2A 1	Lithic	Gun flint
2600	11	2002	2A 1	Ceramic	Medieval

<i>Exc. Code</i>	<i>SF no.</i>	<i>Context</i>	<i>Trench/Area</i>		<i>No. of SFs</i>	<i>Material Type</i>
2600	12	2002	2A	1	Ceramic	Medieval
2600	13	2002	2A	1	Bone	Mammal
2600	14	2002	2A	1	Ceramic	Medieval
2600	15	2002	2A	Several	Bone	Mammal
2600	16	2002	2A	1	Bone	Mammal
2600	17	2002	2A	1	Ceramic	
2600	18	2002	2A	1	Ceramic	
2600	19	2002	2A	1	Ceramic	
2600	20	2002	2A	1	Ceramic	
2600	21	2002	2A	1	Ceramic	
2600	22	2013	2A	1	Shell	Oyster
2600	23	2002	2A	1	Ceramic	
2600	24	2007	2A	2	Ceramic	
2600	25	2136	2A	1	Ceramic	
2600	26	2002	2A	1	Ceramic	
2600	27	2002	2A	3	Bone	Mammal
2600	28	2002	2A	2	Bone	Mammal
2600	29	2002	2A	1	Ceramic	
2600	30	2002	2A	Several	Bone	Sheep/Goat
2600	31	2002	2A	1	Shell	Oyster
2600	32	2028	2A	1	Ceramic	
2600	33	2000	2A	1	Bone	Sheep/Goat?
2600	34	2002	2A	1	Stone	Pot lid?
2600	35	1282	2A	1	Ceramic	Medieval
2600	35	1283	2A	1	Charcoal	
2600	36	2002	2A	Several	Bone	
2600	37	2002	2A	7	Ceramic	Medieval
2600	38	-	-	-	not allocated	
2600	39	2002	2A	4	Ceramic	
2600	40	2002	2A	1	Glass	
2600	41	2002	2A	Several	Bone	
2600	42	2002	2A	4	Bone	
2600	43	2004	2A	2	Bone	Mammal
2600	44	2002	2A	1	Bone	Animal
2600	45	2004	2A	2	Bone	Mammal
2600	46	2004	2A	lots	Bone	Mammal
2600	47	2002	2A	1	Ceramic	
2600	48	2002	2A	1	Ceramic	
2600	49	2004	2A	1	Ceramic	White gritty ware
2600	50	2004	2A	1	Ceramic	
2600	51	2040	2A	Several	Daub?	Uncertain
2600	52	2002	2A	1	Ceramic	
2600	53	2004	2A	1	Ceramic	Green glaze Corded décor. Green glaze
2600	54	2004	2A	1	Ceramic	
2600	55	2040	2A	1	Ceramic	
2600	56	2002	2A	1	Ceramic ?	
2600	57	2002	2A	2	Bone	
2600	58	2002	2A	1	Bone	
2600	59	2002	2A	2	Bone	
2600	60	2032	2A	1	Ceramic	White gritty ware
2600	61	2002	2A	1	Bone	
2600	62	2002	2A	1	Ceramic	White gritty ware
2600	63	2002	2A	6	Bone	
2600	64	2002	2A	2	Bone	
2600	65	2000	2A	1	Ceramic	
2600	66	2002	2A	1	Ceramic	

<i>Exc. Code</i>	<i>SF no.</i>	<i>Context</i>	<i>Trench/Area</i>		<i>No. of SFs</i>	<i>Material Type</i>
2600	67	2002	2A	Several	Bone	
2600	68	2002	2A	1	Bone	
2600	69	2002	2A	1	Bone	
2600	70	2002	2A	1	Ceramic	
2600	71	2002	2A	1	Ceramic	
2600	72	2002	2A	2	Bone	
2600	73	2002	2A	1	Lithic	Brown Flint ?
2600	74	2002	2A	Several	Bone	Animal
2600	75	2002	2A	10	Ceramic	White gritty ware
2600	76	2002	2A	Several	Bone	Animal
2600	77	2002	2A	2	Bone	
2600	78	2002	2A	4	Ceramic ?	Burnt daub?
2600	79	2002	2A	Several	Bone	
2600	80	2002	2A	2	Ceramic	
2600	81	2002	2A	1	Bone	Tooth
2600	82	2002	2A	3	Bone	Teeth
2600	83	2004	2A	1	Bone	Small frags mammal bone
2600	84	2004	2A	1	Ceramic	White gritty ware
2600	85	2002	2A	1	Ceramic	White gritty ware
2600	86	2002	2A	Several	Bone	Mammal
2600	87	2002	2A	4	Bone	
2600	88	2002	2A	1	Ceramic	White gritty ware
2600	89	2002	2A	1	Bone	Mammal
2600	90	2002	2A	Several	Bone	
2600	91	2002	2A	1	Ceramic	White gritty ware
2600	92	2002	2A	Several	Bone	
2600	93	2002	2A	Several	Bone	Mammal
2600	94	2002	2A	1	Ceramic	White gritty ware
2600	95	2005	2A	1	Glass	Green
2600	96	2002	2A	1	Ceramic	White gritty ware
2600	97	2002	2A	1	Ceramic	White gritty ware
2600	98	2002	2A	1	Ceramic	White gritty ware
2600	99	2002	2A	1	Bone	
2600	100	2002	2A	1	Ceramic	White gritty ware
2600	101	2002	2A	3	Bone	
2600	102	2002	2A	1	Ceramic	Green glaze
2600	103	2002	2A	1	Ceramic	White gritty ware
2600	104	2040	2A	1	Ceramic	White gritty ware
2600	105	2002	2A	1	Ceramic	Red ware
2600	106	2002	2A	1	Ceramic	Green glaze
2600	107	2040	2A	1	Ceramic	White gritty ware
2600	108	2042	2A	1	Ceramic	Green glaze
2600	109	2000	2A	1	Ceramic	White glazed
2600	110	2002	2A	1	Bone	Jaw
2600	111	2002	2A		Several Bone	Mammal
2600	112	2000	2A	1	Ceramic	White glaze
2600	113	2000	2A	1	Ceramic	White glaze
2600	114	2000	2A	1	Ceramic	White glaze
2600	115	2000	2A	1	Ceramic	Green glaze
2600	116	2000	2A	1	Ceramic	Blue/White glaze
2600	117	2005	2A	1	Glass	Green
2600	118	2005	2A	1	Bone	Mammal
2600	119	2002	2A	1	Ceramic	White gritty ware
2600	120	2002	2A	1	Ceramic	White gritty ware
2600	121	2000	2A	2	Ceramic	White glaze/cream glaze

<i>Exc. Code</i>	<i>SF no.</i>	<i>Context</i>	<i>Trench/Area</i>		<i>No. of SFs</i>	<i>Material Type</i>
2600	122	2002	2A	1	Ceramic	White gritty ware
2600	123	2002	2A	1	Ceramic	White gritty ware
2600	124	2002	2A	1	Ceramic	White gritty ware
2600	125	2002	2A	1	Bone	Mammal
2600	126	2006	2A	1	Ceramic	
2600	127	2006	2A	1	Ceramic	Red interior / sooty exterior
2600	128	2006	2A	1	Ceramic	White gritty ware
2600	129	2006	2A	2	Ceramic	Red interior face / black exterior
2600	130	2006	2A	1	Ceramic	White gritty ware red core
with						
2600	131	2006	2A	1	Ceramic	White gritty ware sooty external face
with						
2600	132	2027	2A	1	Ceramic	White glaze
2600	133	2027	2A	1	Ceramic ?	
2600	134	2028	2A	1	Ceramic	Green glaze
2600	135	2002	2A	1	Bone	Mammal
2600	136	2002	2A	1	Bone	Mammal
2600	137	2002	2A	2	Bone	Mammal
2600	138	2002	2A	Many	Bone	Mammal
2600	139	2002	2A	1	Bone	Sheep tooth
2600	140	2006	2A	1	Ceramic	White gritty ware
2600	141	2027	2A	1	Ceramic	Red ceramic drain
2600	142	2027	2A	1	Clay	Clay pipe
2600	143	2027	2A	4	Bone	Mammal
2600	144	2028	2A	c.50	Bone	Mammal
2600	145	2028	2A	2	Ceramic	Green glaze
2600	146	2006	2A	5	Ceramic	White gritty ware
2600	147	2006	2A	2	Ceramic	White gritty ware
2600	148	2006	2A	1	Ceramic	Green glaze
2600	149	2002	2A	1	Ceramic	White gritty ware
2600	150	2002	2A	Several	Bone	Long bone
2600	151	2000	2A	1	Bone	
2600	152	2000	2A	1	Bone	
2600	153	2000	2A	1	Bone	Mammal
2600	154	2000	2A	1	Ceramic	Post-medieval
2600	155	2000	2A	1	Ceramic	Clay pipe
2600	156	2007	2A	1	Ceramic	Medieval
2600	157	2002	2A	1	Bone	Mammal
2600	158	2002	2A	1	Tooth	Mammal
2600	159	2002	2A	1	Ceramic	White gritty ware
2600	160	2028	2A	1	Bone	Mammal
2600	161	2028	2A	1	Shell	Oyster ?
2600	162	2002	2A	1	Ceramic	White gritty ware
2600	163	2002	2A	Many	Bone	Mammal
2600	164	2002	2A	Several	Bone	Mammal
2600	165	2009	2A	1	Ceramic	Blue pattern
2600	166	2002	2A	1	Bone	Animal
2600	167	2000	2A	1	Ceramic	Post-medieval
2600	168	2002	2A	1	Iron ?	Fragment
2600	169	2000	2A	5	Bone	Mammal
2600	170	2051	2A	1	Ceramic	Abraded green glaze
2600	171	2002	2A	3	Bone	Mammal
2600	172	2007	2A	1	Ceramic	White gritty ware
2600	173	2002	2A	3	Bone	Fragments
2600	174	2000	2A	5	Bone	Mammal

<i>Exc. Code</i>	<i>SF no.</i>	<i>Context</i>	<i>Trench/Area</i>	<i>No. of SFs</i>	<i>Material Type</i>
2600	175	2000	2A 1	Ceramic	Post-medieval
2600	176	2007	2A 1	Ceramic	White gritty ware
2600	177	2007	2A 1	Ceramic	
2600	178	2007	2A 3	Ceramic	
2600	179	2007	2A 1	Ceramic	Red fabric with sooty interior/exterior
2600	180	2007	2A 1	Ceramic	
2600	181	2002	2A 1	Ceramic	Green glaze
2600	182	2027	2A 1	Ceramic	
2600	183	2002	2A 1	Shell	Oyster
2600	183	2002	2A 1	Glass	Modern
2600	185	2002	2A Several	Bone	Mammal
2600	186	2002	2A 1	Bone	Mammal
2600	186	2002	2A 1	Ceramic	Medieval
2600	187	2002	2A 1	Ceramic	Modern
2600	188	2002	2A 1	Bone	Bird?
2600	189	2002	2A Several	Bone	Mammal
2600	190	2002	2A 1	Ceramic	White gritty ware
2600	191	2002	2A 3	Bone	
2600	192	2002	2A 1	Ceramic	
2600	193	2000	2A 1	Ceramic	Modern
2600	194	2002	2A Several	Bone	Mammal
2600	195	2000	2A 1	Shell	
2600	196	2000	2A 1	Bone	Tooth
2600	197	2012	2A 1	Ceramic	White gritty ware
2600	198	2000	2A 1	Ceramic	Patterned
2600	199	2002	2A 4	Ceramic	Green glaze
2600	200	u/s	2A 1	Ceramic	
2600	201	2001	2A 2	Ceramic	
2600	202	2002	2A 1	Bone	Mammal
2600	203	2027	2A 2	Glass	
2600	204	2002	2A 1	Bone	Mammal
2600	204	2002	2A 1	Ceramic	Medieval
2600	205	2002	2A 1	Bone	
2600	205	2002	2A 1	Ceramic	Medieval
2600	206	2002	2A 1	Ceramic	Green glaze
2600	207	2002	2A 1	Ceramic	Green glaze
2600	208	2002	2A 1	Bone	Large mammal
2600	208	2002	2A 1	Ceramic	Medieval
2600	209	2002	2A 2	Bone	Large mammal
2600	209	2002	2A 1	Stone	Lithic
2600	210	2002	2A 2	Ceramic	Modern
2600	211	2002	2A 1	Ceramic	Modern
2600	212	2002	2A 3+lots	Bone	Mammal
2600	213	2002	2A 1	Metal	Iron bolt
2600	214	2002	2A 1	Shell	Oyster ?
2600	215	2002	2A 1	Bone	Mammal
2600	216	2002	2A 2	Bone	
2600	217	2002	2A 1	Ceramic	White gritty ware
2600	218	2000	2A 1	Ceramic	Clay pipe
2600	219	2002	2A 2	Ceramic	Modern
2600	220	2002	2A 7	Ceramic	Green glaze
2600	221	2000	2A 1	Ceramic	Modern
2600	222	2002	2A 1	Ceramic	White gritty ware
2600	223	2002	2A 1	Ceramic	Green glaze
2600	224	2002	2A 1	Ceramic	White gritty ware
2600	225	2002	2A 1	Ceramic	Red glaze

<i>Exc. Code</i>	<i>SF no.</i>	<i>Context</i>	<i>Trench/Area</i>	<i>No. of SFs</i>	<i>Material Type</i>
2600	226	2002	2A 1	1	Ceramic
2600	227	2002	2A 8	8	Ceramic
2600	228	2000	2A 1	1	Bone
2600	229	2002	2A 1	1	Bone
2600	230	2030	2A 1	1	Stone
2600	231	2002	2A 1	1	Ceramic
2600	232	2002	2A 1	1	Bone
2600	233	2051	2A 1	1	Ceramic
2600	234	2051	2A 1	1	Ceramic
2600	235	2051	2A 1	1	Bone
2600	236	2051	2A 1	1	Ceramic
2600	237	2051	2A 1	1	Bone
2600	238	2051	2A 1	1	Lithic
2600	239	2060	2A 1	1	Ceramic
2600	240	2002	2A 1	1	Bone
2600	241	2060	2A 1	1	Ceramic
2600	242	2051	2A 2	2	Bone
2600	243	2051	2A Several	Several	Bone
2600	244	2062	2A 1	1	Ceramic
2600	245	2000	2A 1	1	Ceramic
2600	246	2051	2A 2	2	Bone
2600	247	2051	2A 1	1	Tooth
2600	248	2002	2A Several	Several	Bone
2600	249	2002	2A 1	1	Tooth
2600	250	u/s	2A 1	1	Ceramic
2600	251	2051	2A 1	1	Ceramic
2600	252	2002	2A 1	1	Ceramic
2600	253	2051	2A 1	1	Iron ?
2600	254	2051	2A Several	Several	Bone
2600	255	2051	2A 1	1	Ceramic
2600	256	2002	2A 3	3	Bone
2600	257	2051	2A 2	2	Ceramic
2600	258	2064	2A 1	1	Ceramic
2600	259	2051	2A 1	1	Ceramic
2600	260	2002	2A 1	1	Ceramic
2600	261	2002	2A 1	1	Ceramic
2600	262	2002	2A 1	1	Ceramic
2600	263	2000	2A 1	1	Ceramic
2600	264	2062	2A 2	2	Ceramic
2600	265	2000	2A 1	1	Iron
2600	266	2051	2A 5	5	Bone
2600	267	2028	2A 1	1	Ceramic
2600	268	2051	2A 1	1	Ceramic
2600	269	2051	2A 1	1	Bone
2600	270	2051	2A 4	4	Bone
2600	271	2051	2A 13	13	Ceramic
2600	272	2028	2A 1	1	Ceramic
2600	273	2051	2A 2	2	Bone
2600	274	2051	2A 4	4	Ceramic
2600	275	2051	2A 2	2	Ceramic
2600	276	2051	2A 1	1	Ceramic
2600	277	2051	2A 1	1	Bone
2600	278	2051	2A 1	1	Ceramic
2600	279	2051	2A 1	1	Bone
2600	280	2051	2A 1	1	Ceramic
2600	281	2051	2A 1	1	Iron
2600	282	2051	2A 1	1	Bone

<i>Exc. Code</i>	<i>SF no.</i>	<i>Context</i>	<i>Trench/Area</i>	<i>No. of SFs</i>	<i>Material Type</i>
2600	283	2010	2A 1	Ceramic	Medieval
2600	284	2097	2A 1	Ceramic	Modern
2600	285	2097	2A 1	Bone	Mammal
2600	286	2028	2A 1	Ceramic	Medieval
2600	287	2028	2A 1	Ceramic	Medieval
2600	288	2051	2A 1	Ceramic	Modern ?
2600	289	2051	2A 1	Ceramic	Modern
2600	290	2060	2A 2	Ceramic	Blue pattern
2600	291	2051	2A 1	Bone	Mammal
2600	292	2051	2A 1	Shell	
2600	293	2009	2A 1	Ceramic	Medieval
2600	294	2051	2A 3	Bone	Mammal
2600	295	2051	2A 2	Bone	Mammal
2600	296	2081	2A 1	Clay	Clay pipe mouth piece
2600	297	2003	2A 2	Ceramic	Green glaze
2600	298	2003	2A 1	Ceramic	
2600	299	2081	2A 3	Ceramic	Modern
2600	300	2081	2A 2	Clay	Pipe bowl
2600	301	2083	2A 1	Ceramic	Medieval
2600	302	2081	2A 3	Ceramic	Modern
2600	303	2081	2A 2	Ceramic	Modern
2600	304	2003	2A 2	Ceramic	Modern
2600	305	2000	2A 1	Ceramic	Modern
2600	306	2082	2A 1	Stone	
2600	307	2000	2A 1	Ceramic	Medieval
2600	308	2000	2A 1	Ceramic	Modern
2600	309	2006/2114	2A 1	Ceramic	Medieval
2600	310	2017	2A 1	Ceramic	Medieval
2600	311	2002	2A 1	Ceramic	Medieval
2600	312	2112	2A 6	Ceramic	Medieval
2600	313	2000	2A 1	Bone	
2600	314	2000	2A 1	Ceramic	Modern
2600	315	2000	2A 1	Ceramic	Modern
2600	316	2000	2A Several	Bone	Modern
2600	317	2066	2A 4	Ceramic	Modern
2600	318	2000	2A 2	Ceramic	Modern
2600	319	2000	2A 1	Ceramic	Modern
2600	320	2000	2A 1	Ceramic	Medieval
2600	321	2006	2A 1	Ceramic	Medieval
2600	322	2006	2A 1	Shell	
2600	323	2000	2A 1	Ceramic	Modern
2600	324	2000	2A 1	Ceramic	Modern
2600	325	2006	2A 1	Ceramic	Medieval
2600	326	2006	2A 1	Ceramic	Medieval
2600	327	2006	2A 1	Ceramic	Medieval
2600	328	2006	2A 1	Ceramic	Medieval
2600	329	2006	2A 1	Ceramic	Medieval
2600	330	2006	2A 1	Ceramic	Medieval
2600	331	2114	2A 37	Ceramic	White gritty ware
2600	332	2115	2A 2	Ceramic	Medieval
2600	333	2116	2A 1	Ceramic	Medieval
2600	334	2116	2A 1	Bone	Animal
2600	335	2006	2A 5	Ceramic	Medieval
2600	336	2006	2A 1	Ceramic	Medieval
2600	337	2112	2A 2	Bone	Tooth
2600	338	2112	2A 8	Ceramic	Medieval
2600	339	2114	2A 14	Ceramic	Medieval

<i>Exc. Code</i>	<i>SF no.</i>	<i>Context</i>	<i>Trench/Area</i>	<i>No. of SFs</i>	<i>Material Type</i>
2600	340	2115	2A 2	Ceramic	Medieval
2600	341	2006	2A 4	Ceramic	Medieval
2600	342	2114	2A 1	Bone	
2600	343	2120	2A 2	Ceramic	Medieval
2600	344	2089	2A Many	Tooth	Mammal
2600	345	2089/2103	2A 1	Ceramic	Medieval
2600	346	2114	2A 1	Ceramic	White gritty- green slip
2600	347	2114	2A 5	Ceramic	White gritty ware-grooved
2600	348	2114	2A 3	Ceramic	
2600	349	2105	2A 1	Ceramic	White gritty ware
2600	350	2089	2A 1	Stone	Cannel coal
2600	351	2105	2A 1	Ceramic	
2600	352	2064	2A 1	Ceramic	Medieval
2600	353	2114	2A 6	Ceramic	Medieval
2600	354	2114	2A 1	Ceramic	Medieval
2600	355	2114	2A 1	Ceramic	Modern
2600	356	2114	2A 1	Stone	?Worked
2600	357	2114	2A 1	Stone	?Worked
2600	358	2133	2A 1	Bone	Tooth
2600	359	2133	2A 2	Ceramic	Medieval
2600	360	2133	2A 2	Ceramic	Medieval
2600	361	2133	2A 1	Ceramic	Medieval
2600	362	2133	2A 1	Ceramic	Medieval
2600	363	2133	2A 7	Ceramic	Medieval
2600	364	2130	2A 1	Metal	Uncertain
2600	365	2114	2A 6	Ceramic	Medieval
2600	366	2114	2A 1	Ceramic	Medieval
2600	367	2114	2A 1	Stone	?
2600	368	2114	2A 1	Stone	?
2600	369	2114	2A 1	Ceramic	Medieval
2600	370	2114	2A 1	Ceramic	Medieval
2600	371	2114	2A 7	Ceramic	Medieval
2600	372	2115	2A several	Ceramic	
2600	373	2133	2A 1	Ceramic	Medieval
2600	374	2143/2145	2A several	Wood	
2600	375	2114	2A 1	Ceramic	Medieval
2600	376	2115	2A 2	Ceramic	Medieval
2600	377	2114	2A 1	Copper alloy	finger ring
2600	378	2133	2A 1	Ceramic	Medieval
2600	379	2114	2A 16	Ceramic	Medieval
2600	380	2114	2A 1	Ceramic	Medieval
2600	381	2044	2A several	Ceramic	Medieval
2600	382	2114	2A several	Ceramic	Medieval
2600	383	2044	2A 1	Shell	
2600	384	2114	2A	Ceramic	Medieval
2600	385	2114	2A 1	Ceramic	Medieval
2600	386	2165	2A 1	Stone	
2600	387	2165	2A 1	Ceramic	Medieval
2600	388	2165	2A 4	Ceramic	Medieval
2600	389	2044	2A 2	Ceramic	Post Medieval
2600	390	2044	2A 2	Uncertain	?Stone/burnt pottery/ industrial waste
2600	391	2044	2A 1	Stone	?Stone
2600	392	2044	2A 2	Bone	

<i>Exc. Code</i>	<i>SF no.</i>	<i>Context</i>	<i>Trench/Area</i>	<i>No. of SFs</i>	<i>Material Type</i>
2600	393	2103	2A 1	1	Stone Lithic
2600	394	2168	2A 1	1	Ceramic Medieval
2600	400	2207	2C 1	1	Ceramic Medieval
2600	401	2207	2C 1	1	Ceramic Medieval
2600	402	2207	2C 5	5	Ceramic Medieval
2600	403	2207	2C 1	1	Ceramic Medieval
2600	404	2207	2C 1	1	Ceramic Clay pipe bowl
2600	405	2203	2B 1	1	Ceramic Clay pipe bowl
2600	406	2202	2B 3	3	Ceramic Post Medieval
2600	407	2207	2C 2	2	Ceramic Medieval
2600	408	2207	2C 1	1	Ceramic Medieval
2600	409	2207	2C 2	2	Ceramic Medieval
2600	410	2207	2C 1	1	Glass
2600	411	2207	2C 2	2	Ceramic Post Medieval
2600	412	2207	2C 1	1	Stone Discarded
2600	413	2207	2C 3	3	Ceramic Medieval
2600	414	2207	2C 2	2	Ceramic Medieval
2600	415	2207	2C 1	1	Bone Tooth
2600	416	2207	2C 1	1	Ceramic Medieval
2600	417	2207	2C 1	1	Ceramic Medieval
2600	418	2207	2C 1	1	Bone Tooth
2600	419	2207	2C 6	6	Ceramic Medieval
2600	420	2211	2B 1	1	Ceramic Medieval
2600	421	2204	2B 1	1	Ceramic Clay pipe bowl
2600	422	2215	2B 2	2	Ceramic Clay pipe bowl
2600	423	2201	2B 1	1	Glass
2600	424	2211	2B 9	9	Ceramic Medieval
2600	425	2211	2B 2	2	Ceramic Medieval
2600	426	2238	2B 1	1	Ceramic Medieval
2600	427	2238	2B 1	1	Ceramic Medieval
2600	428	2238	2B 1	1	Ceramic Clay Pipe stem
2600	429	2235	2B 4	4	Ceramic Medieval
2600	430	2239	2B 1	1	Ceramic Medieval
2600	431	2234	2B 1	1	Ceramic Medieval
2600	432	2234	2B 1	1	Ceramic Medieval
2600	433	2234	2B 1	1	Ceramic Medieval
2600	434	2234	2B 3	3	Ceramic Medieval
2600	435	2234	2B 1	1	Ceramic Medieval
2600	436	2234	2B 1	1	Metal Modern
2600	437	2234	2B 3	3	Ceramic Medieval
2600	438	2234	2B 1	1	Ceramic Clay pipe
2600	439	2234	2B 4	4	Metal Nail fragments
2600	440	2234	2B 1	1	Ceramic Clay pipe
2600	441	2234	2B 1	1	Stone Natural?
2600	442	2236	2B 1	1	Ceramic Medieval
2600	443	2236	2B 1	1	Ceramic Medieval
2600	444	2235	2B 1	1	Ceramic Clay pipe
2600	445	2235	2B 1	1	Ceramic Clay pipe
2600	446	2551	2B 3	3	Ceramic Post Medieval
2600	446	2551	2B 1	1	Ceramic Clay pipe
2600	447	2227	2B 2	2	Ceramic Post Medieval
2600	448	2284	2C 1	1	Ceramic Post Medieval
2600	449	2284	2C 1	1	Ceramic Post Medieval
2600	450	2238	2B 2	2	Ceramic Medieval
2600	451	2238	2B 1	1	Ceramic Medieval
2600	452	2238	2B 1	1	Ceramic Medieval

<i>Exc. Code</i>	<i>SF no.</i>	<i>Context</i>	<i>Trench/Area</i>		<i>No. of SFs</i>	<i>Material Type</i>
2600	453	2238	2B	6	Ceramic	Medieval/Post Medieval
2600	454	2238	2B	2	Ceramic	Post Medieval
2600	455	2271/2276	2C	3	Ceramic	Medieval
2600	456	2276	2C	2	Bone	Mammal
2600	457	2276	2C	1	Ceramic	Clay pipe
2600	458	2276	2C	2	Ceramic	Medieval/Post Medieval
2600	459	2276	2C	1	Sample	Unknown
2600	460	2274	2C	1	Metal	Coin
2600	461	2271/2276	2C	1	Glass	Post Medieval Bottle Glass?
2600	462	2271/2276	2C	1	Ceramic	Medieval
2600		u/s		10	Ceramic	Medieval
2600	500	2278	2D	1	Ceramic	Medieval
2600	501	2348	2D	3	Fe	Medieval
2600	502	2359	2D	1	Ceramic	Post-medieval
2600	503	2311	2D	1	Ceramic	Post-medieval
2600	504	2278	2D	1	Ceramic	Medieval
2600	505	2278	2D	1	Ceramic	Medieval
2600	506	2278	2D	1	Ceramic	Medieval
2600	507	2348	2D	2	Ceramic	Medieval
2600	508	2348	2D	1	Ceramic	Medieval
2600	509	2359/2348	2D	1	Glass	
2600	510	2359	2D	1	Shell	
2600	511	2359	2D	1	Shell	
2600	512	2359	2D	1	Ceramic	Medieval
2600	513	2310	2D	2	Ceramic	Post-medieval
2600	514	2327	2D	6	Ceramic	Post-medieval
2600	515	2321	2D	1	Bone	Medieval
2600	516	2321	2D	9	Ceramic	Post-medieval
2600	517	2350	2D	1	Ceramic	Medieval
2600	518	2351	2D	1	Ceramic	Medieval
2600	519	2302	2D	1	Ceramic	Post-medieval
2600	520	u/s	2D	1	Stone	Pot lid

12.3 List of Samples

<i>Sample No</i>	<i>Area</i>	<i>Con-text No.</i>	<i>Bag Size & %</i>	<i>Reason for Sampling</i>					<i>Application / Comments</i>
				<i>Pot</i>	<i>Lithics</i>	<i>Bone</i>	<i>Botanics</i>	<i>Other</i>	
180	2A	2004	4xL/10%	x		x	x		Upper fill- 1 st spit of fill
181	2A	2008	1xL					Charcoal?	Fill of ditch
182	2A	2032	4xL/20%	x			x	Charcoal?	Lower fill of Kiln
183	2A	2004	3xL/10%	x		x	x	Charcoal	Lower fill-2 nd spit of fill
184	2A	2002	1xL					Charcoal	Layer above cobbles
185	2A	2034	2xM/100%				x	Charcoal	Lenses of ash in Kiln
186	2A	2036	1xM/50%	x					Fill of circular feature cut [2037]
187	2A	2004	1xL/>10%	x		x		Charcoal?	Upper fill of Kiln spit 1
188	2A	2004	1xL/>10%	x				Charcoal?	Upper fill of Kiln spit 2

Sample No	Area	Con-text No.	Bag Size & %	Reason for Sampling					Application / Comments
				Pot	Lithics	Bone	Botanics	Other	
189	2A	2032	1xL/>10%					Charcoal? Iron	Lower fill of Kiln
190	2A	2006	1xM/15%	x				Charcoal	
191	2A	2002	1xL/<5%						
192	2A	2014	1xL/25%					Charcoal	From slot between capping stones of fill
193	2A	2040	1xL/100%					Charcoal?	
194	2A	2014	1xL/50%						From E of capping stones over fill below collapsed stones from Kiln wall
195	2A	2006	2xM/25%					Charcoal	Slot 1
196	2A	2014	1xL/100%					Charcoal	From fill where it bisects the Kiln
197	2A	2048	1xM/10%					Seeds?	Drain outflow?
198	2A	2006	1xM/25%					Charcoal	Slot 2
200	2A	2002	1xL	x		x	x		Midden spread
203	2A	2007	1xL/20%					Charcoal	(A)
204	2A	2007	1xL/20%					Charcoal	(A)
205	2A	2007	1xL/20%					Charcoal	(A)
209	2A	2056	1xM/50%						
213	2A	2013	1xS						Slot 1
214	2A	2002	1xL/<1%	x		x		Charcoal	(2002) surrounding and beneath spread (2059) above (2003) cobbles
215	2A	2063	1xL				X?	Charcoal	Beneath floor of Kiln inside flue
216	2A	2063	1xL					Charcoal	Beneath floor of Kiln inside flue
217	2A	2067	1xL						Fill of Linear feature
218	2A	2072	1xL					Charcoal	Fill of modern rectangular feature 2078
219	2A	2077	1xL					Charcoal	Modern rectangular feature 2078 lower fill
220	2A	2009	1xL	x				Charcoal	Fill of Linear feature 2079 NE/SW in E
221	2A	2010	1xL						Fill of linear feature [2082] (slot 1)
222	2A	2011	1xL					Charcoal	Fill of linear feature
223	2A	2010	1xL						Fill of linear feature [2080] (slot 3)
224	2A	2082	1xL					Charcoal	Fill of linear feature possible animal burrow
225	2A	2009	1xL/<10%					Charcoal	Liner feature NE/SW
226	2A	2010	1xL					Charcoal	Liner feature (slot 2)
227	2A	2070	1xL					Charcoal	Liner feature parallel to 2016

Sample No	Area	Con-text No.	Bag Size & %	Reason for Sampling					Application / Comments
				Pot	Lithics	Bone	Botanics	Other	
228	2A	2075	1xL/<10%						Fill of feature
229	2A	2084	1xL/<10%						Lower fill of 2073
230	2A	2073	1xL/<5%						Fill of 2091
231	2A	2093	1xL/<20%						Fill of [2094]
232	2A	2083	1xL					Charcoal	Fill of [2092](slot 2)
233	2A	2083	1xL					Charcoal	Fill of [2099]
234	2A	2074	1xL						Fill of [2096]
235	2A	2015	1xL						Fill of 2095
236	2A	2010	1xL						Fill of [2080] (slot 4)
237	2A	2087	1xL						Fill of [2087]
238	2A	2089	1xL						Fill of [2089]
239	2A	2100	1xL						Fill of
240	2A	2101	1xL						Fill of
241	2A	2110	1xL/50%						Fill of
242	2A	2116	1xL					Charcoal?	Loose fill behind kiln stones 2030
243	2A	2019	1xL/50%					Charcoal	Fill of possible pit
244	2A	2006	1xL	x				Charcoal	Fill of linear featu5re (Slot 3)
245	2A	2112	1xL					Charcoal?	Fill of linear feature by kiln
246	2A	2114	1xL						Fill of linear feature
247	2A	2120	1xL					Charcoal?	Fill of linear feature 2132/2122
248	2A	2121							
249	2A	2090							
250	2A	2012	1xL/50%						Small linear scoop
251	2A	2105	1xL						Linear feature (Slot 1)
252	2A	2104	1xL						Linear feature (Slot 1)
253	2A	2103	1xL						Linear feature (Slot 2)
254	2A	2104	1xL						Linear feature (Slot 2)
255	2A	2105	1xL						Linear feature (Slot 2)
256	2A	2103	1xL	x			x	Charcoal	Linear feature (Slot 3)
257	2A	2104	1xL	x			x	Charcoal	Linear feature (Slot 3)
258	2A	2126	1xL				x	Charcoal	Possible ash but may be natural (Slot 3)
260	2A	2008	1xL/25%				x		Linear feature
261	2A	2076	1xL/10%				x	Charcoal	Linear feature shallow
259	2A	2120	1xL						Linear feature (slot 2)
262	2A	2090	1xL/20%				x	Charcoal	Fill of linear slot
263	2A	2153	2xL	x		x	x	Charcoal	Pot and bone found within – fill of linear feature, possible daub in fill
264	2A	2105	1xL						Linear feature

Sample No	Area	Con-text No.	Bag Size & %	Reason for Sampling					Application / Comments
				Pot	Lithics	Bone	Botanics	Other	
265	2A	2130	1xL						Square feature, modern
266	2A	2139	1xL						Oval feature next to rock
267	2A	2135	2xL						Fill of linear feature [2141]
268	2A	2136	2xL						Fill of linear feature [2142]
269	2A	2137	1xL						
270	2A	2143	4xL						Fill of possible cess pit
271	2A	2115	1xL						Fill in base of ditch terminal
272	2A	2114	1xL						Fill in base of ditch
273	2A	2133	1xM						Possible clay lining or daub, very fragile and found within soil. In linear feature
274	2A	2137	1xL						
275	2A	2148	1xL				x	Charcoal	Fill of ditch
276	2A	2147	1xM						Fill of ditch
277	2C	2210	1xL						Fill of ditch
278	2A	2165	1xL			x	x	Charcoal	Fill of ditch
279	2A	2143	4xL						Fill of possible cesspit/tree throw
280	2A	2168	3xL						Silt deposit around base of tree trunk (2145)
281	2A	2168	2xL						Lowest level of 2168
282	2A	2145							Samples of tree-trunk
283	2B	2211	2xL						Linear feature
284	2A	2171	1xL						Fill of shallow ditch 2172
285	2B	2217	1xL						Linear feature
286	2A	2168	1xL						Basal fill of "well"
287	2B	2231	1xM						Fill of possible shallow P/H
288	2B	2230	1xL						Fill off 2245
289	2B	2228	1xL 50%						Linear Feature
290	2B	2232	1xL 50%					Charcoal	Possible PH
291	2B	2211	1xL						Fill of linear (slot 3)
292	2B	2233	1xM 50%						Fill of possible PH
293	2B	2251	1xL						Fill of circular feature
294	2B	2254	1xL					Copper alloy discolouration	Fill of circular feature
295	2B	2227	1xL						Animal Burial
296	2B	2227	1xL						Bone
297	2C	2276	1xL			x			Bone
298	2C	2275	2xM						Fill of linear feature
299	2C	2281	1xL					C.V	Fill of linear feature

Sample No	Area	Con-text No.	Bag Size & %	Reason for Sampling					Application / Comments
				Pot	Lithics	Bone	Botanics	Other	
300	2D	2279 (slot1)	1xL						Circular feature
301	2D	2279 (slot 2)	1xL						Circular feature
302	2D	2279 (slot 3)	1xL						Circular feature
303	2D	2279 (slot 4)	1xL						Circular feature
304	2D	2310	2xL 1xM						PH
305	2D	2280	1xM						Fill
306	2D	2321 (slot 1)	1xL						Linear feature
307	2D	2280	1xM						Linear feature
308	2D	2327	1xM						Linear feature fill
309	2D	2278	1xM						Slot 1 linear feature
310	2D	2278	1xL						Slot 2 linear feature
311	2D	2311	1xL						Linear feature (modern?)
312	2D	2309	1xM						Circular feature
313	2D	2278	1xL						Linear feature Slot 3
314	2D	2294	1xM						Small circular feature
315	2D	2306	1xL						Large circular feature
316	2D	2339	1xL						Large oval feature
317	2D	2297	1xM						Possible post-hole
318	2D	2334	1xM						Possible post-hole
319	2D	2293	1xL						
320	2D	2347	1xM						
321	2D	2348	1xL						Slot 1
322	2D	2300	1xS						Small PH
323	2D	2331	1xS						Linear feature
324	2D	2329	1xL						Linear Feature
325	2D	2348	1xL						Slot 2
326	2D	2348	1xL						Slot 3
327	2D	2348	1xL						Slot 4
328	2D	2348	1xL						Slot 5
329	2D	2351	1xL 10%						Slot 1
330	2D	2351	1xL 10%						Slot 3
331	2D	2351	1xL 10%						Slot 4
332	2D	2348	3xL 50%						Slot 6
333	2D	2278	1xL 10%						Slot 8
334	2D	2348	2xL 20%						Slot 7
335	2D	2348	1xL 10%						Slot 7
336	2D	2348	1xL 10%						Slot 8
337	2D	2351	1xL 10%						Slot 8
338	2D	2348	1xL 10%						Western prong of feature

12.4 *List of Drawings*

<i>Area</i>	<i>Drawing No.</i>	<i>Sheet No.</i>	<i>Subject</i>	<i>Contexts</i>	<i>Scale</i>
2A	200	100	Plan	2004, 2014, 2122, 2030, 2008, 2031	1:20
2A	201	101	Plan	2024, 2002, 2002, 2023	1:20
2A	202	102	Plan	2001, 2008, 2033, 2040, 2006, 2043, 2030, 2046, 2018, 2013, 2000, 2053, 2007, 2054, 2029, 2015, 1017	1:20
2A	203	103	Pre-ex plan	2009, 2010, 2070, 2083, 2082, 2015, 2016, 2087, 2088, 2089, 2090, 2072, 2081	1:20
2A	204	104	Plan	2024, 2026, 2025, 2051, 2027, 2068, 2028, 2049, 2047	1:20
2A	205	105	South facing section of fill through Kiln	2004, 2030, 2116, 2035, 2117, 2605, 2063, 2032, 2038, 2014, 2039	1:20
2A	206	106	Pre-excavation plan	2028, 2097, 2000	1:20
2A	207	105	West facing section of drain/flue	2014, 2039	1:10
2A	208	107	South facing section	2040, 2008, 2041	1:10
2A	209	105	North-west facing section through slot 1	2006, 2036, 2037, 4034	1:10
2A	210	108	South facing section of field drain	2005	1:10
2A	211	108	South-east facing section	2026, 2047	1:10
2A	212	107	Pre-excavation plan	2024, 2026, 2003, 2005, 2002, 2023	1:20
2A	213	108	North-west facing section	2023, 2050	1:10
2A	214	110	Pre-excavation plan	2024, 2026	1:20
2A	215	111	East facing section	2025, 2049	1:10
2B	216	105	North-east facing section through 2006	2006, 2043	1:10
2B	217	112	Pre-excavation plan of cobbled area	2110, 2024, 2025, 2042, 2023, 2003, 2005, 2111	1:20
2A	218	113	Post-excavation plan of corn drying Kiln/flu	2030, 2035, 2039, 2034	1:20
2A	219	114	Post-excavation plan of 2003	2003, 2024, 2026, 2023, 2005	1:20
2A	220	115	Plan	2067, 2048, 2003, 2001	1:20
2A	221	105	North-west facing section	2007, 2053	1:10
2A	222	105	North-east facing section	2007, 2054	1:10
2A	223	116	Plan	2024, 2002, 2005, 2003	1:20
2A	224	117	North-east facing section after extension	2007, 2054	1:10
2A	225	117	North-west facing section after extension	2007, 2053	1:10
2A	226	118	Post-excavation plan	2053, 2054, 2121, 2013, 2046, 2037, 2043, 2044, 2006	1:20

<i>Area</i>	<i>Drawing No.</i>	<i>Sheet No.</i>	<i>Subject</i>	<i>Contexts</i>	<i>Scale</i>
2A	227	117	East facing section through circular feature	2056, 2057	1:10
2A	228	119	Pre-excavation plan of 2003	2024, 2005, 2003, 2002	1:20
2A	229	120	Plan	2098, 2060, 2052, 2097, 2061, 2024, 2051	1:20
2A	230	121	Middle section of south facing section	2027, 2028, 2068, 2000, 2024, 2069	1:10
2A	231	122	E end of S facing section	2000, 2028, 2005, 2023, 2024, 2069, 2024, 2003, 2028, 2001, 2002	1:10
2A	232	123	West end of S facing section	2000, 2002, 2028, 1061, 2098, 2097, 2024	1:10
2A	233	124	Flue beneath kiln floor	2065, 2039, 2035, 2119, 2117, 2030	1:20
2A	234	125	Pre-excavation plan north-east corner	2093, 2074, 2073, 2075, 2106, 2076, 2010, 2100, 2101, 2080, 2129	1:20
2A	235	117	West facing section slot 1 through linear feature	2010, 2080	1:10
2A	236	126	Plan	2062, 2098, 2060, 2097, 2061	1:20
2A	237	127	North-east facing section of linear feature	2009, 2079	1:10
2A	238	117	West facing section slot 3 through linear feature	2010, 2080, 2076	1:10
2A	239	128	East facing section	2082	1:10
2A	240	129	South-west facing section	2085, 2084, 2035, 2086	1:10
2A	241	129	East facing section	2073, 2091	1:10
2A	241	129	West facing section of 2073	2091, 2073	1:10
2A	242	127	West facing section	2009, 2010, 2070, 2071, 2079	1:10
2A	243	129	East facing section	2093, 2094	1:10
2A	244	117	North-west facing section slot 4 possible forking	2010, 2080	1:10
2A	245	129	East facing section	2074, 2096	1:10
2A	246	130	Overlay of Drawing 228, showing SF locations	2003, 2005	1:20
2A	247	128	West facing section	2083, 2099, 2082, 2092	1:10
2A	248	131	Plan of cobbles	2003, 2066, 2005	1:20
2A	249	128	East facing section	2087	1:10
2A	250	128	South-west facing section	2100, 2107	1:10
2A	251	128	East facing section	2101, 2108	1:10
2A	252	127	East north-east terminal of linear feature	2080, 2010	1:10
2A	253	132	Plan of south-east end of trench	2006, 2114, 2017, 2007, 2120, 2115, 2143, 2137, 2135, 2136, 2151, 2064, 2105, 2104, 2081, 2148, 2103, 2139, 2130, 2153,	1:50

<i>Area</i>	<i>Drawing No.</i>	<i>Sheet No.</i>	<i>Subject</i>	<i>Contexts</i>	<i>Scale</i>
2A	253(contd)	132	Plan of south-east end of trench	2154, 2147, 2106,	1:50
2A	254	127	East facing section of linear feature	2110, 2111	1:10
2A	255	135	Plan. Overlay of #203	2056, 2012, 2015, 2009, 2079, 1010, 2070, 2071, 2083, 2087, 2099, 2102, 2082, 2092, 2072, 2078, 2011, 2081, 2080, 2090, 2131, 2109, 2089, 2088	1:20
2A	256	133	Plan after cobbles 2003 removed	2001	1:20
2A	257	134	North facing section of 2006 slot 3	2006, 2043	1:10
2A	258	136	Post-excavation of 5 m form north between 160E to 169E	2100, 2107, 2101, 2108, 2010, 2080, 2089, 2076, 2093, 2074, 2075, 2073, 2106	1:20
2A	259	127	South facing section	2115	1:10
2A	260	127	South facing section	2120	1:10
2A	261	127	South facing section slot 2	2103, 2123	1:10
2A	262	127	South facing section slot 2	2104	1:10
2A	263	129	South facing section slot 2	2105	1:10
2A	264	134	South facing section slot 1	2105	1:10
2A	265	134	South facing section slot 1	2104	1:10
2A	266	108	South facing section slot 3 of linear feature	2089, 2104, 2105, 2081, 2125, 2124, 2126	1:10
2A	267	134	South-west facing section of 2033 linear	2033, 2008	1:10
2A	268	134	Post-excavation plan of 2033	2033, 2008	1:20
2A	269	108	North facing section of linear feature terminal	2104, 2105, 2124, 2125, 2105, 2096, 2081	1:10
2A	270	129	East facing section	2076, 2129	1:10
2A	271	129	West facing section	2076, 2129	1:10
2A	272	134	South-east facing section linear feature slot 2	2120, 2132	1:10
2A	273	129	North facing section of linear feature	2090, 2131	1:10
2A	274	129	North facing section	2104	1:10
2A	275	129	North-west facing section	2064, 2133	1:10
2A	276	129	North facing section	2103	1:10
2A	277	137	East facing section	2130	1:10
2A	278	138	Post-excavation plan of south-east end	2103, 2104, 2064	1:20
2A	279	134	West facing section	2141, 2142, 2135, 2136	1:10
2A	280	137	North facing section	2139, 2140	1:10
2A	281	137	West facing section	2064, 2133	1:10
2A	282	138	Post-excavation plan	2114, 2120, 2137, 2115,	1:10
2A	283	139	Post-excavation plan	2120, 2132, 2137, 2138, 2145	1:20
2A	284	140	South-west facing section	2137, 2138, 2143, 2145	1:10
2A	285	141	Plan of ditch	2064	1:20

<i>Area</i>	<i>Drawing No.</i>	<i>Sheet No.</i>	<i>Subject</i>	<i>Contexts</i>	<i>Scale</i>
2A	286	138	N facing section	2114	1:10
2A	287	138	N facing section	2114	1:10
2C	288	141	SW facing section	2148, 2107	1:10
2A	289	142	Plan	2138, 2137, 2143, 2169, 2147, 2145	1:20
2A	290	142	N facing section	2138, 2145, 2143	1:20
2A	291	142	S facing section	2147	1:20
2A	292	142	Plan	2169, 2168, 2145, 2138, 2137, 2143, 2169, 2147	1:20
2A	293	140	NE facing section	2165, 2044	1:10
2C	294	141	S facing section through wall foundation	2212, 2210, 2209	1:20
2C	295	143	Plan of Trench C, E side.	2207, 2212, 2209, 2219, 2220	1:20
2C	296	144	Plan of Trench C, E side	2207, 2222, 2208, 2221	1:20
2C	297	141	Plan of wall foundation	2209, 2210, 2212, 2207	1:20
2A	298	145	Post-ex plan	2114, 2044, 2146, 2045, 2166, 2165, 2167, 2171, 2120	
2A	299	140	S facing section	2171, 2172	1:10
2B	300	146	S facing section	2211	1:10
2A	301	140	NW facing section	2143, 2168, 2145, 2169	1:10
2B	302	146	S facing section	2217	1:10
2A	303	147	Plan of gullys (overlay of 253)	2166, 2165, 2146, 2114, 2120, 2132, 2018, 2019, 2007, 2169, 2143, 2137, 2143, 2165, 2128, 2115, 2128, 2147, 2148, 2156, 2149, 2105, 2104, 2081, 2135, 2136, 2106, 2103, 2130, 2253, 2154, 2252, 2139.	1:50
2A	304	148	Section through pit	2143, 2145, 2169, 2128	1:10
2B	305	146	S facing section	2231, 2244	1:10
2B	306	146	N facing section	2230, 2245	1:10
2B	307	150	W facing section	2247, 2232	1:10
2B	308	149	Plan	2225, 2226, 2259, 2264, 2251, 2250, 2227, 2218, 2263, 2211, 2237, 2217, 2262, 2215, 2260, 2229, 2230, 2231, 2261, 2228, 2232, 2233, 2234, 2239, 2242, 2235, 2238, 2236, 2203, 2256, 2265	1:100
2B	309	146	SE facing section	2228, 2248	1:10
2B	310	146	SE facing section	2228, 2248	1:10
2B	311	146	NW facing section	2228, 2248	1:10
2B	312	146	S facing section	2211	1:10
2B	313	150	Plan	2228, 2248,	1:20
2B	314	150	S facing section	2211, 2237	1:10

<i>Area</i>	<i>Drawing No.</i>	<i>Sheet No.</i>	<i>Subject</i>	<i>Contexts</i>	<i>Scale</i>
2B	315	146	E facing section	2233, 2249	1:10
2B	316	151	Plan	2237, 2211	1:20
2B	317	151	Plan	2225	1:20
2B	318	151	Plan	2244, 2231, 2230, 2245	1:20
2B	319	151	Plan	2226	1:20
2B	320	151	Plan	2229	1:20
2B	321	151	Plan	2215	1:20
2B	322	151	Plan	2243, 2217	1:20
2B	323	151	Plan	2218, 2254	1:20
2B	324	151	Plan	2247, 2232	1:20
2B	325	151	S facing section	2251, 2250	1:10
2B	326	151	Plan	2250, 2251	1:20
2A	327	148	N facing section	2105, 2125	1:10
2A	328	148	N facing section	2115, 2128	1:10
2A	329	148	N facing section	2114, 2146	1:10
2C	330	152	Plan	2267, 2236, 2238, 2242, 2240, 2239, 2235, 2238, 2266,	1:20
2B	331	153	Plan	2241, 2234, 2233	1:20
2B	332	146	S facing section	2218, 2254	1:10
2B	333	146	Plan	2218, 2254	1:20
2C	334	154	S facing section	2200, 2201, 2202, 2203, 2256, 2204	1:20
2C	335	154	S facing section	2202, 2204	1:50
2C	336	155	E facing section	2205, 2206, 2207,	1:20
2C	337	156	Plan of Slot 1	2275, 2268, 2269, 2270, 2271, 2272	1:20
2C	338	157	E facing section	2207, 2275, 2277	1:10
2C	339	157	E facing section	2205, 2207, 2281, 2282	1:20
2C	340	155	E facing section	2205, 2206, 2207	1:20
2C	341	156	Plan of Slot 2	2284, 2268, 2287	1:20
2C	342	158	Plan	2274	1:100
2D	343	159	S facing section Slot 1	2279, 2288	1:10
2D	344	159	SE facing section Slot 2	2279, 2288	1:10
2D	345	159	W facing section Slot 3	2279, 2288	1:10
2D	346	159	E facing section Slot 4	2279, 2288	1:10
2D	347	160	Pre-ex plan Site 2D at West	2278, 2280, 2290, 2297, 2298, 2299, 2300, 2301, 2303, 2305, 2306, 2307, 2308, 2309, 2310, 2311, 2323, 2324, 2325, 2326, 2327, 2328, 2329 2330, 2331, 2332, 2333, 2334, 2340, 2341, 2343, 2344, 2348, 2349, 2350, 2351, 2352, 2353, 2355, 2357, 2358, 2360	1:50
2D	348	159	E facing section	2300, 2325	1:10

<i>Area</i>	<i>Drawing No.</i>	<i>Sheet No.</i>	<i>Subject</i>	<i>Contexts</i>	<i>Scale</i>
2D	349	159	NW facing section	2280, 2323	1:10
2D	350	159	SE facing section	2280, 2326	1:10
2D	351	159	S facing section	2311, 2335, 2337, 2338	1:10
2D	352	161	Pre-ex plan Site 2D at East	2278, 2279, 2288, 2289, 2291, 2292, 2293, 2312, 2313, 2314, 2315, 2319, 2320, 2321, 2332, 2336, 2339, 2346, 2347, 2348, 2350, 2351, 2357, 2360	1:50
2D	353	162	Post-ex plan	2279, 2288	1:20
2D	354	159	W facing section	2309, 2341	1:10
2D	355	166	Mid-ex plan	2234, 2280, 2323, 2326	1:20
2D	356	159	W facing section	2306, 2343	1:10
2D	357	159	N facing section	2334, 2344	1:10
2D	358	163	Post-ex plan	2329, 2330, 2301, 2352, 2353	1:20
2D	359	163	Post-ex plan	2306, 2343	1:20
2D	360	163	Post-ex plan	2311, 2327, 2328, 2355	1:20
2D	361	163	Post-ex plan	2300, 2325	1:20
2D	362	163	Post-ex plan	2309, 2341	1:20
2D	363	163	Post-ex plan	2331, 2349	1:20
2D	364	163	Post-ex plan	2296, 2310, 2324	1:20
2D	365	163	Post-ex plan	2339, 2340	1:20
2D	366	159	S facing section	2331, 2349	1:10
2D	367	159	S facing section	2329, 2352	1:10
2D	368	159	S facing section	2330, 2353	1:10
2D	369	159	S facing section	2327, 2328	1:10
2D	370	164	E facing section Slot 1	2348, 2350, 2351, 2357	1:20
2D	371	164	W facing section Slot 2	2348, 2350	1:20
2D	372	164	E facing section Slot 3	2348, 2350, 2351, 2357	1:20
2D	373	164	W facing section Slot 4	2278, 2332, 2348, 2350	1:20
2D	374	165	Post-ex plan Slot 1	23332, 2350, 2357	1:20
2D	375	165	Post-ex plan Slot 2	2350	1:20
2D	376	165	Post-ex plan Slot 3	2332, 2350, 2357	1:20
2D	377	165	Post-ex plan Slot 4	2332, 2350, 2357	1:20
2D	378	166	Post-ex plan	2280, 2323, 2326, 2344	1:20
2D	379	166	Mid-ex plan	2234, 2344	1:20
2D	380	166	NW facing section	2234, 2344	1:10
2D	381	164	W facing section Slot 5	2278, 2302, 2332, 2348, 2350, 2351	1:20
2D	382	165	Post-ex plan Slot 5	2332, 2350	1:20
2D	383	167	Post-ex plan Slot 6	2350, 2357	1:20
2D	384	167	W facing section Slot 6	2348, 2350, 2351, 2357	1:20
2D	385	164	E facing section Slot 7	2348, 2350	1:20
2D	386	167	Post-ex plan	2332, 2350, 2357	1:20
2D	387	167	SE facing section Slot 7	2278, 2332, 2348, 2351, 2357	1:20

<i>Area</i>	<i>Drawing No.</i>	<i>Sheet No.</i>	<i>Subject</i>	<i>Contexts</i>	<i>Scale</i>
2D	388	167	Post-ex plan Slot 7	2332, 2350	1:20
2D	389	167	SE facing section Slot 7	2348, 2350	1:10
2D	390	169	Plan of W end of 2348	2348, 2350	1:20
2B	391	168	Plan of well		1:20
2B	392	168	Section of well		1:10
2D	393	169	Post-ex plan	2278, 2279, 2288, 2289, 2312, 2313, 2315, 2319, 2320 2321, 2332, 2339, 2340, 2348, 2350, 2351, 2357, 2358, 2360,	1:50
2D	394	170	Post-ex plan	2300, 2301, 2306, 2309, 2310, 2311, 2324, 2325, 2327, 2328, 2329, 2330, 2331, 2332, 2333, 2341, 2343, 2348 2349, 2350, 2351, 2352, 2353, 2355, 2357, 2358, 2360	1:50

12.5 List of Photographs

Film Number 14

<i>Area</i>	<i>Frame</i>	<i>Digital Number</i>	<i>Context No.</i>	<i>Subject</i>	<i>Taken from</i>	<i>Date</i>
2A	22	P4220080		General shot of area after topsoil removal and cleaned		22/4/08
2A	23	P4220081		General shot of area after topsoil removal and cleaned	E	22/4/08
2A	24	P4220082		General shot of area after topsoil removal and cleaned	E	22/4/08
2A	25	P4220083		General shot of area after topsoil removal and cleaned	E	22/4/08
2A	26	P4220084		General shot of area after topsoil removal and cleaned	E	22/4/08
2A	27	P4220085		General shot of area after topsoil removal and cleaned	E	22/4/08
2A	28	P4220086		General shot of area after topsoil removal and cleaned	NW	22/4/08
2A	29	P4220087	2004	Topsoil removed and cleaned	W	22/4/08
2A	30	P4220088	2004	Topsoil removed and cleaned	W	22/4/08
2A	31	P4220089	2004	Topsoil removed and cleaned	NW	22/4/08
2A	32	P4220090	2005	Field drain	S	22/4/08
2A	33	P4220090	2006	Linear feature	SW	22/4/08
2A	34	P4220092	2204	Mineral staining downhill of 2004	W	22/4/08
2A	35	P4230093	2013	Field drain	S	23/4/08

Film Number 15

<i>Area</i>	<i>Frame</i>	<i>Digital Number</i>	<i>Context No.</i>	<i>Subject</i>	<i>Taken from</i>	<i>Date</i>
	1			Film ID shot		23/4/08
2A	2	P4230094	2029	Pre-excavation; removal of topsoil	S	23/4/08
2A	3	P4230095	2029	Post-excavation; removal of stones	S	23/4/08
2A	4	P4230096	2004	Mid-excavation showing collapsed stones in fill	NW	23/4/08
2A	5	P4230097	2023	Pre-excavation of linear feature and metalled surface	NE	23/4/08
2A	6	P4230098	2008	Curving feature in corn drying kiln	S	23/4/08
2A	7	P4240099	2004,2030	Shot of jawbone (SF46) in section	S	24/4/08
2A	8	P4240100	2008,2031	Linear feature in ditch	W	24/4/08
2A	9	P4240101	2008,2031	Kiln and enclosing ditch	SW	24/4/08
2A	10	P4240102	2004	Kiln and enclosing ditch	NE	24/4/08
2A	11	P4240103	2004	Kiln and enclosing ditch	N	24/4/08
2A	12	P4240104	2004	Kiln detail and Chris	NW	24/4/08
2A	13	P4240105	2004	Kiln detail and Chris	NW	24/4/08
2A	14	P4240107	2030,2032	Lower fill of corn drying kiln	W	24/4/08
2A	15	P4240108	2008	South facing section	S	24/4/08
2A	16	P4240109	2003,2023	Kevin removing (2002) onto cobbles of (2023)	S	24/4/08
2A	17	P4240110	2024,2027, 2025,2026	West end of trench	NW	24/4/08
2A	18	P4240111	2025,2026	Drains	N	24/4/08
2A	19	P4240112	2005	Field drain; north/south alignment	N	24/4/08
2A	20	P4250113	2004,2032	South facing section of kiln fill	S	25/4/08
2A	21	P4250114	2030	Post-excavation shot of section through kiln	W	25/4/08
2A	22	P4250115	2030	Post-excavation shot of section through kiln	E	25/4/08
2A	23	P4250116	2030	View of possible hatch or flue into fire pit	N	25/4/08
2A	24	P4250117	2034	Ash deposit at base of kiln	W	25/4/08
2A	25	P4250118	2006	Pre-excavation shot	SE	25/4/08
2A	26	P4250119	2005,2023	(2002) removed	S	25/4/08
2A	27	P4250120	2003	(2002) removed east of (2023)	W	25/4/08
2A	28	P4250121		Kiln and Chris; fill (2004) removed	SW	25/4/08
2A	29	P4250122	2006,2036	Mid-excavation view of north end of (2006)	SW	25/4/08
2A	30	P4250123	2024	Line of evaluation trench	W	25/4/08
2A	31	P4250124	2006	East end of trench	E	25/4/08
2A	32	P4250125		East end of trench	E	25/4/08
2A	33	P4250126		East end of trench	E	28/4/08
2A	34	P4280012	2030,2038	Post-excavation view of corn drying kiln	W	28/4/08
2A	35	P4280013	2030,2038	Post-excavation view of corn drying kiln	E	28/4/08
2A	36	P4280014	2014	East end of drain or kiln flue	W	28/4/08
2A	37 (no B/W)	-	-	Working Shot (colour print only)	S	28/4/08

Film Number 16

<i>Area</i>	<i>Frame</i>	<i>D i g i t a l Number</i>	<i>Context No.</i>	<i>Subject</i>	<i>T a k e n from</i>	<i>Date</i>
	1			Film ID shot		
2A	2	P4280012	2014,2039	Post-excavation shot of west end of drain or flue	W	28/4/08
2A	3	P4280016	2040,2008	Pre-excavation view and kiln in background	E	28/4/08
2A	4	P4280017	2040	South facing section	S	28/4/08
2A	5	P4280018	2014,2039	West facing section of drain or flue in kiln	W	28/4/08
2A	6	P4280019	2041	Post-excavation view	S	28/4/08
2A	7	P4290020	2036,2037	North-west facing section of circular feature	NW	29/4/08
2A	8	P4290021	2036,2037	Mid-excavation shot of circular feature	MW	29/4/08
2A	9	P4290022	2003	After removal of (2002)	NE	29/4/08
2A	10	P4290023	2003	After removal of (2002)	N	29/4/08
2A	11	P4290024	2003	After removal of (2002)	NW	29/4/08
2A	12	P4290025	2025,2026	Mid-excavation	W	29/4/08
2A	13	P4290026	2005,2003	After removal of (2002)	S	29/4/08
2A	14	P4290027	2005	After removal of (2002)	S	29/4/08
2A	15	P4290028	2005	After removal of (2002)	N	29/4/08
2A	16	P4290030	2023	After removal of (2002)	NW	29/4/08
2A	17	P4290031	2023	After removal of (2002)	SE	29/4/08
2A	18	P4290032	2006,2043, 2036,2037	North-west facing section of Slot 1	NW	29/4/08
2A	19	P4290033	2006,2043, 2036,2037	North east facing section of feature	NE	29/4/08
2A	20	P4290034	2023	Slot through fill	SE	29/4/08
2A	21		2023	Slot through fill	NW	29/4/08
2A	22	P4290035	2026	South-east facing section of drain	SE	29/4/08
2A	23	P4300036	2005	South facing section of field drain	S	30/4/08
2A	24	P4300037	2044,2045	Modern field drain	N	30/4/08
2A	25	P4300038	2044,2045	Modern field drain	N	30/4/08
2A	26	P4300039	2046	Pre-excavation view of possible circular feature	NW	30/4/08
2A	27	P4300040	2025	Southeast facing section	SE	30/4/08
2A	28	P4300041	2006,2043	North facing section of Slot 2	N	30/4/08
2A	29	P4300042	2043	Shot of slot 2 feature (2006)	W	30/4/08
2A	30	P5010043	2030	Post-excavation view of corn drying kiln	S	1/5/08
2A	31	P5010044	2003 and many	Pre-excavation view of cobbled area after removal of (2002)	S	1/5/08
2A	32	P5020045	2046	Fractured bedrock directly east of (2006)	NW	2/5/08
2A	33	P5020046		General view of north-east area of site	E	2/5/08
2A	34	P5020047	2006,2007	Detail of (2006) and (2007)	E	2/5/08
2A	35	P5020048	2006,2007	Detail of (2006) and (2007)	E	2/5/08
2A	36	P5020050	2003	East end of cobbles	NE	2/5/08
2A	37	P5020051	2003	West end of cobbles	NE	2/5/08
2A	38	P5020052	-	Shot of cobbles and drain (colour print only)	-	2/5/08

Film Number 17

<i>Area</i>	<i>Frame</i>	<i>D i g i t a l Number</i>	<i>Context No.</i>	<i>Subject</i>	<i>T a k e n from</i>	<i>Date</i>
	1	P5020053		ID shot		
2A	2	P5020054	2002	Cleaned back from the south of cobble	SW	2/5/08
2A	3	P5020055	2005	Field drain	S	2/5/08
2A	4	P5020056	2000	Area west of field drain (2027)	S	2/5/08
2A	5	P5020057	2052	Cobbles in west and drain (2028)	S	2/5/08
2A	6	P5020058	2052,2028	Cobbles in west and drain (2028)	N	2/5/08
2A	7	P5020059	2003	General view	W	2/5/08
2A	8	P5020060	2007	Northeast facing section	N	2/5/08
2A	9	P5020061	2007	Kiln	W	2/5/08
2A	10	P5020062	2007	Kiln	NW	2/5/08
2A	11	P5020063	2007	Kiln	NW	2/5/08
2A	12	P5060064	2007	Northeast facing section	NE	6/5/08
2A	13	P5060065	2007	Northwest facing section	NW	6/5/08
2A	14	P5060066	2007,2054	Northeast facing section	NE	6/5/08
2A	15	P5060067	2007,2053,2054	Mid excavation shot	N	6/5/08
2A	16	P5070068	2007,2053	Northwest facing section after extension of section	NW	6/5/08
2A	17	P5070069	2007,2053,2054	Mid excavation	N	7/5/08
2A	18	P5070070	2007,2053,2054	Post excavation	N	7/5/08
2A	19	P5070071	2007,2053,2054	Post excavation	N	7/5/08
2A	20	P5070072	2007,2053,2054	Post excavation	S	7/5/08
2A	21	P5070073	2007,2053,2054	Post excavation	E	7/5/08
2A	22	P5080074	2056	Pre excavation shot, possible small circular feature	W	8/5/08
2A	23	P5080075	2056,2057	East facing section through circular feature	E	8/5/08
2A	24	P5080076	2012,2058	East facing section through possible curvilinear feature	E	8/5/08
2A	25	P5080077	2023,2001	2003 removed in a small slot outside natural	S	8/5/08
2A	26	P5080078	2058,2028	After 200 removed (2057,2052)	S	9/5/08
2A	27	P5090079	2058	After 200 removed (2057,2052)	S	9/5/08
2A	28	P5090080	2058	Northwest corner after 2000 removed	S	9/5/08
2A	29	P5090081	2058	Northwest corner after 2000 removed	W	9/5/08
2A	30	P5090082	2059,2003,2002	Mid excavation of stone spread above (2003)	SW	12/5/08
2A	31	P5120001	2059,2003,2002	Mid excavation of stone spread above (2003)	NW	12/5/08
2A	32	P5120002	2059,2003,2002	Mid excavation of stone spread above (2003)	NE	12/5/08
2A	33	P5120003	2059,2003,2002	Mid excavation of stone spread above (2003)	SE	12/5/08
2A	34	P5120004	2038,2063	Kiln flue ½ removed onto natural	W	12/5/08
2A	35	P5120005	2038,2063	Kiln flue ½ removed onto natural	S	12/5/08

Film Number 18

<i>Area</i>	<i>Frame</i>	<i>Digital Number</i>	<i>Context No.</i>	<i>Subject</i>	<i>Take n from</i>	<i>Date</i>
	1			Film ID shot		
2A	2	P5130009	2003,2005,2024	Post excavation with (2059) stone spread removed	SW	13/5/08
2A	3	P5130010	2003,2005,2024	Post excavation with (2059) stone spread removed	NW	13/5/08
2A	4	P5130011	2003,2005,2024	Post excavation with (2059) stone spread removed	NE	13/5/08
2A	5	P5130012	2003,2005,2024	Post excavation with (2059) stone spread removed	SE	13/5/08
2A	6	P5130013	2030,2065	Stone floor removed of kiln 2063 fill	W	13/5/08
2A	7	P5130014	2030,2065	South facing section	SE	13/5/08
2A	8	P5130015		West end of trench and field drain	SW	13/5/08
2A	9	P5130016		West end of trench and field drain	NW	13/5/08
2A	10	P5130017		West end of trench and field drain	NW	13/5/08
2A	11	P5130018	2065	2063 removed inside flue	W	13/5/08
2A	12	P5130019		Moving off topsoil	NW	13/5/08
2A	13	P5130020	2067	Pre excavation	S	13/5/08
2A	14	P5140021	2067	Slot through linear feature	S	14/5/08
2A	15	P5140022	2009	Pre excavation of linear feature	W	14/5/08
2A	16	P5140023	2009,2010,2070, 2071	Pre excavation	W	14/5/08
2A	17	P5140024	2009,2010,2070, 2071	Pre excavation	E	14/5/08
2A	18	P5140025		East end of trench (north)	E	14/5/08
2A	19	P5140026		East end of trench (south)	E	14/5/08
2A	20	P5140027	2072,2010	Pre excavation recent modern feature	N	14/5/08
2A	21	P5140028	2011	Pre excavation of linear feature in trench edge	S	14/5/08
2A	22	P5140029	2072,2010,2001	Pre excavation (wider shot)	S	14/5/08
2A	23	P5140030	2010	Pre excavation of linear feature	W	14/5/08
2A	24	P5150031		Northwest corner west of field drain 2061	S	15/5/08
2A	25	P5150032	2076	Pre excavation shot of possible feature	NW	15/5/08
2A	26	P5150033	2073,2075	Pre excavation of linear feature	W	15/5/08
2A	27	P5150034	2078,2077	Cut of modern recent feature not full excavation	W	15/5/08
2A	28	P5150035	2078,2077,2072	North facing section of modern recent feature	N	15/5/08
2A	29	P5150037	2079	Cut of linear feature northeast/southwest in east	NW	15/5/08
2A	30	P5150038	2079,2009	Northeast facing section of linear feature northeast /southwest in east	NE	15/5/08
2A	31	P5150039		Northwest corner section (south facing)west end	S	15/5/08
2A	32	P5150040		Northwest corner section (south facing)east	S	15/5/08
2A	33	P5150041		Northwest corner section (south facing)see drawing	S	15/5/08

Film Number 19

<i>Area</i>	<i>Frame</i>	<i>D i g i t a l Number</i>	<i>Context No.</i>	<i>Subject</i>	<i>T a k e n from</i>	<i>Date</i>
	1	P5150043		Film ID shot	S	15/5/08
2A	2	P5150044	2028	South facing section	S	15/5/08
2A	3	P5150045	2028	South facing section	S	15/5/08
2A	4	P5150046	2027	South facing section	S	15/5/08
2A	5	P5150047		Field drain	S	15/5/08
2A	6	P5150048		South facing section	S	15/5/08
2A	7	P5150049		South facing section	S	15/5/08
2A	8	P5150050	2003	South facing section	S	15/5/08
2A	9	P5150051	2003	Edge of cobbles	S	15/5/08
2A	10	P5150052	2010,2080	West facing section through linear feature slot 1	W	15/5/08
2A	11	P5150053	2083	Pre excavation	W	15/5/08
2A	12	P5150054	2082	Pre excavation	W	15/5/08
2A	13	P5150055	2015,2016	Pre excavation	W	15/5/08
2A	14	P5150056	2011	Linear feature – slot though	SW	15/5/08
2A	15	P5150057	2081	Ceramic drain	S	15/5/08
2A	16	P5150058	2075	Post excavation	SE	16/5/08
2A	17	P5160059	2009,2010,2070	West facing section of slot through linear feature	W	16/5/08
2A	18	P5160060	2071,2079,2080	Plan view of slot through linear feature post excavation	N	16/5/08
2A	19	P5160061	2010,2080	West facing section through linear feature slot 3	W	16/5/08
2A	20	P5160063	2080	Post excavation shot slot 3 linear feature after removal of 2010	S	16/5/08
2A	21	P5160065	2080	Post excavation shot slot 1 linear feature after removal of 2010	S	16/5/08
2A	22	P5160066	2090	Pre excavation	S	16/5/08
2A	23	P5160067	2089	Pre excavation	S	16/5/08
2A	24	P5160068	2088	Pre excavation	S	16/5/08
2A	25	P5160069	2087	Pre excavation	S	16/5/08
2A	26	P5160070	2073	Pre excavation	W	16/5/08
2A	27	P5160071		Northeast end with lots of diggers (working shot)	W	16/5/08
2A	28	P5160074	2003	Edge of cobbles onto clay	S	16/5/08
2A	29	P5160075	2025	Detail of west edge of cobbles in cut 2025	S	16/5/08
2A	30	P5160076		East end of trench end north side	E	16/5/08
2A	31	P5160077		East end of trench end south side	E	16/5/08
2A	32	P5160078		East end of trench end northeast corner	E	16/5/08
2A	33	P5160079	2073	Post excavation	W	16/5/08
2A	34	P5160080	2009,2070	West extent of linear feature pre excavation	N	16/5/08

Film Number 20

<i>Area</i>	<i>Frame</i>	<i>D i g i t a l Number</i>	<i>Context No.</i>	<i>Subject</i>	<i>T a k e n from</i>	<i>Date</i>
	1			Film ID shot		16/5/08
2A	2	P5160082	2082,2092	West facing section	W	16/5/08
2A	3	P5160081	2092	Post excavation plan view of linear feature	N	16/5/08
2A	4	P5160083	2093	Pre excavation	E	16/5/08
2A	5	P5160084	2058/2052?	Pre excavation	W	16/5/08
2A	6	P5160085	2093	Post excavation of east facing section	E	16/5/08
2A	7	P5160086	2095,2015	West facing section	W	16/5/08
2A	8	P5160087	2074	Pre excavation	E	16/5/08
2A	9	P5160088	2010,2080	Southeast facing section slot 4 showing possible fork in linear feature	SE	16/5/08
2A	10	P5160089	2010,2080	Northwest facing section of linear feature	NW	16/5/08
2A	11	P5160090	2080	Pre excavation shot	N	16/5/08
2A	12	P5160091	2071	Post excavation of east terminal of linear feature	S	16/5/08
2A	13	P5190092	2074	East facing section of pit	E	19/5/08
2A	14	P5190093	2093	Retaken east facing section of pit	E	19/5/08
2A	15	P5190094	2074	Retaken east facing section of pit	E	19/5/08
2A	16	P5190095	2024,2027	Area cleaned to subsoil	S	19/5/08
2A	17	P5190096	2024,2026	Area cleaned to subsoil	S	19/5/08
2A	18	P5190097	2083	West facing section of 2083	W	19/5/08
2A	19	P5190098	2081,2089	West facing section through 2089	W	19/5/08
2A	20	P5190099	2082 (slot2)	West facing section of 2082 slot 2	W	19/5/08
2A	21	P5190100	2098	After west part of 2052 removed	S	19/5/08
2A	22	P5190101	2010	Pre excavation of northeast terminal of east 'Y'	SW	19/5/08
2A	23	P5200102	2087	East facing section	E	20/5/08
2A	24	P5200104	2100,2101	Pre excavation of 2100 and 2101	N	20/5/08
2A	25	P5200105	2087,2082	Clean back over 2087 no visible trace of 2083 running parallel	S	20/5/08
2A	26	P5200106	2082,2083	Pre excavation plan of 2082 showing relation ship with 2083	W	20/5/08
2A	27	P5200107	2100	Southwest facing section of 2100	SW	20/5/08
2A	28				NE	20/5/08
2A	29	P5200109	2100	Plan of 2100, facing southeast	SE	20/5/08
2A	30	P5200110	2101	East facing section of 2101	E	20/5/08
2A	31	P5200111	2101	Plan of 2101 facing east	E	20/5/08
2A	32	P5210112	2082	post excavation plan of 2082 continuation of feature	S	20/5/08
2A	33	P5210113	2080	Post excavation of northeast terminal of linear feature	S	21/5/08
2A	34	P5210114	2010,2080	East-northeast facing section	ENE	21/5/08

<i>Area</i>	<i>Frame</i>	<i>D i g i t a l number</i>	<i>Context No.</i>	<i>Subject</i>	<i>T a k e n from</i>	<i>Date</i>
2A	35	P5210115	2089,2109	North facing section of 2089	N	21/5/08
2A	36	P5210116	2089,2109	Post excavation plan of 2089 east facing	W	21/5/08

Film Number 21

<i>Area</i>	<i>Frame</i>	<i>D i g i t a l number</i>	<i>Context No.</i>	<i>Subject</i>	<i>Taken from</i>	<i>Date</i>
	1			Film ID shot		21/5/08
2A	2	P5210117	2110	Linear feature cutting 2024 (pre excavation)	W	21/5/08
2A	3	P5210118	2110	Linear feature 2024 west facing section	W	21/5/08
2A	4	P5210119	2089	Pre excavation south half of feature	S	21/5/08
2A	5	P5210120	2110	Linear feature east facing section	E	21/5/08
2A	6	P5220001	2066	Trench cutting feature 2066	N	22/5/08
2A	7	P5220002	2114,2017	Pre excavation of two linear features	W	22/5/08
2A	8	P5220003	2115	Pre excavation of linear feature	E	22/5/08
2A	9	P5220004	2006	Pre excavation of slot 3 2006	E	22/5/08
2A	10	P5220005	2030,2116	Section though kiln sides	S	22/5/08
2A	11	P5220006	2117	Kiln base and flue cut	W	22/5/08
2A	12	P5220007	2003	Working shot, cobbles removed close up	E	22/5/08
2A	13	P5220008	2003	Working shot, cobbles removed wide shot	S	22/5/08
2A	14	P5220009	2018,2019	Pre excavation	S	22/5/08
2A	15	P5220010	2019	Southeast facing section	SE	22/5/08
2A	16	P5230011	2112	Pre excavation (little remained)	E	23/5/08
2A	17	P5230012	2003	Working shot cobbles removed close up	W	23/5/08
2A	18	P5230013	2003	Working shot wide shot	W	23/5/08
2A	19	P5230014	2119	Post excavation	W	23/5/08
2A	20	P5230018	2006 slot 3	Post excavation plan	W	23/5/08
2A	21	P5230019	2006 slot 3	North facing section	N	23/5/08
2A	22	P5230020	2121	West facing section	W	23/5/08
2A	23	P5230021	2021	South facing section	S	23/5/08
2A	24	P5230022	2090	North facing section	N	23/5/08
2A	25	P5230023	2104	South-southeast facing section	SSE	23/5/08
2A	26	P5230025	2104	North-northwest facing section	NNW	23/5/08
2A	27	P5230026	2104	Plan view	E	23/5/08
2A	28	P5230027	2012	East facing section	E	23/5/08
2A	29		2012	Post excavation	E	23/5/08
2A	30	P5230028	2006 slot 3	Post excavation south facing section	S	23/5/08
2A	31	P5230029	2003	Post excavation cobbles removed	W	23/5/08
2A	32	P5230030	2105	South facing section	S	23/5/08
2A	33	P5230031	2105	North facing section	N	23/5/08
2A	34	P5230032	2105	Plan view	E	23/5/08
2A	35	P5230033	2114,2017	South facing section	S	23/5/08
2A	36	P5230034	2114,2014	Plan view	W	23/5/08

<i>Area</i>	<i>Frame</i>	<i>D i g i t a l number</i>	<i>Context No.</i>	<i>Subject</i>	<i>Taken from</i>	<i>Date</i>
2A	37	P5230036	2120	Post excavation south facing section	S	23/5/08
2A	38		2120	Plan view post excavation	W	23/5/08

Film Number 22

<i>Area</i>	<i>Frame</i>	<i>D i g i t a l Number</i>	<i>Context No.</i>	<i>Subject</i>	<i>T a k e n from</i>	<i>Date</i>
	1			Film ID shot		23/5/08
2A	2	P5230038	2120	Post excavation south facing section	S	23/5/08
2A	3	P5230039	2120	Post excavation plan view	W	23/5/08
2A	4	P5270040	2115	Post excavation of south facing section	S	23/5/08
2A	5	P5270041	2120	Post excavation of south facing section	S	27/5/08
2A	6	P5270042	2103 slot 2	Post excavation of south facing section	S	27/5/08
2A	7	P5270043	2103,2105	Post excavation of evaluation trench revealing linear feature	E	27/5/08
2A	8	P5280044	2104 slot 2	Post excavation of south facing section	S	28/5/08
2A	9	P5280045	2105 slot 2	Post excavation of south facing section	S	28/5/08
2A	10	P5280046	2105 slot 1	Post excavation of south facing section (overcut)	S	28/5/08
2A	11	P5280047	2104 slot 1	Post excavation of south facing section (overcut)	S	28/5/08
2A	12	P5280048		General working shot of site from spoil heap	E	28/5/08
2A	13	P5280049		General working shot of site from spoil heap	E	28/5/08
2A	14	P5280050	2105,2089	South facing baulk of linear feature	S	28/5/08
2A	15	P5280051	2105,2089	South facing baulk of linear feature	S	28/5/08
2A	16	P5280052	2104,2105,2089	Wider shot of both linear features joining to 2089	S	28/5/08
2A	17	P5280053	2125	Cut of 2104 going into baulk of 2089	E	28/5/08
2A	18	P5290054	2033,2008	Northeast facing section of [2033] showing (2008)	NE	28/5/08
2A	19	P5290056	2033,2008	Post excavation of slot through [2033] and (2008)	NE	29/5/08
2A	20	P5290057	2105,2104,2089	North terminal of 2104 north facing section cutting 2105	N	29/5/08
2A	21	P5290058	2109,2124,2125	Cut of north terminal of 2104	E	29/5/08
2A	22	P5290059	2076	Pre excavation	N	29/5/08
2A	23	P5290060	2064	Pre excavation	E	29/5/08
2A	24	P5290061	2076,2129	Post excavation slot through linear feature showing west terminal	S	29/5/08
2A	25	P5290062	2076,2129	East facing section	E	29/5/08
2A	26	P5290063	2090,2131	Linear feature between 2010 and 2089	N	29/5/08

<i>Area</i>	<i>Frame</i>	<i>D i g i t a l number</i>	<i>Context No.</i>	<i>Subject</i>	<i>T a k e n from</i>	<i>Date</i>
2A	27	P5290064	2120,2132	Southeast facing section through linear feature slot 2	SE	29/5/08
2A	28	P5290065	2090,2131	South facing section of linear feature	S	29/5/08
2A	29	P5300066	2120,2132	Slot 2 linear feature post excavation shot	NE	30/5/08
2A	30	P5300067	2120,2135	Slot 2 linear feature post excavation shot	NW	30/5/08
2A	31	P5300068	2104,2064	Post excavation 2064 joining 2104	E	30/5/08
2A	32	P5300069	2115	Pre excavation shot	NW	30/5/08
2A	33	P5300070	2104,2105	Working shot looking along features showing slots 1-4	N	30/5/08
2A	34	P5300071	2103	South facing section post excavation	S	30/5/08
2A	35	P5300072		General working shot	S	30/5/08
2A	36	P5300073		General working shot	S	30/5/08

Film Number 23

<i>Area</i>	<i>Frame</i>	<i>D i g i t a l number</i>	<i>Context No.</i>	<i>Subject</i>	<i>T a k e n from</i>	<i>Date</i>
2A	1	P300074	-	Film ID shot		30/5/08
2A	2	P300075	2064, 2133	Post-ex shot of slot through 2064	W	30/5/08
2A	3	P300076	2064, 2133	Section of 2064	NW	30/5/08
2A	4	P300077	2130	Pre-ex of square feature	E	30/5/08
2A	5	P300078	-	General shot of cobbles (wet)	SW	30/5/08
2A	6	P300079	-	General view of cobbles (wet)	N	30/5/08
2A	7	-	-	General working shot of site	E	30/5/08
2A	8	P6020081	2130	Post-ex half section	W	2/6/08
2A	9	P6020083	2135, 2136	Post-ex shot of linear features	S	2/6/08
2A	10	P6020084	2135, 2136	West facing sections	W	2/6/08
2A	11	P6020085	2139	Pre-ex of oval feature south of rock outcrop	S	2/6/08
2A	12	P6020086	2139	Post-ex of oval feature	S	2/6/08
2A	13	P6020087	2064, 2133	West facing section	W	2/6/08
2A	14	P6020088	2137, 2138, 2144, 2143	South-West facing section through possible cess pit	SW	2/6/08
2A	15	P6020089	2137, 2138, 2145	Mid-ex shot of in situ wood – exposure normal	NW	3/6/08
2A	16	P6030090	2137, 2138, 2145	Mid-ex shot of in situ wood – exposure lighter x1	NW	3/6/08
2A	17	P6030091	2137, 2138, 2145	Mid-ex shot of in situ wood – exposure lighter x2	NW	3/6/08
2A	18	P6030092	2137, 2138, 2145	Mid-ex shot of in situ wood – exposure normal	SW	3/6/08
2A	19	P6030093	2137, 2138, 2145	Mid-ex shot of in situ wood – exposure lighter x1	SW	3/6/08
2A	20	P6030094	2137, 2138, 2145	Mid-ex shot of in situ wood – exposure lighter x2	SW	3/6/08
2A	21	P6030096	2115	Post-ex of linear feature	S	3/6/08
2A	22	P6030097	2064	Post-ex of linear feature	W	3/6/08

<i>Area</i>	<i>Frame</i>	<i>D i g i t a l number</i>	<i>Context No.</i>	<i>Subject</i>	<i>T a k e n from</i>	<i>Date</i>
2A	23	P6030098	2064	Post-ex of linear feature- West end	S	3/6/08
2A	24	-	2137, 2138	North-West facing section- mid-ex shot	NW	4/6/08
2A	25	P6040099	-	General view	E	4/6/08
2A	26	P6040100	-	General view	E	4/6/08
2A	27	P6050101	2114, 2146	North facing section of slot 2	N	5/6/08
2A	28	P6050102	2114, 2146	South facing section of slot 1	S	5/6/08
2A	29	P6050103	2147	Working shot - South-West facing section	SW	5/6/08
2A	30	P6050104	2143	Working shot - North-East facing section	NE	5/6/08
2B	31	P6050105	-	General view of East end	SE	5/6/08
2B	32	P6050106	2203	Detail of linear feature	SE	5/6/08
2B	33	P6050107	-	General view of West end	SE	5/6/08
2B	34	P6050108	2200, 2201, 2202, 2203	Detail of linear feature	S	5/6/08
2C	35	P6050109	-	Blasé and rubble removed	S	5/6/08
2A	36	-	2135, 2136	Pre-ex shot of linear features	S	2/6/08

Film Number 24

<i>Area</i>	<i>Frame</i>	<i>D i g i t a l number</i>	<i>Context No.</i>	<i>Subject</i>	<i>T a k e n from</i>	<i>Date</i>
2C	1	-	-	ID shot	-	5/6/08
2C	2	P6050110	-	Working shot	S	5/6/08
2C	3	P6050111	2206	Section of trench	-	5/6/08
2C	4	P5060112	-	Working shot	N	5/6/08
2C	5	P5060113	2209	Linear feature	NE	5/6/08
2C	6	P6050114	2208	Cobbles	-	5/6/08
2A	7	P6050115	2114, 2146	Post-ex of ditch	-	5/6/08
2A	8	P6060116	2149	Pre-ex shot	S	6/6/08
2A	9	P6060117	2149	Post-ex shot of natural hollow	S	6/6/08
2A	10	P6060118	2147, 2148	Pre-ex of ditch features at South-East end of trench	S	6/6/08
2A	11	P6060119	2148, 2157	South-West facing section of slot through ditch	SW	6/6/08
2A	12	P6060120	2147, 2158	South-East facing section of slot through ditch	SE	6/6/08
2A	13	P6060121	2148, 2157, 2147, 2158	Post-ex of slot	S	6/6/08
2C	14	P6090001	2209	Working shot – visible extent of (2209)	S	6/6/08
2C	15	P6090002	2209	Pre-ex detail shot	W	6/6/08
2A	16	P6090003	2147	General shot of ephemeral feature after cleaning	SSE	9/6/08
2A	17	P6100004	2143, 2145, 2168, 2169	Mid-ex showing lower part of tree trunk and possible cut for	SW	10/6/08
2A	18	P6100005	2143, 2145, 2168, 2169	Sub-circular feature and mid-ex of tree trunk	S	10/6/08
2A	19	P6100006	2143, 2145, 2168, 2169	Sub-circular feature and mid-ex of tree trunk	S	10/6/08

<i>Area</i>	<i>Frame</i>	<i>D i g i t a l number</i>	<i>Context No.</i>	<i>Subject</i>	<i>T a k e n from</i>	<i>Date</i>
2A	20	P6100007	2145, 2169	Mid-ex of tree trunk and possible cut	N	10/6/08
2A	21	P6100008	2143, 2145, 2168, 2169	Working shot	NE	10/6/08
2A	22	P6100009	2145, 2169	Mid-ex of tree trunk and possible cut	SE	10/6/08
2A	23	P6100010	2165, 2166, 2044, 2045	North-East facing section of ditch and truncated field drain	NE	10/6/08
2A	24	P6100011	2167	Older ditch cut by field drain and feeding into (2114)	NE	10/6/08
2A	25	P6100012	2143, 2145	South-East facing section	SE	10/6/08
2A	26	P6100014	2143, 2145, 2168, 2169	North-West facing section	NW	10/6/08
2A	27	P6110015	2162	Pre-ex of possible post-hole	S	11/6/08
2A	28	P6110016	2163	Pre-ex of possible post-hole	S	11/6/08
2A	29	P6110017	2114, 2146, 2165, 2166	Post-ex showing intersection of ditches and truncated by field drain	N	11/6/08
2A	30	P6110018	2114, 2146, 2044, 2045	Post-ex showing [2146] truncated by field drain [2045]	S	11/6/08
2A	31	P6110019	2167	Showing terminal of [2167] inside of [2146]	SW	11/6/08
2A	32	P6110020	2164	Pre-ex of possible post-hole	S	11/6/08
2A	33	P6110021	2160	Pre-ex of possible post-hole	E	11/6/08
2A	34	P6110022	2161	Pre-ex of possible feature	W	11/6/08
2A	35	P6110023	2159	Pre-ex shot of area where possible pit truncates ditch (2105)	W	11/6/08
2A	36	P6110024	2145, 2143	North-West facing section	NW	11/6/08
2A	37	P6110025	2145, 2143	North-West facing section (no black & white)	W	11/6/08

Film Number 25

<i>Area</i>	<i>Frame</i>	<i>D i g i t a l number</i>	<i>Context No.</i>	<i>Subject</i>	<i>T a k e n from</i>	<i>Date</i>
2A	1	P6110026	-	ID shot	-	11/6/08
2A	2	P6110027	2170	Pre-ex of possible feature	N	11/6/08
2A	3	P6120028	2171	Pre-ex shot	S	12/6/08
2A	4	P6120029	2171, 2172	South facing section of shallow ditch	S	12/6/08
2B	5	P6120030	2211	North facing section	N	12/6/08
2B	6	P6120031	2217	North facing section	N	12/6/08
2B	7	P6120032	2239, 2238, 2234	General pre-ex shot of possible surfaces	NW	12/6/08
2B	8	P6120033	2239, 2238, 2234	General pre-ex shot of possible surfaces	NE	12/6/08
2A	9	P6130034	2152, 2151, 2150	General shot of area	S	13/6/08
2A	10	P6130035	2103	Area where ditch may curve	E	13/6/08
2B	11	P6130036	2211	South facing section	S	13/6/08
2B	12	P6160001	2227	Pre-ex shot	E	16/6/08
2B	13	P6160002	2218	Pre-ex shot of possible post-hole	S	16/6/08
2B	14	P6160003	2215	Pre-ex shot	S	16/6/08

<i>Area</i>	<i>Frame</i>	<i>D i g i t a l number</i>	<i>Context No.</i>	<i>Subject</i>	<i>T a k e n from</i>	<i>Date</i>
2B	15	P6160004	2225	Pre-ex shot of possible post-hole	S	16/6/08
2B	16	P6160005	2226	Pre-ex shot of possible post-hole	S	16/6/08
2B	17	P6160006	2230	Pre-ex shot	S	16/6/08
2B	18	P6160007	2231	Pre-ex shot of possible post-hole	S	16/6/08
2B	19	P6160008	2229	Pre-ex shot of possible post-hole	S	16/6/08
2B	20	P6160009	2228	Pre-ex of linear feature	SE	16/6/08
2B	21	P6160010	2232	Pre-ex of possible post-hole	S	16/6/08
2B	22	P6160011	2233	Pre-ex of possible post-hole	S	16/6/08
2B	23	P6160012	2241	Pre-ex of possible post-hole	S	16/6/08
2B	24	P6160013	2240	Pre-ex of possible post-hole	S	16/6/08
2B	25	P6160014	2239, 2238, 2235	Pre-ex of possible features	E	16/6/08
2B	26	P6160015	2242	Pre-ex of possible feature	NW	16/6/08
2B	27	P6160016	2236	Pre-ex of possible feature	E	16/6/08
2B	28	P6160017	2234	Pre-ex of possible feature	S	16/6/08
2B	29	P6160018	2204	South facing section at extreme north-east of trench	S	16/6/08
2B	30	P6160019	2231	South facing section	S	16/6/08
2B	31	P6160020	2230	North facing section	N	16/6/08
2B	32	P6160021	2229	North facing section	N	16/6/08
2B	33	P6160023	2226	East facing section	E	16/6/08
2B	34	P6160024	2225	East facing section (no black & white)	E	16/6/08
2B	35		2218	Mid-ex shot showing possible copper alloy staining (no black& white)	S	17/6/08

Film Number 26

<i>Area</i>	<i>Frame</i>	<i>D i g i t a l number</i>	<i>Context No.</i>	<i>Subject</i>	<i>T a k e n from</i>	<i>Date</i>
2B	1	-	-	ID shot	-	17/6/08
2B	2	P6170026	2215	South facing section (no colour)	S	17/6/08
2B	3	P6170027	2228	South-East facing section – slot 3	SE	17/6/08
2B	4	P6170028	2228	South-East facing section – slot 2	SE	17/6/08
2B	5	P6170029	2228	South-East facing section – slot 1	NW	17/6/08
2B	6	P6170030	2232	West facing section	W	17/6/08
2B	7	P6170031	2228	Post-ex overview of linear feature	NW	17/6/08
2B	8	P6170032	2228	Post-ex overview of linear feature	SE	17/6/08
2B	9	P6170033	2237	Section at South terminal of [2239]	S	17/6/08
2B	10	P6170034	2237	Post-ex of [2237]	S	17/6/08
2B	11	P6170035	2237	Post-ex of [2237]	N	17/6/08
2B	12	P6180036	2233	Half section of possible post-hole	E	18/6/08
2A	13	P6180037	2154	Post-ex showing slots	SW	18/6/08
2B	14	P6180038	-	Overview of North-East corner of trench	SW	18/6/08
2B	15	P6180039	-	Overview of North-East corner of trench (no colour)	SE	18/6/08
2B	16	P6180040	-	Overview of North-East corner of trench	W	18/6/08

<i>Area</i>	<i>Frame</i>	<i>D i g i t a l number</i>	<i>Context No.</i>	<i>Subject</i>	<i>T a k e n from</i>	<i>Date</i>
2B	17	P6180041	-	Overview of South-East corner of trench	N	18/6/08
2B	18	P6180042	-	Overview of South-East corner of trench	W	18/6/08
2B	19	P6180043	-	Working shot looking West across trench	E	18/6/08
2B	20	P6180044	-	Working shot from North-West corner of trench	NW	18/6/08
2B	21	P6180045	-	Working shot from South-West corner of trench	SW	18/6/08
2B	22	P6180046	2211	Working shot	NE	18/6/08
2B	23	P6180047	-	Cobbled area at east of site	W	18/6/08
2B	24	P6180048	-	Cobbled area at east of site	S	18/6/08
2B	25	P6180049	-	Cobbled area at east of site	E	18/6/08
2B	26	P6180050	-	Looking South over cobbles	N	18/6/08
2C	27	P6180051	-	Pre-ex shot of trench	N	18/6/08
2C	28	P6180052	-	Pre-ex shot of trench	W	18/6/08
2C	29	P6180053	-	Pre-ex shot of trench	S	18/6/08
2B	30	P6180054	-	Working shot looking East	W	18/6/08
2B	31	P6180055	-	Working shot looking East	W	18/6/08
2B	32	P6180056	-	Working shot looking North-East	SW	18/6/08
2B	33	P6180057	-	Working shot looking North	S	18/6/08
2B	34	P6180058	-	Working shot looking North-West	SE	18/6/08
2B	35	P6180059	-	Working shot looking West	E	18/6/08
2B	36	-	-	Working shot looking North-West (no black & white)	SE	18/6/08
2B	37	-	-	Working shot (no black & white)	-	18/6/08

Film Number 27

<i>Area</i>	<i>Frame</i>	<i>D i g i t a l number</i>	<i>Context No.</i>	<i>Subject</i>	<i>T a k e n from</i>	<i>Date</i>
2B	1	-	-	ID shot	-	18/9/08
2B	2	P6190060	2250, 2251	Pre-ex shot	W	19/6/08
2A	3	P6190061	-	Trench in site 2A	W	19/6/08
2A	4	P6190062	-	Trench in site 2A	E	19/6/08
2A	5	P6190063	2105, 2125	North facing section	N	19/6/08
2A	6	P6190064	2115, 2128	North facing section	N	19/6/08
2A	7	P6190065	2114	North facing section	N	19/6/08
2A	8	P6190066	2252	Stone drain	NE	19/6/08
2B	9	P6190067	2250, 2251	South facing section	S	19/6/08
2B	10	P6190068	2250, 2251	Post-ex shot	S	19/6/08
2B	11	P6190069	2218, 2254	South facing section	S	19/6/08
2B	12	P6190070	2218, 2254	Post-ex shot	S	19/6/08
2B	13	P6190071	2227, 2255	Mid-ex shot of animal burial	E	19/6/08
2B	14	P6200072	2220-2204	Location shot of trench section in North-East corner	SE	20/6/08
2B	15	P6200073	2220-2204	Section of trench in North-East corner	S	20/6/08
2C	16	P6200074	-	Pre-ex of slot 1	N	20/6/08
2C	17	P6200075	-	Pre-ex of slot 1	S	20/6/08
2C	18	P6200076	-	Pre-ex of slot 2	S	20/6/08

<i>Area</i>	<i>Frame</i>	<i>D i g i t a l number</i>	<i>Context No.</i>	<i>Subject</i>	<i>T a k e n from</i>	<i>Date</i>
2C	19	P6200077	-	Pre-ex of slot 2	N	20/6/08
2B	20	P6200078	2266	Circular feature	S	20/6/08
2B	21	P6200079	2267	Drain	S	20/6/08
2B	22	P6230080	2227	Post-ex of animal burial	E	23/6/08
2C	23	P6230081	-	Mid-ex shot of slot 1	S	23/6/08
2C	24	P6230082	-	Mid-ex shot of slot 1	N	23/6/08
2C	25	P6230083	-	Mid-ex shot of slot 2	S	23/6/08
2C	26	P6230084	-	Possible ditch feature in slot 1 – pre-ex	W	23/6/08
2C	27	P6240085	2268, 2274	Post-ex shot of slot 1	S	24/6/08
2C	28	P6240086	2268, 2274	Post-ex shot of slot 1	N	24/6/08
2C	29	P6240087	2205, 2206, 2207	West facing section	W	24/6/08
2C	30	P6240088	2268	Pre-ex shot	S	24/6/08
2C	31	P6240089	2269, 2270	Pre-ex shot	S	24/6/08
2C	32	P6240090	2271, 2272	Pre-ex shot	S	24/6/08
2C	33	P6240091	2273, 2274	Pre-ex shot	N	24/6/08
2C	34	P6250098	2277, 2275	East facing section	E	25/6/08
2C	35	P6260001	2281	Pre-ex shot	SW	26/6/08
2C	36	P6260002	2281, 2282	Post-ex – East facing section	NE	26/6/08
2C	37	P6260003	-	Post-ex of slot – West side of trench	S	26/6/08

Film Number 28

<i>Area</i>	<i>Frame</i>	<i>D i g i t a l number</i>	<i>Context No.</i>	<i>Subject</i>	<i>Taken from</i>	<i>Date</i>
2C	1		-	ID shot	-	26/6/08
2C	2	P6260004	-	Post-ex shot of slot 2	N	26/6/08
2C	3	P6260005	-	West facing section of trench	E	26/6/08
2C	4	P6260006	2272, 2273	Cobbles at North of trench and possible wall	N	26/6/08
2D	5	P6270007	2279	Pre-ex after first clean	E	27/6/08
2D	6	P6270008	2280	Pre-ex after first clean	SE	27/6/08
2D	7	P6270009	-	General shot of area cleaned so far	E	27/6/08
2D	8	P6300010	2279	Post-ex shot	W	30/6/08
2D	9	P6300011	2279	Post-ex of slot 1	S	30/6/08
2D	10	P6300012	2279	Post-ex of slot 2	S	30/6/08
2D	11	P6300013	2279	Post-ex of slot 3	S	30/6/08
2D	12	P6300014	2279	Post-ex of slot 4	S	30/6/08
2D	13	P7010017	2304	Pre-ex shot of field drain	E	1/7/08
2D	14	P7010018	2307	Pre-ex shot of stone feature	E	1/7/08
2D	15	P7010019	2305	Pre-ex shot of stone feature	E	1/7/08
2D	16	P7010020	2310	Pre-ex shot of post-hole/pit	E	1/7/08
2D	17	P7010021	2308	Pre-ex shot of stone feature	S	1/7/08
2D	18	P7010022	2306	Pre-ex shot of post-hole/pit	E	1/7/08
2D	19	P7010023	2303	Pre-ex shot of field drain	W	1/7/08
2D	20	P7010024	2309	Pre-ex of possible post-hole	N	1/7/08
2D	21	P7010025	2311	Pre-ex shot	S	1/7/08
2D	22	P7010026	2301	Pre-ex shot of linear feature	S	1/7/08

<i>Area</i>	<i>Frame</i>	<i>D i g i t a l number</i>	<i>Context No.</i>	<i>Subject</i>	<i>Taken from</i>	<i>Date</i>
2D	23	P7010027	2299	Pre-ex shot	S	1/7/08
2D	24	P7010028	2300	Pre-ex shot	E	1/7/08
2D	25	P7010029	2302	Pre-ex of feature	N	1/7/08
2D	26	P7010030	2297	Pre-ex of possible post-hole	E	1/7/08
2D	27	P7010031	2290	Pre-ex shot of stone feature	E	1/7/08
2D	28	P7010032	2298	Pre-ex of linear feature	E	1/7/08
2D	29	P7010033	2296	Pre-ex shot of modern field drain	S	1/7/08
2D	30	P7010034	2278	Pre-ex of linear feature	E	1/7/08
2D	31	P7010035	2280	Pre-ex shot	S	1/7/08
2D	32	P7010036	2289	Pre-ex shot of linear feature cutting 2279	S	1/7/08
2D	33	P7010037	2294	Pre-ex shot	E	1/7/08
2D	34	P7010038	2292	Pre-ex shot of possible post-hole	S	1/7/08
2D	35	P7010039	2291	Pre-ex shot of possible post-hole	S	1/7/08
2D	36	P7010040	2293	Pre-ex shot of stone linear feature	S	1/7/08
2D	37	P7010041	2312	Pre-ex shot of field drain	S	1/7/08
2D	38	P7010042	2315	Pre-ex shot of field drain	N	1/7/08
2D	39		-	General shot of site	W	1/7/08

Film Number 29

<i>Area</i>	<i>Frame</i>	<i>D i g i t a l number</i>	<i>Context No.</i>	<i>Subject</i>	<i>T a k e n from</i>	<i>Date</i>
2D	1		-	ID shot	-	1/7/08
2D	2	P7010044	2314	Pre-ex shot	S	1/7/08
2D	3	P7010045	2317	Pre-ex of linear feature	SE	1/7/08
2D	4	P7010046	2318	Pre-ex of linear feature	NE	1/7/08
2D	5	P7010047	2316	Pre-ex of linear feature	SE	1/7/08
2D	6	P7010048	2313	Pre-ex of modern field drain	S	1/7/08
2D	7	P7010049	2319	Pre-ex of modern field drain	S	1/7/08
2D	8	P7010050	2320	Pre-ex of field drain	S	1/7/08
2D	9	P7010051	2295	Pre-ex of possible stone feature	E	1/7/08
2D	10	P7020061	-	Site 2D after first clean	W	2/7/08
2D	11	P7020062	-	South view after first clean	S	2/7/08
2D	12	P7020063	-	South view after first clean	S	2/7/08
2D	13	P7020064	-	South view after first clean	S	2/7/08
2D	14	P7020065	-	South view after first clean	S	2/7/08
2D	15	P7020066	-	South view after first clean	S	2/7/08
2D	16		-	Site 2D after first clean (no colour)	E	2/7/08
2D	17	P7020067	2300, 2325	Post-ex shot - East facing section	W	2/7/08
2D	18	P7020068	2300, 2325	Post-ex shot	W	2/7/08
2D	19	P7020069	2326	Pre-ex shot	S	2/7/08
2D	20	P7020070	2310	Post-ex shot	W	2/7/08
2D	21	P7020071	2280, 2326	South-East facing section	SE	2/7/08
2D	22	P7020072	2280, 2323	North-West facing section	NW	2/7/08
2D	23	P7020073	2289	Linear feature cutting 2288	S	2/7/08
2D	24	P7020074	2289	Post-ex shot of linear feature cutting 2288	S	2/7/08
2D	25	P7020075	2327	North facing section	N	2/7/08
2D	26	P7020076	2327	Post-ex shot	E	2/7/08

<i>Area</i>	<i>Frame</i>	<i>Digital number</i>	<i>Context No.</i>	<i>Subject</i>	<i>Taken from</i>	<i>Date</i>
2D	27	P7030077	2315, 2312	Post-ex shot of modern field drain	S	3/7/08
2D	28	P7030078	2278, 2332	Post-ex shot	N	3/7/08
2D	29	P7030079	2278	East facing section	W	3/7/08
2D	30	P7030080	2278	West facing section	W	3/7/08
2D	31	P7030081	2329	Pre-ex shot	S	3/7/08
2D	32	P7030082	2330	Pre-ex shot	S	3/7/08
2D	33	P7030083	2331	Pre-ex shot	N	3/7/08
2D	34	P7030084	2329	North facing section	N	3/7/08
2D	35	P7030085	2329	Post-ex shot	E	3/7/08
2D	36	P7030086	2321	Post-ex shot of slot 1	S	3/7/08
2D	37	P7030087	2321	South facing section	S	3/7/08

Film Number 30

<i>Area</i>	<i>Frame</i>	<i>Digital Number</i>	<i>Context No.</i>	<i>Subject</i>	<i>Taken from</i>	<i>Date</i>
2D	1		-	Id shot	-	3/7/08
2D	2	P7030088	2321	Post-ex plan of (2321) Slot 2	S	3/7/08
2D	3	P7030089	2321	S facing section	S	3/7/08
2D	4	P7030090	2330	N facing section of (2321)	N	3/7/08
2D	5	P7030091	2330	Post-ex plan view of (2330)	N	3/7/08
2D	6	P7030092	2330	Post-ex plan view of (2330)	E	2/7/08
2D	7	P7030093	2380	Mid-ex plan	NW	3/7/08
2D	8	P7030094	2280	Mid-ex plan	SE	3/7/08
2D	9	P7030095	2320	Pre-ex plan	NE	3/7/08
2D	10	P7030096	2320	Pre-ex plan	SW	3/7/08
2D	11	P7030097	2321, 2279	Mid-ex plan	E	3/7/08
2D	12	P7030098	2321, 2279	Mid-ex plan	W	3/7/08
2D	13	P7030099	2278	Post-ex plan of (2278) slot 2	S	3/7/08
2D	14	P7030100	2278	E facing section of (2278) slot 2	W	3/7/08
2D	15	P7030101	2278	W facing section of (2278) slot 2	E	3/7/08
2D	16	P7030102	2301, 2333	S facing section (2301)	S	3/7/08
2D	17	P7030103	2301, 2333	N facing section of (2301)	N	3/7/08
2D	18	P7030104	2301	Post ex plan of (2301)	W	3/7/08
2D	19	P7030105	2291	Post-ex plan of (2291)	NW	3/7/08
2D	20	P7030106	2292	Post-ex plan (2291)	NE	3/7/08
2D	21	P7030107	2334	Pre-ex shot of possible posthole at NW end of (2280)	NW	3/7/08
2D	22	P7030108	2335	S facing section (2311)	S	3/7/08
2D	23	P7030109	2335	S facing section (2511) plan view	E	3/7/08
2D	24	P7030110	2331	S facing section (2331)	S	3/7/08
2D	25	P7030111	2331	Post-ex plan view of (2331)	W	3/7/08
2B	26	P7040112	Well	Post-drainage shot of well	N	4/7/08
2D	27	P7040114	2241 2309	W facing section of (2309)	W	4/7/08
2D	28	P7040115	2309	Post-ex plan view of (2309)	S	4/7/08
2D	29	P7040116	2311	Plan view of (2311) [2335]	S	4/7/08
2D	30	P7040116	2339	Pre-ex plan of (2339)	S	4/7/08
2D	31	P7040117	2342	N facing section of (2294)	N	4/7/08
2D	32	P7040118	2342	Plan view of section of (2294)	N	4/7/08

<i>Area</i>	<i>Frame</i>	<i>Digital Number</i>	<i>Context No.</i>	<i>Subject</i>	<i>Take n from</i>	<i>Date</i>
2D	33	P7040119	2339	Half section, post ex plan of (2339)	W	4/7/08
2D	34	P7040120	2339	W facing section of (2339)	W	4/7/08
2D	35	P7040121	2278	Post-ex plan of (2278) slot 3	N	4/7/08

Film Number 31

<i>Area</i>	<i>Frame</i>	<i>Digital Number</i>	<i>Context No.</i>	<i>Subject</i>	<i>Take n from</i>	<i>Date</i>
2D	1			Film ID shot	-	4/7/08
2D	2		2278	E facing section of (2278) slot 3	W	4/7/08
2D	3		2278	W facing section of (2278) slot 3	E	4/7/08
2D	4		2297	S facing section of 2297	S	4/7/08
2D	5		2997	Plan view of 2297	S	4/7/08
2D	6		2999	Post-ex view of 2999	N	4/7/08
2D	7		2343	W facing section of (2306)	W	4/7/08
2D	8		2306	Post-ex plan view of (2306)	S	4/7/08
2D	9		2334	Post-ex plan of (2334)	S	7/7/08
2D	10		2334	Post-ex plan of (2334)	N	7/7/08
2D	11		2393	E facing section	E	7/7/08
2D	12		2346/2347	Post-ex in plan	E	7/7/08
2D	13		2346,2347	NE facing section	NE	7/7/08
2D	14		2348	Pre-ex of linear feature	E	7/7/08
2D	15		2334, 2280	Post-ex shots of two features	N	8/7/08
2D	16		2321, 2289	Post-ex showing end of field drain 2289 and continuation of field drain 2321	SW	8/7/08
2D	17		2278, 2348, 2351	Post ex of slot 4	N	8/7/08
2D	18		2278, 2348, 2351	Post ex of slot 4	S	8/7/08
2D	19		2278, 2348, 2351	W facing section from N to S slot 4	W	8/7/08
2D	20		2278, 2348, 2351	W facing section from N to S slot 4	W	8/7/08
2D	21		2278, 2348, 2351	W facing section from N to S slot 4	W	8/7/08
2D	22		2278, 2348, 2351	W facing section from N to S slot 4	W	8/7/08
2D	23		2278, 2348, 2351	W facing section from N to S slot 4	W	8/7/08
2D	24		2278, 2348, 2351	W facing section from N to S slot 4	W	8/7/08
2D	25		2278, 2348, 2351	W facing section from N to S slot 4	W	8/7/08
2D	26		2321, 2351	2321 cutting linear feature 2351	SW	8/7/08
2D	27		2278, 2348, 2351	Gen shot of slot 1 across track	N	9/7/08
2D	28		2278, 2348, 2351	Gen shot of slot 1 across track	S	9/7/08
2D	29		2278, 2348, 2351	West facing section running N to S across the slot	W	9/7/08

<i>Area</i>	<i>Frame</i>	<i>D i g i t a l Number</i>	<i>Context No.</i>	<i>Subject</i>	<i>T a k e n from</i>	<i>Date</i>
2D	30		2278, 2351	2348, West facing section running N to S across the slot	W	9/7/08
2D	31		2278, 2351	2348, West facing section running N to S across the slot	W	9/7/08
2D	32		2278, 2351	2348, West facing section running N to S across the slot	W	9/7/08
2D	33		2278, 2351	2348, West facing section running N to S across the slot	W	9/7/08

Film Number 32

<i>Area</i>	<i>Frame</i>	<i>D i g i t a l Number</i>	<i>Context No.</i>	<i>Subject</i>	<i>T a k e n from</i>	<i>Date</i>
2D	1	P7090009	-	ID shot	-	9/7/08
2D	2	P7090010	2348	General shot of slot 2	S	9/7/08
2D	3	P7090011	2348	General shot of slot 2	N	9/7/08
2D	4	P7090012	2348	West facing section of slot 2	N	9/7/08
2D	5	P7090013	2315, 2321	Post-ex shot showing ceramic drain (2315) cutting stone drain (2321)	SW	9/7/08
2D	6	P7090014	2348	General shot of slot 3	N	9/7/08
2D	7	P7090015	2348	General shot of slot 3	S	9/7/08
2D	8	P7090016	2348, 2351	East facing section of slot 3	E	9/7/08
2D	9	P7090017	2348, 2351	East facing section of slot 3	E	9/7/08
2D	10	P7100018	2348, 2351	East facing section of slot 3	E	9/7/08
2D	11	P7100019	2321	Post-ex shot of slot 1	NE	10/7/08
2D	12	P7100020	2348, 2350	General shot of slot 5	S	10/7/08
2D	13	P7100021	2348, 2350	General shot of slot 5	N	10/7/08
2D	14	P7100022	2348, 2350	West facing section of slot 5	W	10/7/08
2D	15	P7100023	2348, 2350	West facing section of slot 5	W	10/7/08
2D	16	P7100024	2348, 2350	West facing section of slot 5	W	10/7/08
2D	17		2348, 2350	West facing section of slot 5	W	10/7/08
2D	18	P7110025	2278	Terminal end of features, 'track'	W	11/7/08
2D	19	P7110026	2348	Terminal end of features, 'track'	W	11/7/08
2D	20	P7110027	2351	Terminal end of features, 'track'	W	11/7/08
2D	21	P7110028	2278	Post-ex shot of slot 6 showing drain fragmenting feature	E	11/7/08
2D	22	P7110029	2348	Post-ex shot of linear feature – Slot 6	E	11/7/08
2D	23	P7110030	2348	East facing section of slot 7	E	11/7/08
2D	24	P7110031	2348	East facing section of slot 7 – Plan view	E	11/7/08
2D	25	P7110032	2348, 2278	2351, Post-ex shot of extension of slot 4	N	11/7/08
2D	26	P7110033	2348, 2278	2351, Post-ex shot of extension of slot 4	S	11/7/08
2D	27	P7140034	2348, 2278	2351, Post-ex shot of slot 8	NE	14/7/08
2D	28	P7140035	2348	Post-ex shot	W	14/7/08
2D	29	P7140036	-	Post-ex shot of trench	W	14/7/08
2D	30	P7140037	-	Post-ex shot of trench	E	14/7/08
2B	31	P7140038	-	Shot of site 2B completed	NE	14/7/08

<i>Area</i>	<i>Frame</i>	<i>Digital</i> <i>Number</i>	<i>Context No.</i>	<i>Subject</i>	<i>Taken</i> <i>from</i>	<i>Date</i>
2C	32	P7140039	-	Shot of site 2C completed (no black & white)	S	14/7/08

12.6 DES

LOCAL AUTHORITY:	City of Edinburgh Council
PROJECT TITLE/SITE NAME:	Edinburgh Tram Scheme: Gogar Church
PROJECT CODE:	2600.2
PARISH:	Gogar
NAME OF CONTRIBUTOR(south):	Heather F James
NAME OF ORGANISATION:	GUARD
TYPE(south) OF PROJECT:	Excavation and preservation <i>in situ</i>
NMRS NO(south):	-
SITE/MONUMENT TYPE(south):	Medieval settlement
SIGNIFICANT FINDS:	Cobbled courtyard, cobbled surfaces, corn drying kiln and a complex ditch system
NGR (2 letters, 6 figures)	NT 169 725
START DATE (this season)	April 21st 2008
END DATE (this season)	July 14th 2008
PREVIOUS WORK (incl. DES ref.)	Sneddon D & Will R 2006 <i>Edinburgh Tram Scheme Work Strands 3 and 4 Archaeological Evaluation. Data Structure Report</i> . Unpublished Report GUARD 2235. Jenni Morrison 2002 <i>Gogarburn Headquarters Project</i> . Unpublished Report, Headland Archaeology Ltd. Jenni Morrison 2003 <i>Excavation of Land to North of A8, Gogarburn Headquarters Project, Gogarburn, Edinburgh</i> . Unpublished Report Headland Archaeology Ltd.
MAIN (NARRATIVE) DESCRIPTION: (May include information from other fields)	<p>Medieval remains had been found in previous archaeological work for the Gogarburn Headquarters to the west of this area, and archaeological evaluation of the corridor of the Edinburgh Tram Scheme brought to light an area where further archaeological investigation was required (Sneddon & Will 2006). The excavations were carried out by GUARD on behalf of Transport Initiative Edinburgh (TIE) and The City of Edinburgh Council, in advance of construction. Four trenches were opened in the vicinity of Gogar Church.</p> <p>Site 2A consisted of a Medieval cobbled courtyard, which had been discovered during the evaluation phase. Significant other archaeological remains were discovered, including a corn drying kiln, a complex Medieval ditch system (which produced numerous Medieval pottery sherds and a copper alloy ring) and a possible Medieval well. These were cut by both stone-filled and ceramic field drains.</p> <p>Site 2B comprised a rough cobbled surface at a depth of 1.5 m; sherds of Medieval pottery along with clay pipe fragments were retrieved from the surface of the cobbles and from the layers above. A linear feature containing only Medieval pottery may be the remnants of a Medieval field or property boundary. The layers sealing the Medieval features consisted of re-deposited ploughsoil and building debris from the demolished nineteenth- and twentieth-century buildings. A well found just outside the construction corridor was marked on a plan of the early nineteenth century but had gone out of use by 1829. It was drained and backfilled with gravel during these works.</p> <p>Site 2C comprised rough cobbling of probable Medieval date at a depth of about 1.2 m below the surface. Several sherds of Medieval pottery and a late Medieval coin were also retrieved. The cobbling was sealed</p>

<p>MAIN (NARRATIVE) DESCRIPTION: (May include information from other fields)</p>	<p>by deep deposits of re-deposited ploughsoil and building debris. The corner of a nineteenth-century building was found, possibly the village school.</p> <p>Site 2D consisted of a possible Medieval trackway with drainage ditches or hedgerows to either side. Ruts cut into natural subsoil beneath were thought to be cart tracks. Remnants of a ring-ditch and an ephemeral curving ditch also indicate that there was further activity towards the northern edge of the site. The remaining features were predominantly either stone-filled field drains or ceramic field drains.</p>
<p>PROPOSED FUTURE WORK:</p>	<p>Post-excavation work on artefacts and soil samples.</p>
<p>SPONSOR OR FUNDING BODY:</p>	<p>Transport Initiative Edinburgh and The City of Edinburgh Council</p>
<p>ADDRESS OF MAIN CONTRIBUTOR:</p>	<p>Gregory Building, Lilybank Gardens, University of Glasgow, Glasgow, G12 8QQ</p>
<p>EMAIL ADDRESS:</p>	<p>h.james@archaeology.arts.gla.ac.uk</p>
<p>ARCHIVE LOCATION (intended/deposited)</p>	<p>Archive to be deposited in NMRS. Report lodged with CECAS SMR and NMRS.</p>

12.7 *Written Scheme of Investigation*

See following pages

GUARD 2600: Edinburgh Tram Network Archaeological Works Line 2 Written Scheme of Investigation

Introduction

Transport Initiatives Edinburgh have commissioned GUARD to undertake archaeological works associated with the Edinburgh Tram Project Line 2. The route has been classified as archaeologically sensitive and at risk by the development by the City of Edinburgh Council Planning Authority. The archaeological sites in the vicinity include a medieval and post-medieval settlement at Nether Gogar, Gogar church and a prehistoric fort. An archaeological excavation of the neighbouring site to the west has revealed medieval pits, linear features and pottery (Morrison 2003). Archaeological works so far within the line of the tramway have included an evaluation of the tramway route (Sneddon & Will 2007) and a metal detecting survey of part of a battlefield site (Headland internal report). The evaluation revealed the presence of archaeological features of prehistoric and medieval date in two areas and a 2WW brick-built pillbox. The area south of Gogar church could not be evaluated at that time and so forms part of the present scheme of works.

This Written Scheme of Investigation (WSI) covers this work which will consist of two areas of excavation (Sires 1 & 2), a watching brief and evaluation to the west of Gogar church and a standing building survey of the pillbox. The works may include post excavation analyses and publication. If archaeological remains are uncovered adjacent to Gogar Church these will be preserved *in situ* and will be protected during the construction phase.

Aims

The aims of the archaeological evaluation are:

- To determine the extent, character and date of the concentration of prehistoric features revealed within Evaluation Trenches 123, 124 & 125. (Site 1);
- To determine the extent, character and date of the medieval features revealed within Evaluation Trenches 6 and 7 (Site 2).
- To determine whether there are any remains of a medieval and post-Medieval settlement of Nether Gogar in the vicinity of Gogar church.
- To carry out a Historic Building Survey (Level 3) on the 2WW pill-box.

Methodology

All significant archaeological features discovered in the evaluation trenches will be 100% excavated by hand apart from linear features which will be 50% excavated. Sampling will involve routine recovery of up to 10 L bulk samples from all features. Where fills are particularly rich (artefactual or archae-botanical remains) the greater proportion of the fill will be recovered as bulk samples. A portion of fills which are not bulk sampled will be screened for artefactual recovery through coarse sieving on site. Monolith or kubiena samples will be taken through suitable features which potentially have complex depositional histories.

The recording of all archaeological features encountered during the evaluation will follow conventional methodologies, such as *pro forma* record sheets. Scaled hand drawn plans will be at 1:20 and sections at 1:10. Photography will include black and white prints and colour prints or slides and digital photographs.

The site will be surveyed into the national grid using a Total Station.

A full risk assessments and method statement has been produced and submitted to tie ltd

Human Remains

Should any human remains be encountered during the course of the evaluation, GUARD will follow standard procedures by leaving any such remains *in situ* and notifying the client, CECAS and police as soon as possible. Only if and after clearance has been received will work be permitted to continue on any human remains encountered.

Timetable

GUARD propose to complete this element of fieldwork within six weeks.

The Report

Once the fieldwork has been completed a report in the form of a standard data structures report (DSR) will be submitted to the client and, after their approval, to the City Council Archaeologist within 6 weeks. This report will contain the following sections:

- Executive summary
- Archaeological background;
- Aims and objectives
- Methodology
- Results;
- Discussion
- Recommendations: this will detail any additional archaeological work or mitigation that may be required on site. Any mitigation measures will be agreed before hand with the client and Planning Authority.
- Acknowledgements
- References

A separate post-excavation design and costing will be prepared which will bring the results and evidence from the evaluation and excavations to publication and to include the analysis of archaeological samples and artefacts retrieved. Copies of the report will be submitted to the National Monuments Record of Scotland and the Local Sites and Monuments Record.

Archive

The archive for the project will be submitted to the National Monuments Records for Scotland within six months of completion of the post-excavation work.

Finds Disposal

All artefacts recovered will be declared to the Treasure Trove Panel in accordance with Scots Law. All artefacts will be temporarily stored by GUARD until a decision has been made by the panel.

Publication

A summary of the project results will be submitted to *Discovery and Excavation in Scotland*, and accordingly the standard fee of £40 has been included in the costing.

Personnel & Liaison

The team will consist of experienced professional archaeologists currently working for GUARD. The director will be a GUARD fieldwork manager Ms Heather James and the overall project manager will be Mr Bob Will. The other members of the team will be experienced field archaeologists. Specialists including osteoarchaeologists, palaeobotanists, finds specialists etc will be on standby should their skills be required. CVs of all staff involved with the project are attached.

Monitoring

The GUARD project manager will liaise with the client and the Council in all points relevant to the proper conduct of the project and in particular will give immediate notification of any artefact or archaeological discovery of significance.

Health & Safety and Insurance

GUARD, operating through the University of Glasgow, adhere to the guidelines and standards prescribed for archaeological fieldwork set down in the Institute of Field Archaeologists approved Health and Safety in Field Archaeology document, prepared under the aegis of the Standing Conference of Archaeological Unit Managers. It is standard GUARD policy, prior to any fieldwork project commencing, to conduct a risk assessment and to prepare a project safety plan, the prescriptions of which will be strictly followed for the duration of all archaeological fieldwork. Copies of the resultant project safety plan and of GUARD's Fieldwork Safety Policy Statement may be viewed upon request.

GUARD, operating through the University of Glasgow, also possess all necessary insurance cover, proofs of which may be supplied upon request.

References

Morrison J 2003 *Excavation of land to North of A8, Gogarburn Headquarters Project, Gogarburn, Edinburgh*. Unpublished report, Headland Archaeology Ltd Report.

Sneddon D & Will R 2007 *Edinburgh Tram Scheme Work Stands 3 & 4 Archaeological Evaluation: Data Structure Report Project 2235*. Unpublished report, Glasgow University Archaeological Research Division.