

St. Mark's Episcopal Church

Portobello, City of Edinburgh

Archaeological Survey and Excavation

for

St. Mark's Episcopal Church

November 2014



Photograph Addyman Archaeology



Addyman Archaeology

Building Historians & Archaeologists

a division of Simpson & Brown Architects

St Ninian's Manse Quayside Street Edinburgh EH6 6EJ

Telephone 0131 555 4678 Facsimile 0131 553 4576

admin@addyman-archaeology.co.uk www.simpsonandbrown.co.uk

St. Mark's Episcopal Church,
Portobello, City of Edinburgh

Archaeological Survey and Excavation: October / November 2014

Data Structure Report

AA 2030

by Andrew Morrison

Contents

Executive Summary

- 1. Introduction**
 - i. General
 - ii. Setting
- 2. Brief Historical Summary**
- 3. Archaeological Building Recording**
- 4. Excavation of the East Boundary Wall Foundation Trench**
 - i. General
 - ii. Excavation
 - iii. Excavation trench extension April 2015
- 5. Summary**
- 6. Acknowledgements**

Bibliography

Appendices

- | | |
|-------------------|--------------------------------|
| Appendix A | Context Register |
| Appendix B | Photographic Register |
| Appendix C | Drawing Register |
| Appendix D | Photographic Thumbnails |
| Appendix E | Survey Scans |
| Appendix F | Provisional DES Entry |

Unless otherwise stated, all content is the copyright of Simpson & Brown *Architects* with Addyman Archaeology.

St. Mark's Episcopal Church

Portobello, City of Edinburgh

Archaeological Excavation

Executive Summary

Addyman Archaeology was commissioned to undertake the required archaeological mitigation associated with the repair and replacement of the boundary wall around the St. Mark's Church in Portobello (NGR NT 30775 73610). The Church and surrounding walls were built in the 1820s, and St Mark's Graveyard has continued in use from first recorded interment in December 1828 until the present day.

Although much of the wall can be repaired, some sections are considered too unsafe and need to be dismantled and rebuilt. In these areas, new wall foundations are required, and could potentially impact upon the burials located directly adjacent to the wall. Addyman Archaeology have produced a measured hand drawing of all boundary walls, complete with a detailed photographic record, have monitored the demolition of the wall, and have undertaken any excavations required for the installation of new foundations.

A small section of the Eastern Church boundary wall required dismantling, and the affected grave monuments were safely removed and stored for later remounting. A foundation trench was dug along this section, 7.67m in length and 0.75m in width, to a depth of 0.60m according to the specified wall foundation parameters. Six grave cuts within five grave plots were seen, while a number of brick grave plot kerbs were also noted during excavation. No human remains or charnel material was encountered during this exercise.

A record of the evaluation has been deposited with the Online Access to the Index of Archaeological Investigations (OASIS) website hosted by the Archaeological Data Service (OASIS ID addyman1-196629) and with Discovery and Excavation in Scotland (DES), the annual publication of fieldwork by Archaeology Scotland.

1. Introduction

i. General

Addyman Archaeology was contacted by St. Mark's Episcopal Church in Portobello to mitigate the archaeological impact associated with the repair and replacement of the church's Category B listed boundary walls. The boundary walls were in a poor state of repair and in danger of collapse, making the repair and replacement of sections of the walls necessary. This programme of works required a stretch of the eastern boundary wall, measuring less than 8.0m in length to be demolished and new foundations installed.

The present archaeological Data Structure Report has been produced as a result of commissioning this archaeological examination. The archaeological mitigation involved: the recording of the church's boundary walls prior to the work commencing, the completion of a detailed photographic record, the monitoring of the wall's dismantling, and the undertaking of any excavations required for the installation of new foundations.

The initial boundary wall recording was undertaken by Ross Cameron on the 21st of January, and the 13th of March of 2013. The monitoring of the eastern boundary wall's dismantling and the excavation of its foundations was undertaken by Andrew Morrison on the 1st of September 2014, from the 6th to 8th of October, and on the 26th of November 2014. The trench was then extended on the 8th of April of 2015 in order to accommodate the installation of a wall pier required for additional structural support. Weather conditions for the initial 2013 visits were clear and cold, with a scattering of snow on the ground. Weather for the September to November 2014 visits saw a mixture of sun and wind, turning colder with some rain, and the site works in April of 2015 were undertaken in bright, sunny, and warm conditions.

This report contains historic maps, reproduced by permission of the Trustees of the National Library of Scotland (NLS). To view these maps online, see www.nls.uk.

ii. Setting

St. Mark's Episcopal Church is located at 287 High Street, within the centre of Portobello (NT 30851 73632), to the east of Edinburgh. The churchyard is bordered by Portobello High Street to the north, and to the east and south by St. Mark's Place and St. Mark's Lane. A residential property borders the graveyard's west side.

The underlying bedrock geology is formed by the Gullane Formation - Sedimentary Rock Cycles, Strathclyde Group Type. This is a sedimentary Bedrock formed approximately 335 to 352 million years ago in the Carboniferous Period in a local environment previously dominated by swamps, estuaries and deltas. The overlying superficial geology comprises Raised Marine Deposits, Devensian - Sand and Gravel; this formed up to 2 million years ago in the Quaternary Period and is characteristic of a local environment previously dominated by shallow seas.¹

¹ www.bgs.ac.uk/opengeoscience - 01/07/14

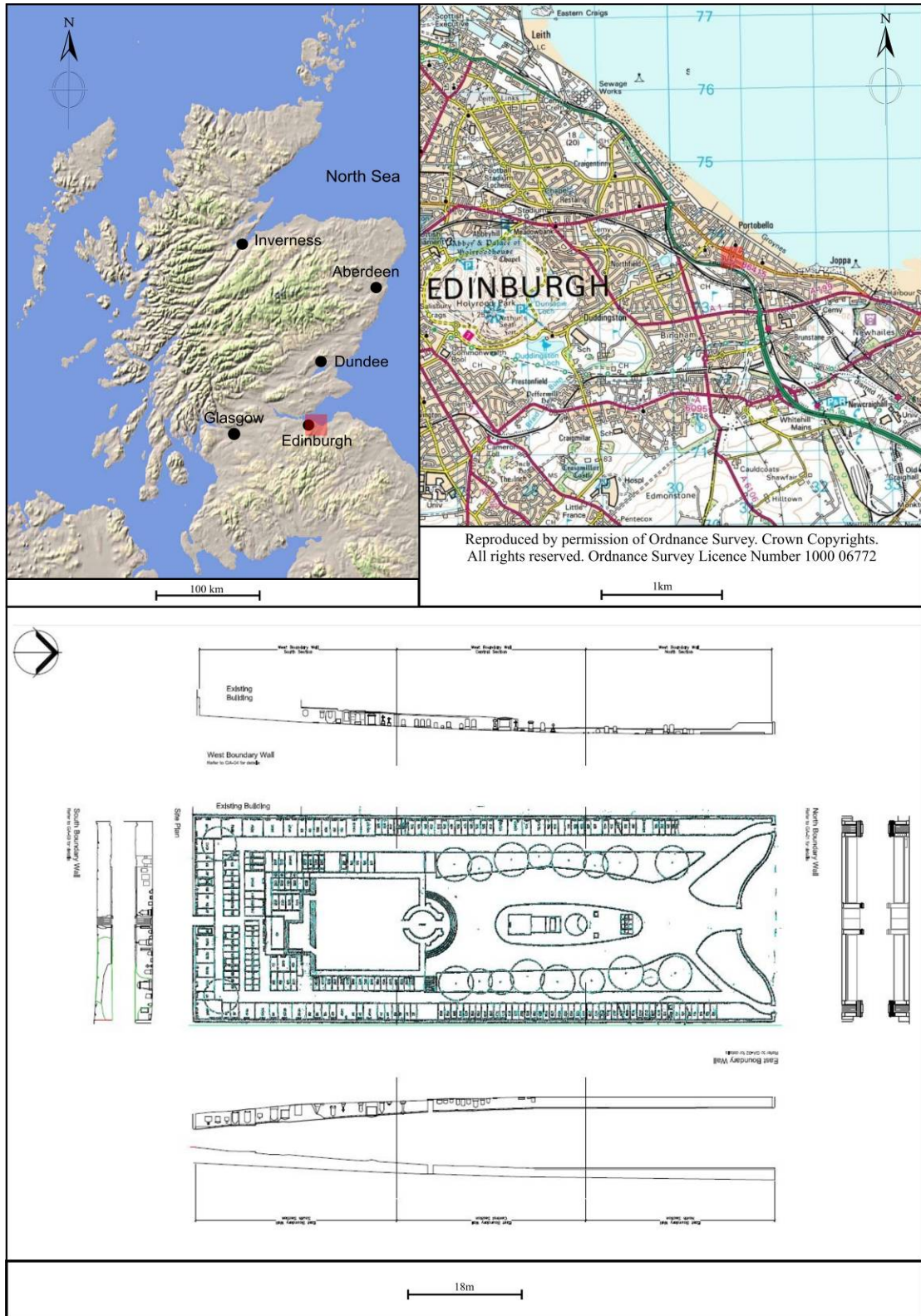

Figure 1 Location Plan

2. *Brief Historical Summary*

Prior to the 1820s it is likely that the area of St. Mark's Church was essentially a green field site. The name 'Portobello' was not coined until post-1742, with the original concentration of the town located some way to the west of the future site of St. Mark's Church. The town developed from the 19th century as first an industrial town, and subsequently a seaside resort. Portobello was made a burgh in 1833.

In 1825 Colonel and Mrs Robert Haliburton feued land in Portobello from the Marquis of Abercorn, and along with Mr and Mrs James Rutherford, privately paid for the construction of St. Mark's. Originally designated as a chapel, St. Mark's was completed by the builder Robert Gray, opening in 1826 and becoming consecrated in 1828.

The vestry was granted the right to open the burial ground in November 1828 and this has continued in use to the present day. The 19th century graves demonstrate the nature of the congregation in this period, with the majority of individuals drawn from the upper levels of Portobello society, characterised by a large number of military figures and men who had held rank in the colonies.

Many of these burials were placed around the perimeter of the site, against the boundary wall. The majority of the burials located in the areas where the boundary wall is to be redeveloped can be dated to the 19th century.



Figure 2 Extract from 'Military Survey of Scotland' by William Roy 1752-55 with approximate site area encircled in red. © The British Library Board. All Rights Reserved (Roy Military Survey of Scotland)

William Roy's 'Military Survey of Scotland' conducted between 1752 and 1755 (Figure 2) revolutionised map making in Scotland, providing a superior level of terrain detail than had been previously seen on earlier maps of the area. Roy's map was the result of 'rapid reconnaissance rather than a measured topographic survey'²; the various inaccuracies the map contains can be forgiven, as it provides us with the first cartographic view of Scotland with any real level of detail, giving us a snapshot of mid-18th century Scotland.

² Fleet C., Wilkes M. & Withers, C. 2011 *Scotland – Mapping the Nation*, 88

The section of Roy's lowland map that covers Portobello contains a high level of information and detail not previously seen on other maps. This section of the map highlights the area east of the Figgate Burn and south of the road from Edinburgh to Berwick, with the approximate location of the Churchyard encircled in red; surveyed from 1752 to 1755, it depicts Portobello prior to the ceramics industry boom that brought with it rapid growth to the area.

Roy's map shows that Portobello during the mid 18th century was mainly cultivated Feu lands with pockets of industry and small villages at Joppa and Duddingston. The site now occupied by St. Mark's church was most likely a cultivated field at this time.

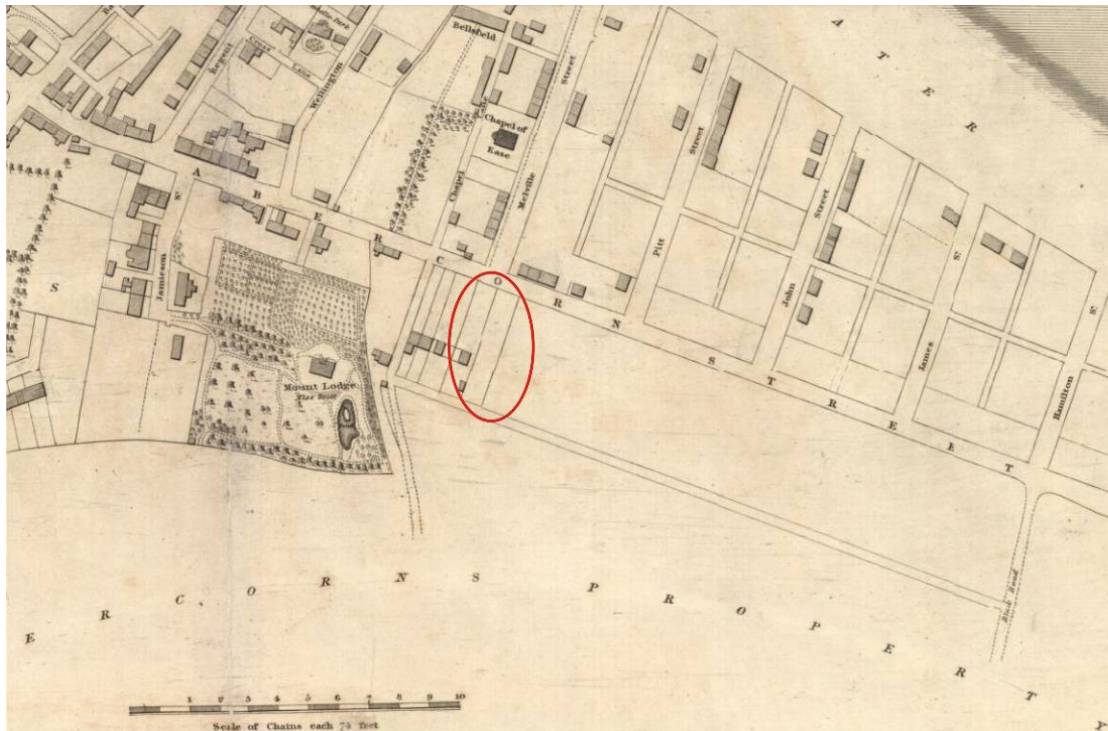

Figure 3 Extract from 'Plan of the Town of Portobello from Actual Survey' by John Wood 1824 with approximate site area encircled in red. (NLS)

John Wood's 'Plan of the Town of Portobello' of 1824 (Figure 3), shows the growth and development of Portobello from the cultivated feu lands depicted on Roy's map nearly seventy years earlier. Abercorn Street is shown (now the Portobello High Street), with Melville Street stretching to the north. The empty plot of land circled is likely that on which St. Mark's Church was to be built a few short years later.

The Ordnance Survey Town Plan of Portobello, surveyed in 1893 (Figure 4), shows the churchyard of St. Mark's Episcopal largely as it appears today. A number of small differences of note: the lane to the east of the churchyard is still open to traffic, burials within the churchyard appear to be largely confined to the area beside and behind the church, and noticeable grave plot outlines can be seen on the ground along the western, southern, and eastern boundary walls.



Figure 4 Extract from the Ordnance Survey 1st edition map of Portobello 1893, sheet IV.6.II. (NLS)

3. *Archaeological Building Recording*

With the boundary walls of St. Mark's being in a poor state of repair and in danger of collapse, a programme of archaeological building recording was required prior to the restoration works commencing on site. At St. Mark's Church, the church building, boundary walls, gates, and gate piers are all Category B listed (ref: 27245), meaning that they are all deemed to be of regional importance.

The recording of the Church's boundary walls was undertaken by Ross Cameron on the 21st of January, and the 13th of March of 2013. A full photographic survey of the interior and exterior elevations of all boundary walls was completed, as was a measured hand drawing of the interior elevation of the eastern boundary wall. Weather during these visits was clear and cold, with a thin layer of snow on the ground. Visibility was generally good, though there were sections of the wall obscured by a thick covering of ivy. The survey of these affected areas was completed by Andrew Morrison in September of 2014 after the vegetation had been removed. The ivy removal had to be done in conjunction with the wall dismantling owing to the fact that the ivy had become a structural element of the wall in places.

The boundary walls are built of a mortared stone rubble, with areas of ashlar coping (some reused); a section of wall at the southern extent of the eastern boundary is also faced with dressed ashlar. A full photographic survey was undertaken of all four boundary walls, with a hand-drawn survey of the interior elevation of the eastern wall done at a scale of 1:50. It is along this eastern boundary wall that the majority of the repairs are required, with a section of approximately 8.0m in length to be dismantled, and a new foundation laid prior to re-erection.



Plate 1 Northwest section of northern boundary wall showing gate and gatepiers (photo 331)



Plate 2 Northern end of western boundary wall from northwest gate (photo 336)



Plate 3 Western end of southern boundary wall with entrance (photo 128)



Plate 4 Southern end of eastern boundary wall section to be dismantled (photo 141)

The field record has been scanned and partly digitised into a set of interpretive drawings and is presented as part of this report in *Appendix D*.

4. *Excavation of the East Boundary Wall Foundation Trench*

i. *General*

Once the recording of the church boundary walls had been completed, the wall repairs and dismantling could begin. A small scale localised excavation was required along the collapsing section of the eastern boundary wall (north of the ashlar facing), for the construction of new wall foundations (*Plate 5*). The location and height of each grave monument along the wall was recorded prior to the dismantling taking place to enable their re-erection in the correct location once the new stretch of wall has been completed.



Plate 5 Collapsing wall section to be dismantled (photo 001)

The wall was hand-demolished stone by stone by the contractor to ground level, with each grave monument carefully dismantled and removed. The gravestones were secured, carefully lifted, and stored on timber pallets away from the ongoing works. The grave markers were all successfully removed undamaged, and are stored and remain in excellent condition.

ii. *Excavation*

The excavation the eastern boundary wall's foundation trench was undertaken by Andrew Morrison from the 6th to 8th of October, and on the 26th of November 2014. Weather conditions for works saw a mix of sun and wind, turning colder later with scattered light rain.

The removal of the foundation stones (*context 001*) was completed by Addyman Archaeology, removing each stone carefully by hand, and setting aside for possible later reuse. The foundation stones were much shallower in depth than had been expected, reaching only 100mm below ground level in some areas. In some instances, the bottom course of foundation stone was visible at pavement level. Two deeper foundation pads reaching a depth of 400mm were spaced at a regular interval, providing the wall with some stability.

The shallow depth of the foundations, the weight of the grave monuments, and the thin, un-tapered wall no doubt were the causes of its advanced state of collapse.

Once the foundations stones had been removed, the trench was then cleaned of loose soil prior to its excavation to a required depth. Specifications for the new wall foundation called for a trench measuring 0.60m in depth by 0.75m in width (*Figure 5*), with an overall length of 7.67m. The excavation was completed in shallow spits, so that any archaeological features or burials could be properly recorded.

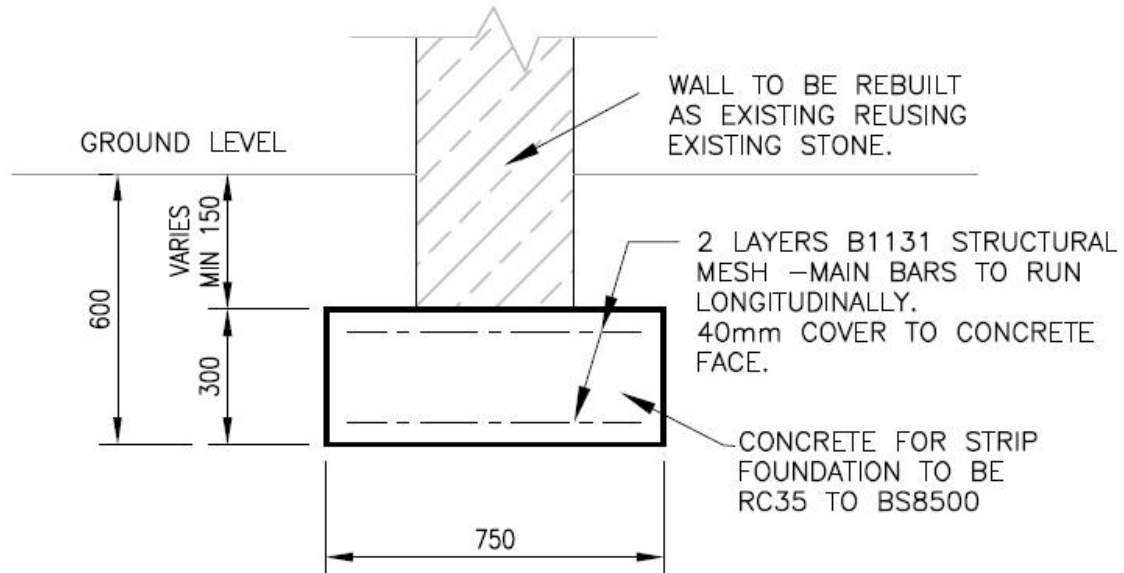

**SECTION THROUGH NEW
FOUNDATION**
1:20

Figure 5 Section through the proposed new wall foundation. Note measurements are in mm. Courtesy of Wren & Bell

The width of the required trench meant that the excavations were likely to encounter grave cuts associated with the adjacent burials, though the depth of the trench meant that the disturbance of those graves remained unlikely.

Overall, excavation proved to be relatively straight-forward, with the wall foundations set directly atop the soft, Portobello sandy natural soil, and the grave cuts and grave plot dividers appearing as expected. The contrast between the natural light sandy subsoil and the dark, humic, clay-rich grave fill allowed for the clear identification of grave cuts. Apart from the grave cuts and their associated features, no archaeological finds or features were uncovered.

As mentioned, the first stage involved the removal of the wall foundation stones [001]. The wall foundations were abutted to the east by the modern asphalt pavement (002) and the pavement's underlying small angular stone bedding layer (003). Both the wall foundations and the asphalt bedding were overlying the light brown- mid orange mottled sandy natural subsoil (004). The wall foundations were abutted to the west by the dark brown, humic cemetery topsoil (005), which had an average depth of 0.30m, but was also recorded depths as shallow as 0.16m. Also occasionally abutting the wall foundations to the west were the mortared brick kerbs dividing the grave plots. Each grave post-dates the construction of the boundary wall, with the kerbs and grave cuts both abutting, underlying, and built into the wall in places.

Grave 34.1

Grave 34.1 is the number allocated during the earlier churchyard survey, and given to the burial plot at the northern extent of the affected area (the affected area covers graves #34-37). This grave was initially listed as grave 34, however the removal of the ivy revealed an additional monument to its south, prompting the renumbering of the grave as 34.1 and the newly uncovered monument as 34.2.



'In Memorium
-
Captain William Briggs
Second son of
W. Briggs J.P.
Of Hylton Castle Durham
Died at Portobello
11 January 1869
Aged 30'

Plate 6 Grave monument #34.1 (photo 003)

Grave 34.1 is associated with the Briggs burial plot, and is located at the northern extent of the foundation trench (roughly 0.40m in width of which has been revealed). A mortared brick kerb [022], within cut [020] and abutted by fill (021), can be seen in the south facing section, and likely delineates the southern boundary of the Briggs burial plot (Plate 7). Topsoil in this area was recorded to a depth of 0.20m. The grave cut [020] and the light to mid orange sandy clay grave fill (021) are cut to the south by the later grave cut [017] associated with grave #34.2. There was heavy root disturbance throughout the grave fill, though no human charnel material was noted to be present. It is likely that the inhumation within grave #34.1 is located at a much lower depth than the 0.60m trench depth required.



Plate 7 Grave #34.1 post-ex, east facing section (photo 080)

Grave 34.2

Grave 34.2 is located immediately to the south of grave 34.1, and was obscured by ivy in the initial cemetery survey. The removal of the ivy revealed a fairly large grave monument dedicated to the Lang family (*Plate 8*).



Plate 8 Grave monument #34.2 (photo 008)

*'Sacred
To the memory of
Thomas Bamford Lang Esq.
Who died 6th April 1868 aged 48 years
Deeply lamented by his sorrowing family
And universally respected and esteemed
And
Frances Nevillia
His fourth daughter
Who died 28th January 1860 aged 8
years
And
Mary Elizth Anne Lang or Robertson
His wife
Who died 31st January 1891 aged 71
years
Not Lost but Gone Before'*

Excavations showed that the grave cut for #34.2 [017] cut the grave cut [020] and fill (021) of grave #34.1, indicating that the latest interment within #34.2 post-dates grave #34.1. The grave cut [017] abuts the mortared brick kerb [014] to the south, and is filled by the dark brown clay-rich primary grave fill (018), which underlies the large, mortared stone deposit (019). Overall, the grave plot measures roughly 1.5m in width. It is unclear if the stone filling the grave cut are limited to the eastern extent of the burial plot, or if they fill the full length and depth of the grave. This was the only grave plot excavated which showed a stone fill of this nature (*Plate 9*).



Plate 9 Grave #34.2 post-ex, east facing section (photo 101)

Graves 35.1 and 35.2

Graves 35.1 (northern) and 35.2 (southern) were listed together as grave #35 during the initial churchyard survey, and are both associated with the Fraser monument. Upon excavation, two distinct grave cuts were revealed within the single grave plot, prompting a renumbering to 35.1 and 35.2.



Plate 10 Grave monument #35 (photo 021)

*'In Memory of
Caroline Purves Home
The beloved wife
Of
Lieutenant Colonel Robert Warden Fraser
Of the Bengal Army
Who died 12th February 1868
Aged 37 years
And of their children
Francis Home
Hugh Maclean
And
Edith Caroline
Who all died in infancy
Also
John Home Biddulph Fraser
Born Dec 20 1867 Died Aug 8 1875
Robert Warden Fraser
Lieut. Col. Bengal Army
Died June 30 1876 aged 70
JOHN XIV'*

As mentioned above, excavations within grave #35 showed two distinct burial cuts within the same burial plot: #35.1 to the north, and 35.2 to the south. The northern burial is identified by grave cut [014], which has near vertical sides and cuts into natural; it contains the mid brown clay-rich sandy grave fill (015) and mortared brick kerb (016). The southern burial is identified by grave cut [012], which also has near vertical sides and cuts into natural; it contains the grave fill (013) similar to (015) only slightly lighter. Both grave cuts individually measure 0.75m in width, and both grave fills contain frequent small stone inclusions. Cut [012] contains the mortared brick kerb [011] to the south. The associated grave monument lists the inhumations of a mother and father with their four children, though it is unclear how those six burials may be divided between the two plots.



Plate 11 Graves #35.2 and 35.1 post-ex, east facing section and trench base (photo 108)

Grave 36



Plate 12 Grave monument #36 (photo 024)

*'Sacred
To the memory of
Captain John Timins Baldwin
Madras Artillery, who died at Sholopore
11th April 1846 aged 41
And of his sons
Frederick Colin, his 3rd son
Who died in Australia Dec 1856
Aged 23
Patrick McNeill, his 5th son
Who died at Portobello 10th March 1866
Aged 22
Robert Henry, his 4th son
Who died at Portobello 30th march 1866
Aged 31
Colonel Archibald Thomas Baldwin
Commandant 7th Regt. M.N.I. his 2nd son
Who died at Edinburgh 5th Dec 1884
Aged 53
Also of his wife and their mother
Barbara Moore Baldwin, 3rd daughter of
Archibald Campbell, Esq of Melfort, Argyleshire
Who died at Edinburgh 24th June 1891 aged 86
Thy Will Be Done
Also of Margaret Johnston
Wife of Colonel A.T. Baldwin
Buried at B. on Tweed 1898*

Grave 36 is located immediately south of grave 35.2, and is associated with the memorial of seven members of the Baldwin family. The plot is not thought to contain all seven family members, but is likely to contain a minimum of four. The burial is identified by grave cut [009] which is abutted by brick kerbs [011] to the north, and [008] to the south, and is filled by grave fill (010)- a dark to medium brown clayrich soil with redeposits of topsoil and sandy natural, and frequent angular stone and rare brick fragment inclusions. Topsoil in this area reaches a depth of 0.30m. Overall, the width of the grave plot measures roughly 0.75m. Heavy root disturbance was noted within this grave plot, and as was the case in all other excavated grave sections, no human charnel material was encountered.



Plate 13 Graves #36 post-ex (left of kerb), east facing section and trench base (photo 109)

Grave 37

A section of Grave #37 was partially excavated during the October works. The entire 2.0m in length east facing section was later fully revealed when the trench was extended on the 26th of November 2014. It was decided that in order to compensate for and mitigate the lean of the upstanding wall south of the foundation trench, a pier would be built- providing the extra strength and support required. In order to accommodate the pier, the trench was extended by 0.65m southwards, abutting the dressed ashlar facing stones.



Plate 14 Grave monument #37 (photo 028)

*'Sacred
To the memory of
Charles Robert Farquharson
The infant son of
Major Thomas D. Ker,
Bombay Army
Born 2nd March 1863
Died 16th July 1863
"of Such is the Kingdom of Heaven"*

Burial place of Maj. TD Ker'

The burial is identified by grave cut [006] which contains brick kerbs [008] to the north, and [023] to the south, and is filled by grave fill (007): a medium brown clayrich sandy soil. Topsoil in this area reaches a depth of 0.30m. The grave cut seems largely confined to the southern edge of the grave plot (Plate 15), possibly related to the grave's association with an infant burial. It may be that the child was interred at the edge of the plot rather than the centre.



Plate 15 Graves #37 post-ex (S corner), east facing section and trench base (photo 127)

ii. *Excavation trench extension April 2015*

A small extension at the south extent of the wall foundation trench was excavated on the 8th of April 2015, under clear, sunny, and warm conditions. The trench extension was required in order to accommodate the construction of the wall support pier, necessitating the excavation of an area westwards into the cemetery; this extension measured 0.15m east-west, 1.0m north-south, to an overall depth of 0.60m as per the engineering specifications.



Plate 16 Trench extension pre-ex looking southwest (photo 359)



Plate 17 Trench extension post-ex (photo 366)

The foundation trench excavated in October 2014 (see *Plate 15*) had now been filled with concrete (*plate 16*), with the current excavations scheduled to take place alongside to the west. Excavations revealed more of the brick grave plot kerb {023}, showing it to extend below the maximum 0.60m depth. Grave cut 37 was further excavated, utilising 100% sieving through a 5mm mesh. No human remains or grave goods were encountered/ disturbed through this exercise.

5. Summary

Overall, the excavation of the foundation trench for a section of the eastern boundary wall at St. Mark's proved rather straightforward and unproblematic. The trench was excavated to an overall length of 7.67m (measured from the edge of the ashlar facing stones of the upstanding southern section of the east boundary wall), and excavated to a specified depth of 0.60m below ground level, and an overall width of 0.75m with a 1.0m x 1.0m pier extension to the south.

Six grave cuts within five grave plots were seen, while a number of brick grave plot kerbs were also noted during excavation. The ease and predictability of the excavation was facilitated by the fact that the boundary wall was erected prior to the burials along its flank, thereby decreasing the possibility of human remains being uncovered directly below the level of the wall. The excavation was also facilitated by the shallow wall foundations and the soft sandy subsoil, which allowed for the clear identification of grave cuts and brick grave plot boundaries.

Particular points of interest within the excavated area are considered to be: the mortared stone filling grave #34.2 (*Plate 9*), the unexpected dual burial cuts within burial plot #35 (*Plate 11*), and the small burial cut (possibly associated with the infant burial) nestled against the edge of burial plot #37 (*Plate 15*).

As expected, no human remains were encountered during this program of works, owing to the fact that only a thin section (c.0.20-0.35m) of the head of the burial plot was removed, and the full extent of the excavations remained too shallow to affect any insitu inhumations. In addition to no human remains being encountered, the excavated trench also proved to be artefactually sterile.

6. Acknowledgements

Addyman Archaeology wishes to thank Mark Peaty of Mark Peaty Building Services, and also his team members Matthew and John, for their accommodation, their interest in archaeology, and the care in which they showed working around the grave plots and monuments.

Thanks are also due to Sophia Marriage and the entire St. Mark's congregation for their hospitality and continued support.

Bibliography

Fleet C., Wilkes M. & Withers, C. 2011. *Scotland – Mapping the Nation*, Edinburgh

www.bgs.ac.uk/opengeoscience

www.historic-scotland.gov.uk

www.nls.uk

Appendix A:

Context Register; Excavation at St. Mark's Episcopal Church, Portobello; AA 2030

<i>Context No.</i>	<i>Initial</i>	<i>Date</i>	<i>Feature</i>	<i>Description</i>
001	AJLM	07/10/2014		Rubble and mortar stone boundary wall, Eastern
002	AJLM	07/10/2014		Asphalt Pavement
003	AJLM	07/10/2014		Bedding for asphalt (002)
004	AJLM	07/10/2014		Light brown - mid orange mottled sandy natural with black banding
005	AJLM	08/10/2014		Cemetery topsoil
006	AJLM	08/10/2014	006	Cut for grave #37, S end of trench
007	AJLM	08/10/2014	006	Fill of [006]
008	AJLM	08/10/2014	006	Mortared stone and brick kerb at N end of #37, within [006]
009	AJLM	08/10/2014	009	Cut for grave #36, N of #37
010	AJLM	08/10/2014	009	Fill of [009]
011	AJLM	08/10/2014	012	Mortared brick kerb within [012], abuts [009]
012	AJLM	08/10/2014	012	Cut for grave #35.2, N of #36
013	AJLM	08/10/2014	012	Fill of [012]
014	AJLM	08/10/2014	014	Cut for grave #35.1, N of #35.2
015	AJLM	08/10/2014	014	Fill of [014]
016	AJLM	08/10/2014	014	Brick, mortares kerb within [014]
017	AJLM	08/10/2014	017	Cut for grave #34.2
018	AJLM	08/10/2014	017	Fill of [017]
019	AJLM	08/10/2014	017	Large stone/ mortared fill of [017], within (018)
020	AJLM	08/10/2014	020	Cut for grave #34.1
021	AJLM	08/10/2014	020	Fill of [020]
022	AJLM	08/10/2014	020	Brick kerb within [020], NW corner of trench
023	AJLM	26/11/2014	006	Brick kerb, S end of trench, within [006]

Appendix B:

Photographic Register; Excavation at St. Mark's Episcopal Church, Portobello; AA 2030

<i>Image No.</i>	<i>Frame</i>	<i>Direction Facing</i>	<i>Date</i>	<i>Description</i>	<i>Taken By</i>	<i>Portrait/ Landscape</i>
001	5002	SE	01/09/2014	Overall view, E wall, vines removed	AJLM	L
002	5003	ENE	01/09/2014	Overall view, E wall, vines removed	AJLM	L
003	5004	ENE	01/09/2014	Grave #34.1, overall, vines removed	AJLM	P
004	5005	ENE	01/09/2014	Grave #34.1, upper detail, cracked masonry	AJLM	L
005	5006	ENE	01/09/2014	Grave #34.1, lower detail, vines removed	AJLM	L
006	5007	ENE	01/09/2014	Grave #34.1, memorial detail	AJLM	P
007	5008	ENE	01/09/2014	Grave #34.2, overall, vines removed	AJLM	P
008	5009	SE	01/09/2014	Grave #34.2, overall, vines removed	AJLM	P
009	5010	SE	01/09/2014	Grave #34.2, upper detail, cracked masonry	AJLM	P
010	5011	NE	01/09/2014	Grave #34.2, lower detail	AJLM	P
011	5012	ENE	01/09/2014	Grave #34.2, memorial detail	AJLM	P
012	5013	SW	01/09/2014	E wall, exterior, overall	AJLM	L

013	5014	W	01/09/2014	E wall, exterior, S end: 1	AJLM	L
014	5015	W	01/09/2014	E wall, exterior, S end: 2	AJLM	L
015	5016	W	01/09/2014	E wall, exterior, S end: 3	AJLM	L
016	5017	W	01/09/2014	E wall, exterior, grave #34.2, upper detail	AJLM	P
017	5018	W	01/09/2014	E wall, exterior, grave #34.2, overall	AJLM	P
018	5019	E	01/09/2014	Grave #33 / 32, overall	AJLM	P
019	5020	E	01/09/2014	Grave #34.1, overall	AJLM	P
020	5021	E	01/09/2014	Grave #34.2, overall	AJLM	P
021	5022	E	01/09/2014	Grave #35, overall	AJLM	P
022	5023	E	01/09/2014	Grave #35, lower detail	AJLM	L
023	5024	E	01/09/2014	Grave #35, upper detail	AJLM	L
024	5025	E	01/09/2014	Grave #36, overall	AJLM	P
025	5026	E	01/09/2014	Grave #36, lower detail	AJLM	L
026	5027	E	01/09/2014	Grave #36, mid detail	AJLM	L
027	5028	E	01/09/2014	Grave #36, upper detail	AJLM	L
028	5029	E	01/09/2014	Grave #37, overall	AJLM	P
029	5030	E	01/09/2014	Grave #37, upper detail	AJLM	L
030	5031	E	01/09/2014	Grave #37, lower detail	AJLM	L
031	5032	E	01/09/2014	S extent of E wall repair	AJLM	P
032	5112	NE	06/10/2014	Pre-ex, E wall removed to foundations	AJLM	L
033	5113	S	06/10/2014	Pre-ex, E wall removed to foundations	AJLM	L
034	5114	E	06/10/2014	Pre-ex, E wall removed to foundations, N extent: 1	AJLM	L
035	5115	E	06/10/2014	Pre-ex, E wall removed to foundations: 2	AJLM	L
036	5116	E	06/10/2014	Pre-ex, E wall removed to foundations: 3	AJLM	L
037	5117	E	06/10/2014	Pre-ex, E wall removed to foundations: 4	AJLM	L
038	5118	E	06/10/2014	Pre-ex, E wall removed to foundations: 5	AJLM	L
039	5119	E	06/10/2014	Pre-ex, E wall removed to foundations: 6	AJLM	L
040	5120	E	06/10/2014	Pre-ex, E wall removed to foundations: 7	AJLM	L
041	5122	E	06/10/2014	Pre-ex, E wall removed to foundations: 7	AJLM	L
042	5123	E	06/10/2014	Pre-ex, E wall removed to foundations: 8	AJLM	L
043	5124	E	06/10/2014	Pre-ex, E wall removed to foundations, S extent: 9	AJLM	L
044	5125	N	06/10/2014	Pre-ex, E wall removed to foundations, N end	AJLM	P
045	5126	S	06/10/2014	Pre-ex, E wall removed to foundations, along length	AJLM	P
046	5127	S	06/10/2014	Pre-ex, E wall removed to foundations, S end	AJLM	P
047	5128	S	06/10/2014	Pre-ex, E wall removed to foundations, S end, base	AJLM	P
048	5129	S	06/10/2014	Pre-ex, E wall removed to foundations, S end, mid	AJLM	P
049	5130	S	06/10/2014	Pre-ex, E wall removed to foundations, S end, upper	AJLM	P
050	5131	E	06/10/2014	Mid-ex, W facing section, N end:1	AJLM	L

051	5132	E	06/10/2014	Mid-ex, W facing section: 2	AJLM	L
052	5133	E	06/10/2014	Mid-ex, W facing section: 3	AJLM	L
053	5134	E	06/10/2014	Mid-ex, W facing section: 4	AJLM	L
054	5135	E	06/10/2014	Mid-ex, W facing section: 5	AJLM	L
055	5136	E	06/10/2014	Mid-ex, W facing section, S end: 6	AJLM	L
056	5137	S	06/10/2014	Mid-ex, N facing section	AJLM	L
057	5138	W	06/10/2014	Mid-ex, E facing section, S end: 1	AJLM	L
058	5139	SW	06/10/2014	Mid-ex, E facing section, S end, void	AJLM	L
059	5140	W	06/10/2014	Mid-ex, E facing section: 2	AJLM	L
060	5141	W	06/10/2014	Mid-ex, E facing section: 3	AJLM	L
061	5142	W	06/10/2014	Mid-ex, E facing section: 4	AJLM	L
062	5143	W	06/10/2014	Mid-ex, E facing section: 5	AJLM	L
063	5144	W	06/10/2014	Mid-ex, E facing section: 6	AJLM	L
064	5145	NW	06/10/2014	Mid-ex, E facing section: 7	AJLM	L
065	5146	N	06/10/2014	Mid-ex, S facing section	AJLM	L
066	5147	E	08/10/2014	Post-ex, W facing section, N end: 1	AJLM	L
067	5148	E	08/10/2014	Post-ex, W facing section: 2	AJLM	L
068	5149	E	08/10/2014	Post-ex, W facing section: 3	AJLM	L
069	5150	E	08/10/2014	Post-ex, W facing section: 4	AJLM	L
070	5151	E	08/10/2014	Post-ex, W facing section, S end: 5	AJLM	L
071	5152	S	08/10/2014	Post-ex, N facing section, showing wall	AJLM	P
072	5153	W	08/10/2014	Post-ex, E facing section, S end: 1	AJLM	L
073	5155	W	08/10/2014	Post-ex, E facing section: 2	AJLM	L
074	5156	W	08/10/2014	Post-ex, E facing section: 3	AJLM	L
075	5158	W	08/10/2014	Post-ex, E facing section: 4	AJLM	L
076	5159	W	08/10/2014	Post-ex, E facing section: 5	AJLM	L
077	5160	W	08/10/2014	Post-ex, E facing section: 6	AJLM	L
078	5161	NW	08/10/2014	Post-ex, NW corner	AJLM	L
079	5163	N	08/10/2014	Post-ex, S facing section	AJLM	P
080	5164	W	08/10/2014	Detail, grave #34.1, cut [020], fill (021), kerb [022], to N: 1	AJLM	L
081	5165	W	08/10/2014	Detail, grave #34.2, fill (019), cut [017], N end: 2	AJLM	L
082	5166	W	08/10/2014	Detail, grave #34.2, fill (019), cut [017], mid: 3	AJLM	L
083	5167	W	08/10/2014	Detail, grave #34.2, fill (019), cut [017], fill (018), kerb [016], S end: 4	AJLM	L
084	5169	W	08/10/2014	Detail, grave #35, kerb [016], cut [014], fill (015), N end: 5	AJLM	L
085	5170	W	08/10/2014	Detail, grave #35, cut [014], fill (015), S end: 6	AJLM	L
086	5171	W	08/10/2014	Detail, grave #35, cut [012], fill (013), N end: 7	AJLM	L
087	5172	W	08/10/2014	Detail, grave #35, cut [012], fill (013), overall: 8	AJLM	L
088	5173	W	08/10/2014	Detail, grave #36, kerb [011], cut [009], fill (010), N end: 9	AJLM	L
089	5174	W	08/10/2014	Detail, grave #36, cut [009], fill (010), kerb [008]: 10	AJLM	L
090	5175	W	08/10/2014	Detail, grave #37, kerb [008], cut [006], fill (007), N end: 11	AJLM	L

091	5176	W	08/10/2014	Detail, grave #37, cut [006], fill (007), mid: 12	AJLM	L
092	5177	W	08/10/2014	Detail, grave #37, cut [006], fill (007), S end: 13	AJLM	L
093	5178	SW	08/10/2014	Detail, W and N facing sections, cut [006], fill (007)	AJLM	L
094	5179	N	08/10/2014	Post-ex, kerb [008], S facing	AJLM	P
095	5180	SW	08/10/2014	Post-ex, kerb [008], N facing	AJLM	P
096	5181	N	08/10/2014	Post-ex, kerb [011], S facing	AJLM	P
097	5182	SW	08/10/2014	Post-ex, kerb [011], N facing	AJLM	P
098	5183	N	08/10/2014	Post-ex, kerb [016], S facing	AJLM	P
099	5184	SW	08/10/2014	Post-ex, kerb [016], N facing	AJLM	P
100	5185	NW	08/10/2014	Post-ex, stone fill (019)	AJLM	L
101	5186	NW	08/10/2014	Post-ex, stone fill (019)	AJLM	L
102	5187	SW	08/10/2014	Post-ex, stone fill (019)	AJLM	L
103	5189	N	08/10/2014	Post-ex, kerb [022], NW corner	AJLM	P
104	5190	V/S	08/10/2014	Post-ex, trench, overall	AJLM	P
105	5191	V/S	08/10/2014	Post-ex, trench, overall	AJLM	P
106	5192	V/W	08/10/2014	Post-ex, trench, overall, N end: 1	AJLM	L
107	5193	V/W	08/10/2014	Post-ex, trench, overall: 2	AJLM	L
108	5194	V/W	08/10/2014	Post-ex, trench, overall: 3	AJLM	L
109	5195	V/W	08/10/2014	Post-ex, trench, overall: 4	AJLM	L
110	5196	V/W	08/10/2014	Post-ex, trench, overall: 5	AJLM	L
111	5197	V/W	08/10/2014	Post-ex, trench, overall: 6	AJLM	L
112		V/W	08/10/2014	Post-ex, trench, overall, stitch (106-111)	AJLM	L
113	5198	V/N	08/10/2014	Post-ex, trench, overall	AJLM	P
114	5199	V/N	08/10/2014	Post-ex, trench, overall	AJLM	P
115		V/W	08/10/2014	Post-ex, trench, overall, E facing section, stitch	AJLM	L
116	5492	V/E	26/11/2014	Pre-ex, S extension, grave #37	AJLM	L
117	5493	S	26/11/2014	Pre-ex, N facing section, grave #37	AJLM	P
118	5494	V/E	26/11/2014	Post-ex, overall	AJLM	L
119	5495	V/W	26/11/2014	Post-ex, overall	AJLM	L
120	5497	E	26/11/2014	Post-ex, W facing section	AJLM	L
121	5498	S	26/11/2014	Post-ex, N facing section, showing [023]	AJLM	L
122	5499	W	26/11/2014	Post-ex, E facing section, showing kerb [023], cut [006], fill (007)	AJLM	L
123	5500	V/W	26/11/2014	Post-ex, E facing section, showing kerb [023], cut [006], fill (007)	AJLM	L
124	5501	SW	26/11/2014	Post-ex, N / E facing sections, no scale	AJLM	L
125	5502	W	26/11/2014	Final post-ex, showing [023], [006], (007)	AJLM	L
126	5503	W	26/11/2014	Final post-ex, showing [023], [006], (007), detail	AJLM	L
127	5504	W	26/11/2014	Final post-ex, showing [023], [006], (007), detail	AJLM	L
128	1044	SW	21/01/2014	Overall view, S wall, N facing	RC	L
129	1045	S	21/01/2014	Overall view, S wall, N facing, E end	RC	L
130	1046	SE	21/01/2014	Overall view, S wall, N facing, W end	RC	L

131	1047	ESE	21/01/2014	Overall view, S wall / E wall, SE corner	RC	L
132	1048	S	21/01/2014	Overall view, S wall, N facing, W end :1	RC	L
133	1049	S	21/01/2014	Overall view, S wall, N facing :2	RC	L
134	1050	S	21/01/2014	Overall view, S wall, N facing :3	RC	L
135	1051	S	21/01/2014	Overall view, S wall, N facing :4	RC	L
136	1052	S	21/01/2014	Overall view, S wall, N facing :5	RC	L
137	1053	S	21/01/2014	Overall view, S wall, N facing :6	RC	L
138	1054	S	21/01/2014	Overall view, S wall, N facing :7	RC	L
139	1055	S	21/01/2014	Overall view, S wall, N facing :8	RC	L
140	1056	S	21/01/2014	Overall view, S wall, N facing, E end :9	RC	L
141	1057	NE	21/01/2014	E wall, S end, Overall	RC	L
142	1058	E	21/01/2014	E wall, S end, Grave markers 40,41,42 :1	RC	L
143	1059	E	21/01/2014	E wall, Graves 38,39,40,41 :2	RC	L
144	1060	E	21/01/2014	E wall, Graves 37,38,39 :3	RC	L
145	1061	E	21/01/2014	E wall, Graves 35,36,37 :4	RC	L
146	1062	E	21/01/2014	E wall, Graves 33,34.1,34.2,35 :5	RC	L
147	1063	E	21/01/2014	E wall, Graves 31,32,33 :6	RC	L
148	1064	E	21/01/2014	E wall, Graves 28,29,30,31 :7	RC	L
149	1065	E	21/01/2014	E wall, Graves 26,27,28,29 :8	RC	L
150	1066	E	21/01/2014	E wall, Graves 25,26,27 :9	RC	L
151	1067	E	21/01/2014	E wall, Graves 25 :10	RC	L
152	1068	SE	21/01/2014	E wall, S section, W facing, Overall	RC	L
153	1069	NW	21/01/2014	S wall, Overall, S facing	RC	L
154	1070	N	21/01/2014	E wall at SE corner, Exterior	RC	P
155	1071	NE	21/01/2014	S wall, Overall, S facing	RC	L
156	1072	N	21/01/2014	S wall, W end, S facing :1	RC	L
157	1073	N	21/01/2014	S wall, S facing :2	RC	L
158	1074	N	21/01/2014	S wall, S facing :3	RC	L
159	1075	N	21/01/2014	S wall, S facing :4	RC	L
160	1076	N	21/01/2014	S wall, S facing :5	RC	L
161	1077	N	21/01/2014	S wall, S facing :6	RC	L
162	1078	N	21/01/2014	S wall, S facing :7	RC	L
163	1079	N	21/01/2014	S wall, S facing :8	RC	L
164	1080	N	21/01/2014	S wall, S facing :9	RC	L
165	1081	N	21/01/2014	S wall, S facing, E end :10	RC	L
166	1232	E	13/03/2014	E wall, Grave 1, Landels 1984-MacGregor 1993	RC	P
167	1233	E	13/03/2014	E wall, Grave 2, Morris 1965-Abbott 1984	RC	P
168	1234	E	13/03/2014	E wall, Grave 3, Maclean 1975-Gow 1986	RC	P
169	1235		13/03/2014	Excerpt of E wall, W facing elevation	RC	L
170	1236		13/03/2014	Excerpt of E wall, W facing elevation	RC	L
171	1237	E	13/03/2014	E wall, Grave 4	RC	P
172	1238	V/E	13/03/2014	E wall, Grave 5, Frederick 1982	RC	L
173	1239	V/E	13/03/2014	E wall, Grave 6, Jackson 1941-Jackson 1946	RC	L
174	1240	E	13/03/2014	E wall, Grave 7, Armstrong 1996-Armstrong 2000	RC	P
175	1241	E	13/03/2014	E wall, Grave 8, Huey 1942	RC	L

176	1242	E	13/03/2014	E wall, Grave 9, Thompson 1945	RC	P
177	1243		13/03/2014	Excerpt of E wall, W facing elevation	RC	L
178	1244		13/03/2014	Excerpt of E wall, W facing elevation	RC	P
179	1245	E	13/03/2014	E wall, Grave 10, CWG, RAF, Sandison 1946	RC	P
180	1246	E	13/03/2014	E wall, Grave 11, Biden 1955-Biden 1987	RC	P
181	1247	E	13/03/2014	E wall, Grave 12, Currie 1956-Wood 2000	RC	P
182	1248	V/E	13/03/2014	E wall, Grave 13, George 1951	RC	L
183	1249	E	13/03/2014	E wall, Grave 14, Baker 1963-Baker 2003	RC	L
184	1250	V/E	13/03/2014	E wall, Grave 15, Jack 1965-Anderson 1969	RC	L
185	1251	E	13/03/2014	E wall, Grave 16, Waddell 1966	RC	P
186	1252	E	13/03/2014	E wall, Grave 17, Montgomery 1967	RC	P
187	1253		13/03/2014	Excerpt from E wall, W facing elevation	RC	P
188	1254	E	13/03/2014	E wall, Grave 18, Tranter 1968-Robertson 2009	RC	P
189	1255	E	13/03/2014	E wall, Grave 19, Livingstone 1968-Finlay 1990	RC	L
190	1256	E	13/03/2014	E wall, Grave 20, Cowe 1969-Watson 1974	RC	L
191	1257	E	13/03/2014	E wall, Grave 21, Snowdon 1972-Gilhespie 1997	RC	L
192	1258	E	13/03/2014	E wall, Grave 22, McIntyre 1981-McIntyre 2008	RC	L
193	1259	E	13/03/2014	E wall, Grave 23, Marshall 1991-Marshall 1997	RC	L
194	1260		13/03/2014	Excerpt of E wall, W facing elevation	RC	P
195	1261	E	13/03/2014	E wall, Grave 24, Marshall 1992-Marshall 1993	RC	L
196	1262	NE	13/03/2014	E wall, N section, Overall	RC	L
197	1263	E	13/03/2014	E wall, Grave 25, Watson 1951	RC	L
198	1264	E	13/03/2014	E wall, Grave 26, Kell 1878	RC	L
199	1265	E	13/03/2014	E wall, Grave 27, Aston 1876-Aston 1915	RC	L
200	1266	E	13/03/2014	E wall, Grave 28, Molison 1876-Mackenzie 1886	RC	L
201	1267		13/03/2014	Excerpt of E wall, W facing elevation	RC	L
202	1268	E	13/03/2014	E wall, Grave 29, Fergusson 1874-Fergusson 1886	RC	P
203	1269	E	13/03/2014	E wall, Grave 30, MacAdam 1871	RC	P
204	1270		13/03/2014	Excerpt from E wall, W facing elevation	RC	L
205	1271	E	13/03/2014	E wall, Grave 31, Giddings 1882-Macintosh 1944	RC	P
206	1272	E	13/03/2014	E wall, Grave 32, T.L.J.	RC	L
207	1273	E	13/03/2014	E wall, Grave 33, Cartman 1869	RC	P
208	1274	E	13/03/2014	E wall, Location of grave 34.2 under ivy	RC	P
209	1275	E	13/03/2014	E wall, Grave 35, Home 1868-	RC	P

				Fraser 1876		
210	1276	E	13/03/2014	E wall, Grave 36, Baldwin 1846- Baldwin 1891	RC	P
211	1277	E	13/03/2014	E wall, Grave 36, Base	RC	L
212	1278		13/03/2014	Excerpt from E wall, W facing elevation	RC	P
213	1279	E	13/03/2014	E wall, Grave 37, Farquharson 1863-Kerr	RC	L
214	1280	E	13/03/2014	E wall, Grave 38, Hall 1835-Hall 1928	RC	P
215	1281	E	13/03/2014	E wall, Grave 39, Bedford 1865	RC	P
216	1282	E	13/03/2014	E wall, Grave 40, Clark 1863- Clark 1995	RC	L
217	1283	E	13/03/2014	E wall, Grave 41, MacGregor 1845	RC	L
218	1284	E	13/03/2014	E wall, Grave 42, macGregor 1838-MacGregor 1852	RC	L
219	1285	ESE	13/03/2014	S wall, E end, Grave43, Edward	RC	L
220	1286	S	13/03/2014	S wall, Grave 44, Wedderburn 1856	RC	P
221	1287	S	13/03/2014	S wall, Grave 44, Wedderburn 1856	RC	P
222	1288		13/03/2014	Excerpt from S wall, N facing elevation	RC	L
223	1289	S	13/03/2014	S wall, Grave 45, Millar	RC	P
224	1290	S	13/03/2014	S wall, Grave 46, Landels 1869- Ketchen 191?	RC	L
225	1291	S	13/03/2014	S wall, Grave 46, Landels 1869- Ketchen 191?	RC	L
226	1292		13/03/2014	Excerpt from S wall, N facing elevation	RC	L
227	1293	S	13/03/2014	S wall, Grave 47, Whyte 1848- ? 1851	RC	P
228	1294	S	13/03/2014	S wall, Grave 47, Whyte 1848- ? 1851	RC	P
229	1295	S	13/03/2014	S wall, Grave 48, Young 1867	RC	P
230	1296	S	13/03/2014	S wall, Grave 48, Young 1867	RC	P
231	1297		13/03/2014	Excerpt from S wall, N facing elevation	RC	L
232	1298	S	13/03/2014	S wall, Grave 49, Strangways 1861	RC	P
233	1299	S	13/03/2014	S wall, Grave 50, Sterndale 1966	RC	P
234	1300	S	13/03/2014	S wall, Grave 51, Eastwood 1870	RC	L
235	1301	S	13/03/2014	S wall, Grave 52, Jameson 1860- Irvine 1870	RC	L
236	1302	S	13/03/2014	S wall, Grave 53, D.J.	RC	L
237	1303	S	13/03/2014	S wall, Grave 54, Giddings 1900	RC	L
238	1304	S	13/03/2014	S wall, Grave 55, Reardon 1900- Reardon 1929	RC	L
239	1305	E	13/03/2014	S wall, E end, Overall	RC	L
240	1306	S	13/03/2014	S wall, Grave 56, Elliott 1862- Hunter 1885	RC	L
241	1307	S	13/03/2014	S wall, Grave 58, Stanley	RC	L
242	1308	S	13/03/2014	S wall, Grave 59, C.D.M.	RC	L
243	1309	S	13/03/2014	S wall, Grave 60, Emma 1884	RC	L
244	1310	S	13/03/2014	S wall, Grave 60, Overall	RC	L
245	1311		13/03/2014	Excerpt from S wall, N facing elevation	RC	L

246	1312	S	13/03/2014	S wall, Grave 61	RC	P
247	1313	S	13/03/2014	S wall, Grave 62, Graeme 1842	RC	L
248	1314	S	13/03/2014	S wall, Grave 63	RC	L
249	1315	S	13/03/2014	S wall, Grave 64, Wood 1839	RC	L
250	1316	S	13/03/2014	S wall, Grave 65, W??S	RC	L
251	1317	S	13/03/2014	S wall, Grave 66, Buchanan 1887	RC	L
252	1318	S	13/03/2014	S wall, Grave 67, Buchanan 1848	RC	L
253	1319	S	13/03/2014	S wall, Grave 68, Buchanan 18?1	RC	L
254	1320	SW	13/03/2014	SW corner, Grave 70	RC	P
255	1321	W	13/03/2014	W wall, Grave 70, Forsyth 1881- Forsyth 1924	RC	P
256	1322	W	13/03/2014	W wall, Grave 71, Ansell ?-? 1849	RC	P
257	1323	W	13/03/2014	W wall, Grave 72	RC	L
258	1324		13/03/2014	Excerpt W wall, E facing elevation	RC	P
259	1325	W	13/03/2014	W wall, Grave 73, Dickson 1836	RC	L
260	1326	W	13/03/2014	W wall, Grave 74, Black	RC	L
261	1327	W	13/03/2014	W wall, Grave 75, Huey 1838	RC	L
262	1328	W	13/03/2014	W wall, Grave 76, Stenhouse 1858	RC	L
263	1329	W	13/03/2014	W wall, Grave 77, Adam	RC	P
264	1330	W	13/03/2014	W wall, Grave 77, Adam	RC	P
265	1331		13/03/2014	Excerpt W wall, E facing elevation	RC	P
266	1332	W	13/03/2014	W wall, Grave 78, Spence	RC	L
267	1333	W	13/03/2014	W wall, Grave 79, Radcliffe 1891	RC	L
268	1334	W	13/03/2014	W wall, Grave 80, Boyd 1890	RC	L
269	1335	W	13/03/2014	W wall, Grave 81, Minor 1991- Minor 2005	RC	L
270	1336	W	13/03/2014	W wall, Grave 82, Rhoades 1989-Tait 2005	RC	L
271	1337	W	13/03/2014	W wall, Grave 83, Garner 1977- Tait 1982	RC	L
272	1338	W	13/03/2014	W wall, Grave 84, Lawson 1942- Lawson 1945	RC	L
273	1339		13/03/2014	Excerpt W wall, E facing elevation	RC	P
274	1340		13/03/2014	Excerpt W wall, E facing elevation	RC	P
275	1341	W	13/03/2014	W wall, Grave 85, Carter 1904	RC	L
276	1342	W	13/03/2014	W wall, Grave 86, Laker 1911	RC	L
277	1343	W	13/03/2014	W wall, Grave 87, Alexander 1942-Walker 1942	RC	L
278	1344	W	13/03/2014	W wall, Grave 88, Skidmore 1929	RC	L
279	1345	W	13/03/2014	W wall, Grave 89, Marchant 1937-Marchant 1933	RC	L
280	1346		13/03/2014	Excerpt W wall, E facing elevation	RC	L
281	1347	W	13/03/2014	W wall, Grave 90, Skidmore 1926-Beech 1931	RC	L
282	1348	W	13/03/2014	W wall, Grave 91, Pierce 1907- Pierce 1906	RC	L
283	1349	V/E	13/03/2014	W wall, Grave 91, Pierce 1907- Pierce 1906	RC	L
284	1350	W	13/03/2014	W wall, Grave 92, Graham	RC	L
285	1351	W	13/03/2014	W wall, Grave 93, Hamilton 1880- Hamilton	RC	L

286	1352	W	13/03/2014	W wall, Grave 94, Home 1874-Home 1876	RC	L
287	1353	W	13/03/2014	W wall, Grave 94, Home 1874-Home 1876	RC	L
288	1354		13/03/2014	Excerpt W wall, E facing elevation	RC	L
289	1355	W	13/03/2014	W wall, Grave 95, Simpson 1871	RC	L
290	1356	W	13/03/2014	W wall, Grave 96	RC	L
291	1357	W	13/03/2014	W wall, Grave 97, Bowman 1853-Bowman 1874	RC	P
292	1358	W	13/03/2014	W wall, Grave 98, Peacock 1873-Peacock 1902	RC	L
293	1359	W	13/03/2014	W wall, Grave 99, Adams 1886	RC	L
294	1360	V/W	13/03/2014	W wall, Grave 100, A.W.	RC	L
295	1361	V/W	13/03/2014	W wall, Grave 101, A.W.	RC	L
296	1362	V/W	13/03/2014	W wall, Grave 102, J.D.	RC	L
297	1363		13/03/2014	Excerpt W wall, E facing elevation	RC	L
298	1364	W	13/03/2014	W wall, Grave 103	RC	L
299	1365	W	13/03/2014	W wall, Grave 104, McDonald - Brown 1933	RC	L
300	1366	W	13/03/2014	W wall, Grave 105, Aaronson 1959	RC	L
301	1367	W	13/03/2014	W wall, Stone	RC	L
302	1368	W	13/03/2014	W wall, Grave 106, Kerr 1949-Kerr 1971	RC	L
303	1369	W	13/03/2014	W wall, Grave 107, Giddings 1916-Deuchar 1923	RC	P
304	1370	W	13/03/2014	W wall, Grave 107, Giddings 1916-Deuchar 1923	RC	P
305	1371	W	13/03/2014	W wall, Grave 107, Giddings 1916-Deuchar 1923	RC	P
306	1372		13/03/2014	Excerpt W wall, E facing elevation	RC	L
307	1373	W	13/03/2014	W wall, Grave 108, Johnston 1906	RC	L
308	1374	W	13/03/2014	W wall, Grave 109, Franks 1909	RC	L
309	1375	W	13/03/2014	W wall, Grave 110, Bayes 1997	RC	L
310	1376	W	13/03/2014	W wall, Grave 111, Wilson 1999	RC	L
311	1377	W	13/03/2014	W wall, Grave 112, Starling 2001	RC	L
312	1378	E	13/03/2014	E wall, N section, at Doorway :1	RC	L
313	1379	E	13/03/2014	E wall, N section :2	RC	L
314	1380	E	13/03/2014	E wall, N section :3	RC	L
315	1381	E	13/03/2014	E wall, N section :4	RC	L
316	1382	E	13/03/2014	E wall, N section :5	RC	L
317	1383	E	13/03/2014	E wall, N section :6	RC	L
318	1384	E	13/03/2014	E wall, N section :7	RC	L
319	1385	E	13/03/2014	E wall, N section :8	RC	L
320	1386	E	13/03/2014	E wall, N section :9	RC	L
321	1387	E	13/03/2014	E wall, N section :10	RC	L
322	1388	NE	13/03/2014	E wall, N section, Tree to Gate	RC	L
323	1389	N	13/03/2014	N wall, E end, Gate	RC	P
324	1390	N	13/03/2014	N wall, E end, Gate	RC	P
325	1391	NW	13/03/2014	N wall, E end, Overall	RC	L
326	1392	N	13/03/2014	N wall, Central Gate	RC	L
327	1393	N	13/03/2014	N wall, Central Gate	RC	L
328	1394	N	13/03/2014	N wall, Central, E pier	RC	L

329	1395	N	13/03/2014	N wall, Central, W pier	RC	L
330	1396	NE	13/03/2014	N wall, E end, Overall	RC	L
331	1397	NW	13/03/2014	N wall, W end, Overall	RC	L
332	1398	N	13/03/2014	N wall, W end, Overall	RC	L
333	1399	N	13/03/2014	N wall, W end, Gate	RC	L
334	1400	N	13/03/2014	N wall, W end, Gate	RC	P
335	1401	W	13/03/2014	W wall, N end :1	RC	L
336	1402	SW	13/03/2014	W wall, Overall	RC	L
337	1403	W	13/03/2014	W wall, N end :2	RC	L
338	1404	W	13/03/2014	W wall :3	RC	L
339	1405	W	13/03/2014	W wall :4	RC	L
340	1406	W	13/03/2014	W wall :5	RC	L
341	1407	W	13/03/2014	W wall :6	RC	L
342	1408	W	13/03/2014	W wall :7	RC	L
343	1409	W	13/03/2014	W wall :8	RC	L
344	1410	W	13/03/2014	W wall :9	RC	L
345	1411	W	13/03/2014	W wall :10	RC	L
346	1412	W	13/03/2014	W wall :11	RC	L
347	1413	W	13/03/2014	W wall :12	RC	L
348	1414	W	13/03/2014	W wall :13	RC	L
349	1415	W	13/03/2014	W wall :14	RC	L
350	1416	W	13/03/2014	W wall :15	RC	L
351	1417	W	13/03/2014	W wall :16	RC	L
352	1418	W	13/03/2014	W wall :17	RC	L
353	1419	W	13/03/2014	W wall :18	RC	L
354	1420	W	13/03/2014	W wall, S end :19	RC	L
355	1422	S	13/03/2014	E wall, E facing, NW corner	RC	P
356	1424	N	13/03/2014	E wall, E facing, N end	RC	P
357	1425	S	13/03/2014	E wall, E facing, S end	RC	P
358	1426	S	13/03/2014	E wall, E facing, S end	RC	P
359		SW	08/04/2015	E wall, Pier extension, Pre-ex	AJLM	L
360		SW	08/04/2015	E wall, Pier extension, Pre-ex	AJLM	L
361		S	08/04/2015	E wall, Pier extension, Pre-ex	AJLM	P
362		S	08/04/2015	E wall, Pier extension, Pre-ex	AJLM	P
363		V/S	08/04/2015	E wall, Pier extension, Post-ex	AJLM	P
364		S	08/04/2015	E wall, Pier extension, Post-ex	AJLM	L
365		V/W	08/04/2015	E wall, Pier extension, Post-ex	AJLM	L
366		SW	08/04/2015	E wall, Pier extension, Post-ex	AJLM	L
367		V/E	08/04/2015	E wall, Pier extension, Post-ex	AJLM	L
368		W	08/04/2015	E wall, Pier extension, Post-ex	AJLM	L
369		W	08/04/2015	E wall, Pier extension, Post-ex	AJLM	L
370		SW	08/04/2015	E wall, Pier extension, Post-ex	AJLM	P
371		SW	08/04/2015	E wall, Pier extension, Post-ex	AJLM	P
372		SW	08/04/2015	E wall, Pier extension, Post-ex	AJLM	P
373		N	08/04/2015	E wall, Pier extension, Post-ex	AJLM	P

Appendix C:

Drawing Register; Excavation at St. Mark's Episcopal Church, Portobello; AA 2030

Drawing No.	Sheet no.	Scale	Type	Date	Drawn by	Description
001	1	1:50	Elevation	2014	RC / AJLM	E wall, west and east facing, showing section for dismantling
002	2	1:50	Elevation	2014	RC	S wall, north and south facing
003	3	1:50	Elevation	2014	RC	W wall, east facing
004	3	1:50	Elevation	2014	RC	N wall, south facing

Appendix D:

Photographic Thumbnails; St. Mark's Episcopal Church, Portobello, AA2030



2030 (001).JPG



2030 (002).JPG



2030 (003).JPG



2030 (004).JPG



2030 (005).JPG



2030 (006).JPG



2030 (007).JPG



2030 (008).JPG



2030 (009).JPG



2030 (010).JPG



2030 (011).JPG



2030 (012).JPG



2030 (013).JPG



2030 (014).JPG



2030 (015).JPG



2030 (016).JPG



2030 (017).JPG



2030 (018).JPG



2030 (019).JPG



2030 (020).JPG



2030 (021).JPG



2030 (022).JPG



2030 (023).JPG



2030 (024).JPG



2030 (025).JPG



2030 (026).JPG



2030 (027).JPG



2030 (028).JPG



2030 (029).JPG



2030 (030).JPG



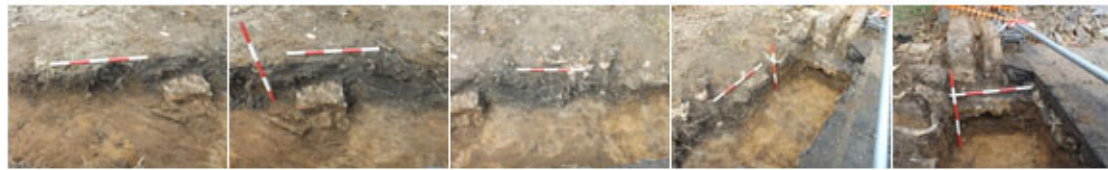

2030 (061).JPG

2030 (062).JPG

2030 (063).JPG

2030 (064).JPG

2030 (065).JPG



2030 (066).JPG

2030 (067).JPG

2030 (068).JPG

2030 (069).JPG

2030 (070).JPG



2030 (071).JPG



2030 (072).JPG



2030 (073).JPG



2030 (074).JPG



2030 (075).JPG



2030 (076).JPG



2030 (077).JPG



2030 (078).JPG



2030 (079).JPG



2030 (080).JPG



2030 (081).JPG



2030 (082).JPG



2030 (083).JPG



2030 (084).JPG



2030 (085).JPG



2030 (086).JPG



2030 (087).JPG



2030 (088).JPG



2030 (089).JPG



2030 (090).JPG





2030 (121).jpg

2030 (122).jpg

2030 (123).jpg

2030 (124).jpg

2030 (125).jpg



2030 (126).jpg

2030 (127).jpg

2030 (128).JPG

2030 (129).JPG

2030 (130).JPG



2030 (131).JPG

2030 (132).JPG

2030 (133).JPG

2030 (134).JPG

2030 (135).JPG



2030 (136).JPG

2030 (137).JPG

2030 (138).JPG

2030 (139).JPG

2030 (140).JPG



2030 (141).JPG

2030 (142).JPG

2030 (143).JPG

2030 (144).JPG

2030 (145).JPG



2030 (146).JPG

2030 (147).JPG

2030 (148).JPG

2030 (149).JPG

2030 (150).JPG



2030 (151).JPG



2030 (152).JPG



2030 (153).JPG



2030 (154).JPG



2030 (155).JPG



2030 (156).JPG



2030 (157).JPG



2030 (158).JPG



2030 (159).JPG



2030 (160).JPG



2030 (161).JPG



2030 (162).JPG



2030 (163).JPG



2030 (164).JPG



2030 (165).JPG



2030 (166).JPG



2030 (167).JPG



2030 (168).JPG

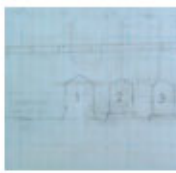

2030 (169).JPG



2030 (170).JPG



2030 (171).JPG



2030 (172).JPG



2030 (173).JPG



2030 (174).JPG



2030 (175).JPG



2030 (176).JPG



2030 (177).JPG



2030 (178).JPG



2030 (179).JPG



2030 (180).JPG



2030 (181).JPG



2030 (182).JPG



2030 (183).JPG



2030 (184).JPG



2030 (185).JPG



2030 (186).JPG



2030 (187).JPG



2030 (188).JPG



2030 (189).JPG



2030 (190).JPG



2030 (191).JPG



2030 (192).JPG



2030 (193).JPG



2030 (194).JPG



2030 (195).JPG



2030 (196).JPG



2030 (197).JPG



2030 (198).JPG



2030 (199).JPG



2030 (200).JPG

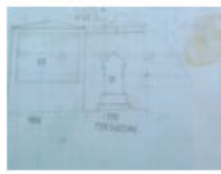

2030 (201).JPG



2030 (202).JPG



2030 (203).JPG

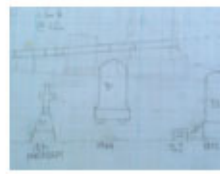

2030 (204).JPG



2030 (205).JPG



2030 (206).JPG



2030 (207).JPG



2030 (208).JPG



2030 (209).JPG



2030 (210).JPG



2030 (211).JPG



2030 (212).JPG



2030 (213).JPG



2030 (214).JPG



2030 (215).JPG



2030 (216).JPG



2030 (217).JPG



2030 (218).JPG



2030 (219).JPG



2030 (220).JPG



2030 (221).JPG



2030 (222).JPG



2030 (223).JPG



2030 (224).JPG



2030 (225).JPG

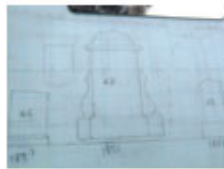

2030 (226).JPG



2030 (227).JPG



2030 (228).JPG



2030 (229).JPG



2030 (230).JPG

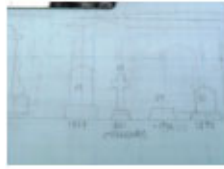

2030 (231).JPG



2030 (232).JPG



2030 (233).JPG



2030 (234).JPG



2030 (235).JPG



2030 (236).JPG



2030 (237).JPG



2030 (238).JPG



2030 (239).JPG



2030 (240).JPG



2030 (241).JPG



2030 (242).JPG



2030 (243).JPG



2030 (244).JPG



2030 (245).JPG



2030 (246).JPG



2030 (247).JPG



2030 (248).JPG



2030 (249).JPG



2030 (250).JPG



2030 (251).JPG



2030 (252).JPG



2030 (253).JPG



2030 (254).JPG



2030 (255).JPG



2030 (256).JPG



2030 (257).JPG



2030 (258).JPG



2030 (259).JPG



2030 (260).JPG



2030 (261).JPG



2030 (262).JPG



2030 (263).JPG



2030 (264).JPG



2030 (265).JPG



2030 (266).JPG



2030 (267).JPG



2030 (268).JPG



2030 (269).JPG



2030 (270).JPG



2030 (271).JPG

2030 (272).JPG

2030 (273).JPG

2030 (274).JPG

2030 (275).JPG



2030 (276).JPG

2030 (277).JPG

2030 (278).JPG

2030 (279).JPG

2030 (280).JPG



2030 (281).JPG

2030 (282).JPG

2030 (283).JPG

2030 (284).JPG

2030 (285).JPG

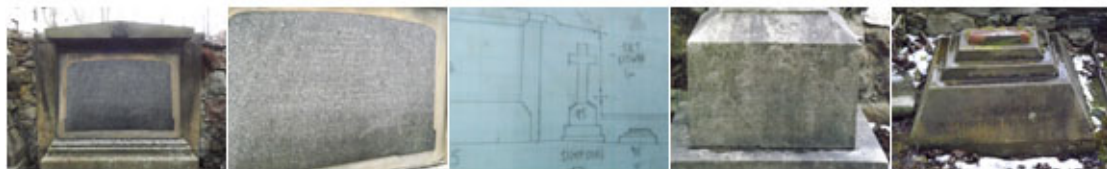

2030 (286).JPG

2030 (287).JPG

2030 (288).JPG

2030 (289).JPG

2030 (290).JPG



2030 (291).JPG

2030 (292).JPG

2030 (293).JPG

2030 (294).JPG

2030 (295).JPG



2030 (296).JPG

2030 (297).JPG

2030 (298).JPG

2030 (299).JPG

2030 (300).JPG



2030 (301).JPG



2030 (302).JPG



2030 (303).JPG



2030 (304).JPG



2030 (305).JPG

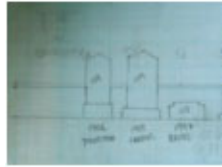

2030 (306).JPG



2030 (307).JPG



2030 (308).JPG



2030 (309).JPG



2030 (310).JPG



2030 (311).JPG



2030 (312).JPG



2030 (313).JPG



2030 (314).JPG



2030 (315).JPG



2030 (316).JPG



2030 (317).JPG



2030 (318).JPG



2030 (319).JPG



2030 (320).JPG



2030 (321).JPG



2030 (322).JPG



2030 (323).JPG



2030 (324).JPG



2030 (325).JPG



2030 (326).JPG



2030 (327).JPG



2030 (328).JPG



2030 (329).JPG



2030 (330).JPG



2030 (331).JPG



2030 (332).JPG



2030 (333).JPG



2030 (334).JPG



2030 (335).JPG



2030 (336).JPG



2030 (337).JPG



2030 (338).JPG



2030 (339).JPG



2030 (340).JPG



2030 (341).JPG



2030 (342).JPG



2030 (343).JPG



2030 (344).JPG



2030 (345).JPG



2030 (346).JPG



2030 (347).JPG



2030 (348).JPG



2030 (349).JPG



2030 (350).JPG



2030 (351).JPG



2030 (352).JPG



2030 (353).JPG



2030 (354).JPG



2030 (355).JPG



2030 (356).JPG



2030 (357).JPG



2030 (358).JPG



2030 (359).JPG



2030 (360).JPG



2030 (361).JPG



2030 (362).JPG



2030 (363).JPG



2030 (364).JPG



2030 (365).JPG



2030 (366).JPG



2030 (367).JPG



2030 (368).JPG



2030 (369).JPG



2030 (370).JPG



2030 (371).JPG



2030 (372).JPG



2030 (373).JPG

Appendix E:
Survey Drawings

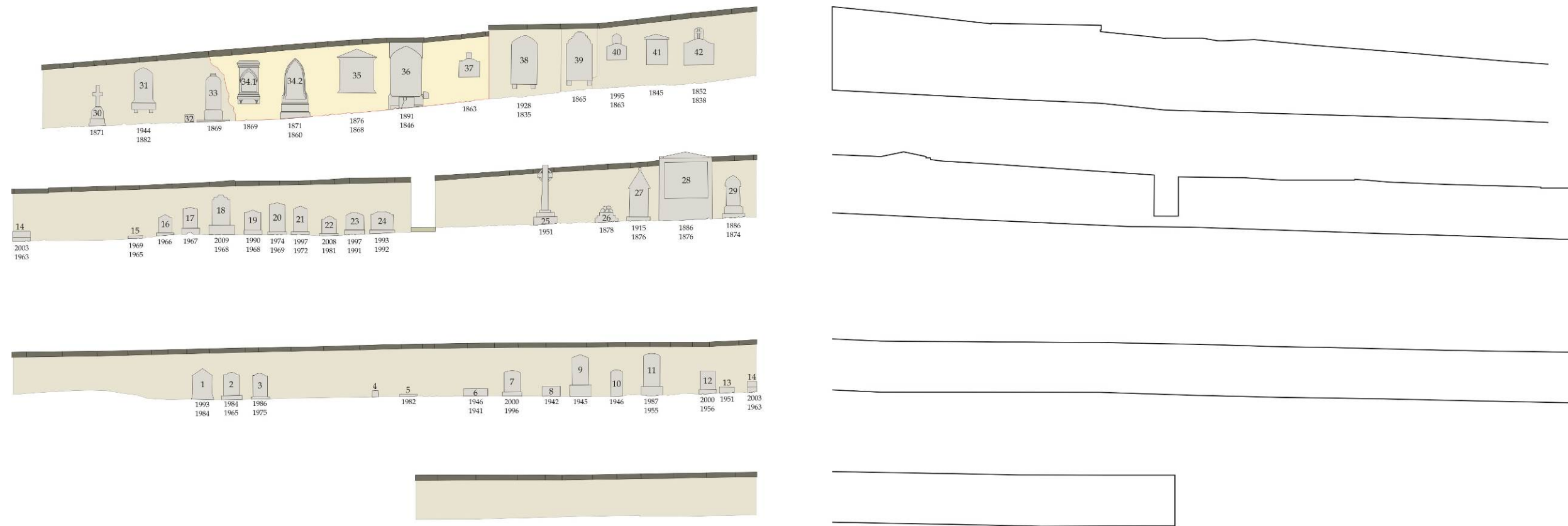

Figure 1 Continuous elevation of E wall, internal (left) and external (right) reproduced at 1:100

5m
Area of east wall dismantled

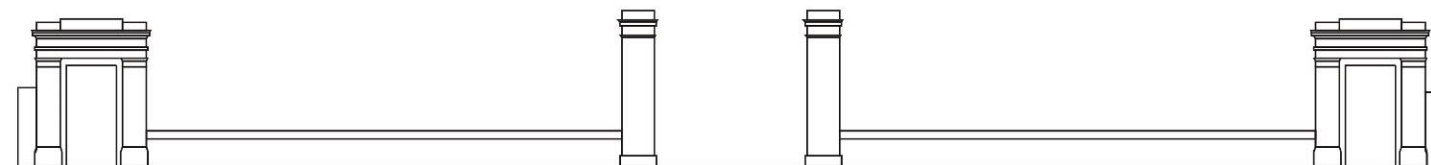

Figure 2 Measured representation of N wall (internal) reproduced at 1:100

5m

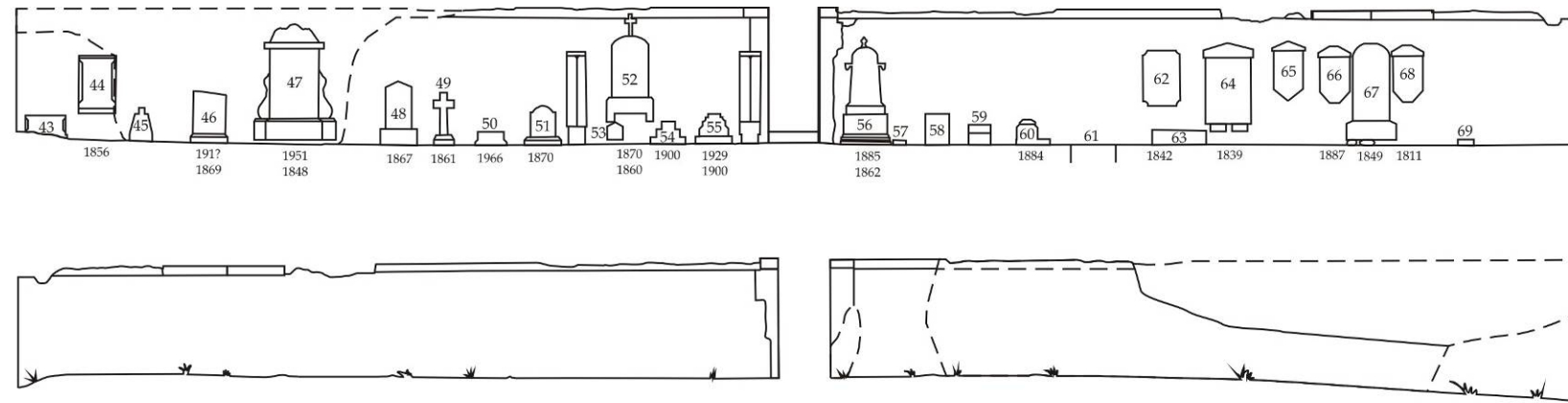

Figure 3 Continuous elevation of S wall, internal (top) and external (bottom) reproduced at 1:100

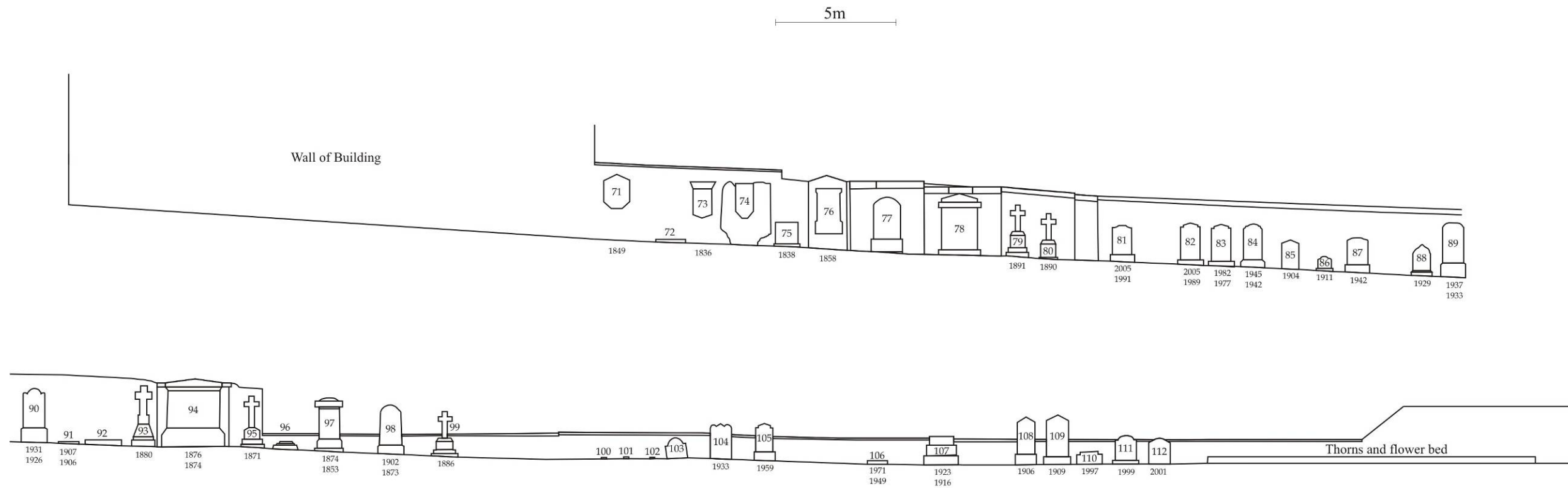

Figure 4 Continuous elevation of E wall, internal reproduced at 1:100

5m

Appendix F:

Provisional Discovery & Excavation Scotland (DES) entry; St. Mark's, Portobello; AA 2030

LOCAL AUTHORITY:	Edinburgh City Council
PROJECT TITLE/SITE NAME:	St. Mark's Episcopal Church
PROJECT CODE:	AA 2030
PARISH:	Portobello
NAME OF CONTRIBUTOR:	Andrew Morrison
NAME OF ORGANISATION:	Addyman Archaeology
TYPE(S) OF PROJECT:	Archaeological Excavation
NMRS NO(S):	N/A
SITE/MONUMENT TYPE(S):	Kirkyard
SIGNIFICANT FINDS:	None
NGR (2 letters, 8 or 10 figures)	NT 30775 73610
START DATE (this season)	1 st September 2014
END DATE (this season)	8 th April 2015
PREVIOUS WORK (incl. DES ref.)	None
MAIN (NARRATIVE) DESCRIPTION: (May include information from other fields)	<p>Addyman Archaeology was commissioned to undertake the required archaeological mitigation associated with the repair and replacement of the boundary wall around the St. Mark's Church in Portobello (NGR NT 30775 73610). The Church and surrounding walls were built in the 1820s, and St Mark's Graveyard has continued in use from first recorded internment in December 1828 until the present day.</p> <p>Although much of the wall could be repaired, some sections were considered too unsafe and needed to be dismantled and rebuilt. In these areas, new wall foundations were required, potentially impacting upon the burials located directly adjacent to the wall. Addyman Archaeology have produced a measured hand drawing of all boundary walls, complete with a detailed photographic record, have monitored the demolition of the wall, and have undertaken any excavations required for the installation of new foundations.</p> <p>After the dismantling of a small section of the Eastern Church boundary wall, the affected grave monuments were safely removed and stored for later remounting. A foundation trench was dug along this section, 7.67m in length and 0.75m in width, to a depth of 0.60m according to the specified wall foundation parameters. Six grave cuts within five grave plots were seen, while a number of brick grave plot kerbs were also noted. No human remains or charnel material was encountered during this exercise.</p>
PROPOSED FUTURE WORK:	None
CAPTION(S) FOR ILLUSTRS:	None
SPONSOR OR FUNDING BODY:	St. Mark's Church
ADDRESS OF MAIN CONTRIBUTOR:	St. Ninian's Manse, Quayside Street, Edinburgh, EH6 6EJ
EMAIL ADDRESS:	admin@addyman-archaeology.co.uk

ARCHIVE LOCATION (intended/deposited)	Archive and report to be deposited with RCAHMS and City of Edinburgh HER.
--	---