

# Panmure House

*Canongate, City of Edinburgh*

---

Archaeological Watching Brief: works related to Demolishing and slapping of historic fabric, November-December 2016: Data Structure Report

for Edinburgh Business School



*Demolition works in progress, Panmure House*

## Addyman Archaeology

Archaeology

Heritage Consultancy

Architecture

# Panmure House

## *Canongate, City of Edinburgh*

---

### *Archaeological Watching Brief: Demolishing and slapping of historic fabric, November-December 2016: Data Structure Report*

*Project No. AA.1910*

by Kenneth Macfadyen

#### **Contents**

<i>Acknowledgements.....</i>	<i>2</i>
<i>Executive Summary.....</i>	<i>4</i>
<i>1. Introduction.....</i>	<i>5</i>
<i>i. General.....</i>	<i>5</i>
<i>ii. The present project.....</i>	<i>5</i>
<i>iii. Setting.....</i>	<i>5</i>
<i>2. Method.....</i>	<i>7</i>
<i>3. Demolitions.....</i>	<i>7</i>
<i>i. Demolition of concrete slab and brick stairs.....</i>	<i>7</i>
<i>iii. Demolition of brick skin within basement.....</i>	<i>9</i>
<i>iv. Reducing lean-to down to ground level.....</i>	<i>9</i>
<i>a Southern elevation.....</i>	<i>9</i>
<i>b South eastern corner of lean-to.....</i>	<i>10</i>
<i>c Eastern elevation.....</i>	<i>13</i>
<i>v. The demolition of the stair tower remnant.....</i>	<i>13</i>
<i>vi. Slapping of a new entrance into Panmure House.....</i>	<i>15</i>
<i>3. Conclusion.....</i>	<i>19</i>
<i>4. References.....</i>	<i>20</i>
<i>Appendix A Photographic register.....</i>	<i>21</i>
<i>Appendix B Illustrations.....</i>	<i>27</i>

## Illustrations

### Figures

Figure 1 Site location	6
------------------------	---

### Plates

<i>Plate 1 Stairs under demolition, showing rubble skin over brick</i>	7
<i>Plate 2 Historic photo from the 1920s? Shows earlier stair arrangement to the basement at the south gable</i>	8
<i>Plate 3 Door exposed on south elevation of lean-to</i>	9
<i>Plate 4 Window exposed on south elevation of lean-to</i>	9
<i>Plate 5 Interior face of south wall, lean-to shows blocked openings</i>	10
<i>Plate 6 Vertical jamb at end of clay masonry to west under excavation. Lime bonded masonry of lean-to formerly abutting to right</i>	10
<i>Plate 7 Vertical jamb at end of clay masonry</i>	10
<i>Plate 8 South elevation of lean-to, shows flue at east end (top)</i>	12
<i>Plate 9 South elevation of lean-to detail of flue emptied shows flue damper in situ and partially open</i>	12
<i>Plate 10 Wall face of flue shows damper handle (bent over) and bricked up opening below?</i>	12
<i>Plate 11 Stair tower remnant as exposed following demolition of concrete roof</i>	13
<i>Plate 12 Iron door lintel inscribed with "Chapel of St Michael"</i>	14
<i>Plate 13 Stair tower demolished showing tower masonry built into window 171 with a little historic harl in situ below the window</i>	15
<i>Plate 14 Stair tower demolished showing tower masonry built over blocking of window 166 and survival of former historic harl</i>	15
<i>Plate 15 Window exterior rubble blocking removed exposing back of modern infill</i>	16
<i>Plate 16 Window fully opened up shows west jamb</i>	16
<i>Plate 17 Window cill showing imprint of window case and 3 bar holes</i>	17
<i>Plate 18 View up to lintel remnant, shows imprint of window case, one bar hole and a possible glazing groove</i>	17
<i>Plate 19 East ingo of window showing plaster in situ</i>	18
<i>Plate 20 Plaster on ingo showing 2 phases</i>	18
<i>Plate 21 Underside of jamb stone from window detail of tooling</i>	18

### Acknowledgements

Addyman Archaeology would like to thank John Lawson, City Archaeologist for advice during the project and Maxi construction Ltd., site contractor, for assistance on site.

Unless otherwise stated all content is the copyright of Simpson and Brown *Architects* with Addyman Archaeology. All photographs and drawings in this report are by the authors unless stated.

# Panmure House

## *Canongate, City of Edinburgh*

---

### *Archaeological Watching Brief: Demolishing and slapping of historic fabric, November-December 2016: Data Structure Report*

#### *Executive Summary*

Addyman Archaeology was commissioned by Edinburgh Business School to undertake archaeological monitoring during the demolition of an historic lean-to extension to the exterior of Panmure House, Canongate, Edinburgh. These demolitions and the formation of a new door into the house were to be undertaken in advance of a new build extension of the building.

The building works involved the demolition of the remains of a lean-to extension on the south-east side of the late 17<sup>th</sup> century Panmure House, possibly of 19<sup>th</sup> century construction. The building had been reduced to a single storey in the mid-20<sup>th</sup> century and a concrete slab roof poured on top. Within this reduced building and also to be demolished was the ground level remnant of a former external stair tower at the south-east junction of the south and east jambs. The stair and jambs had been reduced as part of the 20<sup>th</sup> century alterations.

The formation of a large new door in the south wall of Panmure House leading into the new extension required the removal of an historic window as well other historic fabric. The slapping of the door allowed the unblocking of an original 17<sup>th</sup> century window prior to its demolition. This uncovered the original plaster-lined ingos; two layers of lime-washed plaster were recorded and sampled.

Monitoring of the demolitions hoped to recover some reused architectural fragments within the rubble, however no significant fragments were noted. The stair tower was clearly built from reused masonry, but this was mostly plain squared blocks, although a few stones were seen with their former mouldings completely clawed back to square them up. A window and a door to the lean-to were uncovered; these were formerly believed lost in the mid-20<sup>th</sup> century restorations.

The demolition of the lean-to structure revealed a small remnant of an earlier clay bonded structure mostly replaced by the lime bonded rubble of the lean-to. This clay bonded structure is likely to be the last remnant of a row of cottages extending north-south along the burgage plot boundary; a parallel row is evident built beneath the south gable of Panmure House.

## 1. Introduction

### i. General

Addyman Archaeology were commissioned to undertake a watching brief during demolitions within and around Panmure House, as part of planning conditions associated with the redevelopment of the site (planning ref no: 09/01922/FUL). The watching brief formed part of the archaeological planning conditions on the site, as instructed by John Lawson, City Archaeologist, City of Edinburgh Council Archaeology Service (CECAS), imposed due to the significance of the building and the potential for uncovering significant archaeological information relating to its history.

The works reported here represent a discrete phase within a larger scheme of works to refurbish Panmure House. Previously, extensive recording and analysis of the structure was undertaken following the strip out of modern linings (Addyman Archaeology 2011; Macfadyen & Addyman 2013) and a previous phase of watching brief (Macfadyen and Morrison 2013) and it was hoped the current works would enhance the record and understanding of the building. Recording of external works commenced with an evaluation (Macfadyen 2013) and was followed in 2017 by archaeological excavations during the extensive ground reduction around the south of the building (Karsgaard 2017).

The monitoring works reported here were undertaken between 23<sup>rd</sup> November and 15<sup>th</sup> December 2016. A record of the building recording (*OASIS ID: addyman1-295135*) has been deposited with the Online Access to the Index of Archaeological Investigations (OASIS) website hosted by the Archaeological Data Service and with *Discovery and Excavation in Scotland* (DES), the annual publication of fieldwork by Archaeology Scotland.

### ii. The present project

To allow the construction of a new entrance foyer to the building the single storey structure infilling the area to the south-east between the south and east jambs was to be removed. This was at least in part probably of 19<sup>th</sup> century construction and built around an earlier external stair tower. Both of these had been heavily truncated down to a single storey in a mid-20<sup>th</sup> century restoration and converted into a basement room with a poured concrete roof. The internal elevations were also concealed behind a brick skin.

The works involved:

1. The breaking out of the concrete slab roof and removal of brick steps to the south-west
2. The removal of the brick skin to expose the original masonry to allow recording prior to demolition
3. Reduction of the lean-to masonry down to ground level. Some masonry was left *in situ* to the east and south to retain the higher ground there; this will be removed latterly following the reduction of the ground
4. The demolition of the stair tower remnant
5. Slapping of a new entrance into Panmure House

### iii. Setting

The now much-reduced Panmure House and its very constricted plot lie between Panmure Close to the west and Lochend Close to the east, behind the frontage buildings of the Canongate to the south. To the north are the converted buildings of a former foundry which lie within the former grounds of the house, as well as some new build housing on the site of a demolished north wing of the building. The site generally slopes down to the north from the Canongate. The site is located at NGR NT 26510 73872.



Figure 1 Site location

## 2. *Method*

The demolitions were undertaken in part by the use of a mini-digger and in part by hand with handheld jackhammers. The opening for the new door was partly sawn through the masonry and the masonry removed by hand with jackhammers down to the concrete of the underpinning below.

## 3. *Demolitions*

### *i. Demolition of concrete slab and brick stairs*

The demolition of the stairs leading up to the ground floor level concrete platform covering the basement showed this to be in part of mid-20<sup>th</sup> century build and mainly of a brick construction, skinned with rubble stone on the exterior (*plate 1*). The upper western half of this was of poured concrete poured over corrugated sheeting and the (earlier) eastern half was a timber shuttered concrete slab. Under the stairs there was an access to the basement. This arrangement mirrored stairs seen in an historic photograph from the 1920s but without the rubble skin and with the western half reduced in height (*plate 2*).

It seems probable that the earlier stairs to the basement were just modified in the mid-20<sup>th</sup> C with the western part reduced to fit the level of the new door opening in the south gable; this required the shifting of the basement steps to the west to fit them below this lower level, involving ground reduction in this area at the gable wall foot.



*Plate 1 Stairs under demolition, showing rubble skin over brick*

These stairs to the basement may be a secondary reordering of the lean-to following the raising of the ground to the south, which put the door in the middle of the wall out of use; the bricks are unlikely to be earlier than the late 19<sup>th</sup> century.





*Plate 2 Historic photo from the 1920s? Shows earlier stair arrangement to the basement at the south gable*

The poured concrete slab of the platform was removed as carefully as possible to avoid damaging the main structure. The concrete was sawn through 0.3m from the wall face and the main part demolished leaving this strip around the edge. This strip was largely supported by the brick skin below in the basement and occasionally tied into the rubble masonry of the main elevations. This tying in was sporadic, appeared unplanned and mostly related to existing voids ie the ceiling joist sockets for the lean-to in the south elevation. The floor was better tied in at the south-east corner of the south jamb, but again this was not very well defined.

This last strip of concrete was carefully removed by hand.

iii. *Demolition of brick skin within basement*

The north east and south elevations in the basement room were obscured by a half brick width skin built out 0.1m from the wall face, thought to be for insulation. This also in part supported the concrete platform above.

This skin broke away easily, exposing the north and east elevations prior to demolition work. The brick against the south wall was intended to be left until after the excavations to the south had been completed and removed with the rest of the masonry there, however much of the brick fell away during works exposing a number of features.

iv. *Reducing lean-to down to ground level*

a *Southern elevation*

The southern elevation was reduced down to the ground level of the exterior. In earlier investigations this part of the wall had appeared to be modern and so it proved to be, mostly work of the mid-20<sup>th</sup> century. Indeed in photographs of works from this phase the wall can be seen heavily reduced to near ground level.

The removal of the later rebuild exposed the remnants of the earlier structure in plan. A door and a splayed window were exposed, both with square rybats (*plates 3 and 4*). These can be seen in historic photos (*plate 2*). Interestingly both of these appear to relate to a much lower exterior ground level (1m below current) perhaps showing evidence for extensive recent ground raising to the south exterior.



*Plate 3 Door exposed on south elevation of lean-to*



*Plate 4 Window exposed on south elevation of lean-to*

The openings had been bricked up with mid-20<sup>th</sup> century cemented brick on the interior face with loose fill to the exterior and infilling the openings.



Plate 5 Interior face of south wall, lean-to shows blocked openings

*b* South eastern corner of lean-to

Cleaning up around the south-east corner exposed two phases of structure and a flue. The earlier phase is represented to the east by a small remnant of clay bonded rubble walling forming the street wall face. This was of similar character to that seen within the south gable of the south jamb and predating the 17<sup>th</sup> century build of Panmure House as revealed in the earlier underpinning works (*figure 2*; Macfadyen and Morrison 2013). This has a square rubble jamb to the north where the walling terminates and was reduced to the south by the mid-20<sup>th</sup> century gate (*plates 6 and 7*).

The square jamb is possibly not a gable return and may be an opening for a door or window. Later disturbance at this corner tying in the masonry of the lean-to building has removed evidence to prove this either way, evidence perhaps survives better further down. But if it was a gable returning to the west for a range to the south, the gable would be roughly in line with the north gable of the early clay bonded range to the west.

The clay bonded range to the west was about 5.30m wide and if this walling represented the eastern elevation or north-east corner of a gable of a similar sized row of cottages there would have been a 3.30m wide alley between them originally.



Plate 6 Vertical jamb at end of clay masonry to west under excavation. Lime bonded masonry of lean-to formerly abutting to right



Plate 7 Vertical jamb at end of clay masonry



Figure 2: Plan showing pre-Panmure House clay-bonded walls in red, with conjectural extensions to south and flue in south-east corner. A3 drawings in Appendix B

The later phase relates to construction of the lean-to, which was built from lime-bonded rubble. In addition to the door and window to the west there was evidence for a fire in the south-east corner. This was represented by an approximately 0.30m square flue infilled with soot and a little lime mortar (figure 2; plate 8).

Noted within the flue was a metal flue damper *in situ* and still slightly open (plate 9); the handle for this was also still *in situ*, although bent flat with the wall face. Above this flue damper the flue was built up from an iron bar/lintel with brick on the internal wall face (plate 10). Below the damper there was no obvious fireplace within the masonry although a couple of blackened bricks appeared to be patching up a small opening. It is thought perhaps to have been a freestanding stove with a flue running into the wall or a very small fireplace.



*Plate 8 South elevation of lean-to, shows flue at east end (top)*



*Plate 9 South elevation of lean-to detail of flue emptied shows flue damper in situ and partially open*



*Plate 10 Wall face of flue shows damper handle (bent over) and bricked up opening below?*

*c Eastern elevation*

Prior to works commencing this elevation was thought to represent an earlier boundary wall that was built over by the 17<sup>th</sup> century building of Panmure House, however with the heavy cement pointing and later interventions this was not entirely clear.

Following monitoring of the demolition the masonry is better understood. The demolished part was mainly of one build and most likely related to the lean-to construction. However with the stub of earlier clay bonded masonry to the south and the evidence for earlier masonry below the eastern gable of Panmure House, it seems likely that the lean-to construction has replaced some earlier masonry. This was perhaps clay bonded and in poor condition or not strong enough to carry the new build of the lean-to and needed to be replaced between the jamb/gable return of the clay bonded masonry to the south and the corner of Panmure House.

*v. The demolition of the stair tower remnant*

This was a rectangular structure constructed in the re-entrant angle of the south and east jambs of Panmure House, which formerly contained a stair to the upper floors of the house (*plate 11*). That the stairs are not an original feature can be seen where the masonry of the tower overlies and is partly built into former exterior windows of the house. A3 drawings can be seen in *Appendix B*.

To the west the masonry is built into window 171 and to the north the masonry abuts rubble infill of the window 166 (Macfadyen & Addyman 2013).



*Plate 11 Stair tower remnant as exposed following demolition of concrete roof*

The stairs were accessed at ground level from the east through a door offset to the south and lit from a window to the north (*figure 3*); the south elevation was blank. Much of the rubble within the construction is likely to be reused from an earlier structure as many of the blocks are squared and some have had mouldings clawed back flush.

The former lintel of the door had been replaced with iron lintels in the mid-20<sup>th</sup> century works, the internal lintel had been painted with the inscription “Chapel of St Michael” (plate 12).



Plate 12 Iron door lintel inscribed with "Chapel of St Michael"

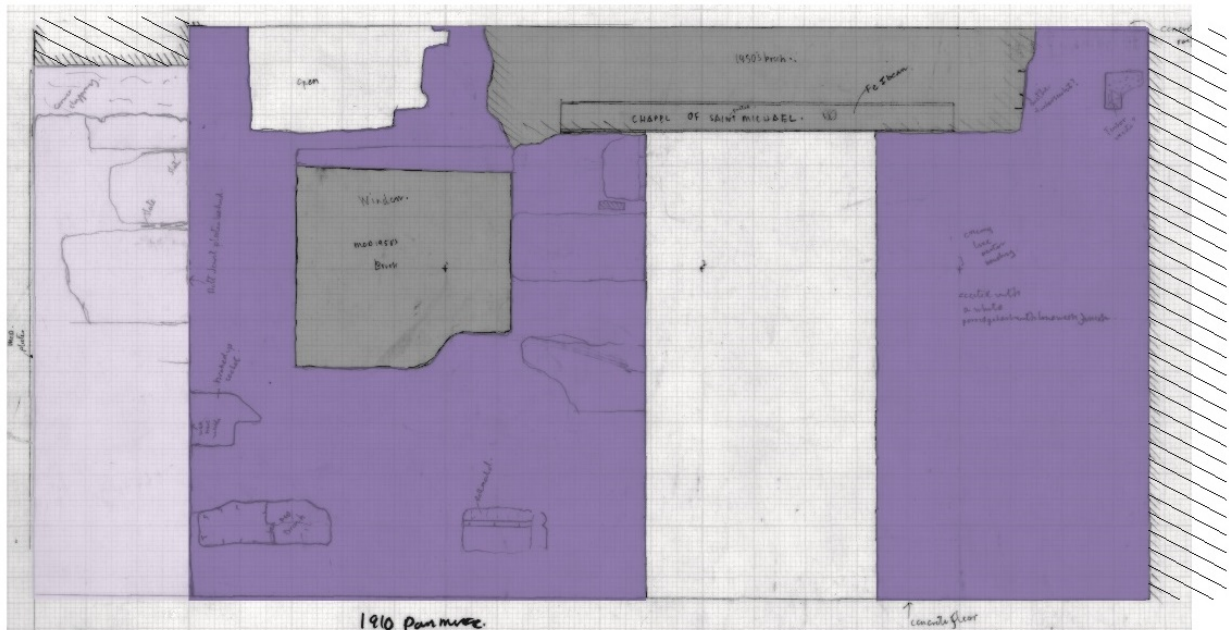

Figure 3: Eastern elevation of remnant stair tower with original masonry to left, possible secondary interventions in purple and 20<sup>th</sup> century alterations in grey

The removal of the tower masonry exposed some former historic exterior harl of Panmure House. To the west this was noted in a small area below the window 171 and is potentially early. To the north the exposed harl is overlying rubble blocking of the window 166 indicating that this harl relates to a secondary phase (plates 13 and 14). The harling over the blocking of the window also shows that it was blocked up prior to the stair tower and lean-to phases.

The internal of the south and south part of the east elevation had a coating of what appeared to be external porridge harl surviving in part; nowhere else on the stair tower was any harl noted so it is unclear why it remains here.



Plate 13 Stair tower demolished showing tower masonry built into window 171 with a little historic harl in situ below the window



Plate 14 Stair tower demolished showing tower masonry built over blocking of window 166 and survival of former historic harl

#### vi. *Slapping of a new entrance into Panmure House*

As part of the new extension a new access door was slapped through the south elevation of the east jamb of Panmure House. This was roughly central to the elevation and required the complete removal of the middle window at basement level.

Prior to the slapping taking place holes needed to be cut through the masonry to fit structural propping for the elevation above; two holes at ground level and four above were cut. These took a while as the masonry proved to be harder than originally envisioned.

The outline of the opening was cut by a saw to attempt a neat edge through the rubble masonry. First the rubble blocking of the window was removed; this proved to be a 0.20-0.25m thick skin of lime bonded rubble stone on the exterior originally leaving the bulk of the window in situ as a recess on the interior. This recess was infilled with an internal brick skin and filled with poured concrete and broken brick and rubble in the works of the mid 20<sup>th</sup> century (*plates 15 and 16*).





*Plate 15 Window exterior rubble blocking removed exposing back of modern infill*



*Plate 16 Window fully opened up shows west jamb*

Following opening up of the window a number of features were uncovered. The window had three vertical square bars diamond set; the historic removal of these had badly damaged the cill but the three sockets still survived. On the lintel only one socket survived as a large amount of the lintel had been removed for a joist socket for the lean-to building.

On the lintel remnant there was an apparent glazing groove running behind the bar socket; this did not continue onto the jambs or cill and may indicate the lintel was reused from an earlier window (*plates 17 and 18*).

The outline of the window case was also seen as on the cill and jambs; this was about 80mm deep and a remnant mortar fillet running up to it survived.



Plate 17 Window cill showing imprint of window case and 3 bar holes



Plate 18 View up to lintel remnant, shows imprint of window case, one bar hole and a possible glazing groove

Upon the exposed ingos some historic plaster on the hard had survived (*plates 19 and 20*). This showed many episodes of lime wash of variable light colours. This plaster was of two phases with the earlier solidly plastered to the masonry and coated with multiple layers of lime wash. This original phase was overlain by a thin skim coat, again with multiple layers of lime wash. This later plaster peeled away from the earlier cleanly and easily; both layers were sampled.

Following recording of the window details the demolition started of the new opening; this was undertaken by hand with powered jackhammers. The masonry proved to be a lot tougher to break out than originally thought but eventually the masonry was removed down to the top of the underpinning below, ready for the new brick jambs to be constructed.

Some of the window jamb stones were recovered largely intact while others needed to be broken up to get them to come out. These recovered jamb stones allowed an examination of the tooling of the internal faces (*plate 21*). The tooling was of a broad chisel characteristic of the 17<sup>th</sup> century; no mason's marks were noted.



*Plate 19 East ingo of window showing plaster in situ*



*Plate 20 Plaster on ingo showing 2 phases*



*Plate 21 Underside of jamb stone from window detail of tooling*

### 3. Conclusion

The monitoring of the demolition works has added some more details to the history of the structure of Panmure House. This includes the exposure of three windows in the south elevation of the basement, one previously known about and two formerly suspected and now confirmed. These were blocked up historically prior to the construction of the stair tower. The construction of the tower has preserved some historic exterior harl trapped behind the stair.

The demolition of the lean-to structure confirmed the layout as seen in historic photos and suggests that the ground to the south has been raised considerably since its construction. A previously unknown early clay bonded structure potentially similar to the one fossilised in the south gable of Panmure House was identified as a small stub of masonry with corner quoining, also fossilised within the east boundary wall. The layout of the wall and its relationship with that below the southern gable of Panmure House, suggests that these represent two rows of cottages within the burgage plots, separated by a narrow alley. This corresponds well to the layout of burgage plots in the area (*figure 4*).

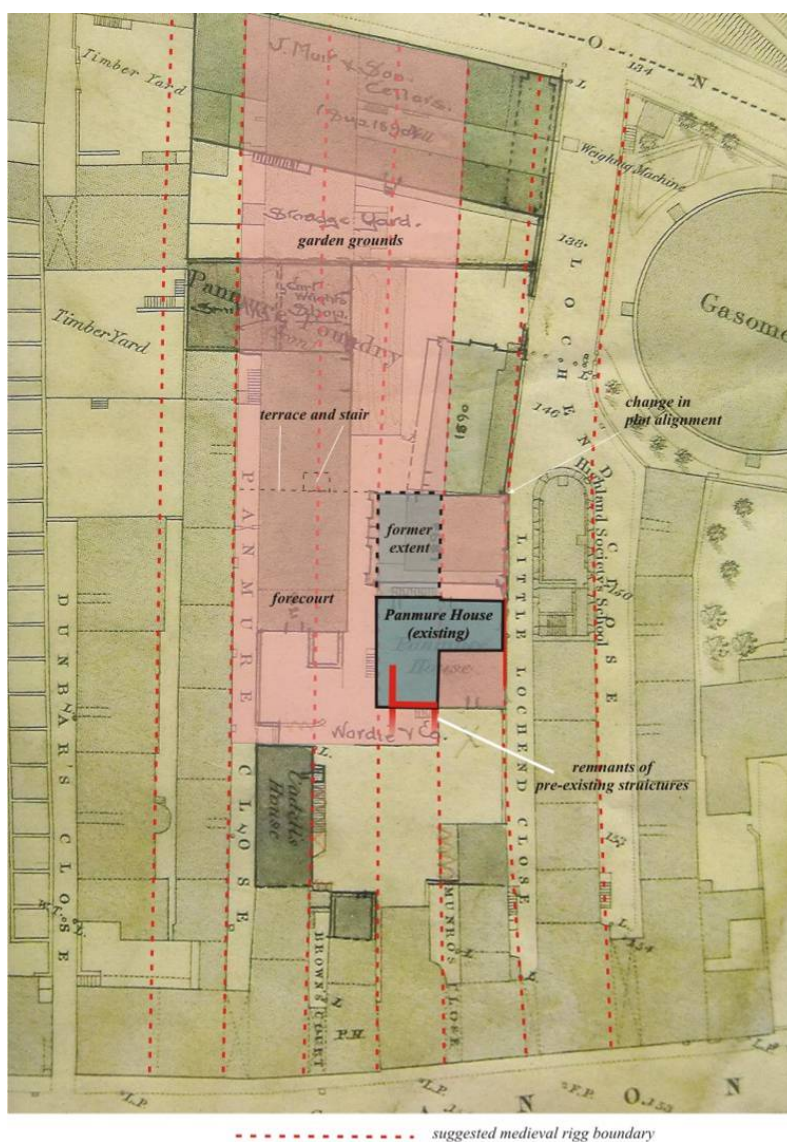

Figure 4 Ordnance Survey town map of 1852, with subsequent annotation of c1890 for proposed new buildings (City of Edinburgh Council, Dean of Guild records). Superimposed is a collation of evidence from earlier maps. The clay-bonded walls found during the archaeological works are shown in red.

#### 4. *References*

Addyman Archaeology 2011 *Panmure House. Analytical and Historical Appraisal of the House and Its Urban Context*. Addyman Archaeology unpublished report.

Karsgaard, P 2017 *Panmure House. Archaeological Excavation*. Addyman Archaeology unpublished report.

Macfadyen, K 2013 *Panmure House. Archaeological Evaluation: Data Structure Report*. Unpublished report.

Macfadyen, K & Addyman, T 2015 *Panmure House. Historic Building Survey and Analytical Assessment*. Addyman Archaeology, unpublished report.

Macfadyen, K & Morrison, A 2013 *Panmure House. Archaeological Watching Brief: Works Related to Underpinning, October – December 2013*. Addyman Archaeology, unpublished report.

## Appendix A Photographic register

Photo No	Direction facing	Date	Description	Taken By
1000	E	23/11/2016	Demolished Courtyard range south wall as left	Kmacf
1001	E	23/11/2016	Demolished Courtyard range , east street front following removal of the concrete slab roof in the extension	Kmacf
1002	N	23/11/2016	Demolished Courtyard range, north elevation following demolition of concrete slab roof	Kmacf
1003	NW	23/11/2016	Demolished Courtyard range, remnant of stairwell as exposed in demolitions	Kmacf
1004	W	23/11/2016	Demolished Courtyard range, remnant of stairwell as exposed in demolition	Kmacf
1005	V	23/11/2016	Demolished Courtyard range, south wall door jamb first seen	Kmacf
1006	NE	23/11/2016	Demolished Courtyard range, stairs down to basement under demolition	Kmacf
1007	SW	23/11/2016	SW corner of site showing modern wall prior to demolition	Kmacf
1008	W	23/11/2016	East exterior of demolished range, shows remnant of east wall pre final demolition. Blocked door	Kmacf
1008	W	23/11/2016	East exterior of demolished range, shows remnant of east wall pre final demolition. Slapped window	Kmacf
1009	W	23/11/2016	East exterior of demolished range, shows remnant of east wall pre final demolition. Butt joint to south	Kmacf
1010	W	23/11/2016	East exterior of demolished range, shows remnant of east wall pre final demolition. Butt joint to south	Kmacf
1011	NW	23/11/2016	Panmure house from SE works in progress	Kmacf
1012	W	23/11/2016	Demolished Courtyard range, remnant of stairwell as exposed in demolitions, east elevation	Kmacf
1013	W	23/11/2016	Demolished Courtyard range, remnant of stairwell as exposed in demolitions, east elevation	Kmacf
1014	W	23/11/2016	Demolished Courtyard range, remnant of stairwell as exposed in demolitions, east elevation	Kmacf
1015	W	23/11/2016	Demolished Courtyard range, remnant of stairwell as exposed in demolitions, east elevation, window	Kmacf
1016	W	23/11/2016	Demolished Courtyard range, remnant of stairwell as exposed in demolitions, east elevation, door	Kmacf
1017	W	23/11/2016	Demolished Courtyard range, remnant of stairwell as exposed in demolitions, east elevation, door	Kmacf
1018	W	23/11/2016	Demolished Courtyard range, remnant of stairwell as exposed in demolitions, east elevation, door	Kmacf
1019	NW	23/11/2016	Demolished Courtyard range, remnant of stairwell as exposed in demolitions, south elevation	Kmacf
1020	NW	23/11/2016	Demolished Courtyard range, remnant of stairwell as exposed in demolitions, general view	Kmacf
1021	NW	23/11/2016	Demolished Courtyard range, remnant of stairwell as exposed in demolitions, general view	Kmacf
1022	NW	23/11/2016	Demolished Courtyard range, remnant of stairwell as exposed in demolitions, general view	Kmacf
1023	SW	23/11/2016	Demolished Courtyard range, remnant of stairwell as exposed in demolitions, south interior	Kmacf
1024	N	23/11/2016	Demolished Courtyard range, remnant of stairwell as exposed in demolitions, south elevation exterior	Kmacf
1025	NW	23/11/2016	Demolished Courtyard range, remnant of stairwell as exposed in demolitions, general view	Kmacf
1026	NW	23/11/2016	Demolished Courtyard range, remnant of stairwell as exposed in demolitions, general view	Kmacf
1027	N	23/11/2016	Demolished Courtyard range, remnant of stairwell as exposed in demolitions, view along east wall head	Kmacf
1028	N	23/11/2016	Demolished Courtyard range, remnant of stairwell as exposed in demolitions, general view of girders over	Kmacf
1029	W	23/11/2016	Demolished Courtyard range, remnant of stairwell as exposed in demolitions, east elevation	Kmacf
1030	W	23/11/2016	Demolished Courtyard range, remnant of stairwell as exposed in demolitions, east elevation	Kmacf
1031	W	23/11/2016	Demolished Courtyard range, remnant of stairwell as exposed in demolitions, east elevation	Kmacf
1032	NW	24/11/2016	Demolished Courtyard range, east elevation, but joint between clay bonded masonry to south and lime bonded to north	Kmacf
1033	NW	24/11/2016	Demolished Courtyard range, east elevation, but joint between clay bonded masonry to south and lime bonded to north	Kmacf
1034	NW	24/11/2016	Demolished Courtyard range, east elevation, but joint between clay bonded masonry to south and lime bonded to north	Kmacf
1035	E	24/11/2016	Demolished Courtyard range, east elevation, but joint between clay bonded masonry to south and lime bonded to north	Kmacf
1036	W	24/11/2016	Demolished Courtyard range, east elevation	Kmacf
1037	W	24/11/2016	Demolished Courtyard range, east elevation	Kmacf
1038	W	24/11/2016	Demolished Courtyard range, east elevation	Kmacf
1039	W	24/11/2016	Demolished Courtyard range, east elevation	Kmacf
1040	W	24/11/2016	Demolished Courtyard range, east elevation	Kmacf
1041	NW	24/11/2016	Demolished Courtyard range, view within once cleared	Kmacf
1402	NW	24/11/2016	Demolished Courtyard range, view within once cleared	Kmacf
1043	E	24/11/2016	Demolished Courtyard range, east elevation of basement pre demolition	Kmacf

<b>Photo No</b>	<b>Direction facing</b>	<b>Date</b>	<b>Description</b>	<b>Taken By</b>
1044	N	24/11/2016	Demolished Courtyard range, north wall shows removed concrete slab roof tied into the former floor joist sockets	Kmacf
1045	E	24/11/2016	Demolished Courtyard range, east elevation of basement pre demolition	Kmacf
1046	E	24/11/2016	Demolished Courtyard range, east elevation of basement pre demolition	Kmacf
1047	E	24/11/2016	Demolished Courtyard range, east elevation of basement pre demolition	Kmacf
1048	E	24/11/2016	Demolished Courtyard range, east elevation of basement pre demolition	Kmacf
1049	E	24/11/2016	Demolished Courtyard range, east elevation of basement pre demolition	Kmacf
1050	E	24/11/2016	Demolished Courtyard range, east elevation of basement pre demolition	Kmacf
1051	E	24/11/2016	Demolished Courtyard range, east elevation of basement pre demolition	Kmacf
1052	E	24/11/2016	Demolished Courtyard range, east elevation of basement pre demolition	Kmacf
1053	E	24/11/2016	Demolished Courtyard range, east elevation of basement pre demolition	Kmacf
1054	E	24/11/2016	Demolished Courtyard range, east elevation of basement under demolition	Kmacf
1055	E	24/11/2016	Demolished Courtyard range, east elevation of basement under demolition, shows modern slapped window in middle	Kmacf
1056	E	24/11/2016	Demolished Courtyard range, east elevation of basement under demolition, shows modern slapped window in middle	Kmacf
1057	N	24/11/2016	Demolished Courtyard range, east elevation of basement under demolition, shows view up wall core following part removal of modern slapped window	Kmacf
1058	S	24/11/2016	Demolished Courtyard range, east elevation of basement under demolition, shows quoining of the southern clay bonded wall exposed	Kmacf
1059	SW	24/11/2016	Demolished Courtyard range, east elevation of basement under demolition, shows quoining of the southern clay bonded wall exposed	Kmacf
1060		24/11/2016	-	Kmacf
1061	N	24/11/2016	Demolished Courtyard range, east elevation of basement under demolition, shows wall core to the north approaching the north door	Kmacf
1062	W	24/11/2016	Demolished Courtyard range, east elevation of basement under demolition, shows door to the north with timber lintel above	Kmacf
1063	NW	24/11/2016	Demolished Courtyard range, east elevation of basement under demolition, shows wall core of blocking of the north door and lintel over	Kmacf
1064	N	24/11/2016	Demolished Courtyard range, east elevation of basement under demolition, shows wall core of blocking of the north door and lintel over	Kmacf
1065	V	24/11/2016	Demolished Courtyard range, east elevation of basement under demolition, detail of recovered timber plank lintel	Kmacf
1066	NW	24/11/2016	Demolished Courtyard range, stair tower reused stone with margin clawed back	Kmacf
1067	N	24/11/2016	Demolished Courtyard range, east elevation of basement under demolition, shows wall core of blocking of the north door	Kmacf
1068	N	24/11/2016	Demolished Courtyard range, east elevation of basement under demolition, shows wall core of blocking of the north door	Kmacf
1069	NW	24/11/2016	Demolished Courtyard range, east elevation of basement under demolition, shows wall core of blocking of the north door	Kmacf
1070	W	24/11/2016	Demolished Courtyard range, east elevation of basement under demolition, shows wall core of blocking of the north door	Kmacf
1071	SW	24/11/2016	Demolished Courtyard range, south elevation part exposed showing blocked window and door	Kmacf
1072	V	24/11/2016	Demolished Courtyard range, south elevation detail of door in plan	Kmacf
1073	V	24/11/2016	Demolished Courtyard range, south elevation detail of door in plan	Kmacf
1074	V	24/11/2016	Demolished Courtyard range, south elevation detail of window in plan	Kmacf
1075	V	24/11/2016	Demolished Courtyard range, south elevation detail of window in plan	Kmacf
1076	V	24/11/2016	Demolished Courtyard range, south elevation detail of window in plan	Kmacf
1077	W	24/11/2016	Demolished Courtyard range, south elevation general view along wall head	Kmacf
1078	E	24/11/2016	Demolished Courtyard range, south elevation general view along wall head	Kmacf
1079	S	24/11/2016	Demolished Courtyard range, south elevation , blocked door	Kmacf
1080	S	24/11/2016	Demolished Courtyard range, south elevation , blocked door	Kmacf
1081	S	24/11/2016	Demolished Courtyard range, south elevation , blocked door	Kmacf
1082	S	24/11/2016	Demolished Courtyard range, south elevation ,	Kmacf
1083	S	24/11/2016	Demolished Courtyard range, south elevation , blocked window	Kmacf
1084	S	24/11/2016	Demolished Courtyard range, south elevation , west end with jamb stones	Kmacf
1085	S	24/11/2016	Demolished Courtyard range, south elevation , west end with jamb stones	Kmacf
1086	NW	25/11/2016	Demolished Courtyard range, stair tower demolition	PK
1087	NW	25/11/2016	Demolished Courtyard range, stair tower demolition	PK
1088	W	25/11/2016	Demolished Courtyard range, stair tower demolition	PK
1089	NW	25/11/2016	East Jamb, south elevation following removal of brick skin exposing windows and door	PK
1090	V	25/11/2016	painted girder, chapel of St Michael	PK

<b>Photo No</b>	<b>Direction facing</b>	<b>Date</b>	<b>Description</b>	<b>Taken By</b>
1091	V	25/11/2016	Painted girder, chapel of st Michael	PK
1092	V	25/11/2016	Painted girder, chapel of st Michael	PK
1093	V	25/11/2016	Painted girder, chapel of st Michael	PK
1094	V	25/11/2016	Painted girder, chapel of st Michael	PK
1095	V	25/11/2016	Painted girder, chapel of st Michael	PK
1096	V	25/11/2016	Painted girder, chapel of st Michael	PK
1097	NW	25/11/2016	East Jamb, south elevation following removal of brick skin exposing windows and door	PK
1098	NE	25/11/2016	East Jamb, south elevation following removal of brick skin exposing windows and door	PK
1099	N	25/11/2016	East Jamb, south elevation following removal of brick skin exposing windows and door	PK
1100	N	25/11/2016	East Jamb, south elevation following removal of brick skin exposing windows and door	PK
1101	N	25/11/2016	East Jamb, south elevation following removal of brick skin exposing windows and door	PK
1102	N	25/11/2016	East Jamb, south elevation following removal of brick skin exposing windows and door	PK
1103	N	25/11/2016	East Jamb, south elevation following removal of brick skin exposing windows and door	PK
1104	N	25/11/2016	East Jamb, south elevation following removal of brick skin exposing windows and door	PK
1105	N	25/11/2016	East Jamb, south elevation following removal of brick skin exposing windows and door	PK
1106	N	25/11/2016	East Jamb, south elevation following removal of brick skin exposing windows and door	PK
1107	N	25/11/2016	East Jamb, south elevation following removal of brick skin exposing windows and door	PK
1108	N	25/11/2016	East Jamb, south elevation following removal of brick skin exposing windows and door	PK
1109	N	25/11/2016	East Jamb, south elevation detail of western window	PK
1110	N	25/11/2016	East Jamb, south elevation detail of western window	PK
1111	N	25/11/2016	East Jamb, south elevation detail of western window	PK
1112	N	25/11/2016	East Jamb, south elevation detail of western window	PK
1113	N	25/11/2016	East Jamb, south elevation detail of western window	PK
1114	N	25/11/2016	East Jamb, south elevation detail of western window	PK
1115	N	25/11/2016	East Jamb, south elevation detail of western window	PK
1116	N	25/11/2016	East Jamb, south elevation detail of western window	PK
1117	N	25/11/2016	East Jamb, south elevation detail of western window	PK
1118	N	25/11/2016	East Jamb, south elevation detail of western window	PK
1119	N	25/11/2016	East Jamb, south elevation detail of floor joist sockets	PK
1120	NE	25/11/2016	East Jamb, south elevation detail of mid window and joist sockets above	PK
1121	N	25/11/2016	East Jamb, south elevation detail of mid window	PK
1122	N	25/11/2016	East Jamb, south elevation detail of mid window	PK
1123	N	25/11/2016	East Jamb, south elevation detail of mid window	PK
1124	NE	25/11/2016	East Jamb, south elevation detail of mid window	PK
1125	NE	25/11/2016	East Jamb, south elevation detail of mid window	PK
1126	N	25/11/2016	East Jamb, south elevation detail of eastern window, slapped into door	PK
1127	NW	25/11/2016	East Jamb, south elevation detail of eastern window, slapped into door	PK
1128	NW	25/11/2016	East Jamb, south elevation detail of eastern window, slapped into door	PK
1129	NW	25/11/2016	East Jamb, south elevation detail of eastern window, slapped into door	PK
1130	NW	25/11/2016	East Jamb, south elevation detail of eastern window, slapped into door	PK
1131	NW	25/11/2016	East Jamb, south elevation detail of eastern window, slapped into door	PK
1132	NW	25/11/2016	East Jamb, south elevation detail of eastern window, slapped into door	PK
1133	NE	25/11/2016	East Jamb, south elevation detail of eastern window, slapped into door	PK
1134	NE	25/11/2016	East Jamb, south elevation detail of eastern window, slapped into door	PK
1135	NE	25/11/2016	East Jamb, south elevation detail of eastern window, slapped into door	PK
1136	NE	25/11/2016	East Jamb, south elevation detail of eastern window, slapped into door	PK
1137	NE	25/11/2016	East Jamb, south elevation detail of eastern window, slapped into door	PK
1138	N	25/11/2016	East Jamb, south elevation detail of eastern window, slapped into door	PK
1139	N	25/11/2016	East Jamb, south elevation detail of eastern window, slapped into door	PK
1140	N	25/11/2016	East Jamb, south elevation detail of eastern window, slapped into door	PK
1141	N	25/11/2016	East Jamb, south elevation detail of eastern window, slapped into door	PK
1142	N	25/11/2016	East Jamb, south elevation detail of eastern window, slapped into door	PK
1143	NE	25/11/2016	East Jamb, south elevation NE corner shows damage around downpipe	PK
1144	NE	25/11/2016	East Jamb, south elevation NE corner shows damage around downpipe	PK
1145	N	25/11/2016	East Jamb, south elevation NE corner shows damage around downpipe	PK
1146	NE	25/11/2016	East Jamb, south elevation NE corner shows damage around downpipe	PK
1147	N	25/11/2016	East Jamb, south elevation, basement general view	PK
1148	NW	25/11/2016	East Jamb, south elevation detail of eastern window, slapped into door	PK
1149	NW	25/11/2016	East Jamb, south elevation detail of eastern window, slapped into door	PK



Photo No	Direction facing	Date	Description	Taken By
1150	N	25/11/2016	East Jamb, south elevation detail of socket? To west	PK
1151	N	25/11/2016	East Jamb, south elevation detail of blocked socket? To west	PK
1152	NE	25/11/2016	East Jamb, south elevation detail of blocked socket? To west	PK
1153	NW	25/11/2016	East Jamb, south elevation detail of blocked socket? To west	PK
1154	NW	25/11/2016	East Jamb, south elevation detail of eastern window, slapped into door	PK
1155	NW	25/11/2016	East Jamb, south elevation detail of eastern window, slapped into door	PK
1156	N	25/11/2016	East Jamb, south elevation general view	PK
1157	N	25/11/2016	East Jamb, south elevation general view	PK
1158	S	25/11/2016	Demolished Courtyard range, south elevation , blocked door	PK
1159	S	25/11/2016	Demolished Courtyard range, south elevation , blocked window	PK
1160	S	25/11/2016	Demolished Courtyard range, south elevation	PK
1161	S	25/11/2016	Demolished Courtyard range, south elevation	PK
1162	S	25/11/2016	Demolished Courtyard range, south elevation	PK
1163	N	07/12/2016	East Jamb, south elevation , following removal of stair tower exposing early harl	Kmacf
1164	N	07/12/2016	East Jamb, south elevation , following removal of stair tower exposing early harl	Kmacf
1165	W	07/12/2016	west jamb, east elevation , following removal of stair tower exposing early harl	Kmacf
1166	W	07/12/2016	west jamb, east elevation , following removal of stair tower exposing early harl	Kmacf
1167	W	07/12/2016	west jamb, east elevation , following removal of stair tower exposing early window	Kmacf
1168	NW	07/12/2016	junction between west and east jambs showing east to abut the west trapping wall plaster/render	Kmacf
1169	NE	07/12/2016	East Jamb, south elevation , following removal of stair tower exposing early harl	Kmacf
1170	NW	07/12/2016	junction between west and east jambs showing east to abut the west trapping wall plaster/render	Kmacf
1172	SW	12/12/2016	East Jamb, south elevation, interior of mid window pre slapping	Kmacf
1171	S	12/12/2016	East Jamb, south elevation, interior of mid window pre slapping	Kmacf
1172	S	12/12/2016	East Jamb, south elevation, interior of mid window pre slapping	Kmacf
1173	S	12/12/2016	East Jamb, south elevation, interior of mid window pre slapping	Kmacf
1174	S	12/12/2016	East Jamb, south elevation, interior of mid window pre slapping	Kmacf
1175	S	12/12/2016	East Jamb, south elevation, interior of mid window pre slapping	Kmacf
1176	E	12/12/2016	East Jamb, east elevation, interior showing sprayed on cement?	Kmacf
1177	E	12/12/2016	East Jamb, east elevation, interior showing sprayed on cement?	Kmacf
1178	V	12/12/2016	Demolished Courtyard range, south elevation, chimney flue to east pre excavation	Kmacf
1179	V	12/12/2016	Demolished Courtyard range, south elevation, chimney flue to east pre excavation	Kmacf
1180	V	12/12/2016	Demolished Courtyard range, south elevation, chimney flue to east pre excavation	Kmacf
1181	V	12/12/2016	Demolished Courtyard range, south elevation, chimney flue to east pre excavation	Kmacf
1182	V	12/12/2016	Demolished Courtyard range, south elevation, chimney flue to east pre excavation	Kmacf
1183	S	12/12/2016	Demolished Courtyard range, south elevation, chimney flue to east as seen on wall face, shows iron plate and handle for flue damp	Kmacf
1184	S	12/12/2016	Demolished Courtyard range, south elevation, chimney flue to east as seen on wall face, shows iron plate and handle for flue damp	Kmacf
1185	SE	12/12/2016	Demolished Courtyard range, south elevation, chimney flue to east as seen on wall face, shows iron plate and handle for flue damp	Kmacf
1186	S	12/12/2016	Demolished Courtyard range, south elevation, chimney flue to east as seen on wall face, shows iron plate and handle for flue damp	Kmacf
1187	S	12/12/2016	Demolished Courtyard range, south elevation, chimney flue to east as seen on wall face, shows iron plate and handle for flue damp	Kmacf
1188	NE	12/12/2016	west jamb south elevation, brick stairs removed	Kmacf
1189	N	12/12/2016	west jamb south elevation, brick stairs removed	Kmacf
1190	N	12/12/2016	west jamb south elevation, brick stairs removed	Kmacf
1191	N	12/12/2016	west jamb south elevation, brick stairs removed	Kmacf
1192	N	12/12/2016	west jamb south elevation, brick stairs removed	Kmacf
1193	N	12/12/2016	west jamb south elevation, brick stairs removed	Kmacf
1194	N	12/12/2016	west jamb south elevation, brick stairs removed	Kmacf
1195	N	12/12/2016	west jamb south elevation, brick stairs removed	Kmacf
1196	N	12/12/2016	west jamb south elevation, west boundary wall removed	Kmacf
1197	E	12/12/2016	Demolished Courtyard range, south elevation, chimney flue and window	Kmacf
1198	V	12/12/2016	Demolished Courtyard range, south elevation, chimney flue and window	Kmacf
1199	V	12/12/2016	Demolished Courtyard range, south elevation, chimney flue and window	Kmacf
1200	V	12/12/2016	Demolished Courtyard range, south elevation, chimney flue and window	Kmacf
1201	V	12/12/2016	Demolished Courtyard range, south elevation, chimney flue and window	Kmacf
1202	W	12/12/2016	Demolished Courtyard range, south elevation, chimney flue and window	Kmacf
1203	NW	15/12/2016	East Jamb, south elevation, mid window blocking part removed, west jamb	Kmacf

Photo No	Direction facing	Date	Description	Taken By
1204	NE	15/12/2016	East Jamb, south elevation, mid window blocking part removed, east jamb	Kmacf
1205	V	15/12/2016	East Jamb, south elevation, mid window blocking part removed, view up to lintel, shows bar hole and possible glazing groove and imprint of window case in mortar	Kmacf
1206	V	15/12/2016	East Jamb, south elevation, mid window blocking part removed, view up to lintel, shows bar hole and possible glazing groove and imprint of window case in mortar	Kmacf
1207	NW	15/12/2016	East Jamb, south elevation, mid window blocking part removed, west jamb	Kmacf
1208	NE	15/12/2016	East Jamb, south elevation, mid window blocking part removed, east jamb	Kmacf
1209	SE	15/12/2016	East Jamb, south elevation, mid window blocking pre removal on interior	Kmacf
1210	V	15/12/2016	East Jamb, south elevation, mid window blocking removed, detail of cill	Kmacf
1211	V	15/12/2016	East Jamb, south elevation, mid window blocking removed, detail of cill	Kmacf
1212	V	15/12/2016	East Jamb, south elevation, mid window blocking part removed, view up to lintel	Kmacf
1213	V	15/12/2016	East Jamb, south elevation, mid window blocking part removed, view up to lintel	Kmacf
1214	NW	15/12/2016	East Jamb, south elevation, mid window blocking removed, west jamb and Ingo	Kmacf
1215	NE	15/12/2016	East Jamb, south elevation, mid window blocking removed, east jamb and Ingo	Kmacf
1216	SE	15/12/2016	East Jamb, south elevation, mid window blocking removed, east jamb and Ingo	Kmacf
1217	SE	15/12/2016	East Jamb, south elevation, mid window blocking removed, east jamb and Ingo	Kmacf
1218	SW	15/12/2016	East Jamb, south elevation, mid window blocking removed, west jamb and Ingo	Kmacf
1219	SW	15/12/2016	East Jamb, south elevation, mid window blocking removed, west jamb and Ingo	Kmacf
1220	SW	15/12/2016	East Jamb, south elevation, mid window blocking removed, west jamb Ingo with early plaster in situ	Kmacf
1221	E	15/12/2016	East Jamb, south elevation, mid window blocking removed, east Ingo with early plaster in situ	Kmacf
1222	E	15/12/2016	East Jamb, south elevation, mid window blocking removed, east Ingo with early plaster in situ, 2 layers visible	Kmacf
1223	NE	15/12/2016	East Jamb, south elevation, mid window blocking removed, east Ingo with early plaster in situ, 2 layers visible	Kmacf
1224	V	15/12/2016	East Jamb, south elevation, mid window blocking removed, view up to lintel	Kmacf
1225	V	15/12/2016	East Jamb, south elevation, mid window blocking removed, detail of cill	Kmacf
1226	E	15/12/2016	East Jamb, south elevation, mid window blocking removed, east Ingo from interior	Kmacf
1227	SE	15/12/2016	East Jamb, south elevation, mid window blocking removed, east Ingo from interior	Kmacf
1228	NE	15/12/2016	East Jamb, south elevation, mid window blocking removed, east jamb general view	Kmacf
1229	NW	15/12/2016	East Jamb, south elevation, mid window blocking removed, west jamb general view	Kmacf
1230	N	15/12/2016	East Jamb, south elevation, mid window blocking removed, east Ingo with early plaster in situ, 2 layers visible, upper one peeling away	Kmacf
1231	N	15/12/2016	East Jamb, south elevation, mid window blocking removed, east Ingo with early plaster in situ, 2 layers visible, upper one peeling away	Kmacf
1232	N	15/12/2016	East Jamb, south elevation, mid window blocking removed, east Ingo with early plaster in situ,, upper one removed exposing lower	Kmacf
1233	W	15/12/2016	East Jamb, south elevation, west jamb removed shows wall core	Kmacf
1234	W	15/12/2016	East Jamb, south elevation, west jamb removed shows wall core	Kmacf
1235	N	15/12/2016	East Jamb, south elevation, west jamb removed shows wall core	Kmacf
1236		15/12/2016	East Jamb, south elevation, west jamb stone recovered, detail of tooling on base	Kmacf
1237		15/12/2016	East Jamb, south elevation, west jamb stone recovered, detail of tooling on top	Kmacf
1238		15/12/2016	East Jamb, south elevation, west jamb stone recovered, detail of tooling on base	Kmacf
1239		15/12/2016	East Jamb, south elevation, west jamb stone recovered, general view	Kmacf
1240		15/12/2016	East Jamb, south elevation, west jamb stone recovered, general view	Kmacf
1241	N	15/12/2016	East Jamb, south elevation, wall core with bit of rotten timber within	Kmacf
1242	N	15/12/2016	East Jamb, south elevation, wall core with bit of rotten timber within	Kmacf
1243	N	15/12/2016	East Jamb, south elevation, general view of exterior showing slapping	Kmacf
1244	N	15/12/2016	East Jamb, south elevation, general view of exterior showing slapping	Kmacf
1245	V	15/12/2016	Demolished Courtyard range, south elevation, chimney flue half sectioned though soot exposing flue damper	Kmacf
1246	N	15/12/2016	Demolished Courtyard range, south elevation, chimney flue half sectioned though soot exposing flue damper	Kmacf
1247	V	15/12/2016	Demolished Courtyard range, south elevation, chimney flue emptied exposing flue damper	Kmacf
1248	V	15/12/2016	Demolished Courtyard range, south elevation, chimney flue emptied exposing flue damper	Kmacf
1249	V	15/12/2016	Demolished Courtyard range, south elevation, chimney flue emptied exposing flue damper	Kmacf
1250	E	15/12/2016	Demolished Courtyard range, south elevation, chimney flue emptied exposing flue damper, and flue side	Kmacf
1251	W	15/12/2016	Demolished Courtyard range, south elevation, chimney flue emptied exposing flue damper, and flue side	Kmacf
1252	V	15/12/2016	Demolished Courtyard range, south elevation, chimney flue emptied exposing flue damper	Kmacf

<b>Photo No</b>	<b>Direction facing</b>	<b>Date</b>	<b>Description</b>	<b>Taken By</b>
1253	SE	15/12/2016	Demolished Courtyard range, south elevation, chimney flue exposed on wall face with handle for flue dampener	Kmacf
1254	SE	15/12/2016	Demolished Courtyard range, south elevation, chimney flue exposed on wall face with handle for flue dampener	Kmacf
1255	W	15/12/2016	East Jamb, south elevation, cill removed exposing rough underside	Kmacf
1256	E	15/12/2016	East Jamb, south elevation, eastern wall core	Kmacf
1257	V	15/12/2016	East Jamb, south elevation, cill removed , detail of top	Kmacf
1258	E	15/12/2016	Demolished Courtyard range, south elevation, chimney flue and window	Kmacf
1259	S	15/12/2016	Demolished Courtyard range, south elevation, chimney flue exposed on wall face with handle for flue dampener	Kmacf
1260	S	15/12/2016	Demolished Courtyard range, south elevation, chimney flue exposed on wall face with handle for flue dampener	Kmacf
1261	S	15/12/2016	Demolished Courtyard range, south elevation, chimney flue exposed on wall face with handle for flue dampener	Kmacf
1262	V	15/12/2016	East Jamb, south elevation, eastern jamb stone from window detail of tooling on underside	Kmacf
1263	V	15/12/2016	East Jamb, south elevation, eastern wall core at LOE	Kmacf

***Appendix B Illustrations***

- 1: Plan of Panmure House, ground floor, showing line of early clay-bonded buildings in red
- 2: Elevations of stair tower – north, east, south

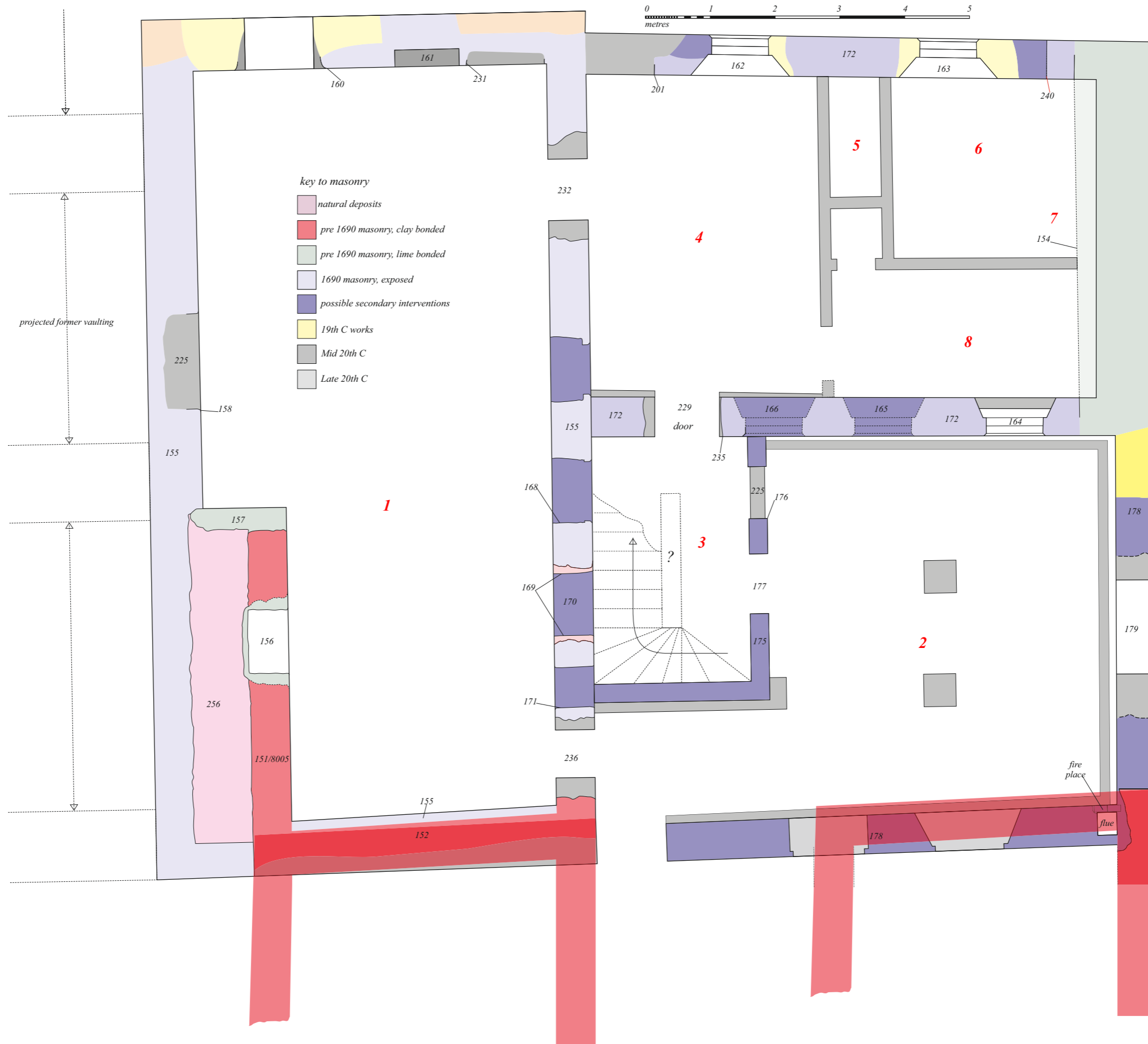

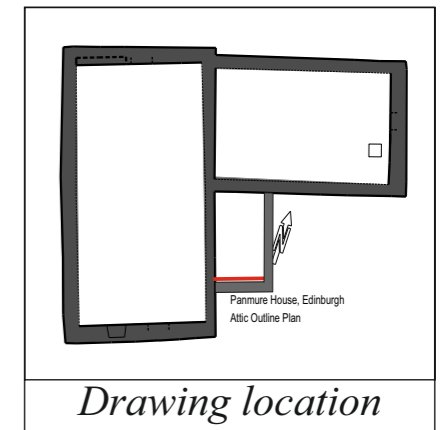
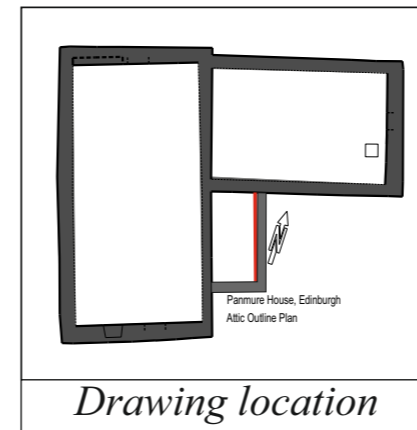
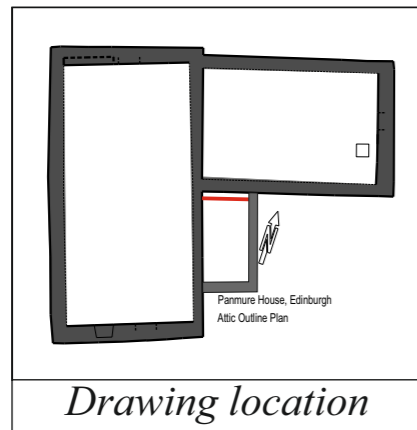
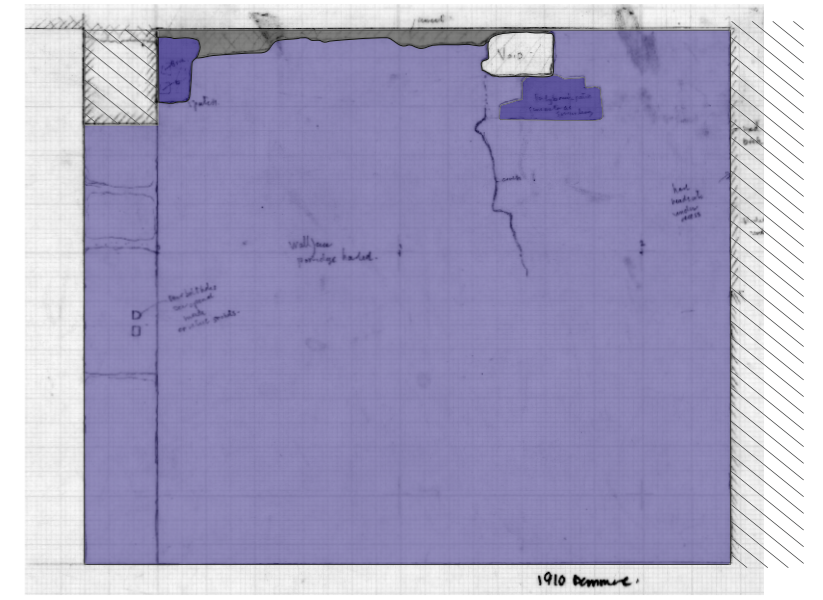
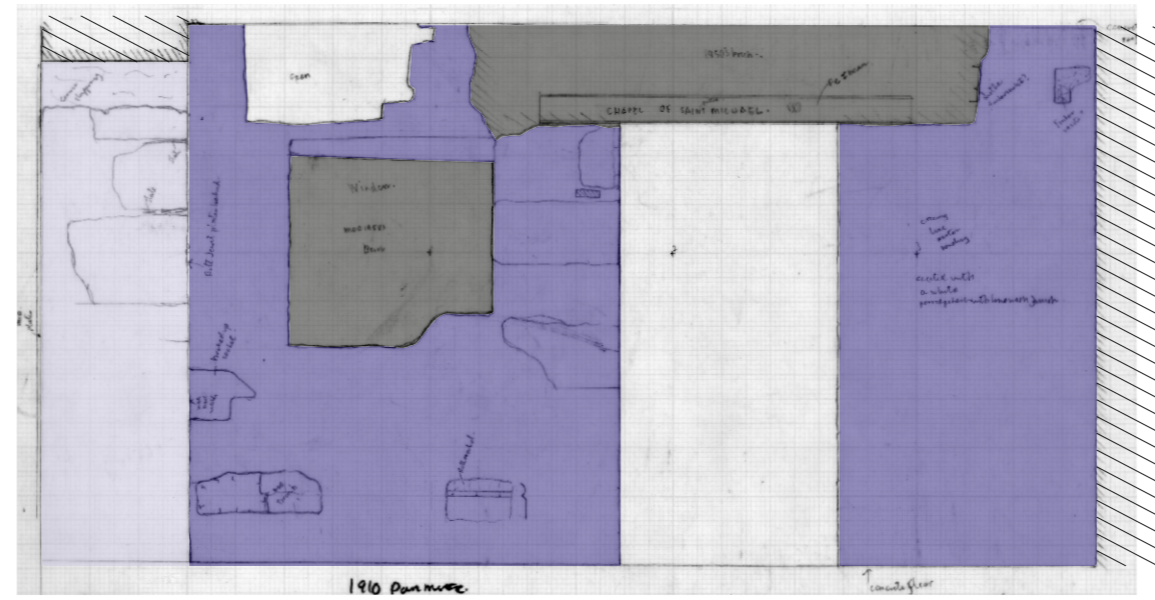
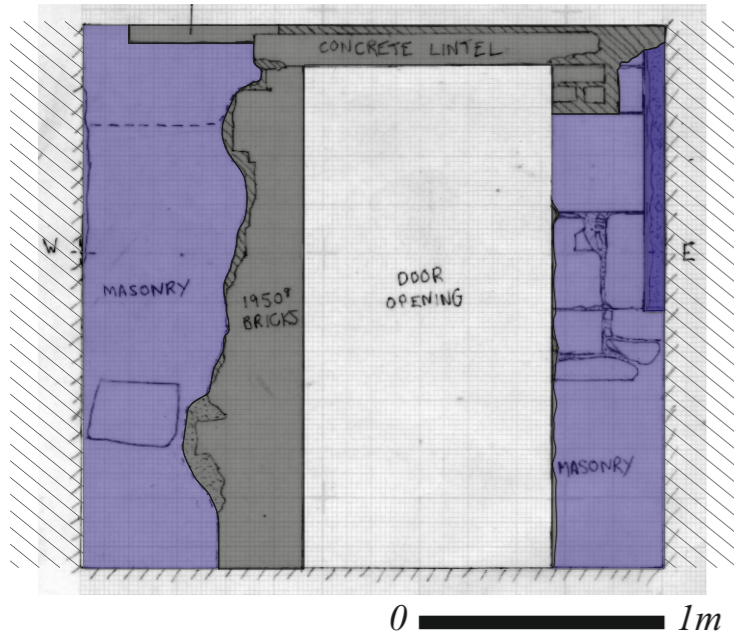

- key to masonry
- natural deposits
  - pre 1690 masonry, clay bonded
  - pre 1690 masonry, lime bonded
  - 1690 masonry, exposed
  - possible secondary interventions
  - 20th C brickwork
  - 20th C plaster on hard