

# Dalmeny Church Hall

*Dalmeny, City of Edinburgh Council*

---

*Watching Brief and Building Recording: 2017*

*for*

Dalmeny Parish Church

*September 2017*



*East-facing elevation of Dalmeny Church Hall*

## Addyman Archaeology

Archaeology   Heritage Consultancy   Architecture

## Addyman Archaeology

The Old Printworks, 77a Brunswick Street, Edinburgh, EH7 5HS  
admin@addyman-archaeology.co.uk  
0131 555 4678

# Dalmeny Church Hall

## Dalmeny, City of Edinburgh Council

---

### *Watching Brief and Building Recording: 2017*

Job number 2288.00

September 2017

by Antoine Ruchonnet

#### *Contents*

#### *Illustrations*

#### *Acknowledgements*

#### *Executive Summary*

<b>1.</b>	<b><i>Introduction</i></b>	<b>5</b>
i.	<i>Site location and setting</i>	5
<b>2.</b>	<b><i>Historical Summary</i></b>	<b>7</b>
<b>3.</b>	<b><i>Watching Brief</i></b>	<b>11</b>
i.	<i>Methodology</i>	11
ii.	<i>Results</i>	11
a.	<i>Gas Trench</i>	11
b.	<i>South Trench</i>	14
c.	<i>North Trench</i>	16
d.	<i>Finds</i>	17
iii.	<i>Discussion</i>	19
<b>4.</b>	<b><i>Historic Building Recording</i></b>	<b>21</b>
i.	<i>Methodology</i>	21
ii.	<i>Results</i>	21
a.	<i>Eastern window and early blocked doorway</i>	21
b.	<i>Central window modification</i>	21
c.	<i>Western doorway: modified window</i>	21
d.	<i>Projecting gable end</i>	22
iii.	<i>Discussion</i>	23
<b>Appendix A</b>	<b><i>Context Register</i></b>	<b>24</b>
<b>Appendix B</b>	<b><i>Drawings Register</i></b>	<b>25</b>
<b>Appendix C</b>	<b><i>Finds Register</i></b>	<b>25</b>
<b>Appendix D</b>	<b><i>Photograph Register</i></b>	<b>26</b>



## *Illustrations*

### *List of Figures*

Figure 1 Site location with development area outlined in red	6
Figure 2 OS 25 inch 1 <sup>st</sup> edition map of 1854 with development area outlined in red. (NLS)	7
Figure 3 OS 25 inch 1 <sup>st</sup> edition map of 1859 (reprinted 1895 with insertions) with development area outlined in red. (NLS)	8
Figure 4 OS 25 inch 2 <sup>nd</sup> Edition map (1895) with development area outlined in red. (NLS)	9
Figure 5 OS 25 inch 2 <sup>nd</sup> Edition map (1917) with part of the development area outlined in red. (NLS)	9
Figure 6 North-facing section of the gas trench	13
Figure 7 North facing section of the south trench	15
Figure 8 South facing section of the north trench	17
Figure 9 Ground floor plan	20
Figure 10 First floor plan	20

### *List of Plates*

Plate 1 View of area of North and South trenches, pre-ex. Facing S	11
Plate 2 View of gas trench area, pre-ex. Facing SW	11
Plate 3 Gas trench showing deposits (003), (004) and service trench [007]. Facing W	12
Plate 4 Gas trench post-ex. Facing SE	12
Plate 5 Wall foundation [005]. Facing W	12
Plate 6 Wall foundation [009] and ceramic drain [006]. Facing S	12
Plate 7 South trench, general view, post ex. Facing E	14
Plate 8 South trench, west end showing stratigraphy. Facing W	14
Plate 9 South trench, east end showing service trenches [017], [019] and [021]. Facing S	15
Plate 10 South trench, charcoal area in deposit (016). Facing S	15
Plate 11 North trench, general view, post ex. Facing E	16
Plate 12 North trench, east end showing rubble concentration in (015) . Facing N	16
Plate 13 North trench, section with deposits (015) and (016) and trench [017]. Facing N	16
Plate 14 North trench, south end. Facing S	16
Plate 15 Ceramic assemblage from the north trench (016)	18
Plate 16 SF014, Wash basin (exterior)	18
Plate 17 SF014, Wash basin (interior)	18
Plate 18 North and south trench, general view. Facing S	19
Plate 19 North, south and gas trench, general view. Facing W	19
Plate 20 South east corner of the building, general view. Facing NW	22
Plate 21 South east corner of the building, detail. Facing NW	22
Plate 22 Lounge internal door with raised surrounds. Facing SE	22
Plate 23 Main range south elevation. Facing N	23

### *List of Tables*

Table 1 Contexts encountered in the gas trench	13
Table 2 Contexts encountered in the South Trench	15
Table 3 Contexts encountered in the North Trench	17

Unless otherwise stated, all content is the copyright of Simpson & Brown *Architects* with Addyman Archaeology.

### ***Acknowledgements***

Thanks to Jim Watters of Gateside Design for facilitation of the project. Many thanks to Paul Brown and his team for their reaction to and understanding of the archaeological conditions and requirements and their patience and hard work. Thanks to John Lawson of CECAS for consultation and advice before and during the works. Many thanks go to Philip Karsgaard for his assistance in the editing of this report.

# Dalmeny Church Hall

## Dalmeny, City of Edinburgh Council

---

### *Watching Brief and Building Recording*

#### *Executive Summary*

Addyman Archaeology undertook an archaeological watching brief and historic building recording at Dalmeny Church Hall, South Queensferry in January 2017. The works were required as part of alteration works to the hall.

A watching brief was maintained throughout ground-breaking and down-taking works, which revealed buried soils of the late 18<sup>th</sup> to early 20th century and services related to the Hall. Building recording noted several modifications of the existing fabric, including a possible remnant of the original early 18<sup>th</sup> century range.

#### *1. Introduction*

##### *i. General*

Addyman Archaeology was contracted by Gateside Design (Contact: James Watters) on behalf of Dalmeny Parish Church to carry out the archaeological mitigation required in association with alteration works at Dalmeny Church Hall, 22 Main Street, Dalmeny, South Queensferry, EH30 9TU. Planning permission for the works (ref. 16/05752/FUL) was granted on 27 January 2017. The planning condition state that

*No development shall take place until the applicant has secured the implementation of a programme of archaeological work, in accordance with a written scheme of investigation which has been submitted to and approved in writing by the Planning Authority, having first been agreed by the City Archaeologist.*

##### **Reasons:-**

- 1. In order to safeguard the interests of archaeological heritage.*

A Written Scheme of Investigation (WSI) was presented and subsequently accepted by CECAS Archaeology Officer, John Lawson.

A record of the works undertaken (OASIS ID: addymanal-295654) has been deposited with the Online Access to the Index of Archaeological Investigations (OASIS) website hosted by the Archaeological Data Service and with Discovery and Excavation in Scotland (DES), the annual publication of fieldwork by Archaeology Scotland.

##### *ii. Site location and setting*

Dalmeny Church Hall lies on the corner of Main Street and Bankhead Road, Dalmeny, South Queensferry (*figure 1*), immediately south-west of Dalmeny St Cuthbert's Kirk, and its burial ground (NGR: NT 1442 7746). The site lies close to Category A and B listed buildings and lies within the Dalmeny Conservation Area.

The site slopes gently up to the north, towards Dalmeny Kirk, and down gently to the west.





*Figure 1 Site location with development area outlined in red*



## 2. Historical Summary

The following map regression focusses on the buildings concerned in the present development. Although the village of Dalmeny appears on, for instance, Blaeu's 1654 map as *Dunmany*, maps produced before the Ordnance Survey often do not include detailed views of individual structures.

The Ordnance Survey 25 inch 1<sup>st</sup> Edition map (1854) shows the development area with a structure on the present site labelled as a school (*figure 2*). The *Canmore* database notes the Scottish Records Office references to the costs of building the school, as received in 1734 (<https://canmore.org.uk/site/50537/dalmeny-main-street-school>). *Figure 2* shows a structure extending further to the north-east than the existing building, its eastern gable end extending almost to the north-south path to the kirk building, with a projecting range to the north. The extent of this original building is probably demarcated by the existing dog-legged boundary wall to the burial grounds.

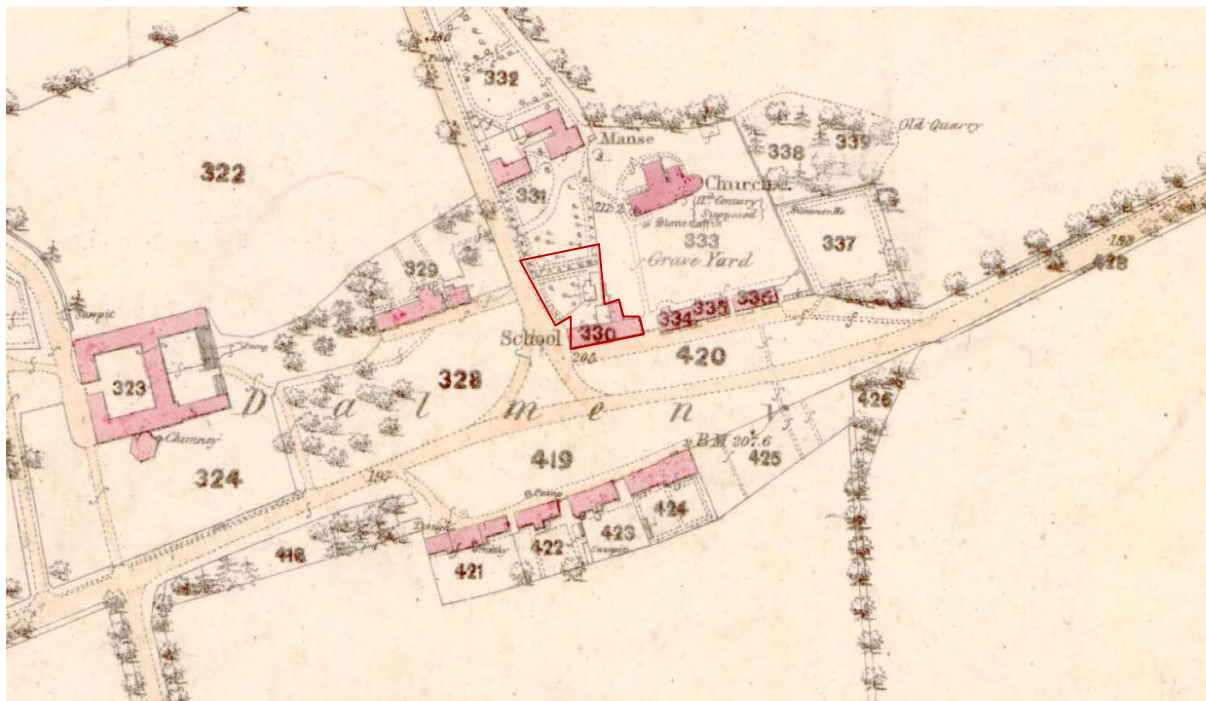

View: Linlithgow Sheet III.13 (Dalmeny, Cramond & Queensferry) - Ordnance Survey 25 inch 1st edition, Scotland, 1855-1882  
<http://maps.nls.uk/view/74963165>

Figure 2 OS 25 inch 1<sup>st</sup> edition map of 1854 with development area outlined in red. (NLS)

The reissue of this map series, *figure 3*, shows this extended block as two buildings. The smaller structures to the north of the main school building, and in the re-entry between the northern projecting range and the north elevation, are still standing.

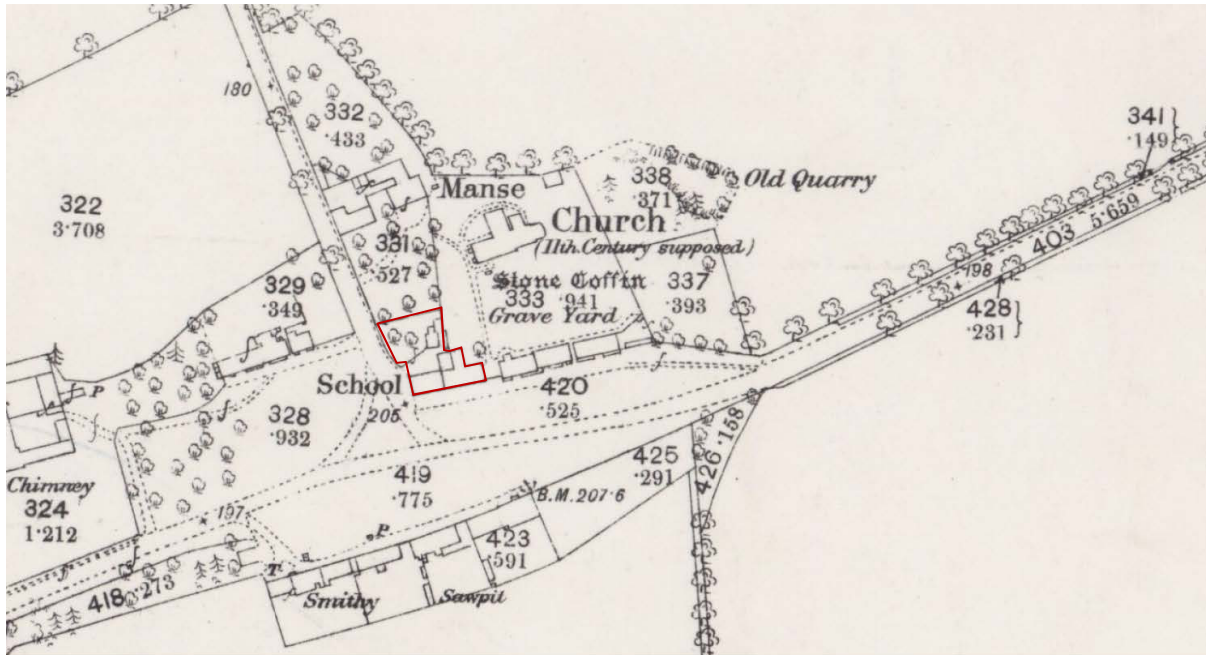

View: Linlithgow Sheet III.13 (Combined) - Ordnance Survey 25 inch 1st edition, Scotland, 1855-1882  
<http://maps.nls.uk/view/74479136>

Figure 3 OS 25 inch 1<sup>st</sup> edition map of 1859 (reprinted 1895 with insertions) with development area outlined in red. (NLS)

The OS 25 inch 2<sup>nd</sup> Edition map of Linlithgowshire (1895) shows the western school building enlarged, and, for the first time, the slightly projecting southern gable end of the western range, and the northern projection of the eastern range (*figure 4*). The building to the north of the school buildings proper has been demolished or incorporated, and new structures have appeared along the north of the development area. The buildings to the east of the existing structures are still shown standing in this edition. The 1917 edition of the OS 25 inch map also shows the eastern range standing and in use as a school (*figure 5*).

The map regression demonstrates the presence of buildings on the site from the early 19<sup>th</sup> century. A major realignment of the western side of the school buildings appears to have taken place some time before 1895, when the mainly northeast-southwest aligned range was altered into two north-south ranges set next to each other, along with continued development of the plot immediately to the north of the buildings. The regression also shows that the eastern side of the development area was, from the early 19<sup>th</sup> century onwards, within the footprint of a building, now demolished.

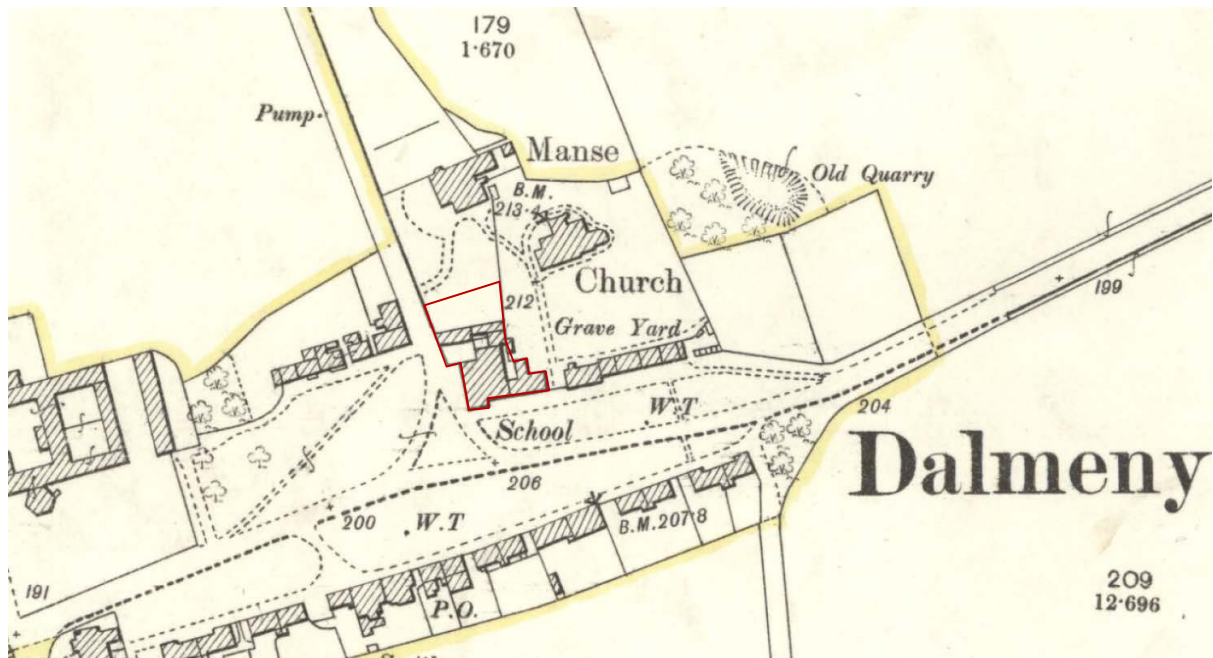

View: Linlithgowshire 003.13 (includes: Dalmeny) - Ordnance Survey 25 inch 2nd and later editions, Scotland, 1892-1949  
<http://maps.nls.uk/view/82895145>

Figure 4 OS 25 inch 2<sup>nd</sup> Edition map (1895) with development area outlined in red. (NLS)

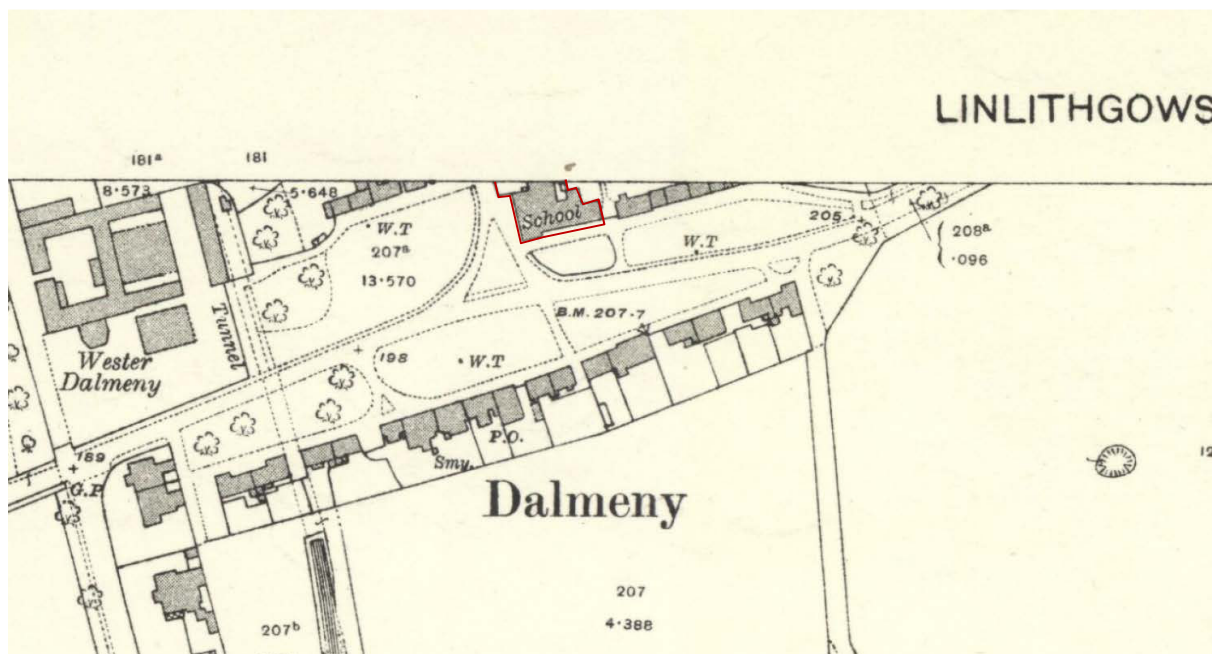

View: Linlithgowshire n005.09 (includes: Dalmeny) - Ordnance Survey 25 inch 2nd and later editions, Scotland, 1892-1949  
<http://maps.nls.uk/view/82895538>

Figure 5 OS 25 inch 2<sup>nd</sup> Edition map (1917) with part of the development area outlined in red. (NLS)

The site itself includes the old school building now used as the Church Hall. The Hall is an unlisted building (*Canmore* ID 50537), mostly of later 19<sup>th</sup> century date but incorporating parts of a pre-existing structure that may be the same structure referred to in documentation of c.1734. The Hall lies within a B Group Listing, which includes Dalmeny Kirk, 1-3 Easter Dalmeny Cottages, Gospatric House, 1-6 (inclusive) and 9-15 (inclusive) Dalmeny Village Main Street, Dalmeny Village Telephone Kiosk, Dalmeny Village War Memorial, 1-4 (inclusive) Wester Dalmeny Farm Cottages, Wester Dalmeny Farmhouse and Wester Dalmeny Steading. The development area is in the centre of the medieval settlement of Dalmeny, and medieval and post-medieval remains are likely in the development area.

The Hall lies immediately to the south-west of Dalmeny St Cuthbert's Kirk, an A-listed 12<sup>th</sup> century foundation with large-scale 17<sup>th</sup> century additions (Listed Building ref. LB5570), and its associated burial ground.



### 3. Watching Brief

#### i. Methodology

A watching brief was conducted during all ground-breaking and ground works at Dalmeny Church Hall. This consisted in the excavation of one (SE-NW) trench to fit a gas main from the north-east corner of the church hall, as well as two (W-E) L-shaped trenches, both to the north of the church hall (*plates 1, 2*). All trenches were first cut through the existing concrete using a still saw, subsequently broken up with a pneumatic drill. The gas trench was dug by hand using shovels and spades, as the mechanical excavator could not do it satisfactorily. Trenches North and South were excavated with a 1.5-tonne tracked mechanical excavator fitted with a toothless ditching bucket, under archaeological direction.

All site recording was undertaken using standard *pro-forma* sheets for the recording of archaeological contexts, finds, drawings, and photographs produced during the archaeological works, which become part of the archaeological record. These records are produced to *CIfA* standards, and Addyman Archaeology adheres to the *CIfA*'s principals and codes of conduct at all times. Standard recording drawings were undertaken at 1:20 scale in plan and section.

In the following account, contexts including fills, layers and deposits are given in round brackets, with cuts and structural elements given in square brackets. The contexts begin at (001). Full lists of contexts are given in Appendix A; finds information is summarised in Appendix C; photographic thumbnails can be found in Appendix E.



Plate 1 View of area of North and South trenches, pre-ex. Facing S



Plate 2 View of gas trench area, pre-ex. Facing SW

#### ii. Results

##### a. Gas Trench

The gas trench was located at the north-west corner of the Hall, and ran from the north-west corner of the north gable end, north-westwards to the western boundary wall (*figure 9*). It measured 4.25m x 0.40m for an average depth of 0.45m (*plates 3, 4*).

The trench revealed a two service features and wall foundation trenches, as well as a midden-like deposit to the west, a mortar-rich deposit to the east and an occupation deposit in the lowest depth reached for the purpose needed. These are described below; *table 1* summarises the contexts encountered in the gas trench, and *figure 6* gives its north-facing section.



*Plate 3 Gas trench showing deposits (003), (004) and service trench [007]. Facing W*



*Plate 4 Gas trench post-ex. Facing SE*

One of the service trenches [007] was dug to accommodate a water main, running SE-NW roughly in the middle of the gas trench. This work was done before the concrete surface (001) was poured as there was no indication that the trench cut it or its bedding (002).

A linear ceramic drain [006], running NE-SW, was discovered at the east end of the gas trench (*plate 6*). No sign of a downpipe was found on the concrete surface (001), though there were, however, some faded traces of fastening on the building exterior elevation above it. This indicates that the downpipe was removed before the concrete surface was laid.

The east end of the gas trench also revealed the stepped-out foundation course for the west wall of the church hall, [009] (*plate 6*). Both wall foundations [009] and ceramic drain [006] seem to share one cut, [013]. This might be because both were made at the same time or because both back-fills are indiscernible. The fill was assigned a single context number, (014).

Also found in the gas trench was a single course of the foundations [005] for the western boundary wall. Its foundation trench cut [010] ran parallel along the wall (*plate 5*).



*Plate 5 Wall foundation [005]. Facing W*



*Plate 6 Wall foundation [009] and ceramic drain [006]. Facing S*

Appearing in the west end of the gas trench was a mid-brown clayey deposit (003), showing typical aspects of midden or garden-soil deposits. Directly to the east was a mortar rich deposit (004) containing occasional rubble and what looks like an iron bracket. This deposit is related to construction of, or, more likely, renovation activity on, the west church hall elevation.

Underlying deposits (003) and (004) was a mid-brown deposit (012), extending across the whole of the trench.

<i>Context Number</i>	<i>Description</i>
(001)	Concrete surface
(002)	Concrete surface bedding
(003)	Midden deposit to the west of the gas trench
(004)	Mortar rich deposit to the east of the gas trench
[005]	Foundations of west boundary wall
[006]	Ceramic drain
[007]	Service trench
(008)	Fill of service trench [007]
[009]	Foundations of west church hall wall
[010]	Foundation trench for foundation [005]
(011)	Fill of foundation trench [010]
(012)	Mid brown deposit under (004) and (005)
[013]	Cut for drain [006] foundation trench [009]
(014)	Fill of cut [013]

Table 1 Contexts encountered in the gas trench

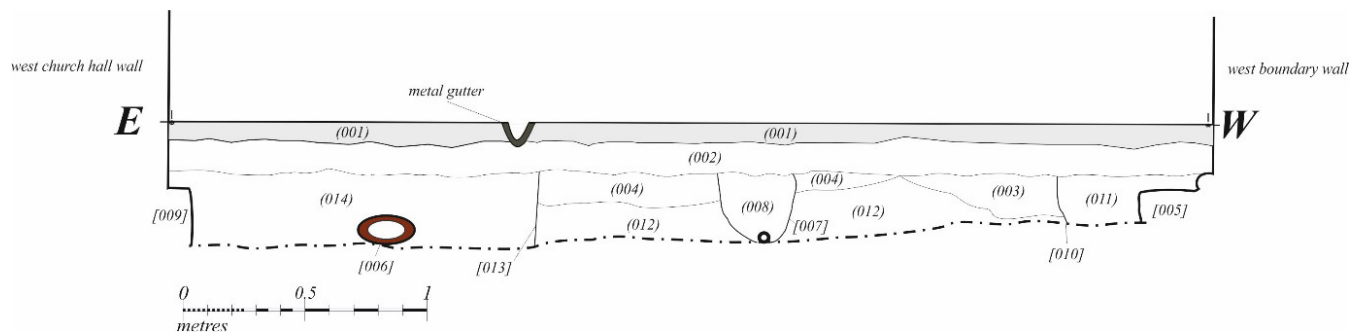

Figure 6 North-facing section of the gas trench



*b. South Trench*

The south trench was located against the west wall of the eastern projecting range (*figure 9* and *plates 7-8*). It was L-shaped in plan, and ran 5.45m x 0.80m E-W, returning to the north at its eastern extent to run 1.30m northwards. It was 0.80m wide and was excavated to an average depth of 0.65m.

The south trench revealed two service trenches to the east, as well as a wall foundation trench. The rest of the trench was quite homogenous in its stratigraphy (see *figure 7, north-facing section*).

Service trench [017] was dug for a water main and ran SE-NW, originating in the south east corner of the trench, under the concrete stairs.

The second service trench [019] accommodated three cables, including the electricity main, and ran east to west, entering the building through an opening in the west wall. Service trench [019] cut the foundation trench [021] for the foundation of the west elevation of the building (*plate 9*).

Two deposits were noted under the concrete surface (001) and its mixed sandy bedding (002). Directly below the surface and bedding lay a mortar rich deposit (015), containing occasional rubble, most likely related to renovation of the Hall. Directly under it was a mid-brown deposit (016) containing occasional ceramic fragments. A small shallow charcoal-rich area (0.20m in diameter) containing a few burnt animal bone fragments was uncovered (*plate 10*) – most likely a single depositional event, part of the mixed fill constituting the matrix of deposit (016).



*Plate 7 South trench, general view, post ex. Facing E    Plate 8 South trench, west end showing stratigraphy. Facing W*



Plate 9 South trench, east end showing service trenches [017], [019] and [021]. Facing S



Plate 10 South trench, charcoal area in deposit (016). Facing S

<i>Context No.</i>	<i>Description</i>
(001)	Concrete surface
(002)	Mixed sandy bedding for Surface (001)
(015)	Mortar rich deposit under (002)
(016)	Mid brown deposit under (015)
[017]	Service trench for water main. Filled by (018)
(018)	Fill of service trench [017]
[019]	Service trench for various services
(020)	Fill of service trench [019]
[021]	Cut for foundation trench of north west wall [023]
(022)	Fill of foundation trench [021]
[023]	Foundation course of north east wall

Table 2 Contexts encountered in the South Trench

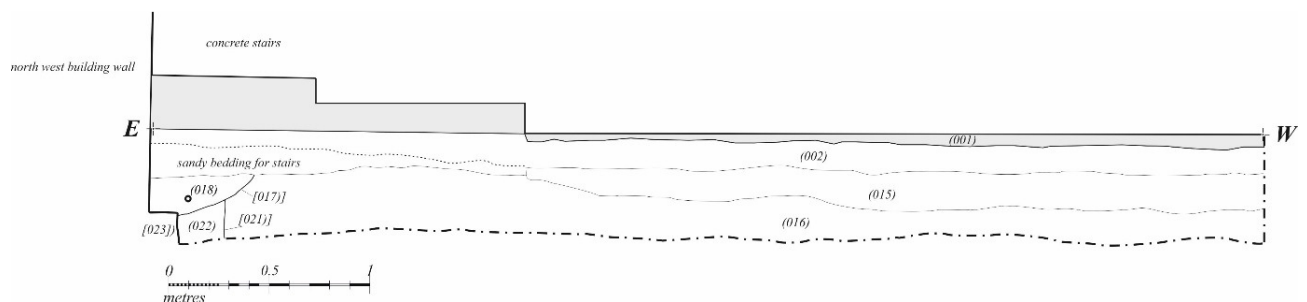

Figure 7 North facing section of the south trench



c. North Trench

The north trench was located north of the church hall gable end (*figure 9* and *plate 11*). It was L-shaped in plan, and ran north of the gable end for 3.1m, then returning to the east for 5.2m. It was between 0.65 and 0.70m in width, with an average depth of 0.65m. *Figure 8* shows its north-facing section, and *table 3* summarises the contexts encountered in the North Trench.

Two features were discovered in the north trench. These were the continuation of the water main service trench [017] found in the south trench, continuing on its SE-NW alignment; and the foundation trench [013] for the west range of the church hall, as also revealed in the gas trench.

The stratigraphy consisted again of two deposits below the concrete surface (001) and bedding (002). A mortar-rich deposit (015), similar to that found in the south trench, contained occasional rubble, most likely related to renovation activity on the Hall. At the eastern end of the trench, a higher concentration of rubble was noted (*plate 12*) as part of (015). As in the south trench, directly below mortar-rich deposit (015) was mid-brown silty clay deposit (016) containing frequent ceramic fragments (*plate 13*).



Plate 11 North trench, general view, post ex. Facing E



Plate 12 North trench, east end showing rubble concentration in (015). Facing N



Plate 13 North trench, section with deposits (015) and (016) and trench [017]. Facing N



Plate 14 North trench, south end. Facing S

<i>Context No.</i>	<i>Description</i>
(001)	Concrete surface
(002)	Mixed sandy bedding for Surface (001)
(015)	Mortar rich deposit under (002)
(016)	Mid brown deposit under (015)
[017]	Service trench for water main. Filled by (018)
(018)	Fill of service trench [017]

Table 3 Contexts encountered in the North Trench

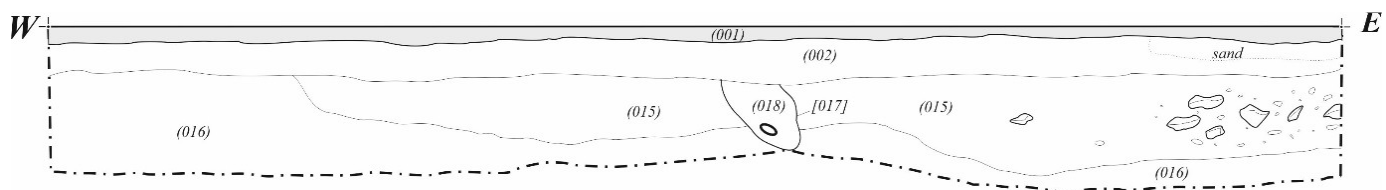

Figure 8 South facing section of the north trench

#### *d. Finds*

Though the excavation was not extensive, numerous finds were uncovered, including faunal remains with butchery marks, glass bottles, ferrous structural elements, and various ceramic fragments, dating from the second half of the 19<sup>th</sup> century onwards (*plates 15-17*).

Most notable were *SF014*, two large fragments of a wash basin (*plates 16-17*). Its exterior is decorated with a depiction of Brighton Pavilion with visitors in its grounds. The interior shows discrete arrangements of thistles and roses, and the word 'QUI' in a decorative band, enclosing a further Willow-pattern decorative field, at its base. This may be a fragment of the popular motto, *Honi soit qui mal y pense*, used as the motto of the Order of the Garter, incorporated as an encircling band on a version of the Royal Arms (though not that displayed most often in Scotland), and popular also with military groups and schools (which function the Hall served before its adoption as the Church Hall).





*Plate 15 Ceramic assemblage from the north trench (016)*



*Plate 16 SF014, Wash basin (exterior)*



*Plate 17 SF014, Wash basin (interior)*

*iii. Discussion*

The watching brief at Dalmeny Church Hall revealed a sequence of deposits and features related to the later stages of the building's occupation and use (*plates 18-19*). The underlying sterile geology was not encountered in the depths required for the access ramp works (North and South trenches) or in the Gas Trench. It appears that the mortar rich deposit (015) found in both North and South trenches is related to renovations of the Church Hall, while the underlying deposit (016) relates to the occupation of the building and area before this. The ceramic evidence of deposit (016) provides a date in the first half of the 19<sup>th</sup> century, with a few residual elements from the second half of the 18<sup>th</sup> century. This coincides well with the cartographic evidence, showing that the last major renovation was conducted in the middle of the 19<sup>th</sup> century and gave the building the configuration it has to this date. All services were installed subsequently. Lastly the area was covered with a concrete surface.



*Plate 18 North and south trench, general view. Facing S*



*Plate 19 North, south and gas trench, general view. Facing W*

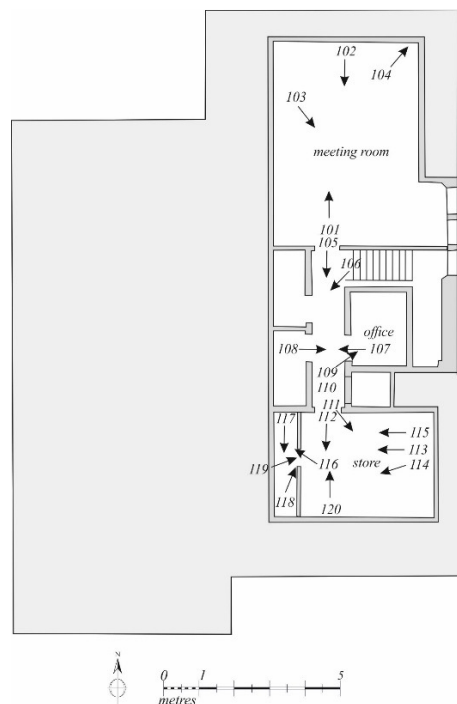
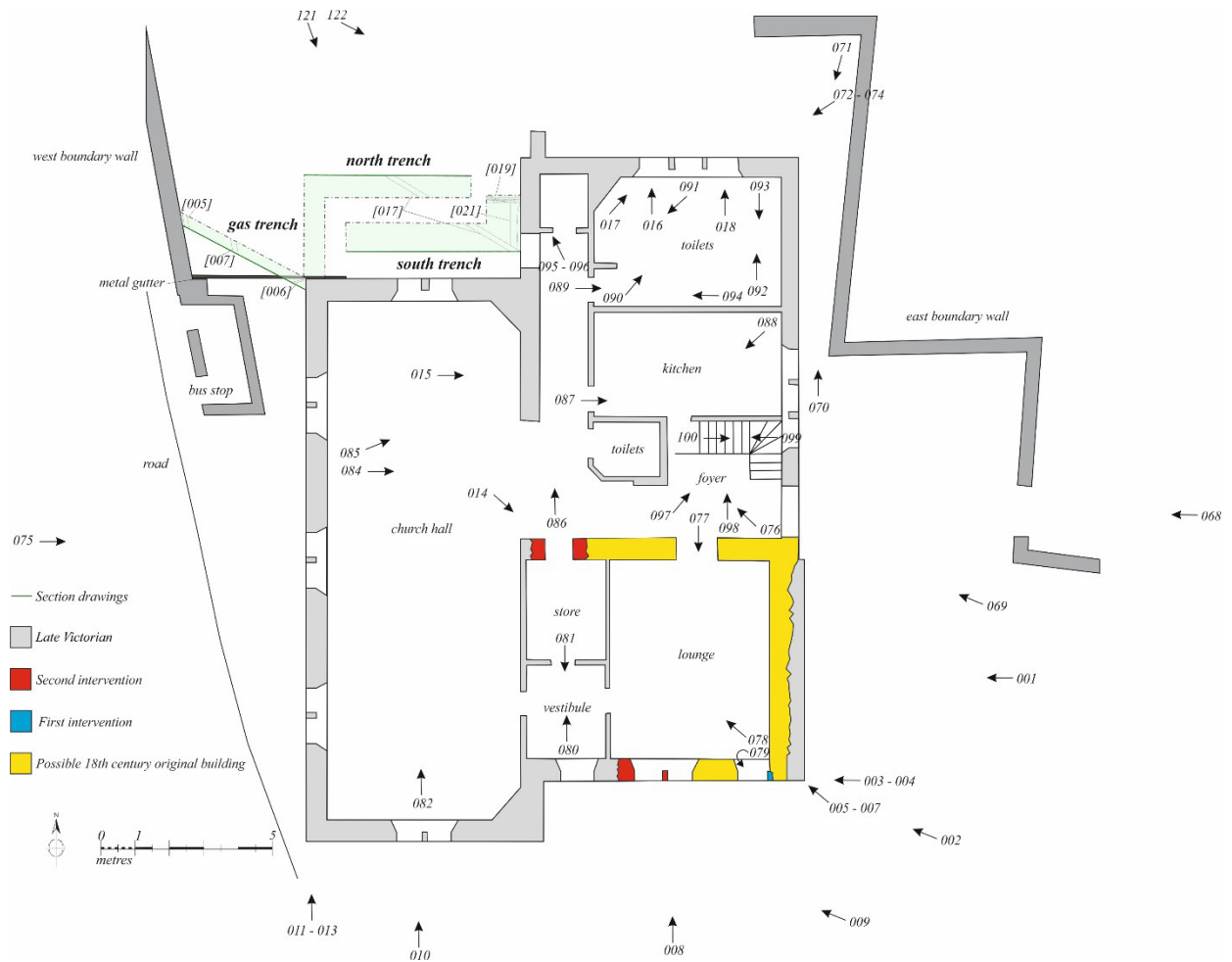



## **4. Historic Building Recording**

### *i. Methodology*

A brief programme of building recording at Dalmeny Church Hall was conducted concurrently with the watching brief. Photographs of the exterior and interior of the building were taken in order to understand the extent of the different phases of the building, if and where possible. At the time of recording, the interior was largely already re-covered in plaster boarding, with the exception of three areas, which permitted some inspection of the original fabric. Photo location plans can be found in *figures 9 and 10*. Photographic thumbnails are given in *Appendix F*. Proposed building phasing and interventions are also shown on *figure 9*.

### *ii. Results*

Both the map regression and historical sources indicated, as discussed above, that the existing buildings may represent rebuildings or modifications of existing structures on the site, with a reference to funds for the construction of the School building on the site of the present Hall in 1734. Until 1859 and before 1895, this consisted of two NE-SW aligned ranges parallel with the road frontage; after 1895, projecting gable ends are seen at the north-east and south-west ends of the building respectively. After 1895, the east building was demolished and is now represented only by the courtyard area and dog-legged eastern perimeter wall. Therefore, the existing east gable end of the present building (*plate 20, 21*), as well as the south-facing elevation of the NE-SW aligned range (*plate 23*), extending from the gable end to the west projecting gable end, were thought to potentially retain stonework of the early 18<sup>th</sup> century structure. It was these areas which were targeting for closer examination.

#### *a. Eastern window and early blocked doorway*

The easternmost window of the south elevation is furnished with shallow raised squared surrounds on both jambs and a shallow squared lintel, with a projecting cill. At the bottom east corner of the window is stonework which appears quoined, running from the base of the window to ground level (*plate 21*). This indicates a partially blocked doorway, with a window inserted into the upper half of the doorway. *Figure 9* also shows the east side of the internal face of this window is not furnished with canted ingos, as the other windows are, but has a jamb flush with the east gable end wall, again suggesting an original doorway, not window, aperture. This quoining and its stonework appear to be the earliest extant structural element.

#### *b. Central window modification*

The central double window of the south elevation (*plate 23*), just to the west of the window just discussed, is also furnished with shallow squared surrounds. The lintel and central mullion, however, are later insertions, and a distinction is evident in the cills: the east cill is both more heavily worn and ends off-centre to the mullion. This cill may be original to the window. The central mullion, however, was inserted later, replacing the original shallow surround, which was inserted as the jamb of the newly-expanded, now double-lighted, window on its western side, this western side also receiving a new cill.

#### *c. Western doorway: modified window*

The existing doorway to the west of the central windows just discussed appears to be a slapped-through window (*plate 23*). The door-jambs do not display the shallow-relief squared surrounds of the windows as might be expected if they were contemporary features: instead, its eastern quoins are cut and shortened. (Shallow relief squared door surrounds are seen internally, in the north-west door of the Hall Lounge: *plate 22*). The lintel preserves traces of a shallow-relief squared surround, which however stop short of the full width of the existing doorway. The western jamb of the door also appears to cut through existing stonework and is not quoined, or displays truncated quoins. This door, therefore, appears to have been slapped through an existing window aperture.

*d. Projecting gable end*

The projecting gable end at the western side of the main range under discussion relates clearly to the late 19<sup>th</sup> century remodelling of the building, as does the bulk of the rest of the existing building. Further, it appears that the east gable end – which originally would have been a cross-wall or building end dividing the two original ranges, was re-skinned in the later phase of works so that no early 18<sup>th</sup> century elements are visible. This may also be seen in the wall thickening of the gable end at its southern extent (*figure 9*).



*Plate 20 South east corner of the building, general view. Facing NW*



*Plate 21 South east corner of the building, detail.  
Facing NW*



*Plate 22 Lounge internal door with raised surrounds.  
Facing SE*





*Plate 23 Main range south elevation. Facing N*

### *iii. Discussion*

The brief photographic survey revealed some elements of disparate phasing and modifications at Dalmeny Church Hall. The earliest element – possibly related to the original 1734 structure – is stonework below the east window of the main range's southern elevation. This door was later partially blocked to form a window. The central windows are an expansion of the original single window, with the insertion of a new mullion and lintel and the re-siting of the west jamb to the west side of the enlarged new window. The existing door to the west is a modified window, slapped through to form a door. Finally, the bulk of the building, including the projecting gable ends to north and south, relate to the late 19<sup>th</sup> century modifications between 1859 and 1895.

**Appendix A Context Register**

<b>Context No.</b>	<b>Recorded by</b>	<b>Date</b>	<b>Trench</b>	<b>Description</b>
(001)	AR	04/09/2017		Concrete surface
(002)	AR	04/09/2017		Bedding for concrete surface (001)
(003)	AR	04/09/2017	Gas Trench	Midden deposit to the west of the gas trench
(004)	AR	04/09/2017	Gas Trench	Mortar rich deposit to the east of the gas trench
[005]	AR	04/09/2017	Gas Trench and North	Foundations of west boundary wall
[006]	AR	04/09/2017	Gas Trench	Ceramic drain for downpipe
[007]	AR	04/09/2017	Gas Trench	Service trench. Filled by (008)
(008)	AR	04/09/2017	Gas Trench	Fill of service trench [007]
[009]	AR	04/09/2017	Gas Trench	Foundations of west building wall
[010]	AR	04/09/2017	Gas Trench	Foundation trench for foundation [005]. Filled by (011)
(011)	AR	04/09/2017	Gas Trench	Fill of foundation trench [010]
(012)	AR	04/09/2017	Gas Trench	Mid brown deposit under (004) and (005)
[013]	AR	04/09/2017	Gas Trench and North	Cut for drain [006] foundation trench [009]. Filled by (014)
(014)	AR	04/09/2017	Gas Trench and North	Fill of cut [013]
(015)	AR	05/09/2017	South and North	Mortar rich deposit under (002)
(016)	AR	05/09/2017	South and North	Mid brown deposit under (015)
[017]	AR	05/09/2017	South and North	Service trench for water main. Filled by (018)
(018)	AR	05/09/2017	South and North	Fill of service trench [017]
[019]	AR	05/09/2017	South	Service trench for various services. Filled by (020)
(020)	AR	05/09/2017	South	Fill of service trench [019]
[021]	AR	05/09/2017	South	Cut for foundation trench of north west wall [023]. Filled by (022)
(022)	AR	05/09/2017	South	Fill of foundation trench [021]
[023]	AR	05/09/2017	South	Foundations of wall north east wall

**Appendix B Drawings Register**

<b>Drawing No.</b>	<b>Sheet</b>	<b>Scale</b>	<b>Type</b>	<b>Date</b>	<b>Drawn by</b>	<b>Description</b>
1	1	1:20	Section	04/09/2017	AR	North facing section of Gas Trench
2	1	1:20	Plan	04/09/2017	AR	Plan of Gas Trench
3	1	1:20	Section	05/09/2017	AR	North facing section of South Trench
4	1	1:20	Plan	05/09/2017	AR	Plan of South Trench
5	2	1:20	Section	05/09/2017	AR	East facing section of North Trench
6	2	1:20	Section	05/09/2017	AR	South facing section of North Trench
7	2	1:20	Plan	05/09/2017	AR	Plan of North Trench

**Appendix C Finds Register**

<b>Finds No.</b>	<b>Context No.</b>	<b>Trench No.</b>	<b>Material</b>	<b>Date</b>	<b>Initials</b>	<b>Quantity</b>	<b>Description</b>
001	012	Gas Trench	CBM	04/09/2017	AR	1	
002	012	Gas Trench	Faunal	04/09/2017	AR	1	Small ungulate radius
003	012	Gas Trench	Shell	04/09/2017	AR	1	Oyster
004	002	North Trench	Glass	04/09/2017	AR	1	Bottle base
005	004	Gas Trench	Fe	04/09/2017	AR	4	Metal spike with a rectangular section
006	003	Gas Trench	Faunal	04/09/2017	AR	1	Long bone fragment with saw marks
007	003	Gas Trench	Ceramic	04/09/2017	AR	3	Blue and white
008	016	South Trench	CBM	04/09/2017	AR	1	
009	016	South Trench	Glass	04/09/2017	AR	2	
010	016	South Trench	Shell	04/09/2017	AR	2	Oyster and clam
011	016	South Trench	Faunal	04/09/2017	AR	4	Juvenile suid tibia, pelvis fragment, skull fragment and incisor
012	016	South Trench	Sn/Al	04/09/2017	AR	1	Button
013	016	South Trench	Ceramic	04/09/2017	AR	7	Blue and white, white
014	016	North Trench	Ceramic	04/09/2017	AR	3	Wash basin
015	016	North Trench	Ceramic	04/09/2017	AR	32	Blue and white, brown and white, pale green and brown
016	016	North Trench	Shell	04/09/2017	AR	1	Clam
017	016	North Trench	Faunal	04/09/2017	AR	2	Large ungulate pelvis with saw marks
018	016	North Trench	Mortar	04/09/2017	AR	2	
019	016	North Trench	Pb	04/09/2017	AR	1	Metal fixing
020	016	North Trench	Glass	04/09/2017	AR	12	Iridescent, white and green-brown

## Appendix D *Photograph Register*

<i>Image No.</i>	<i>Direction Facing</i>	<i>Date</i>	<i>Description</i>	<i>Portrait / Landscape</i>	<i>Initials</i>
001	W	04/09/2017	Building recording, east elevation, south end	L	AR
002	NW	04/09/2017	Building recording, south east elevation	L	AR
003	W	04/09/2017	Building recording, south east corner	P	AR
004	W	04/09/2017	Building recording, south east corner, gable detail	P	AR
005	W/Up	04/09/2017	Building recording, south east corner, gable detail	L	AR
006	W/Up	04/09/2017	Building recording, south east corner, gable detail	P	AR
007	W	04/09/2017	Building recording, south east corner, gable detail	P	AR
008	N	04/09/2017	Building recording, south elevation, east end	L	AR
009	NW	04/09/2017	Building recording, south elevation	L	AR
010	N	04/09/2017	Building recording, south elevation, west end	L	AR
011	N	04/09/2017	Building recording, south west corner	P	AR
012	N/Up	04/09/2017	Building recording, south east corner, gable detail	P	AR
013	N	05/09/2017	Building recording, south east corner, gable detail	P	AR
014	SE	04/09/2017	Building recording, ground floor, vestibule doorframe, stripped wall	L	AR
015	E	04/09/2017	Building recording, ground floor, church hall, stripped wall	L	AR
016	N	04/09/2017	Building recording, ground floor, toilets, stripped wall	L	AR
017	NE	04/09/2017	Building recording, ground floor, toilets, stripped wall	L	AR
018	N	04/09/2017	Building recording, ground floor, toilets, stripped wall	P	AR
019	SW	04/09/2017	Pre-ex	L	AR
020	S	04/09/2017	Pre-ex	L	AR
021	SE	04/09/2017	Pre-ex	L	AR
022	SW	04/09/2017	Gas trench, mid-ex	L	AR
023	S	04/09/2017	Gas trench, mid-ex	L	AR
024	S	04/09/2017	Gas trench, mid-ex, showing deposits (003) and (004), E to W	L	AR
025	S	04/09/2017	Gas trench, mid-ex, showing deposits (003) and (004), E to W	L	AR
026	S	04/09/2017	Gas trench, mid-ex, showing deposits (003) and (004), E to W	L	AR
027	W	04/09/2017	Gas trench, mid-ex, showing deposits (003) and (004)	P	AR
028	W	04/09/2017	Gas trench, mid-ex, showing deposits (003) and (004)	P	AR
029	W	04/09/2017	Gas trench, wall foundations [005]	P	AR
030	W	04/09/2017	Gas trench, wall foundations [005], detail	P	AR
031	W/Vert.	04/09/2017	Gas trench, wall foundations [005]	L	AR
032	SE	04/09/2017	Gas trench, post-ex	P	AR
033	NW	04/09/2017	Gas trench, post-ex	P	AR
034	S/Vert.	04/09/2017	Gas trench, post-ex, W to E	L	AR
035	S/Vert.	04/09/2017	Gas trench, post-ex, W to E	L	AR
036	S/Vert.	04/09/2017	Gas trench, post-ex, W to E	L	AR
037	E/Vert.	04/09/2017	Gas trench, post-ex, W to E	L	AR
038	S/Vert.	04/09/2017	Gas trench, post-ex, W to E	L	AR
039	S	04/09/2017	Gas trench, post-ex, north facing section, W to E	L	AR
040	S	04/09/2017	Gas trench, post-ex, north facing section, W to E	L	AR
041	S	04/09/2017	Gas trench, post-ex, north facing section, W to E	L	AR
042	S/Vert.	04/09/2017	South trench, post-ex, W to E	L	AR

043	S/Vert.	04/09/2017	South trench, post-ex, W to E	L	AR
044	S/Vert.	04/09/2017	South trench, post-ex, W to E	L	AR
045	S/Vert.	04/09/2017	South trench, post-ex, W to E	L	AR
046	S/Vert.	04/09/2017	South trench, post-ex, W to E	L	AR
047	E	04/09/2017	South trench, post-ex, general view	P	AR
048	S	04/09/2017	South trench, post-ex, west end, north facing section, detail	L	AR
049	W	04/09/2017	South trench, post-ex, west end, east facing section, detail	P	AR
050	SE	05/09/2017	North and South trenches, post-ex, general view	L	AR
051	S	05/09/2017	North and South trenches, post-ex, general view	L	AR
052	N	05/09/2017	North trench, post-ex, south facing section, E to W	L	AR
053	N	05/09/2017	North trench, post-ex, south facing section, E to W	L	AR
054	N	05/09/2017	North trench, post-ex, south facing section, E to W	L	AR
055	N	05/09/2017	North trench, post-ex, south facing section, E to W	L	AR
056	N	05/09/2017	North trench, post-ex, south facing section, E to W	L	AR
057	N	05/09/2017	North trench, post-ex, south facing section, E to W	L	AR
058	NW	05/09/2017	North trench, post-ex, south facing section, E to W	L	AR
059	W	05/09/2017	North trench, post-ex, south facing section, E to W	L	AR
060	S	05/09/2017	North trench, post-ex, south end	L	AR
061	S	05/09/2017	North trench, post-ex, south end, detail of wall foundation [009]	P	AR
062	E	05/09/2017	North and South trenches, post-ex, general view	L	AR
063	E	05/09/2017	North and South trenches, post-ex, general view	P	AR
064	W	05/09/2017	North and South trenches, post-ex, general view	P	AR
065	NW	05/09/2017	North and South trenches, post-ex, general view	L	AR
066	N	05/09/2017	South trench, post-ex, east end, detail, cut [019] and [021]	L	AR
067	NE	05/09/2017	South trench, post-ex, east end, detail, cut [019] and [021]	L	AR
068	W	05/09/2017	Building recording, east elevation	L	AR
069	NW	05/09/2017	Building recording, east elevation, north end	L	AR
070	N	05/09/2017	Building recording, east elevation, north passageway	P	AR
071	S	05/09/2017	Building recording, north east corner	L	AR
072	SW	05/09/2017	Building recording, north east corner	L	AR
073	SW	05/09/2017	Building recording, north elevation, east end	P	AR
074	SW	05/09/2017	Building recording, north elevation, east end	P	AR
075	E	05/09/2017	Building recording, west elevation	L	AR
076	NW	05/09/2017	Building recording, ground floor, foyer	L	AR
077	S	05/09/2017	Building recording, ground floor, lounge	L	AR
078	NW	05/09/2017	Building recording, ground floor, lounge	L	AR
079	SW	05/09/2017	Building recording, ground floor, lounge, detail of window	L	AR
080	N	05/09/2017	Building recording, ground floor, vestibule	P	AR
081	S	05/09/2017	Building recording, ground floor, vestibule	P	AR
082	N	05/09/2017	Building recording, ground floor, church hall	L	AR
083	S	05/09/2017	Building recording, ground floor, church hall	L	AR
084	E	05/09/2017	Building recording, ground floor, hallway	L	AR
085	NE	05/09/2017	Building recording, ground floor, church hall, stripped wall and fireplace	L	AR
086	N	05/09/2017	Building recording, ground floor, hallway	L	AR
087	NE	05/09/2017	Building recording, ground floor, kitchen	L	AR
088	SW	05/09/2017	Building recording, ground floor, kitchen	L	AR
089	E	05/09/2017	Building recording, ground floor, toilets	P	AR



090	NE	05/09/2017	Building recording, ground floor, toilets	L	AR
091	SW	05/09/2017	Building recording, ground floor, toilets	L	AR
092	N	05/09/2017	Building recording, ground floor, toilets	L	AR
093	S	05/09/2017	Building recording, ground floor, toilets	L	AR
094	W	05/09/2017	Building recording, ground floor, toilets	L	AR
095	N	05/09/2017	Building recording, ground floor, hallway, north end	P	AR
096	NW	05/09/2017	Building recording, ground floor, hallway, back door	P	AR
097	NE	05/09/2017	Building recording, ground floor, stairs	L	AR
098	N	05/09/2017	Building recording, ground floor, stairs	L	AR
099	W	05/09/2017	Building recording, ground floor, stairs	P	AR
100	E	05/09/2017	Building recording, ground floor, stairs	P	AR
101	N	05/09/2017	Building recording, first floor, meeting room	L	AR
102	S	05/09/2017	Building recording, first floor, meeting room	L	AR
103	SE	05/09/2017	Building recording, first floor, meeting room	L	AR
104	NE	05/09/2017	Building recording, first floor, meeting room, north window, detail	P	AR
105	S	05/09/2017	Building recording, first floor, hallway	P	AR
106	SW	05/09/2017	Building recording, first floor, boiler room	P	AR
107	W	05/09/2017	Building recording, first floor, small store	P	AR
108	E	05/09/2017	Building recording, first floor, office	P	AR
109	NW	05/09/2017	Building recording, first floor, office	L	AR
110	NE	05/09/2017	Building recording, first floor, office	L	AR
111	SE	05/09/2017	Building recording, first floor, store	L	AR
112	S	05/09/2017	Building recording, first floor, store	L	AR
113	W	05/09/2017	Building recording, first floor, store	L	AR
114	SW	05/09/2017	Building recording, first floor, store	L	AR
115	W	05/09/2017	Building recording, first floor, store	L	AR
116	W	05/09/2017	Building recording, first floor, store closet	L	AR
117	S	05/09/2017	Building recording, first floor, store closet	L	AR
118	NE	05/09/2017	Building recording, first floor, store closet	P	AR
119	NE	05/09/2017	Building recording, first floor, store	P	AR
120	N	05/09/2017	Building recording, first floor, hallway	P	AR
121	S	05/09/2017	Building recording, north elevation, west end	L	AR
122	SE	05/09/2017	Building recording, north elevation, west end	L	AR
123	-	13/09/2017	SF <014>, washing basin, outside	L	AR
124	-	13/09/2017	SF <014>, washing basin, inside	L	AR
125	-	13/09/2017	Find assemblage SF<015>	L	AR

*Appendix E    Photograph Contact Sheets*



2288 (001).JPG



2288 (002).JPG



2288 (003).JPG



2288 (004).JPG



2288 (005).JPG



2288 (006).JPG



2288 (007).JPG



2288 (008).JPG



2288 (009).JPG



2288 (010).JPG



2288 (011).JPG



2288 (012).JPG



2288 (013).JPG



2288 (014).JPG



2288 (015).JPG



2288 (016).JPG



2288 (017).JPG



2288 (018).JPG



2288 (019).JPG



2288 (020).JPG



2288 (021).JPG



2288 (022).JPG



2288 (023).JPG



2288 (024).JPG



2288 (025).JPG



2288 (026).JPG



2288 (027).JPG



2288 (028).JPG



2288 (029).JPG



2288 (030).JPG



2288 (031).JPG



2288 (032).JPG



2288 (033).JPG



2288 (034).JPG



2288 (035).JPG



2288 (036).JPG



2288 (037).JPG



2288 (038).JPG



2288 (039).JPG



2288 (040).JPG



2288 (041).JPG



2288 (042).JPG



2288 (043).JPG



2288 (044).JPG



2288 (045).JPG



2288 (046).JPG



2288 (047).JPG



2288 (048).JPG



2288 (049).JPG



2288 (050).JPG



2288 (051).JPG



2288 (052).JPG



2288 (053).JPG



2288 (054).JPG



2288 (055).JPG



2288 (056).JPG



2288 (057).JPG



2288 (058).JPG



2288 (059).JPG



2288 (060).JPG





2288 (061).JPG



2288 (062).JPG



2288 (063).JPG



2288 (064).JPG



2288 (065).JPG



2288 (066).JPG



2288 (067).JPG



2288 (068).JPG



2288 (069).JPG



2288 (070).JPG



2288 (071).JPG



2288 (072).JPG



2288 (073).JPG



2288 (074).JPG



2288 (075).JPG



2288 (076).JPG



2288 (077).JPG



2288 (078).JPG



2288 (079).JPG



2288 (080).JPG



2288 (081).JPG



2288 (082).JPG



2288 (083).JPG



2288 (084).JPG



2288 (085).JPG



2288 (086).JPG



2288 (087).JPG



2288 (088).JPG



2288 (089).JPG



2288 (090).JPG



2288 (091).JPG



2288 (092).JPG



2288 (093).JPG



2288 (094).JPG



2288 (095).JPG



2288 (096).JPG



2288 (097).JPG



2288 (098).JPG



2288 (099).JPG



2288 (100).JPG



2288 (101).JPG



2288 (102).JPG



2288 (103).JPG



2288 (104).JPG



2288 (105).JPG



2288 (106).JPG



2288 (107).JPG



2288 (108).JPG



2288 (109).JPG



2288 (110).JPG



2288 (111).JPG



2288 (112).JPG



2288 (113).JPG



2288 (114).JPG



2288 (115).JPG



2288 (116).JPG



2288 (117).JPG



2288 (118).JPG



2288 (119).JPG



2288 (120).JPG



2288 (121).JPG



2288 (122).JPG



2288 (123).JPG



2288 (124).JPG



2288 (125).JPG