

Woolsington Hall

Woolsington, Tyne and Wear

Watching Brief on Temporary Drainage: 27th January – 3rd February 2020

for

Cameron Hall Developments

February 2020



Excavating Trench 1, to the South East of the Hall

Addyman Archaeology

Archaeology Heritage Consultancy Architecture

Addyman Archaeology

The Old Printworks, 77a Brunswick Street, Edinburgh EH7 5HS
admin@addyman-archaeology.co.uk
0131 555 4678

Woolsington Hall

Woolsington, Tyne and Wear

Watching Brief : 27th January – 3rd February 2020

Job number 1964

February 2020

by Antoine Ruchonnet

Contents

Illustrations

Acknowledgements

Executive Summary

1.	<i>Introduction</i>	3
i.	<i>Background and previous work</i>	3
ii.	<i>Site location and setting</i>	3
2.	<i>Methodology</i>	5
3.	<i>Results</i>	6
i.	<i>Trench 1</i>	6
ii.	<i>Trench 2</i>	6
a.	<i>General</i>	6
b.	<i>Trench 2a (western trench)</i>	7
c.	<i>Trench 2b (eastern trench)</i>	7
iii.	<i>Trench 3</i>	8
4.	<i>Discussion</i>	9
	<i>References</i>	10
Appendix A	<i>Context Register</i>	11
Appendix B	<i>Drawings Register</i>	11
Appendix C	<i>Photograph Register</i>	12

Illustrations

List of Figures

Figure 1	Site location.	4
Figure 2	Site plan	5
Figure 3	Trench 2b, Features superimposed on existing plans	8

List of Plates

Plate 1	Trench 1, West end, North facing section	6
Plate 2	Trench 1, Sump, North facing section	6
Plate 3	Trench 2, Sump, South facing section	7
Plate 4	Trench 2a, Concrete 2007	7
Plate 5	Trench 2a, Drain 2010	7
Plate 6	Trench 2, East, Wall 2011	8
Plate 7	Trench 2, East, Foundations 2012, Downpipe 2013 and Wall 2014	8
Plate 8	Trench 3, Demolition 2016	9
Plate 9	Trench 3, Sump, East facing section	9

Unless otherwise stated, all content is the copyright of Simpson & Brown *Architects* with Addyman Archaeology.

Woolsington Hall

Woolsington, Tyne and Wear

Watching Brief

Executive Summary

Addyman Archaeology undertook a Watching Brief at the 17th century Listed Building of Woolsington Hall, Tyne and Wear, between the 27th January and the 3rd February 2020. These were the final works of Stage 2 archaeological monitoring and recording undertaken during demolition works following a major fire that gutted the interior of the building and in advance of the proposed redevelopment of the site. The excavations were undertaken for the installation of four French drains and three associated sumps to the north, west and south-east of the Hall. The excavations did not reveal any significant archaeological features to the south and west of the Hall. To the north, a concrete surface, stone and brick foundations, two brick walls and a downpipe recorded during the Historic Building Recording phase were re-excavated as part of the drainage works. A ceramic drain pipe running east to west, 4.5m north of the hall, was the only new feature encountered.

1. Introduction

i. Background and previous work

Addyman Archaeology undertook a Watching Brief at the 17th century Listed Building of Woolsington Hall, Tyne and Wear, between the 27th January and the 3rd February 2020 on behalf of Cameron Hall Developments. The works formed the final stage of archaeological works associated with Stage 2 demolition works at the Hall. The demolition works followed a major fire that gutted the interior of the building and were undertaken in advance of the proposed redevelopment of the site.

The Watching Brief was conducted during the excavation of drainage trenches around the Hall in accordance with a Written Scheme of Investigation (January 2018) outlining the Stage 2 works. Previous monitoring and recording works carried out as part of the Historic Building recording programme at the site are described in reports on the Stage 1 and 2 works (Addyman Archaeology 2017 and 2019).

A record of the watching brief (*OASIS ID: addymanal-385860*) has been deposited with the Online Access to the Index of Archaeological Investigations (OASIS) website hosted by the Archaeological Data Service.

ii. Site location and setting

Woolsington Hall is a Grade II* Listed Building located on the north-western outskirts of Newcastle upon Tyne, approximately 5km from the city centre (*figure 1*). The associated estate is approximately 110 ha (270 acres) in extent, and the Hall itself, with its ancillary buildings, are located at the northern edge of the estate. The estate boundary is bounded by a line of mature trees. The A696 passes close to the western boundary of the estate, which is accessed from points off the B6918. Newcastle International Airport is situated directly to the north of the estate.



Figure 1 Site location.

2. Methodology

The excavations were conducted in three areas: to the north, the west and the south-east of the Hall (*figure 2*). The ground breaking works were undertaken in order to install temporary French drains and sumps to soak away the water from the downpipes of the recently rebuilt roof. The drains consisted of one shallow 0.3m – 0.5m deep trench (two in the north) leading to a large deep pit backfilled with stones to serve as a sump.

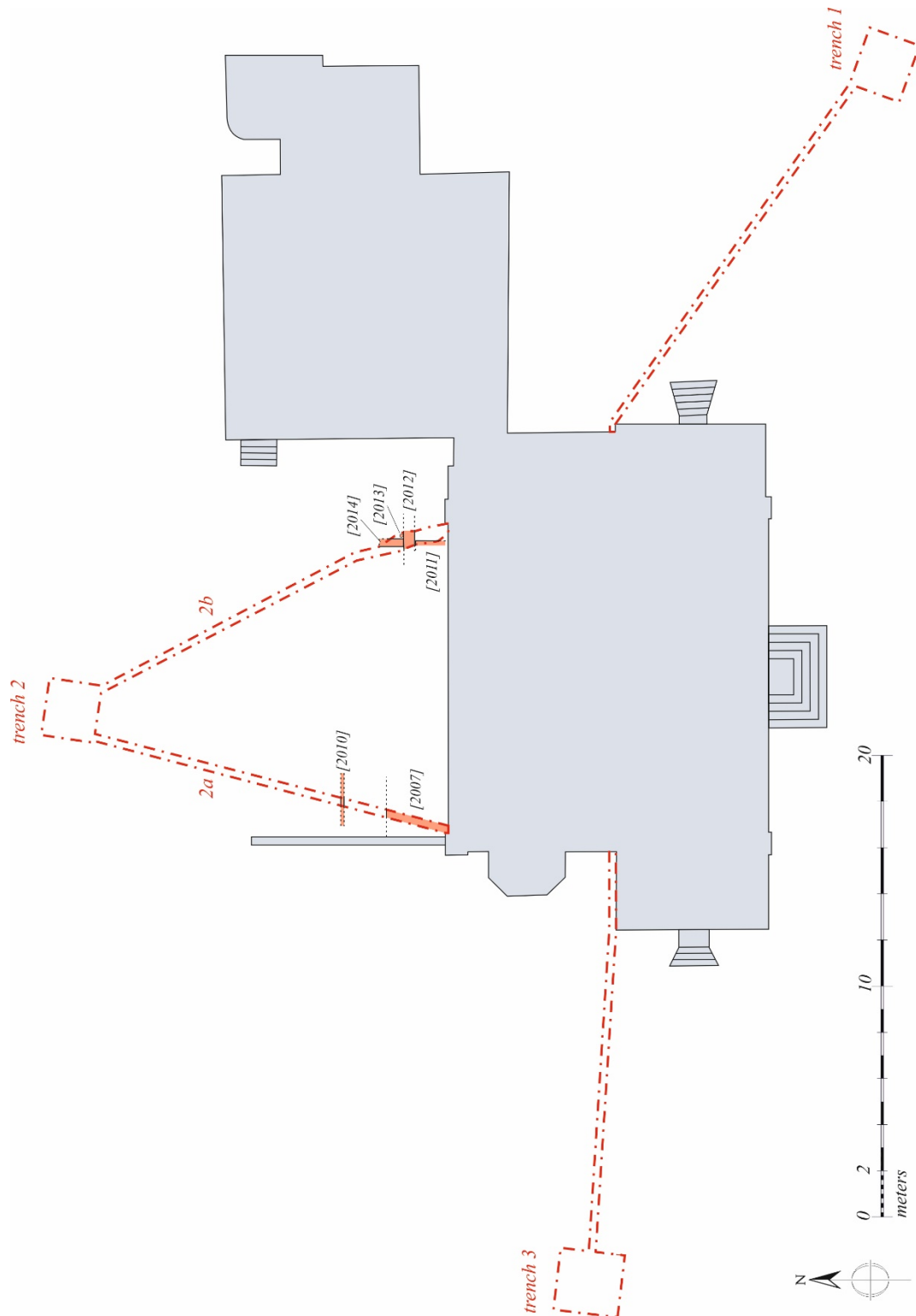

Figure 2 Site plan

3. Results

i. Trench 1

Trench 1 was aligned NW-SE and originated from approximately the centre of the east elevation of the Hall. The trench was 18m long, 0.3m wide and 0.5m deep. The sump was 2.5m by 2.3m and 1.2m deep.

The trench was excavated through an overlying stone horizon 2003 (0.15m thick) which had previously been laid by the contractors around the Hall during the works. The stone 2003 overlay dark brown – black topsoil 2004 (0.2m thick); this was over greyish brown – light brown gravelly clay 2001 with occasional CBM and sandstone fragments and char/coal nodules, interpreted as a construction horizon 2001 (*plate 1*). Between 8m and 15m from the north-west end, the trench was excavated through very disturbed surface slurry. The east end and the sump of Trench 1 was excavated through 0.3m of loamy topsoil 2000 and 0.3m of construction horizon 2001, which sealed the natural clay 2002 (*plate 2*).



Plate 1 Trench 1, West end, North facing section



Plate 2 Trench 1, Sump, North facing section

ii. Trench 2

a. General

Trench 2 comprised a large sump (2.5m by 2.3m and 1.5m deep) and two shallow trenches, which led from the two corners of the north elevation of the Hall. The western trench (2a) extended NNE from the north-west corner of the hall to the sump and measured 15.76m by 0.3m wide and 0.3-0.4m deep. The eastern trench (2b) extended NNW from the north-east corner of the hall to the sump and measured 17.16m by 0.3-0.6m and 0.4-0.6m deep.

Excavation of the sump revealed 0.25m of topsoil 2005, which overlay a 0.15m cinder horizon 2006; the cinder 2006 sealed the natural clay 2002 (*plate 3*).



Plate 3 Trench 2, Sump, South facing section

b. Trench 2a (western trench)

The southern end of Trench 2a was overlain with stone horizon 2003. Against the north elevation of the Hall, this stone 2003 covered a concrete pad 2007 (*plate 4*). The extent of the concrete 2007 east to west was not exposed but the pad was 2.7m wide and 0.2m thick. To the north of the concrete 2007, excavation proceeded through stone 2003 and construction horizon 2008, similar to construction horizon 2001 in Trench 1. The top of a salt glazed ceramic pipe drain was encountered 4.5m from the north elevation of the Hall. This drain 2010 runs east to west and was 0.15m in diameter, with no visible cut within construction horizon 2008 (*plate 5*). At 6.5m from the south end excavation revealed a heavily disturbed build-up 2009, created during the downtakings and emergency works. The last section of the trench, closest to the sump was excavated through topsoil 2005 and cinder 2006.



Plate 4 Trench 2a, Concrete 2007



Plate 5 Trench 2a, Drain 2010

c. Trench 2b (eastern trench)

A number of features were encountered at the southern end of Trench 2b, which had been previously exposed during the excavations and recording of the Hall and were backfilled only recently when the later extension to the Hall was demolished (*figure 3*). A brick wall 2011 bonded with pale brown mortar extended north-south at the southern end of the trench; three courses of stretchers were exposed (*plate 6*). This was a crosswall of the later extension to the Hall. Parallel to the western extent of the wall 2011 was a flagstone and brick foundation 2012, made of brick bonded with grey mortar and a single course of flagstone, which measured 0.5m wide. This was originally the north wall of the Hall extension. To the north of the foundations 2012 a 0.15m diameter ceramic downpipe 2013 was recorded, originally this would have been the corner between the north extension and the 20th century stairs, of which the surviving east wall was revealed as brick and concrete wall 2014. Wall 2014 was

exposed to a depth of three courses (*plate 7*); its east-west return was completely dismantled in 2019, along with all above ground masonry of the extension.



Plate 6 Trench 2, East, Wall 2011



Plate 7 Trench 2, East, Foundations 2012, Downpipe 2013 and Wall 2014

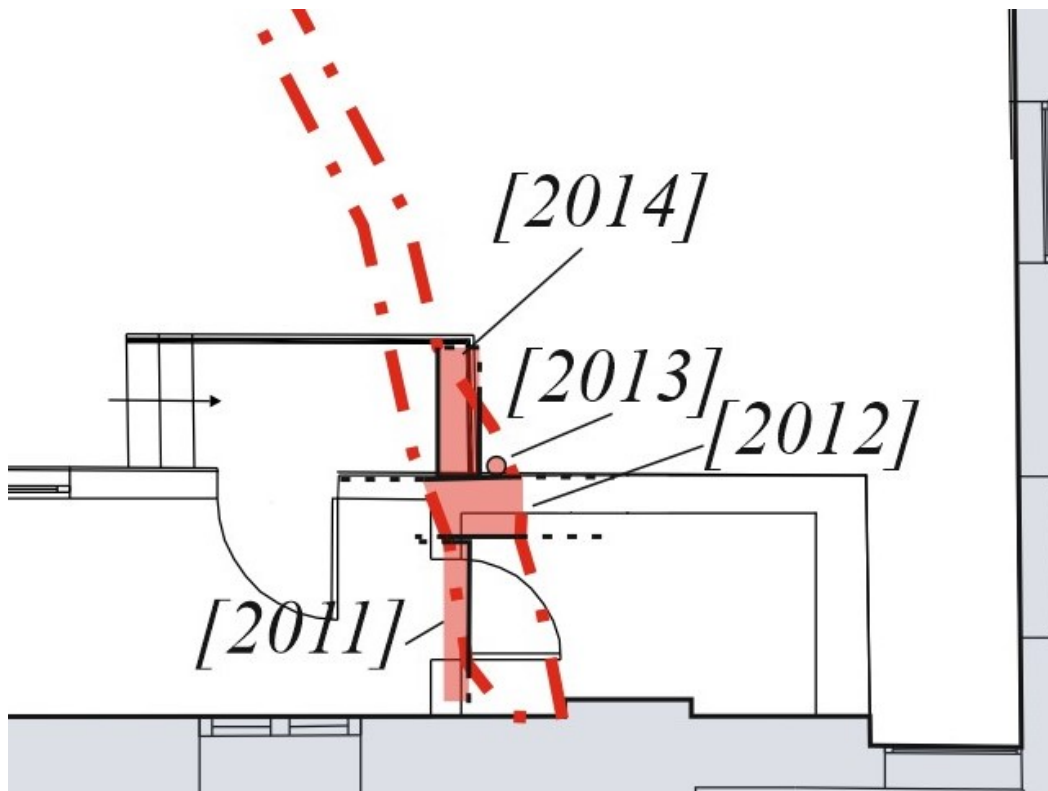

Figure 3 Trench 2b, Features superimposed on existing plans

iii. Trench 3

Trench 3 was aligned east-west and originated from approximately the centre of the east elevation of the Hall. The trench was 18.3m long, 0.3m wide and 0.2-0.8m deep. The sump at the west end measured 2.8m by 2.7m and was 1.6 deep.

Initial excavation of the trench was undertaken through loose demolition rubble 2016, which had built up against the west elevation of the Hall and was made up of bricks, burnt debris and rubbish (*plate 8*). Excavation stopped when the pre-fire ground level was reached. The demolition rubble 2016 extended for 4.39m from the eastern end of the trench; subsequent excavation was within stone 2003 and topsoil 2017 (similar to topsoil 2004 and 2005). The sump excavation was undertaken through

stone 2003 (0.3m thick) and topsoil 2017 (0.4m thick), which overlay natural clay 2002 (plate 9). As the sump was excavated through the main access road, both stone 2003 and topsoil 2017 were quite compacted here. It is possible that the topsoil 2017 in Trench 3 is a combination of the topsoil and a construction horizon, similar to that found in Trenches 1 and 2, which has been disturbed by the works and the vehicular traffic above. No archaeological features were noted within Trench 3.



Plate 8 Trench 3, Demolition 2016



Plate 9 Trench 3, Sump, East facing section

4. Discussion

The ground-breaking works for the installation of temporary French drains did not reveal any significant archaeological features. The few features discovered in Trench 2a on the north side of the Hall were previously recorded during the previous Historic Building recording Stage 2 works, prior to their backfilling. The area surrounding the Hall was quite heavily disturbed during the demolition works. The natural clay horizon is 0.3-0.7m deep around the Hall, depending on the amount of build-up created by the demolition and repair works.

References

Addyman Archaeology 2017 *Woolsington Hall, Woolsington, Tyne & Wear: Post-fire recording works, clearance and materials recovery*. Unpublished report on behalf of Cameron Hall Developments.

Addyman Archaeology 2019 *Woolsington Hall, Woolsington, Tyne and Wear. Phase 2 Post-fire Recording Works: Demolition, Clearance and Materials Recovery 2018-2019*. Unpublished report on behalf of Cameron Hall Developments.

Appendix A Context Register

Context No.	Building	Date	Initial	Description
2000	Trench 1	27/01/2020	AR	Topsoil. Moderate compaction, grey - dark brown loam
2001	Trench 1	27/01/2020	AR	Deposit. Compact, greyish brown - beige, clayey silt with frequent gravel, occasional CBM fragments, charcoal and yellow sandstone fragments
2002	Trench 1, 2, 3	27/01/2020	AR	Natural. Very compact, yellow brown clay with grey patches
2003	Trench 1, 2, 3	28/01/2020	AR	Deposit. Loose rubble spread, laid by contractors for drainage and stability around the hall
2004	Trench 1	28/01/2020	AR	Topsoil. Moderate compaction, dark brown - black topsoil, underneath spread (2003)
2005	Trench 2	30/01/2020	AR	Topsoil. Moderate compaction, dark brown - grey, silty loam, very disturbed during previous works with gravel, rubble, and CBM fragments
2006	Trench 2	30/01/2020	AR	Deposit. Loose black cinder/coal horizon over natural, possibly for drainage
2007	Trench 2	30/01/2020	AR	Structural. Linear, E-W, concrete pad, parallel to the hall
2008	Trench 2	30/01/2020	AR	Deposit. Moderate compaction, dark brown - black, clayey silt with CBM fragments
2009	Trench 2	31/01/2020	AR	Deposit. Very mixed built up area by contractors
2010	Trench 2	31/01/2020	AR	Structural. Linear, E-W, salt glazed ceramic pipe
2011	Trench 2	03/02/2020	AR	Structural. Linear, N-S turning E-W, brick and beige mortar wall
2012	Trench 2	03/02/2020	AR	Structural. Linear, E-W, flagstone and brick and grey mortar foundations
2013	Trench 2	03/02/2020	AR	Structural. Salt glazed ceramic downpipe, north of foundations [2012]
2014	Trench 2	03/02/2020	AR	Structural. Linear, N-S, brick and concrete wall
2015	Trench 2	03/02/2020	AR	Deposit. Loose, grey - brown sandy silt with high frequency of gravel
2016	Trench 3	03/02/2020	AR	Deposit. Loose, rubble from the fire and demolition on the west of Hall
2017	Trench 3	03/02/2020	AR	Topsoil. Compact, dark brown, clayey silt, appears quite mixed, but it is underneath the main access road

Appendix B Drawings Register

Dwg No.	Scale	Type	Date	Drawn by	Description
198	1:20	Plan	03/02/2020	AR	Plan of Trench 2, East, south end

Appendix C Photograph Register

Image No.	Original No.	Direction Facing	Date	Description
WB001	3278	N	27/01/2020	General view of Hall
WB002	3279	E	27/01/2020	General view of Hall
WB003	3280	W	27/01/2020	Trench 1, Pit, pre-ex
WB004	3281	W	27/01/2020	Trench 1, Pit, topsoil (2000) removed onto horizon (2001)
WB005	3282	W	27/01/2020	Trench 1, Pit, horizon (2001) removed onto natural (2002)
WB006	3283	S	27/01/2020	Trench 1, Pit, north facing section
WB007	3285	N	27/01/2020	Trench 1, Pit, south facing section
WB008	3286	S	27/01/2020	Trench 1, Pit, north facing section
WB009	3287	S	27/01/2020	Trench 1, Pit, north facing section
WB010	3288	W	27/01/2020	Trench 1, Pit, post-ex
WB011	3289	W	27/01/2020	Trench 1, Pit, post-ex
WB012	3290	W	27/01/2020	Trench 1, location
WB013	3291	W	27/01/2020	Trench 1, location
WB014	3292	NW	28/01/2020	Trench 1, pre-ex
WB015	3293	NW	28/01/2020	Trench 1, pre-ex
WB016	3294	NW	28/01/2020	Trench 1, pre-ex
WB017	3295	S	28/01/2020	Trench 1, removing rubble (2003)
WB018	3296	S	28/01/2020	Trench 1, north facing section, west end
WB019	3297	S	28/01/2020	Trench 1, north facing section, west end
WB020	3298	E	28/01/2020	Trench 1, slurry in east end
WB021	3299	N	28/01/2020	Trench 1, south facing section, centre west
WB022	3300	N	28/01/2020	Trench 1, south facing section, centre east
WB023	3301	SE	28/01/2020	Trench 1, post-ex

<i>Image No.</i>	<i>Original No.</i>	<i>Direction Facing</i>	<i>Date</i>	<i>Description</i>
WB024	3302	SE	28/01/2020	Trench 1, post-ex
WB025	3303	SE	28/01/2020	Trench 1, post-ex
WB026	3304	NW	28/01/2020	Trench 1, post-ex
WB027	3305	NW	28/01/2020	Trench 1, post-ex
WB028	3306	N	28/01/2020	Trench 1, south facing section, east
WB029	3307	S	30/01/2020	Trench 2, pre-ex
WB030	3308	SW	30/01/2020	Trench 2, pre-ex
WB031	3309	E	30/01/2020	Trench 2, Pit, topsoil (2005) removed onto horizon (2006)
WB032	3310	E	30/01/2020	Trench 2, Pit, horizon (2006) removed onto natural (2002)
WB033	3311	S	30/01/2020	Trench 2, Pit, north facing section
WB034	3312	N	30/01/2020	Trench 2, Pit, south facing section
WB035	3313	E	30/01/2020	Trench 2, Pit, topsoil (2005) with mixed rubble and gravel
WB036	3314	S	30/01/2020	Trench 2, Pit, post-ex
WB037	3315	SW	30/01/2020	Trench 2, Pit, post-ex
WB038	3316	NE	30/01/2020	Trench 2, West, pre-ex
WB039	3317	E	30/01/2020	Trench 2a, West, concrete [2007]
WB040	3318	W	30/01/2020	Trench 2a, West, east facing section, south end
WB041	3319	W	30/01/2020	Trench 2a, West, concrete [2007]
WB042	3319-2	NW	31/01/2020	Trench 2a, West, excavating through (2009)
WB043	3320	W	31/01/2020	Trench 2a, West, mixed deposit (2009)
WB044	3321	N	31/01/2020	Trench 2a, West, post-ex
WB045	3322	S	31/01/2020	Trench 2a, West, post-ex
WB046	3323	N	31/01/2020	Trench 2a, West, pipe [2010], within deposit (2008)
WB047	3324	E	31/01/2020	Trench 2a, West, west facing section, north end

<i>Image No.</i>	<i>Original No.</i>	<i>Direction Facing</i>	<i>Date</i>	<i>Description</i>
WB048	3325	E	31/01/2020	Trench 2a, West, west facing section, north end
WB049	3326	NW	03/02/2020	Trench 2b, East, post-ex
WB050	3327	SE	03/02/2020	Trench 2b, East, post-ex
WB051	3328	W	03/02/2020	Trench 2b, East, wall [2011]
WB052	3329	E	03/02/2020	Trench 2b, East, foundations [2012], pipe [2013] and wall [2014]
WB053	3330	W	03/02/2020	Trench 2b, East, wall [2011], foundations [2012], pipe [2013] and wall [2014]
WB054	3331	W	03/02/2020	Trench 2b, East, wall [2011], foundations [2012], pipe [2013] and wall [2014]
WB055	3332	W	03/02/2020	Trench 2b, East, wall [2011], foundations [2012], pipe [2013] and wall [2014]
WB056	3333	N	03/02/2020	Trench 2b, East, foundations [2012], pipe [2013] and wall [2014]
WB057	3334	N	03/02/2020	Trench 2b, East, foundations [2012], pipe [2013] and wall [2014]
WB058	3335	E	03/02/2020	Trench 2b, East, wall [2013]
WB059	3336	E	03/02/2020	Trench 2b, East, wall [2013]
WB060	3337	E	03/02/2020	Trench 2b, East, wall [2013]
WB061	3338	N	03/02/2020	Trench 2b, East, foundations [2012]
WB062	3339	W	03/02/2020	Trench 2b, East, east facing section, centre
WB063	3340	W	03/02/2020	Trench 2b, East, east facing section, north
WB064	3341	S	03/02/2020	Trench 3, removing rubble (2016)
WB065	3342	SE	03/02/2020	Trench 3, removing rubble (2016)
WB066	3343	SW	03/02/2020	Trench 3, removing rubble (2003)
WB067	3344	SW	03/02/2020	Trench 3, removing rubble (2003)
WB068	3345	N	03/02/2020	Trench 3, south facing section, centre east
WB069	3346	N	03/02/2020	Trench 3, south facing section, centre east
WB070	3347	N	03/02/2020	Trench 3, south facing section, centre west
WB071	3348	N	03/02/2020	Trench 3, south facing section, west

<i>Image No.</i>	<i>Original No.</i>	<i>Direction Facing</i>	<i>Date</i>	<i>Description</i>
WB072	3349	E	03/02/2020	Trench 3, post-ex
WB073	3351	W	03/02/2020	Trench 3, post-ex
WB074	3352	N	03/02/2020	Trench 3, south facing section, east
WB075	3353	NE	03/02/2020	Trench 3, Pit, west facing section
WB076	3354	NE	03/02/2020	Trench 3, Pit, west facing section
WB077	3355	N	03/02/2020	Trench 3, Pit, south facing section
WB078	3356	E	03/02/2020	Trench 3, Pit, west facing section
WB079	3357	W	03/02/2020	Trench 3, Pit, east facing section