

# Middletons, Cherry Tree Lane Bourton-on-Dunsmore Warwickshire

ARCHAEOLOGICAL OBSERVATION AND RECORDING



EXPERTISE WHERE YOU NEED IT

Archaeology Warwickshire Report No 1749  
JUNE 2017



*Working for  
Warwickshire*

**Project:** Middletons, Cherry Tree Lane Watching Brief  
**Commissioned by:** Paul Whittle  
**Project Report No.** 1749  
**Site Code:** BT17  
**Planning Reference:** R17/0034  
**National Grid Reference:** SP 2846 7236  
**Team:**  
**Project Manager:** Stuart Palmer MCIfA  
**Fieldwork:** Rob Jones  
**Author:** Pete Thompson BA  
**Illustrations:** Candy Stevens  
**Report checked by:** Stuart Palmer MCIfA  
**Date:** June 2017  
**Report reference:** Thompson, P, 2017 *Middletons, Cherry Tree Lane, Bourton-on-Dunsmore, Warwickshire: Archaeological Observation and Recording, Archaeology Warwickshire Report 1749.*

**Archaeology Warwickshire**

**Unit 9**

**Montague Road**

**Warwick**

**CV34 5LW**

**01926 412278**

**[fieldarchaeology@warwickshire.gov.uk](mailto:fieldarchaeology@warwickshire.gov.uk)**

**[www.warwickshire.gov.uk/archaeology](http://www.warwickshire.gov.uk/archaeology)**

## CONTENTS

	Summary	2
1	Introduction	3
2	Site Location	4
3	Archaeological and Historical Background	5
4	Aims and Methods	7
5	Results	8
6	Conclusions	9
	Acknowledgements	10
	References	11

## APPENDICES

A	List of Contexts	12
B	List of Finds	13

## PHOTOGRAPHS

1	Site location	14
2	View northwards showing ground reduction	14
3	Foundation trenches to east of existing house	15

## FIGURES

1	Location of application area and Historic Environment information
2	Detail from First Edition Ordnance Survey map of 1887
3	Location of trenches observed and recorded

## SUMMARY

*An archaeological watching brief was undertaken on behalf of Mr Paul Whittle during the groundworks for a new extension within the confines of the medieval village and close by cropmarks of probable prehistoric or Roman date.*

*No significant archaeological finds or deposits were recorded during the work. A small assemblage of post-medieval pottery was recorded and is considered typical for a village garden in the area.*

# 1 INTRODUCTION

- 1.1 Planning permission has been granted by Rugby Borough Council for the erection of front and rear extensions at Middletons, Cherry Tree Lane, Bourton-on-Dunsmore, Warwickshire, CV23 9QL (Ref. R17/0034). The development site lies within an area of archaeological potential within the probable extent of medieval settlement and it was therefore possible that archaeological remains might be disturbed during the development. A condition of planning permission required the applicant to secure the implementation of a programme of archaeological work to be carried out in conjunction with the development.
- 1.2 A programme of fieldwork, consisting of the archaeological observation of soil stripping and foundation trenches in accordance with advice by the County Planning Archaeologist on behalf of the Planning Authority, was commissioned from Archaeology Warwickshire and carried out in April 2017. This report presents the results of that work.
- 1.3 The project archive will be stored at the Warwickshire Museum under Site Code BT17, temporary accession number T/1241.
- 1.4 The work was carried out in accordance with the Chartered Institute for Archaeologists standard and Guidance for an archaeological watching brief (2014).

## 2 SITE LOCATION

- 2.1 The site is centred on National Grid Reference SP 4340 7058, in the centre of the village of Bourton-on-Dunsmore on the western side of Main Street, in the parish of Bourton and Draycote. Middletons lies on the south side of Cherry Tree Lane within a property which is bounded by other dwellings and gardens. The proposed development area covers an area of approximately 0.018 hectares.
  
- 2.2 The underlying geology of the area is Dunsmore Gravel (British Geological Survey 2017).

### 3 ARCHAEOLOGICAL AND HISTORICAL BACKGROUND

- 3.1 The site lies in an area identified as having archaeological potential including possible prehistoric activity, Roman remains and medieval settlement.

#### Prehistoric and Roman

- 3.2 The Warwickshire Historic Environment Record contains no records indicating pre-Roman activity in the vicinity of the development and no confirmed evidence of prehistoric, Roman period or Anglo-Saxon remains are known in Bourton-on-Dunsmore. However, the village lies to the south of a series of complex crop marks identified on aerial photographs (MWA 3175, 5396, 6801). These appear to consist of circular and rectangular enclosures and although their date remains unknown, their form suggests a likely prehistoric or Roman date.

#### Medieval

- 3.3 The probable extent of the medieval settlement at Bourton-on-Dunsmore (MWA 9495) has been deduced from layout of the village on the Ordnance Survey First Edition map and the site lies within this area: there are earthwork banks and ditched enclosures (MWA 3327) possibly associated with the medieval settlement. The church of St Peter at the southern end of main Street (MWA 3321) has 13th century origins with some 14th century rebuilding and major restoration in the 19th century.

#### Post-medieval

- 3.4 There are a number of Grade II Listed Buildings in the vicinity of the site:

#### Listed Buildings in the vicinity of the site

LB Reference	HER Ref (MWA)	Description	Date
1034967	2962	4 Main Street	17th century cottage
1185231	-	Potney Cottage /Spinney Cottage	18th century cottages
1034966	-	School House	19th century school house
1246630	-	Village Hall	19th century toll house
1034968	3319	Bourton Hall	18th century house and chapel
1185250	3321	Church of St Peter	13th century church

- 3.5 The Ordnance Survey First Edition map of 1887 shows an arrangement of buildings and an adjacent paddock or orchard.



## **4 AIMS AND METHODS**

- 4.1 The main aim of the work was to record any archaeological remains disturbed by the development, to collate the records in an archaeological archive and present the significant aspects of the archive in a report for dissemination.
- 4.2 The secondary aim was to form an understanding of the remains recorded in terms of their character and date, and to place the evidence in the context of Bourton-on-Dunsmore and any other local and regional context.
- 4.3 The objective of the work was a programme of supervised and recorded excavation to development formation levels, or the geological natural, whichever the higher.
- 4.4 The work undertaken involved the examination of early map evidence as well as records of archaeological remains in the area and local historical journals and other publications.
- 4.5 An experienced archaeologist was made available for each day of ground disturbance as notified by the client in accordance with WSI/Brief planning condition.

## 5 RESULTS

- 5.1 The watching brief was undertaken during the excavation of foundation trenches for the proposed extension. The trenches were 0.6m wide and between 1m to 1.4m deep. A very simple deposit sequence was revealed and no archaeological features were revealed.

### **Deposit sequence**

- 5.2 Geological natural yellow clay (3) was observed in all parts of the trenching.
- 5.3 A layer of yellowish brown clay loam (2) overlaid the natural clay. This was 0.3m thick and contained a small assemblage of post-medieval pottery. No archaeological features were associated with this deposit which very likely represents a former horticultural soil.
- 5.4 The sequence was sealed by a layer of very dark grey loam (1) which was 0.35m thick. The topsoil deposit contained occasional brick and tile fragments, none of which were retained.

## 6 CONCLUSIONS

- 6.1 No evidence for prehistoric or Roman activity was observed despite the proximity to cropmarks suspected as being of this date. This need not preclude there being any such evidence in the vicinity as the groundworks observed constitute a very small sample of the area.
- 6.2 No evidence for medieval Bourton-on-Dunsmore was revealed during the course of the archaeological work. This could imply the site lies in an area not developed at that time although, again, the sample was very small.
- 6.3 The small assemblage of post-medieval pottery could typically be recorded from a village garden, having derived from domestic disposal. The material is reworked within the topsoil through horticultural activity.

---

## **ACKNOWLEDGEMENTS**

Archaeology Warwickshire would like to thank Paul Whittle for commissioning the work.

## REFERENCES

British Geological Survey 1984 Geological Survey of Great Britain (England and Wales),  
Solid and Drift Geology, Warwick Sheet 200

Ordnance Survey 1887 *First Edition 1:2500 map*, Warwickshire Sheet 27

Ordnance Survey 1905 *Second Edition 1:2500 map*, Warwickshire Sheet 27

VCH 1951 *Victoria County History, Vol VI, Knightlow Hundred*, London

## APPENDICES

### A List of contexts

<b>Context</b>	<b>Description</b>	<b>Width (m)</b>	<b>Thickness (m)</b>	<b>Comment</b>
1	Very dark grey clay loam	-	0.35m	Topsoil
2	Yellowish brown clay loam	-	0.3m	Horticultural zone
3	Yellow clay	-		Geological natural

**B List of finds**

<b>Context</b>	<b>Description</b>	<b>Quantity</b>	<b>Type</b>	<b>Date</b>	<b>Comment</b>
<b>1</b>	Pottery	2	Pearlware (1), transfer printed glazed (1)	19th/20th century	Not retained
	Brick	1	Undiagnostic brick fragment	19th/20th century	Not retained
	Tile	2	Roof tile	Post-medieval	Not retained
<b>2</b>	Pottery	5	Creamware (1), Pearlware (1), Coareware (2), Mochaware (1)	18th to 19th century	Not retained



1 View northwards showing ground reduction



2 Foundation trenches





3. Foundation trenches to east of existing house

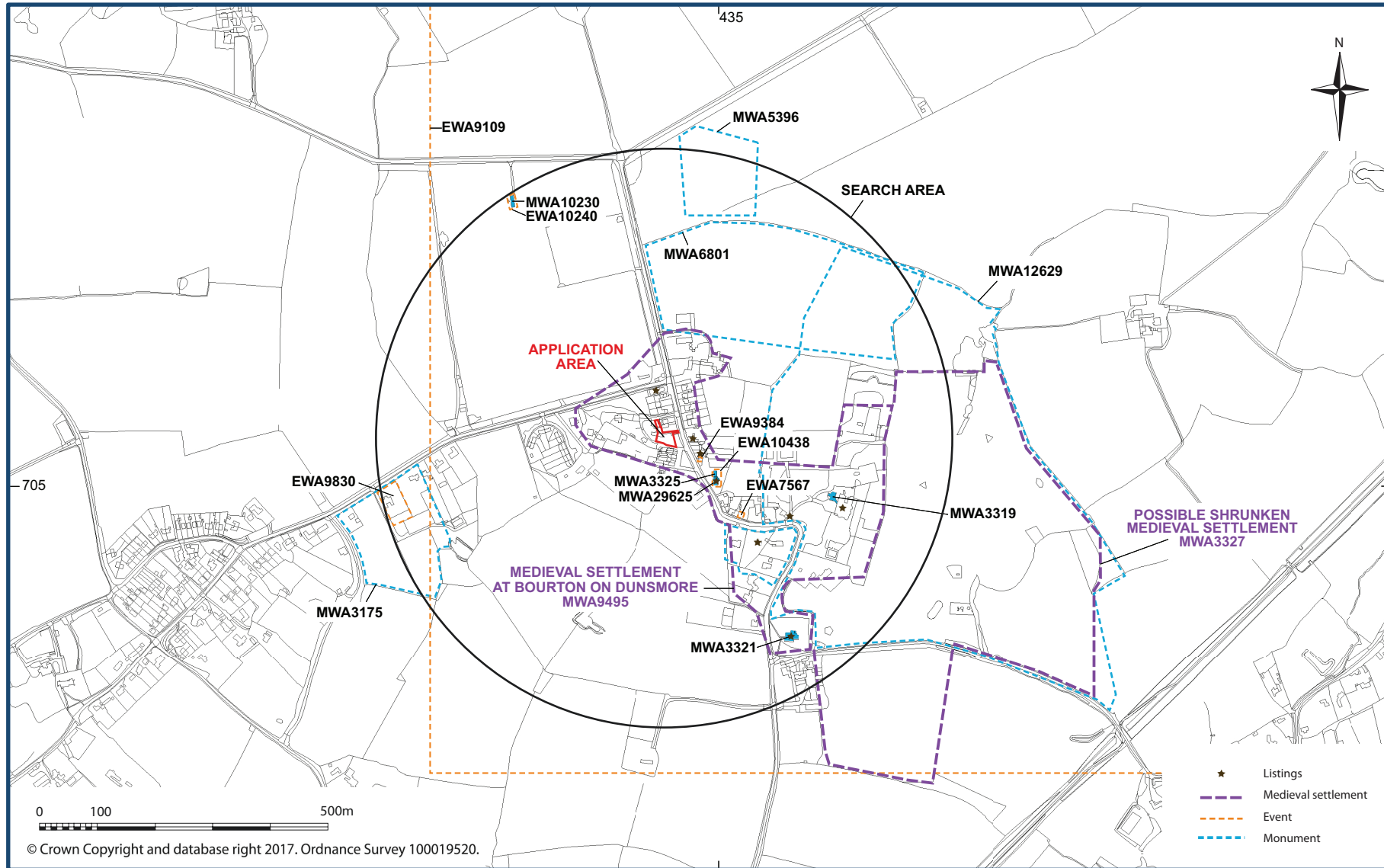

Fig 1: Location of application area and Historic Environment information



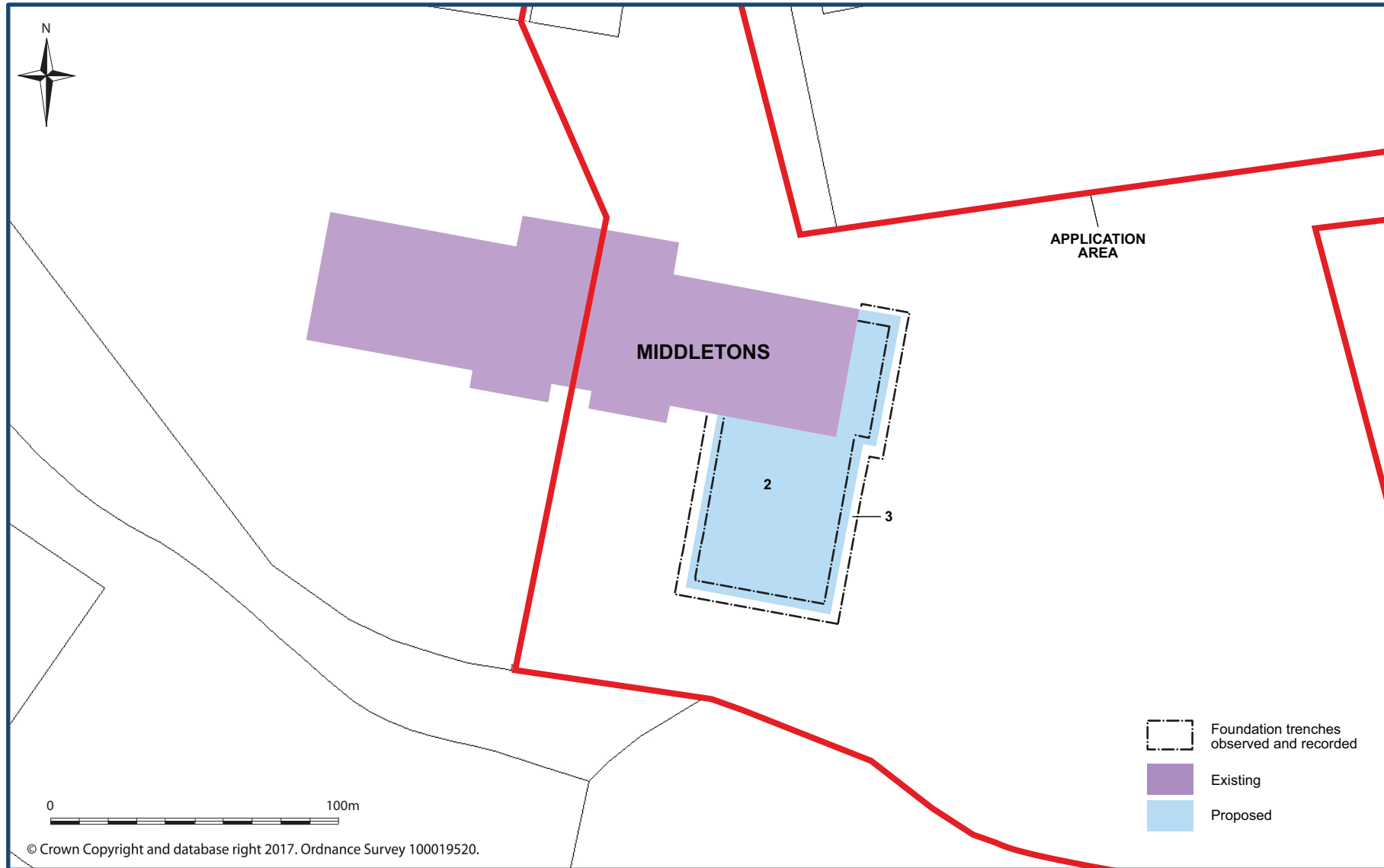

Fig 3: Location of trenches observed and recorded