

**MILNE'S CROFT
HUNTLY
ABERDEENSHIRE**



Standing Building Photographic Survey

Carried out July 31st, 2012

by

Murray Archaeological Services Ltd



Report No: MAS 2012-24

by

H K Murray and J C Murray

H K Murray BA, PhD, MIFA, FSA Scot

J C Murray BA, MIFA, FSA Scot, FMA

Hill of Belnagoak, Methlick, Ellon, Aberdeenshire AB41 7JN

Telephone: (01651) 806394 e-mail: cmurray@btinternet.com

MILNE'S CROFT
HUNTLY
ABERDEENSHIRE

- Standing Building Photographic Survey -

1. Background
 - 1.1 A standing building photographic survey was required for Milne's Croft, W of Ordbrae, Huntly, prior to its demolition.
 - 1.2 The archaeological condition was applied in the context of planning legislation (PAN 2/2011, SPP, SHEP), which states that it is necessary for developers to arrange for archaeological work to take place prior to development, in appropriate circumstances.
Planning Application Number: APP/2012/2225
Grid Reference: NJ 5001 4171
SMR No: NJ54SW0046
 - 1.3 A Photographic Survey was required which includes photographs of the building and its setting with an annotated plan to show the location of the photographs.
 - 1.4 Murray Archaeological Services Ltd was commissioned to undertake the work by John Wink, John Wink Design, and the site element of the survey was completed on 31st July 2012.
 - 1.5 The buildings comprised a cottage (11 x 5m) lying E/W and the foundations and part of the walls of a steading 22.3 x 5m lying E/W. These would appear to be the two buildings shown on the 1888 OS map according to the SMR. The steading was SW of the house and 22.7m from the SW corner of the house to the NE corner of the steading. The cottage was lacking most of the E gable

and could not be entered. Interiors were photographed through the door and windows. The steading was mostly only a foundation but parts of the N and W walls remains to a maximum of 1.75m. It had originally comprised a structure c13m long, with an additional 9m long addition added to the E end. No openings were visible.

Appendix 1: Photographic archive

A full set of photographs with the photo location plan will be supplied on CD to the Aberdeenshire SMR in Aberdeen and to the NMRS.

The positions of all photographs are indicated on Illus 1 and in the catalogue below.

Digital frame	Content
1-4	S elevation from SW
5-6	S elevation from SE
7	S elevation, W window and door
8-10	W elevation
11-12	N elevation from NE
13	N elevation, W end
14	N elevation, E end
15-18	N elevation from W including outshot
19-21	E elevation from N
22-24	E elevation from E
25-26	Garden enclosure to E of E gable
27-28	Setting of cottage from E looking SSW. The ruined steading in trees marked by ranging rods
29-31	Interior E room from E gable looking W
32	E room looking S through N window
33-39	Interior of W room through W window in S wall. Shows fireplace with swey and cupboard

40	Interior through door looking N showing wooden partition
41	Interior through door looking NE
42-47	Ruined steading from N
48-49	Ruined steading NW corner
50	Setting of steading with house behind and Bin Forest in background
51-52	Cottage setting, from SE

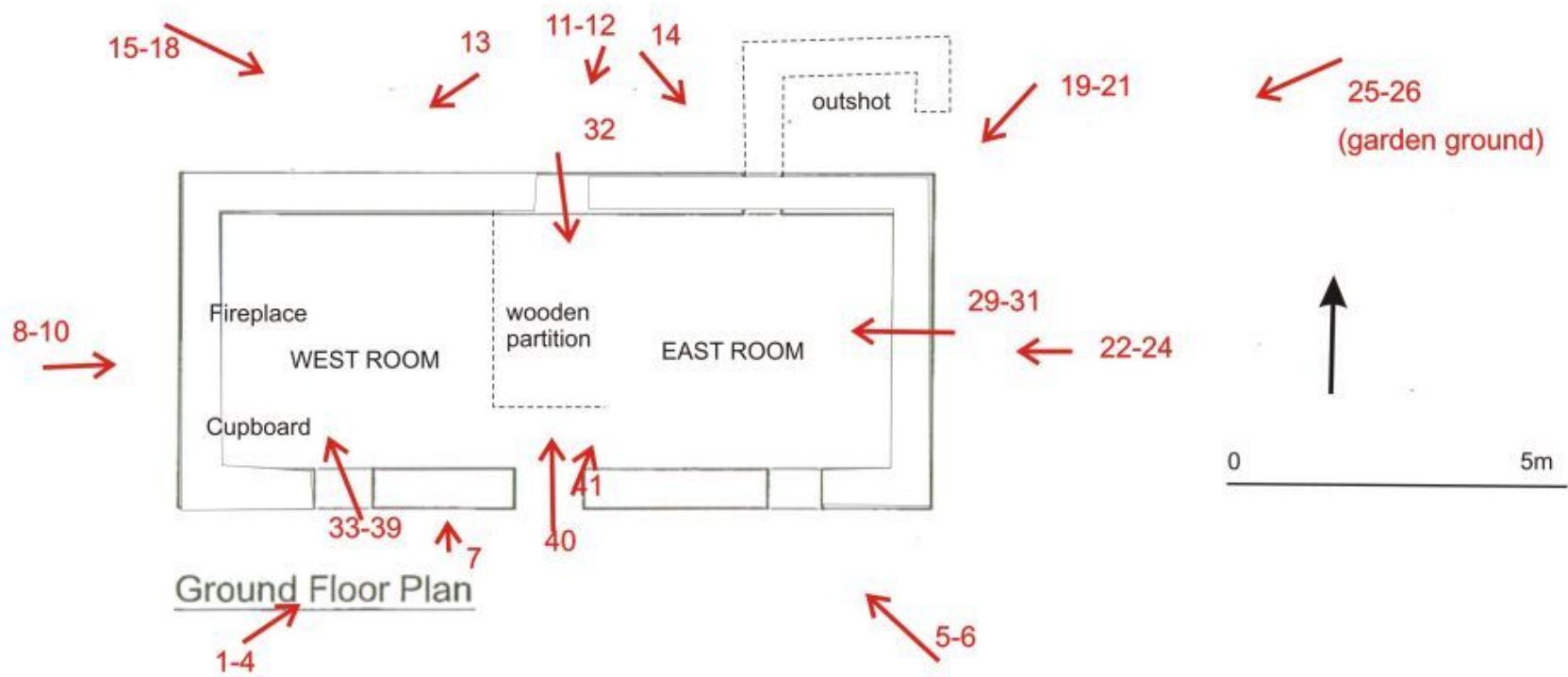

Illus 1 Annotated plan with photograph numbers (Based on plan supplied by courtesy of John Wink Design)

