

**WESTFIELD COTTAGE  
MILLTIMBER  
ABERDEEN**



**- Archaeological Watching Brief -  
Carried out 21<sup>st</sup> April and 15<sup>th</sup> May 2014  
by  
Murray Archaeological Services Ltd**



**Report No: MAS 2014-3**  
by

J C Murray

H K Murray BA, PhD, MIFA, FSA Scot  
J C Murray BA, MIFA, FSA Scot, FMA  
Hill of Belnagoak, Methlick, Ellon, Aberdeenshire AB41 7JN  
Telephone: (01651) 806394 e-mail: cmurray@btinternet.com

**WESTFIELD COTTAGE  
MILLTIMBER  
ABERDEEN**

- Archaeological Watching Brief -

J C Murray

1. Background

- 1.1 A proposal for the replacement of a dwelling and expansion of the residential curtilage at Westfield Cottage, Contlaw Road, Milltimber, Aberdeen, was approved, subject to a planning condition (Planning Application No: P121352 – Condition 1) stipulating that no work shall take place until the applicant has secured the initiation of a programme of archaeological work in accordance with a written scheme of investigation approved by Aberdeen City Council. The condition states that: ‘No development shall take place within the application site until the applicant has secured the implementation of a written scheme of investigation which has been submitted by the applicant and approved by the Planning Authority – in the interests of protecting items of historic importance as may exist within the application site’.
- 1.2 The Condition was applied in the context of PAN (Planning Advise Note) 2/2011, SPP and SHEP, which states that it is necessary for developers to arrange for archaeological work to take place prior to development, in appropriate circumstances. Following discussions with Judith Stones, Lead Curator, Local History and Archaeology, Aberdeen City Council, it was decided that an archaeological watching brief during ground disturbance would be appropriate.

1.3 Murray Archaeological Services Ltd was commissioned by William Lippe Architects Ltd, on behalf of their client, Mr Drummond Whiteford, to undertake the work, which was carried out on 21<sup>st</sup> April and 15<sup>th</sup> May 2014.

## 2. THE SITE

2.1 Westfield Cottage is located on the N side of the A93 and Contlaw Road, Milltimber. It lies to the E side of Beans Hill, an area rich in archaeological sites which includes cairnfields, hut circles, cup marked stones and rig and furrow cultivation. It also lies in close proximity to several Aberdeen City boundary stones.

NMRS NO: NJ80SW 50

NGR: NJ 8544 0346

Parish: Peterculter



**Illus 1: Map showing site location circled in red. © Crown Copyright. All rights reserved License No.100049810.**

### 3. The Watching Brief

- 3.1 Almost all of the central area of the site had been occupied by the previous cottage which had been demolished and cleared prior to the commencement of the watching brief. In effect this only left two small areas to be observed, on the W side of the site (Area 1) and the vehicle access road on the E side (Area 2).
- 3.2 The soil strip of the areas observed was carried out by a full-slew mechanical digger using a 2m wide toothless ditching bucket.



**Illus 2: View of the central area of the site, looking NW to Area 1.**

- 3.3 The grassed area on the NW side of the site measured c.19m (N-S) x c.12m (E-W), which had been a garden area of the former cottage (Area 1, Illus.3). The grass and topsoil removed was 250mm deep and overlay hard, very stoney, beige natural. No archaeological features or finds were evident.
- 3.4 On the E side of the site the area of the access road observed measured c.13m x c.2m (Area 2, Illus.3). Only c.150-200mm of grass and topsoil overlay light brown-yellow natural mixed with stone and very large boulder.

No archaeological features or finds were evident.

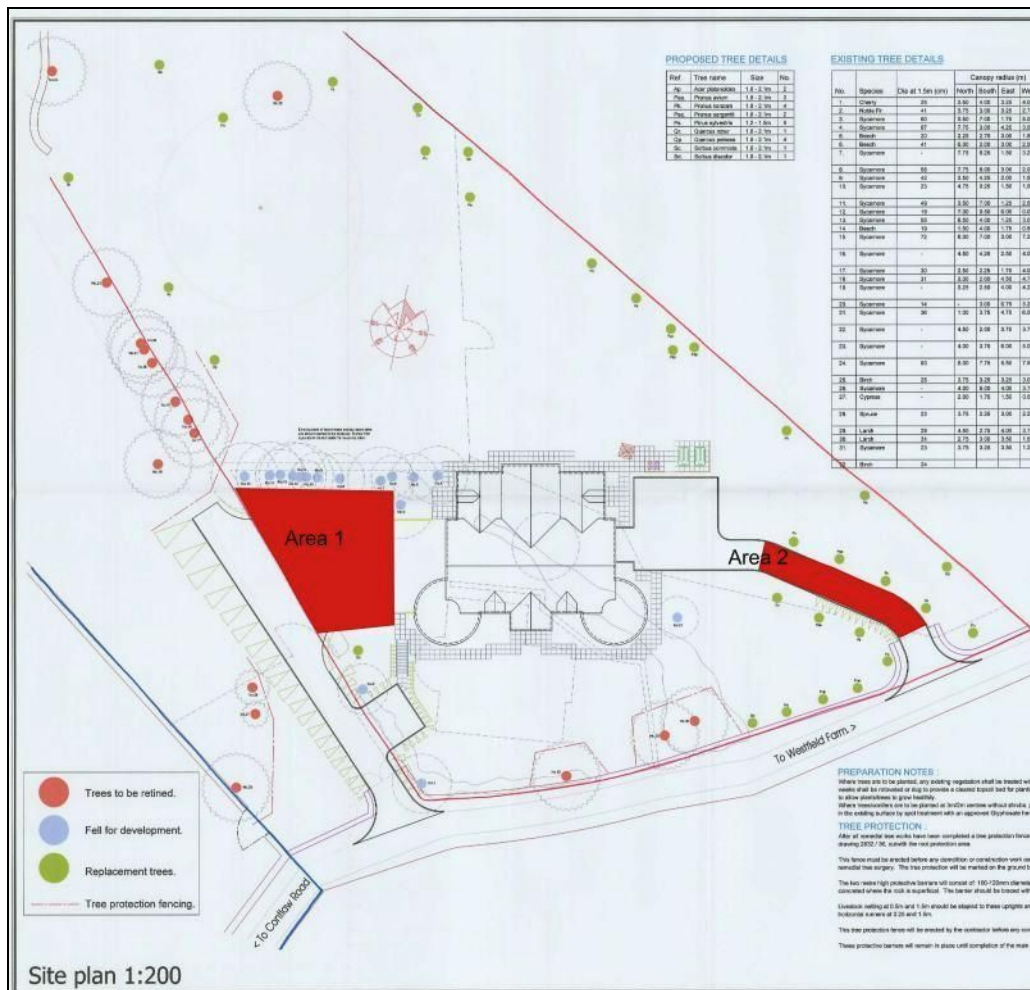

Illus 3: Site Plan, showing Areas 1 and 2



Illus 4: Area 1, after soil strip, looking N



**Illus 5: Area 2, looking W**



**Illus 6: Area 2, looking E**

#### 4. Results

- 4.1 The demolition of the previous cottage on the site left only two small garden areas relatively undisturbed.
- 4.2 No archaeological features or finds were observed in either area.

**Catalogue of Digital Photographs (Supplied to Archive)**

- 1 Site entrance, looking NE
- 2 Area 1, before excavation, looking SE
- 3 As 2, looking E
- 4-10 Area 1, before excavation, looking W
- 11 E area of site
- 12-14 Area 1, W side of site, looking N
- 15-16 Central area of site, looking E
- 17-19 Area 2, looking NW
- 20 Area 2, looking SE
- 21-23 Central area of site following excavation
- 24 Area 2, looking SE
- 25 Detail of Area 2, looking NW