

**PLOT 2, MONBODDO  
FORDOUN  
ABERDEENSHIRE**



**- Archaeological Watching Brief -**

Carried out 16<sup>th</sup> January 2014  
by  
**Murray Archaeological Services Ltd**



**Report No: MAS 2014-9**  
by  
H K & J C Murray

H K Murray BA, PhD, MIFA, FSA Scot  
J C Murray BA, MIFA, FSA Scot, FMA  
Hill of Belnagoak, Methlick, Ellon, Aberdeenshire AB41 7JN  
Telephone: (01651) 806394 e-mail: cmurray@btinternet.com

**PLOT 2, MONBODDO  
FORDOUN  
ABERDEENSHIRE**

**- Archaeological Watching Brief –**

**H K & J C Murray**

**1. Background**

- 1.1 A planning application for the erection of two houses on land adjacent to 3, Mondoddo, Fordoun, Aberdeenshire, was granted planning permission in principle (Planning Ref: APP/2011/3025) subject to conditions. Condition 13 required that an archaeological watching brief be carried out prior to the soil strip over the footprint of the houses and their associated access tracks. The site is divided into two plots and this report refers to the watching brief carried out on Plot 2.
- 1.2 The Conditions were applied in the context of PAN (Planning Advise Note) 2/2011, SPP and SHEP.
- 1.3 Murray Archaeological Services Ltd was commissioned by Mr E and Mrs J Giles, to undertake the work which was carried out 16<sup>th</sup> January 2014.

**2. THE SITE**

- 2.1 The site is located to the E of Auchenblae (NGR: NO 7453 7833; Parish: Fordoun), bounded to the E by the Nursery Burn and on its S and W sides by unclassified roads (Illus.1).

- 2.2 The building plot lies c.50m NE of Monboddo House [NMRS No: NO77NW 15], a 16<sup>th</sup> century manor house which may have replaced an earlier building in the same location.
- 2.3 To the NW and N lie two cropmark sites, the first, to the NW, showing possible ring ditches [NMRS No: NO77NW 43; Aberdeenshire SMR Ref: NO77NW0034], and the second, to the N, shows possible prehistoric or mediaeval enclosures [NMRS No: NO77NW 44, Aberdeenshire SMR Ref: NO77NW0025].

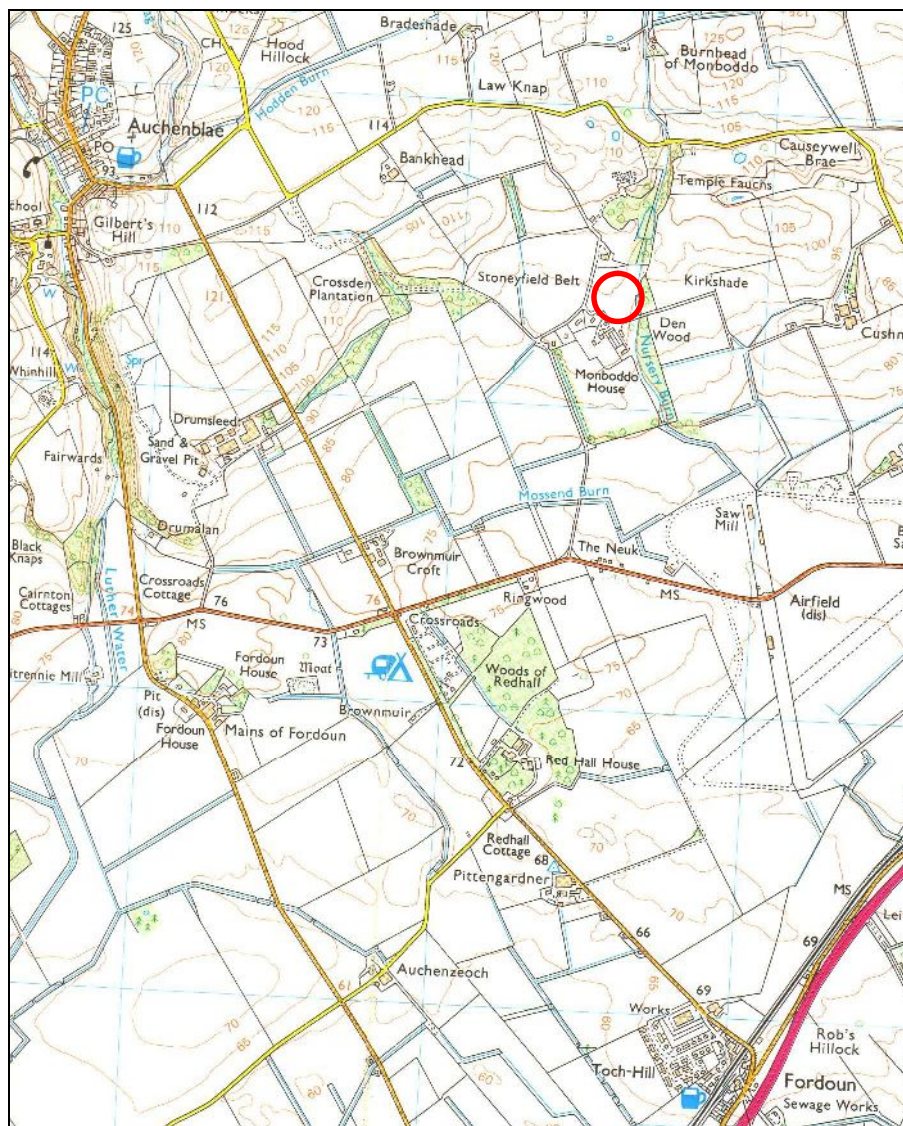

Illus 1: Map with location of the site marked in red. © Crown Copyright. All rights reserved  
License No.100049810

### 3. The Watching Brief

- 3.1 The soil strip was carried out using a full-slew mechanical digger with a toothless ditching bucket. The area observed was confined to the footprint of the new house and the access route at the W end of the plot. The remainder of the plot was undisturbed as it is being used for recreational and gardening purposes.

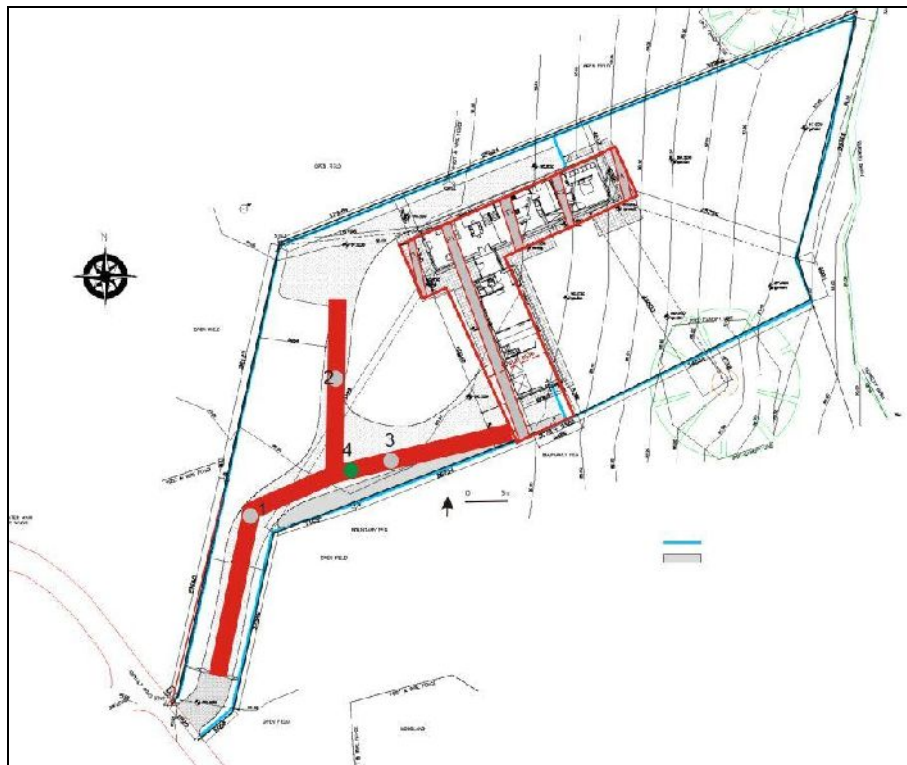

**Illus 2: Plan showing the areas of soil strip observed outlined in red, no's 1-3. No.4 (in green) is a modern service pipe.**

- 3.2 The area of the footprint of the house measured c.28m, E-W and c.27m N-S x c.6m wide. A 2m wide trench was excavated along the lines of the access tracks (see Illus.2). The depth of grass and topsoil removed varied between 550 – 600mm over the footprint of the house and c.350mm over the access

track. The underlying natural was reddish sandy clay typical of the Mearns.

- 3.3 Rig and Furrow: Five rows of rig and furrow were visible crossing the footprint of the house running N-S (see Illus.3)

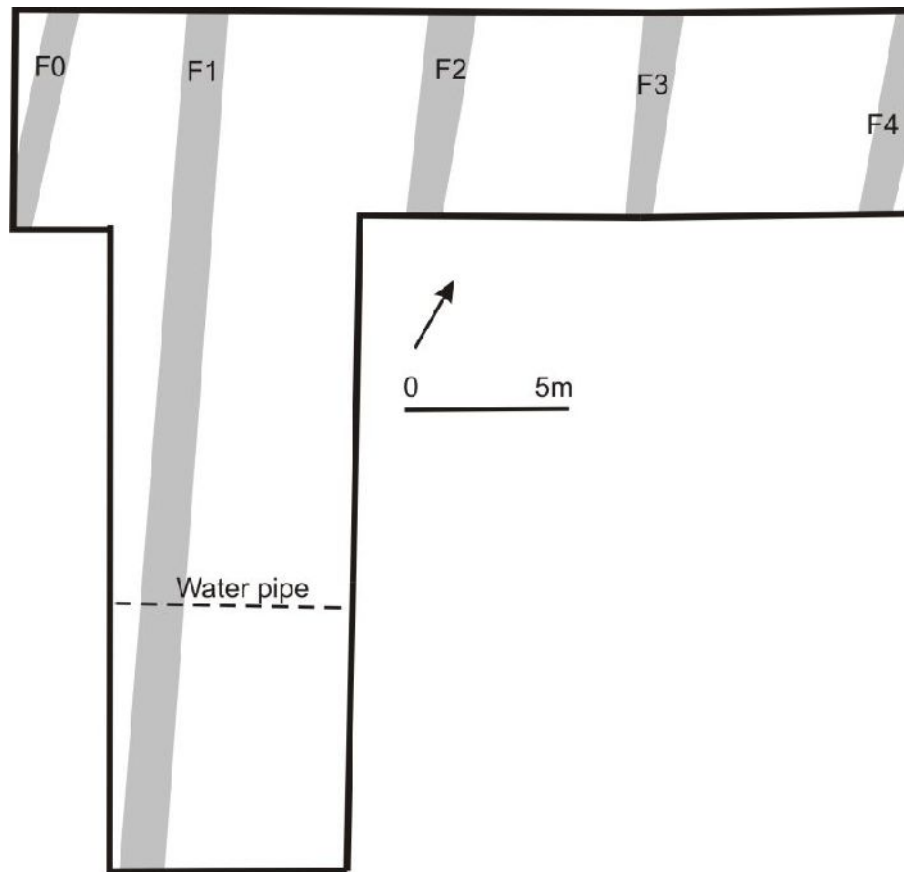

**Illus 3: Plan showing the lines of rig and furrow on house footprint**

Furrows F1 to F4 were all c.6.6m apart, c.900mm to 1.3m wide and varying between 550 – 600mm below grass level. The exception was F0 which was only 4.3m distant from F1 by 1m wide. It is possible that F0 marks a boundary on the W side.

- 3.4 Possible lines of furrow were also observed crossing the access track numbered 1, 2 and 3 (Illus.2).

## 4. Results

- 4.1 With the exception of the rig and furrow cultivation no other archaeological features or finds were evident.





**Illus 4: View of house footprint with rig and furrow marked by ranging poles, looking E**



**Illus 5: View of furrow, F1, looking S**



**Illus 6: View of access track, looking NE**

**Catalogue of Digital Photographs (Supplied to Archive)**

1-2	View across soil strip of house footprint, with ranging poles laid along the lines of the rig and furrow, looking E
3-5	As 1-2 above, looking S
6	As 1-2, above, looking W
7-8	Views across soil strip to Monboddo House, looking SE
9	General view across site, looking E
10	General view across soil strip, looking N
11-12	Views across soil strip of access track, looking N and NE

## *Discovery & Excavation in Scotland Entry*

<b>LOCAL AUTHORITY:</b>	Aberdeenshire
<b>PROJECT TITLE/SITE NAME:</b>	Plot 2, Monboddo, Fordoun, Aberdeenshire
<b>PROJECT CODE:</b>	MAS 2014-9
<b>PARISH:</b>	Fordoun
<b>NAME OF CONTRIBUTOR:</b>	H K & J C Murray
<b>NAME OF ORGANISATION:</b>	Murray Archaeological Services Ltd
<b>TYPE(S) OF PROJECT:</b>	Watching Brief
<b>NMRS NO(S):</b>	
<b>SITE/MONUMENT TYPE(S):</b>	
<b>SIGNIFICANT FINDS:</b>	Rig and Furrow
<b>NGR (2 letters, 8 or 10 figures)</b>	NO 7453 7833
<b>START DATE (this season)</b>	16 <sup>th</sup> January 2104
<b>END DATE (this season)</b>	16 <sup>th</sup> January 2014
<b>PREVIOUS WORK (incl. DES ref.)</b>	
<b>MAIN (NARRATIVE) DESCRIPTION:</b> (May include information from other fields)	A watching brief was maintained prior to the building of a new house. The site lies in close proximity to Monboddo House (NMRS No: NO77NW 15), a 16 <sup>th</sup> century manor house which may have replaced an earlier building in the same location. Traces of rig and furrow cultivation survived below the footprint of the house and the access track. No other archaeological features or finds were evident
<b>PROPOSED FUTURE WORK:</b>	
<b>CAPTION(S) FOR ILLUSTRS:</b>	
<b>SPONSOR OR FUNDING BODY:</b>	Mr and Mrs Giles
<b>ADDRESS OF MAIN CONTRIBUTOR:</b>	Hill of Belnagoak, Methlick, Ellon, Aberdeenshire AB41 7JN
<b>EMAIL ADDRESS:</b>	<a href="mailto:cmurray@btinternet.com">cmurray@btinternet.com</a>
<b>ARCHIVE LOCATION (intended/deposited)</b>	Archive to be deposited in NMRS. Report and photographs deposited in Aberdeenshire SMR