

MARYWELL
STONEHAVEN ROAD
ABERDEENSHIRE



Standing Building Survey
Carried out 23rd April 2015
by
Murray Archaeological Services Ltd



Report No: MAS 2015-17
by
H K Murray and J C Murray

H K Murray BA, PhD, MCifA, FSA Scot
J C Murray BA, MCifA, FSA Scot, FMA
Hill of Belnagoak, Methlick, Ellon, Aberdeenshire AB41 7JN
Telephone: (01651) 806394 e-mail: cmurray@btinternet.com

MARYWELL
STONEHAVEN ROAD
ABERDEENSHIRE

- Standing Building Survey -

1. Background
 - 1.1 A standing building survey was required for buildings at Marywell, Stonehaven Road, Aberdeenshire, prior to their demolition and the construction of a mixed use development.
 - 1.2 The archaeological condition was applied in the context of planning legislation (PAN 2/2011, SPP, SHEP), which states that it is necessary for developers to arrange for archaeological work to take place prior to development, in appropriate circumstances. Planning Application Numbers: APP/2013/3235.
 - 1.3 A Level 1 Standing Building Survey was required which includes measured plans and elevations, a written account of the building's plan, form, function, age and development sequence in addition to a photographic survey of the interior and exterior of the building.
 - 1.4 Murray Archaeological Services Ltd was commissioned to undertake the work by D4 Developments (UK) Ltd. The site element of the survey was completed on the 23rd April 2015.
2. Desk-top survey
 - 2.1 A search was carried out in the Sites and Monuments Record, Archaeology Service, Aberdeenshire Council and in the Sites and Monuments Records of the Royal Commission for Ancient and Historic Monuments in Scotland (RCAHMS) through Canmore and Pastmap.
 - 2.2 The 1st and 2nd edition Ordnance Survey maps were consulted.

3. The Site

3.1 The site lies adjacent to the Marywell Park Homes on Wellington Road, E of the A90.

Parish: Banchory-Devenick NGR NO 9304 9904

Aberdeenshire SMR: NO99NW0066

NMRS NO99NW 7 Canmore id: 184028

4. Documentary evidence

4.1 **Kincardine Sheet VIII.2 (combined) 1865 (pub 1868)** shows two buildings lying at right angles to the road; the larger N building being L-shaped with a narrower building to the S with two short projections on the N facade. A horse mill is shown on the W end of the N building.



Illus 1 Detail of the 1st edition Ordnance Survey 25" map, surveyed in 1865 (published 1868) Kincardine sheet VIII.2 www.nls.ac.uk

4.2 By the 2nd edition 25"/mile Ordnance Survey of 1902 (published 1903. **Kincardineshire 007.15**) the original N building remains and has an additional E wing and another building abutting its NW corner. The S building

has been replaced or partially rebuilt to a wider, rectangular plan. A dwelling house has been built SW of the steading.

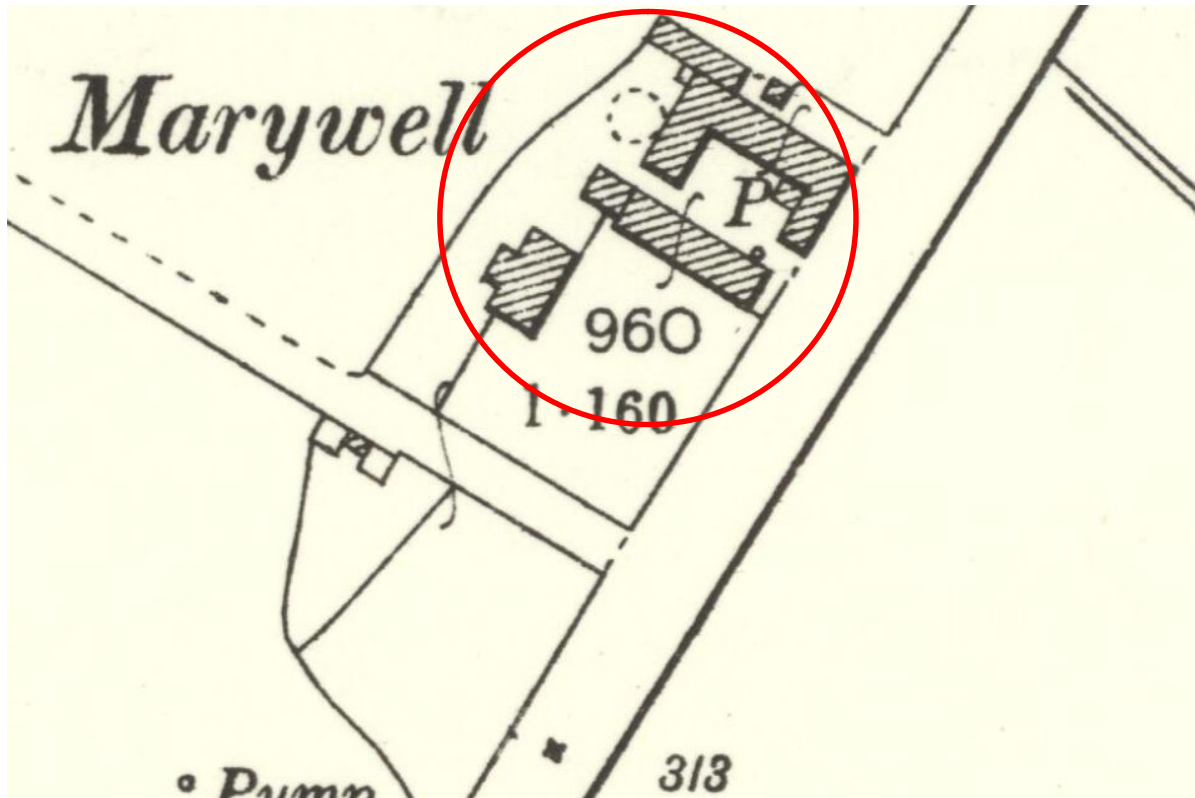

Illus 2 Detail of the 2nd edition 25"/mile Ordnance Survey of 1902 (published 1903. Kincardineshire 007.15) www.nls.ac.uk

4.3 By the revision of 1923 (published 1925. Kincardineshire 007.15) the buildings remain, with the horse mill removed and a number of small additions abutting the NW of the N building.

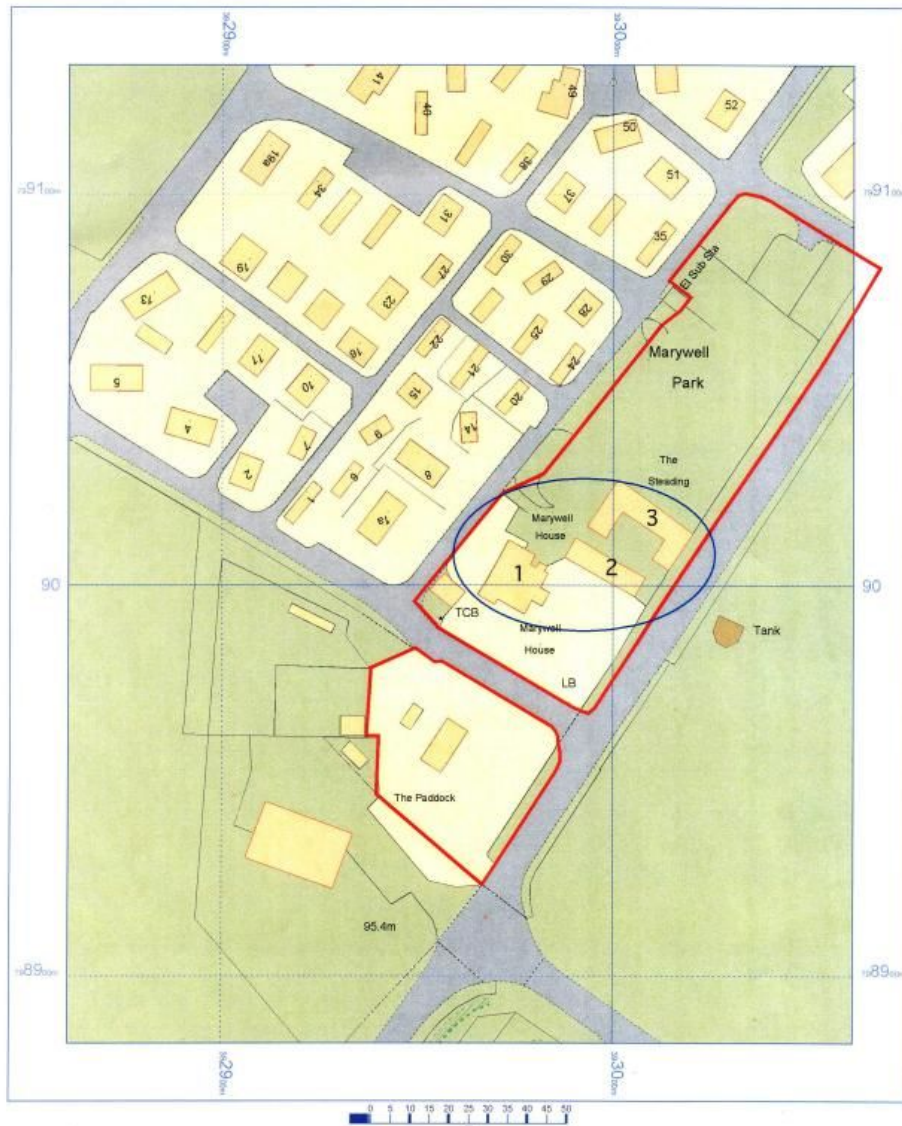

Illus 3 Location plan supplied by client

5 Methodology

- 5.1 The ground plans (illus 4) and elevations (illus 15, 16) were drawn by MAS Ltd and have been annotated to show details which may help in understanding the development and history of the building.
- 5.2 The areas recorded were photographed. The full set of photographs will be supplied for the archive and an annotated plan in the present report (illus 17) indicates the position of each.

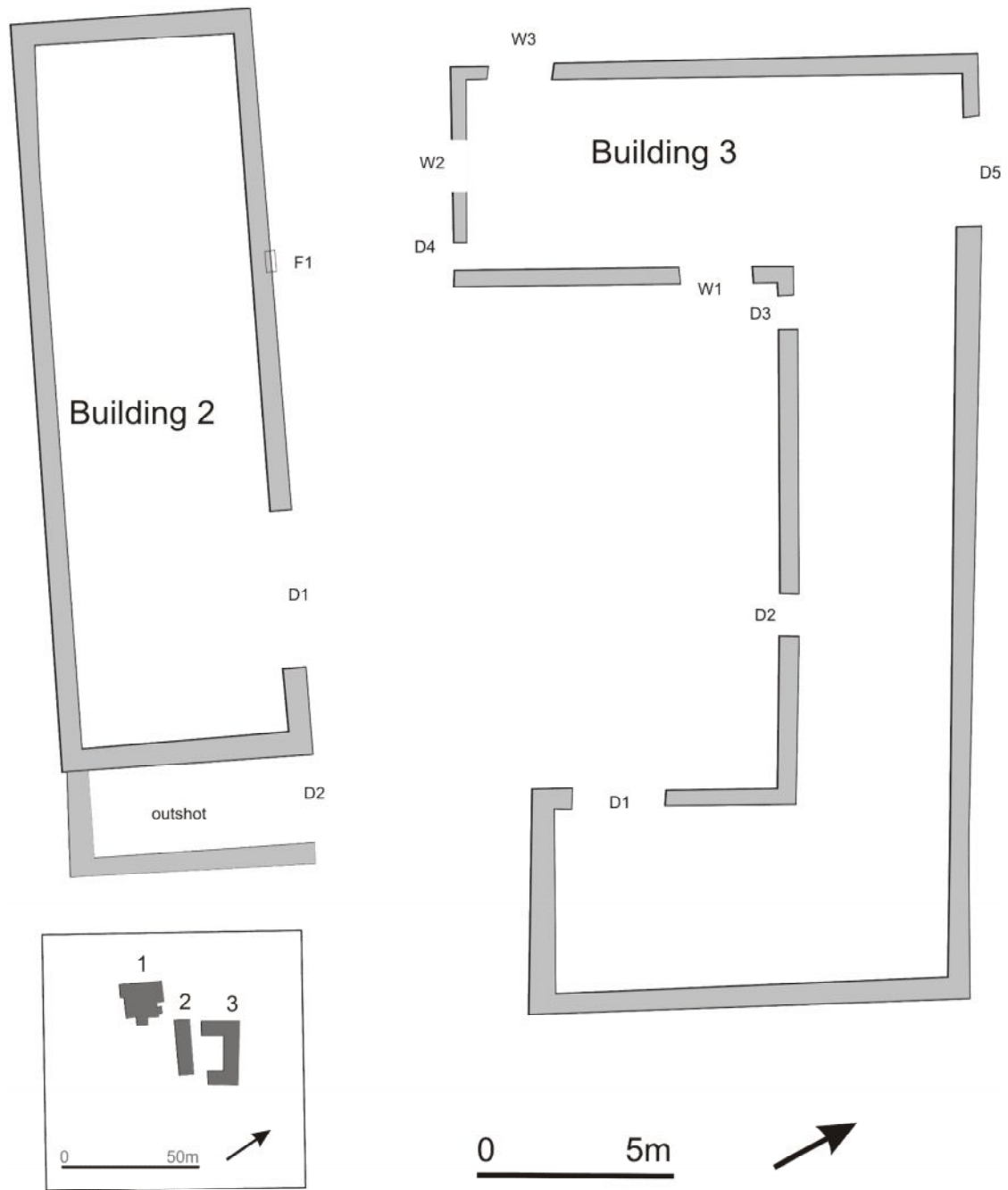

Illus 4 Plan. Inset shows steading (Buildings 2 & 3) in relation to house (Building 1)



Illus 5 General view looking ENE (Photo 7)

6 The Buildings

Three buildings were within the survey area. Building 1, the dwelling house lay to the W of the steading. It was not planned in detail as very little of the original fabric was visible.



Illus 6 Building 1. House. E elevation (Photo 26)

6.1 DWELLING HOUSE: BUILDING 1 (ILLUS 4)

Dimensions c. 7.5m x 11.5m externally (the original core), with several modern additions.

Present/recent use Dwelling

Original use Dwelling

Walls The original parts of walls built of squared rough dressed rubble stone. Additions harled- probably concrete blockwork.

Roof Slate on main building and part of additions. One outshot with corrugated iron roof.

Chimneys Rectangular granite with plain table. Ceramic pots.

Windows and doors All windows and doors were modern replacements. Not detailed.



Illus 7 Building 1. House. S elevation. (Photo 28)



Illus 8 Building 1. House. N elevation. (Photo 30)

6.2 SOUTH STEADING BUILDING : BUILDING 2 (ILLUS 4)

Dimensions 18.85m E/W (21.65m including outshot at E end) x c 6m N/S
externally

Present/recent use Storage and garage. Access to E end only but too full for
any detailed recording.



Illus 9 Building 2. S steading. Internal view of internal wall and part of loft at E end (Photo 2)

Original use The E end had had a loft and may have been a grain store.

Walls Stone, externally harled so no detail of blockings. Thickness: c550mm.

E outshot appears to be harled concrete blocks.

Roof Slate. E outshot corrugated iron.



Illus 10 Building 2. S steading. N elevation. (Photo 20)



Illus 11 Building 2. S steading. S elevation. (Photo 24)

Doors and windows

N wall

D1 W: 4.2m H: 2.75m Sliding metal doors.

D2 Into outshot. W: 2.35m H: 1.70m Wooden door.

F1 Bulge in foundation course of stones between 6m and 7m from W end could indicate an opening or a former wall but does not tally with anything on early OS maps.

E wall Gable. No features.

W wall Gable. No features.

S wall Modern garage door and 'shed' door at W end within garden of house. Not surveyed.

6.3 NORTH STEADING BUILDING : BUILDING 3 (ILLUS 4)

Dimensions Irregular U-plan. c.24m E/W x 5.5m width externally.

Present/recent use Central part had been in use as Gallery and had been lined out (No access). W range in use as store (No access).

Original use The size suggests that most of this had been in use for livestock. The 1865 and 1902 OS maps indicate a horse mill attached to the W gable.

Walls Well coursed squared stone. The stone only visible at S and E elevations, the remainder harled. Estimated thickness: 500mm.

Roof Slate



Illus 12 Building 3. N steading. S wall main block. F1 to RHS of ranging rod. (Photo 6)



Illus 13 Building 3. N steading. E wall of W range. Shows window W1 built in earlier opening. (Photo 12)

Doors and windows

E wall To road. No features.

S wall E range. Gable. No features

W wall E range

D1 W: 2.4m H: 2.05m Hinged metal door. Concrete lintel.

S wall main block

D2 W: 1.05m H: 1.85m Granite lintel.

D3 W: 1.05m H: 1.85m Granite lintel.

F1 Vertical join in wall (illus 16)

E wall W range

W1 W:1.85m H: 1.35m Modern window set into full height original opening-possibly cart opening (illus 13).

S wall W range

D4 W:0.95m H: 1.86m Modern door

W2 W: 1.80m H:1.27m. Modern window (illus 16)

W wall W range

W3 W: 1.80m H:1.27m. Modern window

N wall

D5 W: 3m H: 2.6m . Modern door in gable.



Illus 14 Building 3. N steading. N elevation with house (Building 1) beyond on RHS. (Photo 18)

7 Discussion

In its original form this appears to have been a moderate/small steading. The position of the original house in 1865 is unclear and may have been in the original S building. The N and W wings of the N steading building (Building 3) are shown however and are therefore of early/mid 19th century date. There was a horse mill at the W end.

By 1903 the house (Building 1) had been built and was originally a fairly substantial rectangular block with a projecting extension on the W side. At the same time the S steading building (Building 2) appears to have been rebuilt or partially rebuilt on the present plan. As the exterior was harled and most of the interior inaccessible, it was not possible to determine any building phases. The N steading building remained, with the E range added by this stage. A number of additional buildings abutting the N building are shown both on the 1902 and 1923 maps. None of these survive today. By 1923 the horse mill had disappeared, possibly reflecting the increased use of mechanical threshers with the shortage of horses after WW1.

8 Archive

A full set of photographs with the photo location plan (Illus 17) will be supplied to the Aberdeenshire SMR in Aberdeen and to the NMRS.

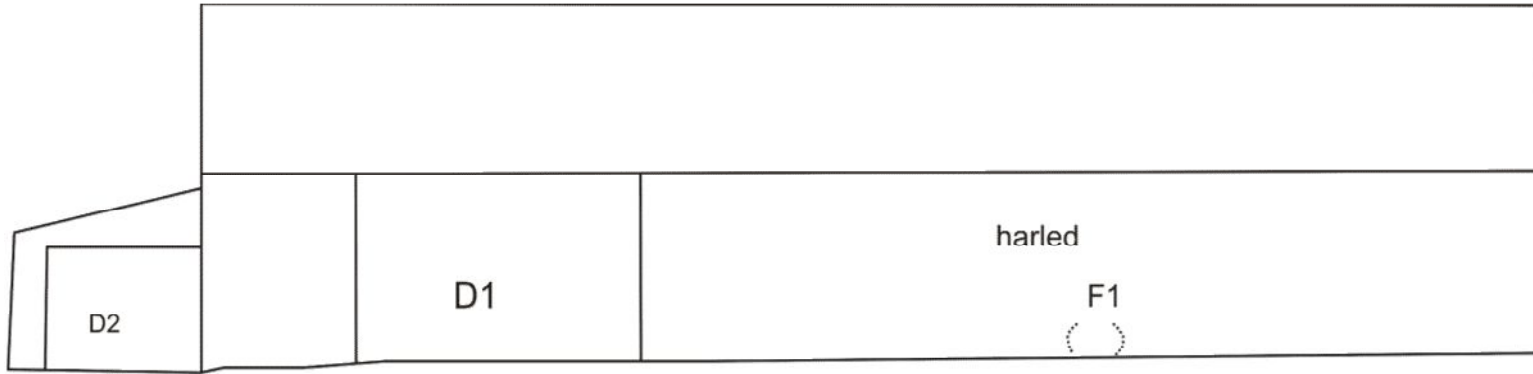

NORTH ELEVATION

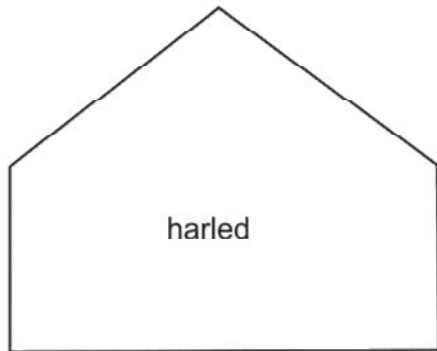

WEST ELEVATION



Illus 15 Elevations of Building 2 (South stading)

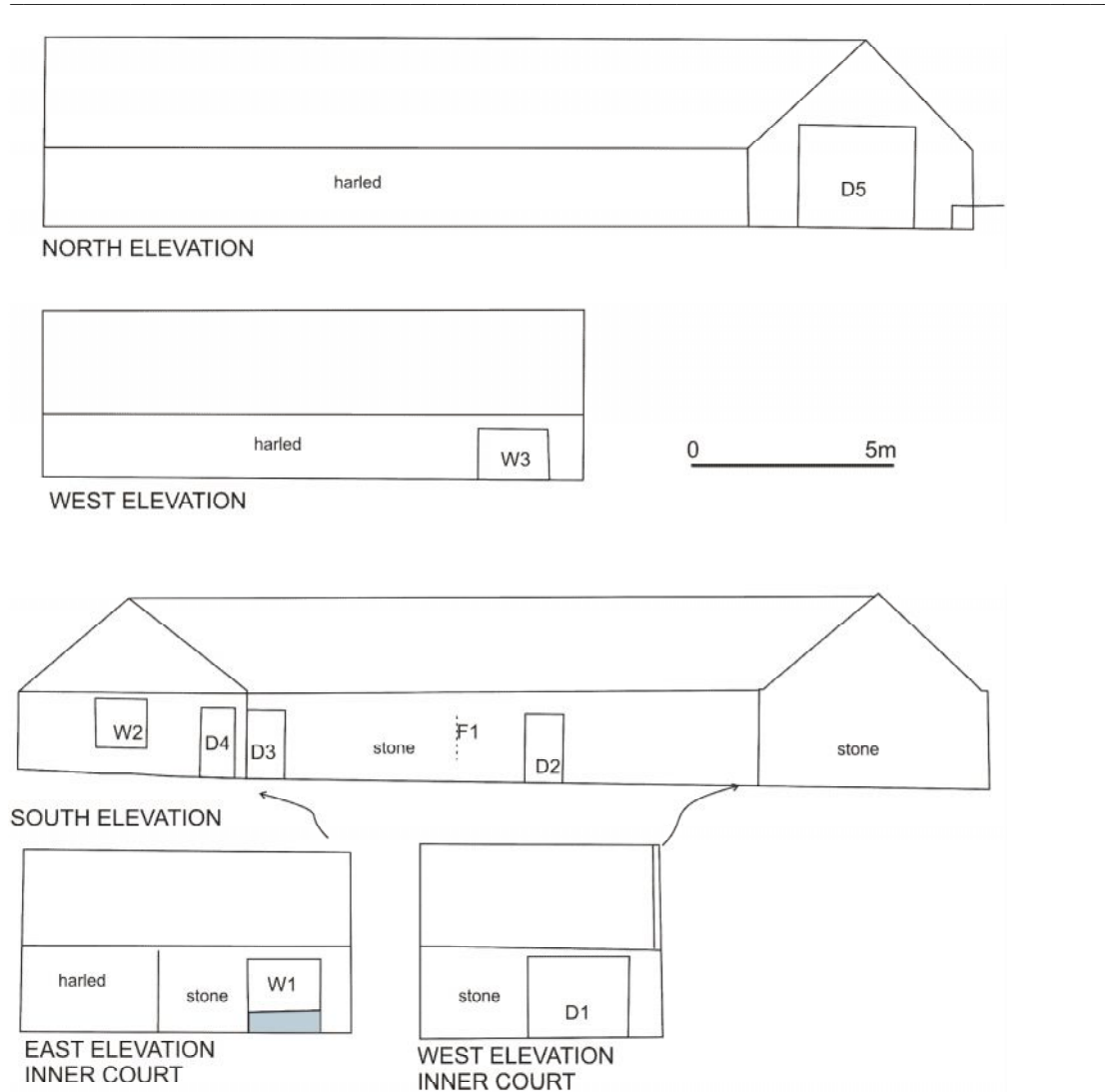

Illus 16 Elevations of Building 3 (North steading)

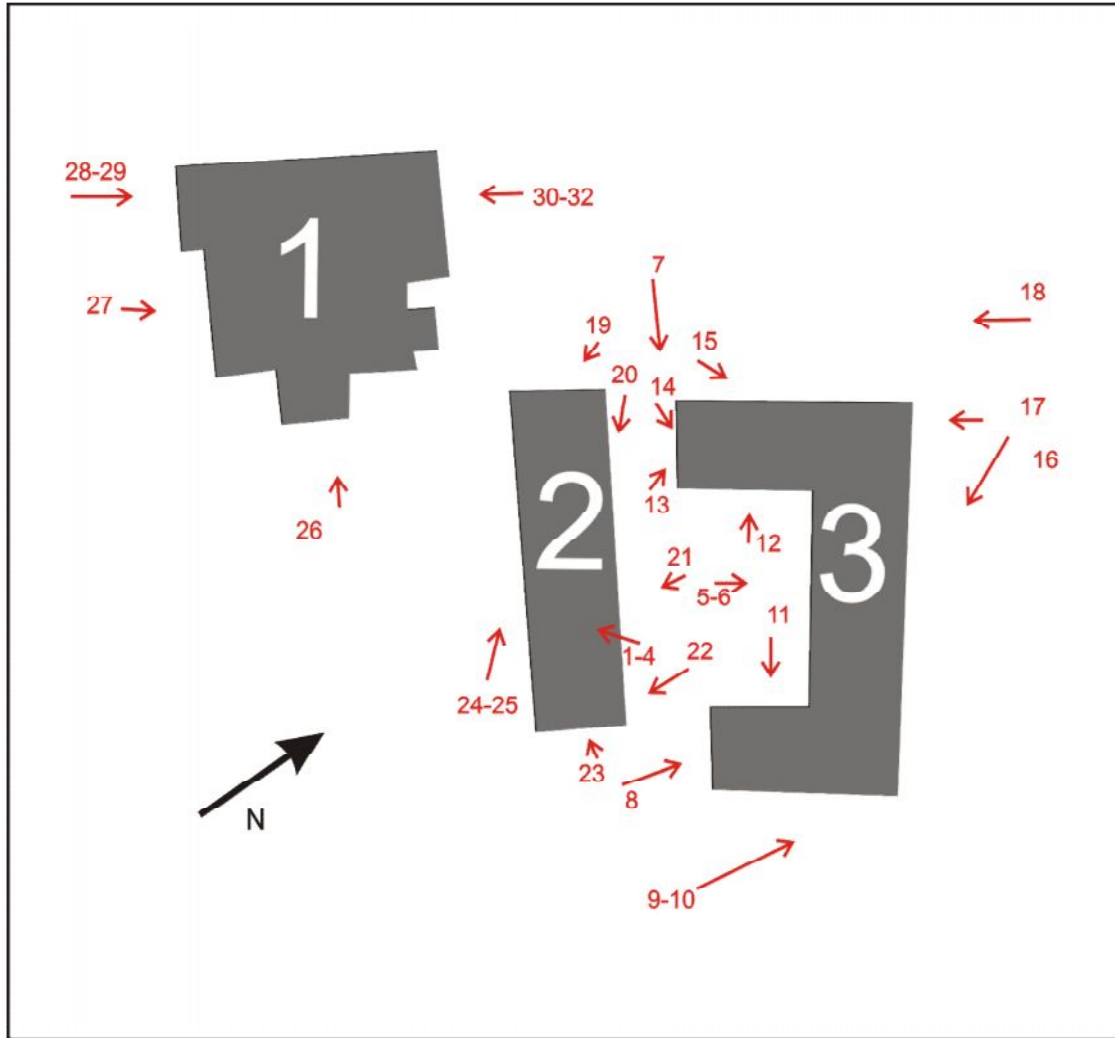

Illus 17 Plan of Buildings 1-3 with photographs indicated by red arrows and numbers.