

**FARM STEADING
CRAIGMYLE
KEMNAY
ABERDEENSHIRE**



Standing Building Survey

Carried out 20th July 2015

by

Murray Archaeological Services Ltd



Report No: MAS 2015-23

by

H K Murray and J C Murray

H K Murray BA, PhD, MCIFA, FSA Scot

J C Murray BA, MCIFA, FSA Scot, FMA

Hill of Belnagoak, Methlick, Ellon, Aberdeenshire AB41 7JN

Telephone: (01651) 806394 e-mail: cmurray@btinternet.com

**FARM STEADING
CRAIGMYLE
KEMNAY
ABERDEENSHIRE**

- Standing Building Survey -

1. Background
 - 1.1 A standing building survey was required for the steading buildings at Craigmyle, Kemnay, Aberdeenshire, prior to their demolition before the construction of two new dwellings.
 - 1.2 The archaeological condition was applied in the context of planning legislation (PAN 2/2011, SPP, SHEP), which states that it is necessary for developers to arrange for archaeological work to take place prior to development, in appropriate circumstances. Planning Application Number: APP/2015/1049.
 - 1.3 A Level 1 Standing Building Survey was required which includes measured plans and elevations, a written account of the building's plan, form, function, age and development sequence in addition to a photographic survey of the interior and exterior of the building.
 - 1.4 Murray Archaeological Services Ltd was commissioned to undertake the work by Squire Associates (Aberdeen) Ltd on behalf of their clients Mr and Mrs Mike Still. The site element of the survey was completed on the 20th July 2015.
2. Desk-top survey
 - 2.1 A search was carried out in the Sites and Monuments Record, Archaeology Service, Aberdeenshire Council and in the Sites and Monuments Records of

the Royal Commission for Ancient and Historic Monuments in Scotland (RCAHMS) through Canmore and Pastmap.

2.2 The 1st and 2nd edition Ordnance Survey maps were consulted.

3. The Site

3.1 The site lies on the N side of the B994 road between Kemnay and Kintore, a little E of its junction with the B993.

Parish: Kemnay

NGR NJ 7490 1622

RCAHMS No: None

Aberdeenshire SMR No: NJ71NW0207

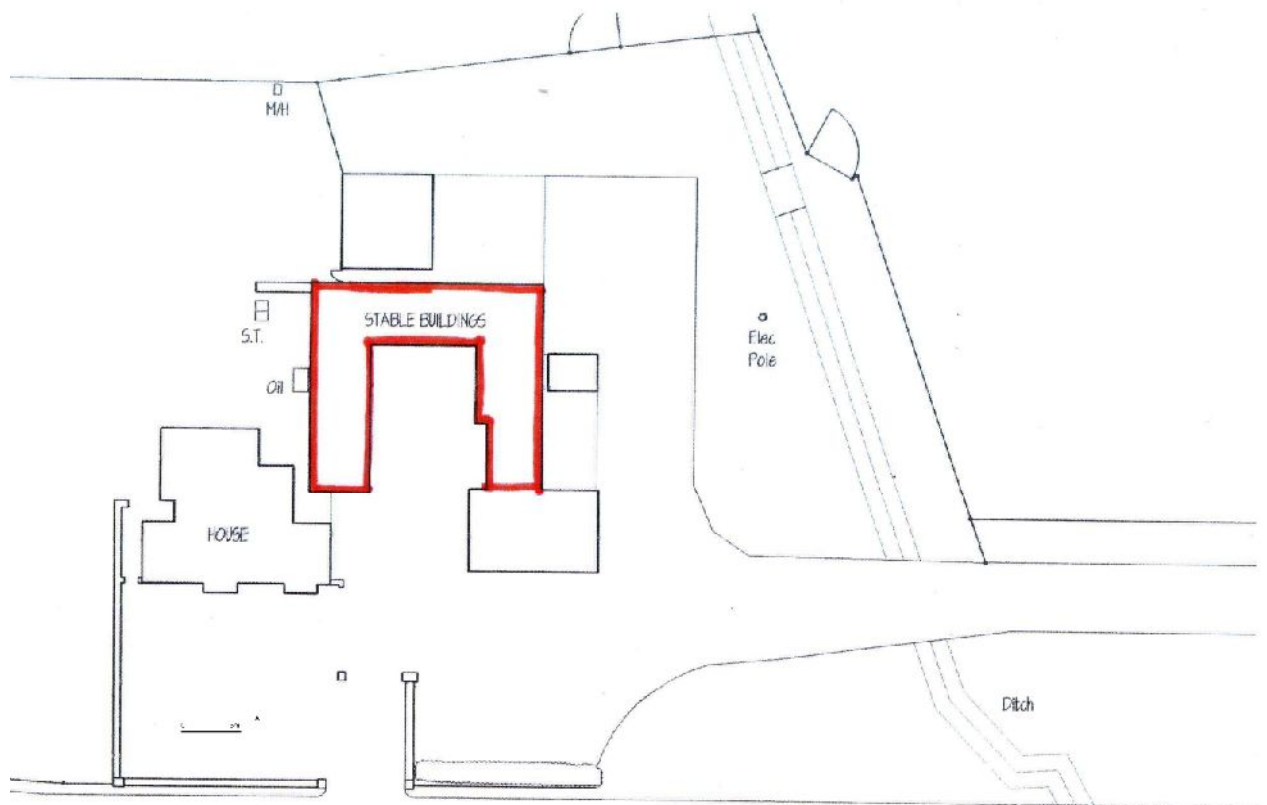

Illus 1 Overall plan. Courtesy of Squire Associates (Aberdeen) Ltd

4. Documentary evidence

- 4.1 **1st edition Ordnance Survey 25"/mile Aberdeen Sheet LXIV.3 (Kemnay) 1864 (pub 1869)** shows a main L-shaped steading with N and W ranges. A smaller L-shaped building (grey shaded ? iron/wood) formed the E range. A freestanding rectangular building lay to the W. The house is shown in its present position but as a plain rectangular block with a small outshot at the NW.

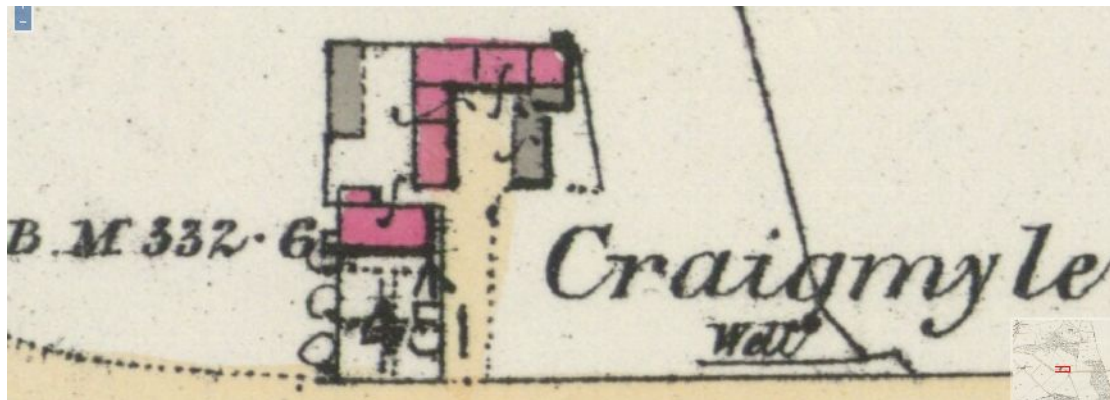

Illus 2 Detail of the 1st edition Ordnance Survey 25" map, surveyed in 1864 (published 1869. Sheet lxiv.3 (Kemnay) www.nls.ac.uk

- 4.2 The **2nd edition 25"/mile Ordnance Survey of 1899 (published 1900. Aberdeenshire Sheet 064.03)**

By 1899, the N and W ranges remain with a new E range transforming this into a U-shaped steading. Three smaller freestanding buildings lay to the W and S. The house remains as it was in 1864.

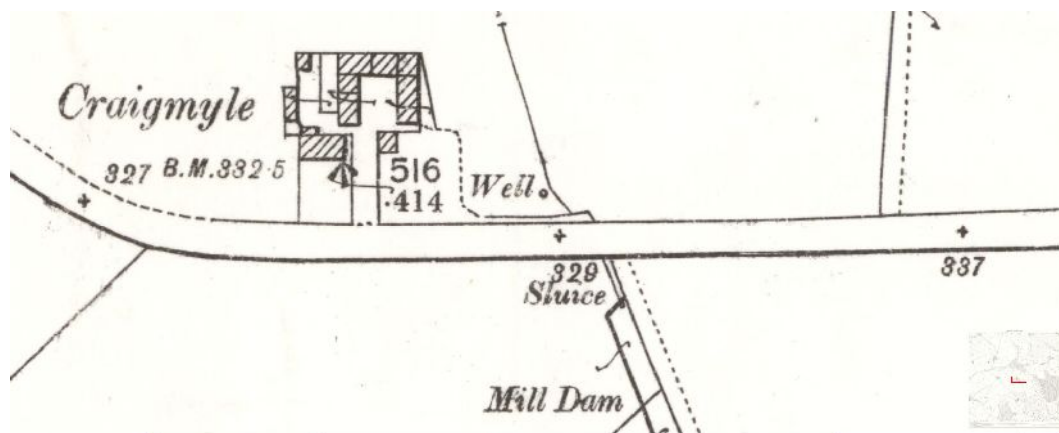

Illus 3 Detail of the 2nd edition 25"/mile Ordnance Survey of 1899 (published 1900. Aberdeenshire Sheet 064.03) www.nls.ac.uk

5 Methodology

- 5.1 The ground plan (Illus 4) and elevations (Illus 20) have been annotated to show details and to indicate differences in the building materials which may help in understanding the development and history of the building.
- 5.2 The areas recorded were photographed. The full set of photographs will be supplied for the archive and an annotated plan in the present report (Illus 19) indicates the position of each.

6 The Steading

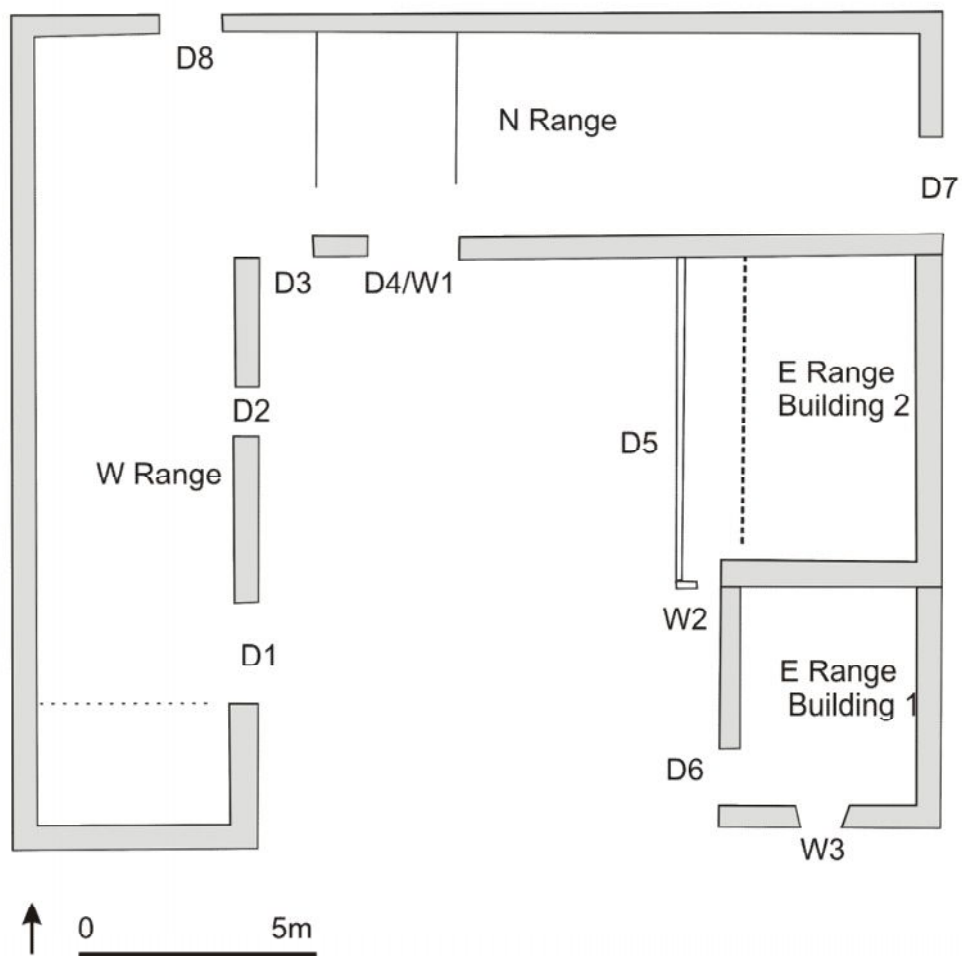

Illus 4 Plan of buildings

6.1 WEST RANGE

Dimensions 5m x 12.5m externally

Original use Tied cattle stalls

Present/recent use Storage

Walls Rubble stone with granite rybats.

Roof Slate with ceramic ridge with ceramic vents (for ventilation for cattle)

2 metal skylights on E and 3 on W side of roof.



Illus 5 E wall of W range

Doors and windows

E wall

D1 H: 1.80m W: 1.25m Replacement concrete lintel. Sliding metal door.

Granite rybats at side suggest this was the original width (Illus 5)

D2 H: 1.93m W: 1.00m Granite lintel and rybats. Wooden door.

Interior Concrete trevise for 6 double stalls for tied cows.. The S stall has been re-used to form a partitioned area.



Illus 6 W Range. Door D2



Illus 7 W Range. Interior looking N showing concrete cow stalls.

6.2 NORTH RANGE

Dimensions 5.5m x 19.5m externally

Original use Partially tied cattle

Present/recent use Recently stables

Walls Rubble stone wall. E gable is noticeably finer with good rectangular blocks.

Roof Slate with ceramic ridge. 1 metal skylight on N side, 4 on S side. 1 ceramic ventilator in ridge at W end for cattle.



Illus 8 From L to R. E Range, Buildings 1 and 2 and E gable of N Range.



Illus 9 Detail of E gable of N range. Note blockwork. Concrete blocking at base of wall appeared to be modern knock-through.



Illus 10 N wall of N range



Illus 11 N Range, S wall. Door D3 and D4 with W1 inserted.

Doors and windows

S wall

D3 H: 1.92m W: 1.15m Granite lintel and rybats. Wooden door.

D4 H: 2m W: 2m Granite lintel. Blocked with concrete blocks. W1 inserted.

W1 H:1.18m. W: 1.30m. Secondary modern window.

E wall

D7 H: 2.3m. W: 2.05m. Sliding metal door

N wall

D8 H: 2.10m. W: 1.18m Wooden lintel, concrete blocks at sides. May originally have given access to a building to N (now only visible as wall stubs Illus 12).



Illus 12 N wall of N Range with door D8 and foundation of building to N

Interior One double cow stall against the N wall, E of door D8. Two recent concrete and wooden partitions in central area.



Illus 13 N Range, door D8 and cow stall from interior



Illus 14 N Range interior looking E to D7

6.3 EAST RANGE: BUILDING 1

Dimensions 4.6m x 5.1m externally. S gable partially visible in wall of modern garage built against it.

Original use Unknown

Present/recent use Storage

Walls Rubble stone

Roof Modern sectional steel roof

Doors and windows

E wall

D6 H: 1.95m W: 1.0m Modern door

S wall

The S wall was only visible from within the modern garage and was much obscured (Illus 15).



Illus 15 S gable of E Range Building 1.

W3 H: 1.90m W: 1.2m Granite lintel. The height suggests this may have been a door but it spalyed to the inside, which is more usual for a window.

Blocked with stonework. Part of a blocked window above W: 1.2m. H: 0.98m

6.4 EAST RANGE: BUILDING 2

Dimensions 5.6m x 6.5m externally. The width of the original building appears to have been c. 4m with an additional flat roofed extension c. 1.5m wide built extending the W side.



Illus 16 E Range, W wall (Building 2 on LHS, with Building 1 in centre and modern garage on RHS)



Illus 17 E Range, E wall

Original use Unknown

Present/recent use Workshop

Walls Rubble stone to E. W wall mostly made up with sliding doors D5 and corrugated sheeting. S wall of concrete blocks.

Roof Modern sectional steel roof

Doors and windows

E wall

D5 Modern sliding metal door.

S wall

W2 H: 0.70m. W: 0.60m Modern window



Illus 18 E Range Building 2.W wall showing flat-roofed extension, D5 and W2

7 Discussion

Craigmyle is a fairly typical small Aberdeenshire improvement steading (Glendinning and Wade Martins 2008, 119-120).

The N and W Ranges appear to be part of the steading shown on the 1864 1st OS map. The E Range may be the building built between 1864 and 1899 and shown on the 2nd edition OS map. It comprised two elements, Building 2 having been built first, abutting the N Range. Building 1 was built later, abutting Building 2.

The good stonework on the E gable of the N Range was noteworthy. It is possible that this was the original position of a mill as better stonework was often used to counter the movement of a mill wheel. The small blocking in the

gable appeared however to be a modern break-through and any other details would have been removed by the insertion of the large gable door.

This identification is supported by the position of the lade shown on the 1864 and 1899 maps (Illus 2, 3). Part of the lade remains as a sunken drain running below the road.

References

Glendinning, M and Wade Martins, S 2008 Buildings of the Land: Scotland's Farms 1750-2000 Edinburgh: RCAHMS.

9 Archive

A full set of photographs with the photo location plan (Illus 16) will be supplied to the Aberdeenshire SMR in Aberdeen and to the NMRS.

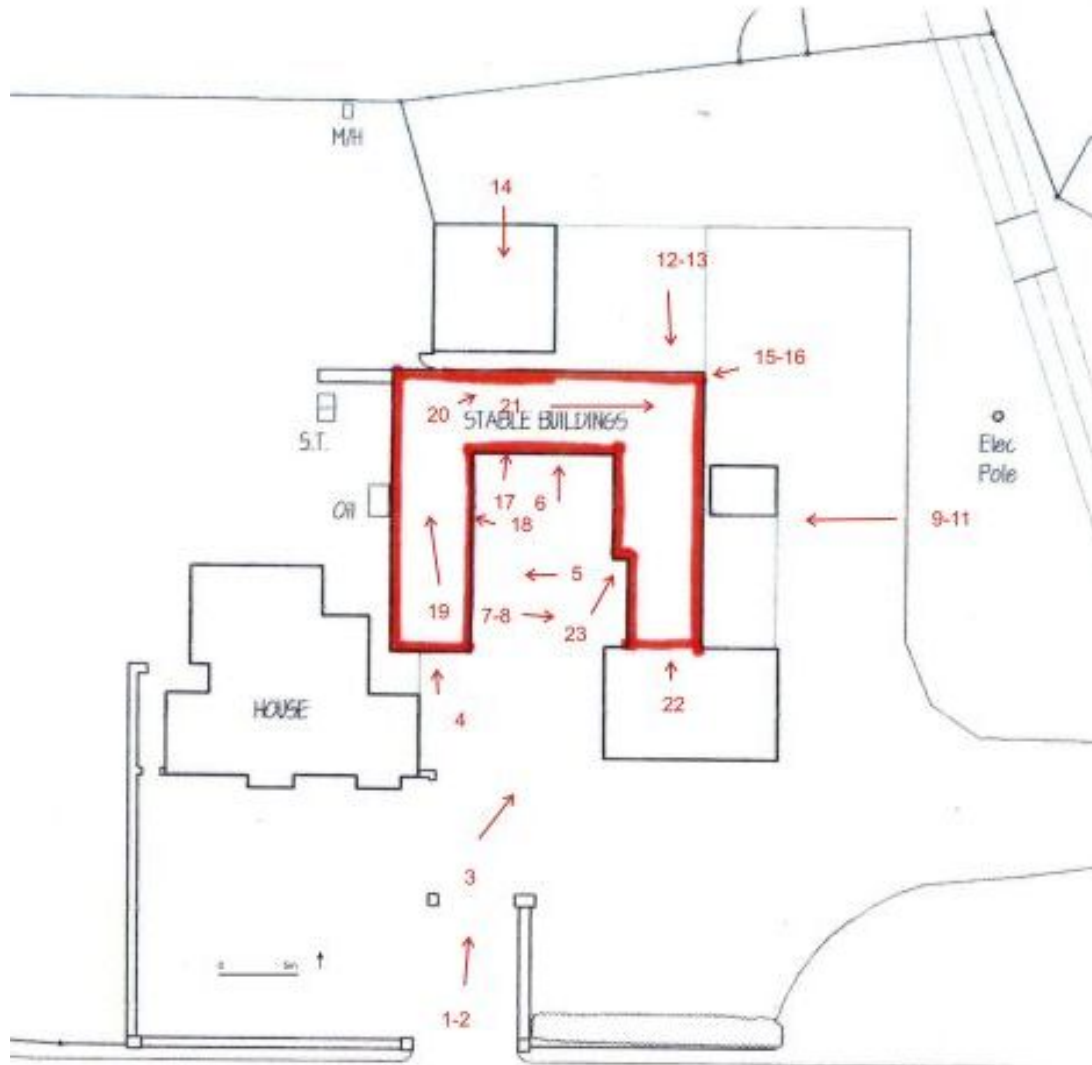

Illus 19 Photographic references. Plan annotated from drawing courtesy of Squire Associates (Aberdeen) Ltd

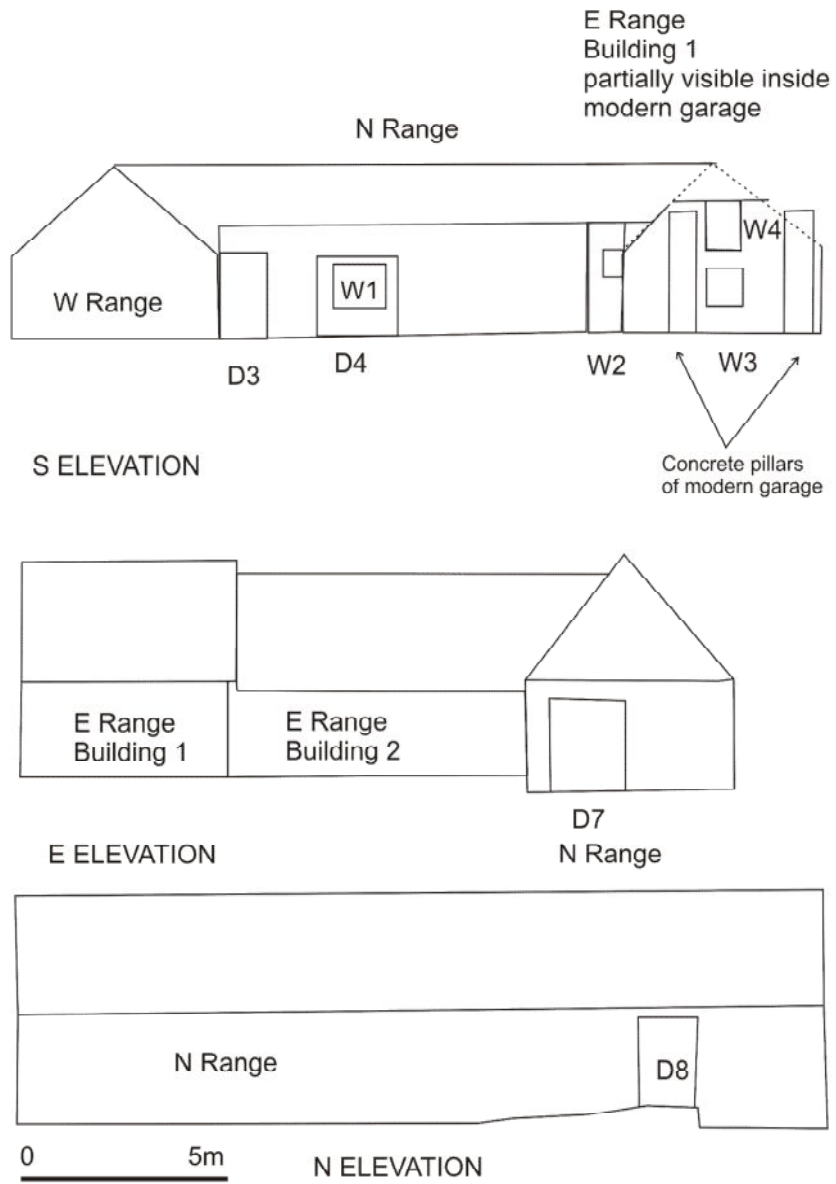

Illus 20 Elevations.