

**EAST MAINS OF FOLLA  
ROTHIENORMAN  
ABERDEENSHIRE**

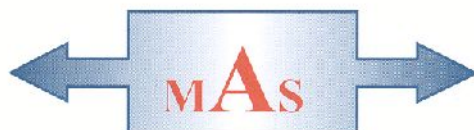

**Standing Building Survey**  
Carried out 4<sup>th</sup> August 2016  
by  
**Murray Archaeological Services Ltd**



**Report No: MAS 2016-25**  
by  
H K Murray and J C Murray

H K Murray BA, PhD, MIFA, FSA Scot  
J C Murray BA, MIFA, FSA Scot, FMA  
Hill of Belnagoak, Methlick, Ellon, Aberdeenshire AB41 7JN  
Telephone: (01651) 806394 e-mail: cmurray@btinternet.com

**EAST MAINS OF FOLLA**  
**ROTHIENORMAN**  
**ABERDEENSHIRE**

**- Standing Building Survey -**

1. Background
  - 1.1 A standing building survey was required for a steading at East Mains of Folla, Rothienorman, Aberdeenshire, prior to its demolition and the erection of a dwelling house.
  - 1.2 The archaeological condition was applied in the context of planning legislation (PAN 2/2011, SPP, SHEP), which states that it is necessary for developers to arrange for archaeological work to take place prior to development, in appropriate circumstances. Planning Application Numbers: APP/2014/2768
  - 1.3 A Level 1 Standing Building Survey was required which includes measured plans and elevations, a written account of the building's plan, form, function, age and development sequence in addition to a photographic survey of the interior and exterior of the building.
  - 1.4 Murray Archaeological Services Ltd was commissioned to undertake the work by Mr David Delph. The site element of the survey was completed on the 4<sup>th</sup> August 2016.
2. Desk-top survey
  - 2.1 A search was carried out in the Sites and Monuments Record, Archaeology Service, Aberdeenshire Council and in the National Monuments Records of Scotland at the Historic Environment Scotland (HES) through Canmore and Pastmap.
  - 2.2 The 1<sup>st</sup> and 2<sup>nd</sup> edition Ordnance Survey maps were consulted.

2.3 The sit location plan was provided by Colin Thompson, Architect. The detailed plan was drawn by MAS Ltd..

### 3. The Site

3.1 The site lies to the N of a private road to the W of the B9001 just S of Rothienorman road. The original farmhouse had stood to the S of the steading but has been previously demolished and replaced by a modern house.

Parish: Fyvie                      NGR NJ 7192 3350

GPS in front of steading: 371922, 833517

NMRS No: NJ73SW 198



Illus 1 Detail of OS map. Ordnance Survey © Crown copyright (2015) All rights reserved. Licence number (100049810). Site indicated by red circle.



Illus 2 General view looking NNW

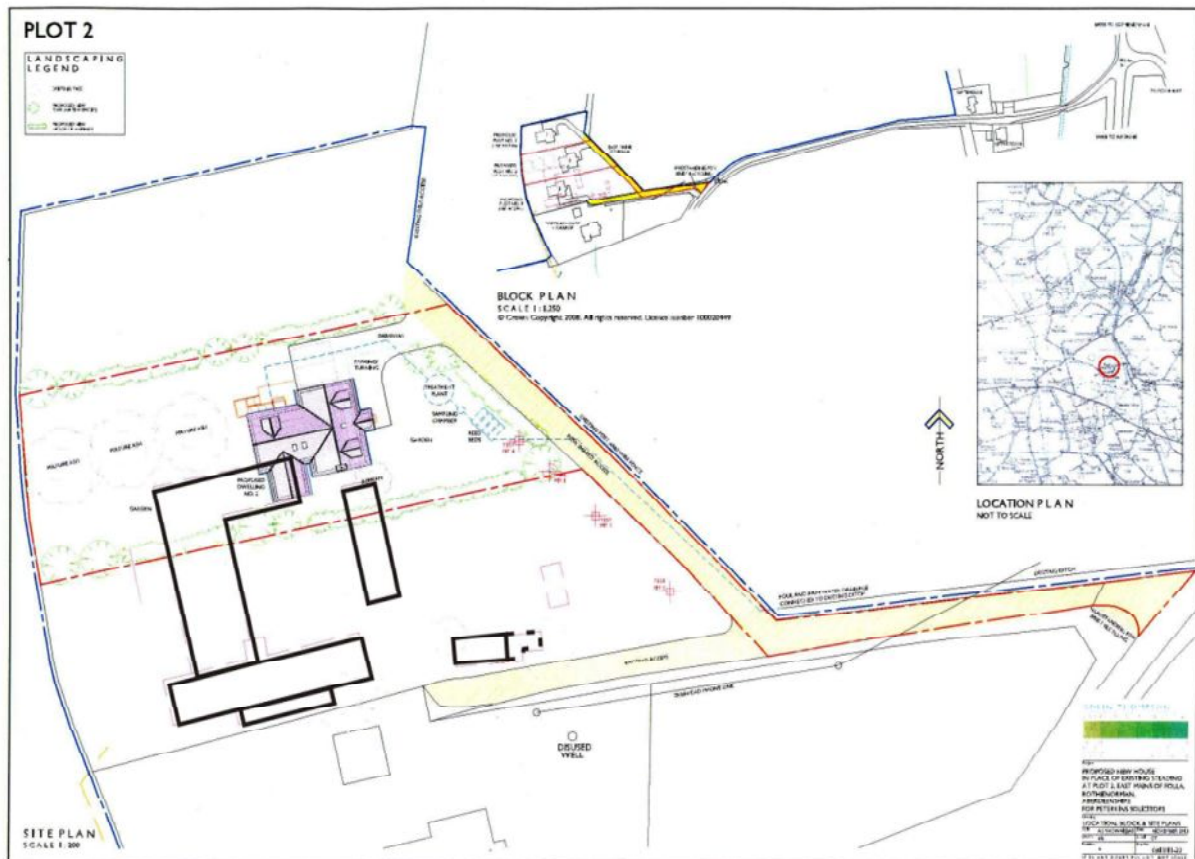

Illus 3 Layout plan courtesy of Colin Thompson. Steading indicated with black outlines

#### 4. Documentary evidence

4.1 **Aberdeen Sheet XXXVI.6 (includes Fyvie) 1867 (pub 1873)** shows a U-shaped steading facing S with a freestanding building, with a horse mill by the S wall, across part of the open S side. An unroofed building lay E of the horse mill. A small freestanding building lay to the E and a larger building, probably the farmhouse to the S of the entrance track. At this point the farm is called North Mains.

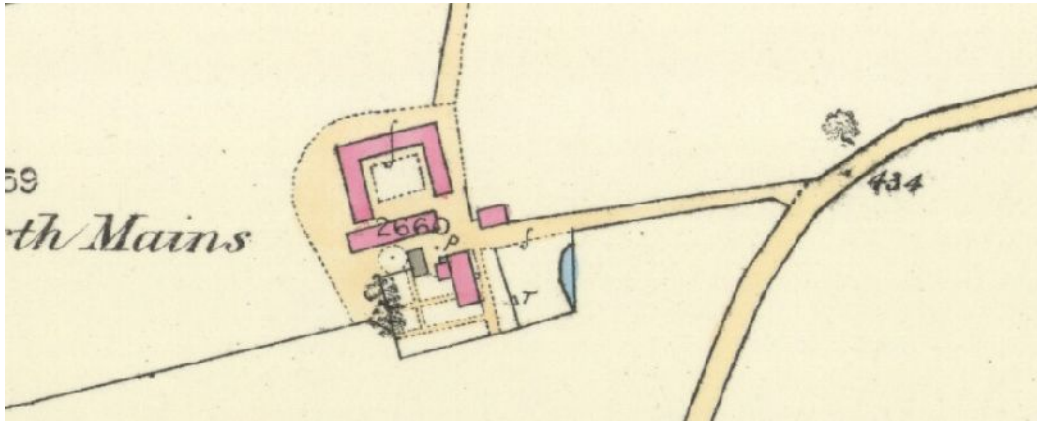

Illus 4 Detail of the 1<sup>st</sup> edition Ordnance Survey 25" map, surveyed in 1867 (published 1873) Aberdeen sheet xxxvi.6 [www.nls.ac.uk](http://www.nls.ac.uk)

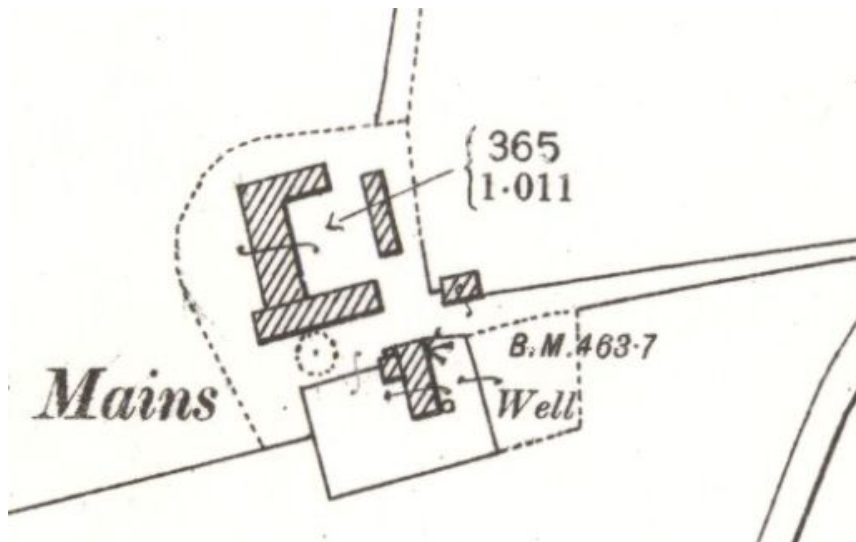

Illus 5 Detail of the 2<sup>nd</sup> edition 25"/mile Ordnance Survey of 1899 (published 1901. Aberdeenshire Sheet 036.06) [www.nls.ac.uk](http://www.nls.ac.uk)

4.2 By the 2<sup>nd</sup> edition 25"/mile Ordnance Survey of 1899 (published 1901)

**Aberdeenshire Sheet 036.06**) the house, the small building N of the track and the building with the horse mill remain. The U-shaped steading has been replaced by an L-shaped building abutting the horse mill building, forming a new U-shaped steading,

---

facing E. The E range of the original steading appears to have been retained as a freestanding building, or replaced on the same footprint. The farm name has been changed to East Mains.

## 5 Methodology

- 5.1 The ground plan (illus 7) has been annotated to show details which may help in understanding the development and history of the building. Elevations were not drawn due to the difficulty of access and unsafe condition of much of the building. A photographic E elevation of Building 1 is shown in illus 8.
- 5.2 The areas recorded were photographed. The full set of photographs will be supplied for the archive and an annotated plan in the present report (illus 24) indicates the position of each.

## 6 The Steading



**Illus 6 B1, looking WNW into court**

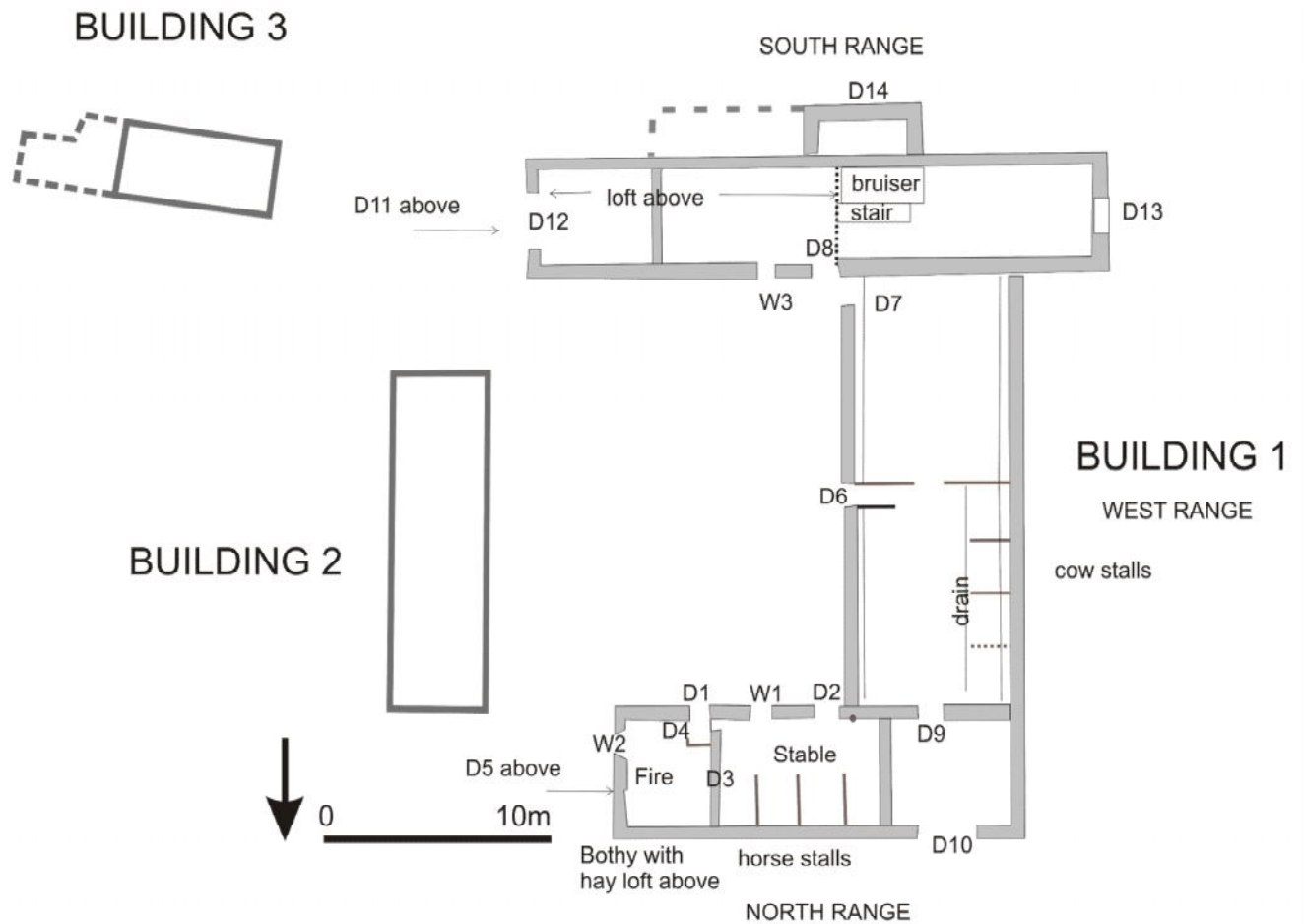

**Illus 7 Plan**



**Illus 8 Photographic E elevation**

## Building 1

Dimensions N range 18 x 6m externally. W range 18.5 x 7.5 externally. S range 21.2 x 5.15m externally with derelict outshot on S side.

Present/recent use Derelict,

Original use N range: stable at W and bothy to E with hay loft above bothy.

W range: Cattle. S range Threshing machine in W. Tractor/implement shed at E end. Loft over centre and E end, stair from beside threshing machine.

Walls N and E ranges large rubble stone with red sandstone rybats and margins. S range, smaller rubble, harled. Grey granite lintels and rubble rybats and margins.

Roof Pitched slate roofs with ceramic ridges. Ventilators on E range ridge (above cattle). Square chimney with flat table at centre of E gable of N range (for bothy fire).

Doors and windows

*North Range*

Bothy at E end entered through D1 into small wood-partitioned lobby, then through D4. Walls wooden panelled to 1.25m, plastered above. Fireplace in centre of E wall. W: 1.16m, H: 1.12m with stone surround and wooden mantelpiece.

Cast iron grate.

Recess to W of fireplace, 0.27m deep.

Concrete floor. Electric light.

Hay loft above.



**Illus 9 N Range. Lobby into bothy**





**Illus 10 Bothy looking E**

Stable at W end with four horse stalls with timber trevises. Each stall W:1.70m L: 2.55m. Wooden end posts, horizontal plank trevis sides with iron band along top. Vent in wall above each stall. Hay hake surviving over E stall. Traces of painted names above stalls- only the W stall legible “ Rose”, with yellow (?) heart above. 2<sup>nd</sup> stall yellow diamonds. Floor cobbled.

Wooden loft partition above stone wall between stable and bothy, plank door D3 between stable and loft at loft level.

Surviving harness peg on inside of S wall, W of door D2.



**Illus 11 Stable from door D2**



**Illus 12** Detail of trevis



**Illus 13** Harness peg



**Illus 14 E end of stable and loft over bothy**

D1 W: 1.07 m H: 2.14m

D2 W: 1.22 m H: 2.105m

D3 central loft door in wooden partition. Not possible to measure

D4 W: 0.74m H: 1.87m internal plank door from lobby to bothy

D5 central loft door in gable. Not possible to measure

D9 W: 1.0m H: 1.85m wooden shutter with iron counter weights

D10 W: 2.37 m H: 2.45m red sandstone rybats. Grey granite lintel. Double wooden sliding doors. Possibly a cart bay that had been raised?

W1 W: 0.92m H: 1.23m Slatted.

W2 W: 0.80m H: 1.23m. 2/2 panes sash window.

#### *West Range*

#### Cattle byre

N half of range had double tied cow stalls surviving on W side. Each stall  
W:2.34m L: 1.75m Floor cobbled and brick with drain behind cows. Hay hake.

Iron cow ties. Skylights over stalls 1 and 4. Small air vents over each stall.

E side of building has no drain or surviving stalls but does have vents so possibly  
an open pen for young stock.

Sliding door at N end possibly used for mucking out.

S half of range could not be entered but appeared to have air vents. Probably also for cattle.



Illus 15 W Range Cattle byre looking S



Illus 16 Detail of double tied cow stall



**Illus 17** Sliding door at N end W Range, note counter weights at level of top of ranging rod



**Illus 18** S end of W Range

D6 W: 1.20m H: 2.10m Red sandstone rybats and lintel

D7 W: 1.24m H: 2.10m Red sandstone rybats and lintel. Plank ½ doors

*South Range*

Threshing machine

Building unsafe to enter but threshing machine visible in centre with stair to grain loft beside it.



**Illus 19 SW corner of Building 1**



**Illus 20 Threshing machine visible behind stair to grain loft in centre of S Range**

D8 W: 1.12m H: 2.00m Rubble stone sides

- D11 Central loft door in gable. Not possible to measure
- D12 W: 2.53m H: 2.55m Grey granite lintel. Sliding metal doors.
- D13 W: 2.00m H: 1.75m . Base of opening is more than 1m above internal floor level.
- D14 Not possible to measure
- W3 W: 0.70m H: 0.75m Wooden lintel, concrete sill. Tipping window.  
2/2panes.

## Building 2

The roof of Building 2 was collapsing so it was not entered and could not be planned in detail.

Dimensions 15.15 x 4.5m externally

Present/recent use Derelict,

Original use Livestock ( some partitions visible).

Walls Rubble stone – estimate c600mm thick.

Roof pitched roof with skylights



Illus 21 Building 2 W wall



**Illus 22 Building 2 S wall**

### Building 3

The roof of Building 3 was collapsing so it was not entered and could not be planned in detail.

Dimensions 8.15 x 4.75m externally. Further structure to E, collapsed rubble of wood and tin.

Present/recent use Derelict,

Original use Unknown but chimney, possibly for boiler ( no fireplace), at W end.

Pens suggest secondary use for livestock.

Walls Rubble stone. Wide doorway in S wall.

Roof Hipped slate roof, brick chimney in centre of W wall.





**Illus 23 Building 3 S wall**

## 7 Discussion

The earliest parts of the steading date to the 1<sup>st</sup> half of the 19<sup>th</sup> century and are shown on the 1<sup>st</sup> OS map of 1867. At that point the farm was called North Mains of Folla.

The U-shaped steading open to the S as depicted in 1867 had been partly demolished, presumably after a fire or similar. Building 2 is either a remnant of the E range of the original steading or a rebuild on the same footprint. Building 3 also survives from 1867. The S Range of the existing steading Building 1 was the freestanding building shown on the 1867 map. It continued in use with a horse mill attached to its S wall – the drive shaft would have gone through the wall to a threshing machine inside the building. More recently the horse mill would have been replaced with an engine, probably housed in the collapsed lean-to against the S wall of this range.

The existing W and N ranges of Building 1 were built between 1867 and 1899 to house cattle, stables for the farm horses and a small bothy. The dark red sandstone used in the rybats and margins of this part of the steading is very typical of a small area centred on Rothienorman and must be from a local quarry.

## 8 Archive

A full set of photographs with the photo location plan (Illus 24) will be supplied to the Aberdeenshire SMR in Aberdeen and to the NMRS.

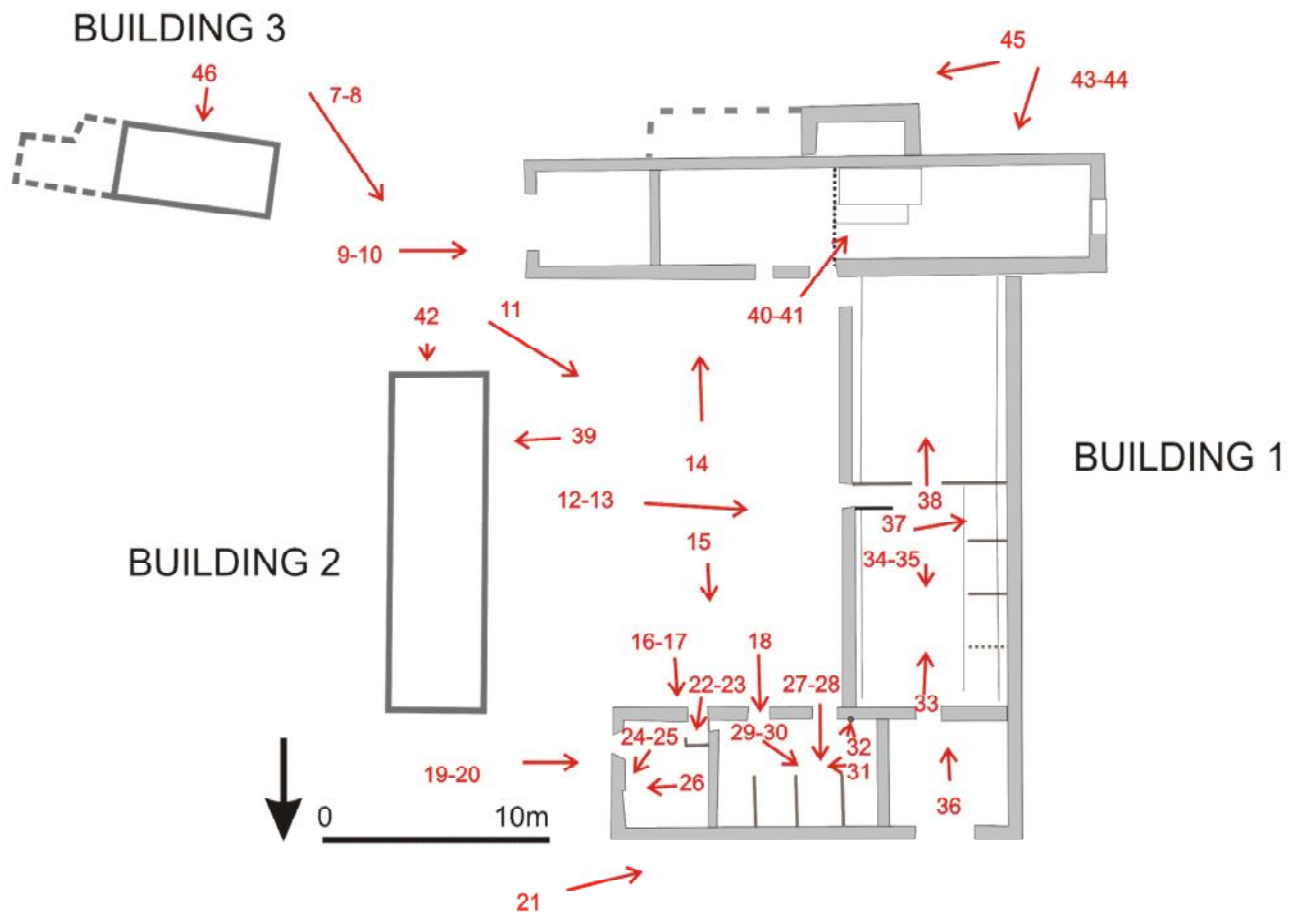

Illus 24 Photo reference plan (Nos 1-6 General shots of site)