

**STATION FARM  
LONGHAVEN  
PETERHEAD  
ABERDEENSHIRE**



**Standing Building Survey**

Carried out 20th October 2017

by

**Murray Archaeological Services Ltd**



**Report No: MAS 2017-25**

by

**H K Murray and J C Murray**

H K Murray BA, PhD, MCIfA, FSA Scot

J C Murray BA, MCIfA, FSA Scot, FMA

Hill of Belnagoak, Methlick, Ellon, Aberdeenshire AB41 7JN

Telephone: (01651) 806394 e-mail: cmurray@btinternet.com

---

**STATION FARM  
LONGHAVEN  
PETERHEAD  
ABERDEENSHIRE**

**- Standing Building Survey -**

1. Background
  - 1.1 A standing building survey was required for a farm steading at Station Farm, Longhaven, Peterhead, Aberdeenshire, prior to the demolition of an existing stone barn and its replacement by a new dwelling house.
  - 1.2 The archaeological condition (Condition 1) was applied in the context of planning legislation (PAN 2/2011, SPP, HESPS), which states that it is necessary for developers to arrange for archaeological work to take place prior to development, in appropriate circumstances. Planning Application Numbers: APP/2014/2571
  - 1.3 A Level 1 Standing Building Survey of the extant structures was required which includes measured plans and elevations, a written account of the building's plan, form, function, age and development sequence in addition to a photographic survey of the interior and exterior of the building.
  - 1.4 Murray Archaeological Services Ltd was commissioned to undertake the work by Mr Russell Smart. The site element of the survey was completed on the 20<sup>th</sup> October 2017.
2. Desk-top survey
  - 2.1 A search was carried out in the Sites and Monuments Record, Archaeology Service, Aberdeenshire Council and in the Sites and Monuments Records of the Royal Commission for Ancient and Historic Monuments in Scotland (RCAHMS, now HES) through Canmore and Pastmap.
  - 2.2 The 1<sup>st</sup> and 2<sup>nd</sup> edition Ordnance Survey maps were consulted.

2.3 Plans and elevations have been drawn and annotated as necessary by MAS Ltd  
(Illus 7, 15).

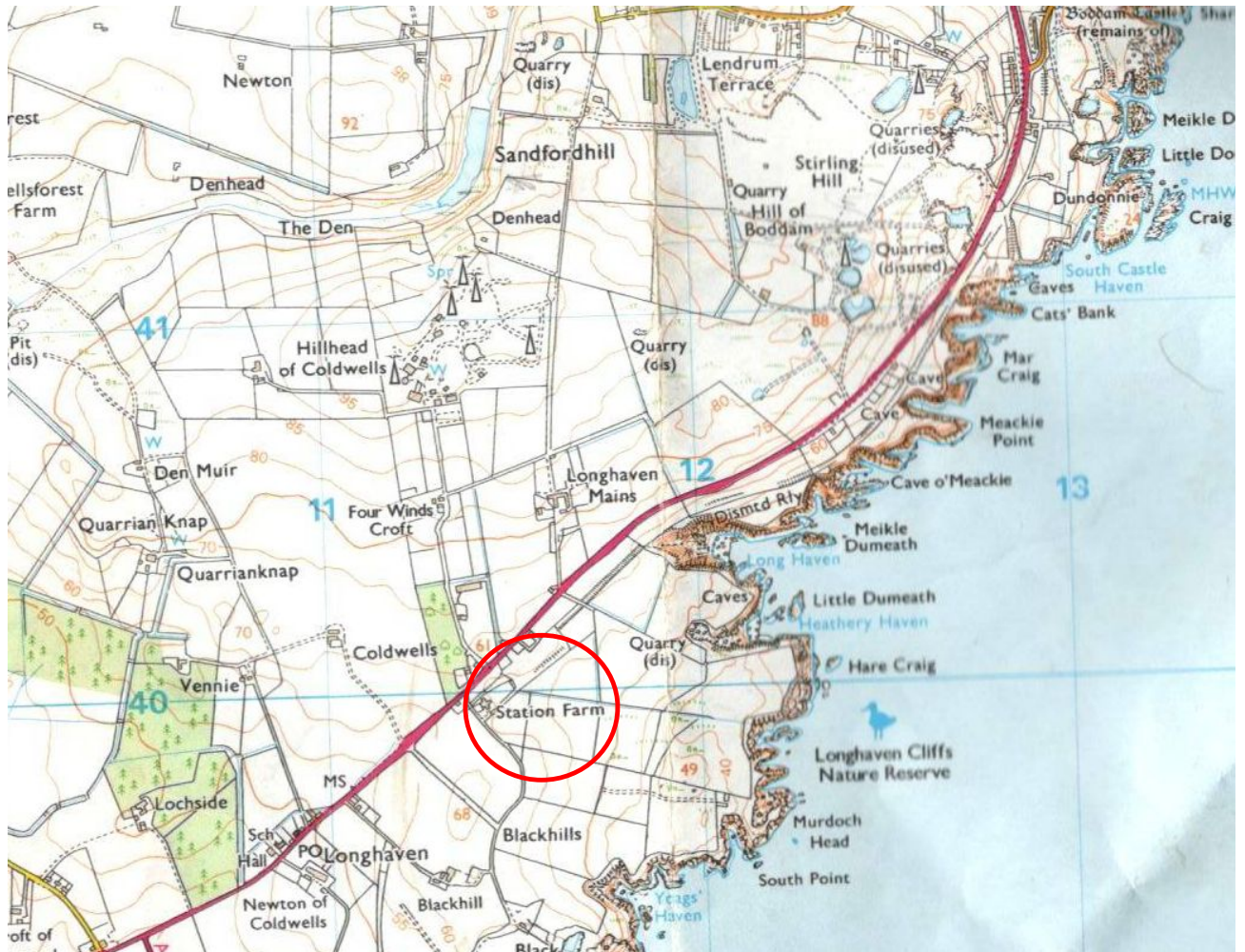

**Illus 1** Detail of OS map. Ordnance Survey © Crown copyright (2002) All rights reserved. Licence number (100049810). Site indicated by red circle.

### 3. The Site

3.1 The site lies some 5km S of Peterhead and just N of Longhaven, on the E side of the A90.

Parish: Cruden NGR: NK 3996 1141

GPS 839962, 411411



Illus 2 Site plan courtesy of Russell Smart. annotated with the building numbers used in this report

#### 4. Documentary evidence

**1868** 25" OS map Aberdeen sheet XXXII.6 (Cruden) surveyed in 1868, published in 1872

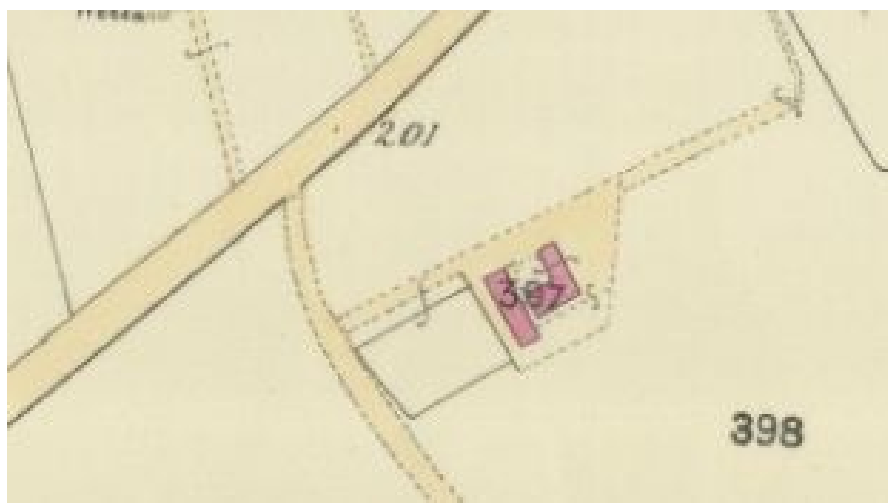

Illus 3 Detail of 25" OS map Aberdeen sheet XXXII.6 (Cruden), 1868, published 1872 [www.nls.ac.uk](http://www.nls.ac.uk)

**1900 The OS map of 1899 (Aberdeenshire 032.06 & 07 published 1901)**

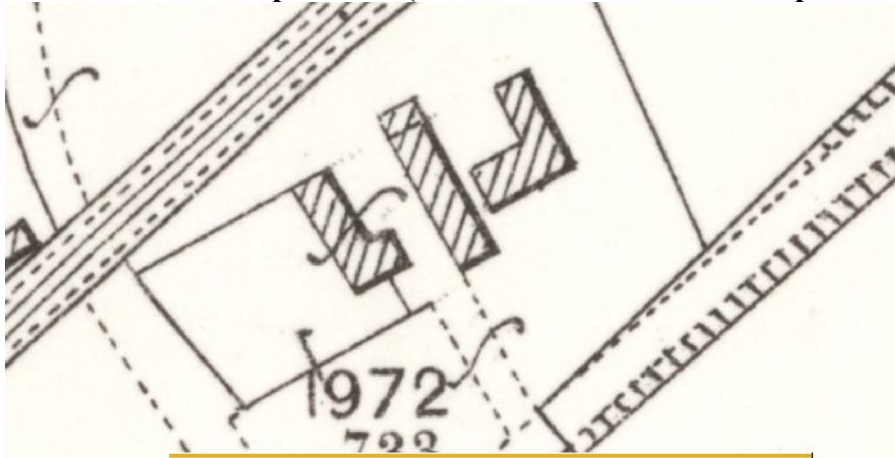

Illus 4 OS map of 1899 (Aberdeenshire 032.06 & 07 published 1912) [www.nls.ac.uk](http://www.nls.ac.uk)

**1970** An advertisement from 1970 is useful as not only does it describe the farmhouse in some detail but it also describes the steading before it stopped having any agricultural usage. It comprised a byre for 16 (cattle), loose box for 4, barn and storage sheds.



Illus 5 Aberdeen Press and Journal 29<sup>th</sup> December 1970 [www.britishnewspaperarchive.co.uk](http://www.britishnewspaperarchive.co.uk)

## 5 Methodology

- 5.1 The ground plans and elevations (illus 7, 15) have been annotated to show details which may help in understanding the development and history of the building.
- 5.2 The areas recorded were photographed. The full set of photographs will be supplied for the archive and annotated plans in the present report (illus 22) indicates the position of each.

## 6 The Buildings

### The farmhouse

The farmhouse, which was not part of the planning application, is 1 ½ storied granite building, partly harled and with a slate roof. A lean-to outshot against the S end of the E wall was probably the original milk house. A garage abuts the N gable. The 1970 advertisement (illus 5) describes the original internal layout.



**Illus 6 Farmhouse from steading.**

## Building 1

Orientation Approx N/S

Dimensions 4.75 x 18m

Present/recent use Has previously been converted for domestic use with new windows and doors and blocking of some of original openings.

Original use Steading

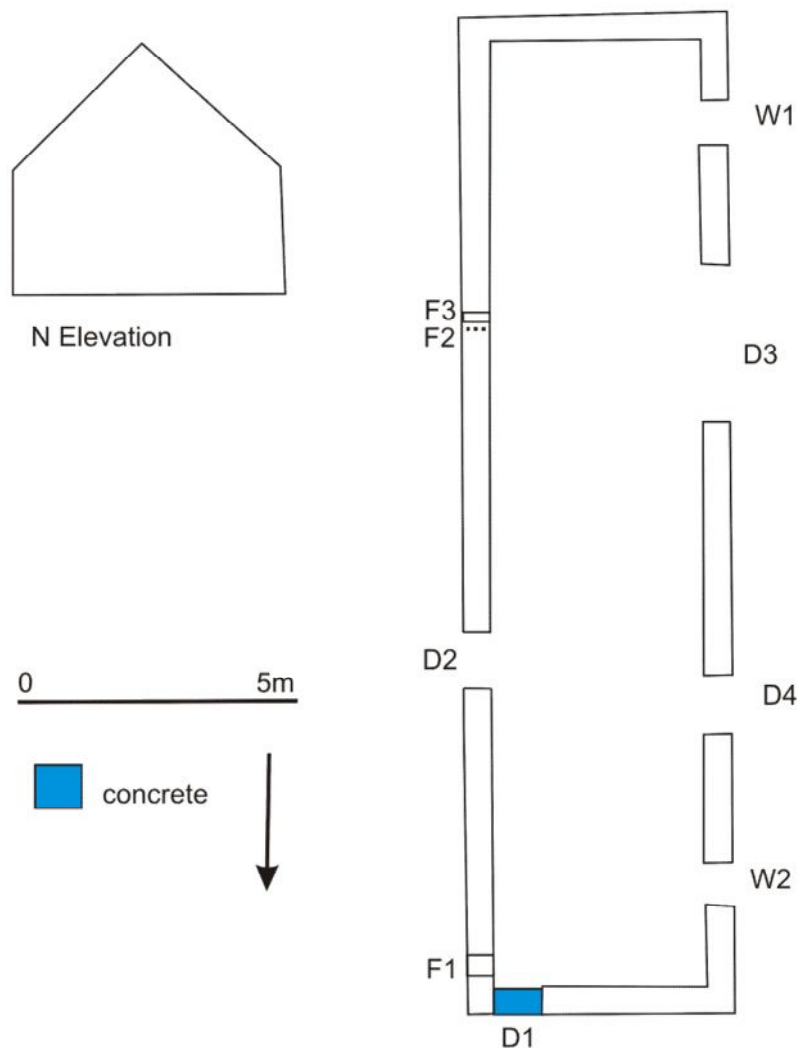

Illus 7 Plan and elevation Building 1

Walls Squared granite blocks, more regular stonework at gables, more varied rubble in side walls.

Roof Corrugated asbestos. Modern pipe chimney out of E side of roof.



**Illus 8 Buildings looking NW with Building 2 (roofless) in foreground, Building 1 (behind caravan) and farmhouse in background. The chimneys are on the farmhouse.**



**Illus 9 Building 1. S gable**



### Doors and windows

#### *N wall*

**D1** W: 0.85m H: 1.65m. Concrete blocked doorway.



**Illus 10 Building 1. N wall. Door D1.**

#### *E wall*

**D2** W: 1.0m H: 2.0m. Red granite rybats. No surviving lintel. Wooden blocking.

**F1** W: 0.45m H: 0.50m. Base 1.05m above ground. Stone blocked. Wooden framing.

**F2** Vertical build line. Rybats to N of line suggest the building had been extended to S.

**F3** Blocked opening. W: 0.35m. H: 0.50m. Stone rybats, lintel and sill. Appears to have been blocked with a single stone.



**Illus 11 Building 1. E wall. F2 building line and F3 blocking. Ranging rod lies against original rybats.**



**Illus 12** Looking N along W wall with modern windows and doors

*W wall*

**D3** W: 2.85m H: 1.90m. Red granite rybats, metal lintel set into roof line. Modern sliding glass doors.

**D4** W: 1.02m H: 1.80m. Concrete lintel and red granite rybats . Modern plastic door.

**W1** W: 0.82m H: 1.05m. Red granite lintel, sill and rybats. Modern plastic window.

**W2** W: 0.81m H: 1.08m. Red granite lintel and sill. Modern plastic window.

Interior Converted. Not entered.

## Building 2

Orientation L-plan. E range orientated N/S, W Range orientated E/W

Dimensions 12.4 x 13.6m max.

Present/recent use Derelict



**Illus 13 Building 2 (background LHS) with gable of Building 1 (RHS) looking SE**



**Illus 14 Building 2 S elevation**

Original use Byre and mill

Walls Red granite rubble.

Roof Missing

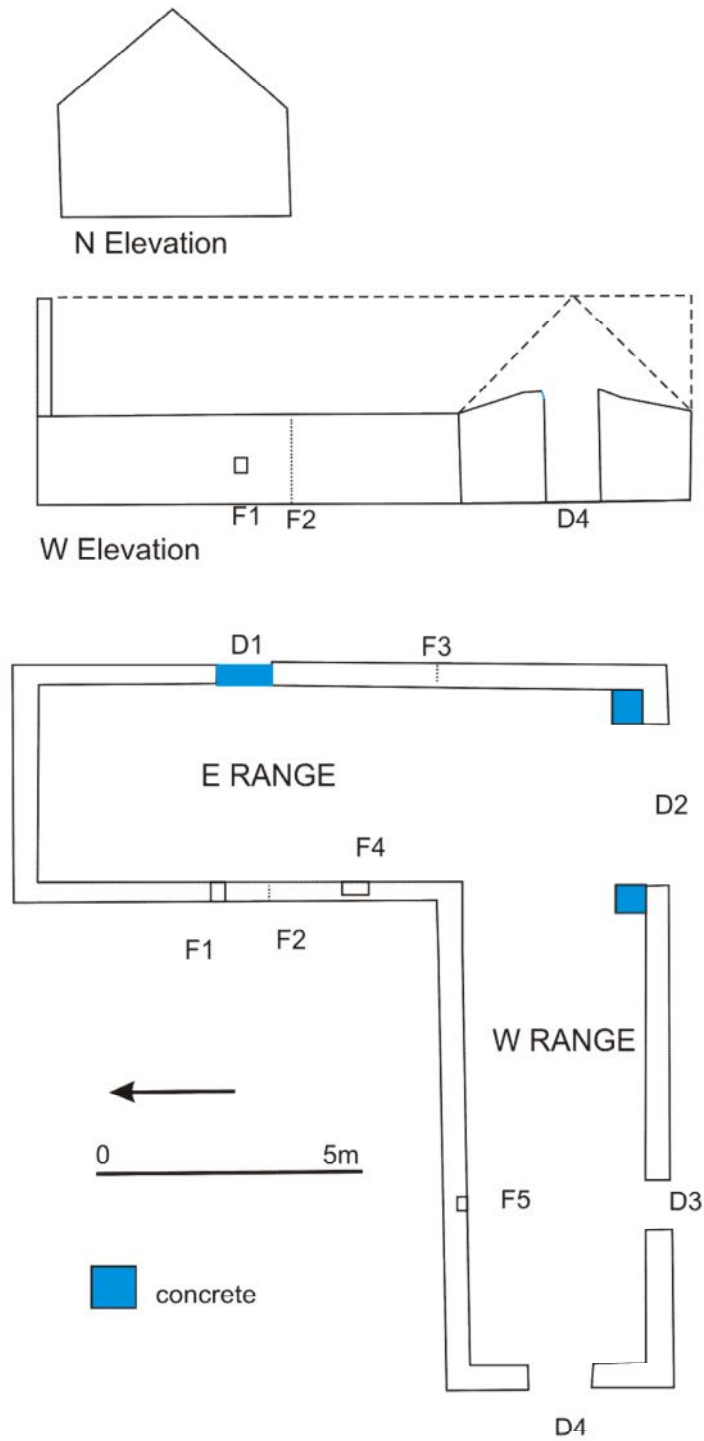

Illus 15 Plan and elevations Building 2

Doors and windows



**Illus 16 Building 2, E wall**

*E Range*

*E wall*

**D1** W: 1.06m H: 1.80m. to wall head. Pink granite rybats. No lintel.

Concrete blocked.

**F3** Roughly vertical building line.

*S wall*

**D2** W: 3.52m to stone (2.96m to concrete). H: 2.35m (to wall top) Knock through at gable with concrete and brick sides.



**Illus 17 Building 2. Door D2**

*W wall*

**F1** W: 0.29m H: 0.34m. Height above ground 0.50m. Rubble stone lintel, sill and rybats. Stone blocked. Visible inside with wooden sill.



**Illus 18 Building 2. F1 and F2 external.**

**F2** Vertical build line. Rybats on S side suggest the building was extended N.

**F4** W: 0.34m H: 0.40m. Sill 0.75m above floor. Blocked opening with wooden sill. Only visible on inside of wall.

W Range

*N wall*

**F5** W: 0.30m H: 0.30m. (estimate). Recess in inner face of wall, approx 0.25m deep. Stone sill and rybats.



**Illus 19 Building 2. Recess F5 seen through partly blocked door D3**

*S wall*

**D3** Partly blocked with concrete blocks to form window. W: 0.87m H: 0.75m (to blocking). Original height 1.50m (to wall head). Rubble rybats.

*W wall*

**D4** W: 1.22m H: 2.16m. Sides built up with brick. No surviving lintel.

Interior The interior was full of rubbish and difficult to access. Apart from the blockings noted above, no original features were evident.





**Illus 20 Building 2. Interior of E Range from door D2**



**Illus 21 Building 2. Interior of W Range from door D4**

## 7 Discussion

Buildings 1 and 2 are both shown on the 1868 OS map, but as there is no separate house shown at that time, it is probable that one of these, probably Building 1, incorporated a small dwelling. In 1899, the Boddam Branch of the Great North of Scotland Railway opened and the croft became Station Farm. Also by 1899, a new separate farmhouse had been built and Building 1 was extended slightly to the N. The post 1970 conversion of the building for domestic use has obscured any details regarding its development or function. Building 2 appears to have incorporated a small barn in the E range- this is suggested by the blocking F1 which probably allowed a drive-shaft to go through the wall to run a threshing machine inside. There is no documentary or physical evidence of either a horse or water-powered mill, so it is most likely that it was driven either from a tractor outside the wall, or by a stationary engine.

## 8 Archive

A full set of photographs with the photo location plans (Illus 22) will be supplied to the Aberdeenshire SMR and to the HES archive.

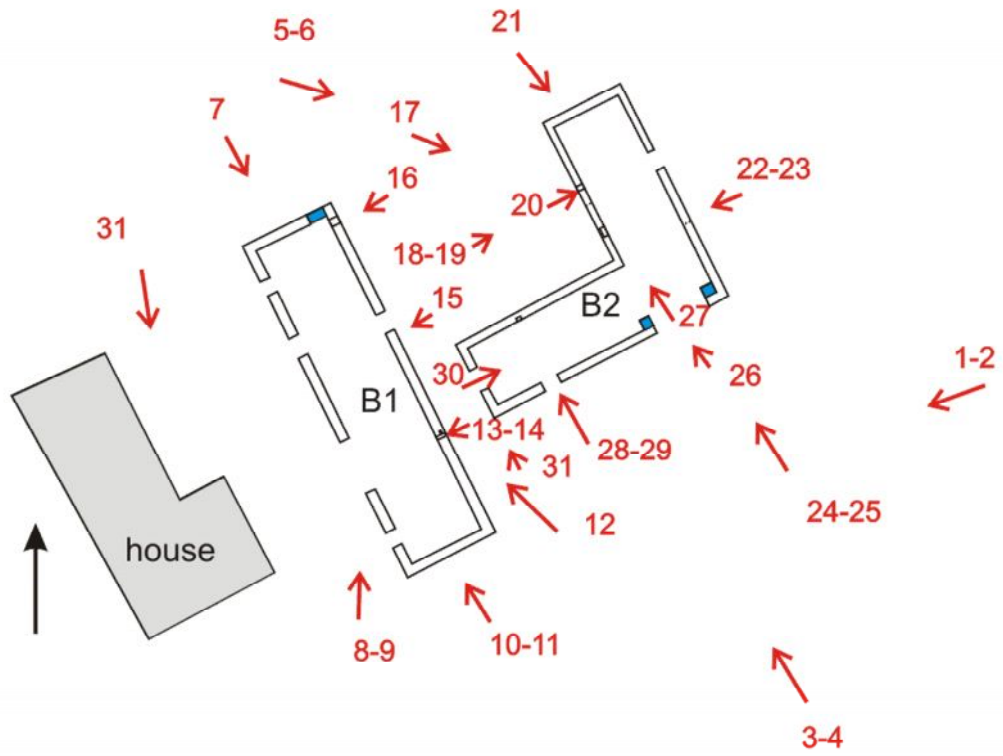

**Illus 22 Photo location plan**

---

<b>Photo number</b>	<b>Content</b>
1-2	General view looking NW towards main road
3-4	General looking N. B1 in centre
5-6	General looking SE. B1 in foreground, B2 behind
7	B1. N wall
8-9	B1. W wall looking N
10-11	B1 S gable
12	B1 looking N along E wall
13-14	B1, E wall, F2 & F3
15	B1, E wall, D2
16	B1, E wall, F1
17	Looking SE into corner of B2
18-19	B2, W wall, F1 & F2
20	B2, W wall, F1
21	B2, N gable
22-23	B2, E wall
24-25	B2, S wall
26	B2, S wall, door D2
27	B2, looking N in interior of E range
28-29	B2, looking N through D3 to recess F5
30	B2, looking E in interior of W Range
31	Looking N between B1 and B2
32	Back of farmhouse, looking S