

**GREENHAUGH STEADING**  
**DRUMBLADE**  
**HUNTLY**  
**ABERDEENSHIRE**



**Standing Building Survey**

Carried out 29<sup>th</sup> October 2018

by

**Murray Archaeological Services Ltd**



**Report No: MAS 2018-28**

by

**H K Murray and J C Murray**

H K Murray BA, PhD, MCIfA, FSA Scot

J C Murray BA, MCIfA, FSA Scot, FMA

Hill of Belnagoak, Methlick, Ellon, Aberdeenshire AB41 7JN

Telephone: (01651) 806394 e-mail: cmurray@btinternet.com

---

**GREENHAUGH STEADING**  
**DRUMBLADE**  
**HUNTLY**  
**ABERDEENSHIRE**

**- Standing Building Survey -**

1. Background

1.1 A standing building survey was required for a range of steading buildings prior to their demolition and replacement by dwelling houses.

1.2 The archaeological condition was applied in the context of planning legislation (PAN 2/2011, SPP, HESPS), which states that it is necessary for developers to arrange for archaeological work to take place prior to development, in appropriate circumstances. Planning Application Number: APP/2018/1240

1.3 A Level 2 Standing Building Survey of the extant buildings and structures was required which comprises a full analytical record, to ‘include detailed photographs of decorative and structural elements, a detailed written description and account of the building’s origins, development, use and the evidence on which this has been based. Readily available historic documentation will be examined and measured drawings will be made of relevant sections, elevations and key architectural features’.

1.4 Murray Archaeological Services Ltd was commissioned to undertake the work by John Wink Design on behalf of their clients Mr K Stewart and Sons. The site element of the survey was completed on the 29<sup>th</sup> October 2018.

2. Desk-top survey

2.1 A search was carried out in the Aberdeenshire Sites and Monuments Record, Archaeology Service, Aberdeenshire Council and in the Sites and Monuments Records of the Royal Commission for Ancient and Historic Monuments in Scotland (RCAHMS, now HES) through Canmore and Pastmap.

- 2.2 The 1<sup>st</sup> and 2<sup>nd</sup> edition Ordnance Survey maps were consulted. The Ordnance Survey Name Book was consulted on-line at <https://scotlandsplaces.gov.uk/digital-volumes/ordnance-survey-name-books>
- 2.3 The British Newspaper archive was searched for references to the property.  
[www.britishnewspaperarchive.co.uk](http://www.britishnewspaperarchive.co.uk)

### 3 Methodology

- 3.1 The ground plans (Illus 22, 38) and elevations (Illus 23, 25, 27, 29, 32, 48) have been supplied courtesy of John Wink Design and annotated to show details which may help in understanding the development and history of the building.
- 3.2.1 The building recorded was photographed. The full set of photographs will be supplied for the archive and a table and annotated plans in the present report (Illus 51, 52) indicate the position of each.

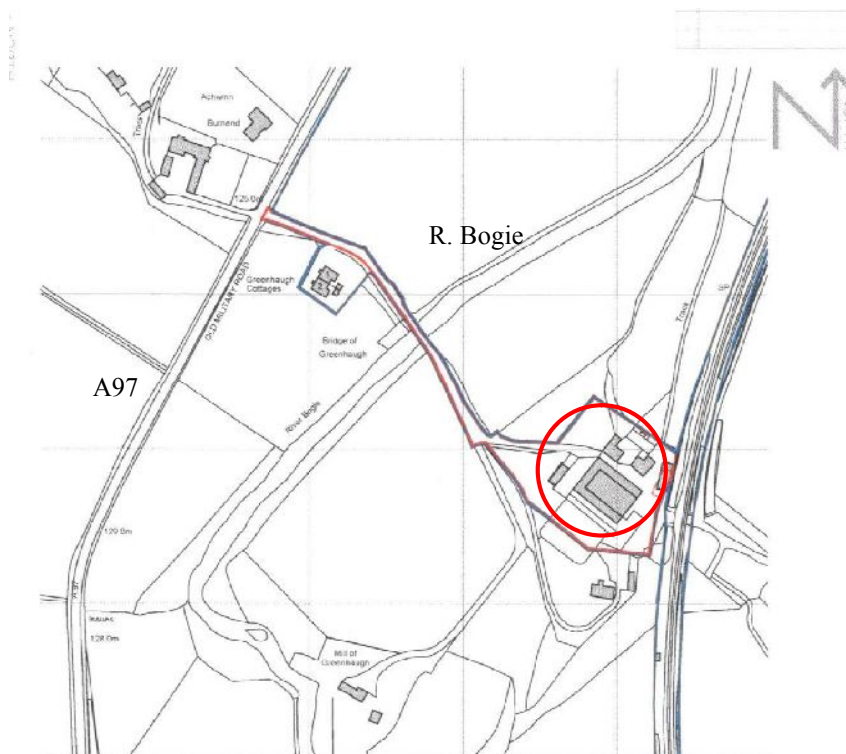

Illus 1 Site location plan courtesy of John Wink Design

#### 4. The Site

4.1 The site lies some 1.5km S of Huntly on a private track to the E of the A97, between the River Bogie and the Railway line.

It comprises a large U-plan steading (Building 1) and a second group of buildings centred on a mill. The farmhouse, which lies to the S of the steading and a modern barn to the E are not part of the present survey.

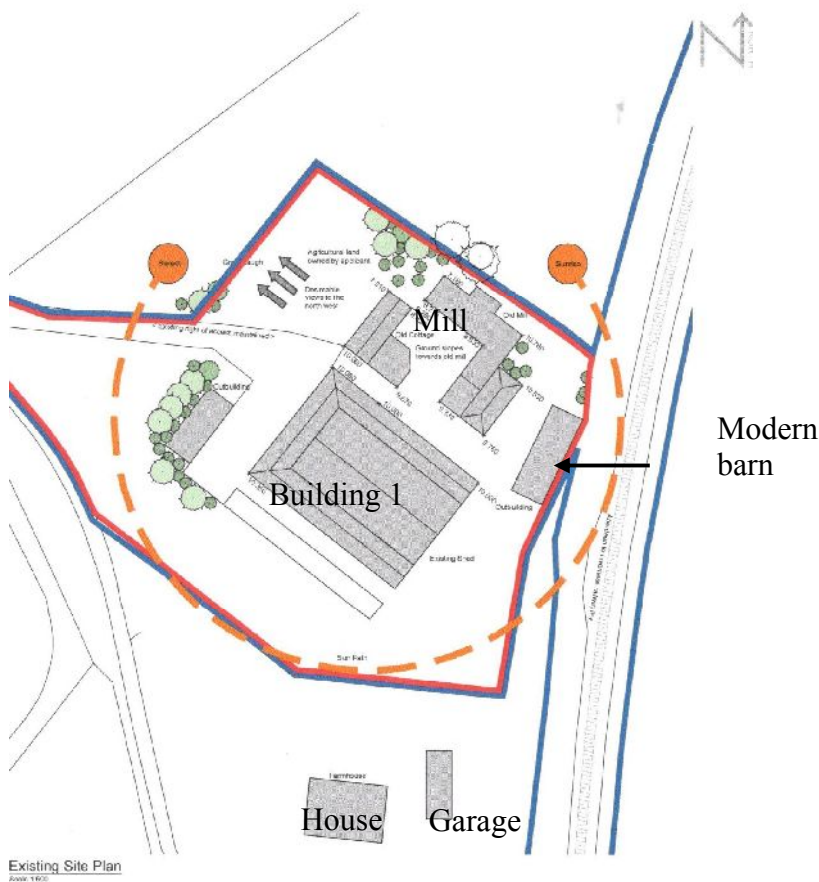

**Illus 2 Site layout plan courtesy of John Wink Design**

Parish: Drumblade

NGR: NJ 52102, 38083

GPS between the two ranges of buildings: 352116, 838076

Aberdeenshire SMR: NJ53NW0046

NMRS: NJ53NW40

Canmore id: 153222

The farmhouse (not included in this survey) is dated 1823 and is B listed: LB 2944

## 5 Documentary evidence

**1747-55** Greenhaugh (Greenhaw) is shown on Roy's Military Map of 1747-55 as a cluster of three buildings and a small enclosure surrounded by the rig and furrow of cultivated land. The military road shown by Roy is on the line of the A97.



Illus 3 Detail from Roy Military map of 1747-55. [www.nls.ac.uk](http://www.nls.ac.uk)

**1827** Captain George Gordon of Greenhaugh is named in a list of proposed Justices of the Peace (*Aberdeen Press and Journal* 18<sup>th</sup> April 1827)

**1828** Captain George Gordon of Greenhaugh granted a game license (*Aberdeen Press and Journal* 20<sup>th</sup> August 1828)

- 1829 An advertisement for a displesh sale at Greenhaugh (Aberdeen Press and Journal 29<sup>th</sup> April and 6<sup>th</sup> May 1829)

On account of the number of articles to be sold, the roup must be commenced at 10 o'clock morning.

**SALE OF FARM STOCKING,  
AND FARMING UTENSILS.**

There will be exposed for sale, by public roup, on Thursday the 7th day of May next, at Backiefield, on the farm of Greenhaugh, near Huntly,

**T**HE whole FARM STOCKING, and FARMING UTENSILS, belonging to William Mitchell there,-- consisting of 12 Cows, all mostly young, calved and in calf; 1 beautiful two-year-old Bull, and various young stock, all of superior breed; also, 2 excellent Work Horses, Carts, Ploughs, Harrows, &c. &c.

The Roup to begin at 12 o'clock noon, and Credit will be given on security.

*Backiefield, by Huntly, 27th April, 1829.*

**SALE ON FRIDAY.**

the Ayr  
Also,  
HUSB  
good In  
Harness  
Machin  
After  
about as  
one of B  
And,  
PARKS  
The r  
given on  
Ar  
DESIR  
A  
THE  
fo

Illus 4 Aberdeen Press and Journal 29<sup>th</sup> April 1829 [www.britishnewspaperarchive.co.uk](http://www.britishnewspaperarchive.co.uk)

- 1829 Captain George Gordon of Greenhaugh again granted a game license (*Aberdeen Press and Journal* 19<sup>th</sup> August 1829)

- 1829 Death announcement for Alexander Gordon, eldest son of Captain George Gordon of Greenhaugh (*Aberdeen Press and Journal* 23<sup>rd</sup> September 1829)

- 1833 Advertisement for a roup of farm stock and implements and the grass parks to be let out.

may menne. John Robert, junr. Greenhaugh, near Huntly, is to be sold, and for further particulars application may be made to A. Milne at Woodhead.

**SALE OF FARM STOCKING, CORN, AND STRAW,  
AND LET OF GRASS PARKS,  
At Greenhaugh, near Huntly.**

There will be Sold, by public roup, upon Wednesday the first day of May next

**T**HE whole FARM STOCKING on GREENHAUGH, consisting of 6 two-year-old Queys; 5 two-year-old Stots; 11 three-year-old Stots; 7 four-year-old Stots; 7 Cows, 2 lately Calved, 4 in Calf, and one fit for the Butcher; 3 Calves; a Bull, three years old. The Cattle are of a superior breed, and in excellent condition.

Also, the LABOURING UTENSILS on said Farm, consisting of Carts, Iron Ploughs, Turnip Plough and Machine, Harrows, Barn Fan, and every other kind of Husbandry Implement. An excellent four-wheeled PHAETON, with HARNESS, almost new, and been very little in use.

The Roup to begin at 10 o'clock, and the usual Credit will be given on Security.

*After the Sale, there will be let for the season,*

Five GRASS PARKS, from 15 to 20 Acres, all enclosed, well watered, and sheltered. The Grass is early, and in the centre of Markets. Also, 5 Ricks of CORN and STRAW, 4 of which are of Potatoe Oats, and of superior quality; and a Rick of WHEAT.

*Huntly, 15th April, 1833.*

Appl  
There  
T  
Charl  
Th  
on St  
There  
(or  
Al  
T  
Whit  
Th  
10 of  
of cal  
heart  
Th  
Stone  
dious  
dri  
w

Illus 5 Aberdeen Press and Journal 24<sup>th</sup> April 1833 [www.britishnewspaperarchive.co.uk](http://www.britishnewspaperarchive.co.uk)

1834 The following year the farm and house at Greenhaugh were up for lease. The farm buildings are described as, ‘a modern square of Offices, slated and every way suitable for its extent; besides a Gig-house and Threshing Mill, driven by water.’ The house is described as built within the last ‘four years’ - although the date stone on the house is 1823.

ALL RIGHTS RESERVED.

Work ble of , and  mson, paid.  capa- s well a pro- and refor- cents,  :ULA parish mant,  F  m of y Dr short great every  r con- : Use.  South Drug- Wil- ; W. RAY- igin;	Aberdeen, 30th Sept. 1834.  <b>CAPITAL FARM, NEAR HUNTLY.</b> <b>UPSET PRICE FARTHER REDUCED.</b> To be Let, for a Grassum, by Public Sale, within the Gordon Arms Inn, Huntly, upon Monday, the 12th of October next, at noon, <b>T</b> HE remainder of the Lease on <b>GREENHAUGH</b> being seven years to run from the term of Whitsunday last. This very desirable Farm consists of about 180 Scotch acres, in the highest state of improvement and rotation of cropping; and from the excel- lence of the soil, all sorts of Crops may be advantageously raised. The Fields have been judiciously laid off, and enclosed either by sub- stantial Stone Dykes, or Hedges in a very thriving state. The Public Roads in the neighbourhood of the Farm are excellent, and a supply of Manure can at all times be had from the town of Huntly, and Lime at a distance of five miles. Within the last four years, a DWELLING HOUSE has been erected at a considerable expense, on a plan every way suitable for the accommodation and comfort of a Genteel Family, and contains Dining and Drawing Room, 24 feet by 18 each, a Parlour, four ex- cellent Bed Rooms, and an Attic Storey, with Fire-places, neatly finished. The Ground Floor consists of Kitchen, Nursery, Pantry, Cellar, Dairy, and Servants' Apartments. The House is delightfully situated on the Banks of the Bogie, within fifteen minutes' walk of the town of Huntly, and the adjacent Grounds tastefully laid out with Shrubberies and thriving Plantations; and the Garden, sur- rounded by a Wall of sufficient height, is stocked with the different sorts of Fruit Trees and Berry Bushes. There is also on the Farm a modern Square of Offices, slated, and every way suited for its extent; besides a Gig-house, and Threshing Mill, driven by water. To a private gentleman, or farmer of sufficient capital, an opening of the above description, and combining so many advantages, is sel- dom to be met with; more particularly as the Farm is in a state that, should any one appear for it, and not be inclined to carry on a regular system of cropping, but circumscribe his operations to a limited extent, the Grass Parks, from their proximity to Cattle Markets, can be readily and advantageously let. Entry to Houses and Land at Martinmas first. For further information apply to Robert Mahe, Esq. Bank Agent, Huntly; or to Alexander Stewart, jun. Writer there; and the Grieve on the Farm will point out the boundaries. 29th September, 1834.	Com their pleted Mr way a Street street Board propi rietas A s diseas In c week, evenir  At (estal tians  F I D  On Gallo near l he ex Loi Mont bells Br belon Mr F PE visiti with
---	---	--

Illus 6 Aberdeen Press and Journal 1<sup>st</sup> October 1834 [www.britishnewspaperarchive.co.uk](http://www.britishnewspaperarchive.co.uk)

1834 A further roup was advertised on 15<sup>th</sup> October 1834, including items not sold in the previous sale.

The roup to begin at 11 o'clock forenoon, and credit to be given on security.  
Barff, 13th Oct. 1834.

**DISPLENISH SALE OF FARM STOCKING,**  
AT GREENHAUGH,  
Parish of Drumblade, near Huntly.

There will be Sold, by Public Roup, upon Monday the 27th day of October current,

**T**HE whole STOCK on said Farm, consisting of 4 excellent Work Horses; 5 Milch Cows; Stots, Queys, Calves, &c. Likewise, the whole LABOURING UTENSILS, consisting of Carts, Iron Ploughs, Harness, and every other kind of Husbandry Implements, and Horse Harness; together with various articles of Kitchen Furniture, Servants' Beds and Bedding, and Dairy Utensils. There will be Sold, at the same time, a Four-post Mahogany Bedstead, and 5 Tent Bedsteads, with Curtains, and various other articles in the Dwelling House, left over at last sale.

As the whole must be sold off on that day without reserve, the Sale will commence exactly at 10 o'clock forenoon.—Credit will be given.  
Huntly, 14th October, 1834.

and  
iday  
h.  
n.

106 Nov.

Illus 7 Aberdeen Press and Journal 15<sup>th</sup> October 1834 [www.britishnewspaperarchive.co.uk](http://www.britishnewspaperarchive.co.uk)

1835 A Sequestration notice describes George Gordon as the 'late tenant of Greenhaugh'.

77th year of his age.  
At 24, Hill Street, Edinburgh, on the 18th inst. the Rev. Dr Gardiner, in his eighty-sixth year.

**Sequestrations.**  
States of the affairs of Archibald Farquharson, Esq. of Finzean, and insurance-broker, Edinburgh, lie at the writing-chambers of Adam and Anderson, advocates, Aberdeen, for two months from the 23d July.—No dividend. Creditors of George Gordon, late tenant of Greenhaugh, stage-coach proprietor and underwriter, Aberdeen, will receive a second dividend, from Robert Milne, agent, Huntly, for the Banking Company in Aberdeen, after 26th August.

**Corn Markets.**  
CORN EXCHANGE, Monday, July 20.—The supply is moderate this morning, and in consequence of the fineness of the weather, Wheat is from 1s. to 2s. lower than on this day week, with a very dull sale at that reduction. The

Illus 8 Aberdeen Press and Journal 29<sup>th</sup> July 1835 [www.britishnewspaperarchive.co.uk](http://www.britishnewspaperarchive.co.uk)



- 1840** A report on a meeting of the Strathbogie Farmers Club ‘ comprised of tenants of the Duke of Richmond’ names Mr Barclay at Greenhaugh. (Aberdeen Press and Journal 26<sup>th</sup> August 1840)
- 1844** A notice concerning Justices of the Peace names ‘Jas Anderson, farmer, Greenhaugh’ (Aberdeen Press and Journal 21<sup>st</sup> February 1844)
- 1853** An advertisement for contractors to work on the barn and byres at Greenhaugh indicates a phase of building works.

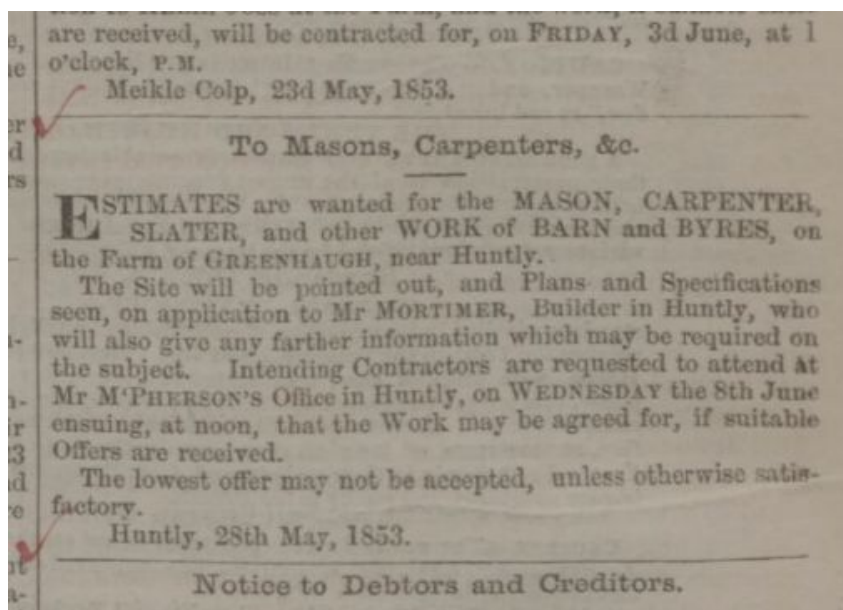

Illus 9 Aberdeen Press and Journal 1<sup>st</sup> June 1853 [www.britishnewspaperarchive.co.uk](http://www.britishnewspaperarchive.co.uk)

- 1861** In 1861 George Anderson, farmer at Greenhaugh and son of James Anderson died in a shooting accident (Aberdeen Press and Journal 5<sup>th</sup> June 1861). Later the same year the father George, still described as ‘farmer at Greenhaugh’ was acting as his son’s executor.

**1862** Grass parks at the farm were advertised to let (Aberdeen Press and Journal 9<sup>th</sup> April 1862) and later the same year there was a displenish sale (Aberdeen Press and Journal 23<sup>rd</sup> April 1862).

**1863**

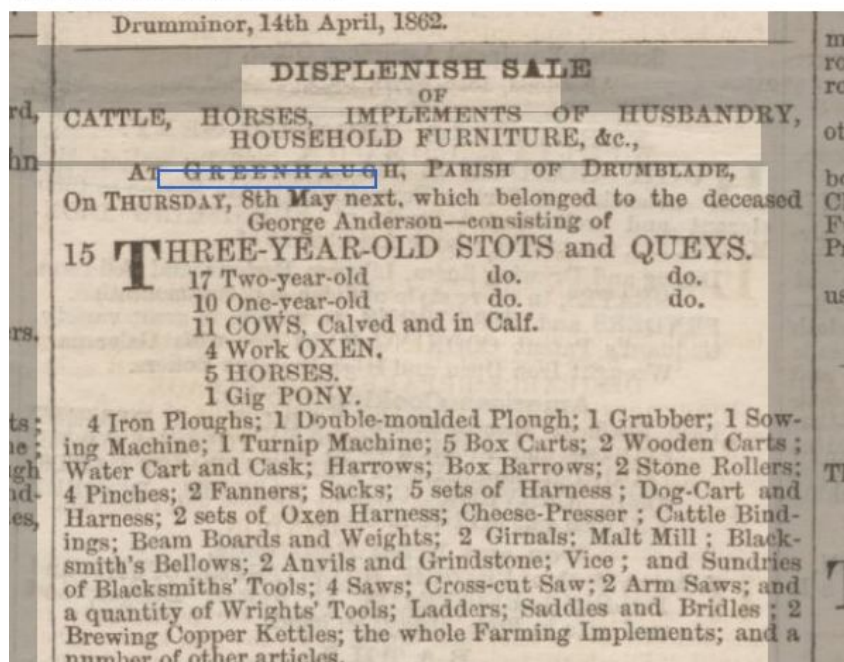

Illus 10 Aberdeen Press and Journal 23<sup>rd</sup> April 1862 [www.britishnewspaperarchive.co.uk](http://www.britishnewspaperarchive.co.uk)

**1869** The Anderson family continued to farm at Greenhaugh and a Mr and Mrs Anderson were praised in 1869 for the help they gave after a rail accident on the adjacent railway line (Aberdeen Free Press 31<sup>st</sup> December 1869)

**1870** A trial of Double-Furrow ploughs took place at Greenhaugh (Aberdeen Press and Journal 9<sup>th</sup> March 1870)

In the same year John Anderson, farmer at Greenhaugh was a judge at a quoiting competition in Huntly (Aberdeen Press and Journal 28<sup>th</sup> September 1870)

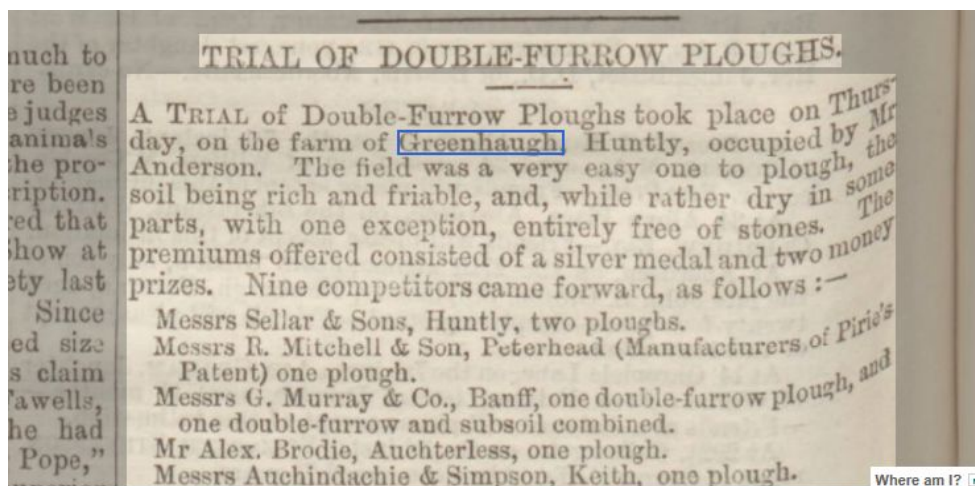

Illus 11 Aberdeen Press and Journal 9<sup>th</sup> March 1870 [www.britishnewspaperarchive.co.uk](http://www.britishnewspaperarchive.co.uk)

1865-71 The Ordnance Survey Name Book, Aberdeenshire OS1/1/25/57

[www.scotlandsplaces.gov.uk](http://www.scotlandsplaces.gov.uk) ) describes Greenhaugh as:

*'A large farmstead, in good repair situated south of Huntly about one and a half miles. There is a large dwelling house and a fine garden attached, and is the property of his grace the Duke of Richmond'. The tenant is named as John Anderson.*

1870 The 1<sup>st</sup> OS map 25"/mile of 1870 (published 1872) ( Aberdeenshire xxvi.13) shows both the existing steading buildings. To the S, nearer to the farmhouse, there is a U-plan steading facing SE, with a small building (not extant) across the open SE end and two small buildings directly S of it. To the N of this there is a group of buildings around three sides of an open court facing SW on to the access track.



Illus 12 1870 (1872) 25"/mile Aberdeenshire xxvi.13 [www.nls.ac.uk](http://www.nls.ac.uk)

- 1874** John Anderson's daughter married (Aberdeen Press and Journal 24<sup>th</sup> June 1874)
- 1876** Some 20 acres of turnips were sold from the field by Mr Anderson (Aberdeen Press and Journal 4<sup>th</sup> October 1876)
- 1877** Grass parks 'on the farm of Greenhaugh, Huntly, tenanted by Mr Anderson' were let for the season. (Aberdeen Press and Journal 5<sup>th</sup> May 1877). Further grass park sales are noted between 1878 and 1884.
- 1877** Mr Anderson won 1<sup>st</sup> prize for butter in a local show (Aberdeen Press and Journal 25<sup>th</sup> July 1877)
- 1884** Funeral announcement of John Anderson 'late of Greenhaugh Huntly' (Aberdeen Press and Journal 17<sup>th</sup> September)
- 1886** John Anderson (? Son) won a 1<sup>st</sup> prize for butter Aberdeen Press and Journal 6<sup>th</sup> August and in the following year for cheese (Aberdeen Press and Journal 21<sup>st</sup> July)
- 1892** Grass parks were still being let in 1891. The quality of the Greenhaugh grass was noted in a survey of 1892 (Aberdeen Press and Journal 8<sup>th</sup> January 1892)

BRITISH LIBRARY BOARD. ALL RIGHTS RESERVED.

plots had a good sole.  
"The value of Nos. 2 and 3 plots would be nearly equal, and about 5s per acre over No. 1 plot.  
"At none of the farms visited was the value of natural grasses better demonstrated than at Greenhaugh.  
"Mr Anderson always sows a percentage of natural grasses with perennial ryegrass and clover seeds, and as No. 1 plot was the only acre in a large field sown without the seeds of natural grasses, its weakness was so marked that any one who may visit Greenhaugh will see its 'blackness' at a long distance. Its value could not be put at less than 10s per acre below all the rest of the field. The whole of Mr Anderson's pasture is very good, and the mixture of seed he uses is almost identical with No. 3 supplied by your society.  
"On the farm of Cattie the natural grasses were found to take a good lead, the plot No. 3 being, as

Print Download

Illus 13 Aberdeen Press and Journal 8<sup>th</sup> January 1892 [www.britishnewspaperarchive.co.uk](http://www.britishnewspaperarchive.co.uk)

1900 The second OS map of 1900 (published 1901) 25"/mile Aberdeenshire sheet xxvi.13 shows no significant change to the buildings.



Illus 14 Aberdeenshire xxvi.13 1900 (published 1901) 25"/mile [www.nls.ac.uk](http://www.nls.ac.uk)

**1908** A ploughing match was held before John Anderson retired (Aberdeen Press and Journal 25<sup>th</sup> February 1908)

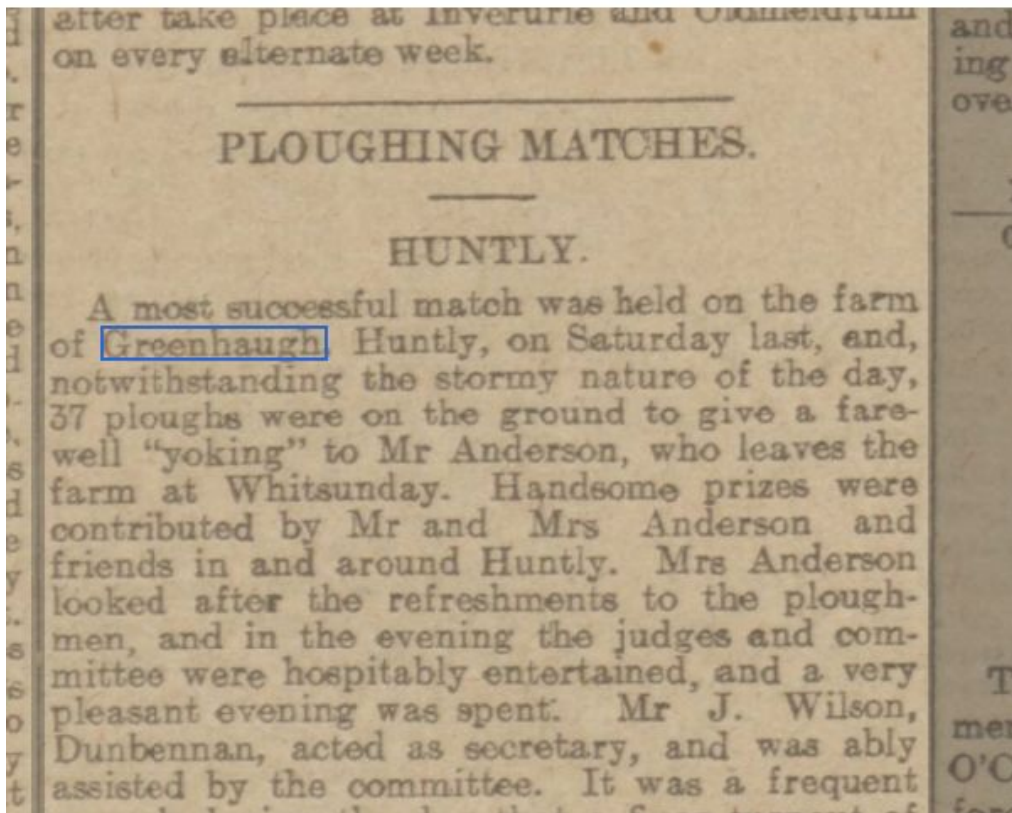

Illus 15 Aberdeen Press and Journal 25<sup>th</sup> February 1908 [www.britishnewspaperarchive.co.uk](http://www.britishnewspaperarchive.co.uk)

**1908** The farm was let to John and Alexander Macpherson.

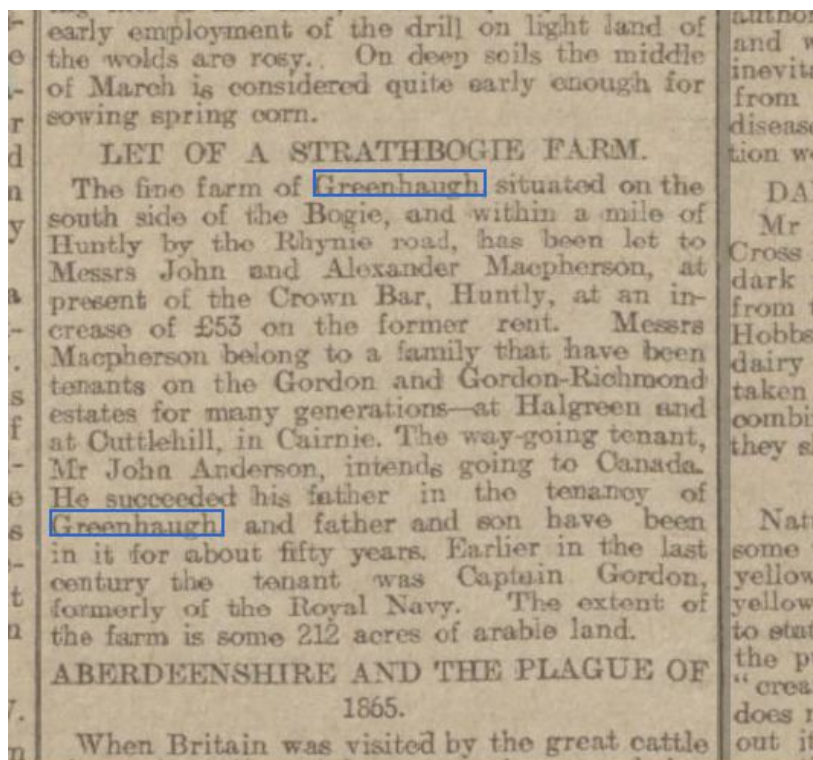

Illus 16 Aberdeen Press and Journal 13<sup>th</sup> March 1908 [www.britishnewspaperarchive.co.uk](http://www.britishnewspaperarchive.co.uk)

1927 Mr Macpherson was preparing to retire and the farm was offered up for a new tenancy.

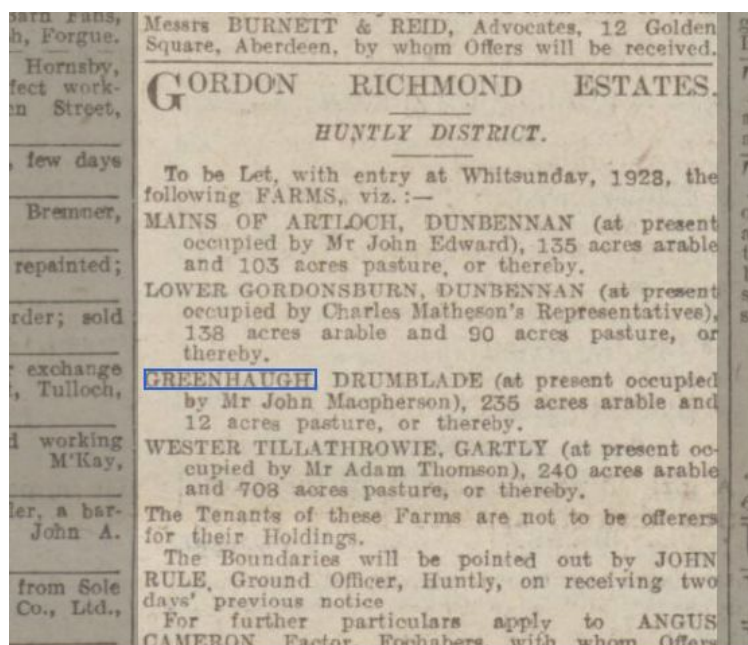

Illus 17 Aberdeen Press and Journal 23<sup>rd</sup> September 1927 [www.britishnewspaperarchive.co.uk](http://www.britishnewspaperarchive.co.uk)

1928 In 1928 Mr Macpherson held a dispenish sale, the listing for which gives some indication of the stock and equipment on the farm at the time.

son & Co. Ltd. Image created courtesy of THE BRITISH LIBRARY BOARD

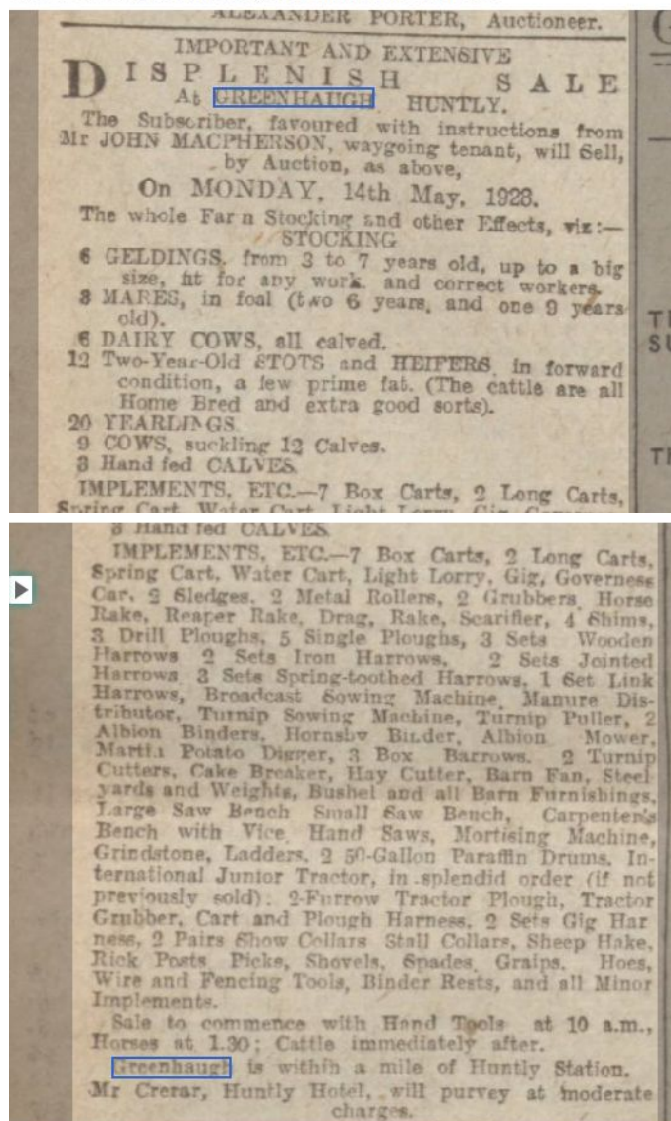

Illus 18 Aberdeen Press and Journal 11<sup>th</sup> May 1928 [www.britishnewspaperarchive.co.uk](http://www.britishnewspaperarchive.co.uk)

1924 The OS map of 1924 (published 1926) shows an additional building at the NW corner of the S building and a further freestanding building to the N of the N building.





Illus 19 Aberdeenshire xxvi.13 1924 (published 1926) 25''/mile [www.nls.ac.uk](http://www.nls.ac.uk)

**1928-1931** The tenant was William Turner but in 1930 the Gordon Richmond Estate were looking for a new tenant from 1931.

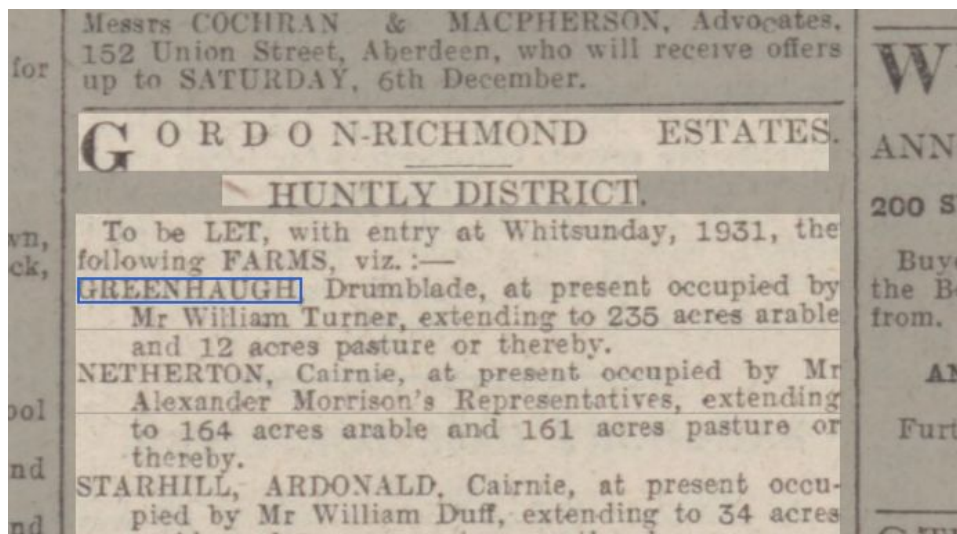

Illus 20 Aberdeen Press and Journal 28<sup>th</sup> November 1930 [www.britishnewspaperarchive.co.uk](http://www.britishnewspaperarchive.co.uk)

**1932** George Simpson took on the tenancy

**1936** Gordon Richmond Estates sold Greenhaugh and a number of other farms. This is probably when it was bought by the Cowdray Estates, Dunecht.

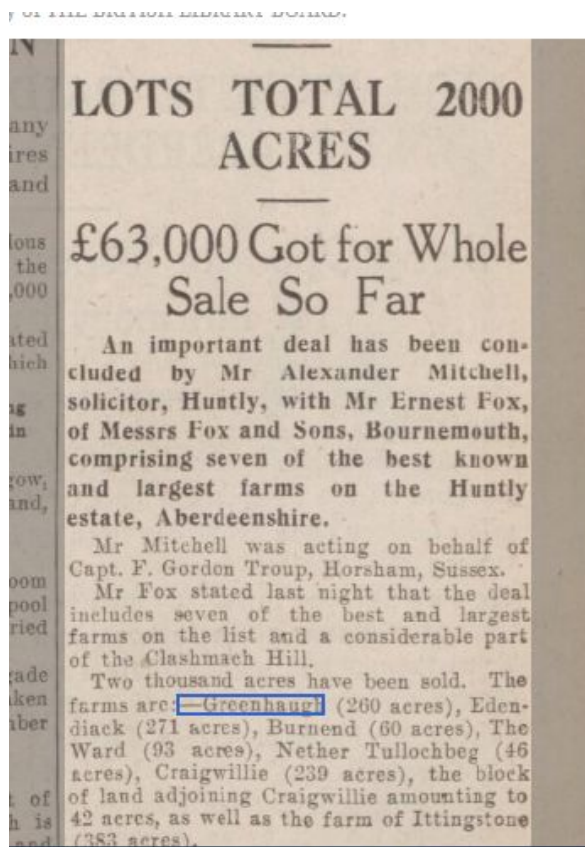

Illus 21 Aberdeen Press and Journal 8<sup>th</sup> October 1936 [www.britishnewspaperarchive.co.uk](http://www.britishnewspaperarchive.co.uk)

George Simpson and later his son Robert Simpson continued to hold the tenancy, selling both cattle and sheep (Huntly Mart records in Aberdeen Press and Journal)

**1968** Death of George Simpson (Aberdeen Press and Journal 13<sup>th</sup> February 1968)

**1975** Death of Robert Simpson (Aberdeen Press and Journal 12<sup>th</sup> December 1975)  
He 'had worked at Greenhaugh since his late father took the tenancy in 1932'

### Recent history

The present owners Mr Stewart and Sons bought the farm in 1984 from the Cowdray Estates, Dunecht (pers.comm. Mr Stewart).

## 6 Building 1 - the U-plan Steading

Dimensions 26.15 x 36m

Present/recent use Cattle accommodation

Former use Cattle, cart sheds etc

Walls Rubble stone with dressed grey granite at quoins and original openings.

Roof Slate over the original N, E and W ranges, corrugated asbestos over central court.

Plan U-plan open to SE with central court covered by modern steel framed roof.

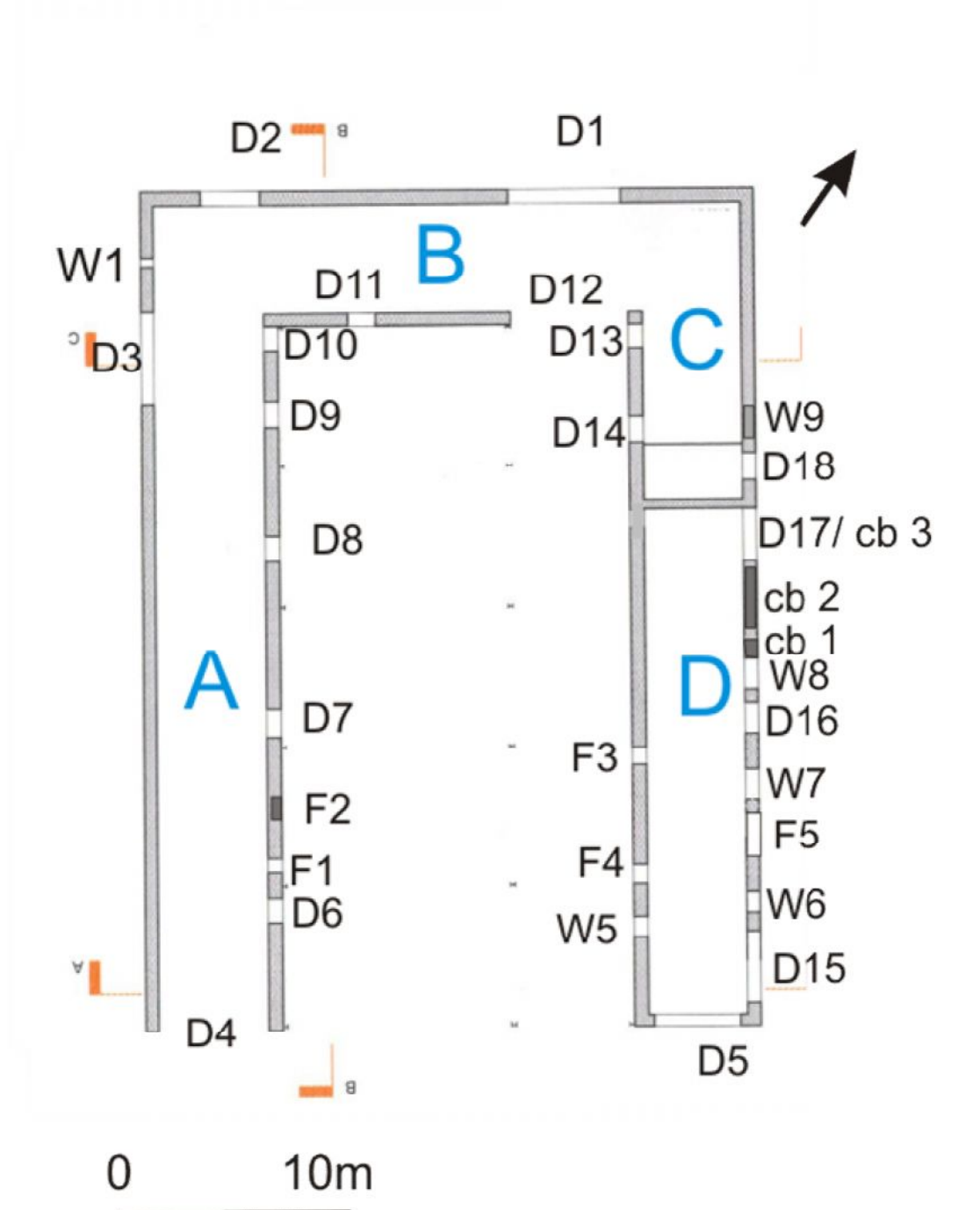

Illus 22 Plan of Building 1 courtesy of John Wink Design annotated by MAS Ltd

*NW Elevation*

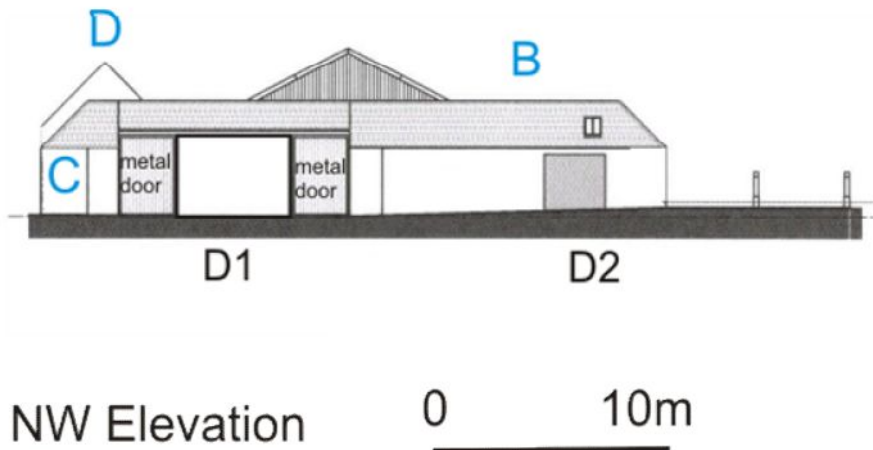

**Illus 23 NW elevation of Building 1 courtesy of John Wink Design annotated by MAS Ltd**

Doors and windows

**D1** W: 4.90m H: 3.45m Modern break through with raised roof and metal lintel, concrete sides. Metal sliding doors.

**D2** W: 2.56m H: 2.25m. Grey granite lintel, stone rybats. Partially blocked with stone with a smaller door (W: 1.23m) blocked by concrete blocks.



**Illus 24 NW elevation looking E**

*SW Elevation*

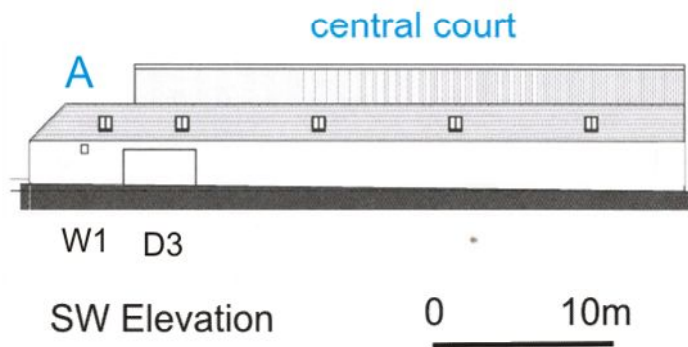

**Illus 25 SW elevation of Building 1 courtesy of John Wink Design annotated by MAS Ltd**

Doors and windows

**D3** W: 3.95m H: 2.27m. Concrete sides and metal lintel. Modern break through or enlargement.

**W1** W:0.43m H: 0.47m. Squared rubble surround.



**Illus 26 SW elevation looking W**

*SE Elevation*

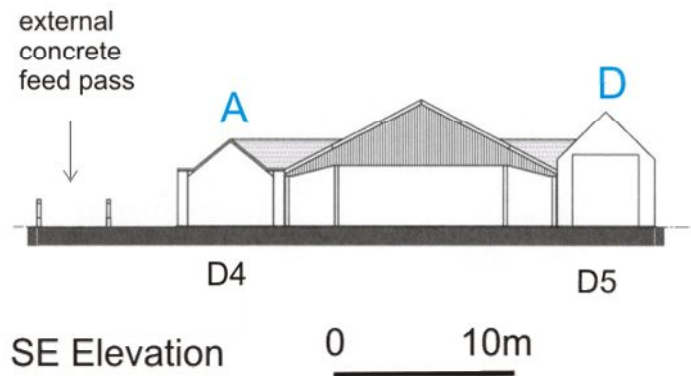

**Illus 27 SE Elevation of Building 1 courtesy of John Wink Design annotated by MAS Ltd**

Doors and windows

**D4** Modern break through of gable

**D5** Modern break through of gable



**Illus 28 SE elevation**

NE Elevation

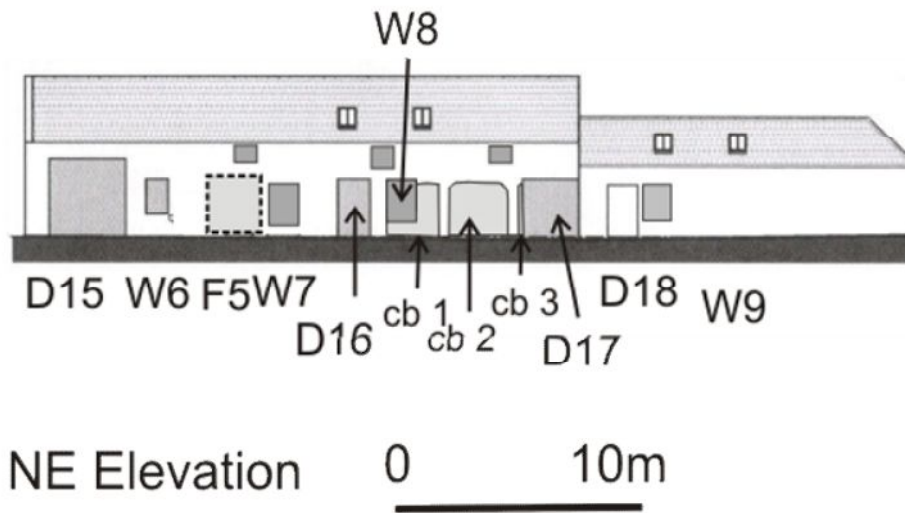

Illus 29 NE Elevation of Building 1 courtesy of John Wink Design annotated by MAS Ltd



Illus 30 Building 1. NE elevation looking W

Doors and windows

- D15** W: 3.12m H: 2.97m. Concrete lintel externally, timber internally. Concrete blocked.
- W6** W: 0.93m H: 1.45m. Granite lintel, sill and rybats. Stone blocked.
- F5** Granite lintel 2.5m wide and granite rybats on E, W rybats not visible. Stone blocked.
- W7** W:1.08m H: 1.55m Stone lintel. Concrete blocked.
- D16** W:1.34m H: 2.26m. Stone lintel. Concrete blocked.
- W8** W:1.13m H: 1.55m. Stone lintel. Concrete blocked.
- cb 1** Part blocked by W8, Originally as cb 2
- cb 2** W: 2.19m. H: approx 1.95m Granite arch and pillars
- cb 3** Almost fully blocked by D17, Originally as cb 2
- D17** W: 2.24m H: 2.45m Concrete lintel
- D18** W:1.22m H: 2.08m Granite lintel, sill and rybats
- W9** W: 1.07m H: approx 1.20m Lintel removed. Stone blocked
- Loft windows** Not measured. Concrete blocked.

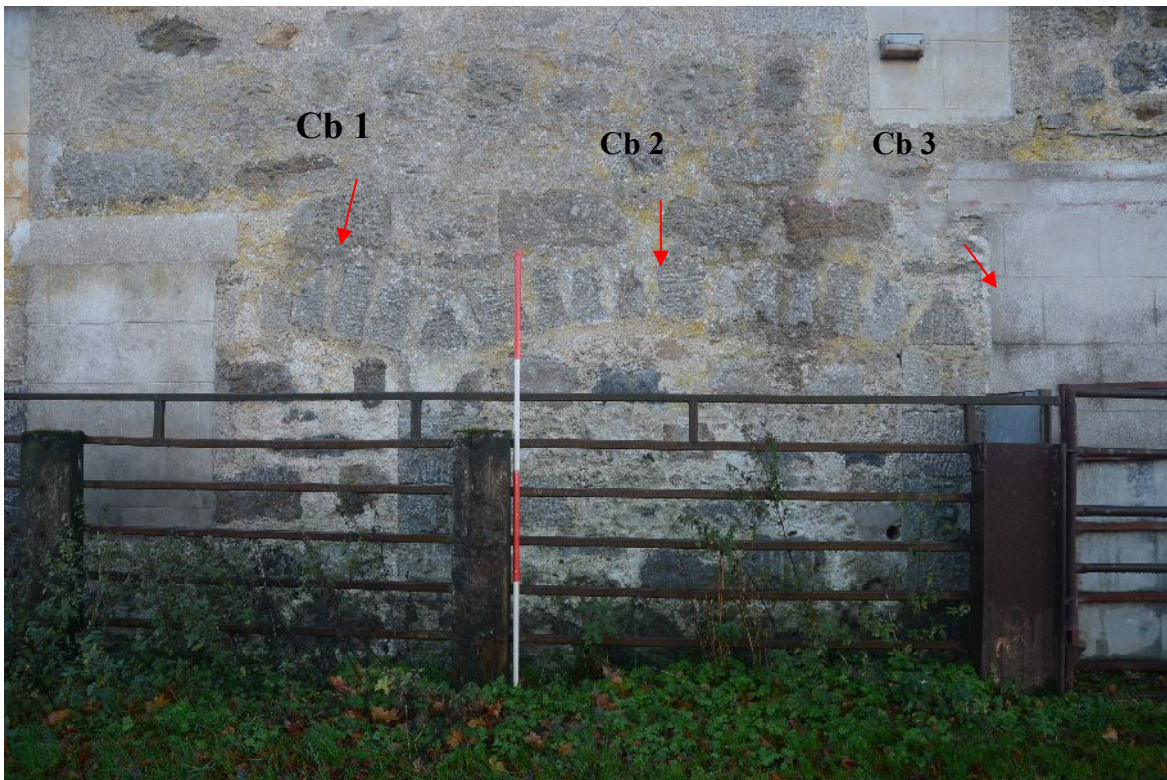

**Illus 31 Blocked cart bays (cb 1 – cb 3) in NE elevation.**



Interior

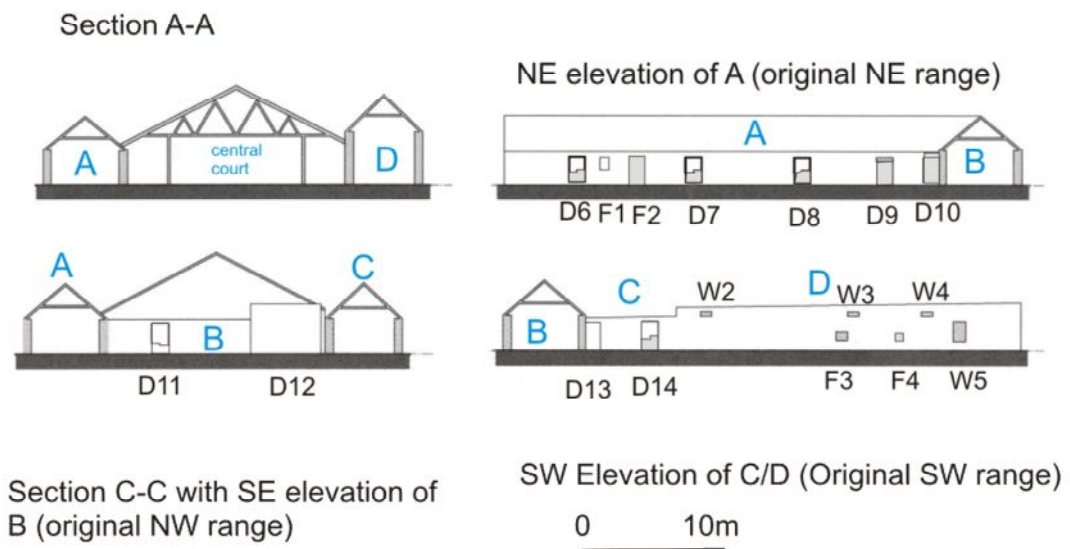

**Illus 32** Sections and interior elevations of Building 1 courtesy of John Wink Design annotated by MAS Ltd

*SE Elevation of Area B*

Doors and windows

**D11** W: 1.23m H: 2.09m. Lower half blocked with secondary water trough

**D12** Modern knock through with metal frame

*NE Elevation of Area A*



**Illus 33** Looking S along NE wall of Area A, seen from central court

Doors and windows

- D6** W: 1.07m H: 1.9m. Lower half blocked with secondary water trough. Granite lintel.  
**D7** W:1.21m H: 1.95m. Lower half blocked with secondary water trough. Granite lintel.



**Illus 34 Door D7 from Area A showing partial blocking by water trough**

- D8** W:1.12m H: 2.07m. Lower half blocked with secondary water trough. Granite lintel.  
**D9** W:1.08m H: 2.09m Concrete blocked. Granite lintel.  
**D10** W:1.07m H: 2.03m Stone rybats. Granite lintel.  
**F1** W: 0.48m H:0.58m. Stone surround. Splays into Area A. Window?  
**F2** W:1.05m H: 1.90m. Stone blocked.

*SW Elevation of Areas C/D*

Doors and windows

- D13** W: 1.0m H: 1.98m. Stone rybats to E, narrowed by concrete to W. Stone lintel. Metal gate.  
**D14** W: 1.06m H: 2.05m. Granite lintel. Lower half blocked with secondary water trough  
**W2-W4** Loft windows W: 0.54m H: approx 0.65m. Concrete blocked.  
**W5** W: 0.93m. H: 1.42m. Granite lintel, sill and rybats. Concrete blocked.  
**F3** W: 0.50m H: 1.60m. Stone surround. Concrete blocked.  
**F4** W:0.26m H:0.60m. Granite lintel. Concrete blocked.

Interior

**Area A** No internal details survive. However the original doors (D6, D7, D8, D9, D10) into what would have been the open central dung court would indicate it had been a cattle byre.

**Area B** No internal details survive.



**Illus 35** Area B looking SW

**Area C**

Area C was divided by a wooden partition. In the larger N room there were 3 double tied cow stalls with concrete trevices. Metal slides for cow chains survived. There was no indication of the function of the smaller area but it would have shielded the cows from draught through door D18. Window W9 must have been blocked prior to the cow stalls being built.



**Illus 36** Area C, cow stalls inside NE wall

**Area D**

Area D could not be entered as it had been used to store scrap metal. However the blocked cart bays (cb 1 – cb 3) indicate that the N end would have been used to store carts.. It is possible that

the S end was used for stabling or for cattle. There had been a hay loft above. A blocked loft door in the N gable of D had been closed off when the slightly lower secondary range C was built.



**Illus 37 Interior of Area D looking NW. Note sawn off joists of loft floor**

### **Central court**

The central court had been roofed by a modern steel framed structure. It had a lowered floor with feed passes on either side.

## **7 The Mill and associated buildings**

Plan The mill is rectangular and forms the NE side of a group of buildings set on three sides of a yard open to the SW onto the main access track to the farm from the bridge over the River Bogie.

### Dimensions

22 x 32m overall

Present/recent use Derelict

Former use Mill and small byre. The SE building (A) had been converted for use as a grain dryer.

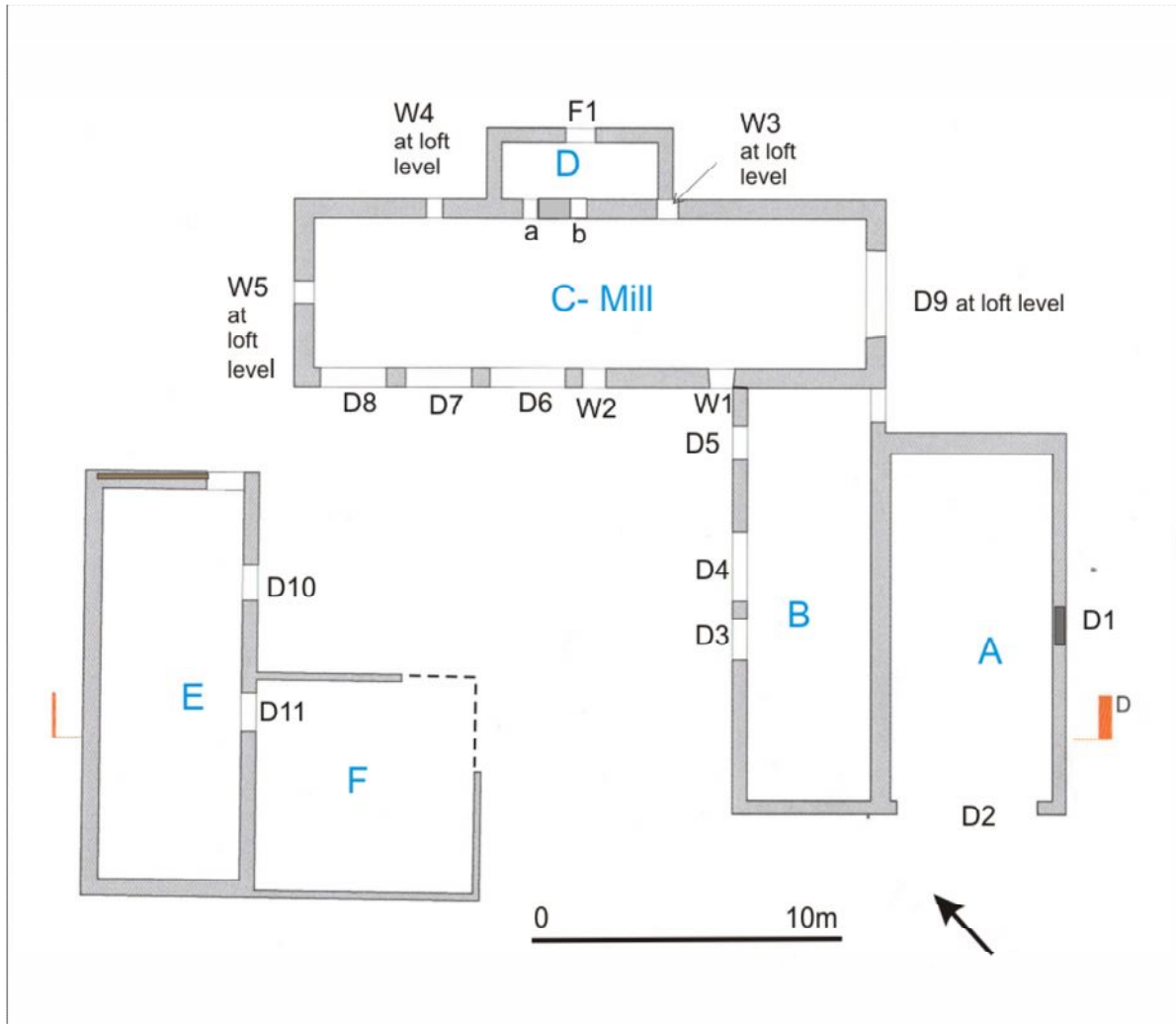

Illus 38 Mill. Ground plan courtesy of John Wink Design and annotated by MAS Ltd

### *Building A*

Dimensions 12 x 5.5m

Walls Regularly well- coursed rubble with granite quoins.

Roof Hipped. Formerly slated.

#### Doors and windows

**D1** W: 1.28m H: 2.67m. Centrally placed in SE wall. Rough dressed granite lintel and rybats. Concrete blocked.

**D2** Gable knocked through when the building was converted to a grain dryer.

Interior On conversion for grain drying, the interior had been gutted and the floor considerably lowered. However there is the marking of a horse trevis on the far end wall and

raggles on the inner face of the NW wall which strongly indicate this had been a stable, an interpretation which also fits with the height of D1.



**Illus 39** Looking NE into Building A. Red arrow indicates trevis mark. Blue line indicates original floor level

## *Building B*

Dimensions 13 x 5m

Walls Abuts mill.

Roof Lean-to against Building A. Collapsed but has been slated.

Doors and windows

**D3** W: 1.22m H: 1.90m Granite rybats. Secondary metal lintel.

**D4** W: 2.20m H: 1.90m Granite rybats. Secondary metal lintel.

**D5** W: 1.09m H: 1.90m. Granite rybats. Wooden lintel.

Interior

Scars on back wall suggest it had been divided into three compartments.

## *Building C and D – the Mill*

Dimensions Mill (C) 19 x 6m. It is built into the slope so that at SE end the ground is on level of loft, whereas the NW end is full height as the ground is much lower. D is the stone walled wheel pit.

Walls Well coursed squared rubble with granite quoins. There appears to be slightly different, smaller stonework at the base of the SW elevation but this was not observed elsewhere.

Roof Missing



Illus 40 Mill seen from the downhill, NW gable



**Illus 41 SW Elevation of mill seen from court**



**Illus 42 SW Elevation of mill. Detail of D6. Red arrow indicates line of arch replaced by concrete lintel**



---

Doors and windows

**D6** W: 2.45m H: 2.25m. Rybats partially stone on E with beginnings of an arch, Replacement concrete sill and replacement concrete pillar between D6 and D7

**D7** W:2.13m H: 2.25m. Base of pillar between D7 and D8 is stone. Replacement concrete sill.

**D8** W: 2.18m H: 2.25m Rybats to W of stone. Replacement concrete sill.

**W1** W:0.77m H:1.26m. Splayed internally. Granite lintel and rybats, replacement concrete sill.

**W2** W:0.74m H: 1.07m. Splayed internally. Granite lintel and rybats, slate sill on inside.

**F1** W: 0.94m. Top broken out.. This would have held the wheel axle and the inner end would have been held in 'b'. Openings a and b were inaccessible.



**Illus 43** Wheel axle holes F1 in foreground, 'b' behind.

**At loft level**

**D9** At SE gable of mill, the top is broken out but granite rybats remain at either side. W: approx: 2.8m. Due to higher ground at this end this opening would have been level with loft floor.



**Illus 44 Mill D9 to loft**

**W3, W4, W5** Not measured. Granite lintel, sill and rybats.

**The wheel pit and lade** The wheel pit (D) abutted the main wall of the mill and was stone-lined and c. 3.6m deep from present ground level. The entry and exit openings of the lade were visible from ground level and still appeared to have some water flow. Internally the wheel pit was approx 5m long, suggesting a wheel of about 4.5m diameter. As the flow appears to have been along the base of the pit the wheel would have been undershot.



**Illus 45** Looking NW along inside of wheel pit. Red arrow marks lade outflow. Openings a, b and F1 are marked

### *Building E and Yard F*

Dimensions E: 14 x 5.5m with yard F: approx 7 x 7m.

Walls Rubble stone. The NE gable appears to have been truncated and refilled with timber; this accords with the plan on both the 1870 and 1900 OS maps which show this building extending to the corner of the mill.

Roof Slate; partial collapse supported by secondary posts internally.

#### Doors and windows

**D10** W: 1.17m H: 1.95m Granite lintel and rybats.

**D11** W: 1.25m H: 1.95m Granite lintel and rybats.

Interior A hay rake and trough along the W wall indicate its use for cattle. Although this was named as 'Old Cottage' on the architects original plan, there is no evidence to suggest it had been a dwelling and no surviving evidence of a hearth, chimney or windows.



**Illus 46 Building E and yard F looking NW from inside the court. The roof on LHS belongs to the main U plan steading.**



**Illus 47 Interior of Building E looking SW**

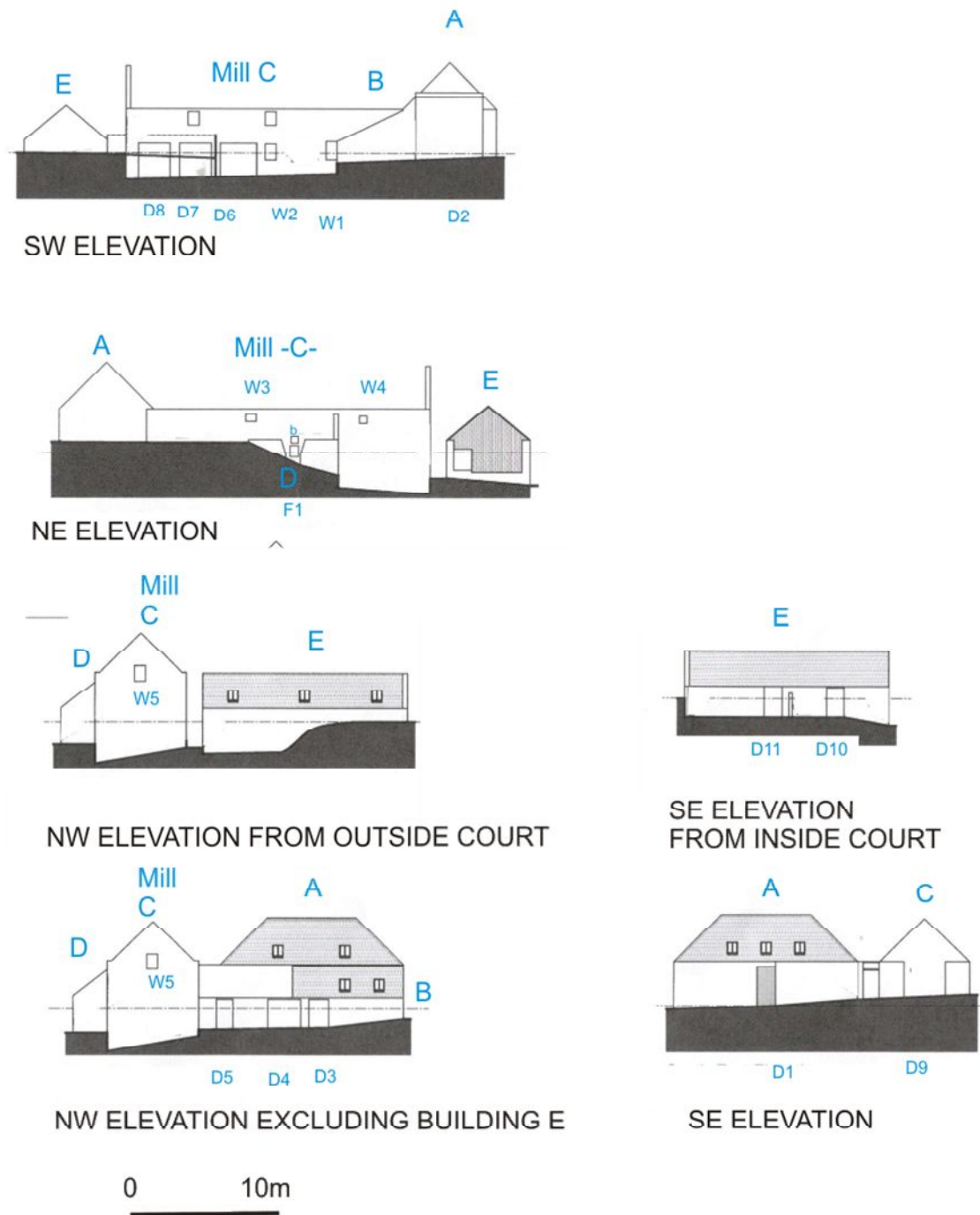

Illus 48 Mill complex. Elevations courtesy of John Wink Design. Annotated by MAS Ltd

## Discussion

Greenhaugh is depicted on Roy's Military Map of 1747-55, when there was a cluster of buildings on the site; however it is not possible to specifically attribute any of the surviving buildings to the 18<sup>th</sup> century. It is nevertheless possible that the mill and the smaller buildings of the mill complex may have been as early as this.

The farmhouse, which is dated by a date stone to 1823, is not a typical farmhouse being described in 1834 as 'suitable for a genteel family'. It was owned by the Gordon family at this stage and it is possible that it was built by them; certainly Captain George Gordon appears to have been tenant of the property from the mid 1820s until 1833/1834. By the end of his tenancy of the property it is described as having, 'a modern square of Offices, slated and every way suitable for its extent; besides a Gig-house and Threshing Mill, driven by water'. The 'modern square of offices' almost certainly would apply to the U-plan steading which in its original form would have been typical of early to mid 19<sup>th</sup>-century steadings, with cattle accommodation and probably stables for the farm horses and cart bays, all around the central open dung court. A building shown on the OS maps from 1870-1926 at the open end of the court may possibly have been a bothy. Typically a mill would have been part of this square. However, it is clear from the 1834 description that the water-driven threshing mill was considered as separate – a strong argument in favour of regarding the mill complex as part of the original- and possibly 18<sup>th</sup> century or certainly early 19<sup>th</sup> century- farmstead. The earliest definite proof of the smaller buildings (B, E) in the mill complex until the OS map of 1870- but they may have been earlier.

Some building works took place around 1853 when the Gordon Richmond Estates were advertising for contractors to work on the 'barn and byres' but it is not possible to identify what work was undertaken.

Most of the buildings that survive had been built by 1870 but the stable (Building A) at the mill complex was not built until between 1870 and 1900, so it cannot be the Gig House referred to in 1834.

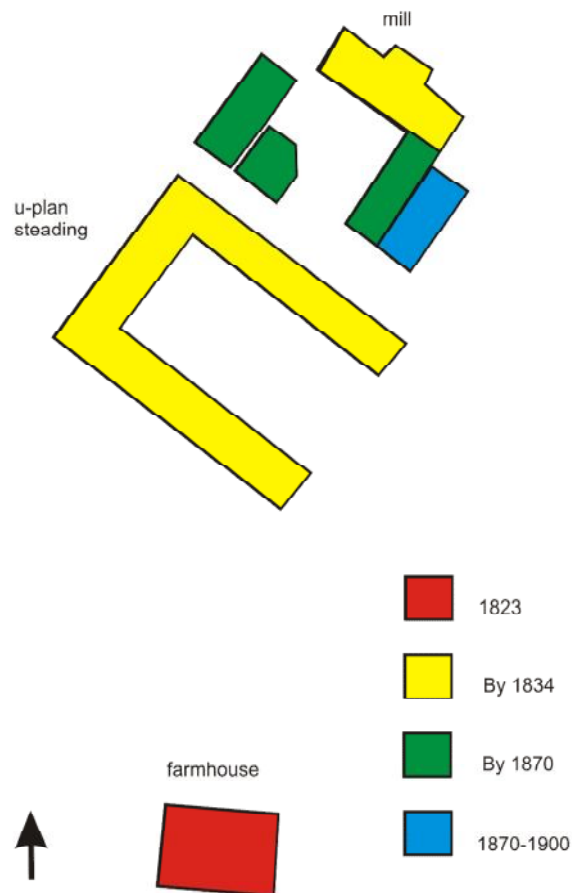

#### Illus 49 Schematic development

The lack of surviving internal details limits identification of the functions of the various buildings but the market reports in the British Newspaper Archive suggest that, although some sheep were traded, the farm mainly had cattle, with farm horses and oxen for draught. In the 1870s and 1880s the tenant John Anderson was winning prizes for butter and cheese in the local show and in 1928 six dairy cows are mentioned in the dispersal sale – these may have been kept in the tied cow stalls in Area C of the U-plan steading.

However much of the grass seems often to have been leased out. In 1930 the farm was described as having 235 acres arable and about 12 acres of pasture – suggesting that at this period cattle numbers had been reduced.

Greenhaugh is an example of a medium-sized 19<sup>th</sup> century farm, with a good example of a possibly 18<sup>th</sup>-century threshing mill.



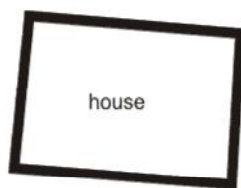
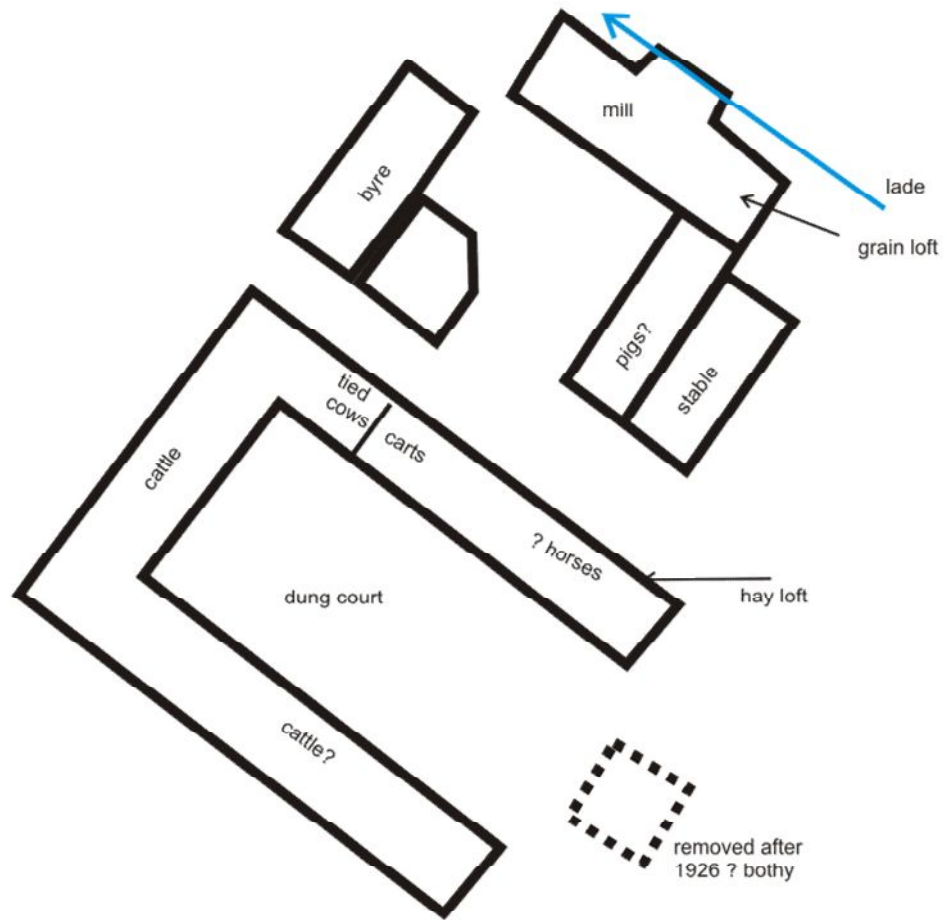

Illus 50 Interpretation of the functions of the steading

## 8 Archive

A full set of photographs with the photo location plans (Illus 51, 52) will be supplied to the Aberdeenshire SMR and to the HES archive.

<b>Photo number</b>	<b>Content</b>
1	General view looking S to farmhouse
	STEADING
2-4	View of steading looking N
5	Steading looking NE
6-7	Steading SE elevation
8-9	Steading N range SE elevation
10	Steading central court infill SE elevation
11-12	Steading S range SE elevation
13	View N across SE Elevation
14-15	Steading SW elevation
16	Steading D3
17	Steading W1
18-19	Steading NW elevation looking N
20	Steading D2
21-22	Steading NE elevation looking E
23-24	Steading NE elevation looking W
25-26	Steading D15
27-28	Steading F5, W7
29-30	Steading W7, D16, W8
31-32	Steading cb1 cb2
33-34	Steading D18, W9
35-36	Steading Area D looking inside from D5
37	SW elevation of Area D looking SE
38-39	SW elevation of Area D , D13, D14
40	Interior Area C looking NE
41	Interior Area C looking SE
42-43	Interior of central court looking S
44-45	Interior Area B looking SW
46-48	Interior Area A looking SE
49	Interior Area A water trough in D7
	MILL COMPLEX
50-51	General view Mill and Building A looking NW
52	Mill D9
53	Interior of mill from D9
54	Mill wheel pit F1
55-56	Looking NW along NE elevation mill and wheel pit
57-58	Looking into mill across wheel pit through F1
59	Opening 'a' in mill wall
60-62	Looking NW down into wheel pit
63-64	Mill NW elevation
65	NE elevation Building E
66-67	Looking E along NE elevation of mill
68-69	Looking W across front (D2) of Building A
70	SE elevation Building A
71-72	SW elevation Building A
73	Interior Building A looking through D2
74	Looking NW to Building E and yard F
75	SW elevation of mill

76	SE elevation Building E and yard F
77	NW elevation Building B
78-79	Mill SW elevation
80	Wall of Building B abutting mill
81-82	Interior of mill
83-84	Building E, D10
85	Yard F
86	Building E interior looking SW
87	Building E interior looking NE

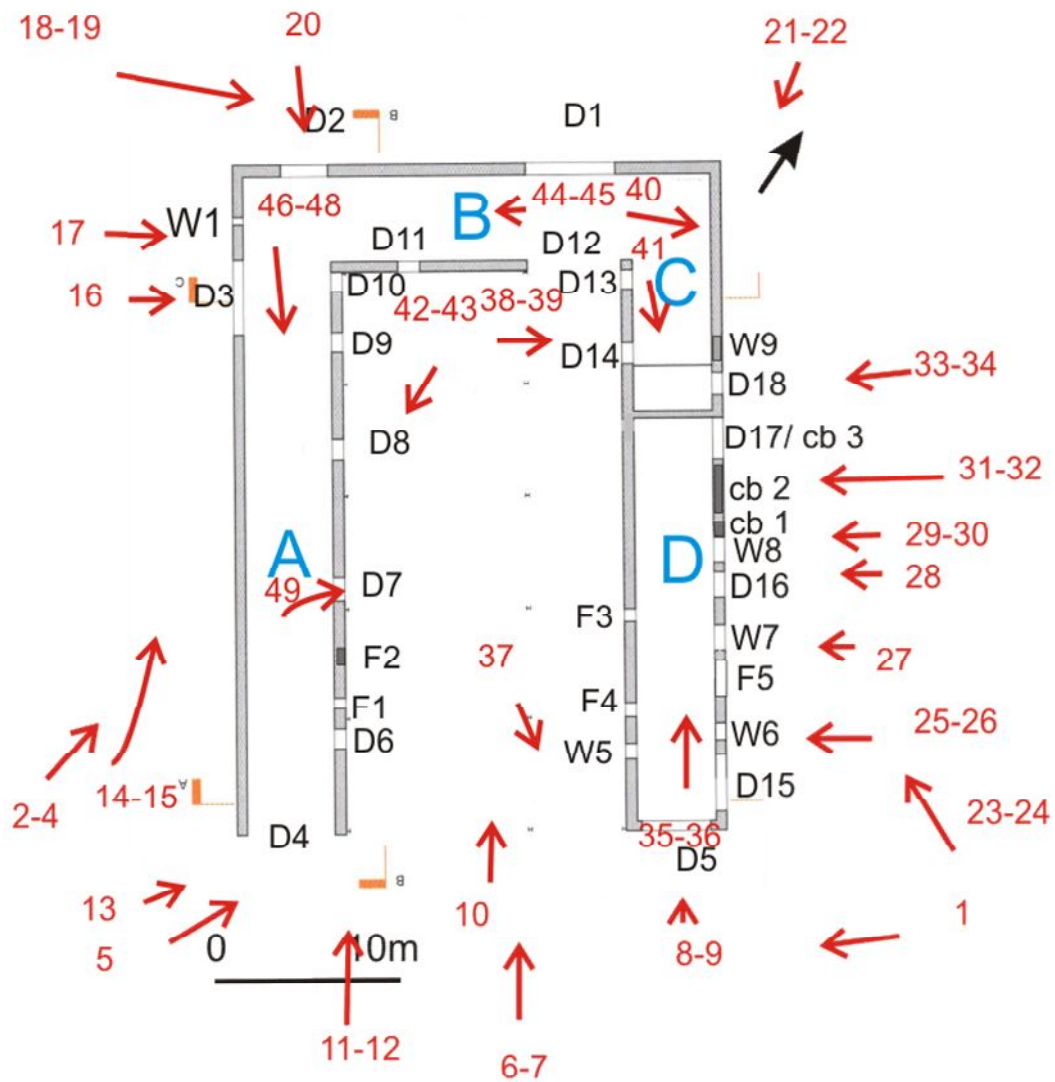

Illus 51 Photo location plan of steading

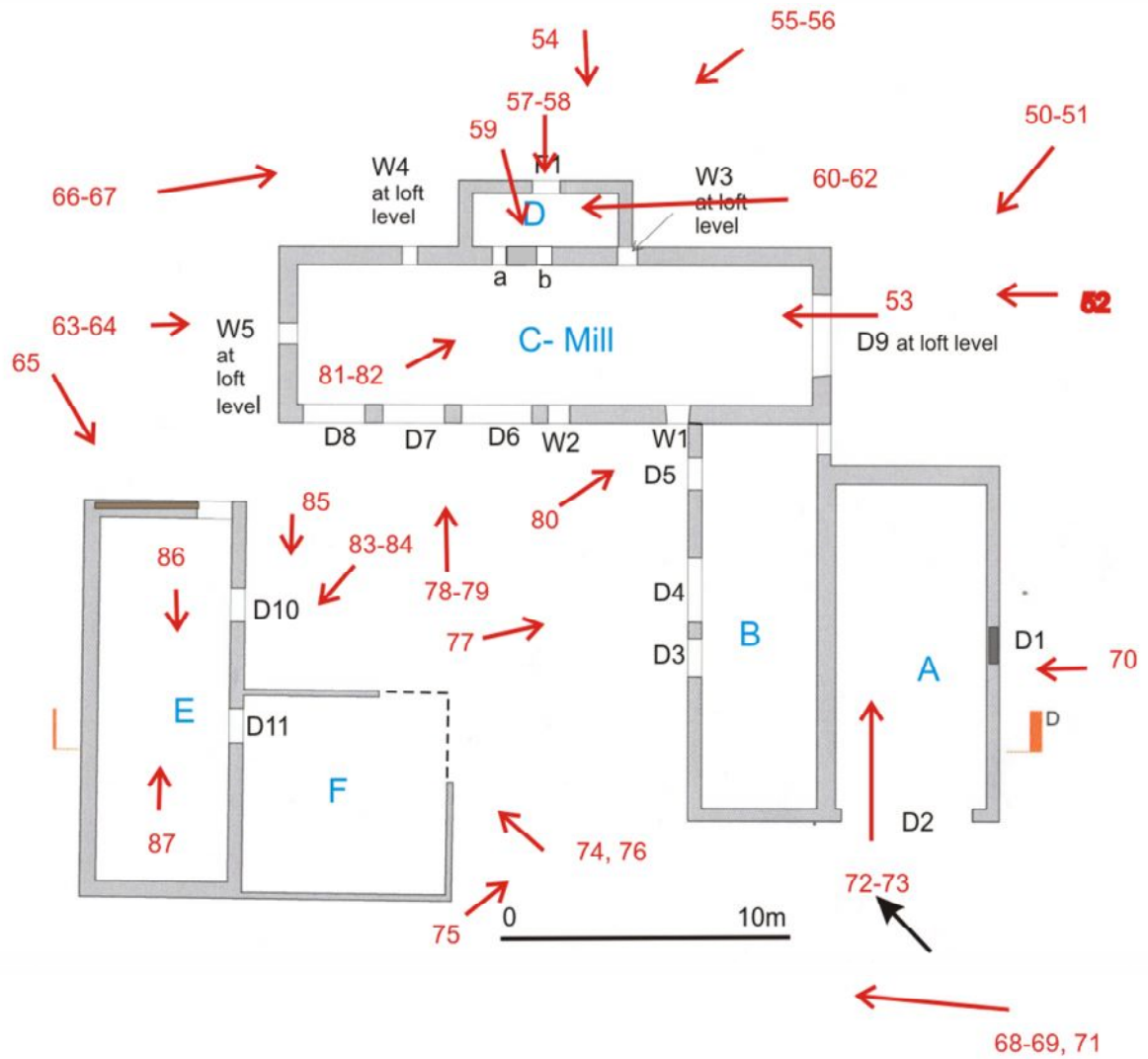

Illus 52 Photo location plan of mill