

wardell-armstrong.com

ENERGY AND CLIMATE CHANGE
ENVIRONMENT AND SUSTAINABILITY
INFRASTRUCTURE AND UTILITIES
LAND AND PROPERTY
MINING AND MINERAL PROCESSING
MINERAL ESTATES
WASTE RESOURCE MANAGEMENT



RM & DM LANDERS

LAND TO THE NORTH OF WALL BANK, WALL UNDER HEYWOOD, SHROPSHIRE

ARCHAEOLOGICAL EVALUATION REPORT

APRIL 2022

DATE ISSUED: April 2022
JOB NUMBER: BM12274
SITE CODE: WUH-A
OASIS REFERENCE: wardella2-503098
ORDNANCE SURVEY GRID REF: SO 50263 93006
REPORT VERSION NUMBER: BM12274-002_V1 FINAL

RM & DM LANDERS

**LAND TO THE NORTH OF WALL BANK, WALL UNDER HEYWOOD, SHROPSHIRE
ARCHAEOLOGICAL EVALUATION REPORT**

APRIL 2022

PREPARED BY:

Charlotte Manning Archaeologist

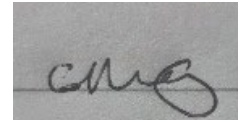

**REVIEWED AND
APPROVED BY:**

Rob Johns Technical Director



This report has been prepared by Wardell Armstrong LLP with all reasonable skill, care and diligence, within the terms of the Contract with the Client. The report is confidential to the Client and Wardell Armstrong LLP accepts no responsibility of whatever nature to third parties to whom this report may be made known.

No part of this document may be reproduced without the prior written approval of Wardell Armstrong LLP.



CONTENTS

SUMMARY.....	1
ACKNOWLEDGEMENTS.....	2
1 INTRODUCTION.....	3
1.1 Project Background.....	3
1.2 Project Documentation.....	3
2 METHODOLOGY.....	5
2.1 Standards and Guidance.....	5
2.2 Documentary Research.....	5
2.3 Archaeological Evaluation.....	5
2.4 Site Archive.....	6
3 BACKGROUND.....	7
3.1 Location and Geological Context.....	7
3.2 Historical and Archaeological Background.....	7
Non-Designated Heritage Assets.....	7
3.3 Previous Work.....	9
4 ARCHAEOLOGICAL EVALUATION RESULTS.....	11
4.1 Introduction.....	11
4.2 Results.....	11
4.3 Archaeological Finds and Environmental Sampling.....	11
5 CONCLUSIONS.....	12
5.1 Interpretation.....	12
6 BIBLIOGRAPHY.....	13
APPENDICES.....	14
APPENDIX 1: CONTEXT TABLE.....	15
APPENDIX 2: PLATES.....	16
APPENDIX 3: FIGURES.....	17

FIGURES (APPENDIX 3)

FIGURE	TITLE	SCALE
Figure 1:	Site and Trench Location.....	1:500
Figure 2:	Rushbury Tithe Map, 1840.....	1:250
Figure 3:	Trench Location Plan.....	1:250

SUMMARY

Wardell Armstrong LLP (WA) was commissioned by RM & DM Landers; hereafter referred to as the 'Client'; to undertake a programme of archaeological investigation of land proposed for the erection of a single plot exception (SPE) affordable dwelling and carport/garden store to the north of Wall Bank, Wall Under Heywood, Shropshire, SY6 7HL; hereafter referred to as 'the Site', centred at National Grid Reference (NGR): 350263, 293006. The evaluation was required as a condition of planning consent and was undertaken in accordance with a Written Scheme of Investigation produced in response to advice from the Archaeological Advisor of the Historic Environment Team at Shropshire Council, Charlotte Orchard.

The archaeological work was undertaken in one day, the 3rd December 2021, and comprised the excavation of one trench. This trench was targeted to provide a section across an earthwork platform recorded on the Shropshire Historic Environment Record to investigate the potential for associated remains, such as an enclosure ditch. The investigation revealed no archaeological features. Furthermore, it was established that no evidence of the possible enclosure ditch surrounding the platform has survived. The investigation identified two features of a horticultural nature, consistent with its current use as a vegetable plot; and a modern service trench. This and other modern land use may have truncated any below-ground archaeological remains that were formerly present.

ACKNOWLEDGEMENTS

WA thanks the Client, RM & DM Landers, for commissioning the project; and for all their assistance throughout the work. WA also thanks Charlotte Orchard, Archaeological Advisor of the Historic Environment Team (HET), at Shropshire Council for her assistance.

The archaeological evaluation was supervised by Robert Johns and the report written by Charlotte Manning. The figures were produced by Richard Abbott and Robert Johns. The project was managed by Robert Johns, who also edited the report.

1 INTRODUCTION

1.1 Project Background

1.1.1 In March 2022 Wardell Armstrong LLP (WA) undertook an archaeological evaluation at Land to the North of Wall Bank, Wall Under Heywood Shropshire, SY6 7HL, centred at National Grid Reference (NGR): 350263, 293006 (Figure 1). It was commissioned by the Client, who intends to erect a single plot exception (SPE) affordable dwelling and carport/garden store for which a planning consent has been granted by Shropshire Council (planning reference: 19/04167/FUL).

The grant of planning permission by Shropshire Council, dated 21st September 2021, contains Condition 5, which states:

“No development shall commence until the applicant/owner/developer has secured the implementation of a programme of archaeological work in accordance with a written scheme of investigation (WSI) which shall first be submitted to and approved in writing by the Local Planning Authority.

Reason: To ensure that any evidence associated with known archaeological features on and in the vicinity of the site is recorded/preserved satisfactorily, in accordance with Policies CS6 and CS17 of the Shropshire Local Development Framework Adopted Core Strategy. This information is required prior to commencement of the development since it relates to matters which need to be confirmed before subsequent phases proceed in order to ensure a sustainable development.”

1.1.2 This planning condition was in line with advice provided to Shropshire Council by Shropshire Council Historic Environment Team (HET) on the planning application, dated 16th October 2019.

1.1.3 The Site lies partly on the recorded location of an enclosure of possible medieval or earlier date, recorded on the Shropshire Historic Environment Record (HER). A forked ditch, also within the Site, is recorded on the northern side of the platform and a further fragmentary ditched enclosure is possibly attached to the western side. A historic well is also noted within the Site.

1.2 Project Documentation

1.2.1 The project conforms to a brief which was prepared in consultation with Charlotte Orchard, Archaeological Advisor in the HET at Shropshire Council. A WSI (WA 2021) was then produced to provide a specific methodology based on the brief for a

programme of archaeological trial trench evaluation. This was approved by the Archaeological Advisor prior to the fieldwork taking place. This is in line with government advice as set out in Section 16 of the National Planning Policy Framework 2019 (MHCLG 2019).

- 1.2.2 This report outlines the work undertaken on site, the subsequent programme of post-fieldwork analysis, and the results of the archaeological evaluation.

2 METHODOLOGY

2.1 Standards and Guidance

2.1.1 The archaeological evaluation was undertaken following the Chartered Institute for Archaeologists (CifA) *Standard and guidance for archaeological field evaluation* (2014a), and in accordance with the WA fieldwork manual (2017).

2.1.2 The fieldwork programme was followed by an assessment of the data as set out in the *Standard and guidance for archaeological field evaluation* (CifA 2014a) and the *Standard and guidance for the collection, documentation, conservation and research of archaeological materials* (CifA 2014b).

2.2 Documentary Research

2.2.1 Information on recorded heritage assets and features of interest was gained via a search of the Shropshire HER, using a study area of 1km radius from the Site boundary (HER ref IR1895).

2.2.2 Information on designated heritage assets was complemented by GIS information from the National Heritage List for England (NHLE), maintained by Historic England (April 2022).

2.3 Archaeological Evaluation

2.3.1 The evaluation comprised the excavation of one trench measuring 24m long and 1.5m wide across the Site of just under 1,000m². The trench was positioned to achieve a section across the site at an acute angle to the possible platform/enclosure, representing a 3.6% sample of the overall site. The evaluation trench specified in the WSI was 25m long, but it was not possible to achieve this given physical on-site constraints.

2.3.2 The general aims of the investigation were:

- to establish the presence/absence, nature, extent and state of preservation of archaeological remains and to record these where they were observed;
- to establish the character of those features in terms of cuts, soil matrices and interfaces;
- to assess the impact of the application on the archaeological site;
- to recover artefactual material, especially that useful for dating purposes;
- to recover palaeoenvironmental material where it survives in order to understand site and landscape formation processes.

And specifically to:

- Confirm the presence or absence of the platform/enclosure identified on the HER within the Site;
- confirm the presence or absence of any associated remains or those of other dates within the Site; and
- evaluate the significance of any such remains.

2.3.3 Deposits considered not to be significant were removed by a mechanical excavator with a toothless ditching bucket, under close archaeological supervision. All possible features or deposits were inspected, and selected deposits were excavated by hand to retrieve artefactual material and environmental samples. Once completed all features were recorded according to the WA standard procedure as set out in the Excavation Manual (WA 2017).

- No finds were recovered during the evaluation.

2.3.4 On completion the evaluation trench was reinstated by replacing the excavated material.

2.4 Site Archive

2.4.1 A full professional archive has been compiled in accordance with the project specification, and the Archaeological Archives Forum recommendations (Brown 2011). The archive will be deposited with Shropshire Archives, with copies of the report sent to the Shropshire HER, available upon request.

2.4.2 Wardell Armstrong LLP supports the **Online Access to the Index of Archaeological Investigations (OASIS)** project. This project aims to provide an on-line index and access to the extensive and expanding body of grey literature, created as a result of developer-funded archaeological work. As a result, details of the results of this project will be made available by WA as a part of this national project. The OASIS reference for the project is: wardella2-503098.

3 BACKGROUND

3.1 Location and Geological Context

3.1.1 The site is located at National Grid Reference (NGR): 350263, 293006. The site is situated north of Wall Bank, Wall Under Heywood, to the east of Church Stretton, South Shropshire. It lies directly to the south-east of Stone Acton Road, in the angle formed between this and the B4371 to the south. To the west, there is a residential dwelling known as 'The Crispen,' and its associated outbuildings. The area of investigation lies at a height of c 186m aOD (above Ordnance Datum) with the wider area sloping down gently to the east and south.

3.1.2 The site is approximately 1,000m² (0.1 hectare) in size and is roughly rectangular in shape. At present the site comprises an intersection between two field enclosures under pasture. It is also partly used for a vegetable plot.

3.1.3 The British Geological Survey (BGS) records the Site as on the boundary between Harnage Shale Formation Mudstone to the north and Pentamerus Sandstone Formation to the south, with a band of Chatwall Flags and Chatwall Sandstone (undifferentiated) immediately to the west. There are no superficial deposits recorded. The natural substrate observed during the current phase of works comprised a firm, mottled mid orangey-greyish brown clayey sand, with outcroppings of stone, and a patch of blueish grey clay, which is consistent with the mapped geologies above.

3.2 Historical and Archaeological Background

Designated Heritage Assets

3.2.1 There are no designated heritage assets within the Site or its close proximity. The nearest are listed buildings in Wall Under Heywood, some 680m and more to the south-east of the Site.

Non-Designated Heritage Assets

3.2.2 Shropshire HER contains a single reference (**ref. 04042**) to a complex of possible archaeological remains within and surrounding the Site to the east and south.

3.2.3 **Prehistoric (up to AD 43):** There is very little record of prehistoric activity in the environs of the Site, save for one record of a flint scatter on Gutter Farm (**HER ref 03435**), around 1.4km to the west of site. This scatter consists of c.800 lithic fragments, ranging from Mesolithic to Bronze Age in date. The lithic types vary, with

knives, arrowheads and axes represented. This collection remains unpublished, so interpretation is limited. However, it suggests that human occupation occurred from at least the Mesolithic period in this area and continued through to the Bronze Age.

3.2.4 **Medieval (AD 1066 – c.1540):** Shropshire HER reference 04042 is described as an earthwork platform and associated ditches, of unknown date, but assumed to be medieval. They are visible on aerial photographs and have been mapped by RCHME's (The Royal Commission on the Historic Monuments of England) Marches Uplands Mapping Project in 1993-4. It is described as rectangular, measuring some 60m by 45m, and appears as a raised earthwork with rounded corners, surrounded by a ditch. A forked ditch extends from the northern side of the platform, and the HER records two or three further ditches to its western side, perhaps indicating a fragmentary enclosure.

3.2.5 The earthworks were identified from a series of specialist oblique aerial photographs, taken by Chris Musson of Clwyd Powys Archaeologist Trust (CPAT) from a light aircraft in the 1980s. An excerpt of one of these is included as Image 1, below.



Image 1: Excerpt from CPAT aerial photograph 84-036-0021 (CPAT, 1984)

3.2.6 A field inspection confirmed the presence of this 'platform' which appears on the ground to comprise an enclosure, possibly of natural origin but likely augmented, with

a substantial embankment to the west, although only traceable to the north (i.e. within the Site) with 'the eye of faith', where this has been used as a garden allotment or vegetable plot.

- 3.2.7 Another potential medieval earthwork (**HER ref 04043**) is recorded in Stone Acton, around 800m to the south-east of the Site. It is described as a possible field system, and was identified from aerial photographs, taken in the 1980s and 2010.
- 3.2.8 No other evidence of medieval activity has been documented, aside from the slight earthwork remains of ridge and furrow cultivation visible on LiDAR imagery (**HER ref 34159**). This is located some 3.2km south of the investigation area.
- 3.2.9 **Post-medieval (AD c.1540 – 1901)**: There are several listed buildings nearby, dating from the 17th century onwards. The oldest extant building recorded in the surrounding area is Old Hall Farmhouse (**HER ref 11355**), a Grade II listed building dating from 1620, with later alterations. Wall paintings of possible 17th century provenance survive.
- 3.2.10 The Historic Farmsteads Characterisation Project, conducted 2008-2010 (**HER ref ESA6427**), identified 11 farmsteads in and around Wall Under Heywood. These date from the 17th century onwards, but are mostly of early 19th construction. This dovetails neatly with the agricultural picture of Rushbury Parish illustrated by the Tithe map of 1840 (Figure 2).
- 3.2.11 The Site is on a crease in the map, but the field enclosures within and around the Site are clear. The current field boundaries seem little changed from this map. Although there is no depiction of an earthwork on the map, land within the Site is shown as plot 303 "Remainder of Round Yard"; with the adjacent plot 298 recorded as "Part of Round Yard", which could well refer to the rounded platform and/or enclosure recorded on the HER. At this time the Site and adjacent property was in the ownership of Frances Thursby and Thomas Papillon and occupied by Edward Butler.
- 3.2.12 The HER records one final instance of post-medieval activity: a quarry identified only from a c.1900 OS map (**HER ref 29875**), around 1.4km to the south-east of Site.
- 3.2.13 The search of the Shropshire HER concluded that there was a reasonable likelihood that archaeological remains of medieval date may be present within the proposed development site.

3.3 Previous Work

3.3.1 No archaeological works have been undertaken within the Site. Outside the Site, the nearest archaeological works that have occurred are a series of broad mapping works concerning monument identification through aerial photography (**HER ref ESA5698**), and surveying of listed buildings at risk (**HER ref ESA5888**).

4 ARCHAEOLOGICAL EVALUATION RESULTS

4.1 Introduction

4.1.1 The evaluation was undertaken on the 3rd of December 2021 with one trench excavated across the Site (Figure 2). The trench was positioned to achieve a section across the site at an acute angle to the possible platform/enclosure (**Plate 1 and 2**). The historic well was immediately adjacent to the north-east (**Plate 3**).

4.2 Results

4.2.1 **Trench 1 (Figures 1 and 3; Plates 4 and 5)** was situated in the centre of the Site and orientated north-west to south-east. The trench measured 24m long and 1.5m wide. It had a minimum depth of 0.3m and a maximum depth of 0.5m. The natural substrate (**1003**) (**Plates 6 and 7**) consisted of a mixed deposit of firm mottled mid orangey-greyish brown clayey sand and sandy clay; with occasional stone inclusions, frequent small angular gravels, isolated outcroppings of stone; and a patch of blueish grey clay> The natural was overlain by a 0.2m thick deposit of a friable, mid orangey-greyish brown sandy clay subsoil (**1002**). The trench was sealed by a 0.3m thick topsoil (**1001**) comprised of a loose, dark greyish brown sandy clay with moderate rooting throughout.

4.2.2 The trench was devoid of features of archaeological interest, but several anomalies were investigated, including: **[1004] (Plate 8)**, a horticultural 'trench' filled with topsoil in the SE end of the trench; **[1005] (Plate 9)**, a horticulture-related gully to the NW; and **[1006] (Plate 10)**, a service trench containing a cast-iron pipe, filled with (**1007**), a deposit consisting of mixed topsoil and natural, located in the north-west end of the trench.

4.3 Archaeological Finds and Environmental Sampling

4.3.1 No archaeological finds were recovered, and no environmental samples were retained during the groundworks.

5 CONCLUSIONS

5.1 Interpretation

- 5.1.1 During the archaeological evaluation at Land to the North of Wall Bank, one trench was excavated within, covering 24m² of the proposed 1000m² development area. The purpose of the evaluation was to establish the nature and extent of above and below ground archaeological remains within the vicinity, the evaluation trench being located to target both the platform and the possible enclosure ditch.
- 5.1.2 The trench was excavated down to the top of the natural substrate.
- 5.1.3 The trench was devoid of archaeological features and deposits, although several features were investigated and proved to be undated, although clearly related to current or recent horticulture; and a service trench. No finds were recovered, and no environmental samples were taken.
- 5.1.4 No evidence relating to the enclosure, such as any suggestion of a ditch; or any associated activity was observed within the trench. However, the platform formed by the enclosure is clearly evident outside the Site; and appears to be embanked to the south and east. Aerial photographs from 1984, such as that reproduced above, appear to show earthworks within the Site, from which it can be inferred that the ground has been landscaped or levelled since this time. Further below ground remains may survive outside the Site.

6 BIBLIOGRAPHY

- BGS. 2021. *Geology of Britain Viewer*, <http://mapapps.bgs.ac.uk/geologyofbritain/home.html>, British Geological Survey, accessed 26th September 2021.
- Brown, D.H. 2011. *Archaeological Archives: A Guide to Best Practice in Creation, Compilation, Transfer and Curation*, Archaeological Archives Forum
- CIfA. 2020a. *Standard and Guidance for an Archaeological Evaluation*, Chartered Institute for Archaeologists, Reading
- CIfA. 2020b. *Code of Approved Conduct for the Regulation of Arrangements in Field Archaeology*, Chartered Institute for Archaeologists, Reading
- CIfA. 2020c. *Standard and Guidance for the collection, documentation, conservation and research of archaeological materials*, Chartered Institute of Field Archaeologists, Reading
- Historic England. 2011. *Environmental Archaeology: A guide to the theory and practice of methods, from sampling and recovery to post-excavation*, Historic England, London
- Historic England. 2015. *Management of Archaeological Research Projects in the Historic Environment, (MoRPHE)*, Historic England, London
- Historic England. 2016. *Preserving archaeological remains: Decision-taking for sites under development*, Historic England: London
- Historic England. 2017a. *Guidance for best practice for treatment of human remains excavated from Christian burial grounds in England, second edition*, Historic England,
- Historic England. 2017b. *Understanding the Archaeology of Landscapes: A Guide to good recording practice*, Second Edition English Heritage, Swindon
- Perrin, K *et al.* 2014. *A Standard and Guidance to Best Practice for Archaeological Archiving in Europe*, EAC Guidelines **1**, Europae Archaeologia Consilium, Namur
- WA. 2017. *Wardell Armstrong Technical Manual for Field Archaeology*, Wardell Armstrong, unpublished internal guidance document

APPENDICES

APPENDIX 1: CONTEXT TABLE

Trench 1

Length: 24m Width: 1.5m Orientation: NW-SE

Average Depth: 0.4m Maximum Depth: 0.5m

Context Number	Context Type	Description	Dimensions	Interpretation
1001	Layer	Loose, dark greyish brown sandy clay with moderate rooting throughout.	D: 0.3m	Topsoil.
1002	Layer	Friable, mid orangey-greyish brown sandy clay.	D: 0.2m	Subsoil.
1003	Layer	Firm, mottled mid orangey-greyish brown clayey sand and sandy clay, with occasional stone inclusions, frequent small angular gravels, and isolated outcroppings of stone, and a patch of blueish grey clay	-	Natural Substrate.
1004	Cut	N-S aligned sub-rectangular feature.	W: 0.55m L: 0.80m+	Cut of horticultural trench.
1005	Cut	E-W aligned linear feature.	W: 0.3m L: 1.75m+	Cut of horticultural gully.
1006	Cut	SW-NE aligned linear feature.	W: 0.3m L: 1.5m+	Cut for modern service trench.
1007	Fill	Friable mixed dark greyish brown and mid orangey brown clayey sand.	W: 0.3m L: 1.5m+	Fill of service trench [1006].

APPENDIX 2: PLATES



Picture Taken:
25/11/2021

Plate
No. 1

Title: Pre-Ex Shot of Site, Showing Possible Medieval Platform. 2m Scale.



Picture Taken:
3/12/2021

Plate
No. 2

Title: Shot of Extent of Possible Medieval Platform. 2m Scale.

Client: RM & DM Landers

Project: Land to the North of Wall Bank, Wall Under Heywood, Shropshire

Project Number: BM12274





Picture Taken:
3/12/2021

Plate
No. 3

Title: SE Facing Shot of Backfilled Trench, Showing Historic Well to NE.
1m Scale.



Picture Taken:
25/11/2021

Plate
No. 4

Title: Pre-Ex Shot of Site Showing Field Boundaries and
Greenhouse.

Client: RM & DM Landers

Project: Land to the North of Wall Bank, Wall Under Heywood, Shropshire

Project Number: BM12274





Picture Taken:
3/12/2021

Plate
No. 5

Title: NW Facing Shot of Trench 1. 2 x 1m Scales.



Picture Taken:
3/12/2021

Plate
No. 6

Title: NE Facing Shot of Intervention into Variation in Natural Substrate. 1m Scale.

Client: RM & DM Landers

Project: Land to the North of Wall Bank, Wall Under Heywood, Shropshire

Project Number: BM12274



Picture Taken:
3/12/2021

Plate
No. 7

Title: NE Facing Shot of Variation in Natural Substrate to SE end of Trench. 1m Scale.



Picture Taken:
3/12/2021

Plate
No. 8

Title: NE Facing Section of Feature [1004]. 1m Scale.

Client: RM & DM Landers

Project: Land to the North of Wall Bank, Wall Under Heywood, Shropshire

Project Number: BM12274





Picture Taken:
3/12/2021

Plate
No. 9

Title: SW Facing Section of Feature [1005]. 1m Scale.



Picture Taken:
3/12/2021

Plate
No. 10

Title: NE Facing Section of Feature [1006]. 1m Scale.

Client: RM & DM Landers

Project: Land to the North of Wall Bank, Wall Under Heywood, Shropshire

Project Number: BM12274

APPENDIX 3: FIGURES

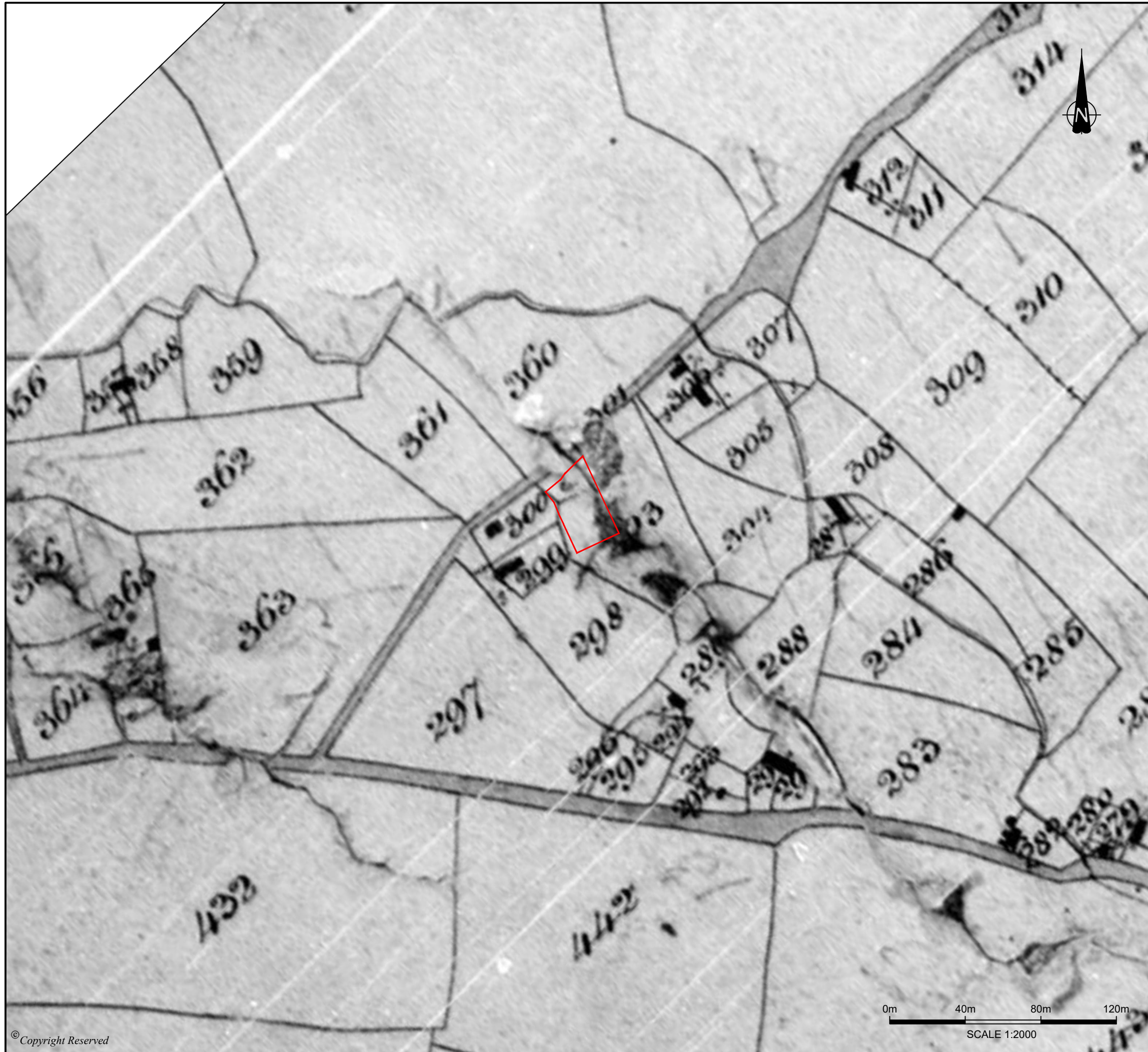

DO NOT SCALE FROM THIS DRAWING

REFERENCE

INDICATIVE SITE BOUNDARY

A	First issue	26/04/22	RA	RJ	RJ
---	-------------	----------	----	----	----

REVISION	DETAILS	DATE	DRN	CHKD	APPD
----------	---------	------	-----	------	------

CLIENT
RM AND DM LANDERS

PROJECT
LAND TO THE NORTH OF WALL BANK,
WALL UNDER HEYWOOD

DRAWING TITLE
FIGURE 2:
RUSHBURY TITHE MAP 1840

DRG No.	BM12274-002	REV	A
---------	-------------	-----	---

DRG SIZE	A3	SCALE	1:2000	DATE	26/04/22
----------	----	-------	--------	------	----------

DRAWN BY	RA	CHECKED BY	RJ	APPROVED BY	RJ
----------	----	------------	----	-------------	----

 BIRMINGHAM | TEL 0121 580 0909
 WWW.WARDELL-ARMSTRONG.COM

<input type="checkbox"/> BOLTON	<input type="checkbox"/> LEEDS
<input type="checkbox"/> CARDIFF	<input type="checkbox"/> LONDON
<input type="checkbox"/> CARLISLE	<input type="checkbox"/> MANCHESTER
<input type="checkbox"/> EDINBURGH	<input type="checkbox"/> NEWCASTLE UPON TYNE
<input type="checkbox"/> GLASGOW	<input type="checkbox"/> STOKE ON TRENT



PLAN OF TRENCH
SCALE 1:100

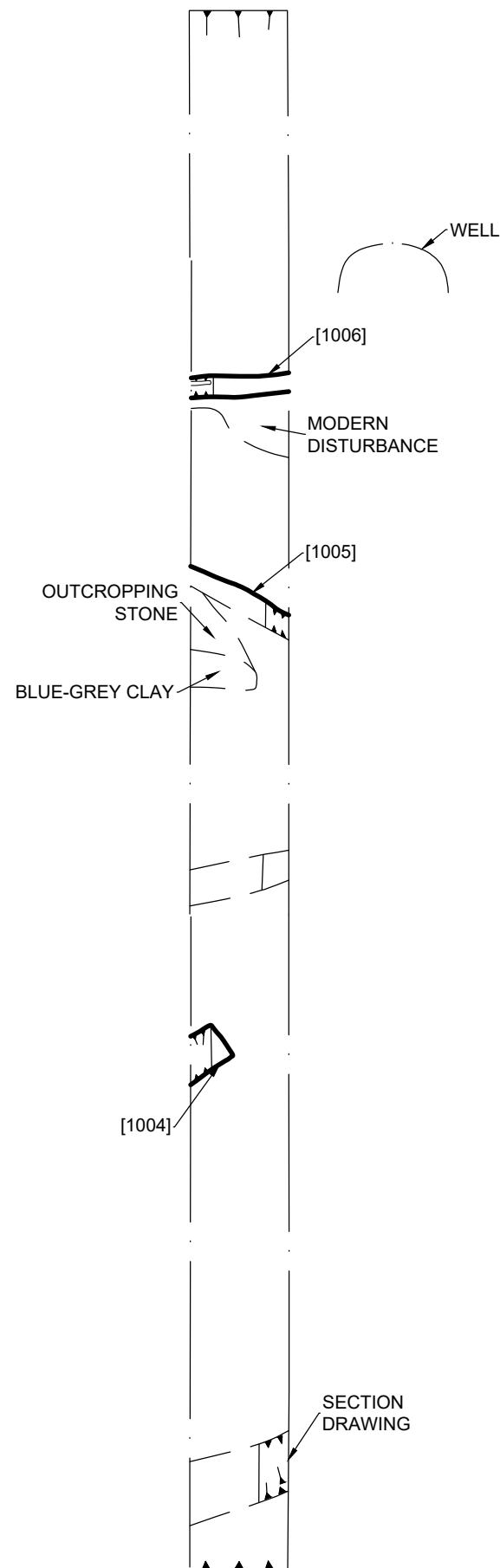

SECTION SHOWING SOUTHEAST END OF TRENCH
SCALE 1:10

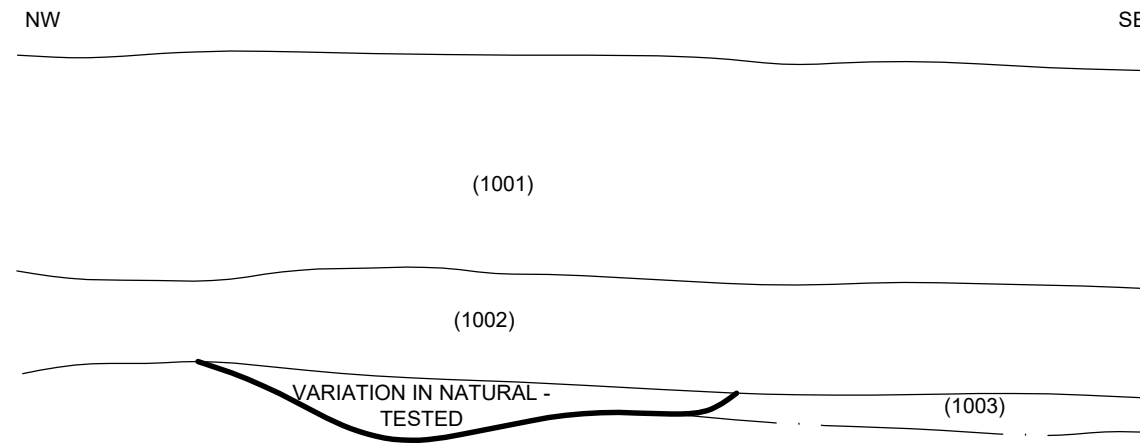

DO NOT SCALE FROM THIS DRAWING

REFERENCE

- CUT LINE
- DEPOSIT LINE
- LIMIT OF EXCAVATION
- TRENCH LIMIT
- PROJECTION LINE

A	First issue	26/04/22	RA	RJ	RJ
---	-------------	----------	----	----	----

REVISION	DETAILS	DATE	DRN	CHK'D	APP'D
----------	---------	------	-----	-------	-------

CLIENT	RM AND DM LANDERS
--------	-------------------

PROJECT	LAND TO THE NORTH OF WALL BANK, WALL UNDER HEYWOOD
---------	---

DRAWING TITLE	FIGURE 3: SECTION AND PLAN OF TRIAL TRENCH
---------------	---

DRG No.	BM12274-003	REV	A
---------	-------------	-----	---

DRG SIZE	A3	SCALE	AS SHOWN	DATE	26/04/22
----------	----	-------	----------	------	----------

DRAWN BY	RA	CHECKED BY	RJ	APPROVED BY	RJ
----------	----	------------	----	-------------	----

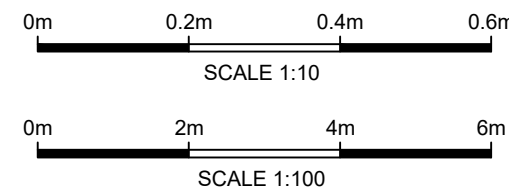

■ BIRMINGHAM | TEL 0121 580 0909
 WWW.WARDELL-ARMSTRONG.COM

<input type="checkbox"/> BOLTON	<input type="checkbox"/> LEEDS
<input type="checkbox"/> CARDIFF	<input type="checkbox"/> LONDON
<input type="checkbox"/> CARLISLE	<input type="checkbox"/> MANCHESTER
<input type="checkbox"/> EDINBURGH	<input type="checkbox"/> NEWCASTLE UPON TYNE
<input type="checkbox"/> GLASGOW	<input type="checkbox"/> STOKE ON TRENT



DO NOT SCALE FROM THIS DRAWING

Key

- Site Boundary
- Excavated Trial Trench
- HER Monument (Polygon)

REVISION	DETAILS	DATE	DRN	CHK'D	APP'D
----------	---------	------	-----	-------	-------

CLIENT
RM and DM Landers

PROJECT
LAND NORTH OF WALL BANK, WALL UNDER HEYWOOD

DRAWING TITLE
FIGURE 1:
SITE AND TRENCH LOCATION

DRG No.	BM12274-003	REV	P1
DRG SIZE	A3	SCALE	1:500
		DATE	April 2022
DRAWN	RJ	CHECKED BY	CM
		APPROVED BY	RJ



- BIRMINGHAM | TEL 0121 580 0909
WWW.WARDELL-ARMSTRONG.COM
- BOLTON
- CARDIFF
- CARLISLE
- EDINBURGH
- GLASGOW
- LONDON
- MANCHESTER
- NEWCASTLE UPON TYNE
- SHEFFIELD
- STOKE ON TRENT

Contains OS data © Crown copyright and database right 2022

STOKE-ON-TRENT

Sir Henry Doulton House
Forge Lane
Etruria
Stoke-on-Trent
ST1 5BD
Tel: +44 (0)1782 276 700

BIRMINGHAM

Two Devon Way
Longbridge Technology Park
Longbridge
Birmingham
B31 2TS
Tel: +44 (0)121 580 0909

BOLTON

41-50 Futura Park
Aspinall Way
Middlebrook
Bolton
BL6 6SU
Tel: +44 (0)1204 227 227

BRISTOL

Desk Lodge
2 Redcliffe Way
Bristol
BS1 6NL
Tel: +44 (0)117 203 4477

BURY ST EDMUNDS

Armstrong House
Lamdin Road
Bury St Edmunds
Suffolk
IP32 6NU
Tel: +44 (0)1284 765 210

CARDIFF

Tudor House
16 Cathedral Road
Cardiff
CF11 9LJ
Tel: +44 (0)292 072 9191

CARLISLE

Marconi Road
Burgh Road Industrial Estate
Carlisle
Cumbria
CA2 7NA
Tel: +44 (0)1228 550 575

EDINBURGH

Great Michael House
14 Links Place
Edinburgh
EH6 7EZ
Tel: +44 (0)131 555 3311

GLASGOW

24 St Vincent Place
Glasgow
G1 2EU
Tel: +44 (0)141 428 4499

LEEDS

36 Park Row
Leeds
LS1 5JL
Tel: +44 (0)113 831 5533

LONDON

Third Floor
46 Chancery Lane
London
WC2A 1JE
Tel: +44 (0)207 242 3243

NEWCASTLE UPON TYNE

City Quadrant
11 Waterloo Square
Newcastle upon Tyne
NE1 4DP
Tel: +44 (0)191 232 0943

TRURO

Baldhu House
Wheal Jane Earth Science Park
Baldhu
Truro
TR3 6EH
Tel: +44 (0)187 256 0738

International office:

ALMATY

29/6 Satpaev Avenue
Hyatt Regency Hotel
Office Tower
Almaty
Kazakhstan
050040
Tel: +7(727) 334 1310