

GLA/SITE/3/13

KW (Kate Woodward) and Miss Rendell

1956 and 1959.

Page 1

1956

Trench CL1. Section 49 & 51 (Directions from RR)

E->W starting from --- side of 15th century cloister wall.

Points of probable features E->W

0'-8' : solid medieval foundation [C:3122].

12' – 16' depth 3' :glass furnace remains

14', depth 2': top of set stones on edge forming kerbing of Cloister (flower) bed

18' – 21' depth 2-3' :foundations of stone walls look carefully for stone 10" X 3" [C:3149]

30' depth 1'8" to 2' :line of spalls [C:3130] which building of 13th century church

47'-49' depth 2'6" :similar foundation (other end of 18'-21' building) [C:3118].

55'-56' :six stones probably kerb of bed again.

Page 1 back

C12th and earlier drop 3' to 4' to s. side of cloister.

Thursday

NB: Extended CL1 to 55'. Existing line unsatisfactory. New NW corner 20'2 ½ " from near edge of cloister marking.

21'11" from inside of path edge.

34'7" from face of church.

Page 2

Thursday

East end 13th century cloister – same layout ? as 5th ? ?.

North trench 12th century cloister, blue lias (clay makeup of cloister seals in 12th century).

South trench on.

Page 3

Monday August 13th

CL1 from 5.

53'6" depth 20" on mortar bed

39'2" depth 2'5" red tile, red rock (glass furnace 3).

East wall.

Page 3 back

Notes from gatehouse section and plan.

? same as 1955 pot.

Page 4

Wednesday Aug 15

Sups 54

Tor burr 56'

61' to 81'

CL 3. Section 52. From North 4'

- lead (possibly [F:SF3204]). Depth 2'8", from North 12'6"

- green pot glaze one side – soft soil (N?) on T. Burr depth 4'5". From North 5' depth 3'1"

- in wet grey clay molten red/black/red pot about ½" thick. N 47'4", depth 2'2", East 2'8").

Page 5

From East 67'

August 15th

Cloister 3. From North 0' to 48'6", 0-5' depth

(at 2'8") 4' 2'6" from east wall. Iron strap under clay of south section below level of mortar strip of east section.

2'6 to 10'. West half loose stones

10' to 12'6" edge of stone from above to Tor burr [C:3212].

4'6" to 4'10" to top. From east 2'4", about 12'6" Tor burr rising in steps

25' at 2' deep started slimming to the end leaving ? at 1'8" to 10"

At end of trench, glass furnace material [F:SF3200] and pot with lip (possibly [F:BF3204]).

Page 5 back

NB disturbance trench or pit shown in east section only extn.

Page 6

Cloister 3

Monday

More digging. North 25' to approx 36' came on paving ? slabs [C:3210].

No trace further South, to go deeper on north & go to paving level.

Tuesday

Lump of lias.

From north 8',

depth 4'3"

mid trench

Page 7

August 16th

44'3 depth 2'6 mid trench

Page 7 back

Summary and additions to page 15 written on close of trench.

Cloister 3 building 1 (? H. De B's Bell tower (?))

The trench showed foundations of north wall of Tor burr building [C:3212] crossing trench at 9' to 16'6" from south edge of north cloister walk (this had been picked up in 1955 trench [C:2037] running E-W from 61' to 81' from edge of east cloister walk). The east return showed going north to south in west side of trench [C:3011] and had not ended at 48'. (An extension of cloister 1. To meet cloister 3 showed the north-south return [C:3137] – Tor burrs in position, foundations approx 7').

The building on these foundations has therefore foundations in position at approximately 4'6" below present surface with N-E corner. 61' from east cloister walk and 9' (or 10') from north cloister walk.

North wall as seen external measurement 20'.

East walls as seen external measurement 39' (continuing)

(Corresponding interior measurements 6' to 8' north side)

(Corresponding interior measurements ditto 25' to 27' east side 6' for return).

The north wall as seen probably belongs to a projection from the main building (these notes continue on back of p. 8).

Page 8

Cloister 3

From south edge of N cloister walk marking to 48' from same. At 67' from corresponding E marking.

0-5' depth 5'5". Signs of molten iron (as furnace?)

5-10'. In NW corner. In east side on floor about 1' from East sandy fill about 7' ending at 10' floor not ? ? to north end. Probably foundation trench of flying buttress robbed [C:3226].

10-15' at 10' about 2'6" from east side 'edgeways' stone with return at 10' to Tor Burrs – not touching wall of trench. At 12'6" Tor Burr foundation (in position 9'6" to 15') going E-W cutting above highest 3'8" 5'(or 4') in width showing on west side at 17' (to 17'6"). 11 to west side of trench. Blue lias wall.

Page 8 back

Summary

Buildings 1,2 and possibly 3

The west side of trench (see section) showed a Tor burr foundation [C:3211] at similar depth meeting and intersected at its north end by B1 (north wall foundation) [C:3212] with no signs of TB further N but visible to 3' from end of trench (45'). From 18' to 35' from north. Above &/or on these TB's there are remains of a lias wall [C:3225] with projecting course and pavement [C:3210] at approx 3'3" from surface and highest standing stone at 2' from surface. Pavement [C:3210] in evidence from about 24' to 35' from N. From about 37' to end of trench (overlapping Tor burrs underneath and with stone resting on skull in clay at 46') the lias stones [C:3211] (all below pavement level) in general larger and squarer than those seen at north end (clay below pavement not removed). East wall at 35' "hump" in layer made me suspect robbery of E-W wall not found however but some stones crossed trench at 40'.

At south end T.B's seen to bottom of trench approx 5'6" from surface – at north end to depth 4'9" where they appear to rest on older mortar and stone / floor going full width of trench to the east wall of B1 (continues to back of page 9).

Page 9

Notes

1'6" and 2' deep still showing at 4'3".

20'-25'

20' depth 2': blue lias (6" - 7" clay and spalls)

depth 3'6": layer of mortar

Shown in section at 21'6".

25'-35' wall continues and paving at depth 3' to 3'6".

3'to 35' step cut down to 4'8" depth at 3'6" paving and lias wall (on Tor burr foundation) 40' another step to above below 6' showing T-B's in side of trench.

East wall at 40' robber trench.

Page 9 back

Summary

B2. The lias building with pavement [C:3210] [C:3225]. May end at approx 37'. The larger stones (upper course of C:3211) could belong to it [C:3225] or B1 or a possible B3. There are signs that B2 continued north of B1 but was robbed to build B1 and clay from E-W foundation trench thrown into its place to fill. No signs of a corresponding wall appeared in C1 which could have been west wall of this building. By inference from the pavement level and the fact that the position of Herlewin's cloister is known, this is probably either the west wall of Thurstins' cloister with paving originally reaching to garth without an east wall of stone or possibly and/or the east wall of a west range of that date.

Mortar and stone floor [C:3215]. This would appear to be older than either B1 or B2 and to correspond to floor of Saxon industrial (kiln) area at east end of C1, '1955' and C2 (go to back of page 10).

Page 10

From memory of B K?, Self

40-48

Below

Step 8" spalls on wall

Step 1'7"

Step 1'11" or 2'

Dist back to BS 2'6"

CL2 found. 6'.

TB – lias 4'11

After 35'

Below 3'6" each layer white clay, mortar, or mortar with stones went right across trench.

Page 10 back

At north end of trench at depth of 4'6" [C:3220] considerable quality of ? slag came out and layers of rust-red appear in clay including floor of trench under clay. This was not investigated owing to time and weather conditions. In floor of trench on west side in the foundation trench of T.B building (1) for about 1' from west side there were lias stones on edge and no T.B visible from 9' to 12'6" in the trench as seen in trench sides, at this depth. (On the floor at the East side from about 3' to 9' or 10' (edge of T.B trench [C:3203]) also extending about 1' from side of trench, rectangular sandy fill probably foundation of late flying buttress [C:3224]. NB (on page 11). Buttresses 20' to 21' apparently going E corresponding foundation trench found in W end of cloister 2 trench (from N 5' to 9') 2 in N extension of 1955 100ft trench where intersects. Cloister 1 (from E 24' to 28' – last year called 28' to 30') - in E end – foundations intact excavated by David King.

Finds

At north end iron slag and lumps

At 35' iron possible hook and staple for door

At end of trench glass furnace material (in disturbance)

Pot - see envelopes – none late except in 1955 disturbance near surface.

Page 11

Pot 11th or 12th century cooking pot at junction of C1 and C3 (approx depth 3'6" to 4' (memory) see envelope).

1959

Back page 11

D5 S-N on west side, length 18'1"

Drain: inner face on S 6'7 ½"

: inner face on N 7'10"

Rough stone from 7'10"-10'

White mortar filling 10'-13'

Wall face.

Wall face 13' (from S) to 16'1".

Mortar floor over clay to 18'1".

East side.

Inner face of drain 6'3.5" to 7'6"

Rough stone to 10'

Wall face 13' to 16'3"?

Page 12

Trench D5. South side of drain.

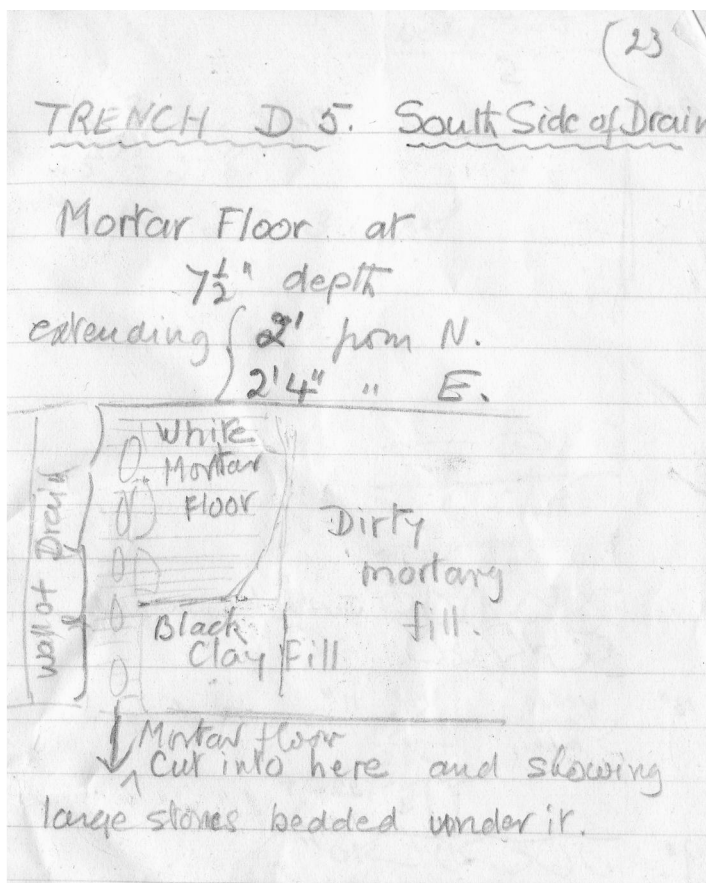

Sketch of trench D5, S side of drain.

Page 12 back

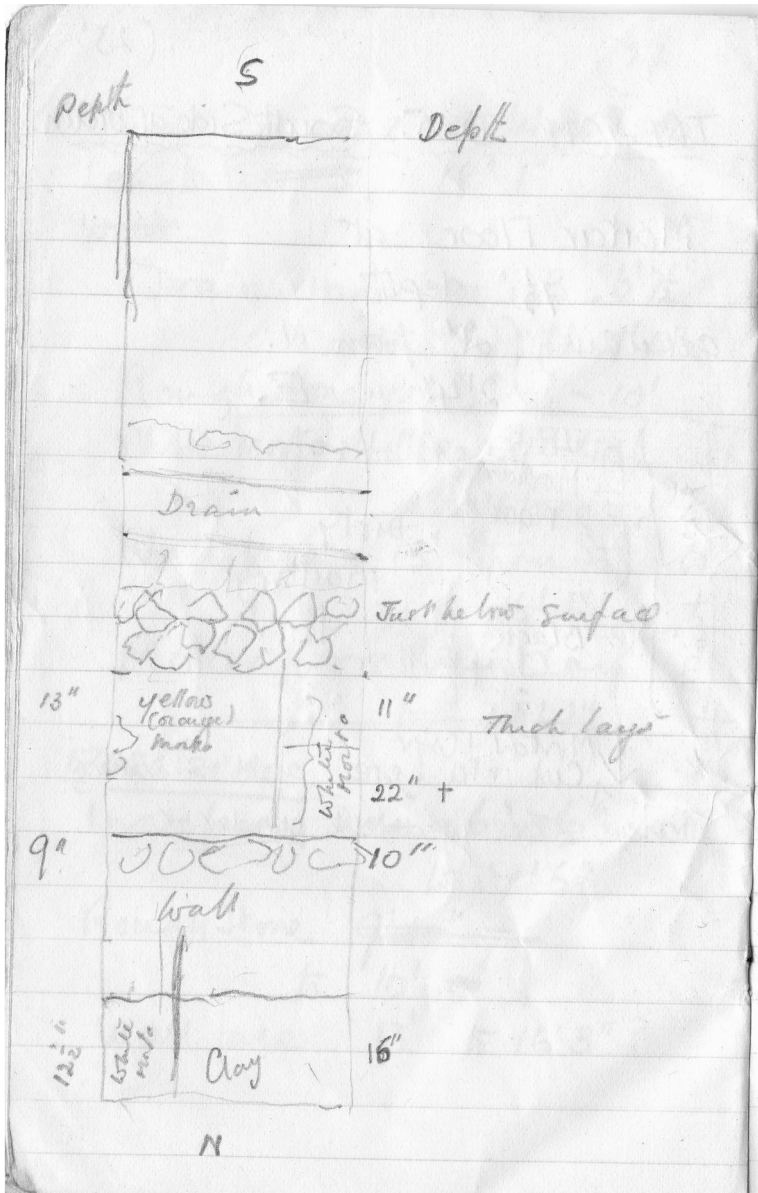

Sketch plan of trench D5.

Page 13

25'-27'6". Depth 2'3"-3'1" pot.

