

GLA/SITE/3/14

D King

Glastonbury Abbey Excavations

1959, 1963 & 1964

Page 1

1959

4th August, 1959

Page 1 Back

Thursday 6th August

Dorter 1. Section 65

West of east wall of Dorter - foundation of inner vault buttress [C:5215] including large blue lias block – Romanesque re-used. See plan

Page 2

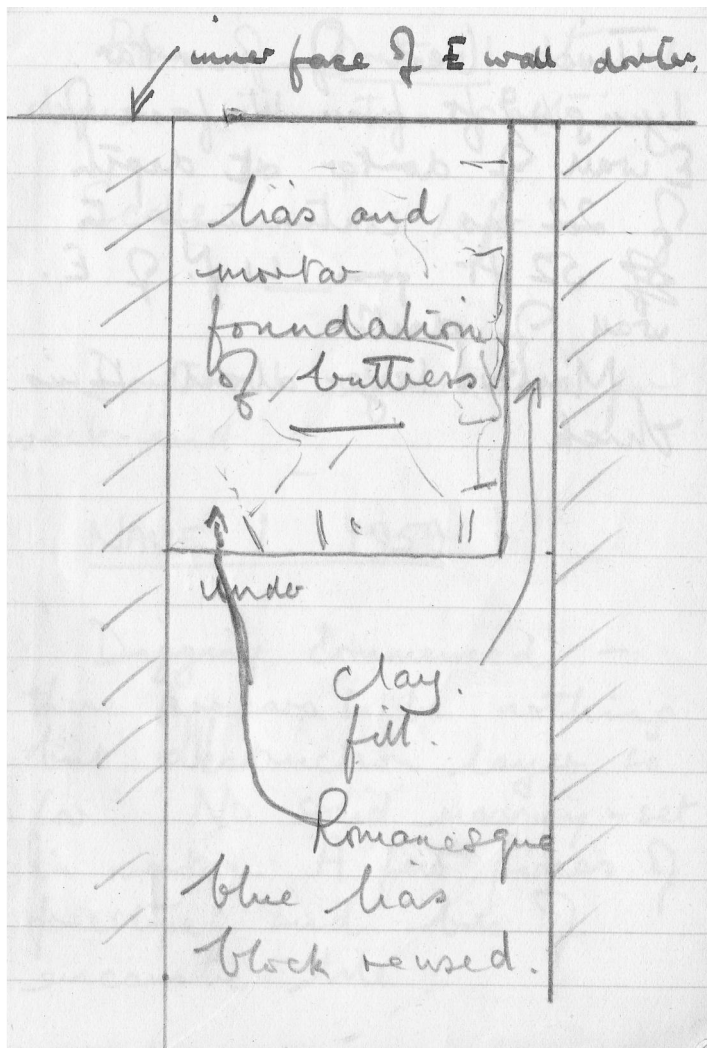

Sketch of inner face of east wall of dorter.

Page 2 back

Dorter 1

Thick bed of mortar [C:5251] lying 49ft from west face of east wall of dorter at depth of 22ins continuing to 52ft from west face of east wall of dorter.

Mortar layer about 4 ins thick.

Page 3

Friday 7th August

Plan of Dorter 1 trench drawn in two parts. Scale 1" = 4ft. Dorter 1 cleared up for weekend.

Nave 1 – 1959. Section 63

Digging commenced – there appears to be nothing but destruction layer so far. No solid masonry – set in mortar. A few pieces of freestone and bits of encaustic tile.

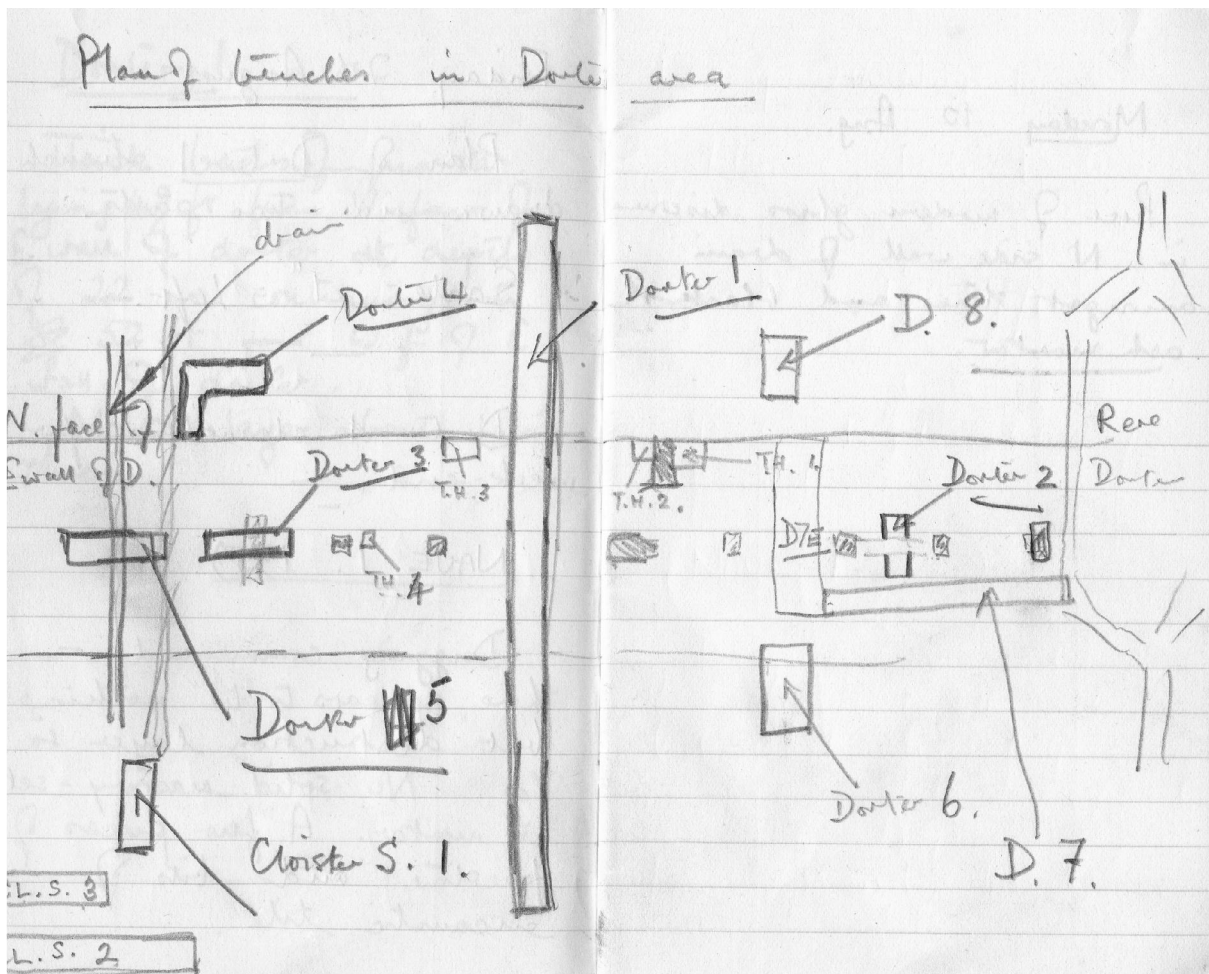

Sketch plan of dorter and CLS trenches.

Page 4 back

Monday 10th August

Piece of modern glass discarded in North side wall of drain amongst stones and blackish ash mortar.

Page 12

Glastonbury Abbey

1963

Abbots hall cross trench

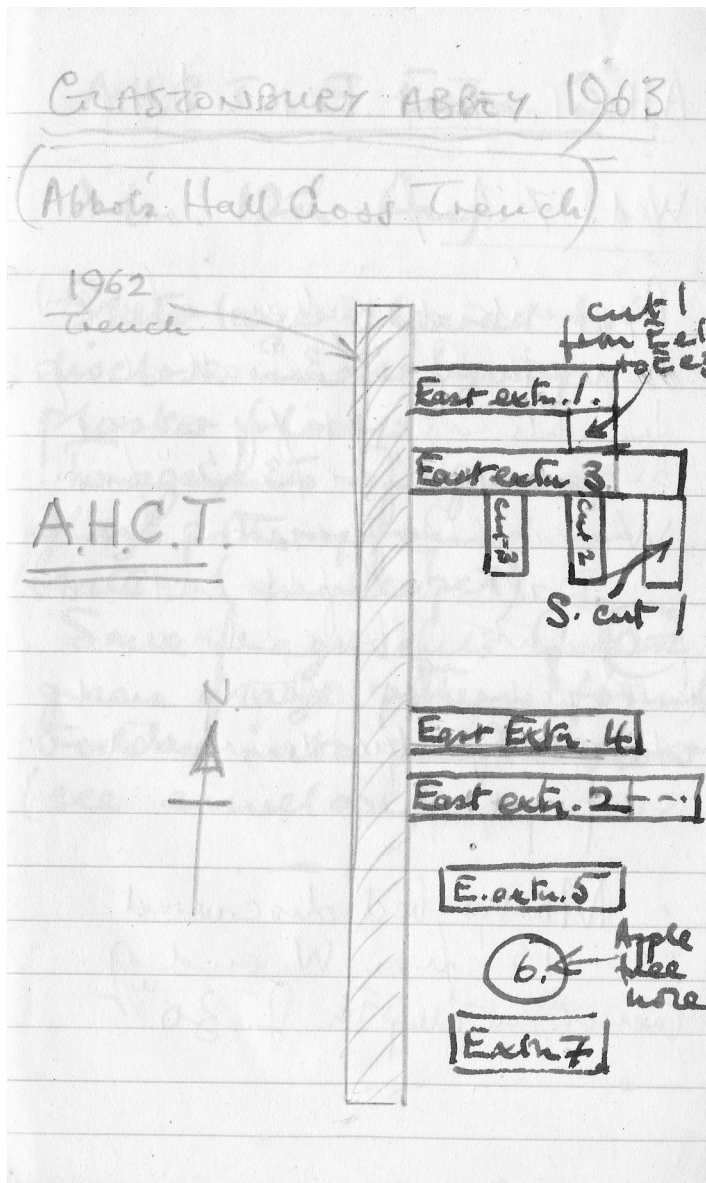

Sketch plan of AHCT trenches.

Page 12 back

AHCT East Extension 1. Section 76

Wednesday 7th August

Apparent disturbance (modern) [C:6052] to depth of 2'3" all along trench except for small area 10'6" - 13'2" from west end of trench.

Disturbed fill contained fragments of bone, stone, late medieval pottery and sherds of blue decorated soup plate.

Mortar bed [C:6056] discovered 12'-15' from west end of trench at depth of 30"

Page 13

AHCT East extension 3. Section 77

Monday 12th August

Slate layer [C:7059] cleared to disclose underlying plaster floor [C:7060]. Fragments of green glaze pottery found in slate (enveloped) [F:BF7110] & [F:BF7112]. Some fragments of 12th century green glaze pottery found trodden into plaster floor (see envelope) [F:BF7077], [F:BF7084] & [F:BF7091].

Page 13 back

Tuesday 13th August & Wednesday

Cross trench cut from AHCT East extension 1 to AHCT East extension 3 in attempt to discover line of Saxon wall.

Apart from a small area about 1ft wide at the south end the mortar floor [C:6056] & [C:7060] had been cut through by a medieval disturbance yielding pottery (see envelopes).

Page 14

AHCT East extension 3 south cut 1

Overlying layer of destruction rubble [C:7054] containing pottery.

At a depth of 9" layer of blue lias spalls [C:7057], some decayed glass found above these.

When cutting through layer of spalls a fresh layer of yellowish mortar rubble lying over the layer of shales from the blue lias at depth of 10 inches.

Page 14 back

Sketch plan of Abbots hall courtyard cobbling in AHCT East extension 3 south cut 1

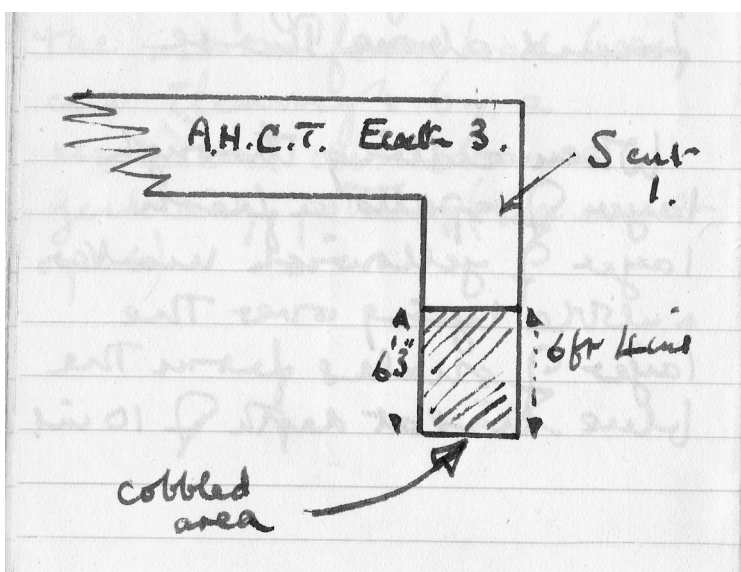

Sketch plan of AHCT Extension 3 and S cut 1.

Page 15

Pins @ 264', 1ft N from SW corner of cage

@ 132'. 6ft3" from NW corner of cage

Page 15 back

1964

Page 16

Glastonbury Abbey 1964

Tuesday 11th Aug.

O-S 13ft 4ins, O-W 2ft 8ins. At depth of c.32ins. Base of pot. Black ware lying on darkish earth and lias make-up (depth taken at line of turf E).

Wednesday 12th August

Fragments of green glaze pot lying beneath shales upon plaster floor.

O-S, 10ft 2ins

O-W, 24ft 9ins

Page 16 back

NW corner of pit. O-N 28ft 9ins against North face, at depth of 4ft 5ins.

Six pieces of assorted med pottery ? 12th century – 15th century/ 17th century in modern fill.

Page 17

The courtyard of Abbots House cut through. This was thick layer of mortar containing chipped lias and broken pieces of free-stone. This appeared in east section of pit O-S 13ft 9ins.

Page 18 back

Trenching S of wall

O-S

O-W

Remains of mortar and rubble pack of courtyard cut through. This yielded green glaze pottery. Beneath this a thin scatter of ?. Below this a further layer of smashed Dundry (?) stone containing a 12th century column in Dundry.

Cutting south along east face of trench. Portions of green glaze pottery – strap handle 13th century etc. in clay make-up below Abbots Yard.

O-S 10ft

O-W 1 ft

Page 19

O-S 32ft

O-W 16 ft

Late M. glazed pottery intrusion through courtyard floor.

Workmen cutting through destruction debris unearthed portion of blue lias column, O-S 12ft, O-W 17ft.