

**GLA/SITE/3/28**

**RALSTON**

**Glastonbury 1957 & 1959**

*Page 1*

1957

CLE walk. Sections 60, 83 & 84. Measurements from W end of trench.

1ft 2in piece of slag in in-fill of foundation trench at extreme W end.

Aug 15th

Cleared N side of trench down to a depth of 1ft started getting kiln frags and glass so abandoned for weekend.

Laid bare foundations at West end of trench but have not yet sunk down face. Dirty clay much more mortary near foundations.

*Page 1 back*

Aug 16th

CL11

9ft from E depth 7ins. Dished shaped mortary disturbance slopes gradually towards E.

*Page 2*

Aug 19th

CLE Walk

Tidied up trench to 1 ft. Sunk to 18ins at each end on north face. The clay is full of small kiln fragments but nothing seems in position. There were three larger fragments with glass adhering and two pieces of pot in the upper part. The 18ins depth is producing a layer of flat stones (not laid exactly flat.).

We do not yet know whether the kiln debris stops with this layer. We have not found the full extent of the layer. Another piece of slag is turning up at the same level.

*Page 2 back*

Aug 21st

Started Southern extension. Extreme Eastern End revealed upper mortar bedding for 15th century floor. We then cut down then cut through next mortar bedding for (first mortar layer of envelopes).

Depth 6-1 ins contained dirty black clay with bones and 12th century pot and much stone though loose. 11-13ins - not pot. Clay became grey and kiln frags started to appear.

Page 3

Aug 22nd

CLE Walk Sth Ext. Section 17

Sunk a trench in front of foundation at W end to depth of 1ft 5ins. V stiff grey clay containing kiln frags and small stones.

Foundation revealed at E end. Foundation of lias 1/7ft from W. Grey clay becomes yellow and reveals kiln frags.

CLE Walk

Sunk to 21ins very stiff dirty clay – kiln frags traces of iron and kiln (in situ?) showing at approx 9 ft from W.

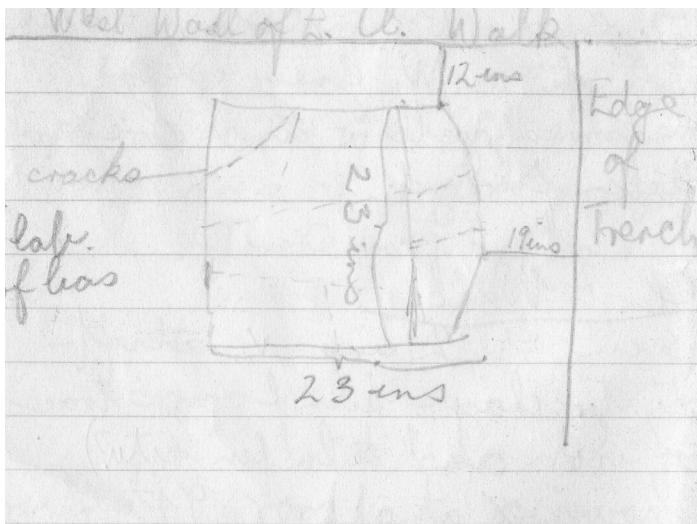

Page 3 back

Kiln showing also at foot from W end definitely in situ.

CLE Walk

Paving Stone

Depth 3ins from Turf

12 – 35ins from W

19-42 ins from N side of trench

PID18796. Sketch plan of west wall within CLE walk trench.

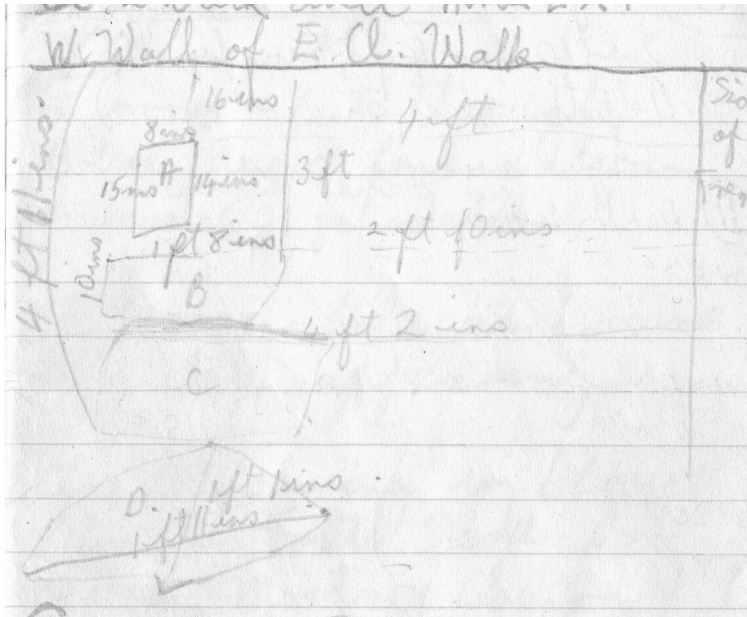

Sketch plan of west wall within CLE walk trench.

CLE walk and N Extn.

- A. 16ins from W – 2ft 8ins. 4ft-48ins from N side of trench. Depth 7ins at W. 3ins at E. Freestone.
- B. Tor burr. 3ft-3ft 10ins from N. 2ft10ins -4ft 6ins from N. Depth: N- 4ins. S – 6ins.

Page 4 back.

- C. Tor burr. 3ft11 ins – 4ft 10ins from W, 2ft 10 ins – 4ft 5 ins from N. Depth 6 ins
- D. Depth 4 ins. Blue Lias.

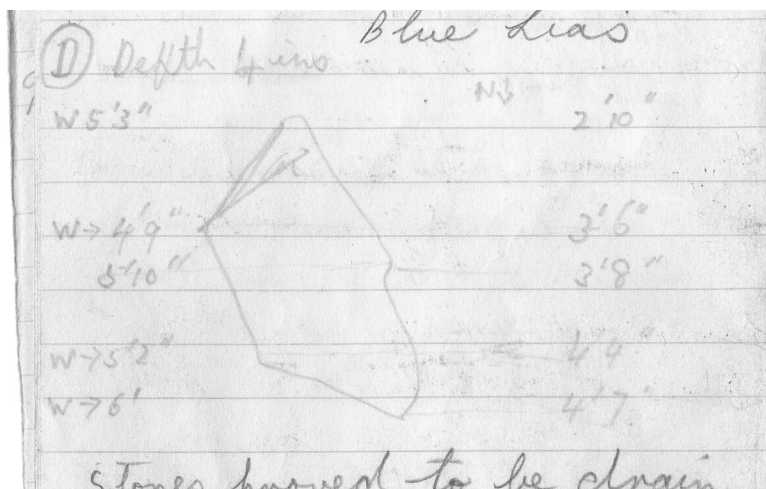

Sketch of blue lias.

Stones proved to be drain cover. Some blue lias and some Tor burr.

*Page 5*

CLE Walk and EXT. Section 17, 60, 83 & 84

NE Corner – cut through Blue Lias foundation towards 13th century foundation.

SE Corner – kiln structure definitely appearing.

Line appearing in clay blue on South side and yellow mortar clay on N at W end of trench 4ft from N side and slopes at 8ft from W to 6ft 6 ins from N.

*Page 5 back*

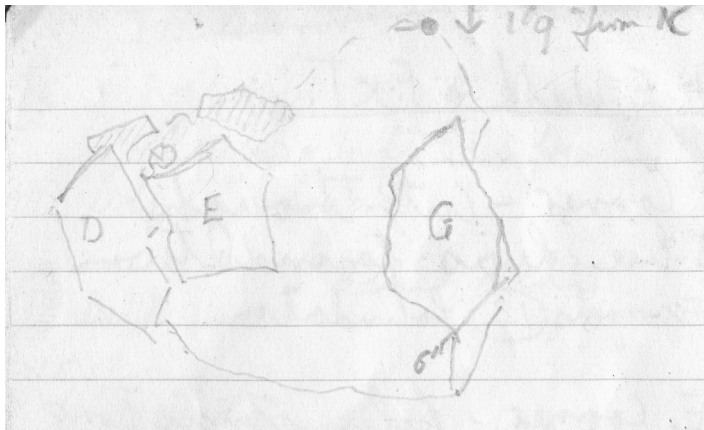

Sketch plan of stones.

*Page 6*

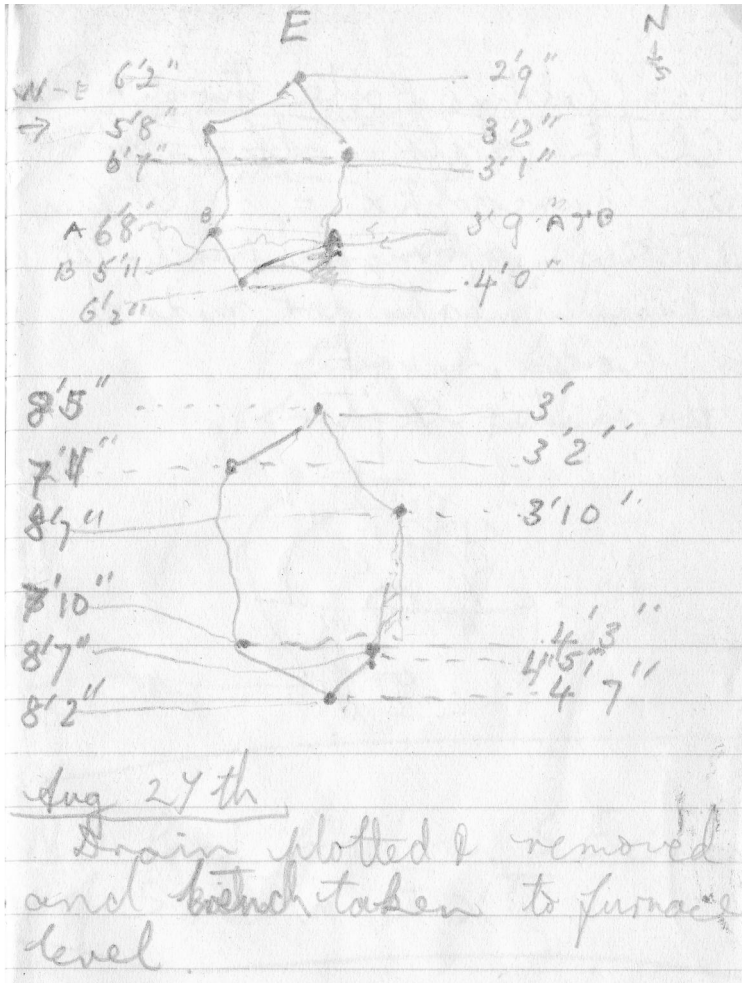

Sketch plan of stones.

Aug 27th. Drain plotted and removed and trench taken to furnace level.

Page 6 back

Scaffolding hole through kiln, CLE walk south ext SE corner of Ext – 8ft 2 ins NE corner of original trench – 9 ft. Measurements for middle of hole.

Diameter 2 ft.

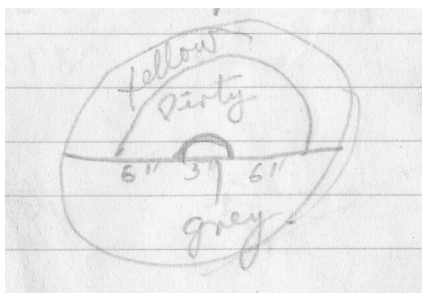

Sketch plan of scaffold-hole through glass furnace.

Page 7

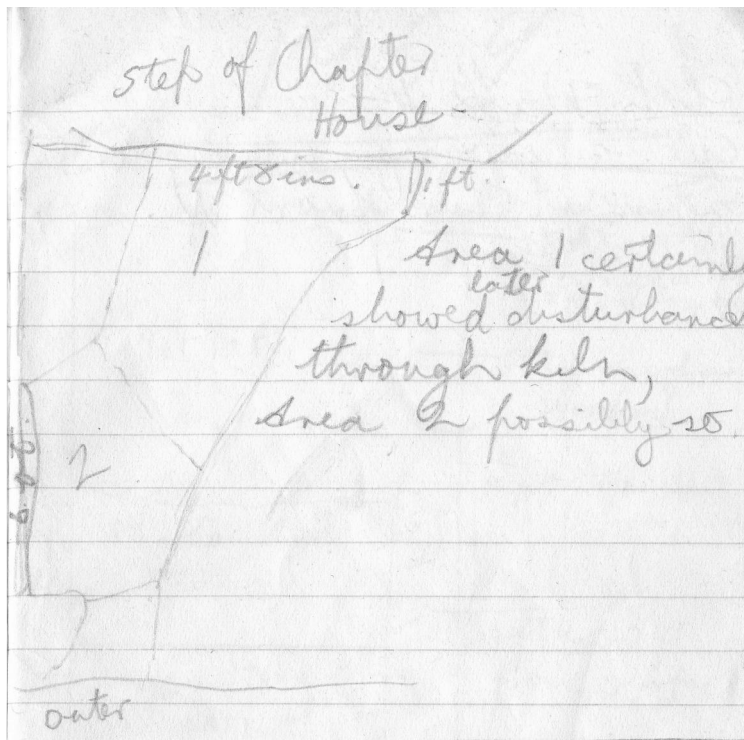

Sketch plan showing area of disturbance near chapter house step.

Note: Area 1 certainly showed later disturbance through kiln, Area 2 possibly to.

N.B Post-hole in SE corner of south ext

*Page 7 back*

CLE walk II. Sections 59 & 85

Cut showing in section at 2ft 5 ins from W at 1ft 7 ½ ins.

*Page 8*

1959

D1. Section 65

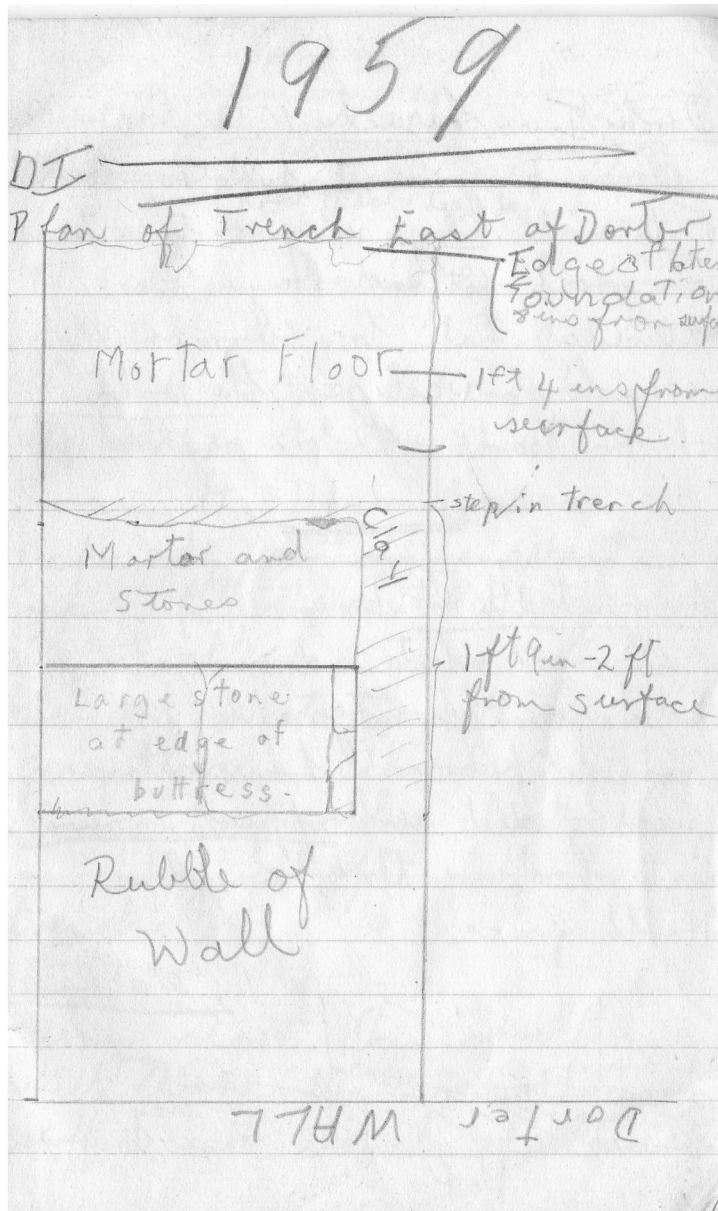

Sketch plan of trench E of dorter.

Page 8 back

Dorter I August 10th

Cleaning 14th century inner buttress to 13th century wall at west side of Dorter. Clay very dirty – contained charcoal, pot and many bones.

Decided that Tor Burrs on West side were last vestige of the wall which had not been robbed.

August 11th DI Drain A

Cleaned late drain at high level for photograph. Silt appears to have 3 layers which did not appear in disturbed earth and tiles in North Face

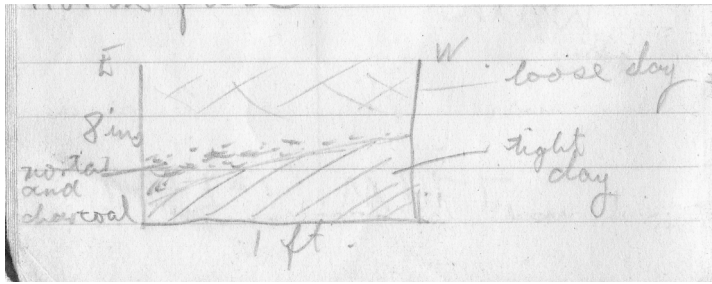

Sketch section in D1.

Page 9

Drain A – when cover stone and remains of filling had been removed was found to curve westwards on South Face of trench, the floor falling at the same time. This will involve re planning.

Afternoon – on taking down the stones to the west of Drain A , Drain B was exposed. Part of the West face of the South side of the trench had gone but there were at least two stones in position on the south section. Cover stones – blue lias – shown on original plan of this trench.

E side. Long stone then small ones which may have been rebuilt and stuffed into trench of drain A.

Page 9 back

West side of Drain B

Face made up of small stones flat on inner face but many pointed on outer face. This may have been to act as a retaining wall.

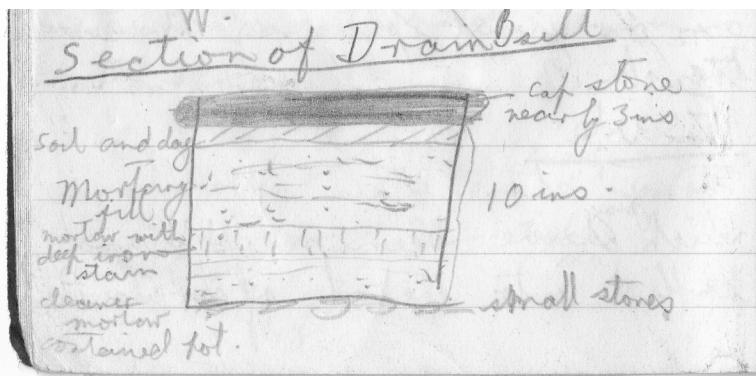

Sketch section of drain B.

Page 10

August 13th

Started demolition of walls of Drain A. It then became clear that the wall running lengthwise in the trench had cut drain B but been cut by Drain A.

The west side of Drain B was then taken down and proved to be much more solidly built than appeared from the top.



When the wall, floor and clay had been removed it became certain that the mortar floor exposed between this feature and the 13th century buttress, underlay drain B.

The Drain Trench on the far side of drain B contained a mortar sandy fill and produced...

*Page 10 back*

...one piece of pot.

Beyond this there was a stiff packing clay lying under Drain A and over the mortar floor. It is cracked but produced cooking pot and bones.

On removing the floor of Drain A a surface burnt patch which started in the E. Drain Trench and continued under the East Wall of Drain was found to continue under the floor also. This proved to be the drain trench of Drain A which was seen by the Director to be post-suppression.

*Page 11*

D1 Aug 19th

Mortar Floor

Thick layer stretching across excavated part of the trench extend from 12ft to 21ft East of E face of concrete bar marking W face E dorter wall.

Under the mortar floor and continuing along the trench there was a layer of iron pan of irregular thickness which overlay a very squidgy clay.

6ft-10ft 6in W of West face of dorter Wall, hollows in ?natural at bottom of trench, produced kiln waste material but no pot or glass. Depth 4ft.

*Page 11 back*

CLS III. Section 61

20-30ft from N face of S Cloister wall rubble layer [C:5512] at a depth of 2ft 2ins – 2ft 4ins from top.

19ft from N face. Depth 2ft 6ins. Large hunk of pink stone taken to gate house.

Intrusion at 26ft from S cloister wall. Filled [C:5518] with lias, bones, kiln fragments and piece of pot.

*Page 12*

Stratigraphy in CLS III

- 1) turf and topsoil [C:5500]
- 2) Soil and stones [C:5512], 13th century make-up
- 3) Dirty clay [C:5517] 12th century make-up. Descended into 2 post-holes [C:5516] & [C:5514]

- 4) Clay with kiln frags [C:5518]
- 5) Cleaner clay at bottom of trench [C:5519] still producing worn pot [F:BF5500]
- 6) Two mortar levels [C:5509] & [C:5511] cut-in associated with high level stones at north end of trench and ?stair foundation ?[C:5510] outside buttresses [C:5507] & [C:5508].
- 7) Rubble layer measured on appropriate page associated with dirty clay layer [C:5517]
- 8) S. End, two buttresses 13th century [C:5508] and 14th century [C:5507] on plan and section. Carrol wall written off.

*Back page*

CLS 3.

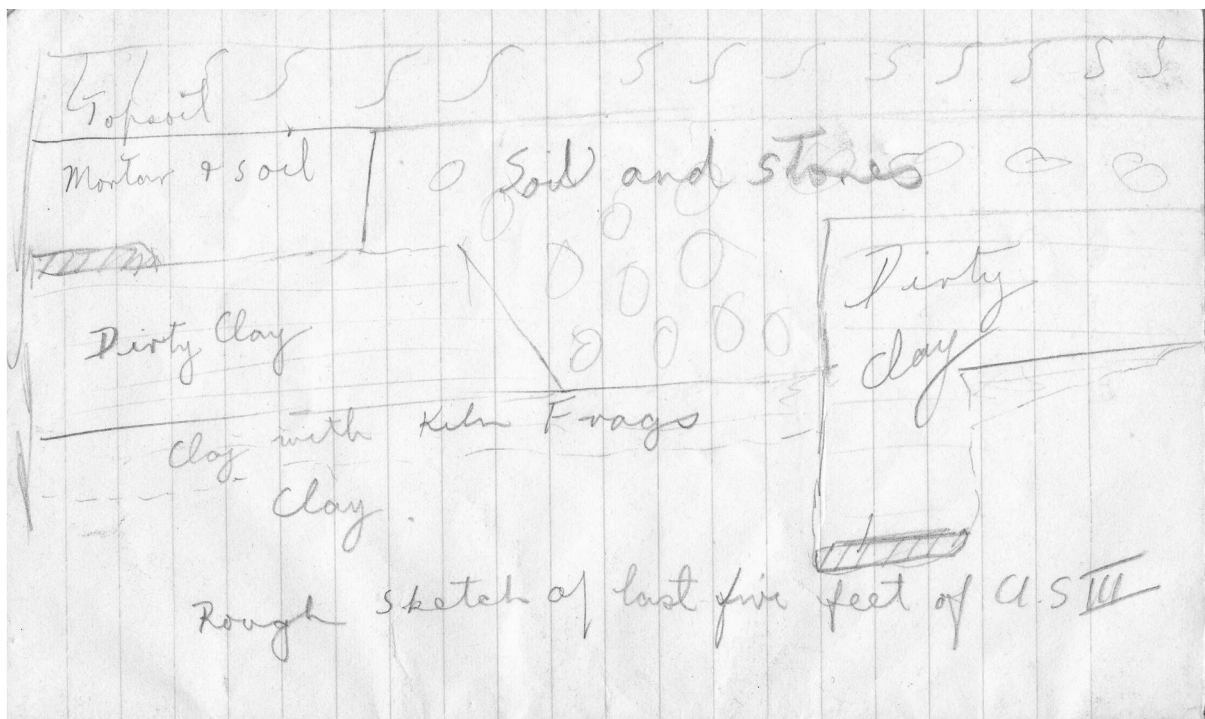

Sketch section of CLS3.