

GLA/SITE/3/30

R. Wainwright, H.A. Wainwright, J.G.S. Temple, D.C.K. Sharpe

Cloister 11

CH2

Page 1

Glastonbury 1957

Cloister 11

N.B. Small finds are recorded from W edge of W wall of cloister walk. Depth from surface of turf.

14th August

Turf and topsoil removed to a depth of 6" below surface of turf. Mortar floor [C:4001] extends to approx 12' from W wall of cloister. Small cutting across trench at this distance exposed masonry? Wall foundation * at depth of 9". Several pieces of unglazed cooking pot at this depth and one piece of modern china.

15th Aug

*Expansion of trial trench at 12' from W edge of W wall of E cloister walk reveals a hard surface extending to W at depth of 9" – supposed to be wall foundation yesterday.

Page 2

Trench CH2. Section 79

Measurements from S transept wall

22nd August.

Topsoil removed exposing in E section burnt material [C:2005] at N end of trench. A further streak of burnt material in the centre of the trench varying in depth from 6" to 1' from turf produced fragments of pipe stem and a piece of modern pottery. Eight feet from S transept wall at depth of 8" the dark layer is cut by yellow mortar fill [C:214]. This may possibly be the foundation trench of N wall of chapter house. At 15' a streak of light coloured mortar appears in E section and...

Page 2 back

...crosses the floor of the trench [C:219]. At 18' 5" at depth of 1' the lower burnt layer [C:230] appears again. The area between the light mortar streak and the 18' mark may possibly be a foundation trench (i.e. southern part of [C:220]) of C12 date. The lower burnt layer [C:230] is probably the Chapter house floor noted in the N section of CH1 ?[C:120] for it extends southwards towards it and consists of burnt material and clay. The "floor" extends westwards into the centre of the trench floor to a maximum extent of 2'. Here it is cut by a N-S foundation trench [C:232] which extends into the W side of the trench. The N-S length of this foundation...

...trench is not yet clear.

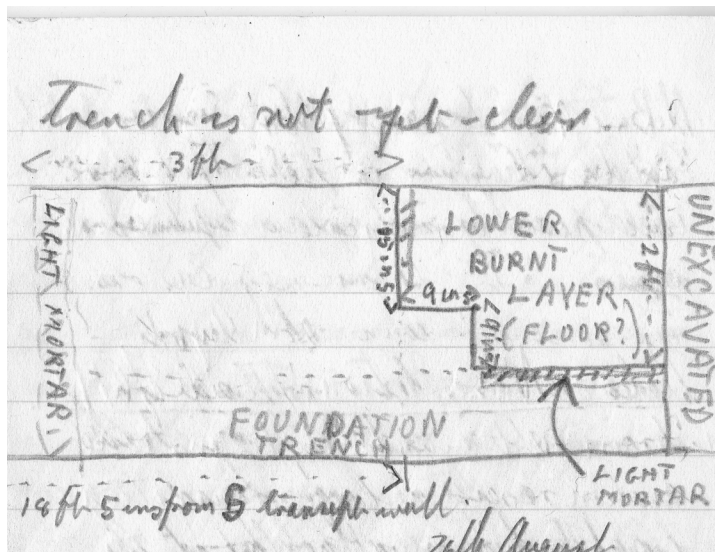

Sketch plan of foundation trench in CH2.

26th August.

Excavation to a greater depth now reveals that the area between 8' S from S transept wall and 18' 5" from S transept wall (i.e. between the two strips of burnt clay floor [C:227] & [C:230]) shows markings which may be tip lines [C:216] & [C:219] for the trench of N wall of C13 chapter. In this case a probable position for wall as indicated by E section of trench would be 12' S to 18' 5" S.

Page 3 back

N.B. 9" square yellow mortar patch noted in diagram on preceding page could possibly indicate a column base.

28th August

Notes on N-S Section of E side of CH2

- 1) From 9' 3" to 18' 2" the section reveals a large foundation trench [C:220] which must be that of the C13 chapter house N wall.
- 2) A small step on the N side of this foundation trench probably represents the N side of the C12 wall which was probably robbed and cut through [C:222] in the 13th century.
- 3) The clay into which these trenches are cut is of two types: a) yellow clay [C:228] (i.e. deep clay) which probably came from the adjacent Celtic bank and b) a deeper blue clay [C:231].

Page 4

Both are flecked with specks of tile and charcoal. The yellow clay produced one pot rim (probably Roman) which is noted in the section.

4) The layer marked on the section as UPPER BURNT LAYER [C:208] is of recent origin, for it produced clay pipe stems and a piece of modern pottery.

5) It is difficult to maintain the original theory that the lower burnt layers [C:227], [C:225] & [C:223] at approx 6' to 8' E represent 1184 fire. If this were the case it would imply a 12th century foundation trench which would be much too shallow.

Page 4 back

28th August

Cloister E walk 3

Finds recorded from E edge of W wall.

Excavation to a depth of approximately 9" has exposed a mass of stonework firmly embedded in yellow mortar. The purpose is not clear. Trial pit on N side of trench has exposed a shallow robber trench at 6' 4" E. The eastern extent of this trench is not yet clear.

Finds

Glass CL East Walk 3.

5'11" from W. 1'3" deep.

Plaster CL East walk 3.

6' 7" from W. 9" down

Page 5

29th August

(CL East Walk 3 cont'd.)

1) Trial trench extended to E wall of cloister walk. 2' W of this point it takes a shallow dip which is filled with a yellow mortar fill. Could this be the C13 wall trench across this point? A peculiar feature is the fact that the section below the E cloister wall shows an inch or so of yellow mortar fill on its N side.

2) At 3' 3" from E side of W wall of cloister walk there now appears to be a break in the blue clay above the masonry, possibly indicating the N-S line of a wall joining the E-W wall already exposed (rough section overleaf).

Finds: Pot frag, 9'2" from W. 1' 7 1/2" deep.

Page 5 back

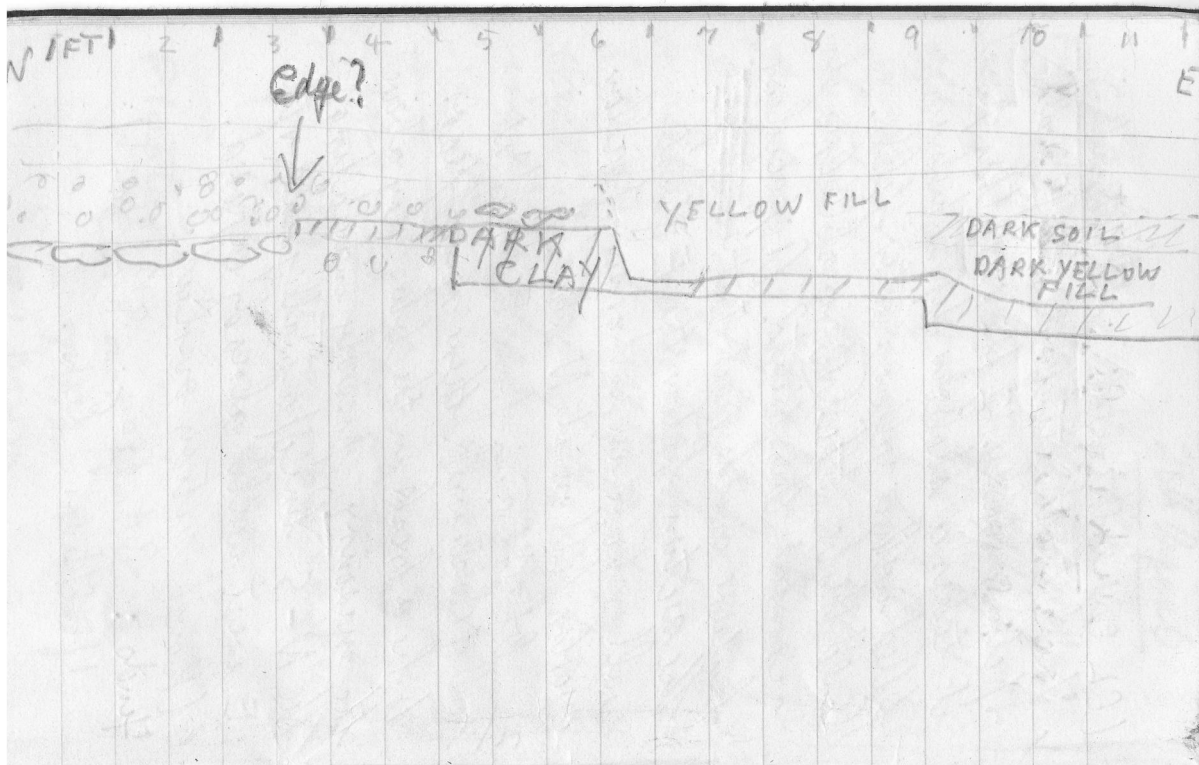

Sketch section of CLE2.

Page 6

29th August

Cloister E Walk 2. Section 59 & 85

Finds from E edge of W wall

Excavation carried out to depth of 1' 8"

Notes on S side of trench:

From E edge to a point 1' 2" E there is a fill of dark clay below the turf (excavator's trench??). From 1' 2" E to 5' 6" E is a disturbed area filled with mortar, stones, clay and burnt material, presumably a robber's trench. From 5' 6" to 10' the remains of a wall? running E – W appears in section. A mass of clay extending N 16" into the trench may be connected with the foundation trench for it is yellow and, presumably, deep clay. Finds include:

1) frag of stone pierced...

Page 6 back

...by metal pin.

2) pot frag.

3) pot frags.

4) flat pieces of iron.

5) rim frag of pot.