

Site/GLA/2/3

Raleigh Radford

Glastonbury 1955

Trenches to be stripped

Whole hollow area in west cloister walk.

Page 1

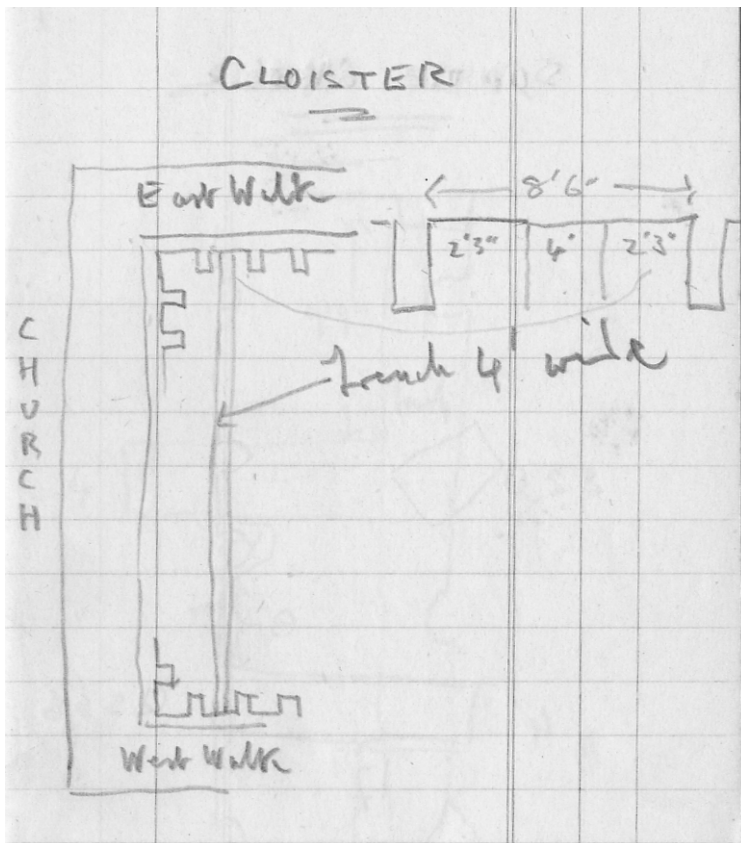

Cloister

1955. Cloister trench.

Back page 1

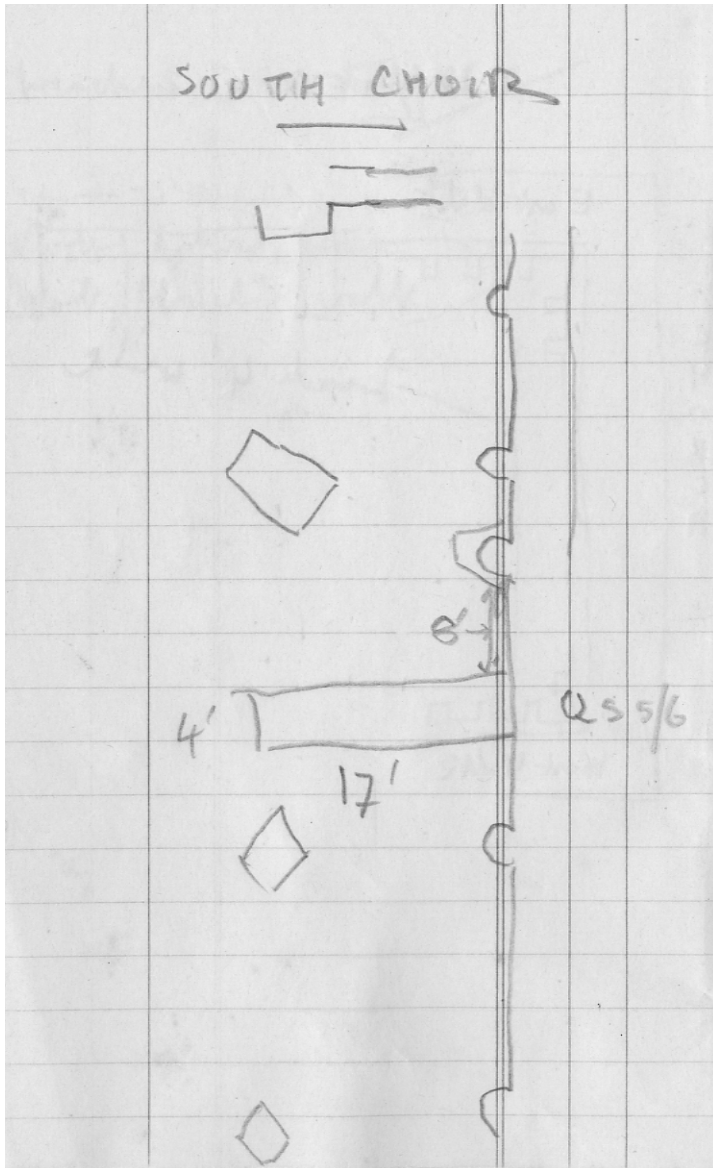

South choir

1955. Sketch of trench QS 6.

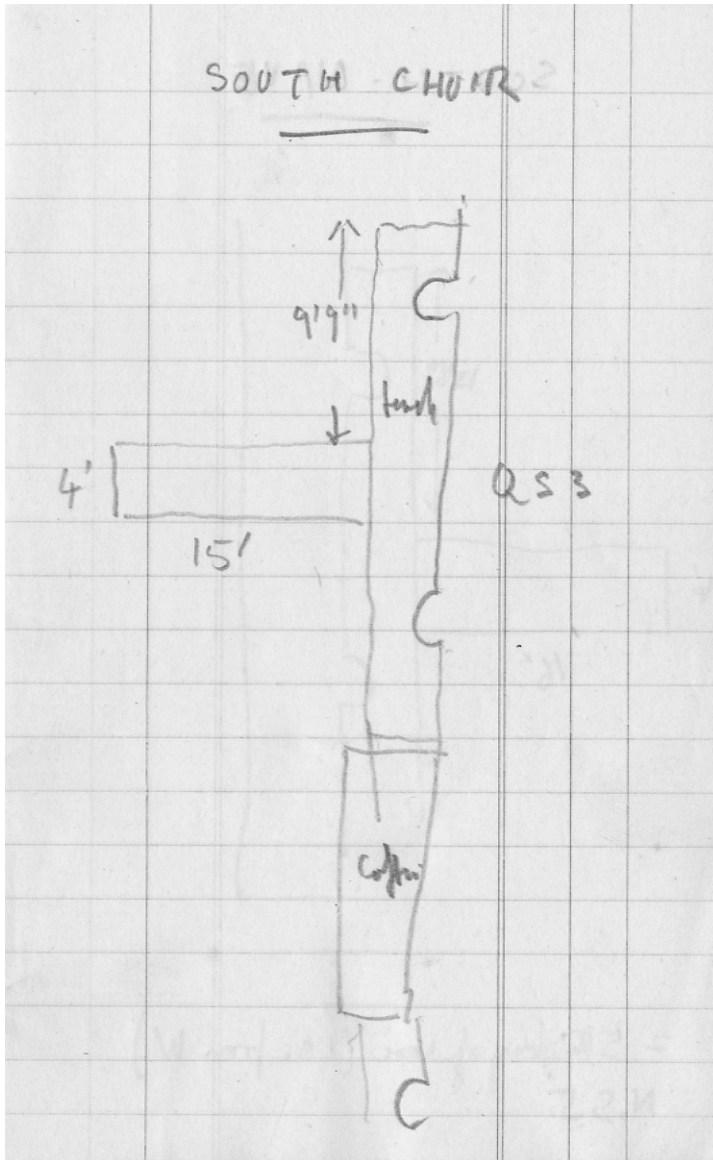

South choir

1955. Trench QS 3

Back page 2

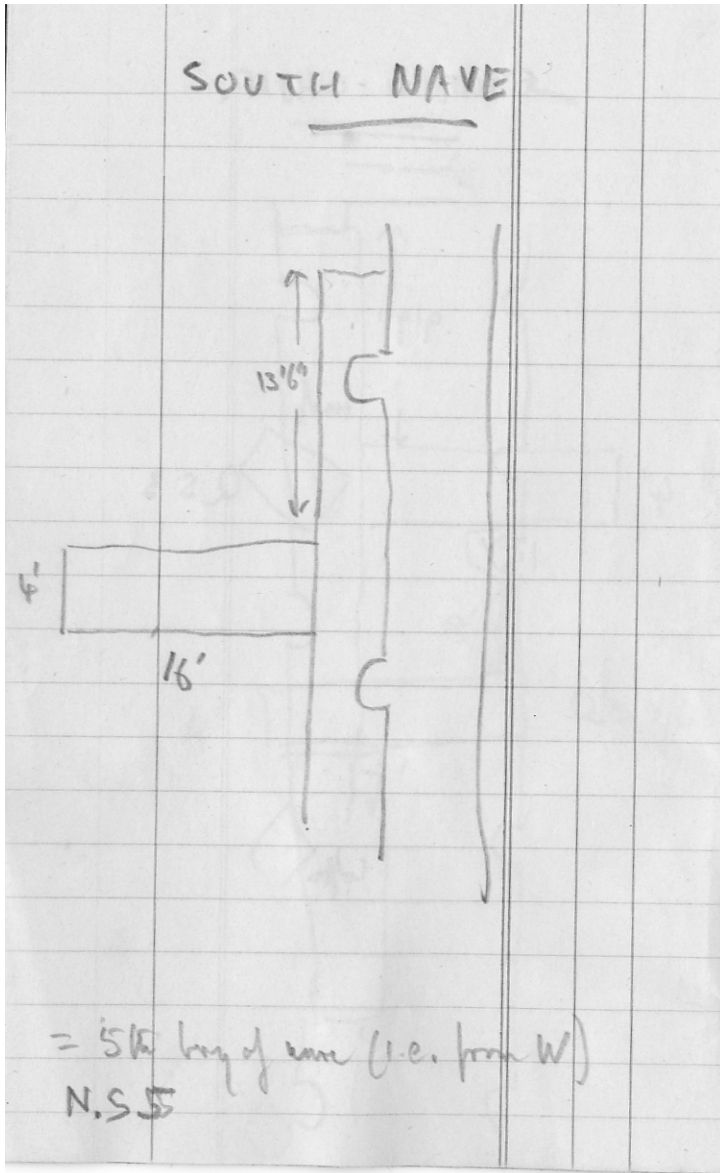

South nave. N.S 5

1955. Sketch of trench in bay 5 of south nave.