

Archaeological Services  
University of Durham

Brompton, Northallerton, Romanby  
Flood Alleviation Scheme

Geophysical survey

Figure 29

Geophysical interpretation of Sun Beck  
Area 3

on behalf of

**Mouchel Parkman UK Ltd**

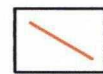

outline of survey area



positive magnetic anomalies



negative magnetic anomalies



dipolar magnetic anomalies

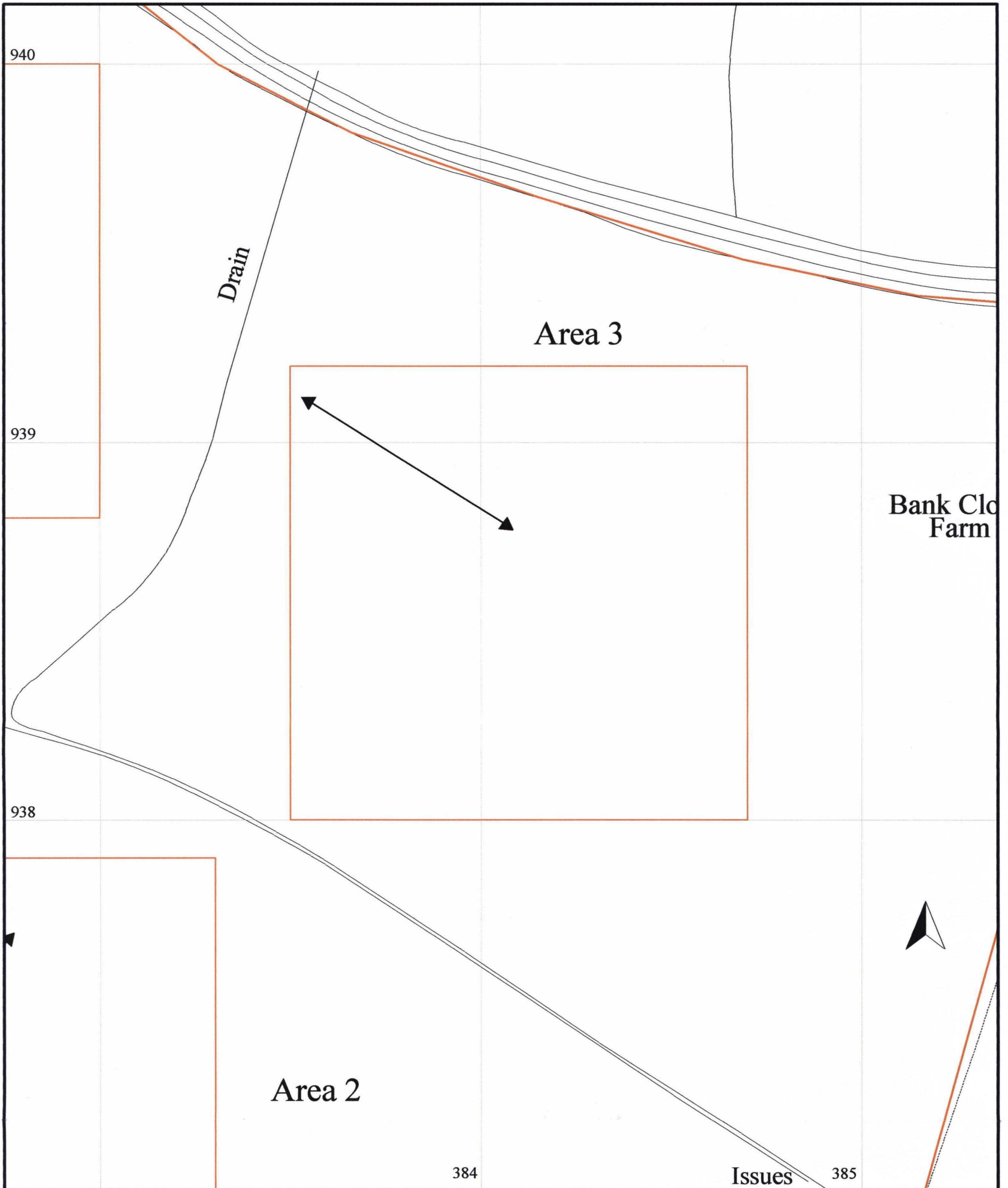

Archaeological Services  
University of Durham

Brompton, Northallerton, Romanby  
Flood Alleviation Scheme

Geophysical survey

Figure 30

Archaeological interpretation of Sun Beck  
Area 3

on behalf of

**Mouchel Parkman UK Ltd**

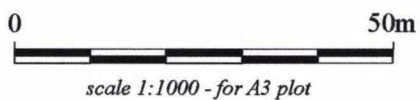

outline of survey area

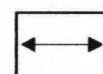

orientation of ridge  
and furrow



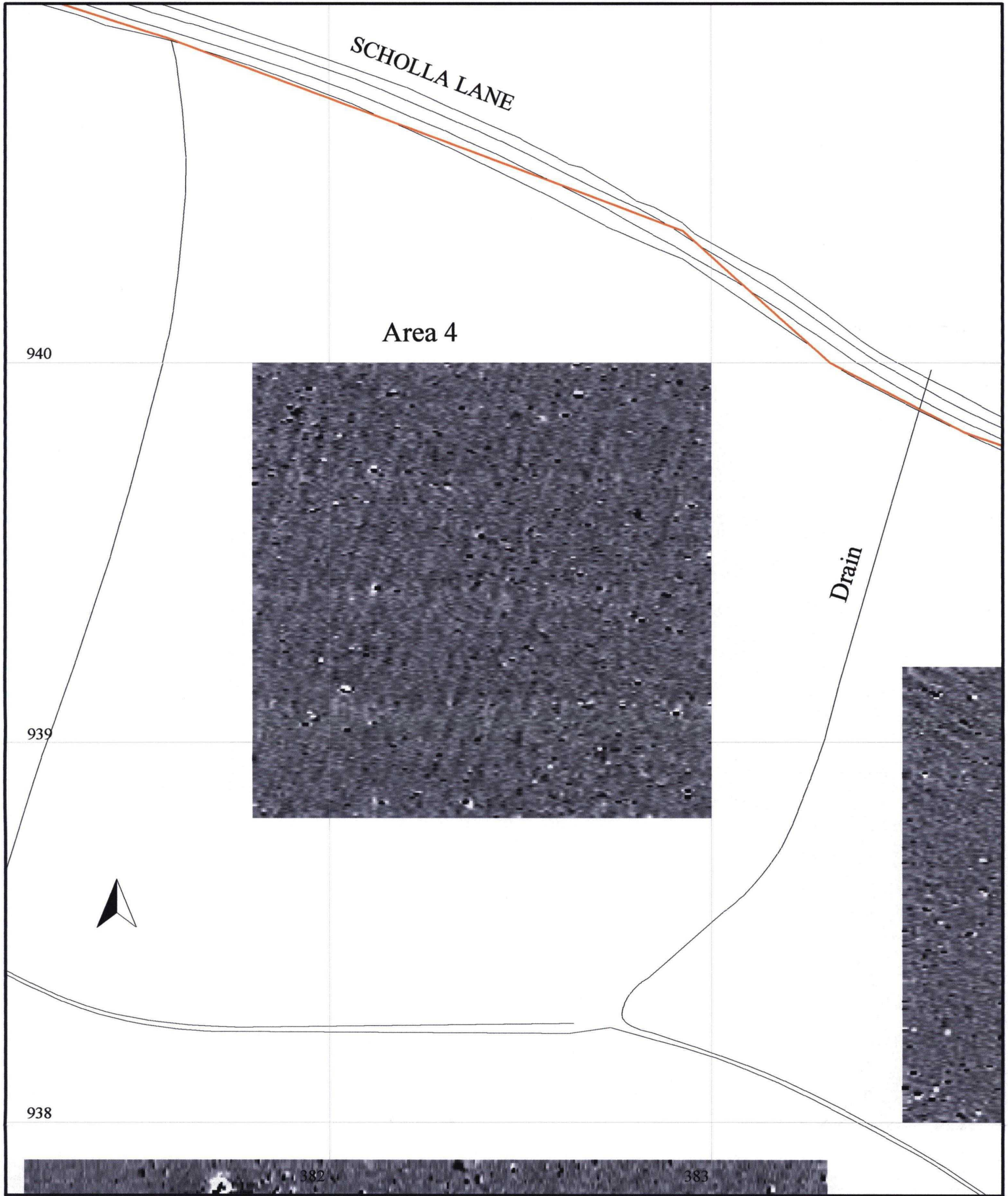

Archaeological Services  
University of Durham

Brompton, Northallerton, Romanby  
Flood Alleviation Scheme

Geophysical survey

Figure 31

Greyscale of Sun Beck Area 4

on behalf of

**Mouchel Parkman UK Ltd**



scale 1:1000 - for A3 plot

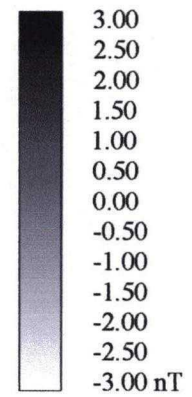



SCHOLLA LANE

Area 4

940

939

938

Drain

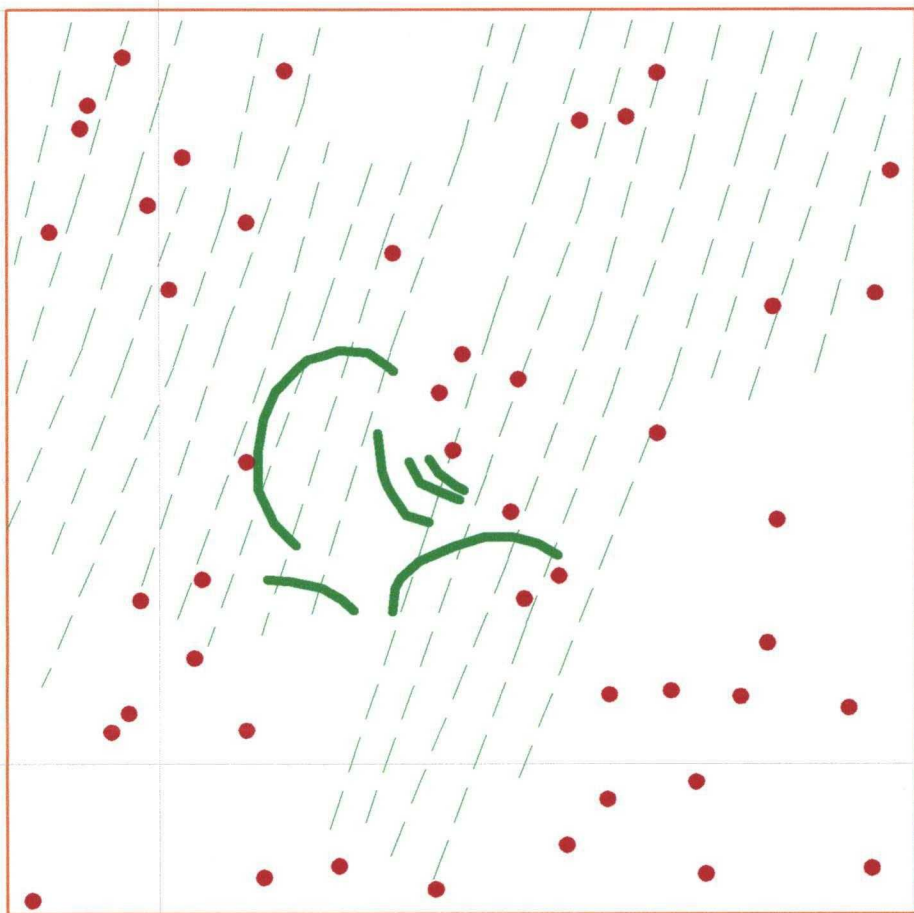

Archaeological Services  
University of Durham

Brompton, Northallerton, Romanby  
Flood Alleviation Scheme

Geophysical survey

Figure 32

Geophysical interpretation of Sun Beck  
Area 4

on behalf of

**Mouchel Parkman UK Ltd**

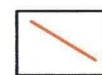
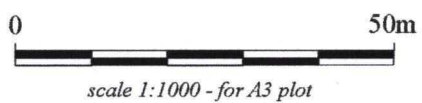

outline of survey area



positive magnetic anomalies



negative magnetic anomalies



dipolar magnetic anomalies

SCHOLLA LANE

Area 4

940

939

938

382

383

Drain

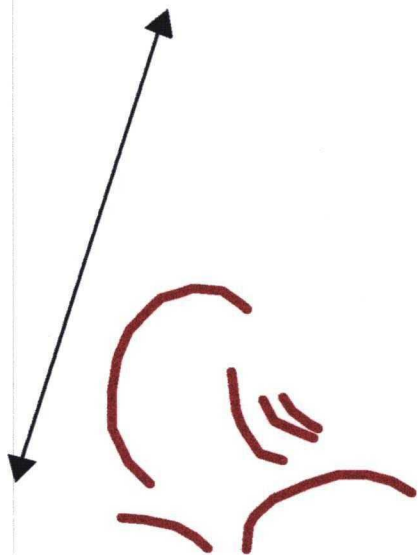

Archaeological Services  
University of Durham

Brompton, Northallerton, Romanby  
Flood Alleviation Scheme

Geophysical survey

Figure 33

Archaeological interpretation of Sun Beck  
Area 4

on behalf of

Mouchel Parkman UK Ltd

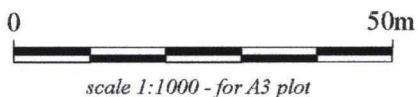

scale 1:1000 - for A3 plot

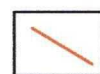

outline of survey area



soil-filled features

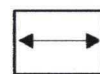

orientation of ridge  
and furrow

948

Area 3

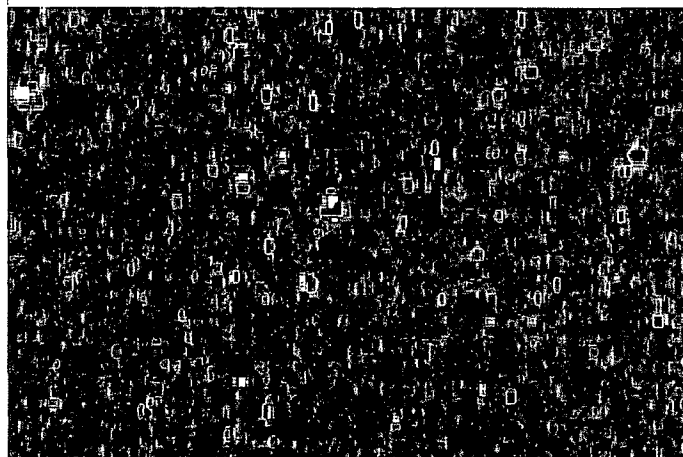

947

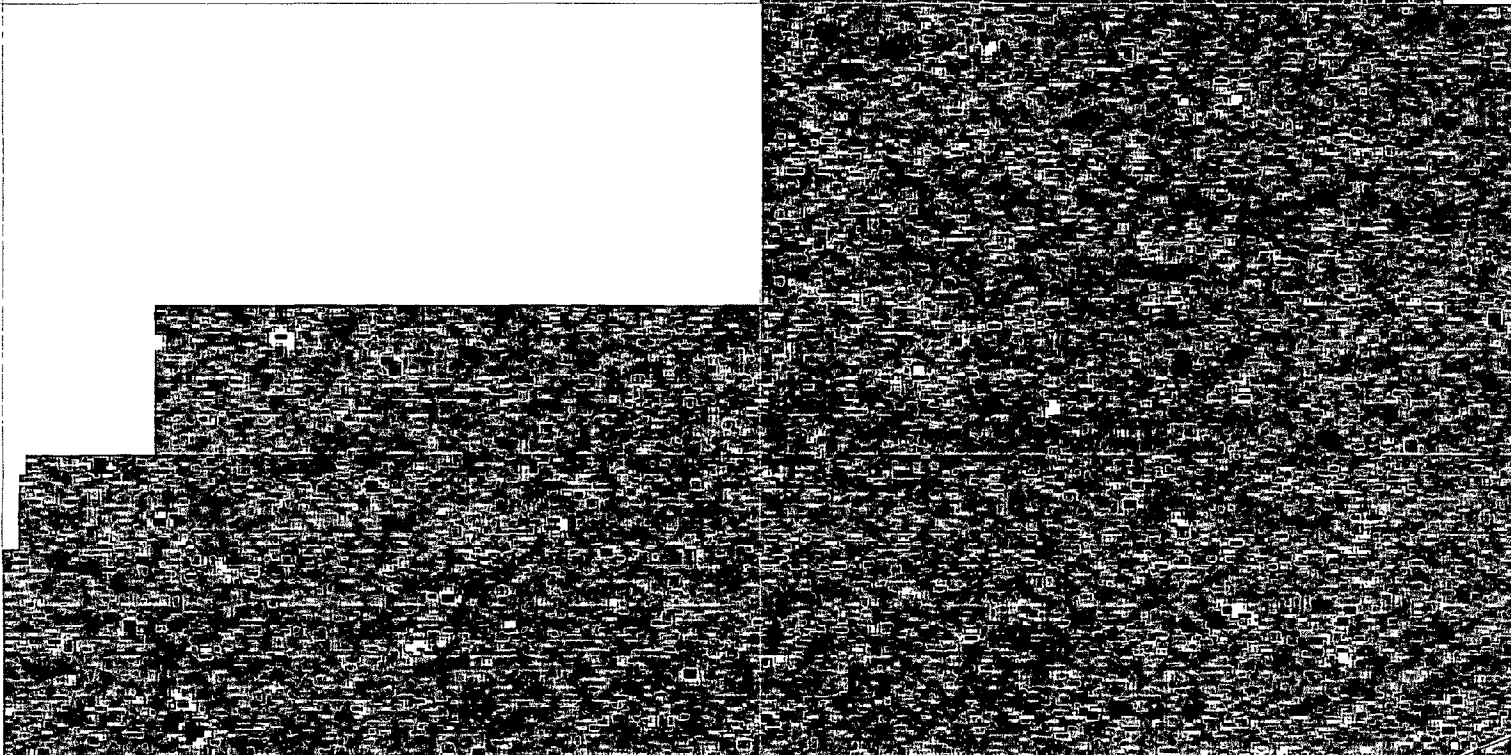

946

Area 1

Turker Beck



381

382

383



Archaeological Services  
University of Durham

Brompton, Northallerton, Romanby  
Flood Alleviation Scheme

Geophysical survey

Figure 34

Greyscale of Turker Beck Area 1 and  
Area 3

on behalf of

**Mouchel Parkman UK Ltd**



scale 1:1000 - for A3 plot

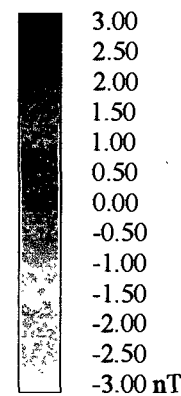



948

Area 3

947

946

Area 1

Turker Beck



381

382

383



Archaeological Services  
University of Durham

Brompton, Northallerton, Romanby  
Flood Alleviation Scheme

Geophysical survey

Figure 35

Geophysical interpretation of Turker  
Beck Area 1 and Area 3

on behalf of

Mouchel Parkman UK Ltd



scale 1:1000 - for A3 plot



outline of survey area



positive magnetic anomalies



negative magnetic anomalies



dipolar magnetic anomalies

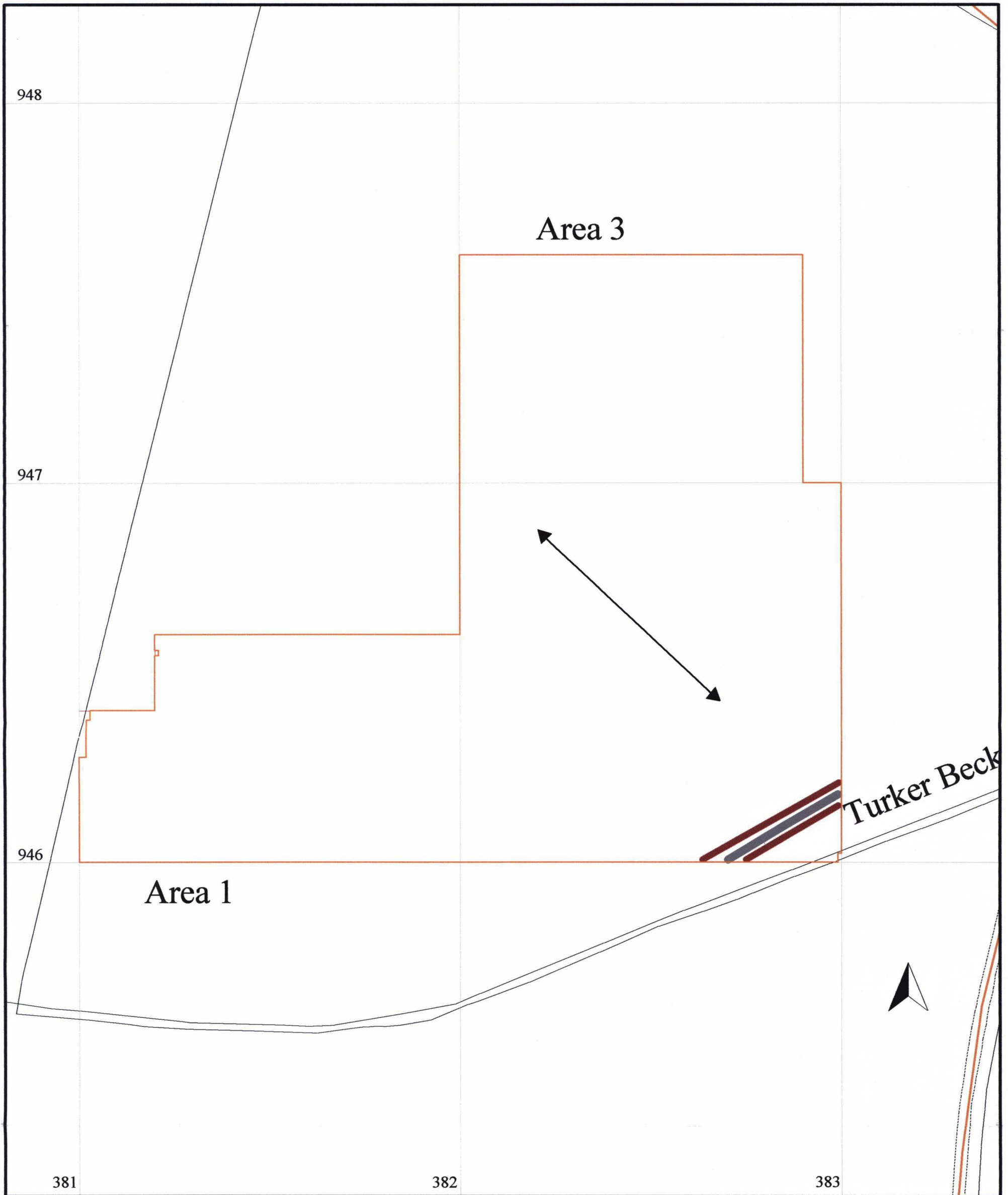

Archaeological Services  
University of Durham

Brompton, Northallerton, Romanby  
Flood Alleviation Scheme

Geophysical survey





Figure 36

Archaeological interpretation of Turker  
Beck Area 1 and Area 3

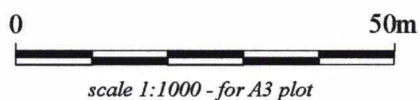
on behalf of

**Mouchel Parkman UK Ltd**



-  outline of survey area
-  soil-filled features
-  orientation of ridge and furrow
-  track



Area 2

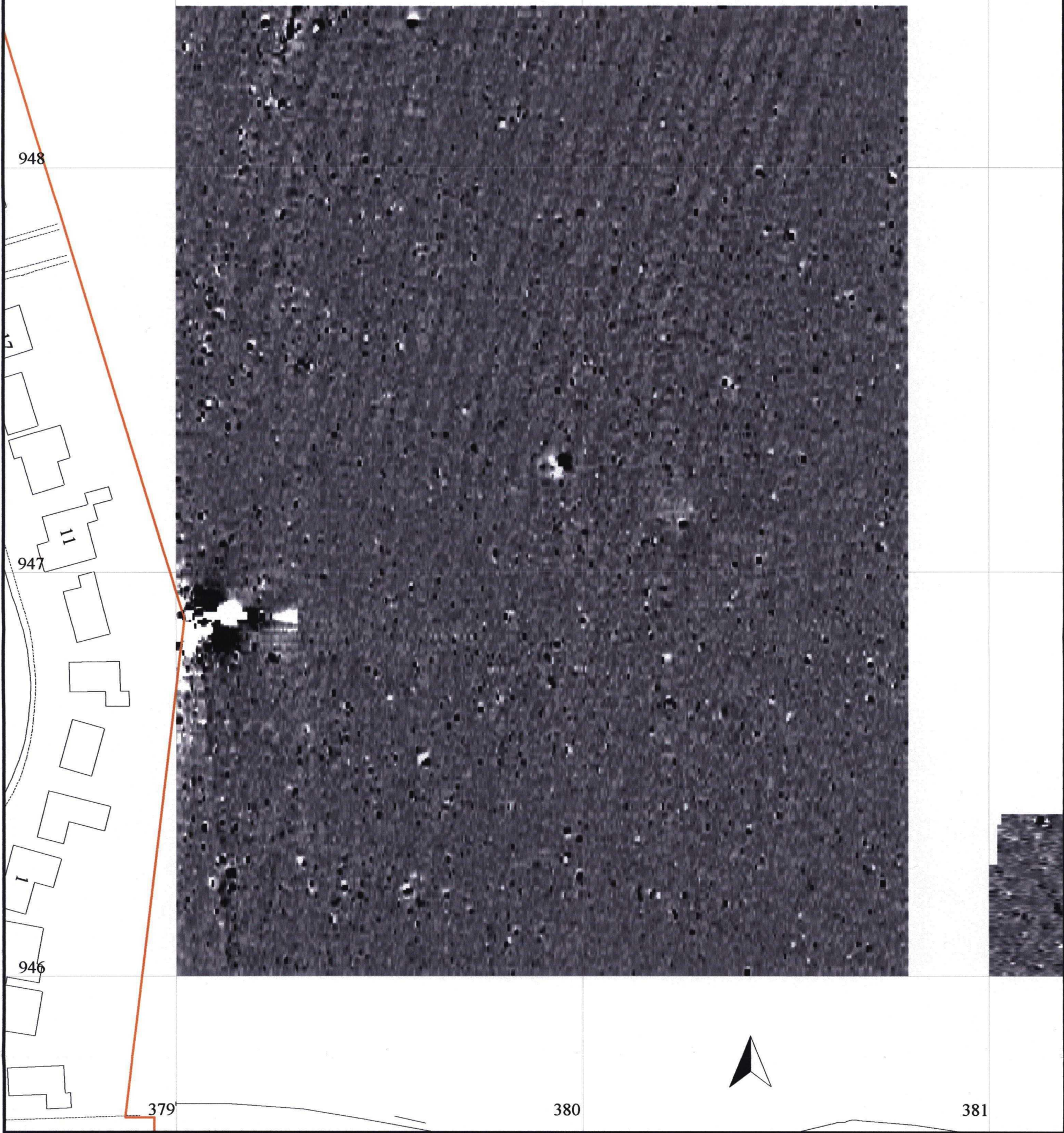

Archaeological Services  
University of Durham

Brompton, Northallerton, Romanby  
Flood Alleviation Scheme

Geophysical survey

Figure 37

Greyscale of Turker Beck Area 2

on behalf of

**Mouchel Parkman UK Ltd**



scale 1:1000 - for A3 plot

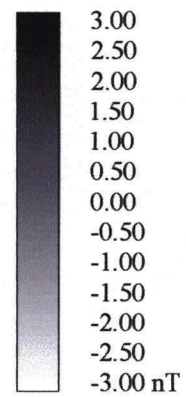



# Area 2

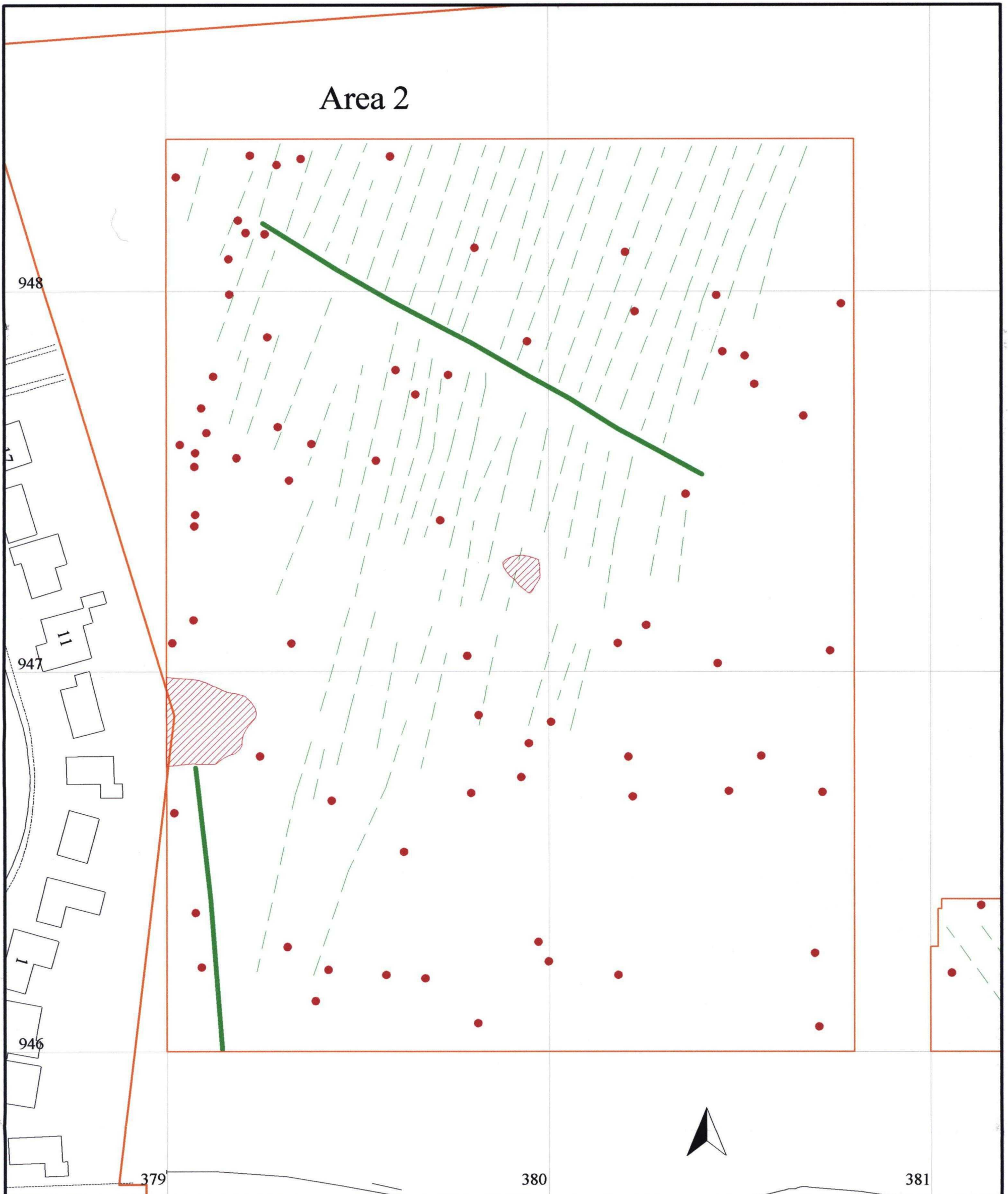

Archaeological Services  
University of Durham

Brompton, Northallerton, Romanby  
Flood Alleviation Scheme

Geophysical survey

Figure 38

Geophysical interpretation of Turker  
Beck Area 2

on behalf of

**Mouchel Parkman UK Ltd**



scale 1:1000 - for A3 plot



outline of survey area



positive magnetic anomalies



negative magnetic anomalies



dipolar magnetic anomalies