

Archaeological Services
University of Durham

**Brompton, Northallerton, Romanby
Flood Alleviation Scheme**

Geophysical survey

Figure 77

*Archaeological interpretation of Winton
Beck Area 4*

on behalf of

Mouchel Parkman UK Ltd



scale 1:1000 - for A3 plot

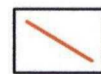

outline of survey area



soil-filled features

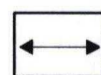

orientation of ridge
and furrow

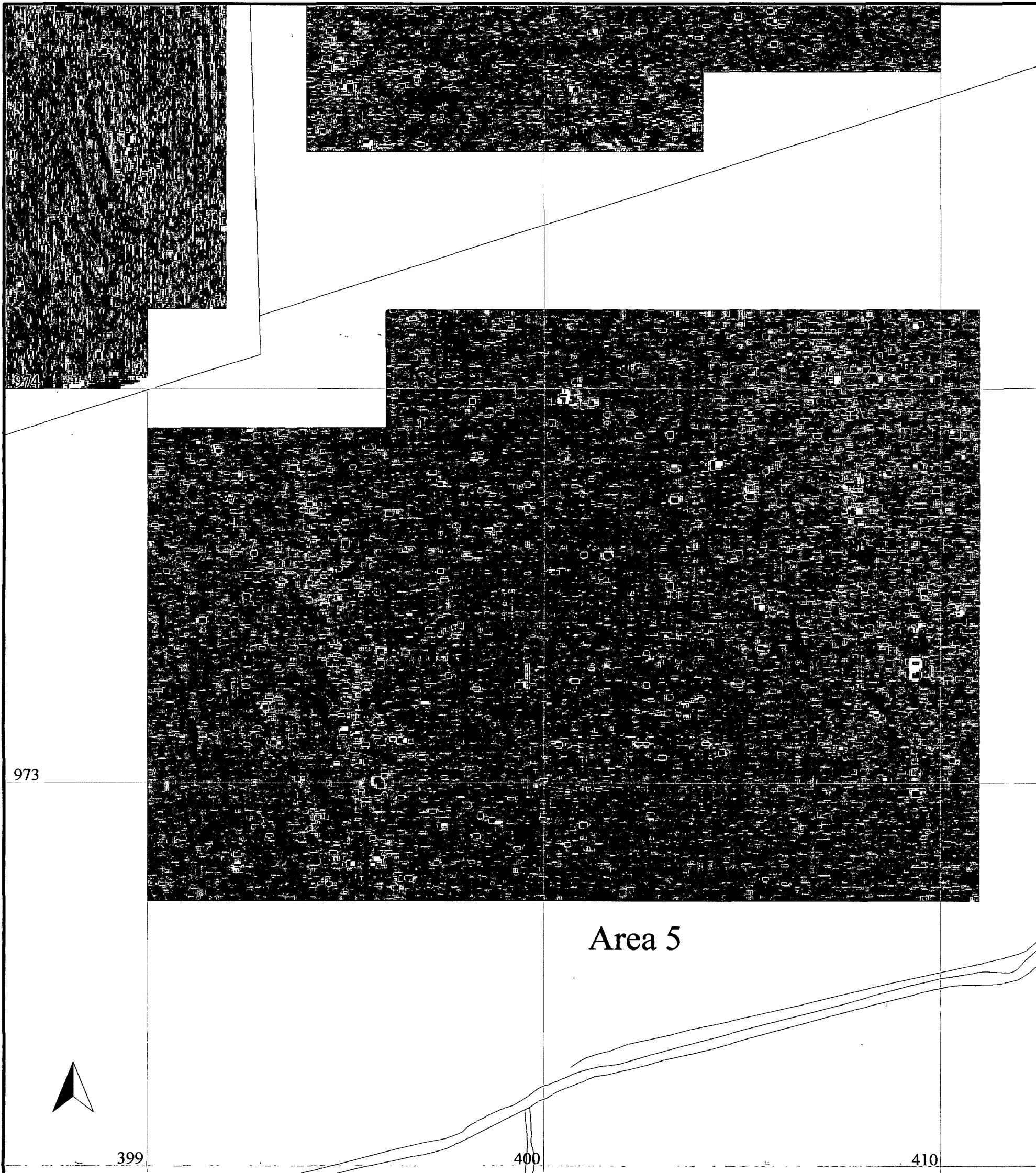

Area 5



399

400

410



Archaeological Services
University of Durham

Brompton, Northallerton, Romanby
Flood Alleviation Scheme

Geophysical survey

Figure 78

Location of Winton Beck Area 5

on behalf of

Mouchel Parkman UK Ltd



scale 1:1000 - for A3 plot

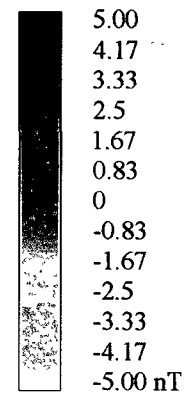

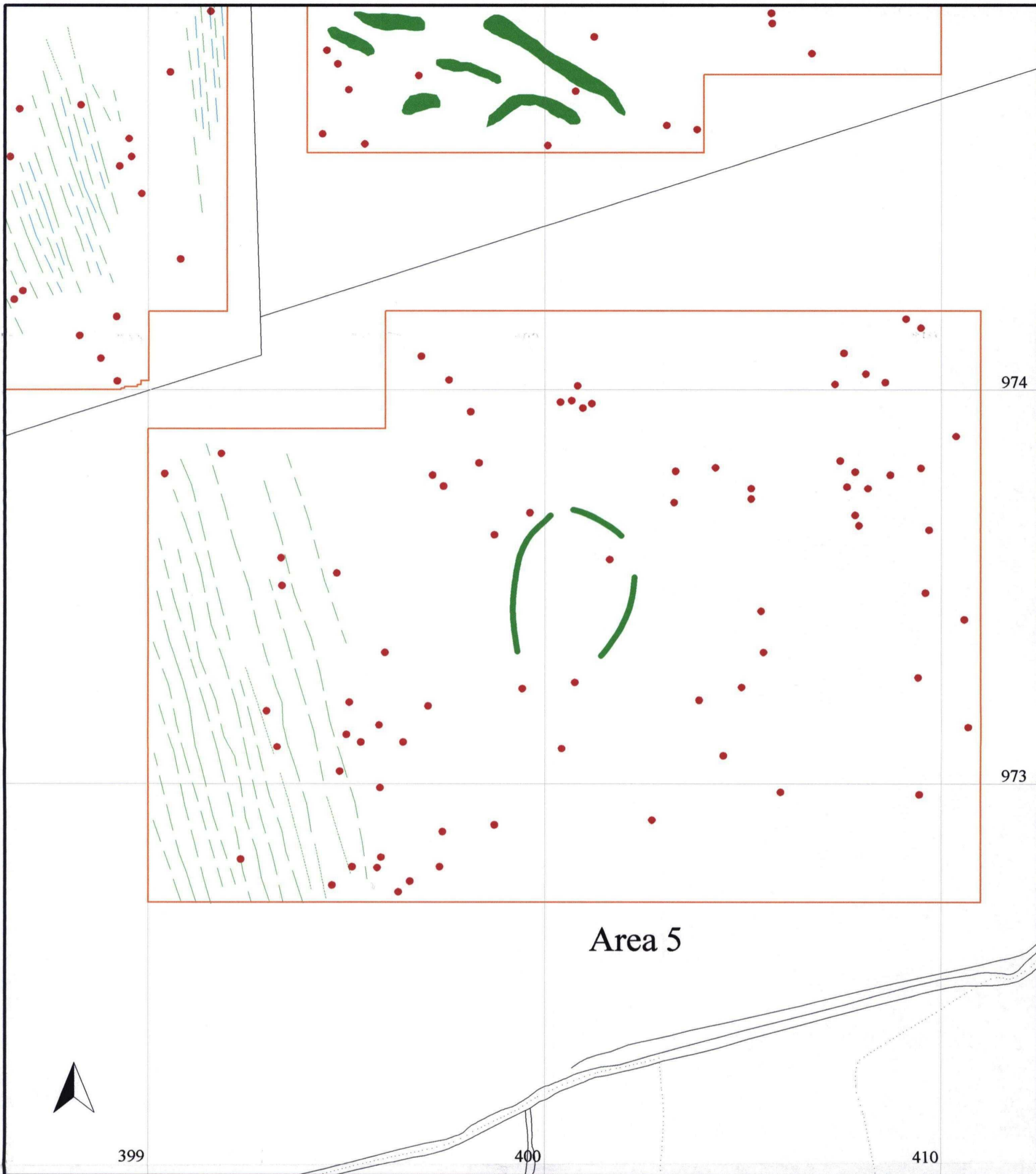

399

400

410

Area 5

974

973

 **Archaeological Services**
University of Durham

**Brompton, Northallerton, Romanby
Flood Alleviation Scheme**

Geophysical survey

Figure 79

*Geophysical interpretation of Winton
Beck Area 5*

on behalf of

Mouchel Parkman UK Ltd

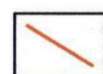
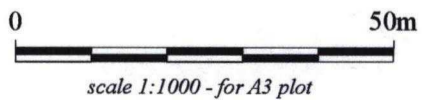

outline of survey area



positive magnetic anomalies



negative magnetic anomalies



dipolar magnetic anomalies



Area 5



Archaeological Services
University of Durham

Brompton, Northallerton, Romanby
Flood Alleviation Scheme

Geophysical survey

Figure 80

Archaeological interpretation of Winton
Beck Area 5

on behalf of

Mouchel Parkman UK Ltd

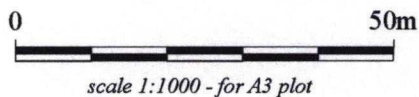

outline of survey area



soil-filled features

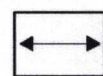

orientation of ridge
and furrow