

Trench 3

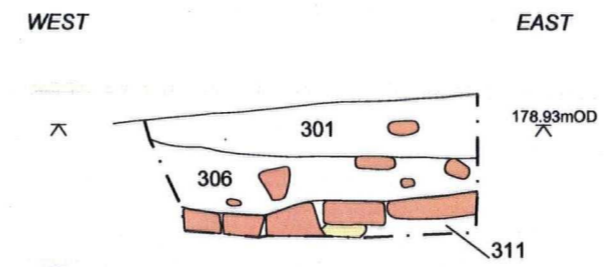

Trench 3 - Section 1



Trench 3 - Section 2

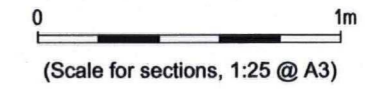
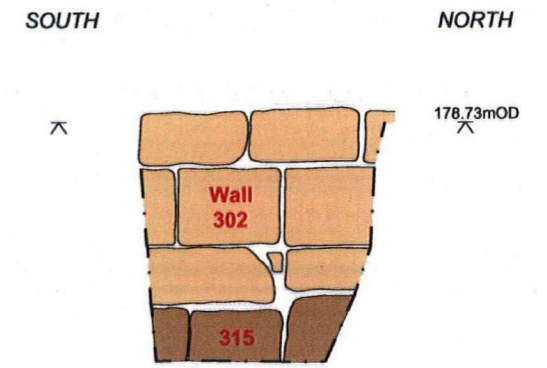

Plate 7: Post-excavation view of Trench 3 showing building (Structure 318) from north (Scale = 1m & 0.5m)

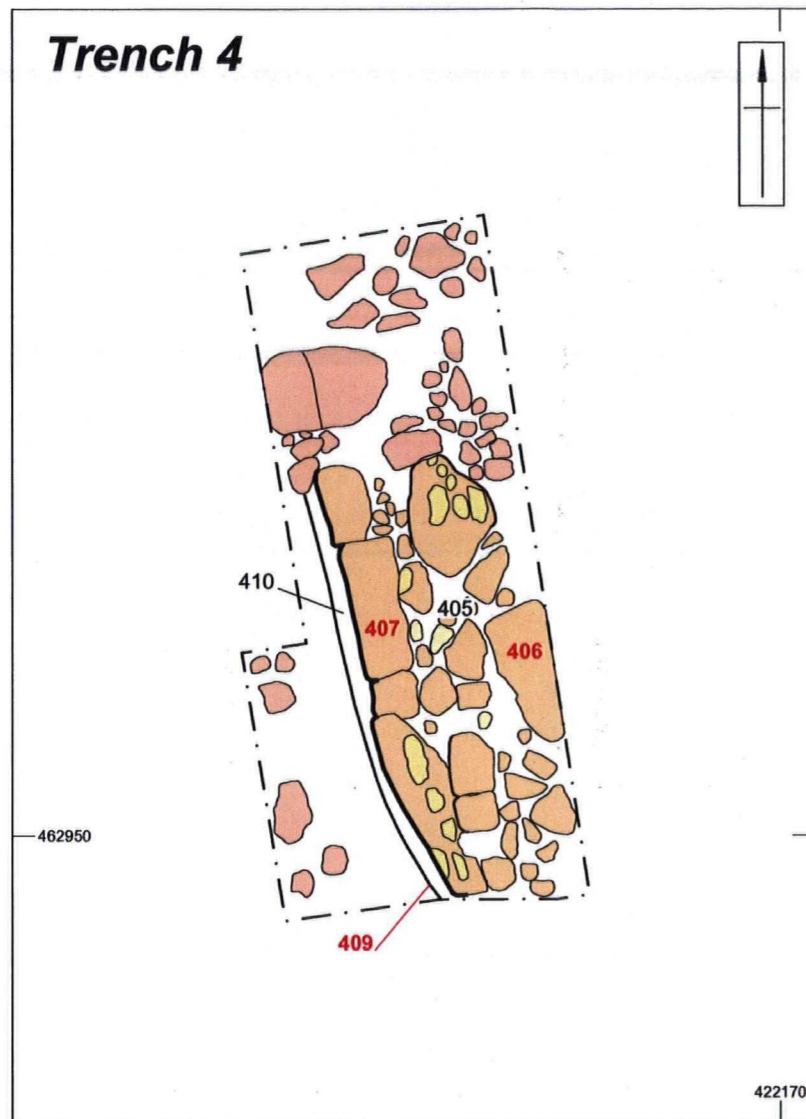

Plate 8: Trench 3, detail of paving 316 from south (Scale = 1m)



Plate 9: Trench 3, detail of Wall 302 and footing 315 from east (Scale = 0.5m)

Trench 4



Walls
 Mortar
 Stone

0 1 2m
 (Scale for plans, 1:50 @ A3)



Plate 10: Post-excitation view of Trench 4 from south (Scales = 1m & 2m)



Plate 11: Decorated tile fragment from Trench 4 (Context 402)

Trench 5

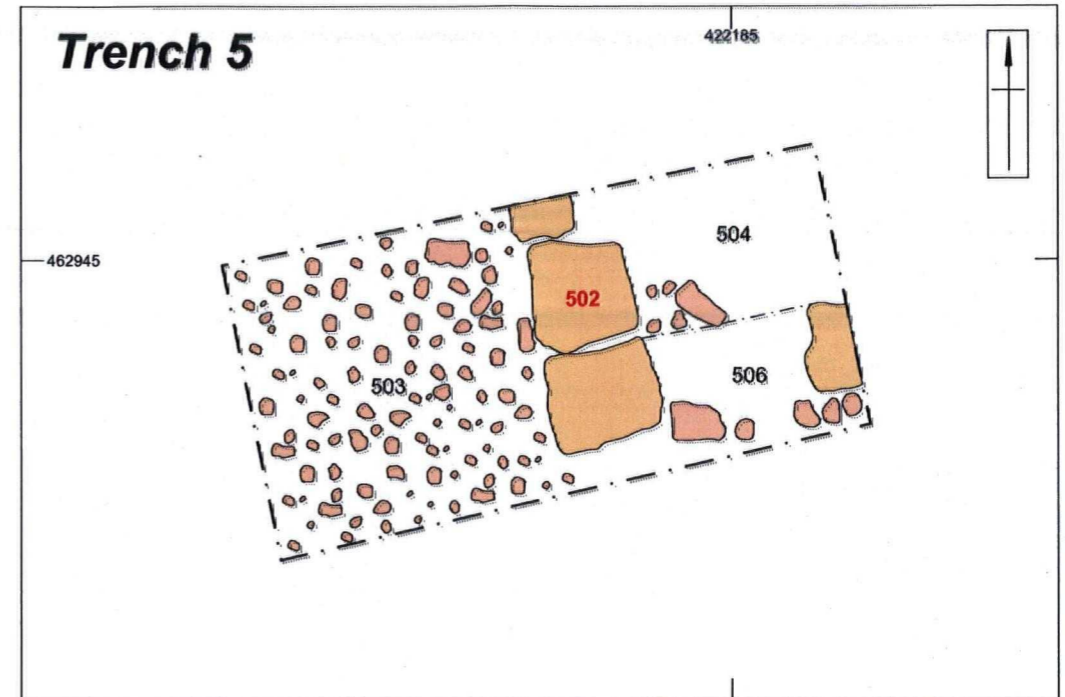
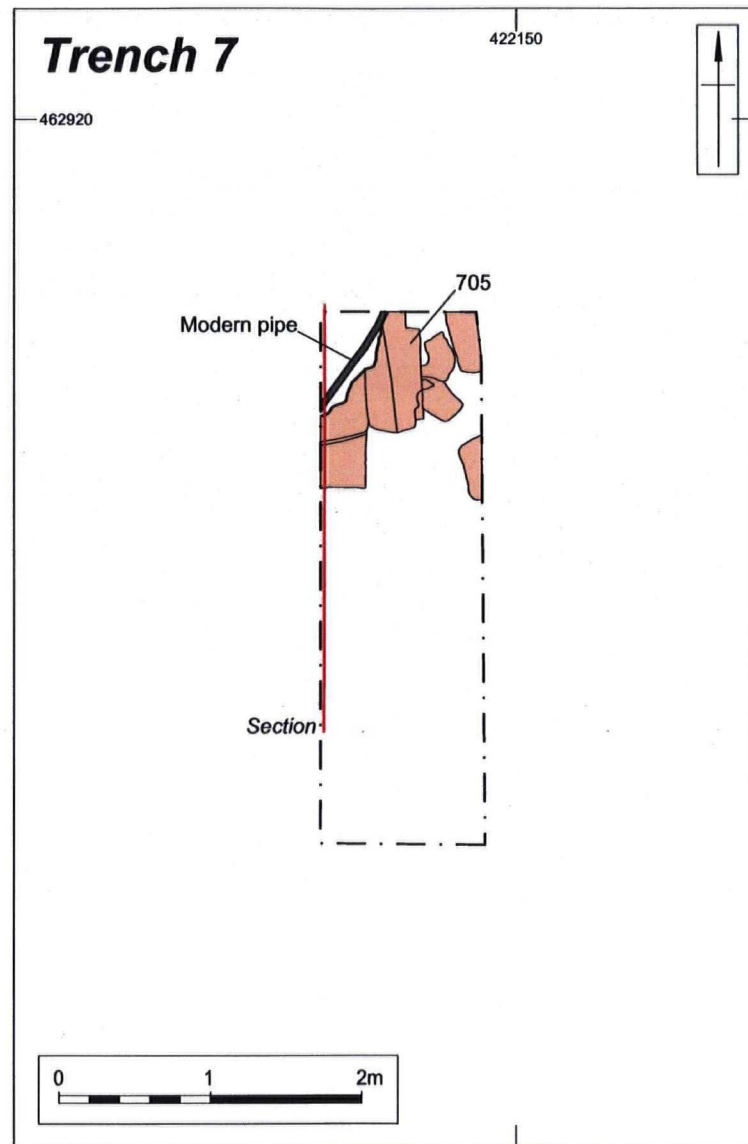

Plate 12: Post-excitation view of Trench 5 from south (Scales = 1m, & 2m)



Trench 7 - Section

SOUTH

NORTH

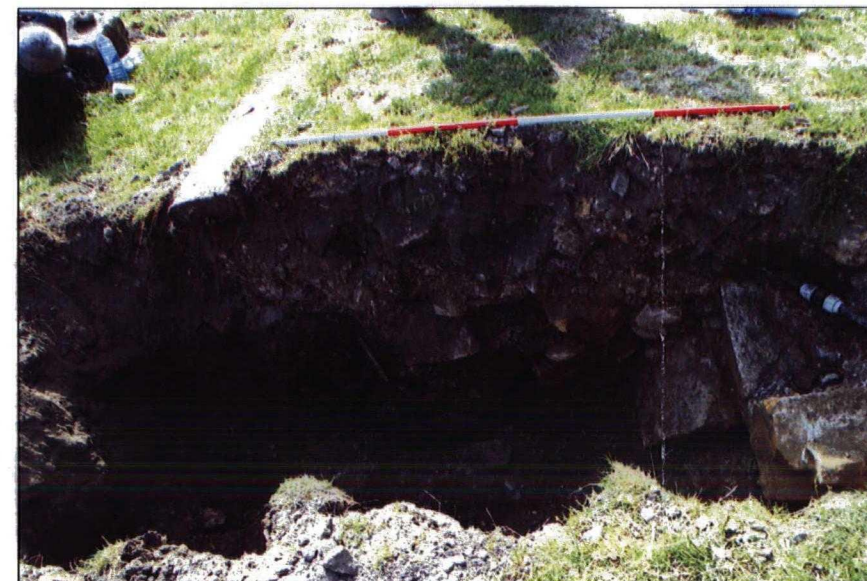
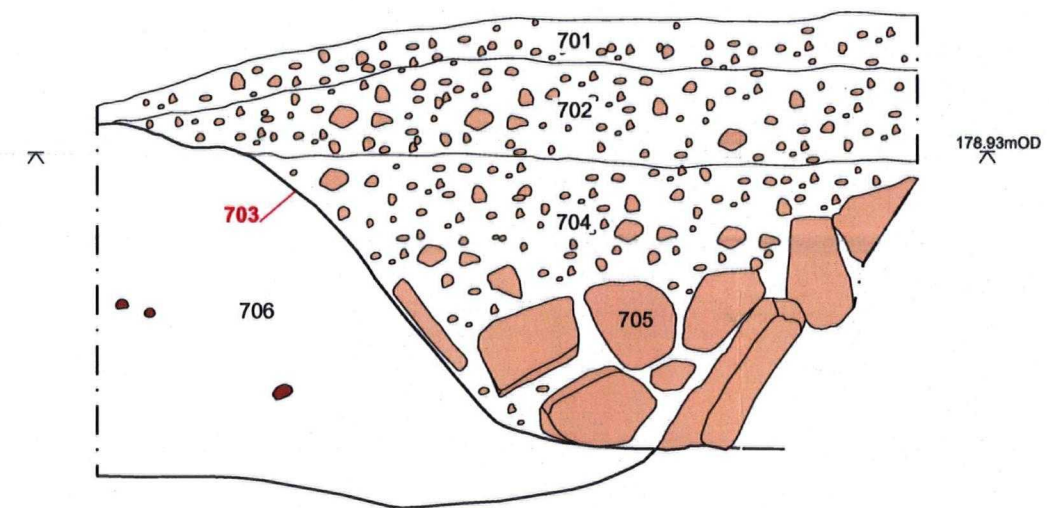

Plate 13: Post-excavation view of Trench 7 from east (Scales = 2m)

-  Stone
-  CBM/Tile