





Figure 2. Watching Brief Area

RYEDALE D.C.  
- 4 OCT 2006  
DEVELOPMENT CONTROL

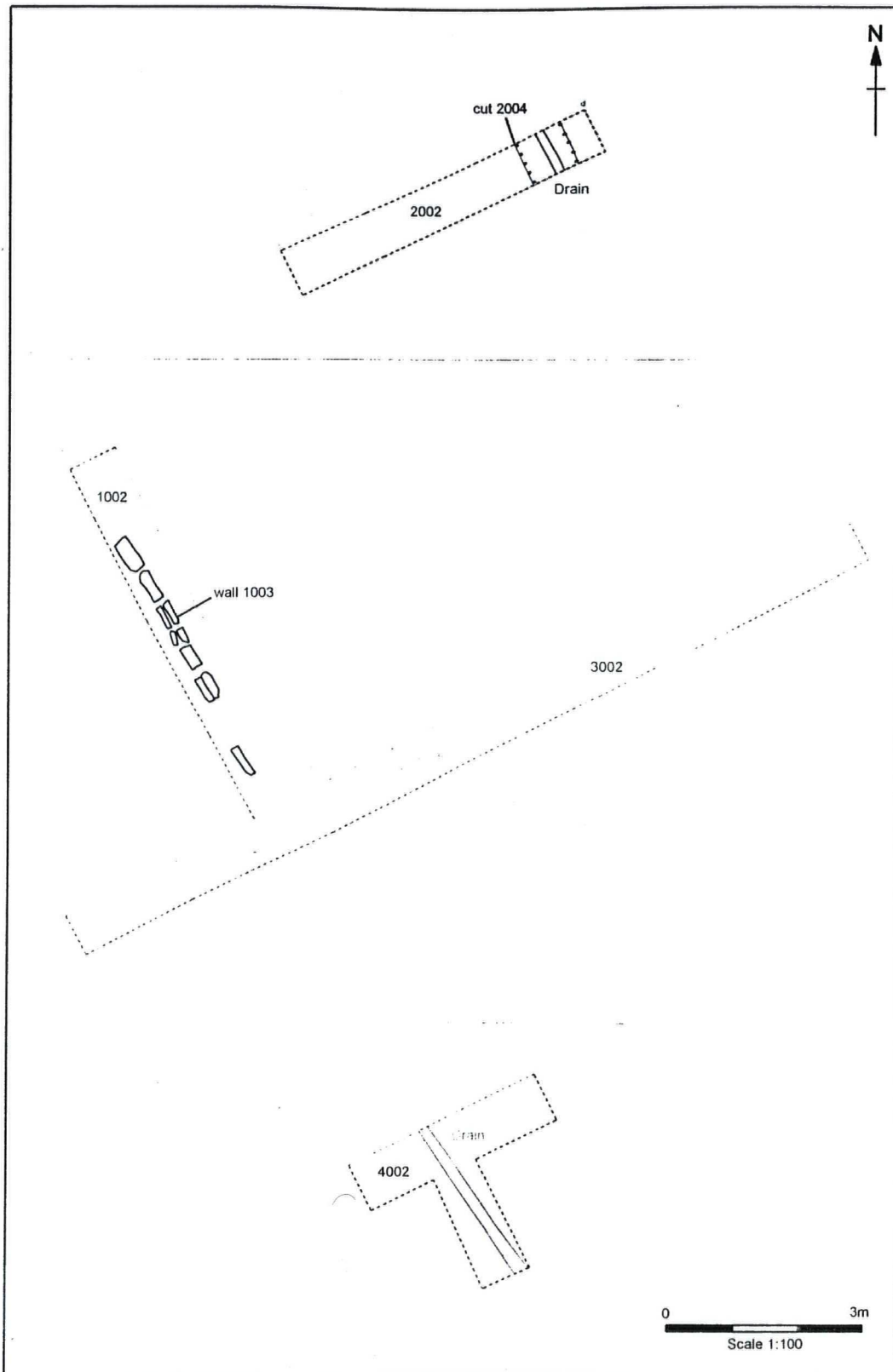

Figure 3. Plan of Watching Brief Features

RYEDALE D.C.

- 4 OCT 2006

DEVELOPMENT CONTROL



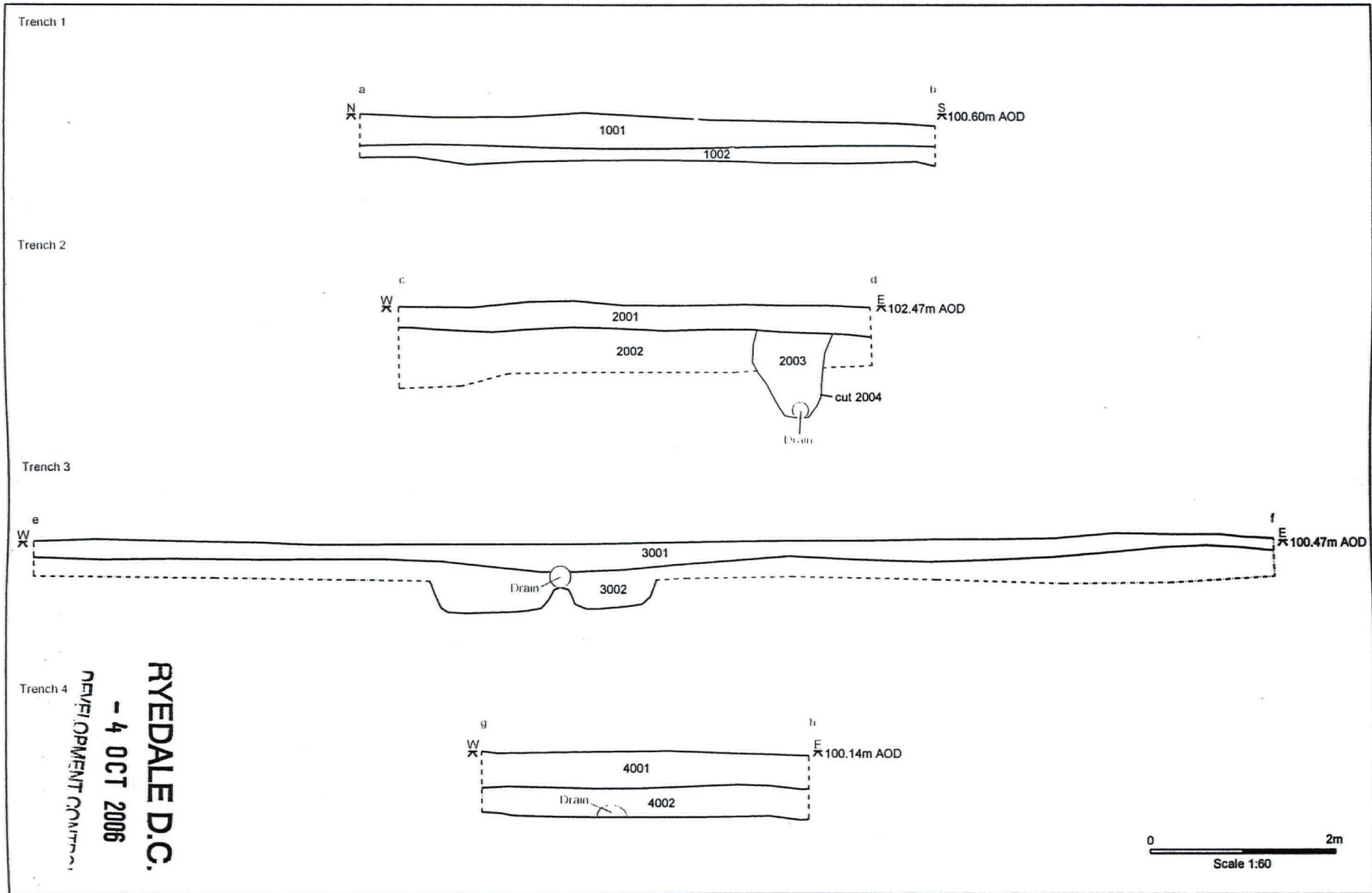

RYEDALE D.C.  
 - 4 OCT 2006  
 NEW/IMPROVEMENT CONTRACT

Figure 4. Watching Brief Sections





Plate 1. Trench 1. Wall 1003. Facing South

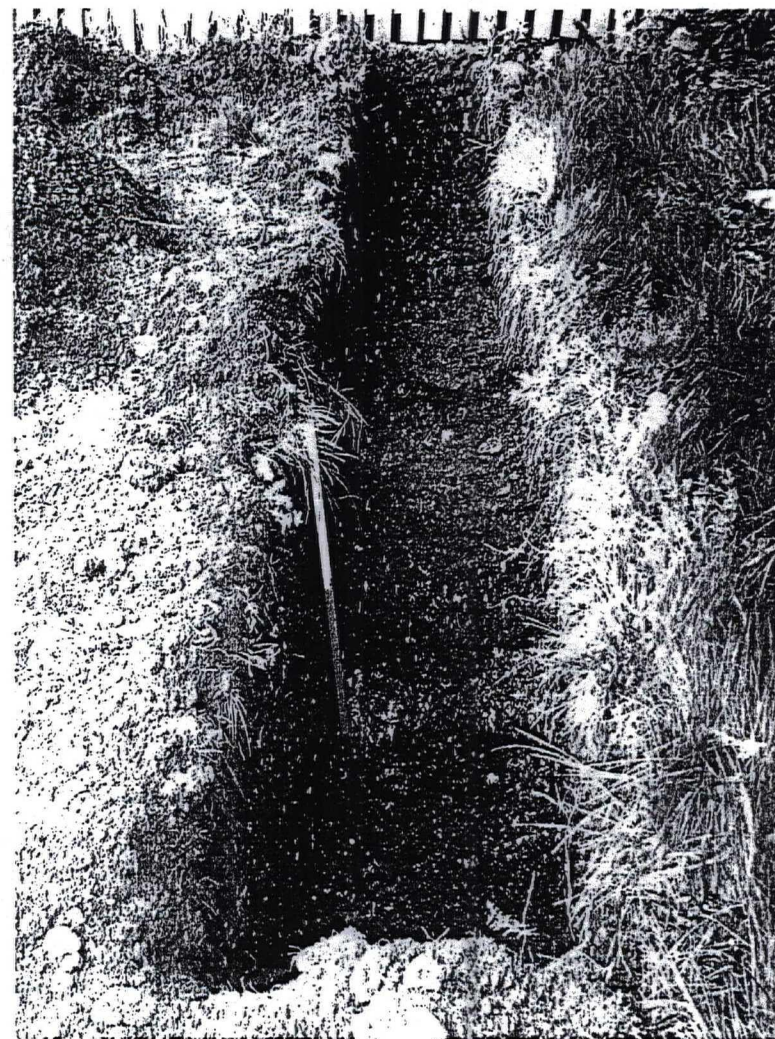

Plate 2. Trench 2. Drain Cut 2004. Facing West

HYEDALE D.C.  
- 4 OCT 2006  
DEVELOPMENT CONTROL





Plate 3. Trench 3. Overall View. Facing East

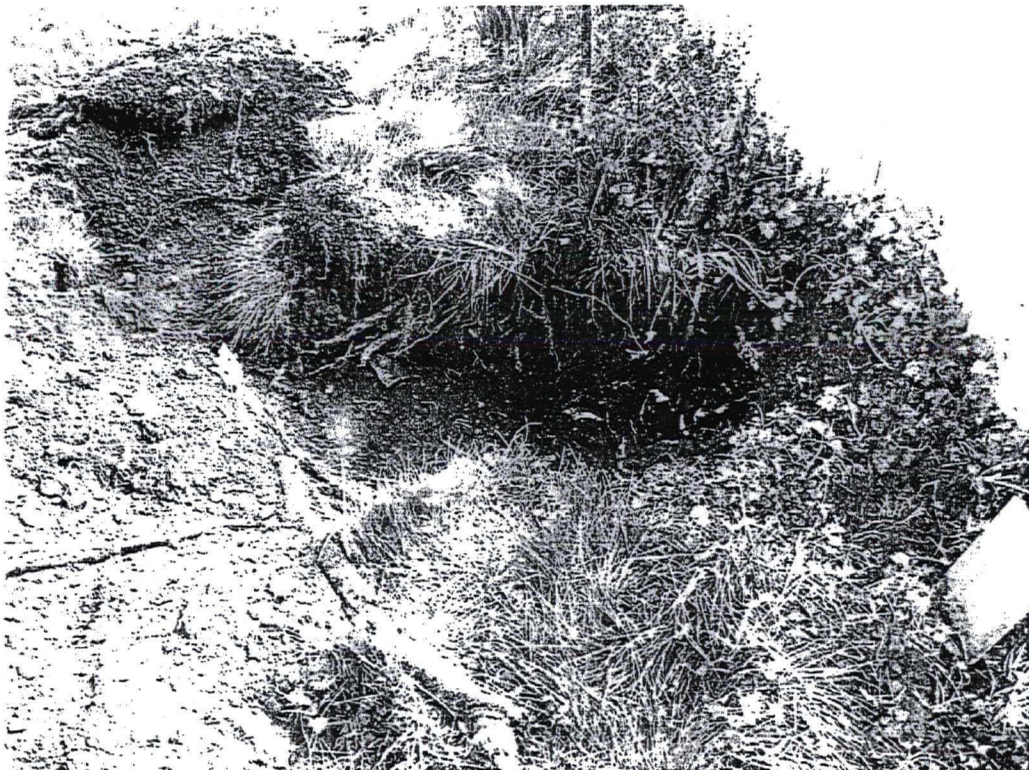

Plate 4. Trench 4. Drain. Facing South West

WYEDALE D.C.

- 4 OCT 2006

DEVELOPMENT CONTROL



# APPENDIX 1

## Context Listing

Land adjacent to Beckside Cottage, Kirby Grindalythe 01.04.06

### Trench 1

Context	Description
1001	Deposit 10YR 4/2, silty, Topsoil
1002	Deposit 10YR 4/3; silt, Subsoil
1003	Structure Chalk wall foundation

### Trench 2

Context	Description
2001	Deposit 10YR 4/2, silty, Topsoil
2002	Deposit 10YR 4/3; silt, Subsoil
2003	Deposit 10YR 4/3; silt; fill of Cut 2004
2004	Cut; drain filled by 2003

### Trench 3

Context	Description
3001	Deposit 10YR 4/2, silty, Topsoil
3002	Deposit 10YR 4/3; silt, Subsoil

### Trench 4

Context	Description
4001	Deposit 10YR 4/2, silty, Topsoil
4002	Deposit 10YR 4/3; silt, Subsoil

RYEDALE D.C.

- 4 OCT 2006

DEVELOPMENT CONTR

## APPENDIX 2

### Finds Catalogue

Land adjacent to Beckside Cottage, Kirby Grindalythe 01.04.06

Context	Type	Total	Description	Weight (g)	Spot date
<b>Trench 1</b>					
1002	Pottery	2	1 base sherd 1 handle sherd	82g	18th-19th century
	CBM	1	Pantile fragment	21g	
<b>Trench 2</b>					
2002		3	2 body sherds 1 base sherd	38g	12th-13th century
<b>Trench 3</b>					
3002	Pottery	3	3 body sherds	60g	12th-14th century

RYEDALE D.C.

- 4 OCT 2006

DEVELOPMENT CONTROL



## APPENDIX 3

### Drawing Archive Listing

Land adjacent to Becksidc Cottage, Kirby Gryndalythe 01.04.06

Drawing No.	Scale	Type	Description
1	1:50	Plan	Overall plan of Trench 1
2	1:50	Section	Trench 1 west facing section
3	1:50	Plan	Overall plan of Trench 3
4	1:50	Section	Trench 2 south facing section
5	1:50	Plan	Overall plan of Trench 3
6	1:50	Section	Trench 3 south facing section
7	1:50	Plan	Overall plan of Trench 4
8	1:50	Section	South facing section of trench 4
9	1:200	Plan	Overall plan of development plot

RYEDALE D.C.  
- 4 OCT 2006  
DEVELOPMENT CONTROL

## APPENDIX 4

### Photographic Archive Listing

Land adjacent to Beckside Cottage, Kirby Gryndalythe 01.04.06

#### Digital Camera

Frame	Description	Scale	Facing
1	Wall foundations 1003	1x1m	North
2	Wall foundations 1003	1x1m	North
3	Wall foundations 1003	1x1m	South
4	Overall view of trench 2	N/A	North
5	Drain cut 1004	1x1m	West
6	Overall view of trench 3	1x1m	East
7	Overall view of trench 4	N/A	South east

ATEDALE D.C.

- 4 OCT 2006

DEVELOPMENT CONTROL



## APPENDIX 5

### Project Team Details

Land adjacent to Beckside Cottage, Kirby Grindalythe 01.04.06

#### Fieldwork

Charlie Morris

#### Post-excavation

Charlie Morris *report*

Nigel Cavanagh *editorial*

Dave Knight *CAD and illustrations*

**RYEDALE D.C.**

**- 4 OCT 2006**

DEVELOPMENT CONTROL