

PARISH 3060

NYCC HER	
SNY	11653
ENY	3937
CNY	5635
Parish	3060
Rec'd	24/07/2007

**2 Wold View  
West Heslerton  
North Yorkshire**

**06/005654/FUL -7**

*Archaeological Watching Brief*

**2 Wold View  
West Heslerton  
North Yorkshire**

**06/005654/Ful**

**Archaeological Watching Brief**

<b>Contents</b>	<b>Page</b>
Figure List	2
Plate List	2
Non-technical Summary	3
1. Introduction	3
2. Topography and Geology	3
3. Archaeological and Historical Background	4
4. Methods	4
5. Results	4
6. Conclusion	5
7. Bibliography	5

**Figure List**

**Page**

- |  |    |
|--|----|
| 1. Site Location Map (1: 25000 scale)                  | 7  |
| 2. Area of Development (1: 2500 scale)                 | 8  |
| 3. Extract from 1853 First Edition Ordnance Survey Map | 9  |
| 4. Watching Brief Area                                 | 10 |

**Plate List**

- |   |    |
|---|----|
| 1. General view of site. Facing north-west. | 11 |
| 2. Natural stratigraphy. Facing north-east. | 11 |

**2 Wold View  
West Heslerton  
North Yorkshire**

**Archaeological Watching Brief**

***Summary***

*An archaeological Watching brief was carried out by MAP Archaeological Consultancy Ltd during the construction of an extension to an existing dwelling at 2 Wold View, West Heslerton, North Yorkshire. No archaeological deposits or finds were present.*

**1. Introduction**

This report sets out the results of an Archaeological Watching Brief carried out during the erection of a two-storey / part single-storey extension, including a garage, to a dwelling at 2 Wold View, West Heslerton, North Yorkshire (SE 9129 7582: Figs. 1, 2 and 4).

As the development had the potential to disturb archaeological remains the Heritage Section of NYCC advised that an Archaeological Watching Brief be attached to the planning permission (06/005654/FUL). MAP Archaeological Consultancy Ltd were engaged to carry out the archaeological work, which took place on 28<sup>th</sup> April 2007.

All works were funded by Mr and Mrs Barber, the site owners.

The Ordnance Survey maps are reproduced under licence from the Ordnance Survey, licence no. AL 50453A, with permission from the Controller of Her Majesty's Stationery Office, (c) Crown Copyright.

**2. Topography and Geology**

The site is situated immediately north of the existing dwelling that forms 2 Wold View, which itself lies on the southern side of Grange Farm Road, the minor road leading eastwards from West Heslerton to Rectory Farm. This location is on the eastern edge of

the village of West Heslerton, on a north-facing slope that overlooks the Vale of Pickering. The site's elevation is c. 58m AOD.

The soils are of the Newport 1 Association, described as well-drained sandy and coarse loamy soils over glaciofluvial drift (Mackney *et al.* 1983).

### **3. Archaeological and Historical Background**

The site lies c. 400m southwest of the multi-period landscape of settlement and funerary remains, ranging in date from Neolithic to middle Saxon, that were excavated in the 1980s (Powlesland *et al.* 1986).

The main focus of the medieval village of West Heslerton lies c. 200m to the west, as shown on the 1853 First Edition Ordnance Survey map (Fig. 3).

### **4. Methods**

An existing lean-to was demolished, and the foundations for the new extension were excavated by a 360° tracked mini-excavator using a 0.70m wide bucket. The foundations covered an area c. 6m x 10m in size (Pl. 1).

A number of record shots were taken on a digital camera set on high resolution with 6 million pixels.

### **5. Results**

Natural deposits consisted of greyish clay overlain by c. a 0.70m thick layer of chalk gravel (Pl. 2). The only disturbances to the natural deposits were the foundations of the former lean-to, and a drain and soak-away situated in the northern foundation run. The sequence was completed by a 0.10m deep layer of loamy topsoil. No archaeological deposits existed within the Watching Brief area and no finds were recovered.

## 6. Conclusion

Although no archaeological deposits or finds existed within the area of the Watching Brief, this may reflect the relatively small area observed along with the degree of disturbance associated with the existing dwelling. It remains possible that archaeological deposits still exist in the vicinity of the site.

## 7. Bibliography

- Mackney D *et al.* 1983      *Soil Survey of England and Wales, Sheet 1: Northern England.*
- Powlesland D *et al.* 1986      Excavations at Heslerton, North Yorkshire 1978-82.  
*Archaeol. J.* 143 (1986), 53-173.



Figure 1. Site Location

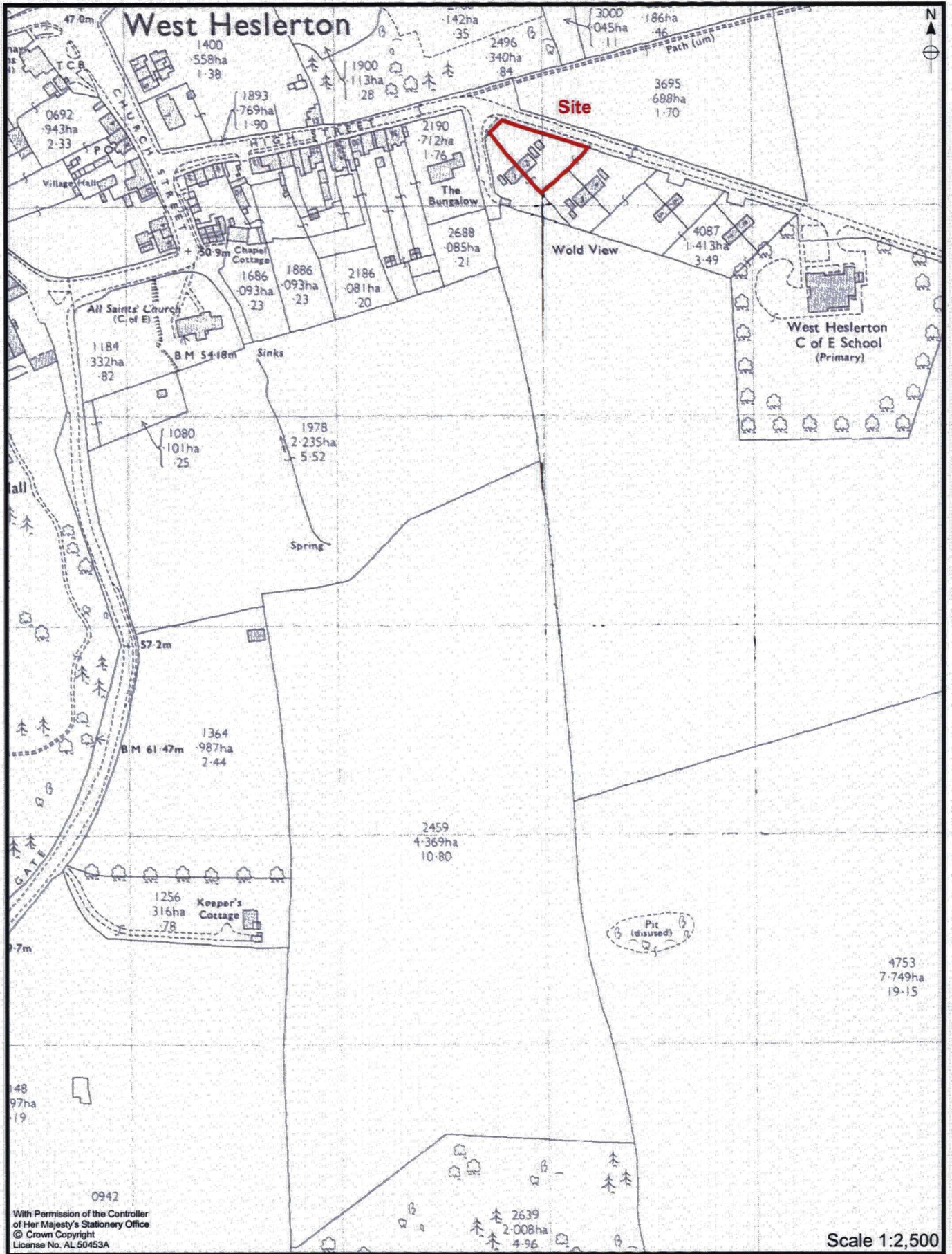

**Figure 2. Area of Development**

With Permission of the Controller of Her Majesty's Stationery Office © Crown Copyright License No. AL 50453A





Figure 3. Extract from the 1853 First Edition Ordnance Map



Figure 4. Watching Brief Area



**Plate 1.** General View of Site. Facing West

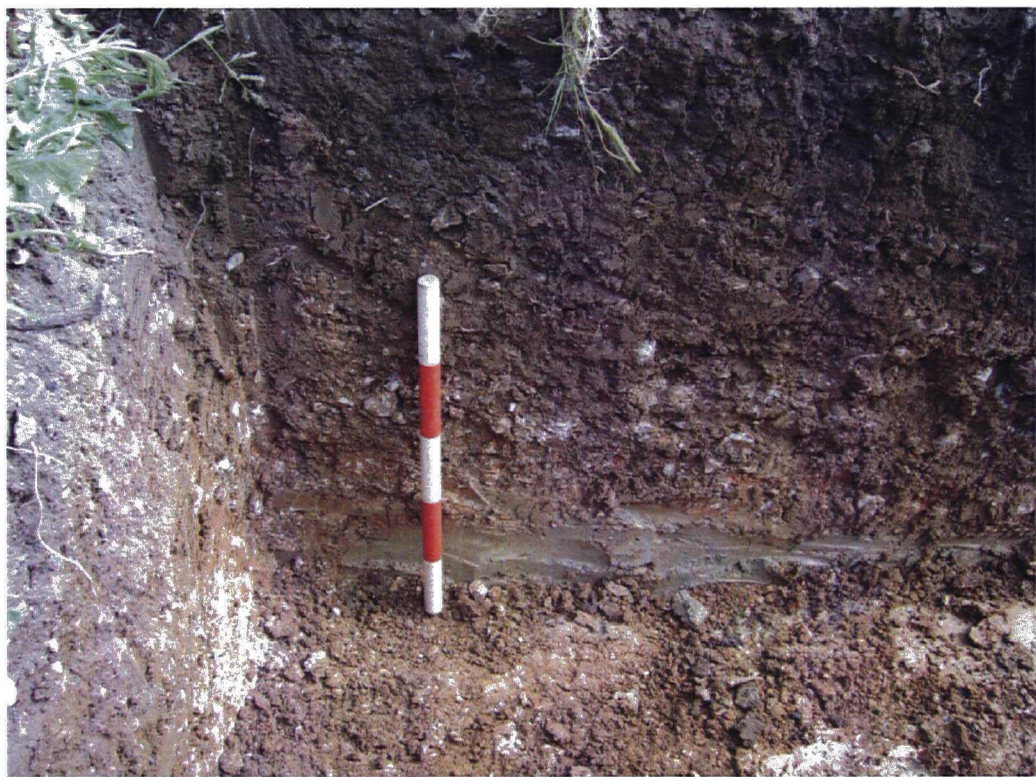

**Plate 2.** Natural Stratigraphy