

KEY / NOTES

□ Site Boundary

MAP

Archaeological Consultancy Ltd.

SITE: Gargrave Road, Skipton.

CLIENT: Indigo Planning Limited

TITLE: Area of Development

Figure 2

Scale: 1:2,000

DRAWING REF.:

DRAWN BY: DK

APPROVED BY:

CHECKED BY:

REVISIONS:



Not To Scale

KEY / NOTES

□ Site Boundary

MAP

Archaeological Consultancy Ltd.

SITE: Gargrave Road, Skipton

CLIENT: Indigo Planning Limited

TITLE: Extract from the Tithe Award Map for Stirton with Thorlby, 1842

Figure 3

Scale: NTS

DRAWING REF.

DRAWN BY: DK

APPROVED BY:

CHECKED BY:

REVISIONS:



KEY/NOTES

 Site Boundary

MAP

Archaeological Consultancy Ltd.

SITE: Gargrave Road, Skipton

CLIENT: Indigo Planning Limited

Extract from the 1852 and 1854
TITLE: First Edition Ordnance Survey
Maps

Figure 4 | Scale: 1:10,560

DRAWING REF.:

DRAWN BY: DK	APPROVED BY:	CHECKED BY:
--------------	--------------	-------------

REVISIONS

Scale 1:10,560
or 6" to 1 mile

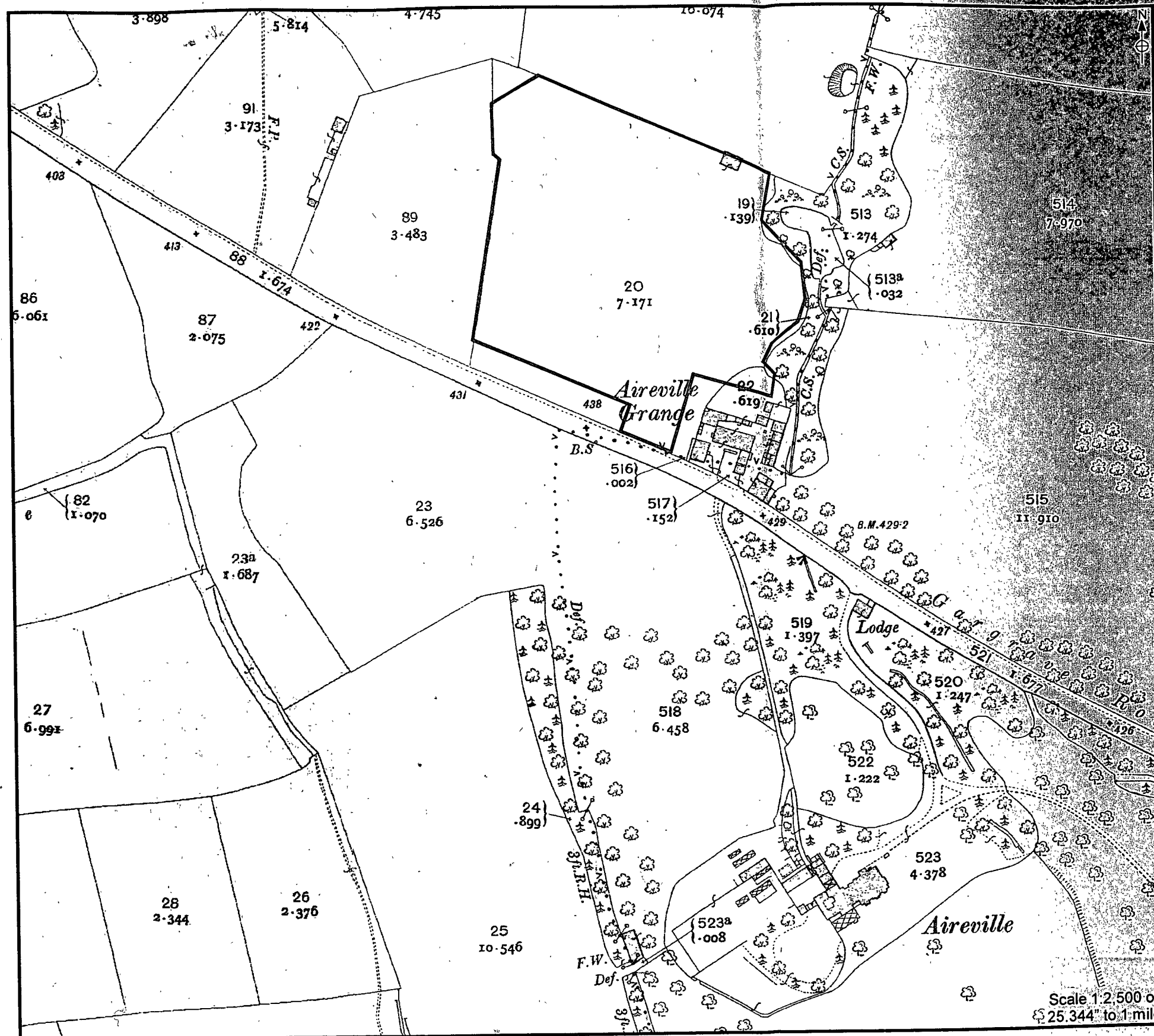

KEY/NOTES

Site Boundary

MAP

Archaeological Consultancy Ltd.

SITE: Gargrave Road, Skipton

CLIENT: Indigo Planning Limited

TITLE: Extract from the 1909 Ordnance Survey Map

Figure 5 **Scale:** 1:2,500

DRAWING REF.

DRAWN BY: DK **APPROVED BY:** **CHECKED BY:**

REVISIONS:

Scale 1:2,500 or
25,344" to 1-mile

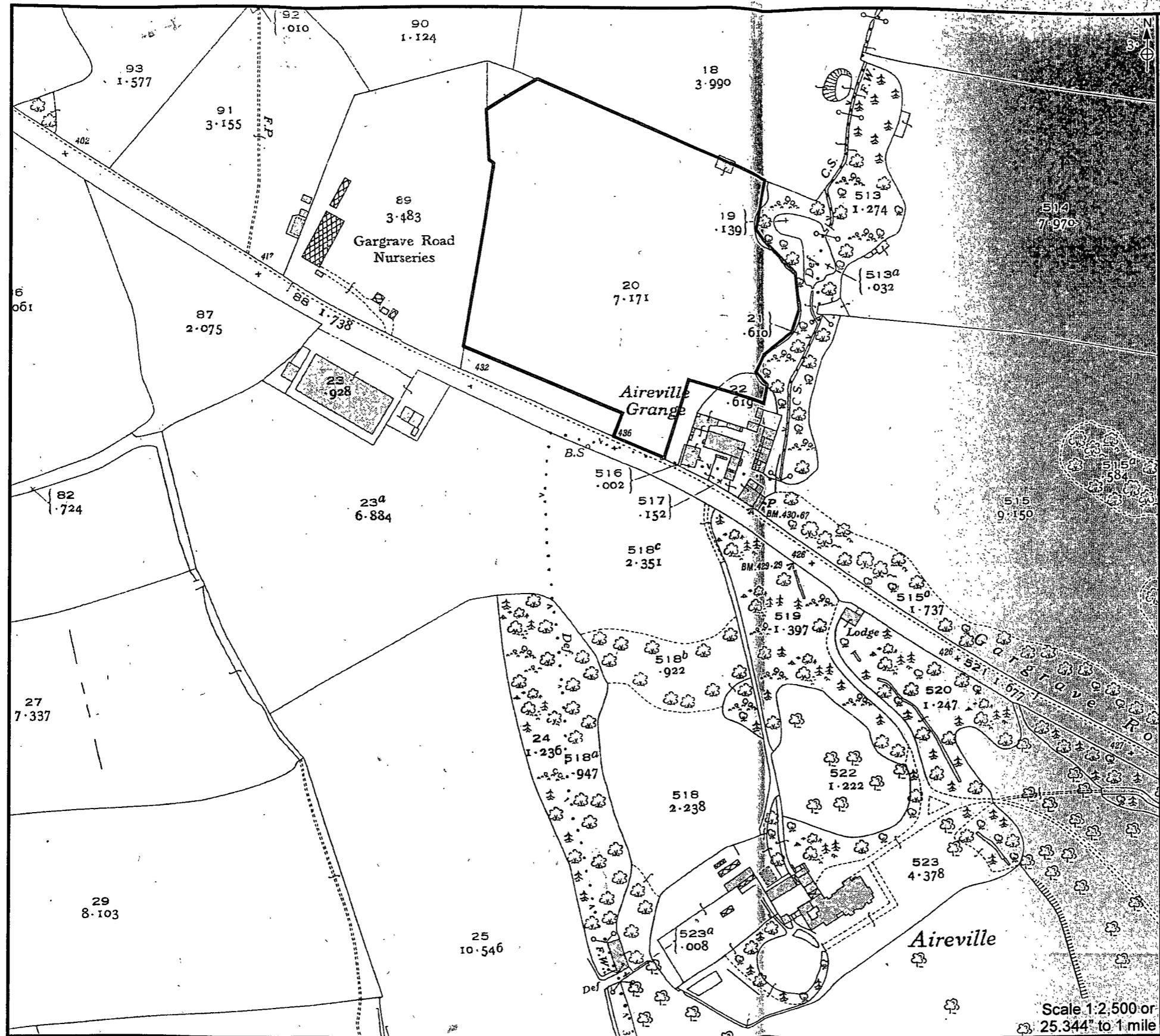

KEY / NOTES

Site Boundary

MAP

Archaeological Consultancy Ltd.

SITE: Gargrave Road, Skipton

CLIENT: Indigo Planning Limited

TITLE: Extract from the 1938 Ordnance Survey Map

Figure 6 Scale: 1:2,500

DRAWING REF:

DRAWN BY: DK **APPROVED BY:** **CHECKED BY:**

REVISIONS:

Scale 1:2,500 or
25,344" to 1 mile

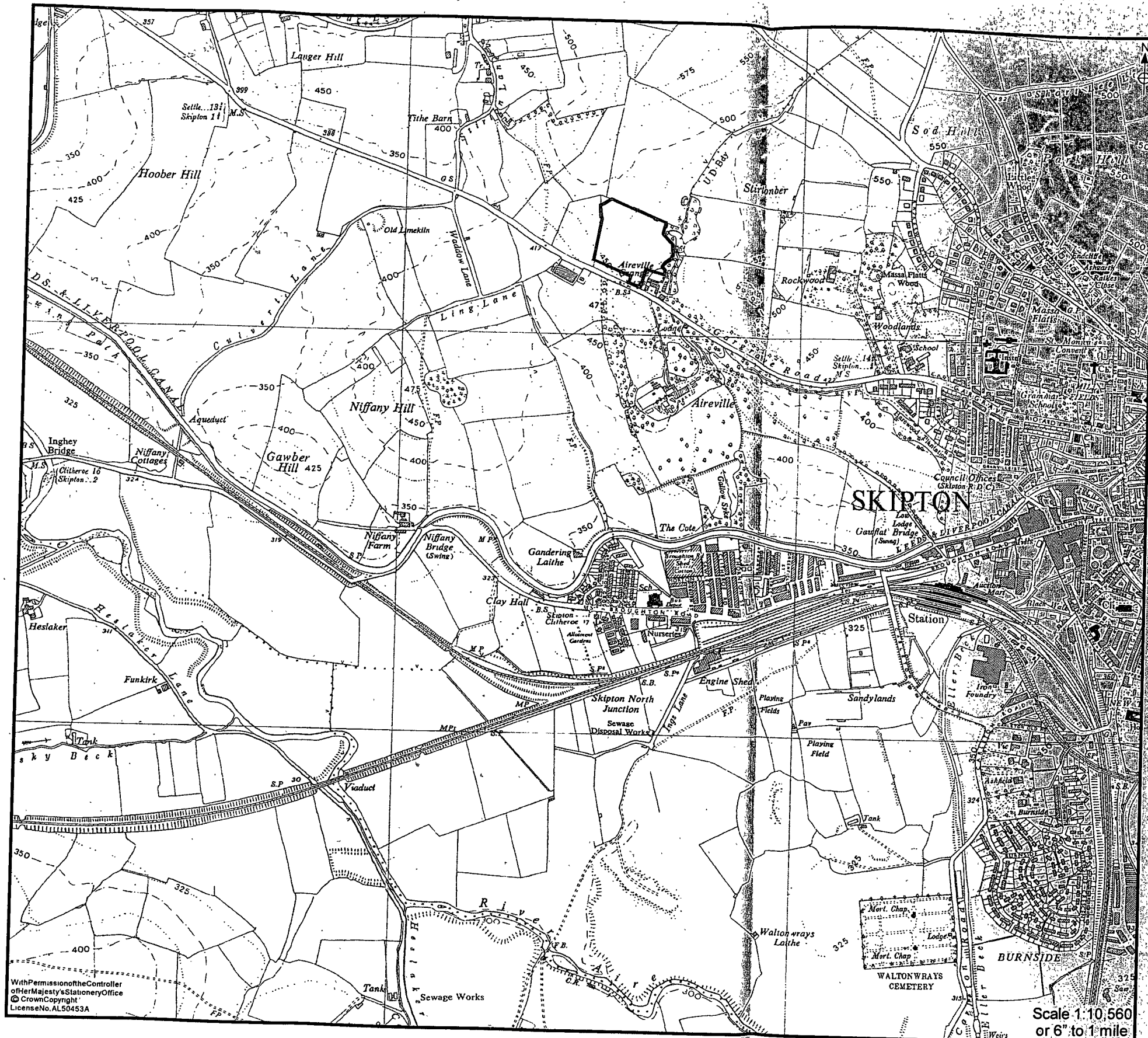

KEY / NOTES

▭ Site Boundary

MAP

Archaeological Consultancy Ltd.

SITE: Gargrave Road, Skipton

CLIENT: Indigo Planning Limited

TITLE: Extract from the 1956 Ordnance Survey Map

Figure 7 Scale: 1:10,560

DRAWING REF.
DRAWN BY: DK **APPROVED BY:** **CHECKED BY:**

REVISIONS:

Scale 1:10,560
 or 6" to 1 mile

With Permission of the Controller
 of Her Majesty's Stationery Office
 © Crown Copyright
 License No. AL50453A

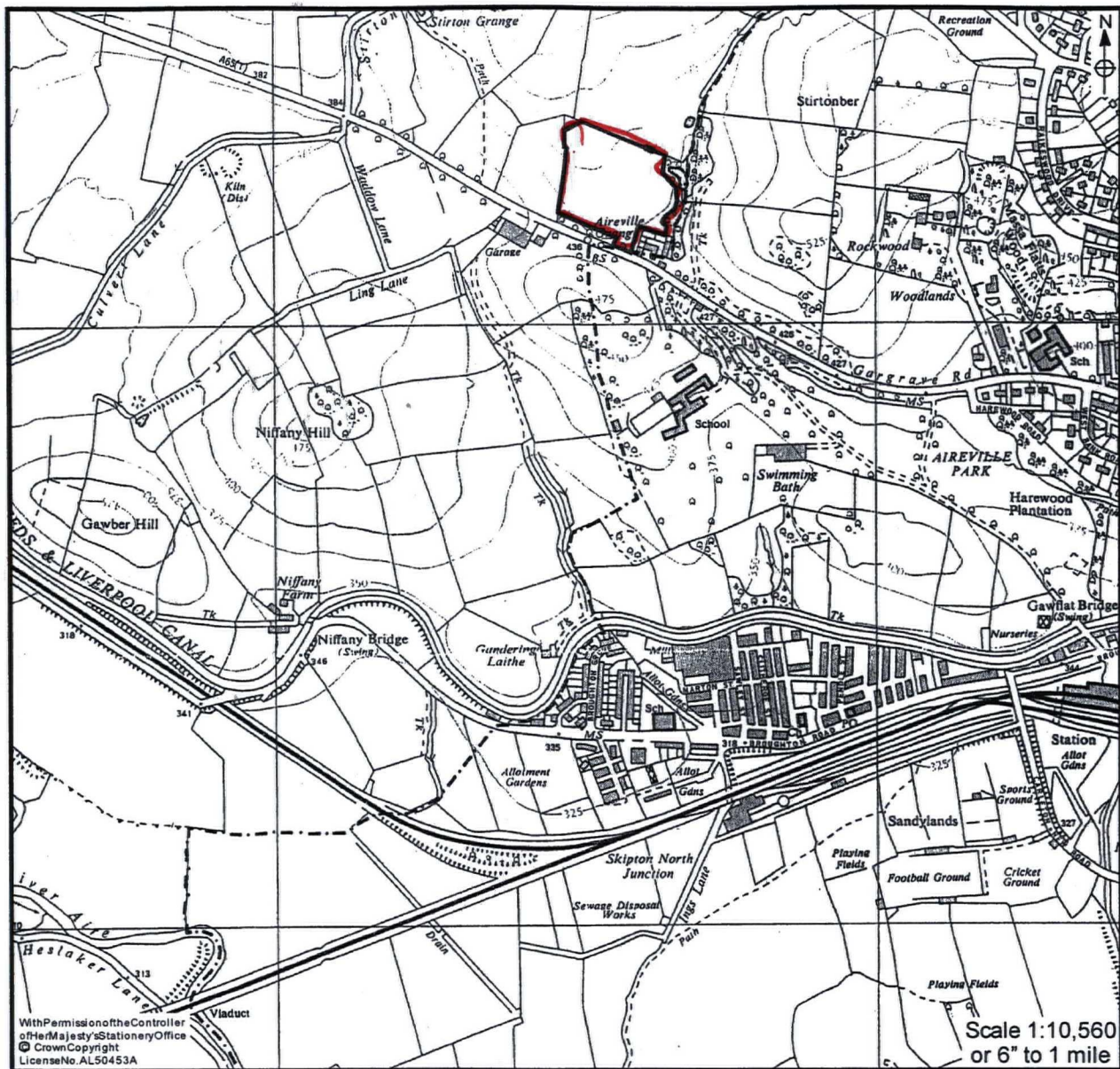

With Permission of the Controller
of Her Majesty's Stationery Office
© Crown Copyright
License No. AL50453A

Scale 1:10,560
or 6" to 1 mile

KEY / NOTES

Site Boundary

MAP

Archaeological Consultancy Ltd.

SITE: Gargrave Road, Skipton

CLIENT: Indigo Planning Limited

TITLE: Extract from the 1970 Ordnance Survey Map

Figure 8

Scale: 1:10,560

DRAWING REF.:

DRAWN BY: DK **APPROVED BY:** **CHECKED BY:**

REVISIONS:

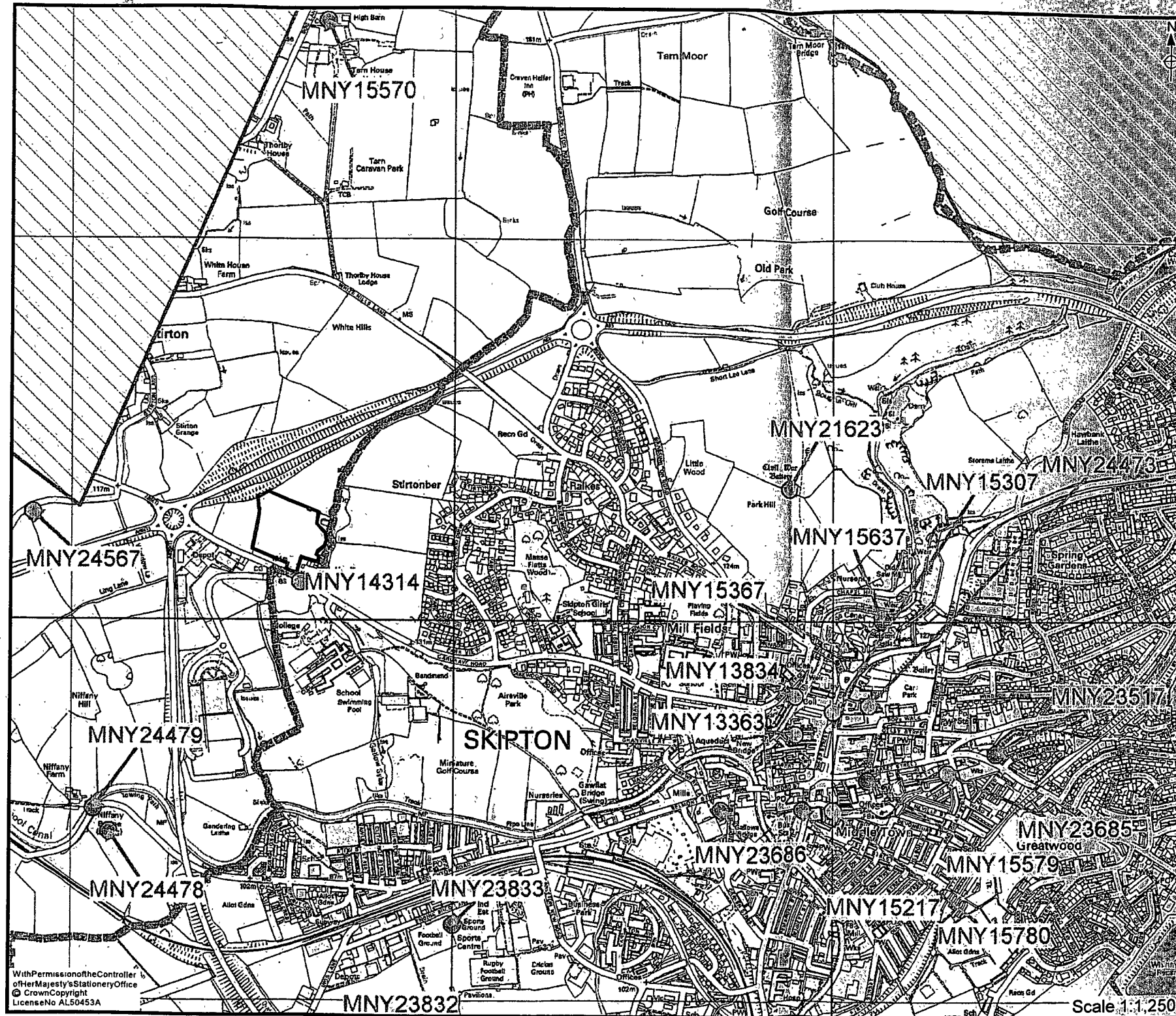

With Permission of the Controller
of Her Majesty's Stationery Office
© Crown Copyright
License No AL50453A

Scale 1:1,250

KEY/NOTES

Site Boundary

MAP

Archaeological Consultancy Ltd.

SITE: Gargrave Road, Skipton

CLIENT: Indigo Planning Limited

TITLE: Site and Monument Record Listings

Figure 9 Scale: 1:12,500

DRAWING REF:

DRAWN BY: DK APPROVED BY: CHECKED BY:

REVISIONS:

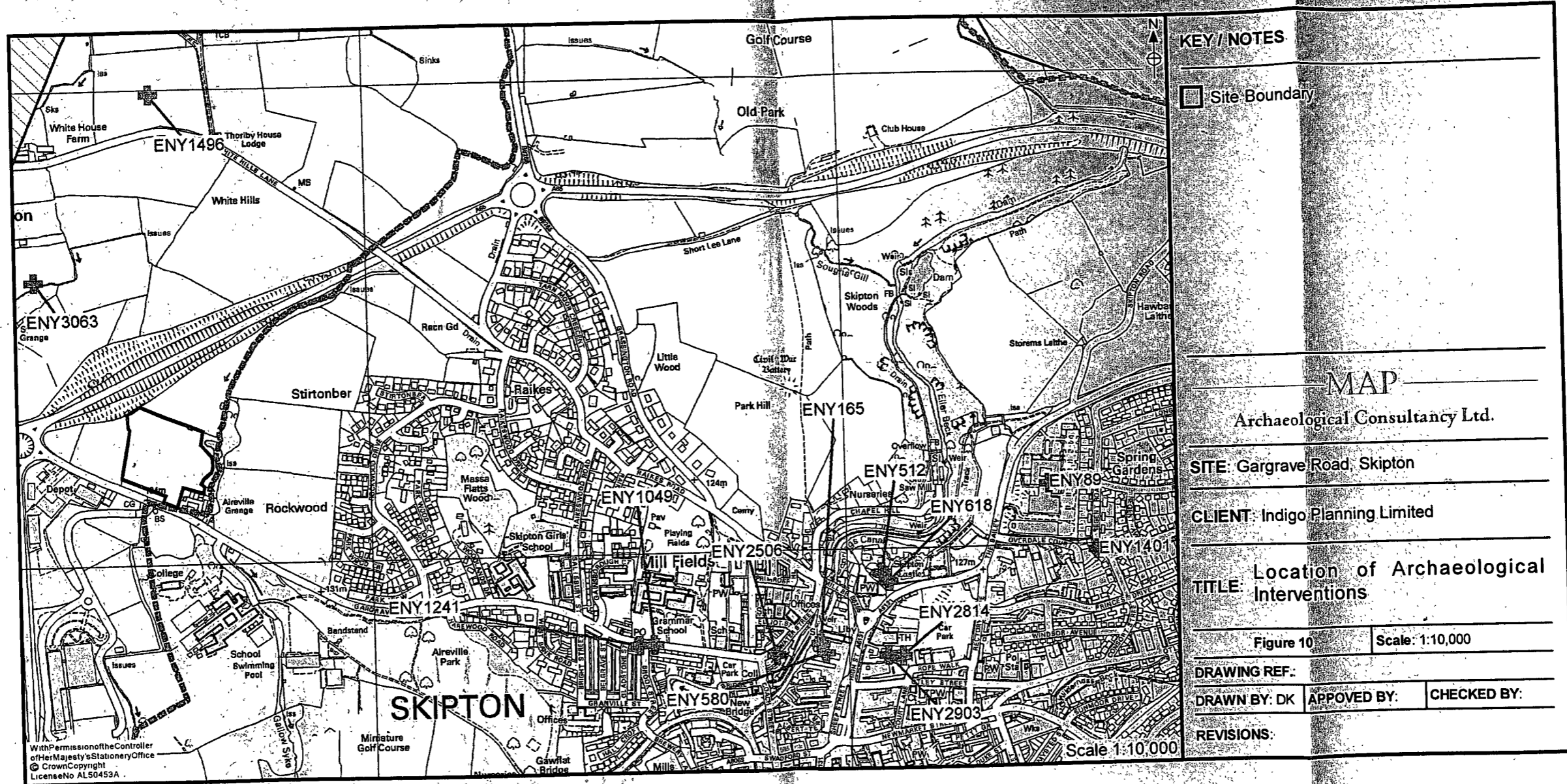

With Permission of the Controller
of Her Majesty's Stationery Office
© Crown Copyright
License No. AL50453A

KEY / NOTES

Site Boundary

MAP

Archaeological Consultancy Ltd.

SITE: Gargrave Road, Skipton

CLIENT: Indigo Planning Limited

TITLE: Location of Archaeological Interventions

Figure 10 Scale: 1:10,000

DRAWING REF.:
DRAWN BY: DK APPROVED BY: CHECKED BY:

REVISIONS:

Scale 1:10,000