

1/092

~~VJF~~
~~NRC~~
~~ECG~~
FILE

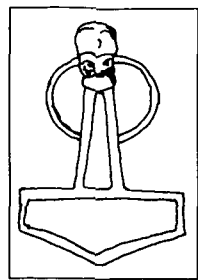

Alison Clarke
Archaeological Consultant

18 Ash Grove, Northallerton, North Yorkshire. DL6 1RQ
Tel 0609 776501 Fax: 0609 779968

RICHMOND MARKET PLACE

ARCHAEOLOGICAL

WATCHING BRIEF

FOR

**NORTH YORKSHIRE COUNTY HIGHWAYS
(RICHMOND DIVISION)**

NYCCHER	
SNY	11934
ENY	4150
CNY	
Parish	1092
Rec'd	?1995

ALISON CLARKE
1995

FEB

PARISH 1092
E 4150
S 11934

RICHMOND MARKET PLACE WATCHING BRIEF: NORTH YORKSHIRE COUNTY COUNCIL HIGHWAYS DEPARTMENT

INTRODUCTION

In February 1995 North Yorkshire County Highways Richmond Division undertook the repaving of an area of footpath in the Market Place Richmond. As archaeological material of some importance, including well preserved medieval deposits, has previously been found under the cobbled surface of the Market Place in Richmond, an archaeological watching brief was required during all ground disturbance work.

WATCHING BRIEF

The area involved was on the south side of the Market Place, from the corner of Millgate on the east to the entrance of the Market Hall on the west, a distance of c. 85 metres of between 1.5 metres and 3 metres in width. Both the flags of the footpath and the kerb stones were removed, and the ground below dug out. A trench for new kerb stones was excavated by hand and machine to a depth of 35cm below the level of the cobbles of the Market Place, and the footpath was similarly excavated to between 23cm and 24cm below the level of the footpath, itself some 15cm above the level of the cobbles.

The kerb stone trench followed for most of its length the same path as a ducted cable which lay 35 to 40 cm below the cobble surface and ran east - west. The fill above and around this was a mixed dirty orange sand and mortary loam. At the westernmost end of the trench a grey/yellow mixed clay was visible at the bottom. No finds were recovered.

The soil removed from the footpath was a similar sand and mortary loam to that in the kerb stone trench. In places it was further disturbed by services, including gas, electricity and BT, which ran across the footpath at depths between 15 and 25 cm. Some areas of disturbed dirty orange clayey soil were observed. Fragments of brick and tile were visible within the soils revealed, and to the east, in front of the bank on the corner of the Market Place, a patch of large stones and broken flags indicating disturbance to a deeper level. Three BT and one electricity access covers within the footpath also caused disturbance to below 25 cm.

CONCLUSIONS

The watching brief revealed no levels of archaeological significance. It seems likely that much of the footpath area of the Market Place is heavily disturbed by modern services to at least the depth reached by the re-flagging process, and in many parts even deeper than that (i.e. below 25cm. beneath the level of the existing footpath). The services are frequently indicated by access covers, and the extent of modern disturbance can be inferred from these to a great extent. It is suggested that further watching briefs on the footpaths in the Market Place are restricted to areas with limited visible disturbance or where works are likely to encroach more than 30 cm below the level of the footpath.

Aileen Clough

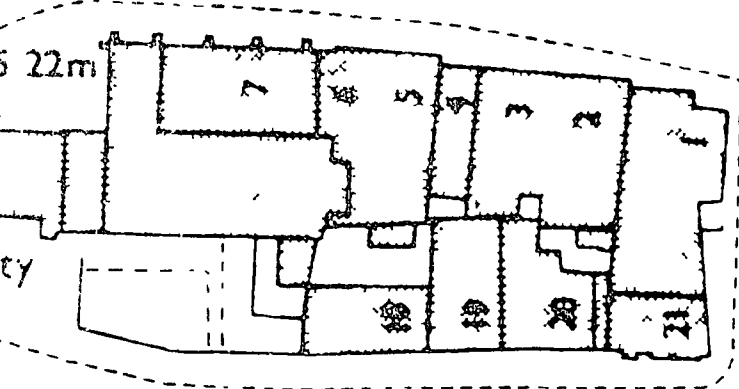

Trinity Church Square 125.9m +

