

MAP

Archaeological Consultancy Ltd.

SITE: Extension to Racing Stables at Musley Bank

CLIENT: R F Racing

TITLE: Site Location.

Figure 1.

Scale: 1:50,000

DRAWING REF.:

DRAWN BY: KCH

REVISIONS:

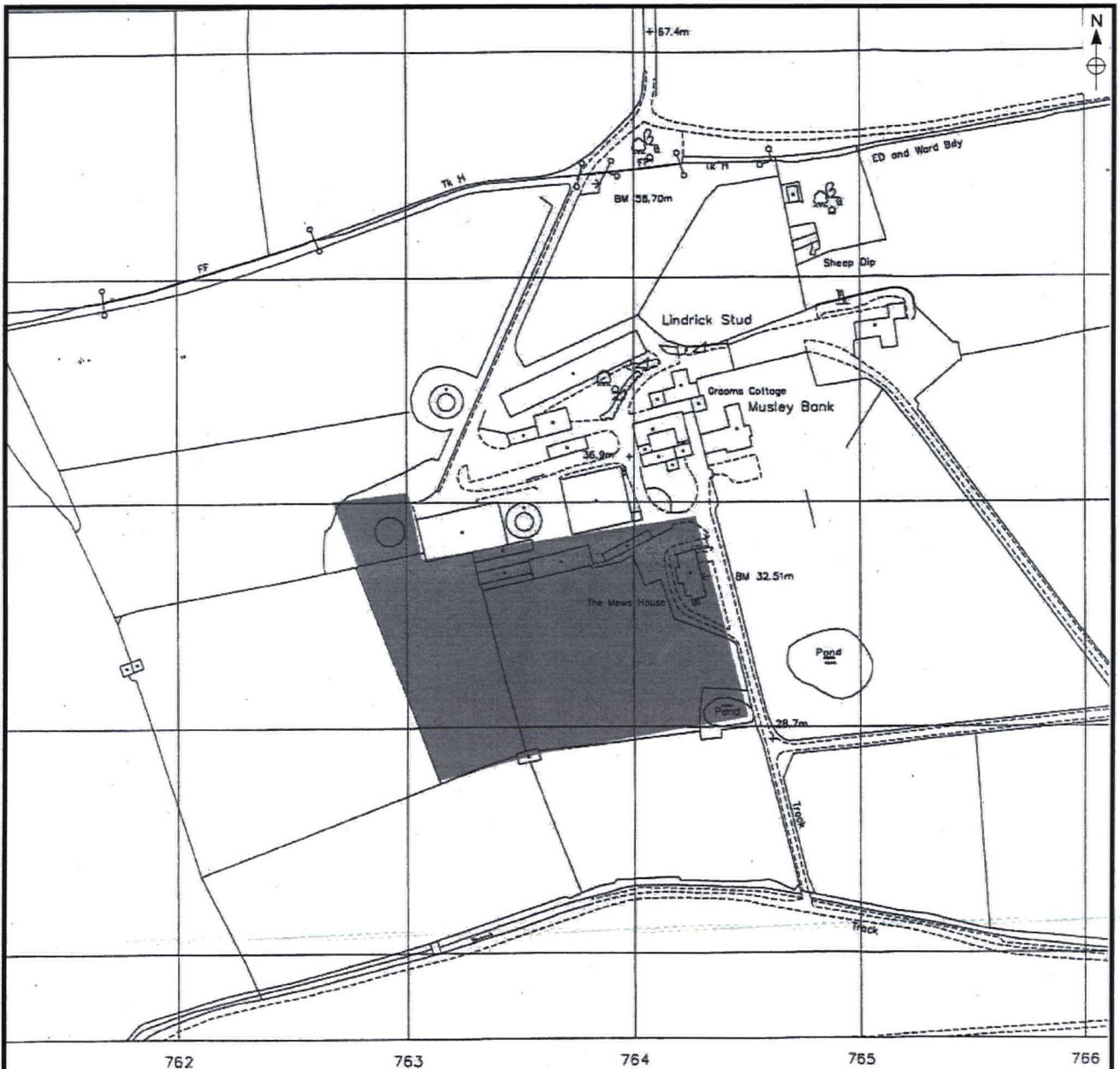

With Permission of the Controller
of Her Majesty's Stationery Office
© Crown Copyright
License No. AL50453A

MAP

Archaeological Consultancy Ltd.

SITE: Extension to Racing Stables at Musley Bank

CLIENT: R F Racing

TITLE: Proposed Development Area.

Figure 2.

Scale: 1:2,500

DRAWING REF.:

DRAWN BY: KCH

REVISIONS:

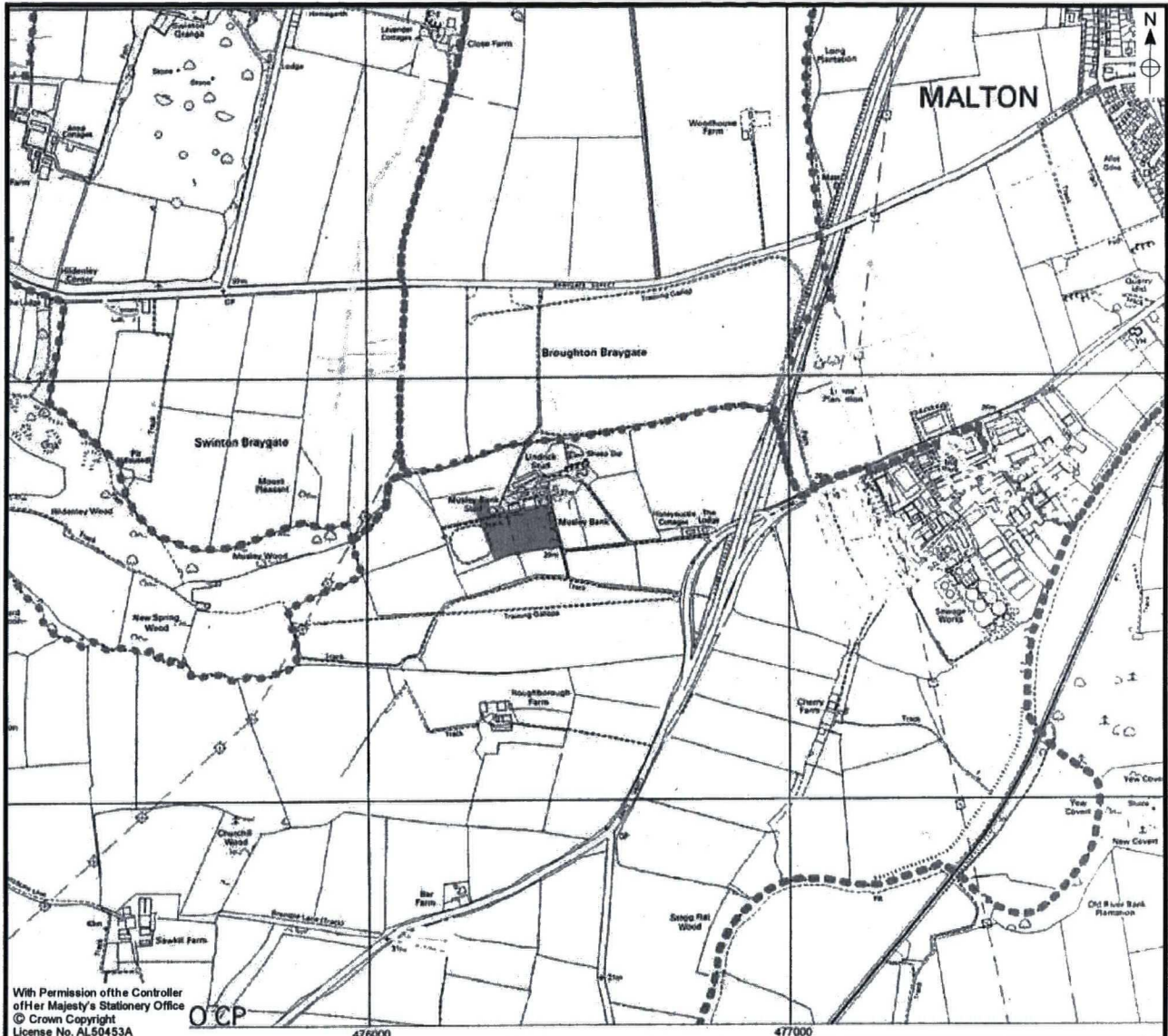

MAP

Archaeological Consultancy Ltd.

SITE: Extension to Racing Stables at Musley Bank

CLIENT: R F Racing

TITLE: Aerial Photographic Cropmarks on the Howardian Hills NMP.

Figure 3.

Scale: 1:15,000

DRAWING REF.:

DRAWN BY: KCH

REVISIONS:

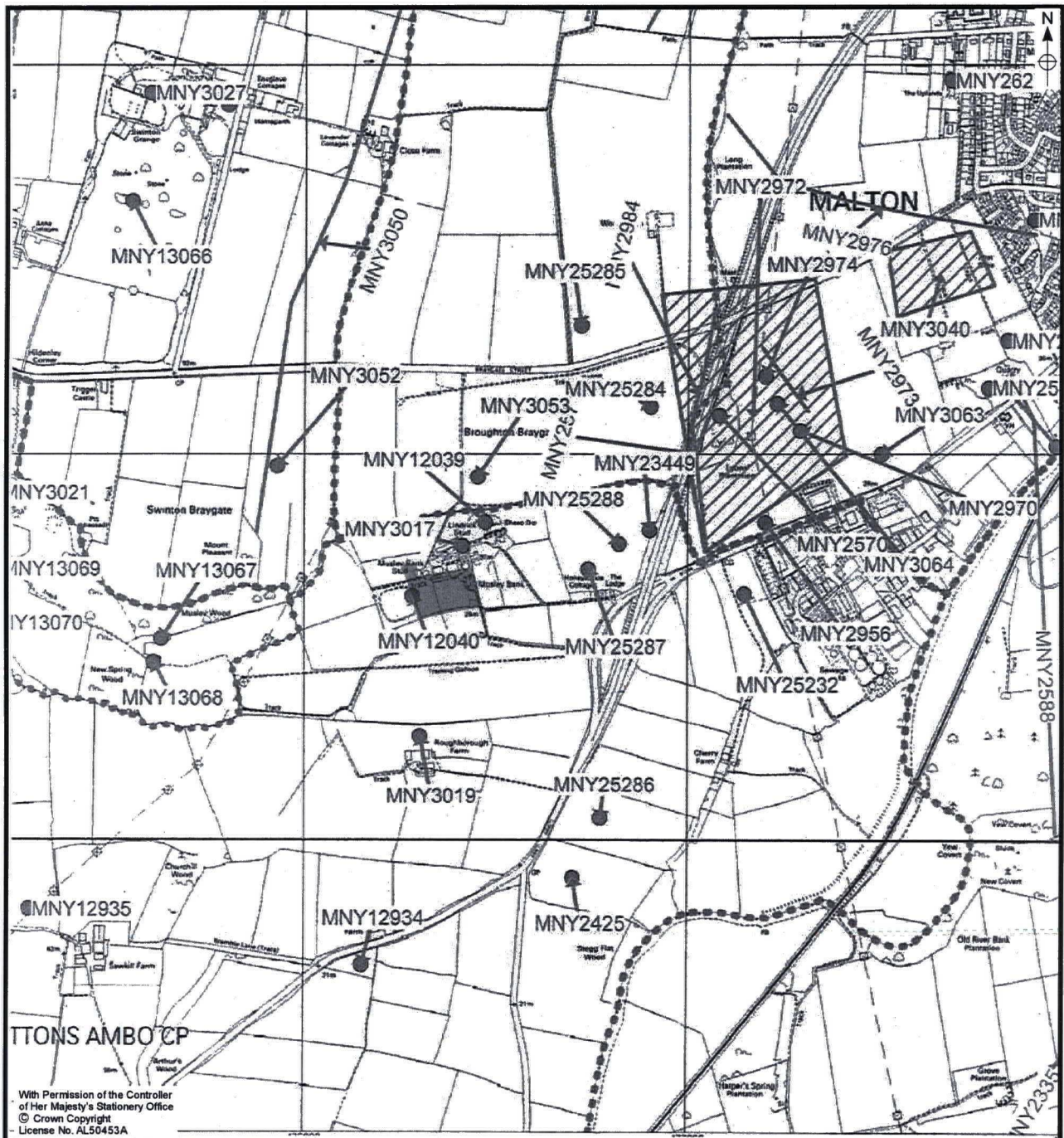

With Permission of the Controller
of Her Majesty's Stationery Office
© Crown Copyright
License No. AL50453A

MAP

Archaeological Consultancy Ltd.

SITE: Extension to Racing Stables at Musley Bank

CLIENT: R F Racing

TITLE: Archaeological Sites on the Historic Environment Record.

Figure 4.

Scale: 1:15,000

DRAWING REF.:

DRAWN BY: KCH

REVISIONS:

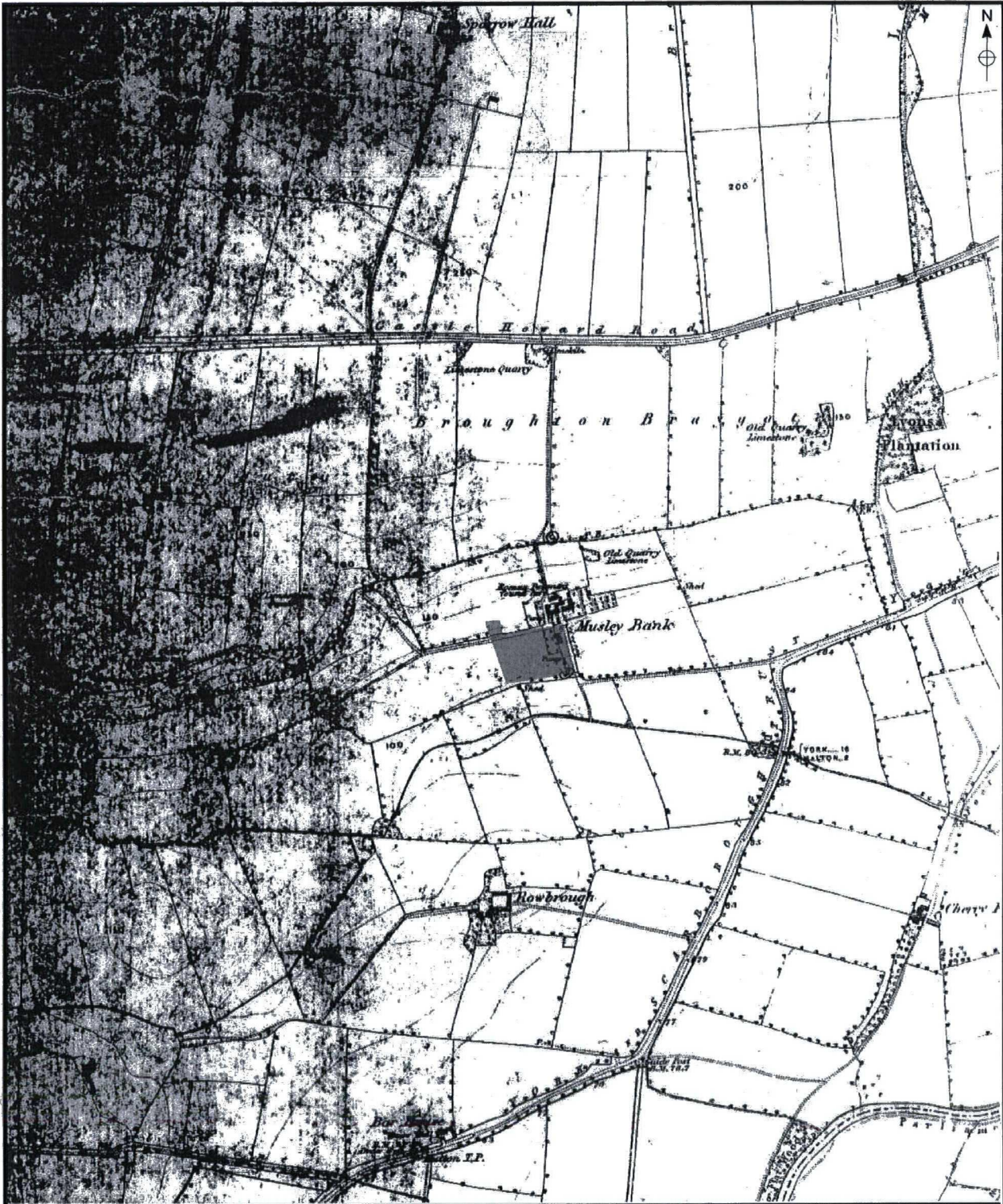

MAP

Archaeological Consultancy Ltd.

SITE: Extension to Racing Stables at Musley Bank

CLIENT: R F Racing

TITLE: Extract from the 1854 First Edition Ordnance Survey Map.

Figure 5.

Scale: 1:10,560

DRAWING REF:

DRAWN BY: KCH

REVISIONS:

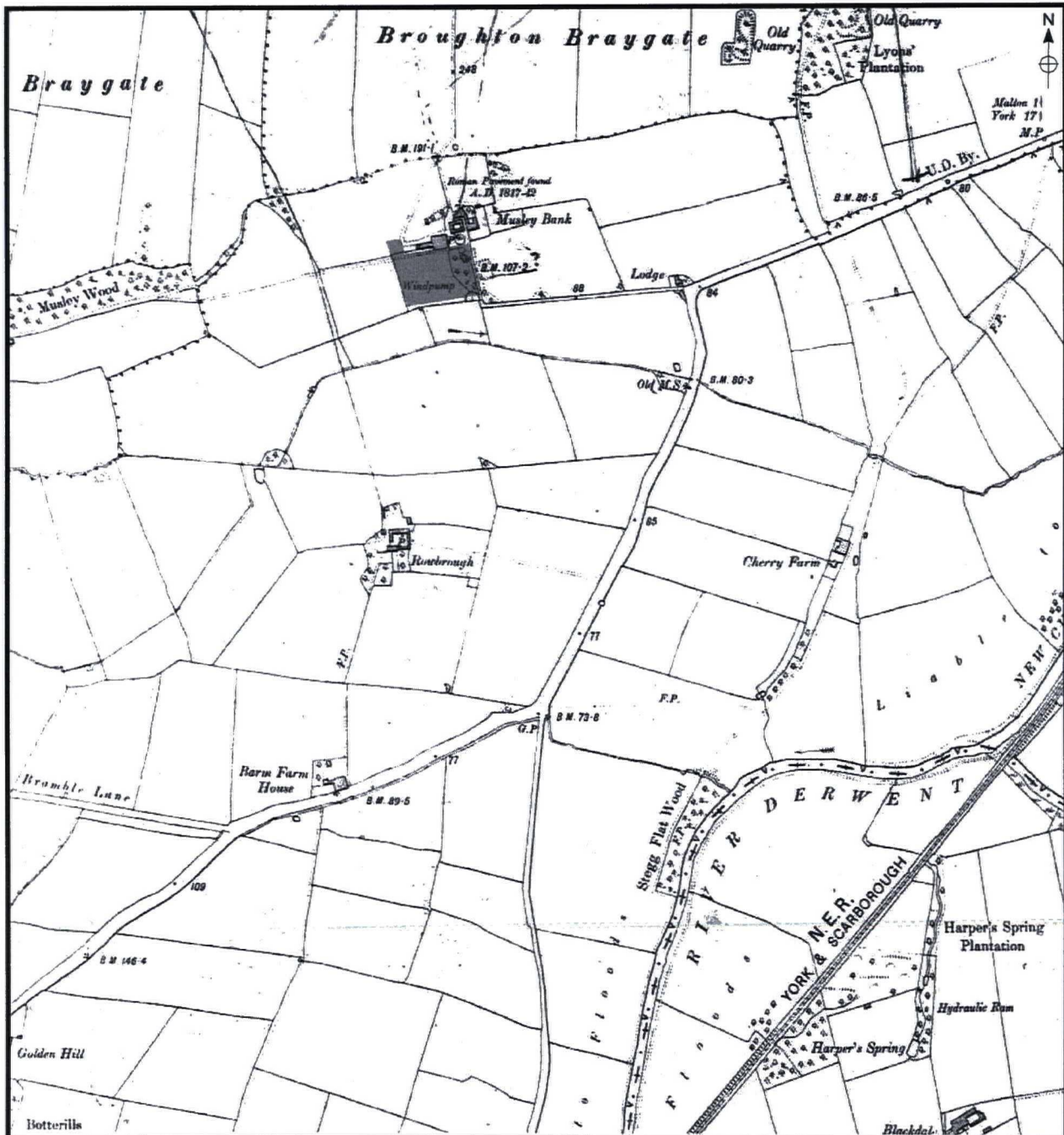

MAP

Archaeological Consultancy Ltd.

SITE: Extension to Racing Stables at Musley Bank

CLIENT: R F Racing

TITLE: Extract from the 1912 Edition Ordnance Survey Map.

Figure 6.

Scale: 1:10,560

DRAWING REF.:

DRAWN BY: KCH

REVISIONS:

Part two of Desk Based Assessment

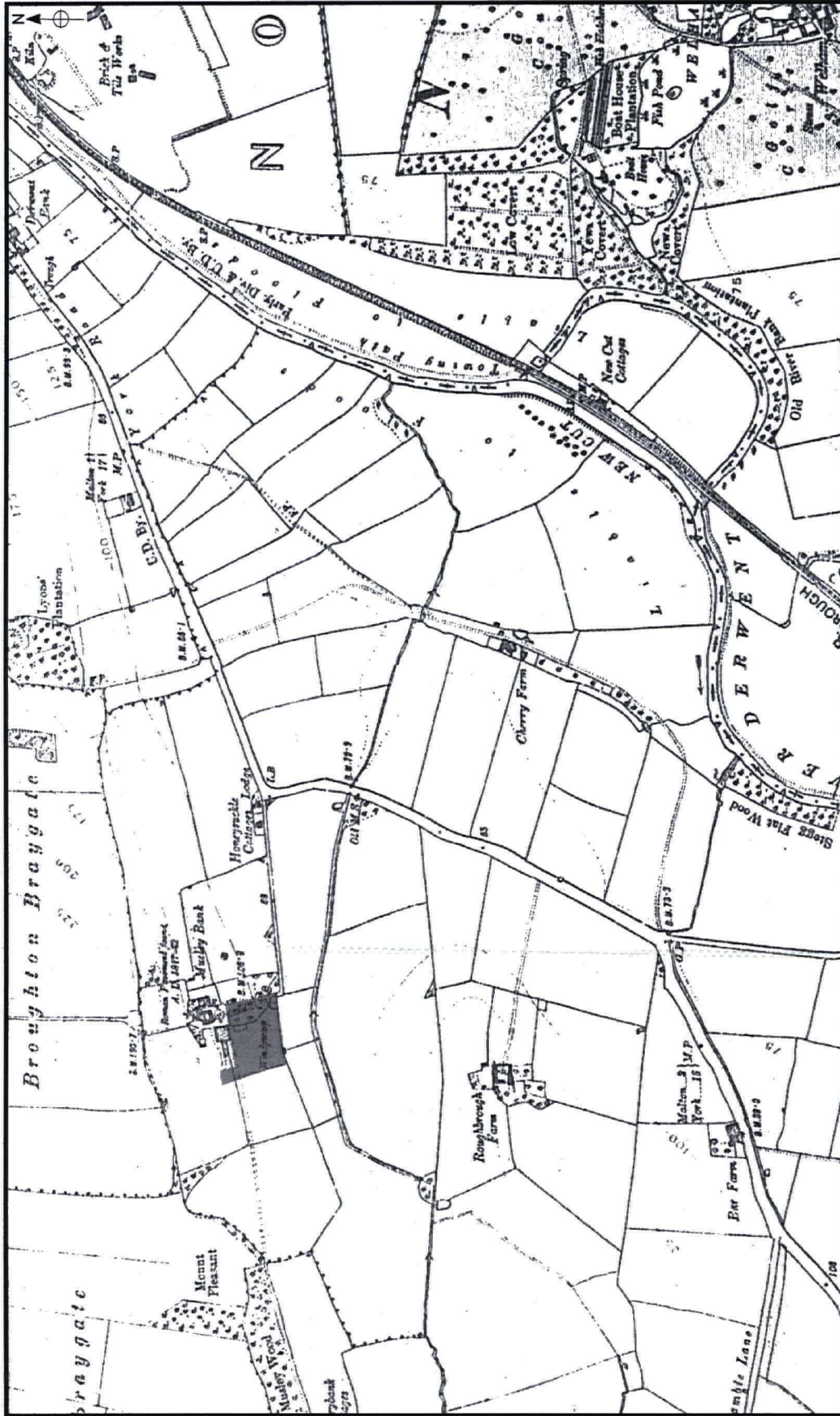

MAP
 Archaeological Consultancy Ltd.
SITE: Extension to Racing Stables at Musley Bank
CLIENT: R F Racing

MAP

Archaeological Consultancy Ltd.

SITE: Extension to Racing Stables at Musley Bank

CLIENT: R F Racing

TITLE: Extract from the 1929 Edition
 Ordnance Survey Map.

Figure 7. Scale: 1:10,560

DRAWING REF:

DRAWN BY: KCH

REVISIONS:

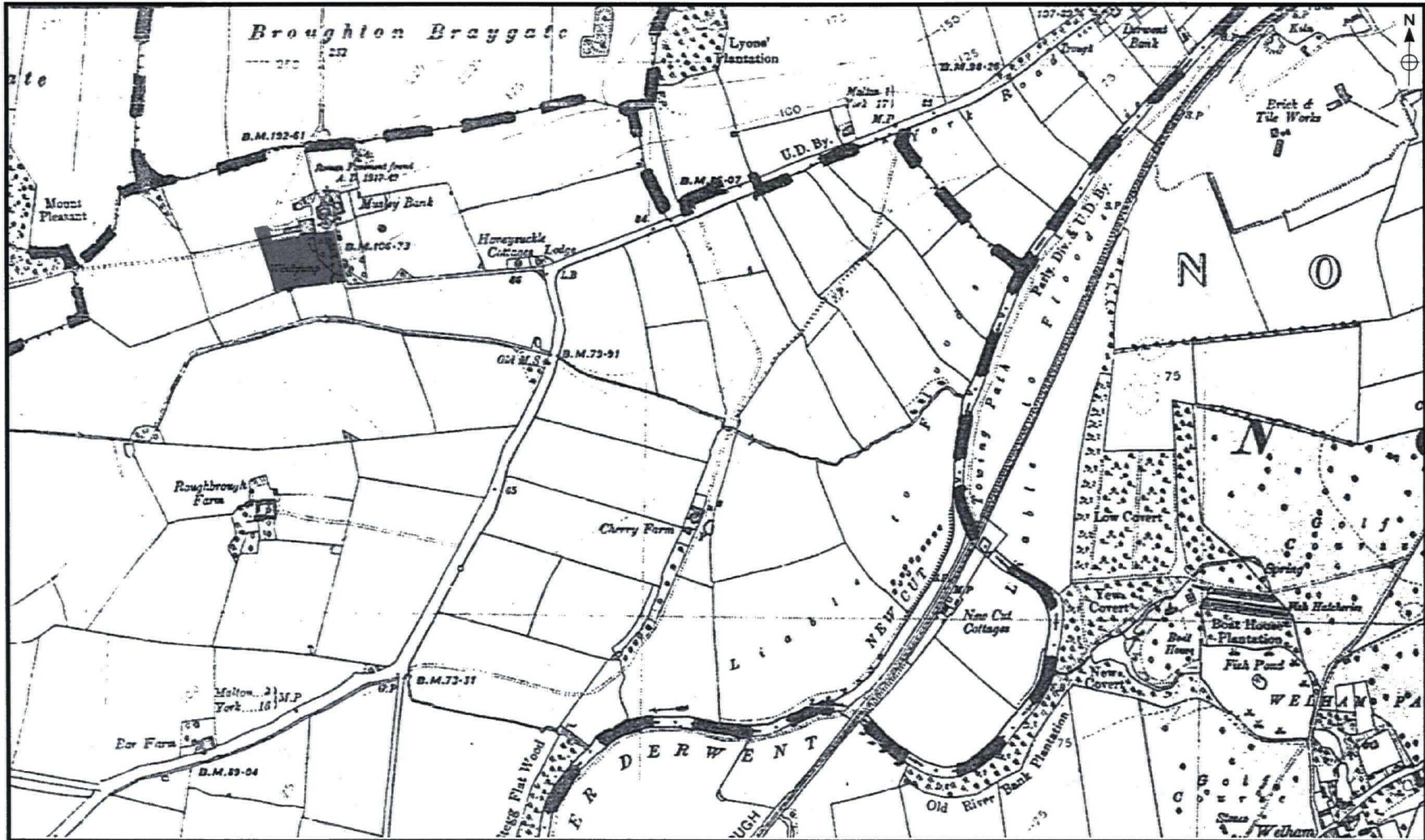

MAP

Archaeological Consultancy Ltd.

SITE: Extension to Racing Stables at Musley Bank

CLIENT: R F Racing

TITLE: Extract from the 1938 Edition Ordnance Survey Map.

Figure 8.

Scale: 1:10,560

DRAWING REF.:

DRAWN BY: KCH

REVISIONS:

**Part three
of Desk
Based
Assessment**

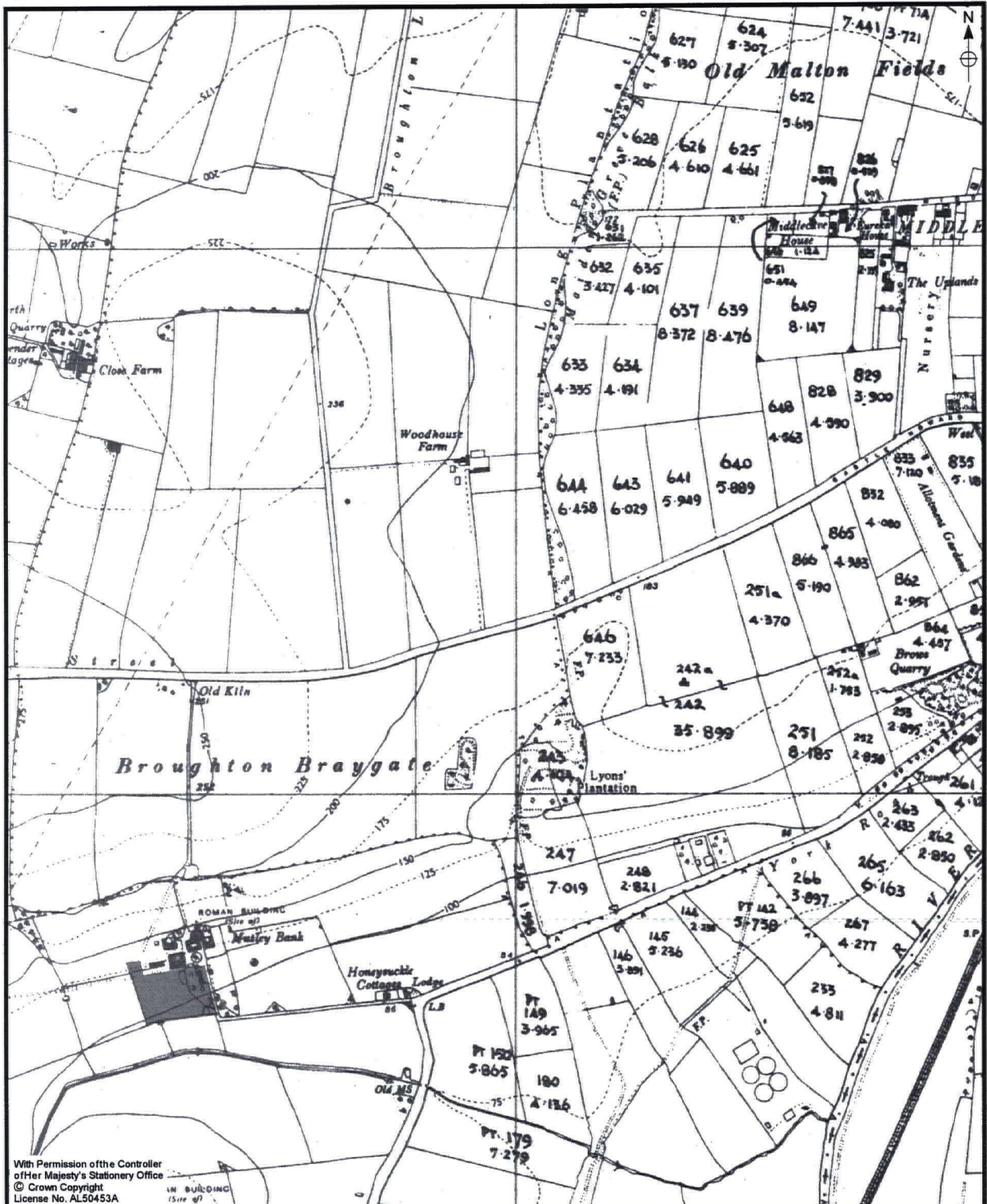

With Permission of the Controller
of Her Majesty's Stationery Office
© Crown Copyright
License No. AL50453A

IN BUILDING
(Site of)

MAP

Archaeological Consultancy Ltd.

SITE: Extension to Racing Stables at Musley Bank

CLIENT: R F Racing

TITLE: Extract from the 1958 Edition
Ordnance Survey Map.

Figure 9.

Scale: 1:10,560

DRAWING REF.:

DRAWN BY: KCH

REVISIONS:

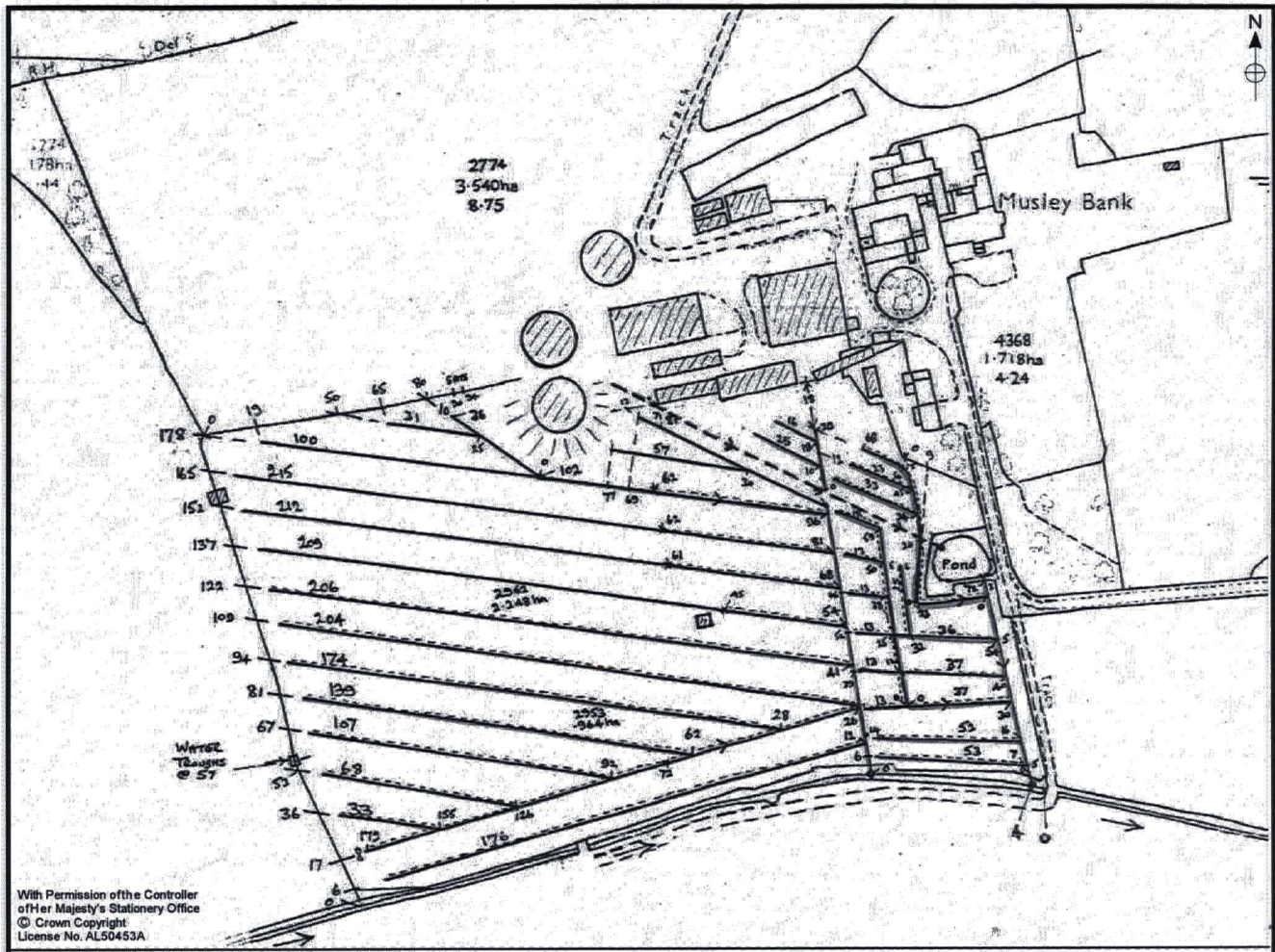

MAP

Archaeological Consultancy Ltd.

SITE: Extension to Racing Stables at Musley Bank

CLIENT: R F Racing

TITLE: Drainage Plan for Fields 2953, 21962 and 4156 (January 2005)..

Figure 10. Scale: 1:2,500

DRAWING REF.:

DRAWN BY: KCH

REVISIONS: