

Alison Clarke

Archaeological Consultant

18 Ash Grove, Northallerton, North Yorkshire. DL6 1RQ
Tel: 0609 776501 Fax: 0609 779968

ON

PARISH 1018 ARCH
E4909
S15192

NYCC HER	
SNY	15192
ENY	4909
CNY	
Parish	1018
Rec'd	?/1993

DALTON HEIGHTS,

DALTON, RICHMOND

ARCHAEOLOGICAL WATCHING BRIEF

ALISON CLARKE

AUG 1993

DALTON HEIGHTS WATCHING BRIEF

BACKGROUND

Randall Orchard Construction obtained permission to convert a group of barns and outbuildings at Dalton Hall, Dalton, near Richmond, into dwellings (see plan 1). The site is known to be in the vicinity of a deserted medieval village, and permission was therefore granted on condition that an archaeologist be present while all ground disturbance work was carried out.

THE WATCHING BRIEF

On 23 July 1993, two trenches across the former farmyard were dug, initially by hand, and the footings of a small retaining wall close to the west range were also tested (see plan 2). These were observed for evidence of archaeological material.

The farmyard which, according to A. Gillman of Randall Orchard, had previously been full of rubbish, had already been cleared and levelled. No former ground surface (eg. cobbles) had been noted. Trial holes along the line of the proposed trenches were hand dug to a depth of c. 40 cm and exposed between 10 and 30 cm of disturbed soil over solid bedrock.

Along the line of one of the trenches (see plan 2) a modern plastic pipe was revealed running along the same alignment as the trench (north-east to south-west). There was also evidence of modern disturbance in the other trench. In view of this, the remainder of the two trenches was removed by machine which excavated to a depth of approximately 40 cm and a width between 80 and 90 cm.

Approximately 7m from the north east end of the first trench a line of large stones appeared to have run across the trench, possibly the footings of the internal wall marked on the OS 1:2500 map (see plan 1). The bowl of a clay pipe was recovered from this area. At the south-eastern end of the other trench more piping and some blue plastic sheeting was revealed at the bottom of the trench.

CONCLUSIONS

The area of the courtyard had already been cleared from an unknown height, and it was apparent that recent disturbances, prior to the current development, below the existing ground level have effectively destroyed any archaeology there might have been there. The survival of medieval levels within the area of the farmyard would seem to be less than likely in any case.

DALTON HEIGHTS PLAN 1

ON

LOCATION PLAN

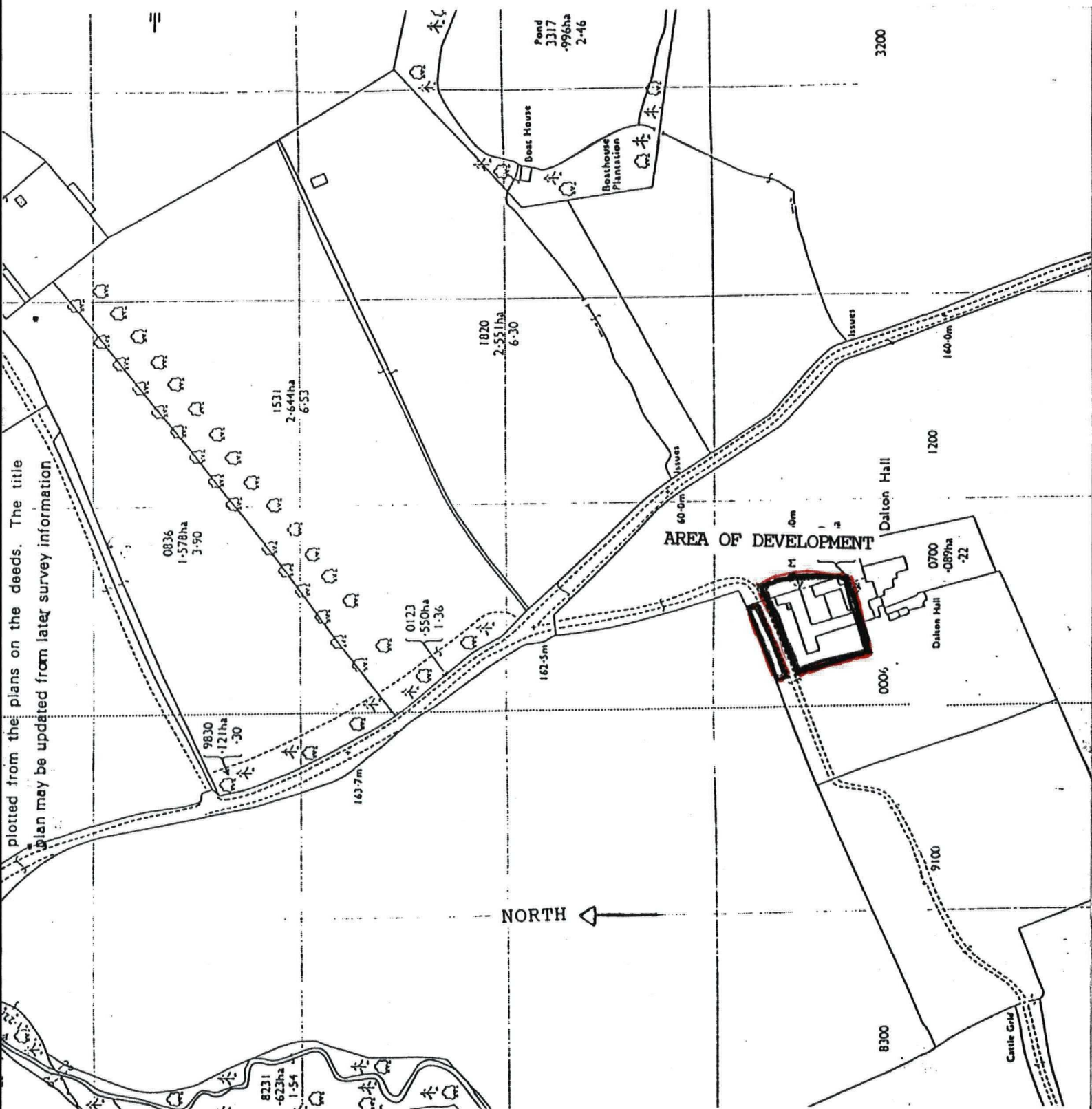

SCALE 1:200

SCALE 1:2500

NORTH

ON

