

1/15/125E/PA/0

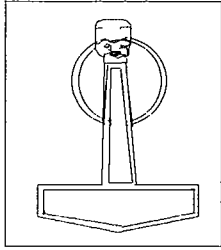

Alison Clarke M.A.
Archaeological Consultant

18 Ash Grove, Northallerton, North Yorkshire, DL6 1RQ
Tel 01609 776501/0860 506062 Fax 01609 779968

NYCC HER	
SNY	15816
ENY	6522
CNY	
Parish	1015
Rec'd	71997

ARCHAEOLOGICAL WATCHING BRIEF

AT

THE YARD, HIGH GREEN,

CATTERICK VILLAGE,

NORTH YORKSHIRE

ALISON CLARKE

MARCH 1997

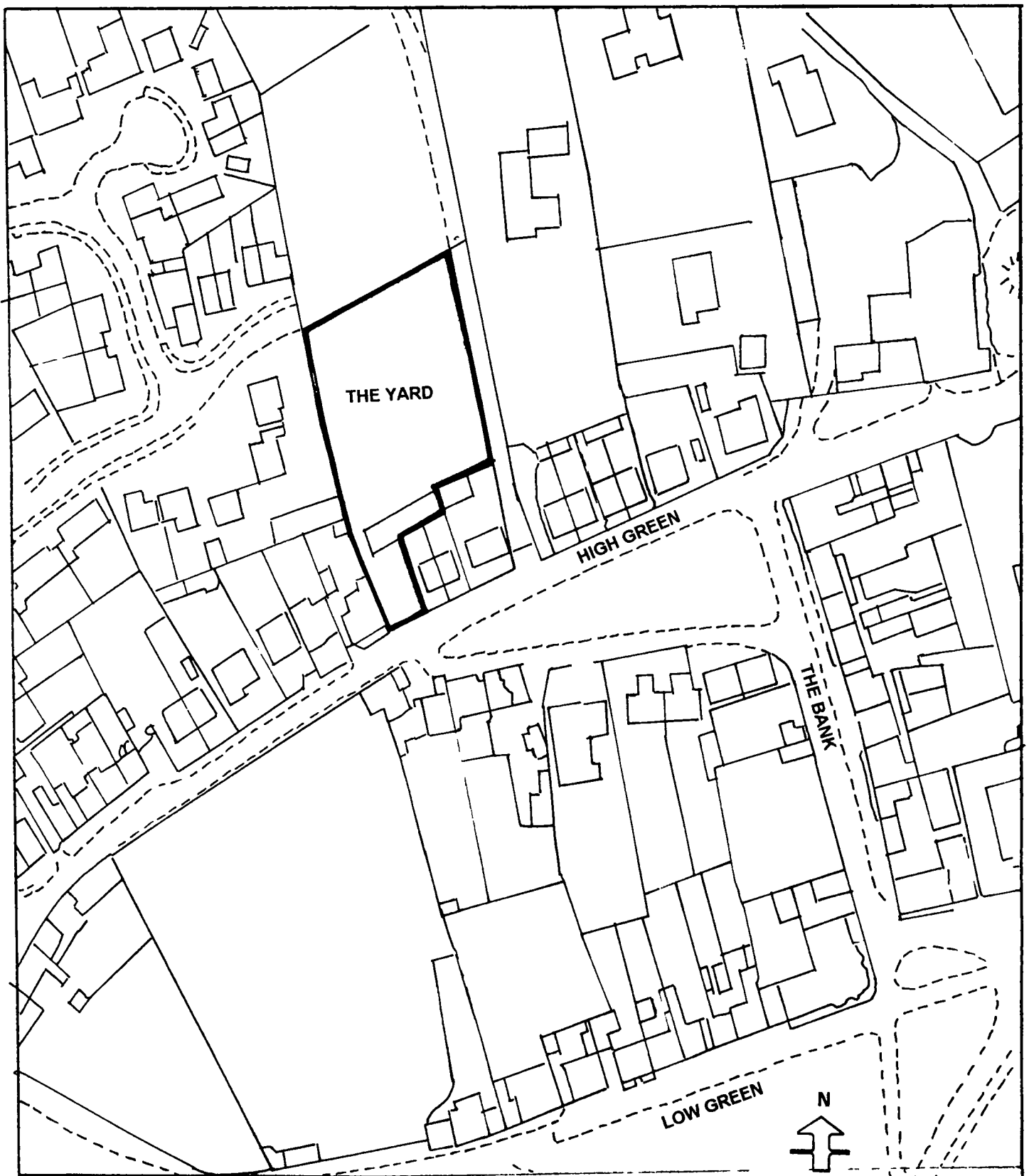

THE YARD, HIGH GREEN, CATTERICK

PLAN ONE

SITE LOCATION

SCALE 1 1250

ARCHAEOLOGICAL WATCHING BRIEF AT THE YARD, HIGH GREEN, CATTERICK VILLAGE

INTRODUCTION

A planning application to build two new houses at the rear of existing buildings on The Yard, High Green, Catterick carried a condition to conduct an archaeological watching brief on all ground disturbance work. This was imposed because of the high potential for archaeological remains in the medieval village of Catterick, with the possibility of pre-medieval remains associated with known archaeological sites to the north of the village.

The site is towards the western end of High Green (Plan One), on land which slopes gradually to the south, and is to the west of and above the medieval church. It has previously been used as a depot, and various buildings including a diesel tank were removed prior to the watching brief. An existing stone barn on the south of the site, behind dwellings fronting onto the Green, is to be retained and converted.

The site (Plan Two) is bounded to the north and east by a hedge and wire fence which is situated on a bank up to 60 cm above the existing ground surface. To the southwest, the ground levels are lower outside the plot than within, but they rise gradually to the north. The site therefore has the appearance of a terrace within the gently falling ground.

THE WATCHING BRIEF

The watching brief took place over four days between 10 and 18 February 1997. The foundations for the two houses were machine excavated, as were various service and drainage trenches. Plot 1 was situated in the north-west corner of the site and Plot 2 on the eastern side (Plan Two). The machine cut trenches were between 86 and 56 cm wide, and varied in depth between 42 and 80 cm.

The stratigraphy over the site was fairly consistent, with the exception of occasional modern disturbances. Surface layers consisted of disturbed dark grey-brown sandy loams with varying degrees of gravel, cobble, brick, sandstone fragments, lime mortar and modern demolition rubbish. The variable thickness of these deposits, from 8 cm to 58 cm, depended in part on the extent to which the ground had been cleared prior to development. Near to the north boundary bank was a dark brown sandy loam topsoil associated with the bank.

Beneath the disturbed layers was a medium brown sandy clayey loam, containing cobbles, sandstone fragments and occasional charcoal flecks. Occasional animal bone fragments were recovered, together with one fragment of twelfth century pottery. This layer was between 8 cm and 53 cm thick, generally thicker towards the south of the site, and had the appearance of a buried ploughsoil, possibly of medieval origin.

In the northern part of the access road in the south-west corner of the site, service and drainage trenches revealed a dark brown sandy loam with pebbles and brick fragments beneath the tarmac which had the appearance of a garden soil. Further to the south, alongside the barn, a light grey-brown rubble containing sand, brick, mortar, gravel and tile, also contained some recently broken late medieval pottery. This layer is probably associated with a building phase of the barn (which has been extensively altered), into which the medieval pottery has been deposited possibly from elsewhere on the site.

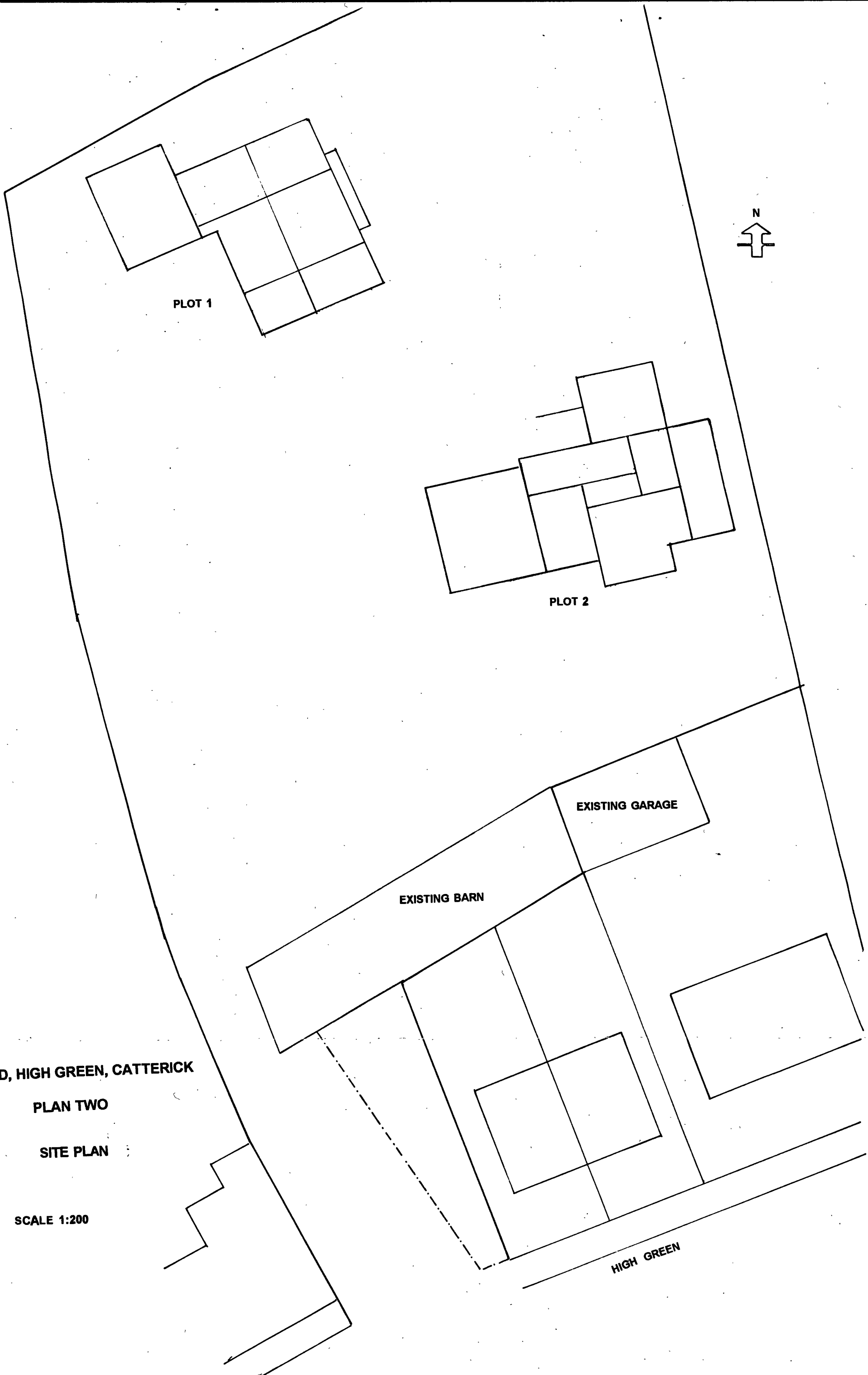

PLOT 1

PLOT 2

EXISTING GARAGE

EXISTING BARN

THE YARD, HIGH GREEN, CATTERICK

PLAN TWO

SITE PLAN

SCALE 1:200

HIGH GREEN

The natural subsoil throughout the site was a medium brown loamy sand with pebbles and cobbles. It was encountered towards or at the base of most of the trenches, and overall rose gradually to the north and west of the site.

CONCLUSIONS

The watching brief did not encounter any features of archaeological significance. The few finds of medieval date do suggest that the area was in use in the medieval period, and the buried ploughsoil suggests an agricultural use. The terracing effect noted in the existing ground surfaces appears to originate in this buried soil, with natural ground levels falling steadily and gradually to the south and east, and a greater build up of ploughsoil in this direction resulting in a relatively level surface.



TERICK
WATCHING BRIEF
'97

AERIAL SHOT OF SITE
2 TO GROUNDWORKS
ING SOUTH WEST.

CATTERICK
WATCHING BRIEF
02/97
PLOT 1. FACING NORTH WEST.

HIGH GREEN
TERICK
WATCHING BRIEF
'97.

AERIAL SHOT OF SITE
2 TO GROUNDWORKS.
ING NORTH.

HIGH GREEN
CATTERICK.
WATCHING BRIEF
02/97
PLOT N°2. FACING SOUTH WEST.

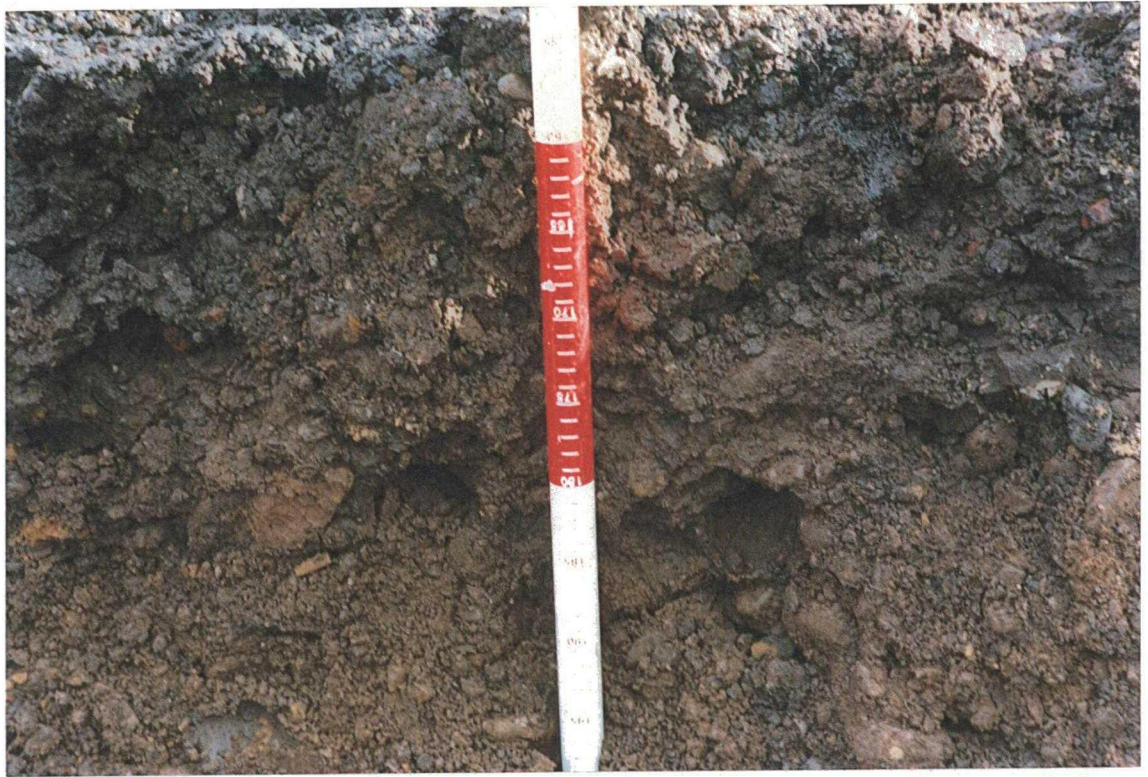

HIGH GREEN
CATTERICK
WATCHING BRIEF
02/97
PLOT N° 2. TRENCH N° 10

HIGH GREEN
CATTERICK
WATCHING BRIEF
02/97
PLOT 1. FACING SOUTH EAST.