

With Permission of the Controller
of Her Majesty's Stationery Office
© Crown Copyright
License No. AL50453A

MAP

Archaeological Consultancy Ltd.

SITE: Village Farm, Back Street, Aldborough

CLIENT: James Tancred

TITLE: Site Location.

Figure 1.

Scale: 1:25,000

DRAWING REF.:

DRAWN BY: KCH

REVISIONS:

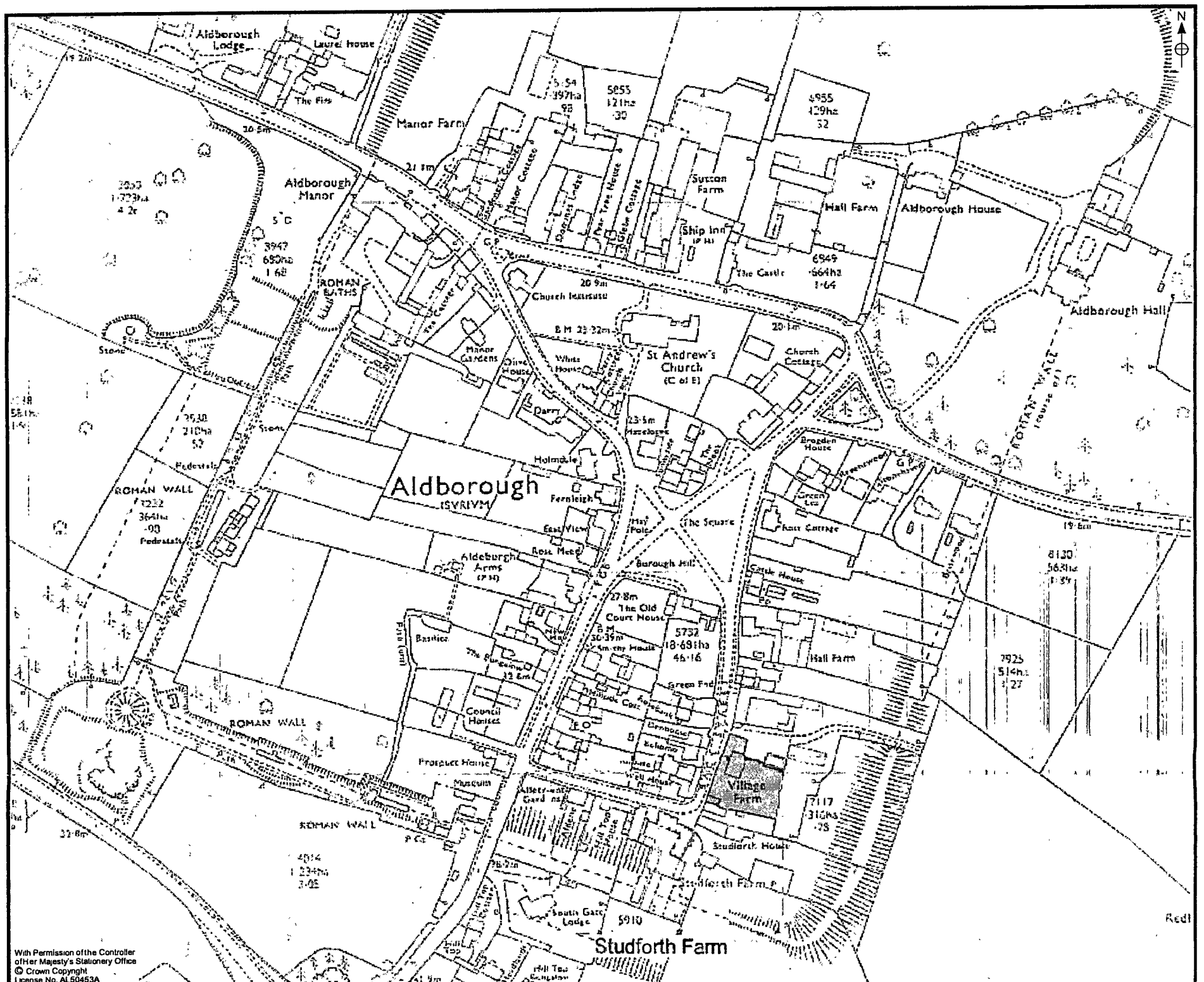

With Permission of the Controller
of Her Majesty's Stationery Office
© Crown Copyright
License No. AL50453A

MAP

Archaeological Consultancy Ltd.

SITE: Village Farm, Back Street, Aldborough

CLIENT: James Tancred

TITLE: Proposed Development Area.

Figure 2.

Scale: 1:2,500

DRAWING REF.:

DRAWN BY: KCH

REVISIONS:



With Permission of the Controller
of Her Majesty's Stationery Office
© Crown Copyright
License No. AL50453A

MAP

Archaeological Consultancy Ltd.

SITE Village Farm, Back Street, Aldborough

CLIENT James Tancred

TITLE Extract from the 1853 First Edition
Ordnance Survey Map..

Figure 3.

Scale 1:10,560

DRAWING REF

DRAWN BY KCH

REVISIONS



PROPOSED GROUND PLAN

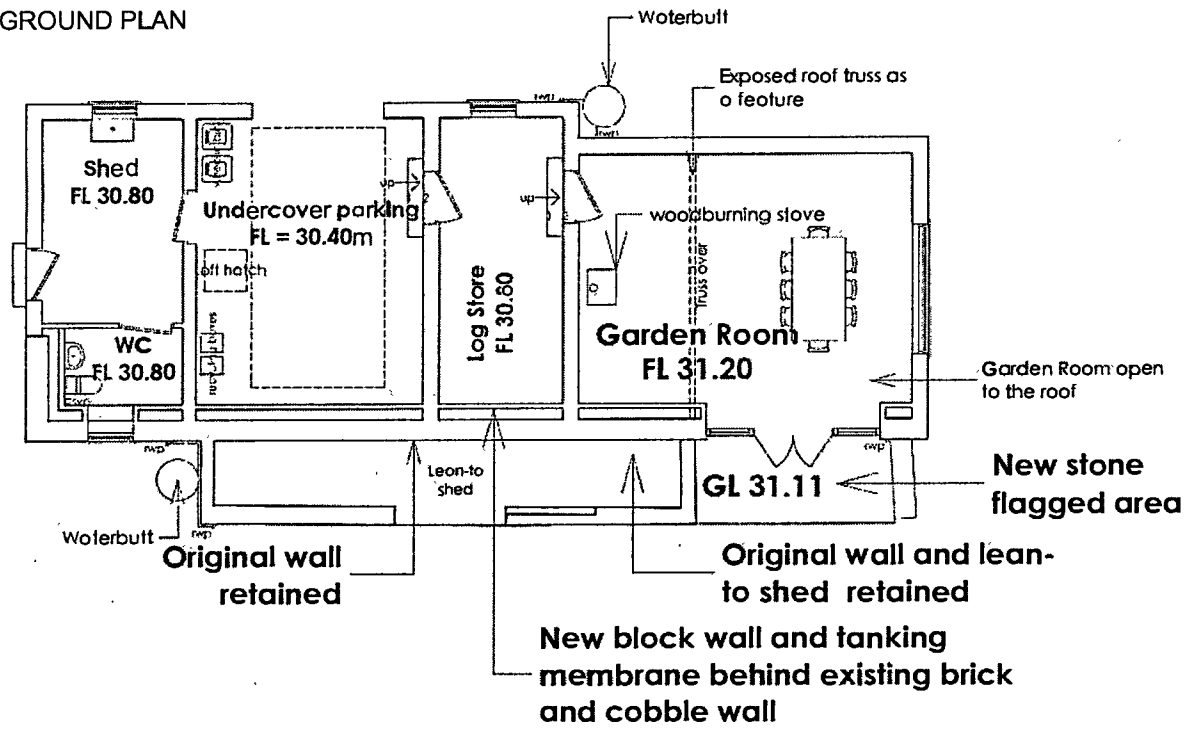

MAP
 Archaeological Consultancy Ltd.
 SITE: Village Farm, Back Street, Aldborough
 CLIENT: James Tancred

TITLE: Proposed Development.

Figure 4. Not to Scale
 DRAWING REF.:
 DRAWN BY: KCH
 REVISIONS:



Plate 1. Entrance to Village Farm. Facing West.



Plate 2. Village Farm. Facing South.



Plate 3. Outbuildings at Village Farm. Facing East.

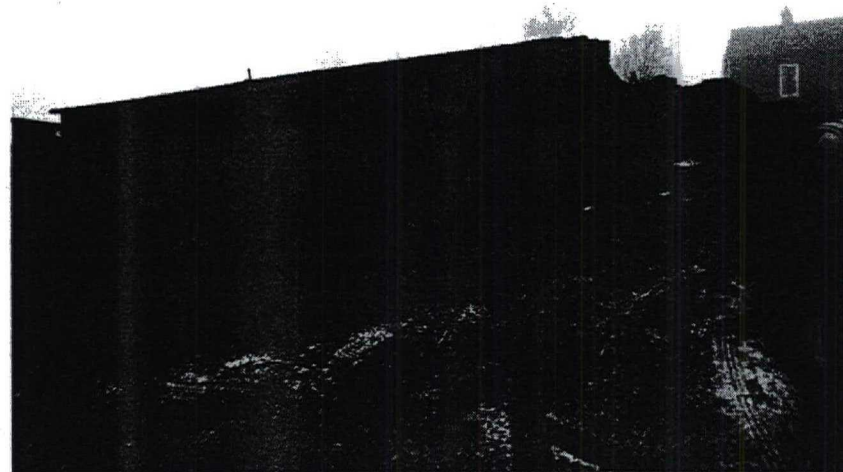

Plate 4. Outbuildings at Village Farm. Facing South-east.