

**Potgate Quarry
North Stainley
Ripon
North Yorkshire**

**Desk Based Assessment
Proposed Quarry Extension
SE 2740 7640**

Authorised by

Date:.....

© MAP Archaeological Consultancy Ltd.

February 2010

**Potgate Quarry
North Stainley
Ripon
North Yorkshire**

**Desk Based Assessment
Proposed Quarry Extension
SE 2740 7640**

Contents	Page
Figure List	2
Plate List	2
Non Technical Summary	3
1. Introduction	3
2. Site Description	4
3. Planning Background	4
4. Aims and Objectives	5
5. Methodology	5
6. Results	5
7. Impact of the Development	15
8. Conclusions and Recommendations	17
9. References and Bibliography	18
10. List of Contributors	19

Figure List	Page
1. Site Location. Scale 1:25,000.	20
2. Proposed Extension Area to Potgate Quarry . Scale 1:10,000.	21
3. Archaeological Sites on the North Yorkshire HER. Scale 1:10,000.	22
4. Listed Buildings on the North Yorkshire HER. Scale 1:4,600.	23
5. Extract from the 1856 First Edition Ordnance Survey Map. Scale 1:10560.	24
8. Extract from the 1894 Edition Ordnance Survey Map. Scale 1:10,560.	25
9. Extract from the 1910 Edition Ordnance Survey Map. Scale 1:10,560.	26
10. Extract from the 1910 Edition Ordnance Survey Map. Scale 1:10,560.	27

Plate List

1. General View towards Potgate Quarry. Facing East.	28
2. General View towards Potgate Quarry. Facing East.	28
3. General View towards Potgate Quarry. Facing East.	29
4. View of Musterfield Lane. Facing South.	29
5. View of Boundary Stone. Facing South.	30
6. View of Proposed Quarry Extension. Facing East.	30
7. View of Proposed Quarry Extension. Facing South.	31
8. View of Proposed Quarry Extension. Facing West.	31

**Potgate Quarry
North Stainley
Ripon
North Yorkshire**

**Desk Based Assessment
Proposed Quarry Extension
SE 2740 7640**

Non Technical Summary

This report has been prepared by MAP Archaeological Consultancy Limited under instruction from David L. Walker Limited acting on behalf of Lightwater Quarries Limited, to assess the Historical and Archaeological background and the impact of the proposed Quarry Extension at Potgate Quarry.

The Site of the Proposed Extension Area to Potgate Quarry is currently part of an arable field.

There are no Scheduled Ancient Monuments, Registered Park and Gardens, Registered Battlefields, Listed Buildings or any known sites on the North Yorkshire Historic Environment Record within the Proposed Extension Area to Potgate Quarry.

1. Introduction

- 1.1 This Desk-based Assessment was commissioned by David L. Walker Limited acting on behalf of Lightwater Quarries Limited, and was undertaken by MAP Archaeological Consultancy Ltd for a Proposed Quarry Extension to Potgate Quarry (SE 2740 7640: Fig. 1).
- 1.2 Archaeological, Historical and Architectural remains are protected by means of Statutory Instruments (including Scheduled Ancient Monument Legislation and Planning Policy Guidance Nos. 15 and 16), and by the Harrogate District Council Local Plan (Chapter 6: Policies HD1, HD4, HD5 and HD7A).
- 1.3 There are no Scheduled Ancient Monuments, Registered Park and Gardens, Listed Buildings or Registered Battlefields within the Proposed Extension

Area to Potgate Quarry. There are two Scheduled Ancient Monuments within 2km of the Proposed Extension Area to the Quarry.

- 1.4 All work was funded by Lightwater Quarries Limited.
- 1.5 The Site Code assigned to this project is MAP 05-02-10.
- 1.6 All Maps within this report have been reproduced from the Ordnance Survey with the permission of the Controller of Her Majesty's Stationery Office, Crown Copyright, Licence No. AL50453A.

2. Site Description

- 2.1 Potgate Quarry is located 1.3 km west-south-west of North Stainley with access from Musterfield Lane to the north (Pls. 1 to 8). North Stainley is located 5km north-north-west of Ripon. The Proposed Extension Area is located north of the current Working Area at Potgate Quarry and is bounded to the north and west by Musterfield Lane with Musterfield Farm to the west and farmland to the east.
- 2.2 The Proposed Extension Area is approximately 320m by 210m (6.7 hectares), which stands between heights of c. 92m and 98m AOD.
- 2.3 The Proposed Quarry Extension Area is situated on soils of the Nercwys (542) Soil Association, described as 'deep fine loamy soils with slowly permeable subsoils and light seasonal waterlogging. Associated with similar slowly permeable seasonally waterlogged soils' over underlying geology of 'Till from Palaeozoic and Mesozoic sandstone and shale (Mackney et al, 1984, p. 9).

3. Planning Background

- 3.1 There have been no recent planning applications lodged for the Proposed Development Sites (since January 2007: www.harrogate.gov.uk).

4. Aims and Objectives

4.1 The aim of the Assessment is to:

- Identify recorded features of archaeological significance within the study area
- Establish the potential for hitherto unrecorded and unknown sites
- Assess the relative importance of the sites
- Assess the likely impact of the proposed development on the sites
- Make recommendations to mitigate any impact of the development on the sites

5. Methodology

5.1 The Desk-based Assessment reviewed the following sources of information for a target area that extended for a radius of 1km from the study site: -

- North Yorkshire Historic Environment Record (HER)
- National Monuments Record
- Listed Building Register
- Aerial Photographs
- Scheduled Monuments List
- English Heritage Register of Historic Parks and Gardens
- English Heritage Register of Battlefields
- Visual inspection of the site
- Plans and maps of the site and its environs, including historical pictorial and surveyed maps and including pre- and post war Ordnance Surveys up to the present day.
- Place and street name evidence
- Trade and Business Directories
- Historical documents and photographs
- Appropriate archaeological and historical journals and books

6. Results

6.1 There are no archaeological sites known within the Existing Consent Area and the Proposed Extension Area to Potgate Quarry on the North Yorkshire Historic Environment Record (HER).

6.2 Within two kilometres of the Proposed Extension Area to Potgate Quarry, there are two Scheduled Ancient Monuments; thirty-two sites on the North Yorkshire Historic Environment Register (HER) and there are twenty-one Listed Buildings.

6.3 Details of the Scheduled Ancient Monuments and the Historic Environment Record are summarised in Table 1 below and illustrated on Figure 3.

Table 1. Archaeological Sites within two kilometres of the Potgate Quarry on the North Yorkshire Historic Environment Record (www.heritagegateway.org.uk)

Monument No.	Grid Ref.	Description	Period
MNY134180	SE 257 782	West Tanfield Ring Ditch	Undated
MNY13755	SE 295 779	East Tanfield Pit Alignment	Undated
MNY21030 Monument No. 29579	SE 291 755	Castle Dikes Iron Age Hillfort Roman Bath house and Villa SCHEDULED ANCIENT MONUMENT	Iron Age Roman
MNY15939	SE 268 742	North Stainley with Sleningford Findspot Axe	Undated
MNY23031	SE 252 770	Mickley Mill Complex Extensive mill complex. Consists of various buildings and water management features, which briefly includes - a large mill race.	Post Medieval
MNY21024 Monument No. 29522	SE 288 780	East Tanfield deserted medieval village (DMV) The remains of the deserted medieval village of East Tanfield, including the earthwork remains of building platforms, associated yards and enclosures and tracks and hollow ways. SCHEDULED ANCIENT MONUMENT	Medieval
MNY23051	SE 262 753	Possible tree nursery or orchard at Newfields	Post Medieval
MNY23050	SE 257 755	Former field boundaries at Westfield Series of two lynchets, remnants of old field boundaries.	Medieval to Post Medieval
MNY29207	SE 257 753	Azerley Hut Circle No upstanding remains were noted. Noted on the aerial photograph as a possible group of 7 - 8 huts, positioned on the SW-NE axis on SW slope of Frizer Hill.	Iron Age

MNY24041	SE 265 755	Newfield Farm Complex, Azerley Consisting of farmhouse, barn, forge, cow house, stable and wheel house.	Post Medieval to Modern
MNY23032	SE 251 767	Ridge and furrow at Mickley	Medieval
MNY15264	SE 278 773	North Stainley with Sleningford Site of) Sleningford Deserted Settlement and Chapel Site of deserted Mediaeval village of Sleningford, and its chapel.	Medieval to Post Medieval
MNY23036	SE 256 769	Ridge and furrow at Mickley	Medieval
MNY23035	SE 257 762	Ridge and furrow at Mickley	Medieval
MNY29208	SE 261 757	Azerley Hut Circle The site had been destroyed by agricultural improvements. It is possible that the structures are concealed beneath an area of recently planted copse. As noted on the aerial photograph, as a complex of hut circles that is situated about c.600m from another similar site (ref. 6019 1007)	Unknown date
MNY23052	SE 260 747	Ridge and furrow at The Chequer	Medieval
MNY15522	SE 260 779	Beaker Burial south of Park Lane, West Tanfield NMR No.: SE27NE19	Bronze Age
MNY23037	SE 265 756	Ridge and furrow at Newfield Very worn R & F. 3-4m wide, orientated E-W.	Medieval
MNY29205	SE 265 757	Azerley, Quarry No evidence of the structure was identified. There was a possible slight depression in the SW corner, straddling the western field boundary. As noted on the aerial photographs as an industrial complex, possible quarry workings visible as cropmarks.	Iron Age
MNY24019	SE 275 769	(Site of) Friar's Hurst Modern farm on the site of a former dairy farm to Fountain's Abbey.	Medieval
MNY29200	SE 266 743	Azerley, Findspot Broken Neolithic stone axe found near Azerley Tower.	Neolithic
MNY15856	SE 286 770	North Stainley Village	Saxon to Modern
MNY13515	SE 260 745	Azerley, Shrunken Village	Saxon to Modern
MNY24029	SE 285 754	St Helens Well, Lightwater Valley Supposed Holy Well - not an antiquity NMR No.: SE27NE12	Roman to Modern
MNY24035	SE 256 770	Mickley (Site of?) Barn	Post Medieval
MNY24030	SE 262 780	South of Furnace Hill, West Tanfield Soil marks of a possible enclosure	Undated

		within which is a small mound (Aerial Photographic Cropmark and Earthwork)	
MNY15776	SE 257 769	Mickley village	Medieval to Modern
MNY29204	SE 264 755	Azerley Enclosure (Aerial Photographic Cropmark)	Iron Age
MNY15007	SE 251 778	West Tanfield Enclosure(Aerial Photographic Cropmark)	Undated
MNY14700	SE 285 744	North Stainley with Sleningford Lime Kiln	Undated
MNY13990	SE 282 780	North Stainley with Sleningford Mill	Undated
MNY13822	SE 258 743	Azerley Mill	Undated

6.4 Details of the Listed Buildings within two kilometres of the Potgate Quarry are summarised in Table 2 below and illustrated on Figure 4.

Table 2. Listed Buildings within two kilometres of Potgate Quarry (noted on Listed Buildings Online)

Name	Grid Reference	Description
Dovecote 200m south-west of Sleningford Park New Road North Stainley with Sleningford	SE 27443 77254	Dovecote, now animal shelter. C18. Coursed rubble and cobbles, ashlar quoins, pantile roof with 3 eaves courses of stone slates. Built as part of group with barn and stables to be viewed from driveway to Sleningford Park. SE 27 NE 2/102 Grade II
Stables 150m south-west of Sleningford Park New Road North Stainley with Sleningford	SE 27447 77376	Stables, now house and outbuildings. Mid to late C18. Coursed rubble and ashlar, stone slate roof. Rusticated quoins. 4 blocks around square courtyard. Built as part of group with barn and dovecote to be viewed from driveway to Sleningford Park. SE 27 NE 2/101 Grade II
Barn 150m south of Sleningford Park New Road North Stainley with Sleningford	SE 27522 77294	Barn or Farm building. C18. Coursed cobbles with rusticated quoins, C20 pantile roof with eaves courses of stone slates. Central narrow door with Diocletian window above. Built as part of group with dovecote and stables to be viewed from driveway to Sleningford Park. SE 27 NE 2/103 Grade II
Sleningford Park New Road North Stainley with Sleningford	SE 27558 77506	Country House. Early C18 for Mr Wray, probably by William Thornton with late C18 and C19 additions and alterations. Rubble with gritstone dressings, blue-slate roof partly replace by cement tiles. 3 storey, 5 bay main block with 2 storey,

		3 bay wing to right, single storey kitchen block now garage far right, single storey 3 bay wing to left and conservatory far left. SE 27 NE 2/100 Grade II
Gate Piers, Gates and Railings 300m south-east of Sleningford Park New Road North Stainley with Sleningford	SE 27821 77274	Gates, railings and inner and outer pairs of gate piers. Early C19. Wrought iron and ashlar. SE 27 NE 2/99 Grade II
Friars Hurst Musterfield Lane Sleningford	SE 27600 76968	House. Late C18. Rendered rubble, purple slate roof. Rusticated quoins, 2 storeys, 3 first floor windows with probably earlier rear range. On site of Grange of Fountains Abbey. SE 27 NE 2/104 Grade II
Sleningford Grange A6108 Sleningford	SE 28495 77512	Country House. Mid C18 with C19 additions. Coursed rubble with cobbles, stone slate roof. 2 storeys, 3 first floor windows, with added wing to rear right linking to parallel rear range. SE 27 NE 2/98 Grade II
Manor Farmhouse West Tanfield Road East Tanfield	SE 29010 77850	Farmhouse. Early C19. Stone, rendered, with graduated slate roof. 2 storeys, 3 bays with back wing SE 27 NE 8/17 Grade II
Gate Piers and Gates to Stainley Hall A6108, North Stainley with Sleningford	SE 28777 76605	Gates and gate piers. Late C18 for Staveley family. Wrought iron and rusticated ashlar. SE 27 NE 2/95 Grade II
Stables 50m north-east of Stainley Hall A6108, North Stainley with Sleningford	SE 28761 76600	Stables, now outbuildings. Mid C18. Coursed cobbles, gritstone dressings, purple slate roof. 2 storey, 3 bay. Quoins. SE 27 NE 2/94 Grade II
Gazebo A6108, North Stainley with Sleningford	SE 28741 76666	Gazebo. Early-mid C19. Probably for the Staveley family of Stainley Hall. Coursed limestone rubble and cobbles, sheet metal roof. Circular 1 storey building built into garden wall. SE 27 NE 2/96 Grade II
Stainley Hall A6108, North Stainley with Sleningford	SE 28709 76522	Country House. 1715 for Miles Staveley with C19 additions and restoration in 1985. Flemish bond, ashlar plinth and details, stone slate roof. Quoins, 3 storeys, 5 first floor windows. SE 27 NE 2/93 Grade II*
Gates, Gate Piers, Flanking Walls with Railings 100m south of Old Sleningford Hall, Old Sleningford Road, North Stainley with Sleningford	SE 26577 76683	Gates, Gate Piers, Flanking Walls with Railings. Early C19. Wrought iron and ashlar. SE 27 NE 2/107 Grade II
Well Cover opposite Gates to Old Sleningford Hall, Old Sleningford Road,	SE 26575 76663	Well Cover. Late C18-Early C19. Ashlar and Gritstone.

North Stainley with Sleningford		SE 27 NE 2/108 Grade II
Stables 30m north-east of Old Sleningford Hall, Old Sleningford Road, North Stainley with Sleningford	SE 26537 76798	Stables, now outbuildings. Early C19. Rendered rubble and brick, stone slate roof. Courtyard plan with gateway and flanking walls on east side; to north and south – low 2 storey ranges, each with a taller square 1 bay tower at east end, West side closed by a wall with narrow board door. SE 27 NE 2/106 Grade II
Old Sleningford Hall with Attached Garden Wall, Old Sleningford Road, North Stainley with Sleningford	SE 26488 76774	Country House and attached garden wall. Early C19. Ashlar, red brick wall, Westmorland Slate roof. 2 storey, 5 bay central block flanked by lower 2 storey, 2 bay wings, the outer bays projecting slightly. Main block: central 3 bays with triangular pediment, SE 27 NE 2/105 Grade II
Methodist Chapel, Main Street, Azerley	SE 25741 770007	Methodist chapel, now house extension. Early C19. Coursed gritstone, rendered with pantile roof. Quoins. SE 27 NE 2/28 Grade II
Stables 70m west of Azerley Chase House, Kirkby Road, Azerley	SE 25715 74490	Stables to Azerley Chase. Late C18 with C19 alterations. Coursed rubble, pantile roof, Courtyard plan with main entrance façade on east side composed of a 2 storey, 5 bay range, the central bay with a carriage arch. SE 27 SE 5/23 Grade II
Hat Barn 5m north of Stables at Azerley Park, Kirkby Road, Azerley	SE 25695 74525	Hay Barn. Probably mid-late C19 (post 1860). Red brick, English bond, pantile roof with eaves course of stone slates. Tall 5 bay building of Dutch barn type. SE 27 SE 5/24 Grade II
The Old Vicarage, Main Street, Mickley	SE 25468 76995	Vicarage, now private house. Mid C19. Split cobbles, ashlar dressings, Westmorland slate roof. 2 storeys with attic, 3 bays, 2 end bays projecting forward slightly as gabled wings. Quoins. SE 27 NE 2/27 Grade II
Church of Saint John Main Street, Mickley	SE 25441 76998	Church. 1841. For the Dalton Family of Sleningford Grange. Coursed split cobbles, ashlar dressings, purple slate roof. Nave of 4 bays with west bellcot, south porch and 1 bay chancel. Built in Early English style. SE 27 NE 2/26 Grade II

6.5 Prehistoric

6.5.1 There are no Prehistoric archaeological sites or finds on the North Yorkshire Historic Environment Record within the Existing Consent Area and the Proposed Extension Area to Potgate Quarry.

6.5.2 Within two kilometres of Potgate Quarry there are eleven prehistoric sites and finds either undated or assigned to the Prehistoric Period. There are references to two finds, both axes, one undated (MNY 15939) and a broken Neolithic Stone axe (MNY29200). There was a Bronze Age Beaker Burial found in West Tanfield (MNY15522). The site of Castle Dikes has substantial earthen ramparts and is noted on the North Yorkshire HER as a possible Iron Age Hillfort, predating the Roman Villa on the site, this is a Scheduled Ancient Monument (Monument No. 29528: MNY21030). There are seven Aerial Photographic Cropmarks sites noted on the North Yorkshire HER which are interpreted as undated or Iron Age features and include Iron Age hut circles (MNY29207; MNY29208), an Iron Age Industrial Site or Quarry (MNY29205); an undated enclosure and mound (MNY24030); an undated pit alignment (MNY13755) and two enclosures, one Iron Age (MNY29204) and one undated (MNY15007).

Potential: Low

6.6 *Romano-British Activity*

6.6.1 No archaeological sites of Roman date are recorded within the Existing Consent Area and the Proposed Extension Area to Potgate Quarry.

6.6.2 900m south-east of Potgate Quarry is Castle Dikes, the site of a known Roman Villa and Bathhouse, which is a Scheduled Ancient Monument (Monument No. 29528: MNY21030). The villa and bathhouse were partially excavated in the nineteenth century and a further range of Roman buildings were uncovered in 1929. The villa dates from the early second century AD. The Villa was first Scheduled as a Monument in 1926 (Monument NY104).

6.6.3 The site of a Spring, St. Helen's Well is noted on the North Yorkshire HER as a possible Roman Spring Votive Site and later Holy well (MNY24029). This well is located 500m south of Potgate Quarry,

Potential: Low

6.7 Anglo-Saxon/Anglo-Scandinavian

6.7.1 There are no archaeological sites of this date recorded within the Existing Consent Area and the Proposed Extension Area to Potgate Quarry.

6.7.2 The villages of North Stainley (MNY15856) and Azerley (MNY13515) are both manors, which predate the Norman Conquest.

Potential: Low

6.8 Medieval Activity

6.8.1 The Potgate Quarry and the Proposed Extension Area lies south-west of the village of North Stainley and north-west of Ripon, in the Parish of North Stainley with Sleningford, in the District of Harrogate, North Yorkshire, which was formerly in the Lower Claro Wapentake in the West Riding of Yorkshire.

6.8.2 The Place-name '*North Stainley*' derives from the Old English for stone "*leah*" meaning grove or glade (Ekwall 1974, 252, 435-8). The first mention of North Stainley in documentary sources is in the Domesday Book (1086).

6.8.3 There are four entries in Domesday for North Stainley. The first entry is under the Land of The Archbishop (of York) "*To Ripon belongs the jurisdiction of these lands (EAST) STAINLEY; SUTTON (GRANGE); another STUDLEY (ROGER); (NORTH) STAINLEY; SLENINGFORD; SUTHEUIC. Between them all 21 ½ carucates taxable. 15 ploughs possible there. Now there are 5 villagers and 3 smallholders who have 3 ploughs. Meadow 2 acres. In SUTHEUIC; underwood 1 ½ leagues long and 1 league wide. Value of Ripon before 1066 £32, now £7 10s.*" (Faull and Stinson 986, 2W8). The second entry under the Land of the Count of Mortain states "*In CUNDALL, NORTON (LE CLAY) an outklier, and LECKBY (PALACE) an outlier, Watheof had one manor of 21 carucates taxable where 12 ploughs are possible. Count Robert has (it) now. Alfredd holds it for him. To the same manor belongs the jurisdiction in LECKBY (PALACE) 4 carucates, BRAMPTON (HALL) 2 carucates, CUNDALL 2 carucates, (NORTH) STAINLEY 1 carucate, (EAST) TANFIELD 1 carucate, CALDEUUELLE, 4 carucates. Together 14*

carucates taxable, where 8 ploughs can plough. All waste excepte CALDEUUELLE there is one villagr with ½ plough. The whole manor 2 leagues long and 1 wide. Value before 1066, £4; now 20s.” (ibid, 5W38). The next entry is in the summary of the holdings of the Archbishop, which states “In (NORTH) STAINLEY and SLENINGFORD 6 ½ carucates” (ibid SW Bu48). The final entru in Domesday is the summary of the holdings of the Count of Mortain, “*in (NORTH) STAINLEY, 1 carucate*” (ibid, SW H9).

6.8.4 There are no Medieval Finds, Sites or Monuments within the Existing Consent Area and or the Proposed Extension Area to Potgate Quarry on the North Yorkshire HER.

6.8.5 Within two kilometers of Potgate Quarry there are eight known Medieval sites on the North Yorkshire HER. Approximately 1.5km north of Potgate Quarry, is the Deserted Medieval Village of East Tanfield, with earthwork remains of building platforms, yards, enclosures and tracks (MNY21024), which is a Scheduled Ancient Monument (Monument No. 29522). East Tanfield DMV was scheduled in August 1958 (NY470). To the west North Stainley, and north of Potgate Quarry is the Deserted Settlement and Chapel of Sleningford (MNY15264). Mickley village has a Medieval foundation (MNY15776). Evidence of Medieval ploughing survives as ridge and furrow at Mickley (MNY23032, MNY23035; MNY23036), at Chequaer (MNY23052) and at Newfield (MNY23037). Former field boundaries and lynchets are noted at Westfield (MNY23050). The site of a Grange for Fountain’s Abbey is noted at Friar’s Hirst (MNY24019).

Potential: Low

6.9 Post-medieval/ Modern

6.9.1 In there were four entries under North Stainey in Baines Directory and Gazetteer of 1822

“Bell, Geo., blacksmith;

Dalton, John, Esq.;

Hudson, C.P., Esq.

Metcalf, Joseph, vict, Golden Letters”

Potgate House is also listed as a farm in North Stainley. The National Gazetteer of Great Britain and Ireland of 1868 notes North Stainley under Ripon with the following description "NORTH STAINLEY, (or Stainley-with-Dleningford), a township in the parish of Ripon, West Riding county York, 4 miles N.W. of Ripon, its post town. The village, which is small, is situated on the S. bank of the river Ure, and near the Roman way to Catterick. The township contains the new palace of the bishops of Ripon, recently erected on the farm of Bramley Grange. The living is a perpetual curacy in the diocese of Ripon, value £100, in the patronage of the dean and chapter. The church is modern." (www.genuki.org.uk).

- 6.9.2 There are no Post-medieval or Modern sites noted on the North Yorkshire HER within the Existing Consent Area for Potgate Quarry or the Proposed Extension Area.
- 6.9.3 Sites within two kilometres of Potgate Quarry include Mickley Mill (MNY23031), a tree nursery or orchard at Newfields (MNY23051), Newfield Farm (MNY24041), a barn at Mickley (MNY24035). A lime kiln (MNY14700) and mills at North Stainley (MNY13990) and Azerley (MNY13822).
- 6.9.4 The 1856 First Edition Ordnance Survey Map (Fig. 5) shows the area of the Proposed Extension Area as two fields east of Musterfield with Musterfield Lane to the north and west. The present quarrying area is two fields to the south. The Area of the Company Landholding on the First Edition Ordnance Survey map includes covers Potgate Farm, a limestone quarry and Limekiln, The Cover (later called Potgate Wood) and twenty-five fields.
- 6.9.5 The 1894 Second Edition Ordnance Survey Map (Fig. 6) shows The Proposed Extension Area as two fields located south and east of Musterfield Lane and east of Musterfield. The Area of the Company Landholding in 1894, includes Potgate Wood and Potgate Farm and twenty-two fields, some field boundaries has changes.

6.9.6 The 1910 Edition Ordnance Survey Map (Fig. 7) showed the Proposed Quarry Extension Area as one field located south and East of Musterfield Lane and east of Musterfield. The Area of the Company Landholding in 1910 included the Old Quarry, Potgate Farm, Potgate Wood and seventeen fields.

6.9.7 The 1930 Edition Ordnance Survey Map (Fig. 8) showed the Proposed Extension Area as one field, as on the 1910 Edition Ordnance Survey Map. The Area of the Company Landholding includes seventeen fields, Potgate Wood and Potgate Farm.

Potential: Low

6.10 Listed Buildings

6.10.1 There are no Listed Buildings within Potgate Quarry and the Proposed Extension Area or bordering the Quarry boundaries. The nearest are in North Stainley village c. 400m east of the company landholding.

6.11 Site Walkover

6.11.1 The site was visited on the 15th February 2010. The area of the Proposed Extension Area to Potgate Quarry was an arable field to the south-west of a farm track (Pls. 1-8).

6.12 Potential for Unrecorded Sites

6.12.1 The potential for unrecorded sites is moderate. The Proposed Quarry Extension Area has been part of a Medieval and Post-medieval Fields Systems. Archaeological Deposits predating the Medieval Period are also a possibility.

6.13 Evidence of Previous Disturbance

6.13.1 There is no known evidence for previous ground disturbance on the Proposed Extension Area other than by agricultural activity.

7. Impact of the Development

7.1 The following potential impacts upon the archaeological resource are considered:

- Loss of, or damage to, archaeological sites and remains
- Settings and views of and from upstanding remains, Listed Buildings, Scheduled Monuments and other archaeological sites
- Changes to ground conditions as a result of changes to the drainage regime which could affect archaeological remains
- Loss of landscape features, structures and areas with historic and cultural heritage associations
- Other possible impacts such as noise, vibration, compressions and other changed ground conditions

7.2 *Loss of, or damage to, archaeological sites and remains*

7.2.1 The proposed Quarry extension will completely remove any archaeological remains, if present, within the Proposed Quarry Extension Area.

7.3 *Settings and views of and from upstanding remains, Listed Buildings, Scheduled Monuments and other archaeological sites*

7.3.1 There are no Scheduled Monuments or Listed Buildings or other archaeological sites within the Proposed Extension Area to Potgate Quarry, or within the existing consented area of working.

7.4 *Changes to ground conditions as a result of changes to the drainage regime which could affect archaeological remains*

7.4.1 The proposed development is not envisaged to have an effect on the prevailing local drainage conditions.

7.5 *Loss of landscape features, structures and areas with historic and cultural heritage associations*

7.5.1 The Quarry will have a minor impact on any features, structures and areas with historic and cultural heritage associations.

7.6 Other possible impacts such as noise, vibration, compressions and other changed ground conditions

- 7.6.1 As per the existing operations, the quarrying will have a minimal impact in terms of noise and vibration in the immediate environment of the application site. It is unlikely that these will have an impact on features of archaeological or historic environment importance.

8. Conclusions and Recommendations

- 8.1 The Area of the Proposed Quarry Extension is currently an agricultural field. There are no known archaeological sites from the HER, Listed Buildings or Scheduled Ancient Monuments within the Proposed Extension Area to Potgate Quarry, or within the Existing Consent Area.
- 8.2 The assessment has shown no evidence of nationally important archaeological remains on the site that would prevent its allocation or subsequent planning permission for a Proposed Quarry Extension in line with PPG.16 and PPG. 15. However it is recommended that consideration is given to further evaluation of the site before there is a physical start on the development.

9. References

9.1 Primary Sources

North York Moors National Park Authority
North Yorkshire Record Office
National Monuments Record
North York Moors Historic Environment Record
www.heritage-gateway.org.uk
www.magic.gov.uk
www.imagesofengland.org.uk
www.pastscape.org.uk
www.british-history.ac.uk
www.genuki.org.uk
www.a2a.org.uk
www.nationalarchives.gov.uk

1856 First Edition Ordnance Survey Map, Scale six inches to one mile.
1894 Second Edition Ordnance Survey Map. Scale six inches to one mile.
1910 Edition Ordnance Survey Map. Scale six inches to one mile.
1930 Edition Ordnance Survey Map, Scale six inches to one mile.

9.2 Secondary Sources

- | | |
|--------------------------------|---|
| Ekwall, E. 1974 | The Concise Oxford Dictionary of English Place-names. Fourth Edition. Oxford University Press/ |
| Faull, M. and Stinson., M 1986 | The Domesday Book: Yorkshire. Part One. Phillimore. |
| Mackney, D. et al. 1984 | Soils of England and Wales . Sheet 1. Northern England. Soil Survey of England and Wales. |
| Smith, A.H. 1961 | The Placenames of the West Riding of Yorkshire. Wapentake of Upper Strafforth. English Placename Society Volume XXXIV Part 5. Cambridge University Press. |

10. List of Contributors

Desk Based Assessment by Paula Ware and Kelly Hunter

Site Walkover by Paula Ware

Edited by Paula Ware and Charlotte Bolton

Drawings by Kelly Hunter

Plates, Administration, Filing, Copying and Binding by Sophie Langford

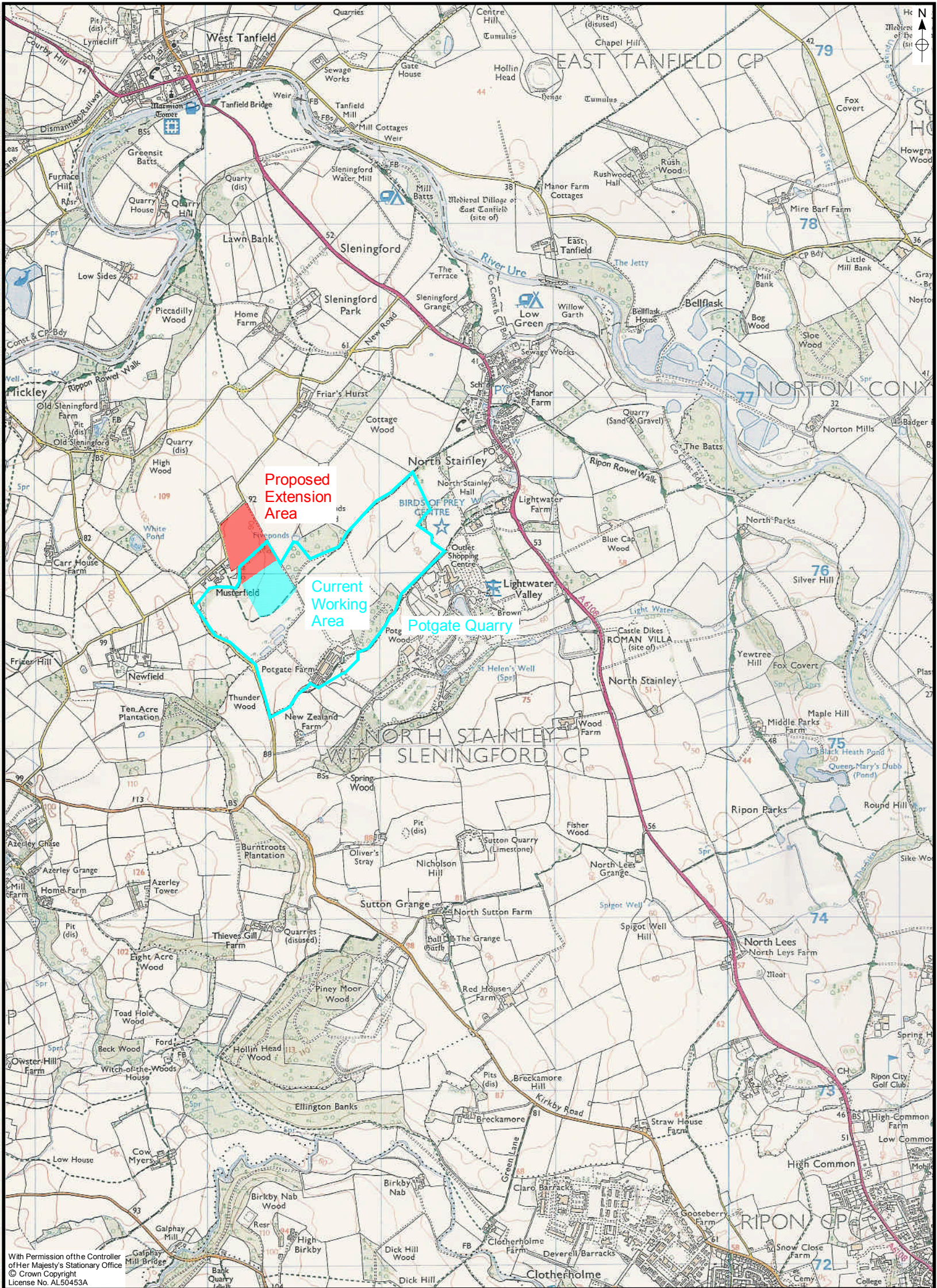

With Permission of the Controller of Her Majesty's Stationary Office
 © Crown Copyright
 License No. AL50453A

MAP

Archaeological Consultancy Ltd.

SITE: Proposed Extension to Potgate Quarry,
 North Stainley, Ripon, North Yorkshire

CLIENT: Lightwater Quarries Limited.

TITLE: Site Location.

Figure 1.

Scale: 1:25,000

DRAWING REF.:

DRAWN BY: KCH

REVISIONS:

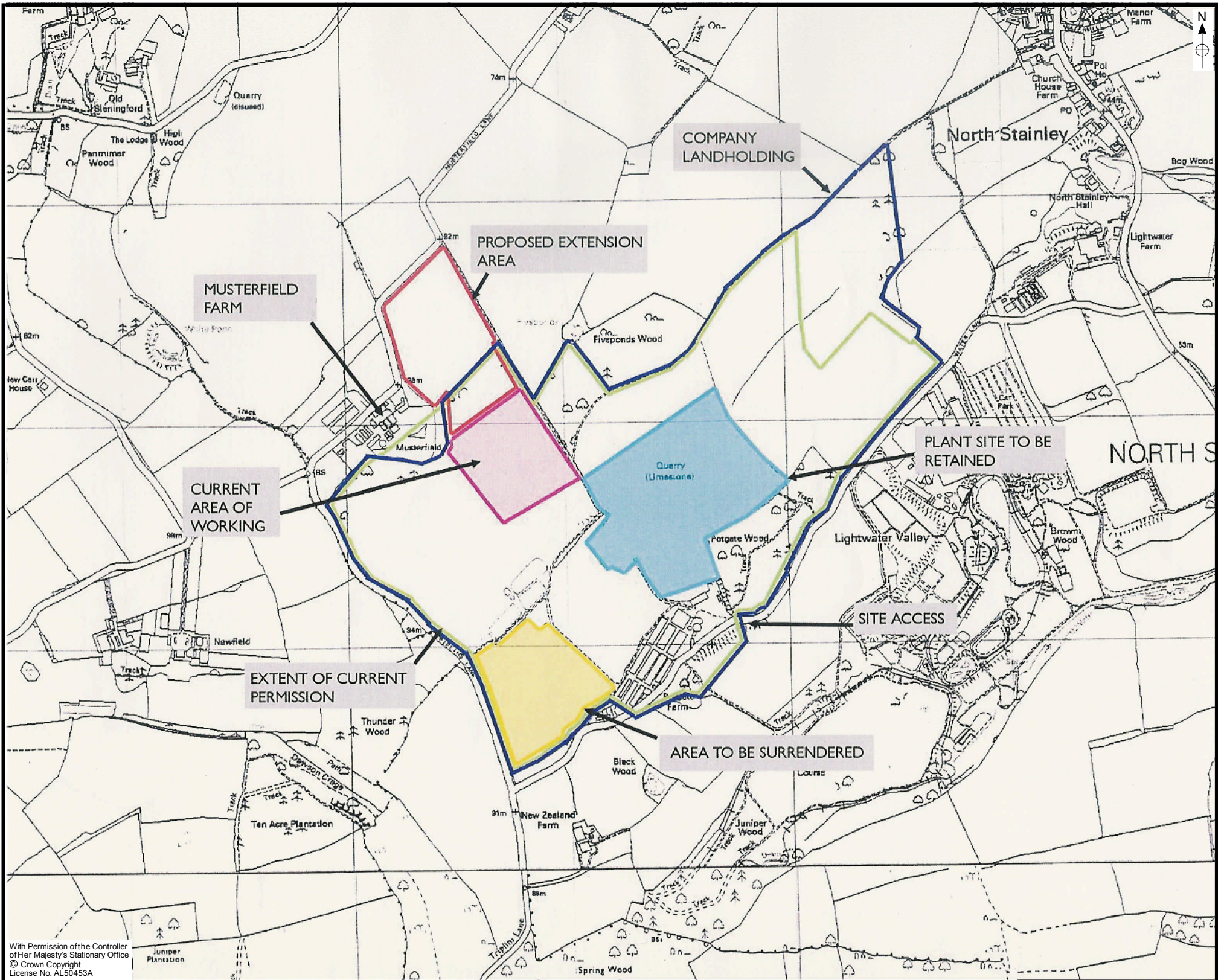

MAP

Archaeological Consultancy Ltd.

SITE: Proposed Extension to Potgate Quarry,
North Stainley, Ripon, North Yorkshire

CLIENT: Lightwater Quarries Limited.

TITLE: Proposed Quarry Extension Area.

Figure 2.

Scale: 1:10,000

DRAWING REF.: David L Walker Plan 1 07/09

DRAWN BY: KCH

REVISIONS:

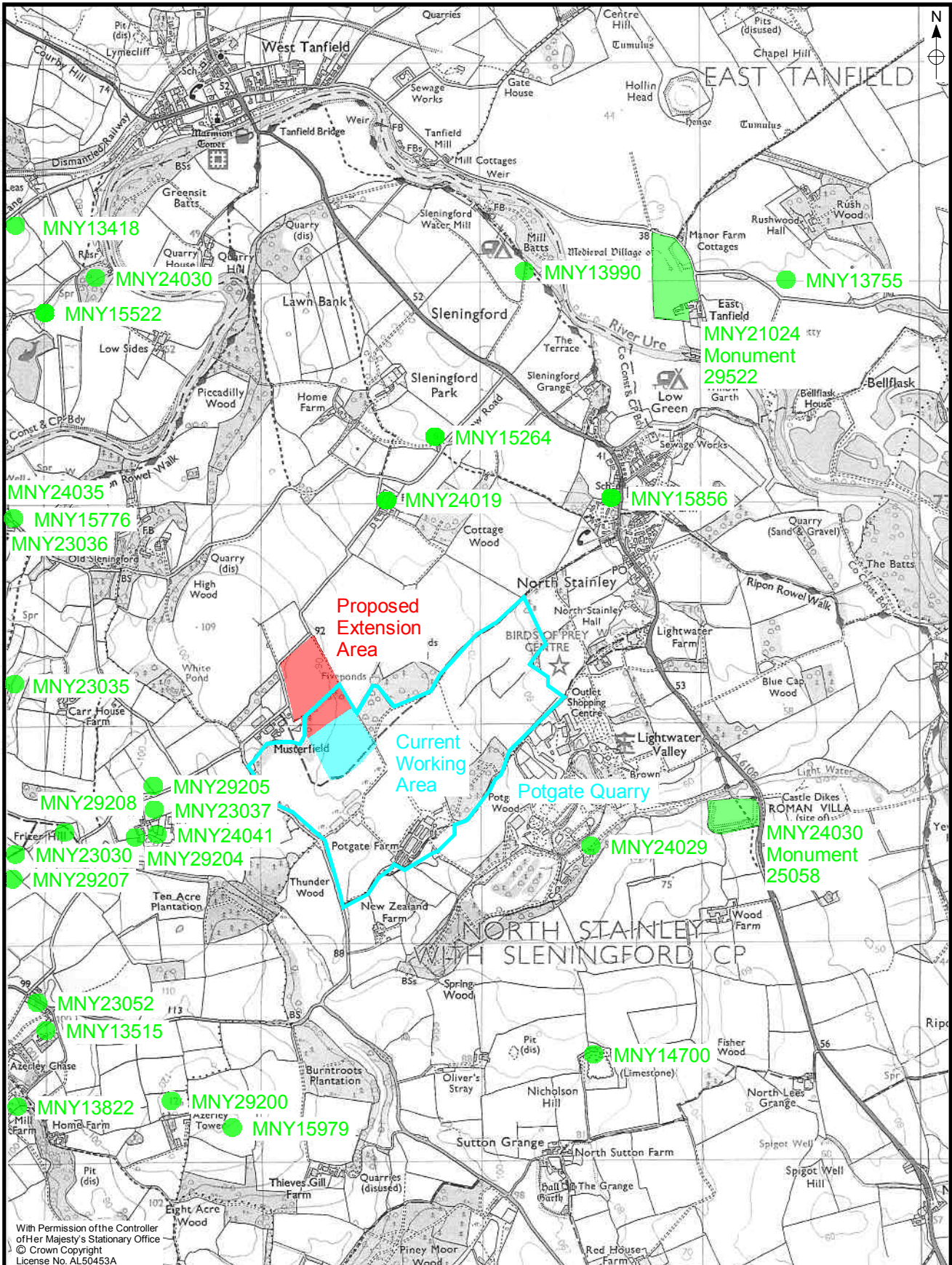

With Permission of the Controller of Her Majesty's Stationary Office © Crown Copyright License No. AL50453A

MAP

Archaeological Consultancy Ltd.

SITE: Proposed Extension to Potgate Quarry, North Stainley, Ripon, North Yorkshire

CLIENT: Lightwater Quarries Limited.

TITLE: Sites on the North Yorkshire Historic Environment Record.

Figure 3.

Scale: 1:25,000

DRAWING REF.:

DRAWN BY: KCH

REVISIONS:

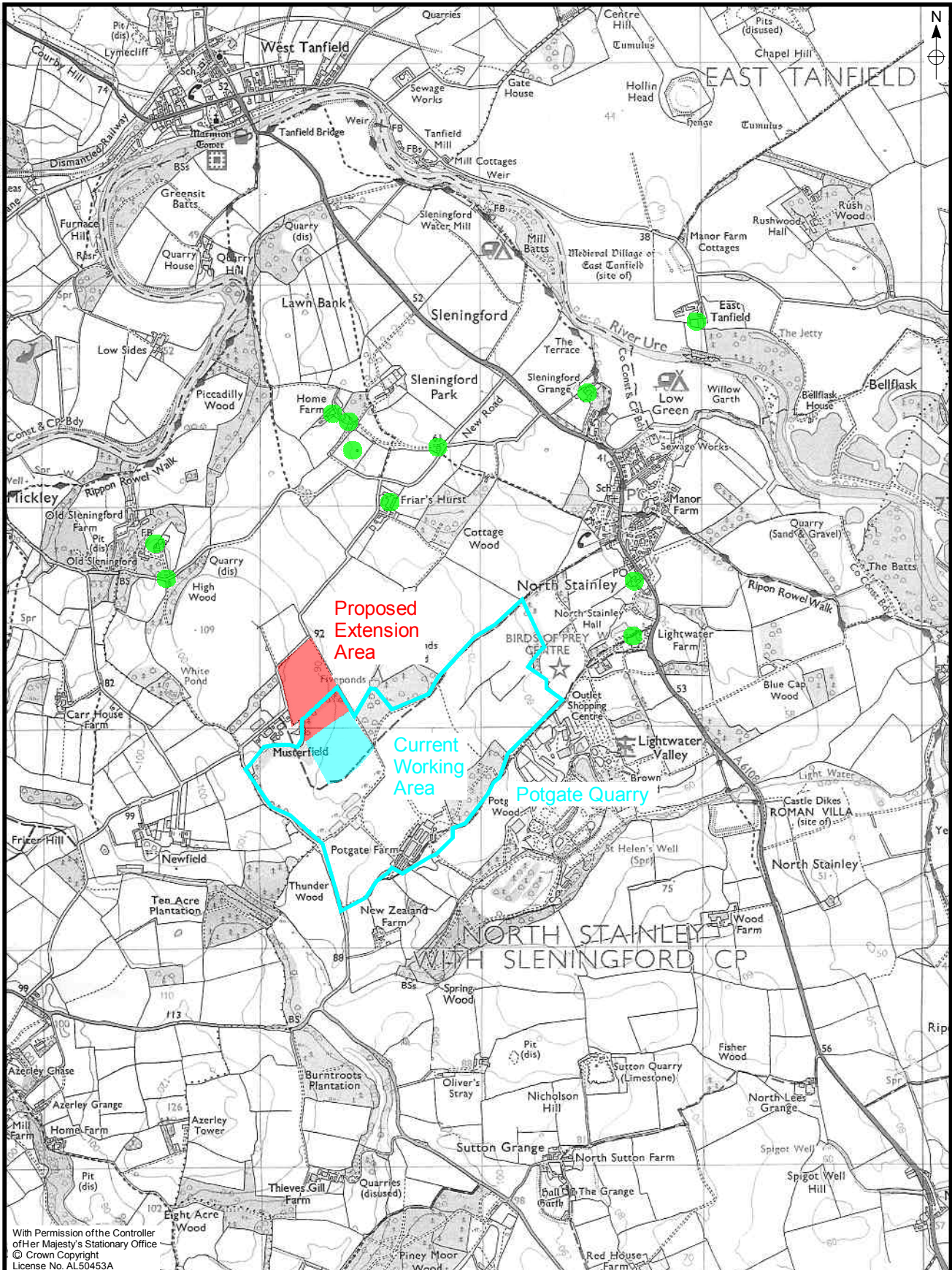

MAP

Archaeological Consultancy Ltd.

SITE: Proposed Extension to Potgate Quarry, North Stainley, Ripon, North Yorkshire

CLIENT: Lightwater Quarries Limited.

TITLE: Listed Buildings.

Figure 4.

Scale: 1:25,000

DRAWING REF.:

DRAWN BY: KCH

REVISIONS:

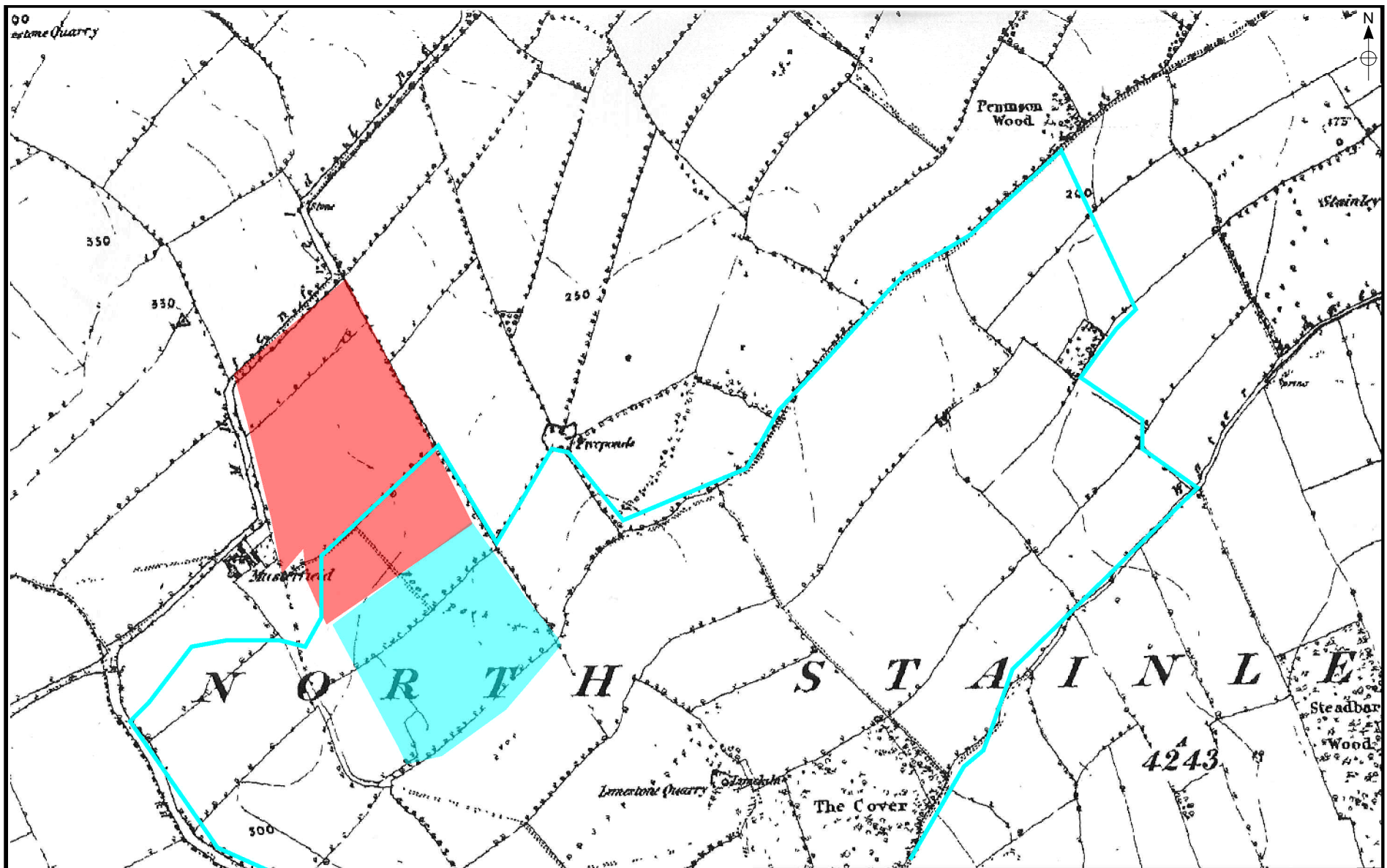

MAP

Archaeological Consultancy Ltd.

SITE: Proposed Extension to Potgate Quarry,
North Stainley, Ripon, North Yorkshire

CLIENT: Lightwater Quarries Limited.

TITLE: Extract from the 1856 First Edition
Ordnance Survey Map.

Figure 5.

Scale: 1:10,560

DRAWING REF.:

DRAWN BY: KCH

REVISIONS:

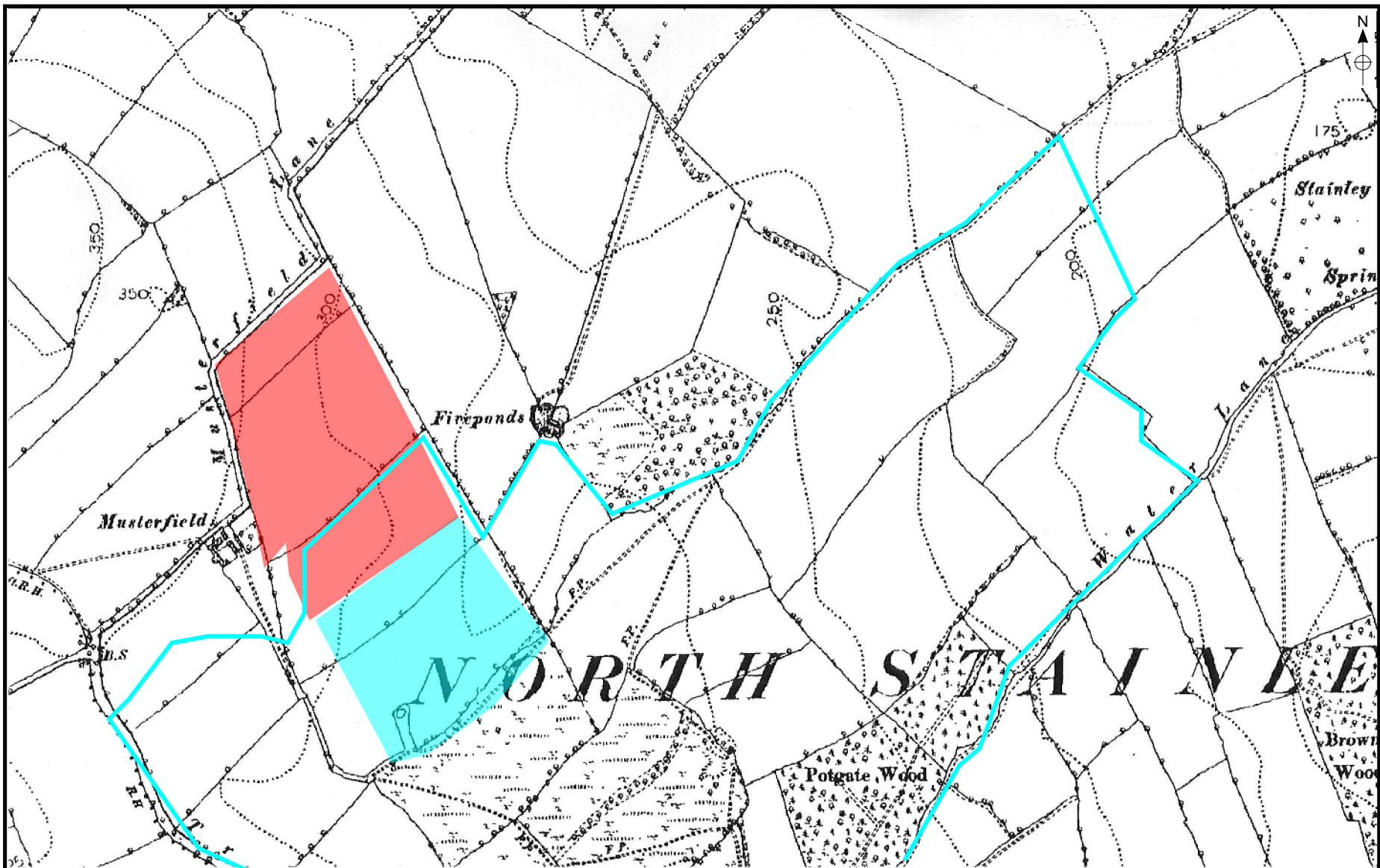

MAP

Archaeological Consultancy Ltd.

SITE: Proposed Extension to Potgate Quarry,
North Stainley, Ripon, North Yorkshire

CLIENT: Lightwater Quarries Limited.

TITLE: Extract from the 1894 Edition
Ordnance Survey Map.

Figure 6.

Scale: 1:10,560

DRAWING REF.:

DRAWN BY: KCH

REVISIONS:

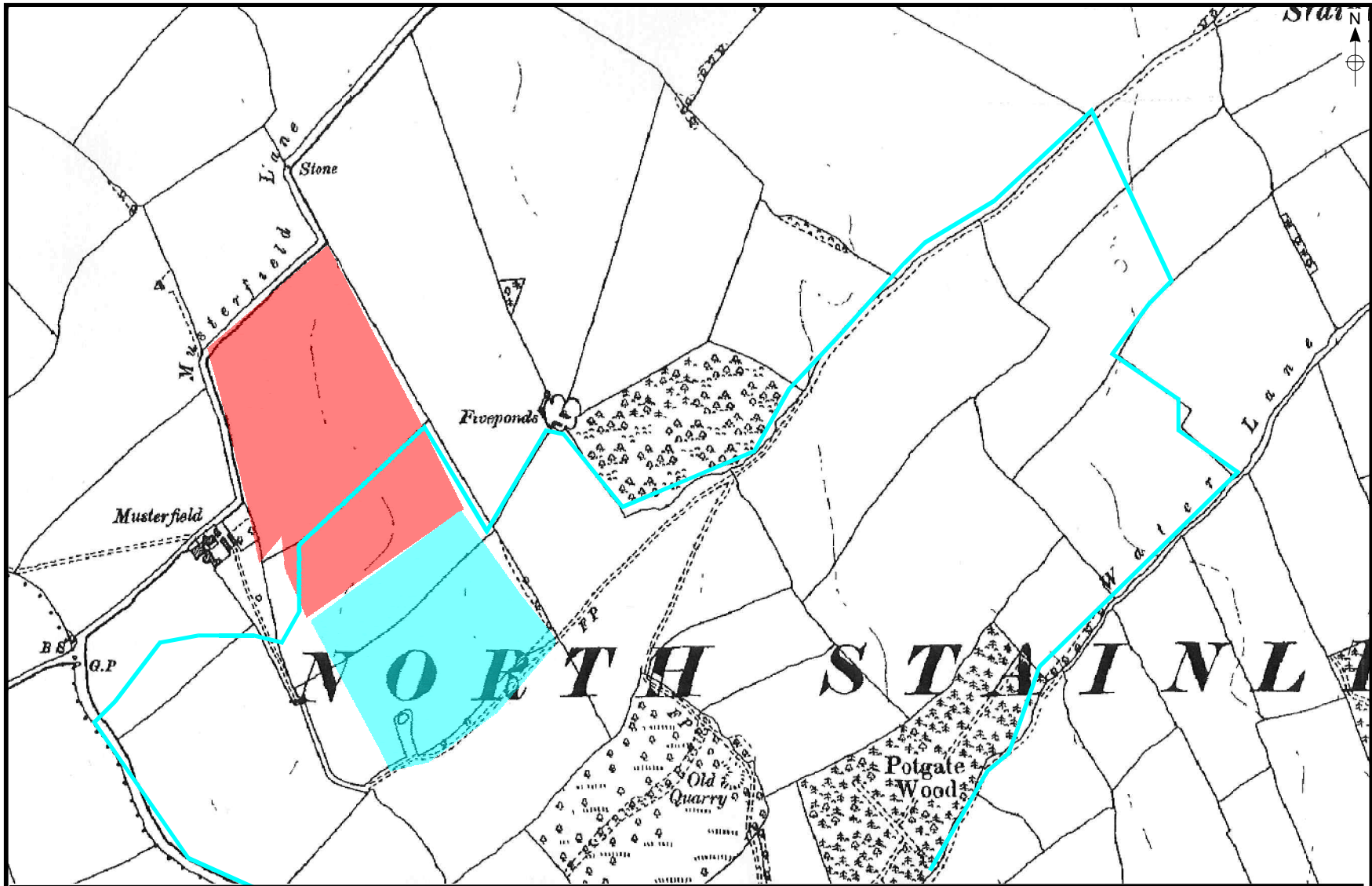

MAP

Archaeological Consultancy Ltd.

SITE: Proposed Extension to Potgate Quarry,
North Stanley, Ripon, North Yorkshire

CLIENT: Lightwater Quarries Limited.

TITLE: Extract from the 1910 Edition
Ordnance Survey Map.

Figure 7.

Scale: 1:10,560

DRAWING REF.:

DRAWN BY: KCH

REVISIONS:

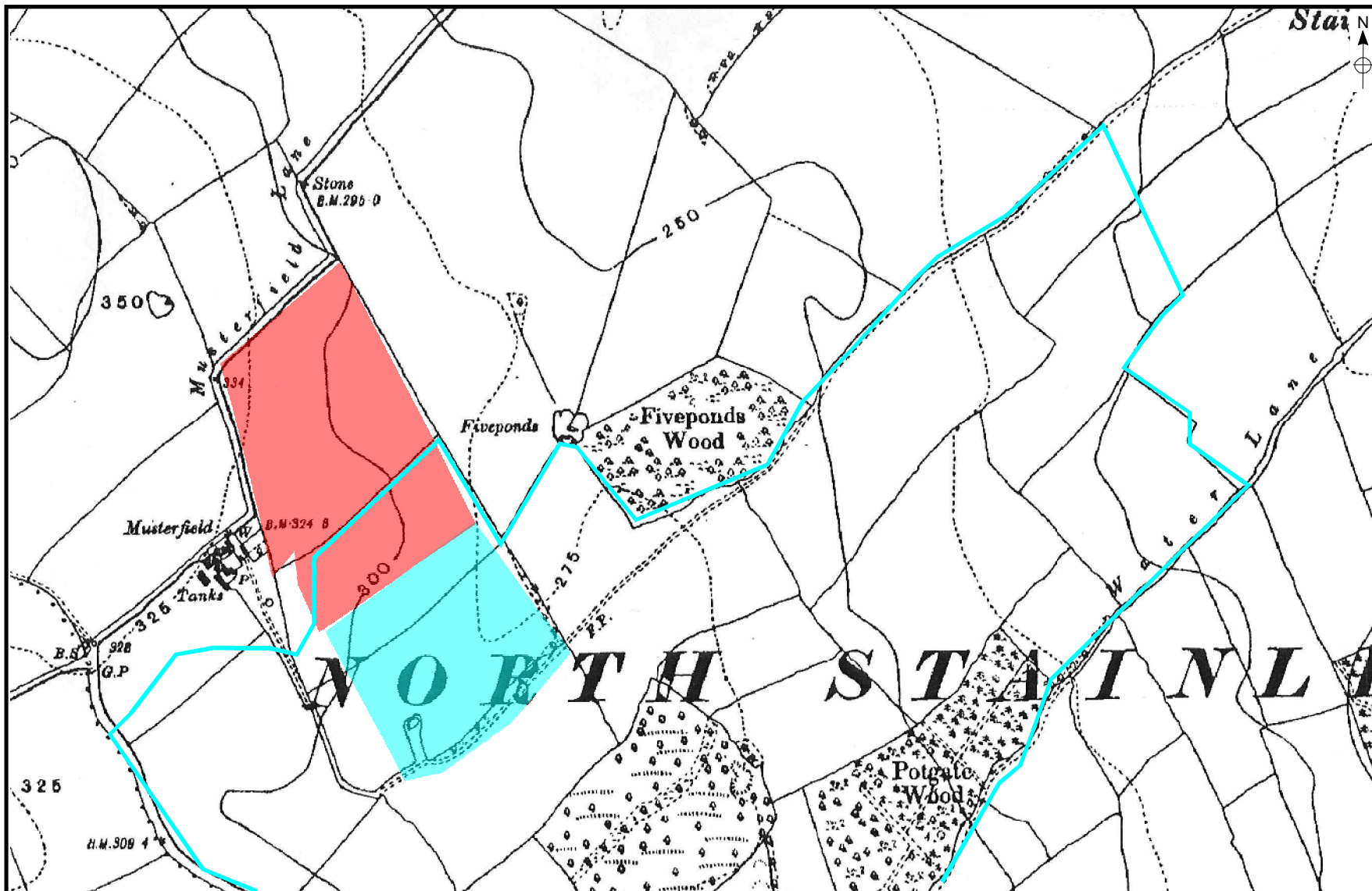

MAP

Archaeological Consultancy Ltd.

SITE: Proposed Extension to Potgate Quarry,
North Stainley, Ripon, North Yorkshire

CLIENT: Lightwater Quarries Limited.

TITLE: Extract from the 1930 Edition
Ordnance Survey Map.

Figure 8.	Scale: 1:10,560
DRAWING REF.:	
DRAWN BY: KCH	
REVISIONS:	



Plate 1. General View towards Potgate Quarry. Facing East.



Plate 2. General View towards Potgate Quarry. Facing East.



Plate 3. General View towards Potgate Quarry. Facing East.



Plate 4. 4. View of Musterfield Lane. Facing South.



Plate 5. 5. View of Boundary Stone. Facing South.



Plate 6. 6. View of Proposed Quarry Extension. Facing East.



Plate 7. View of Proposed Quarry Extension. Facing South.



Plate 8. View of Proposed Quarry Extension. Facing West.