

ARCHAEOLOGICAL  
SERVICES  
DURHAM UNIVERSITY

on behalf of  
Southern Green Ltd  
for  
Dr & Mrs Lawson

Green Walk  
Temple Grounds  
Richmond  
North Yorkshire

archaeological monitoring

report 2452  
July 2010

## **Contents**

1.	Summary	1
2.	Project background	2
3.	Landuse, topography and geology	2
4.	Previous archaeological work	3
5.	Observations	3
6.	Conclusions	3
7.	Sources	3

## **Figures**

Figure 1:	Site location
Figure 2:	The site
Figure 3:	Footings for upper retaining wall looking south
Figure 4:	Footings for lower retaining wall looking south

## **1. Summary**

### **The project**

- 1.1 This report presents the results of archaeological monitoring conducted during rebuilding of retaining walls on the Green Walk, Temple Grounds, Richmond, North Yorkshire.
- 1.2 The works were commissioned by Southern Green Ltd on behalf of the site's owners, Dr and Mrs Lawson, and conducted by Archaeological Services Durham University.

### **Observations**

- 1.3 The footings for the upper and lower retaining walls for the Green Walk were exposed. No other archaeological features or remains were recorded or uncovered during the course of the works.

### **Conclusions**

- 1.4 As no other archaeological resources were identified, no further archaeological work is recommended in relation to these works.

## 2. Project background

### Location (Figures 1 and 2)

- 2.1 The site is located at Temple Grounds, Richmond, North Yorkshire, at grid reference is NZ 167 008. Temple Grounds cover 14.5ha north of the River Swale and west of the town of Richmond. Green Walk lies in the middle of these grounds, and runs from Temple Lodge to the Culloden Tower.

### Works on site

- 2.2 Restoration and reconstruction of the retaining walls on the east and west sides of the Green Walk is being carried out under a Higher Level Stewardship scheme funded through Natural England.

### Objective

- 2.3 Monitoring work was undertaken to ensure that any surviving archaeological features or deposits could be recorded.

### Methods statement

- 2.4 The works have been undertaken in accordance with method statements provided by Archaeological Services (reference numbers PC09.07 and DH09.105) and agreed with Natural England.

### Dates

- 2.5 Excavation of the retaining walls was undertaken between 17th March and 18th June 2009. The geophysical surveys were undertaken on 9th and 17th June 2009. The archaeological monitoring was undertaken between 22<sup>nd</sup> June and 7<sup>th</sup> July 2010. This report was prepared between 20th March and 8th July 2009.

### Personnel

- 2.6 Monitoring work was conducted by Alan Rae and Mark Randerson. This report was prepared by Alan Rae, with illustrations by Janine Wilson. The Project Manager was Richard Annis.

### Archive/OASIS

- 2.7 The site code is **RTG 10**, for **R**ichmond, **T**emple **G**rounds **2010**. The project archive is currently held by Archaeological Services and will be offered to the Yorkshire Museum in due course. Archaeological Services is registered with the **Online Access** to the **Index of archaeological investigationS** project (OASIS). The OASIS ID number for this project is **archaeol3-79572**.

## 3. Landuse, topography and geology

- 3.1 The Green Walk is a grassy lane running between fields of pasture along a spur of high ground north of the River Swale, at a mean elevation of around 130m AOD. The Culloden Tower stands at the south end of the spur and Green Walk runs north from here to Temple Lodge. The Walk is cut into the west slope of the ridge, just off the crest. These features are elements of the gardens of the vanished Yorke House, which stood south-west of The Green.

- 3.3 The solid geology of the area is Carboniferous Limestone along the valley of the Swale, with Millstone Grit on the higher ground to either side. The limestone is exposed in a number of scars along the river bank; on the higher ground the solid geology is normally covered by a layer of glacial boulder clay.

#### **4. Previous archaeological work**

- 4.1 The historical and archaeological background of the site has been set out in a report on trial trench evaluation and geophysical survey (Archaeological Services 2009). A desk-based assessment (Archaeological Services 2005a) followed by an archaeological evaluation (Archaeological Services 2005b) were carried out in advance of a proposed development at Yorke Square car park a short distance south-east of the site, in 2005. This was formerly the site of the stables of Yorke House; the Green Walk was part of the landscaped grounds of that house. The evaluation uncovered fragmentary remains of the stable foundations. Archaeological monitoring at 29 The Green, further to the south, identified the foundations for the eastern face of Yorke House (Archaeological Services 2007).

#### **5. Observations**

- 5.1 Archaeological monitoring was undertaken during subsurface excavations associated with the location of the footings for the upper and lower retaining walls at the Green Walk. The excavations were located along the northern 30m of both the upper (east) and lower walls where damage from tree roots and collapse had made the location of the footings difficult. All areas were excavated using a backhoe excavator equipped with a toothless ditching bucket, under archaeological supervision. The total area covered by the works was approximately 50 square metres.

##### **The retaining walls**

- 5.2 The footings for the upper wall (Figure 3) measured 20m+long x 0.36m wide x 0.24m in height were encountered at a depth of 0.25m below ground level (bgl). Immediately above the footings was topsoil. The footings for the lower wall measured 20m+long x 0.42m wide x 0.22m in height, and were encountered at a depth of between 0.35m and 0.65 bgl (Figure 4). The footings were covered in wall collapse and topsoil. Natural subsoil was not encountered during the excavations.

#### **6. Conclusions**

As no other archaeological resources were identified, no further archaeological work is recommended in relation to these works.

#### **7. Sources**

Archaeological Services 2005a *Yorke Square car park, Richmond, North Yorkshire; archaeological desk-based assessment*, unpublished report **1308**, for Richmondshire District Council, Archaeological Services Durham University  
Archaeological Services 2005b *Yorke Square car park, Richmond, North Yorkshire; archaeological evaluation*, unpublished report **1346**, for Richmondshire District Council, Archaeological Services Durham University

Archaeological Services 2007 *29 The Green, Richmond, North Yorkshire;*  
*archaeological monitoring*, unpublished report **1429**, for Sherpa Expeditions,  
Archaeological Services Durham University

Archaeological Services 2009 *Temple Grounds, Richmond, North Yorkshire:*  
*archaeological evaluation and geophysical survey*, unpublished report **2164**,  
for Southern Green Ltd, Archaeological Services Durham University



Reproduced from Explorer 304 1:25 000 by permission of Ordnance Survey on behalf of The Controller of Her Majesty's Stationery Office. © Crown copyright 1995. All rights reserved. Licence number AL100002176

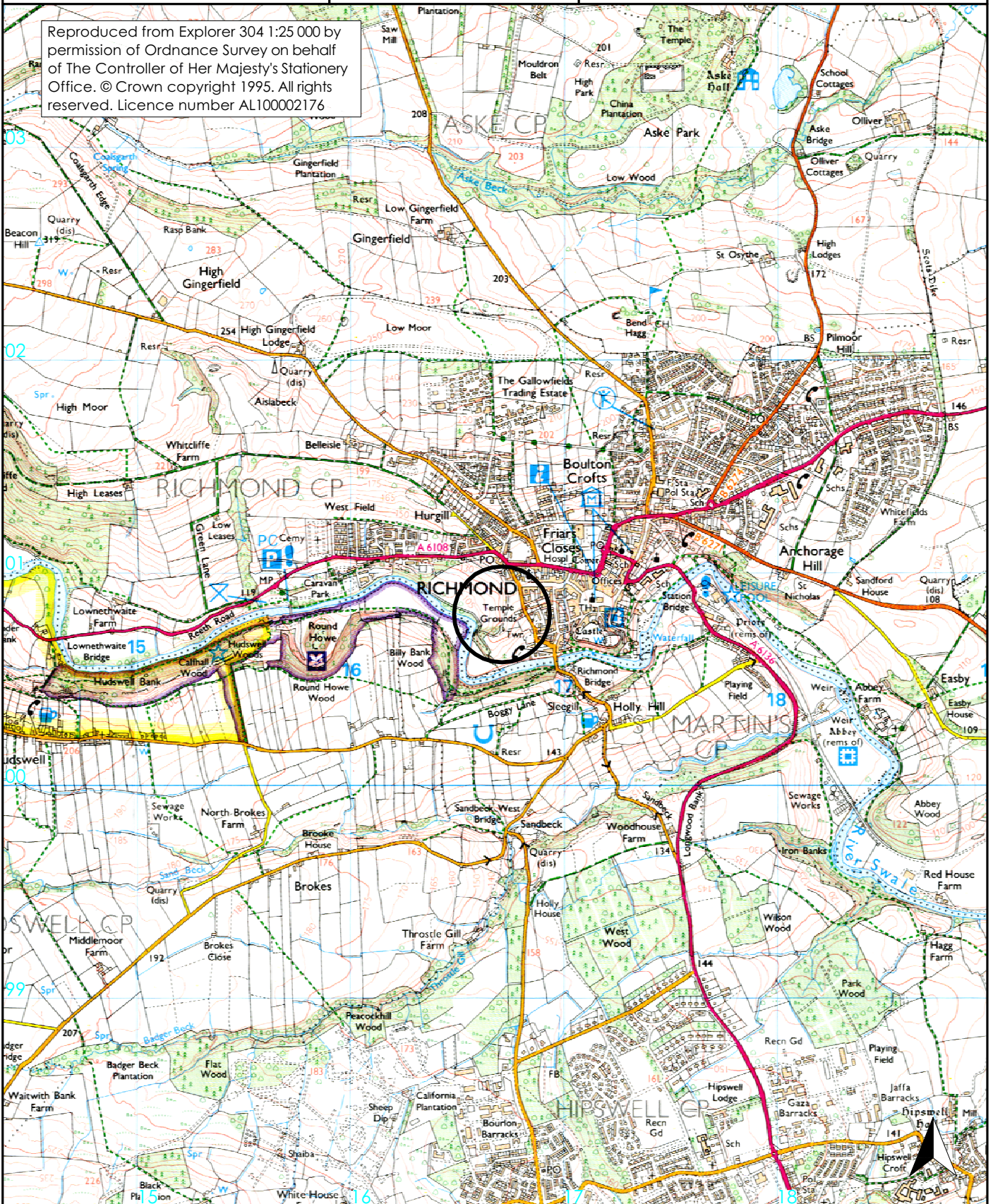

 site location

0  1km  
scale 1:25 000 for A4 plot

Reproduction in whole or in part is prohibited without the prior permission of Southern Green Ltd

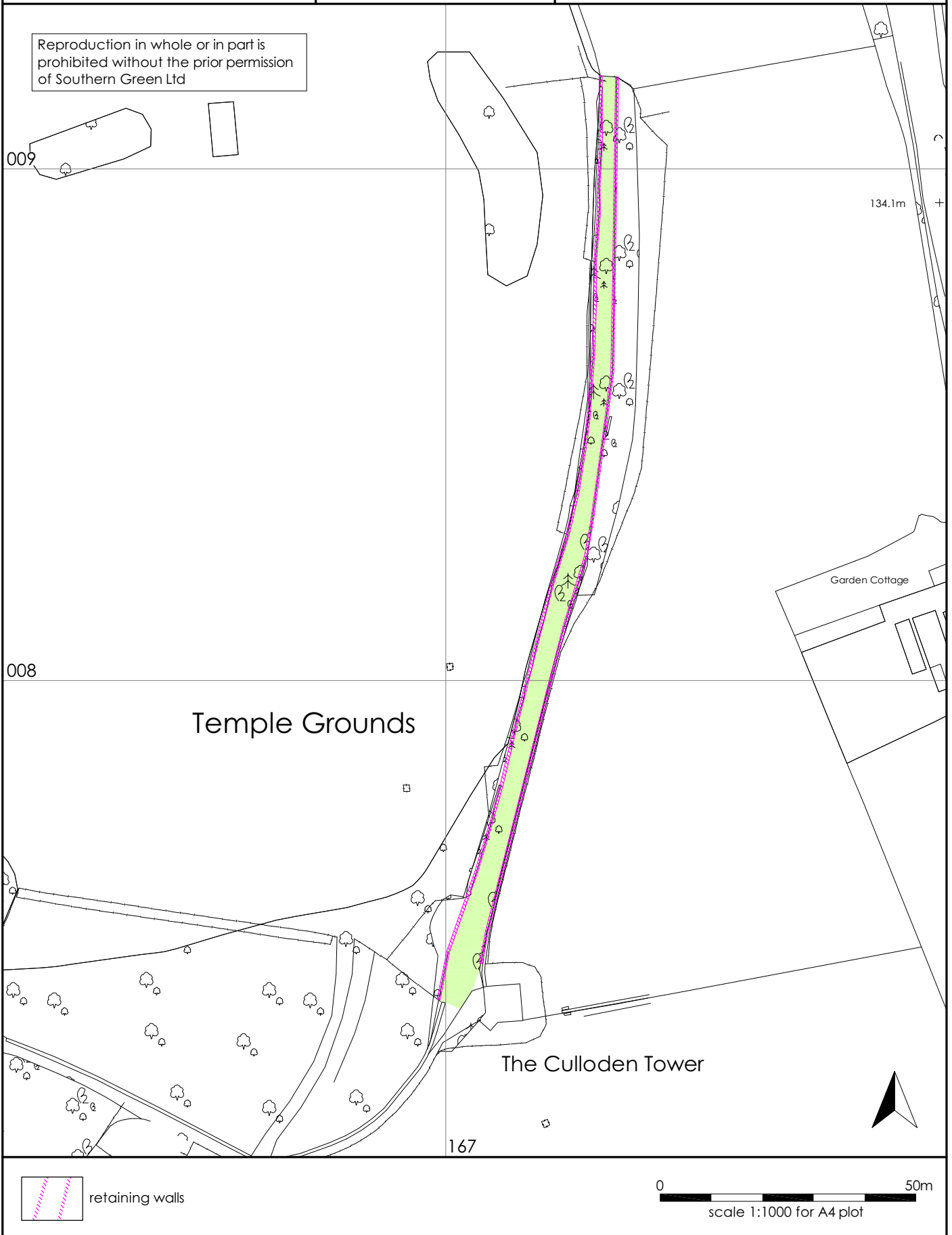





Figure 3: footings for upper retaining wall, looking south



Figure 4: footings for lower retaining wall, looking south