



## YORK ARCHAEOLOGICAL TRUST REPORT

<b>SITE ADDRESS</b>	51 Market Place, Richmond, North Yorkshire		
<b>CLIENT NAME</b>	RBA Moody Bros (Contractors) Ltd		
<b>YAT PROJECT #</b>	5518	<b>YAT REPORT #</b>	2011/48
<b>MUSEUM ACCESSION #</b>	n/a	<b>GRID REFERENCE</b>	NZ 1719 0082
<b>PLANNING REFERENCE #</b>	1/92W/1090Q/FULL	<b>AAI OPS NOTICE #</b>	n/a

### INTRODUCTION

A periodic watching brief on ground-works was undertaken at a site to the rear of 51 Market Place, Richmond, North Yorkshire between 8<sup>th</sup> and 15<sup>th</sup> June 2011 (Figure 1). The works were carried out by York Archaeological Trust on behalf of RBA Moody Bros (contractors) Ltd. The watching brief was maintained subsequent to an earlier watching brief on six large test-pits around the footprint of the proposed building (YAT Report 2011/29).

The site is sub-rectangular in shape, with the long axis aligned north-west to south-east, and within this plot of land a rectangular building is proposed. The northern-western side of the site is bordered by buildings, the north-eastern side by a narrow path to the rear of a series of properties fronting onto the market place, the northern half of the south-eastern side is bordered by a retaining wall to the south of which the ground drops sharply, the southern half of the south-eastern side is bordered by a Jehovah's Witness Kingdom Hall, and the south-western side of the site is bordered by an alley named Castle Wynd to the south-west of which are domestic properties. Access to the site is via a cobbled lane on the western side. The ground level ranges from 131.78m AOD on the cobbled alley at the western side of the site to 130.66m at the south-western corner of the site. The south-eastern most portion of the site is flagged, the flags being 0.44m<sup>2</sup>.

The buildings on site had been demolished prior to the commencement of the first watching brief, leaving a surface deposit of fragments of concrete 0.15m thick, brick rubble and sandstone blocks up to 0.26m x 0.19m x 0.06m in size. This deposit was removed from site during the course of the first watching brief which thereafter involved the observation of the machine excavation of six test-pits. These test-pits were numbered in the order that they were excavated, and are shown in Figure 2.

This earlier watching brief on the six test-pits demonstrated that the profile of undisturbed natural ground sloped markedly to the south and east. Directly over this sloping profile of natural deposits were thick, dark layers containing quantities of stone and stone rubble with a small amount of later post-medieval pan-tile, these being less than 1m deep at the northern end of the site, but up to 3m deep at the south-east end of the site. These human-derived deposits were seen to represent deliberate dumping in order to raise the ground level to an even surface.

The watching brief which forms the subject of this report was carried out on 8<sup>th</sup> and 15<sup>th</sup> June during which time the strip foundations for the new building were cut and the foundations laid. In the first visit foundation trenches in the south and eastern part of the site were observed and recorded. In the second visit foundation trenches on the northern and western part of the site were observed and recorded. All foundation trenches were cut by a tracked mini-digger equipped with a toothed bucket. The trenches were all slightly over 1m wide and their depth ranging from in excess of 2.5m in the southern part of the site to less than 2m in the northern part of the site. For Health and Safety reasons it was not possible to enter the foundation trenches in the southern part of the site – all observations being made from the ground surface. All recording was carried out in accordance with a Written Scheme of Investigation (WSI) prepared by YAT and followed the strictures of YAT fieldwork standards (YAT 2005).

<b>COMPLETED BY</b>	M. Johnson	<b>CHECKED BY</b>	M. Stockwell	<b>FINISHED</b>	12/08/11
<b>FINDS</b>	None	<b>SAMPLES</b>	None	<b>PHOTOS</b>	Yes
				<b>PAGE</b>	1 of 7





## YORK ARCHAEOLOGICAL TRUST REPORT

<b>SITE ADDRESS</b>	51 Market Place, Richmond, North Yorkshire		
<b>CLIENT NAME</b>	RBA Moody Bros (Contractors) Ltd		
<b>YAT PROJECT #</b>	5518	<b>YAT REPORT #</b>	2011/48
<b>MUSEUM ACCESSION #</b>	n/a	<b>GRID REFERENCE</b>	NZ 1719 0082
<b>PLANNING REFERENCE #</b>	1/92W/1090Q/FULL	<b>AAI OPS NOTICE #</b>	n/a



Figure 1 Site location (site outlined red)

### OBSERVATIONS

(Figure 2)

At the time of the visit of 8<sup>th</sup> June 2011 the south-eastern foundation trench, parts of the north-eastern side together with the eastern part of the full-width internal cross-wall had been cut (Figure 3). Observations within these trenches were seen to correlate with those of test-pits 1, 2 and 6.

Natural deposits in the form of yellowish clayey sand, context 2000, were seen to lie at depths of between 1.0 - 2.6m BGL (below ground level) and to fall to the south and east. Directly above natural deposits lay a thick deposit of dark grey, sandy silt clay, context 2001, that was seen to contain large amounts of stone rubble together with very occasional fragments of ceramic building material and very occasional flecks of lime mortar and charcoal. The only other finds material observed within 2001 were two pieces of later post-medieval white glazed ware, a sherd of thin window glass and two small fragments of animal bone. In the foundation for the full-width cross-wall a further deposit, 2007, was seen to overlie context 2000. This material was very similar to 2001 but contained more stone rubble and was of slightly looser consistency. The dating evidence available

<b>COMPLETED BY</b>	M. Johnson	<b>CHECKED BY</b>	M. Stockwell	<b>FINISHED</b>	12/08/11
<b>FINDS</b>	None	<b>SAMPLES</b>	None	<b>PHOTOS</b>	Yes
				<b>PAGE</b>	2 of 7

York Archaeological Trust is a  
Registered Charity  
No. 509060



Registered Office:  
47 Aldwark, York YO1 7BX  
Tel: 01904 663000 Fax: 01904 663024



A Company Limited by Guarantee  
Without Share Capital Registered  
in England No. 1430801



## YORK ARCHAEOLOGICAL TRUST REPORT

<b>SITE ADDRESS</b>	51 Market Place, Richmond, North Yorkshire		
<b>CLIENT NAME</b>	RBA Moody Bros (Contractors) Ltd		
<b>YAT PROJECT #</b>	5518	<b>YAT REPORT #</b>	2011/48
<b>MUSEUM ACCESSION #</b>	n/a	<b>GRID REFERENCE</b>	NZ 1719 0082
<b>PLANNING REFERENCE #</b>	1/92W/1090Q/FULL	<b>AAI OPS NOTICE #</b>	n/a

for this ground levelling suggests that it was probably taking place some time around the 18<sup>th</sup> century. Only one feature, a stretch of stone walling, context 2006, was observed and this was seen to cut through 2007. Parts of this walling, which was aligned south-east – north-west (i.e. along the length of the development plot) were seen in the full-width cross wall foundation trench. The wall, more properly a wall footing, was of five – six courses of sandstone standing around 650mm tall and around 350mm wide. The stratigraphic location of this walling clearly indicate that it post-dates the levelling up of the site with deposits 2001 and 2007.

More recent deposits are represented by context 2002, a deposit of stone fragments visible in the south-eastern part of the north – east wall foundation trench (Plate 2). This measured in excess of 1.50m across by 0.85m deep and, given the pitching of stone at all angles, appears likely to represent a stoney element within the ground levelling operations rather than a disturbed wall. Immediately to the north-west of 2002 lay a roughly cast block of concrete, context 2005, within a foundation cut, context 2004. This concrete, which contained some steel reinforcing bars, had a width in excess of 1.6m and a thickness of around 1.1m. This modern structural element is presumed to relate to recently demolished building/s at the site.

At the time of the visit of 15<sup>th</sup> June 2011 the remaining parts of the foundation trenches to the north-eastern side and to the full width cross-wall were fully opened. Also open for inspection was the north-western foundation trench and parts of that to the south-western side. Observation of these sections showed that at the north-western side of the plot (Figure 4) natural deposits, context 2013, lay at a depth of around 700mm BGL. These deposits were seen to be comprised of broad laminations of yellow clayey sands and pale grey sandy clays. Partly decayed roots up to 25mm thick were seen to penetrate 2013 in a number of places. Immediately above these natural deposits was a thin layer of compact, very dark grey, slightly clayey sandy silt, generally around 80mm thick, context 2012. Given its stratigraphic position context 2012 may represent an old turf-line. Sealing this putative turf-line was context 2011, a dark greyish brown, sandy silt clay containing amounts of stone rubble and occasional fragments of ceramic building material. This material represents post-medieval dumping/levelling and can be equated with contexts 2001 and 2007 observed elsewhere. Modern materials, context 2010, sealed the deposit sequence in this area of the site.

Observations of the north-eastern foundation trench (Figure 5) showed that considerable depths of post-medieval levelling materials were ubiquitous in this area. By contrast, in the south-western foundation trench natural deposits, context 2008, generally lay at depths of around 800mm BGL. These were again sealed by dark greyish brown, slightly clayey sandy silt, rubble rich, dumped/levelling deposits, context 2009, that can be equated with 2001, 2007 and 2011. No former turf-lines between natural deposits and post-medieval levelling deposits were apparent in this trench. The uppermost deposits are of entirely modern materials, context 2003.

## CONCLUSION

This watching brief has served to confirm the observations of the initial archaeological works at the site. It is clear that the original topography of the immediate locality was one of ground that sloped heavily to the south and east, that is away from the castle towards the much lower ground of these areas. Although broad indicators of this original topography still survive in this part of the town it has to some degree been masked by terracing and terrace walls, such as that adjacent to the south-east

<b>COMPLETED BY</b>	M. Johnson	<b>CHECKED BY</b>	M. Stockwell	<b>FINISHED</b>	12/08/11
<b>FINDS</b>	None	<b>SAMPLES</b>	None	<b>PHOTOS</b>	Yes
				<b>PAGE</b>	3 of 7





## YORK ARCHAEOLOGICAL TRUST REPORT

<b>SITE ADDRESS</b>	51 Market Place, Richmond, North Yorkshire		
<b>CLIENT NAME</b>	RBA Moody Bros (Contractors) Ltd		
<b>YAT PROJECT #</b>	5518	<b>YAT REPORT #</b>	2011/48
<b>MUSEUM ACCESSION #</b>	n/a	<b>GRID REFERENCE</b>	NZ 1719 0082
<b>PLANNING REFERENCE #</b>	1/92W/1090Q/FULL	<b>AAI OPS NOTICE #</b>	n/a

end of the site. The post-medieval levelling of the development plot can be seen as part of this process of topographic development. No evidence was found of any archaeological features or finds pre-dating the later post-medieval period. As such, the area of the development plot appears likely to have formed sloping open ground that was unoccupied until the post-medieval period.

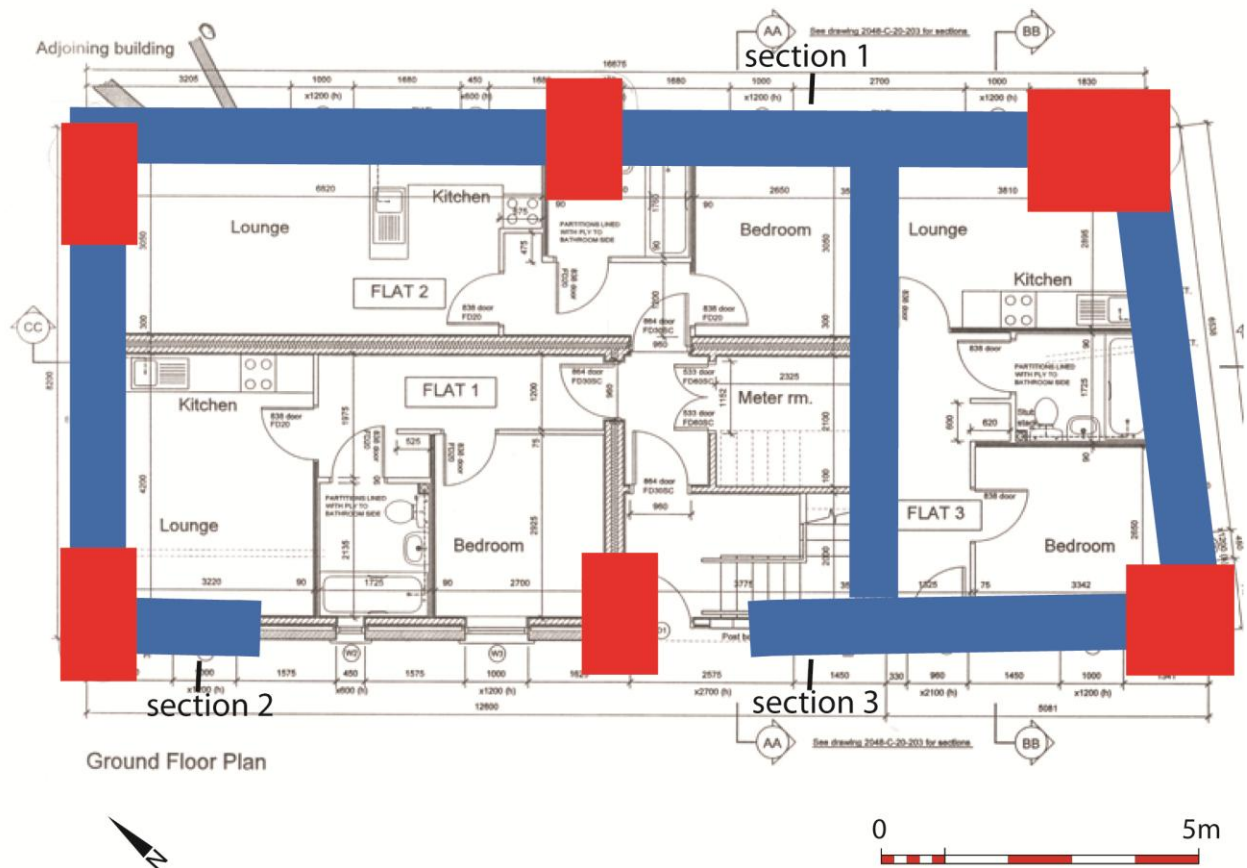

Figure 2 Works location plan (test-pits of first watching brief highlighted red, observed foundation trenches highlighted blue; location of sections indicated)

<b>COMPLETED BY</b>	M. Johnson	<b>CHECKED BY</b>	M. Stockwell	<b>FINISHED</b>	12/08/11
<b>FINDS</b>	None	<b>SAMPLES</b>	None	<b>PHOTOS</b>	Yes
				<b>PAGE</b>	4 of 7

York Archaeological Trust is a  
Registered Charity  
No. 509060



Registered Office:  
47 Aldwark, York YO1 7BX  
Tel: 01904 663000 Fax: 01904 663024



A Company Limited by Guarantee  
Without Share Capital Registered  
in England No. 1430801





# YORK ARCHAEOLOGICAL TRUST REPORT

<b>SITE ADDRESS</b>	51 Market Place, Richmond, North Yorkshire		
<b>CLIENT NAME</b>	RBA Moody Bros (Contractors) Ltd		
<b>YAT PROJECT #</b>	5518	<b>YAT REPORT #</b>	2011/48
<b>MUSEUM ACCESSION #</b>	n/a	<b>GRID REFERENCE</b>	NZ 1719 0082
<b>PLANNING REFERENCE #</b>	1/92W/1090Q/FULL	<b>AAI OPS NOTICE #</b>	n/a

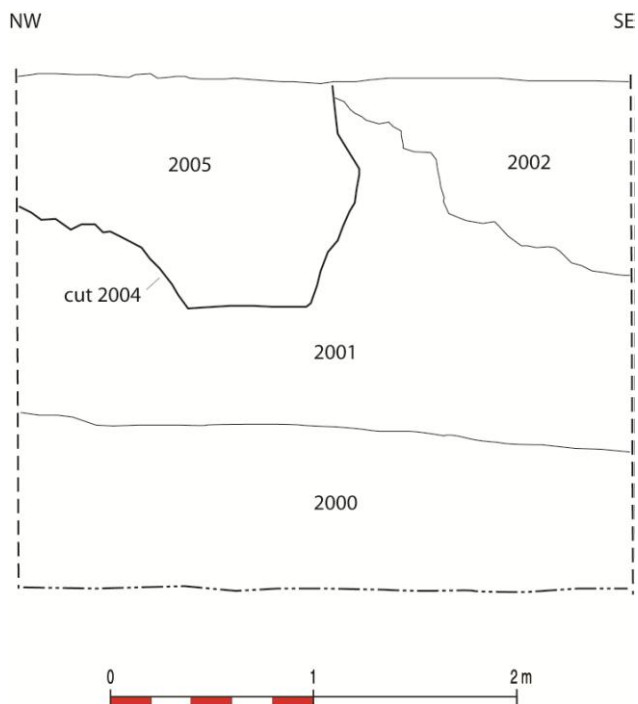

Figure 3 Section 1

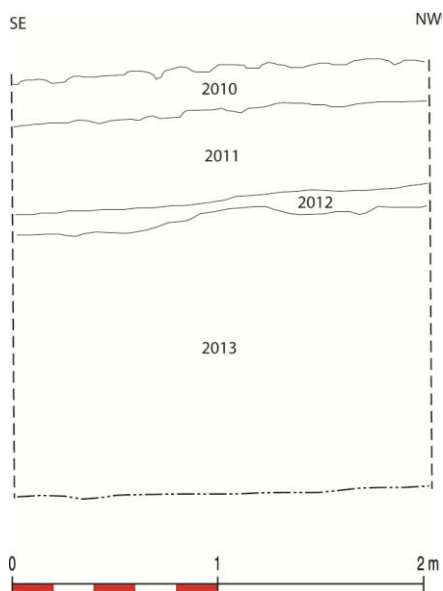

Figure 4 Section 2

<b>COMPLETED BY</b>	M. Johnson	<b>CHECKED BY</b>	M. Stockwell	<b>FINISHED</b>	12/08/11
<b>FINDS</b>	None	<b>SAMPLES</b>	None	<b>PHOTOS</b>	Yes
				<b>PAGE</b>	5 of 7



## YORK ARCHAEOLOGICAL TRUST REPORT

<b>SITE ADDRESS</b>	51 Market Place, Richmond, North Yorkshire		
<b>CLIENT NAME</b>	RBA Moody Bros (Contractors) Ltd		
<b>YAT PROJECT #</b>	5518	<b>YAT REPORT #</b>	2011/48
<b>MUSEUM ACCESSION #</b>	n/a	<b>GRID REFERENCE</b>	NZ 1719 0082
<b>PLANNING REFERENCE #</b>	1/92W/1090Q/FULL	<b>AAI OPS NOTICE #</b>	n/a

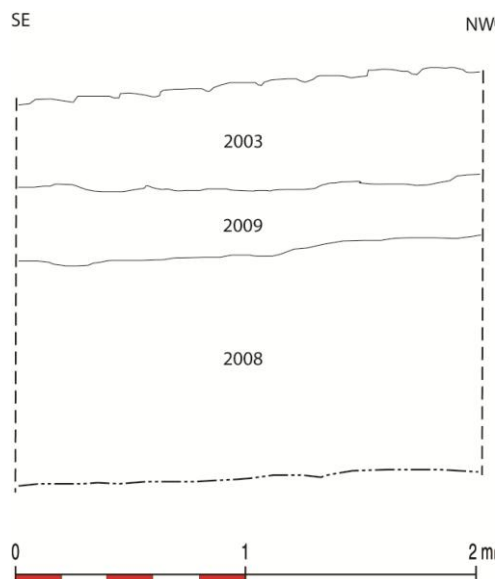

*Figure 5 Section 3*



*Plate 1 Overall view of site, looking SE*

<b>COMPLETED BY</b>	M. Johnson	<b>CHECKED BY</b>	M. Stockwell	<b>FINISHED</b>	12/08/11
<b>FINDS</b>	None	<b>SAMPLES</b>	None	<b>PHOTOS</b>	Yes
				<b>PAGE</b>	<b>6 of 7</b>

York Archaeological Trust is a  
Registered Charity  
No. 509060



Registered Office:  
47 Aldwark, York YO1 7BX  
Tel: 01904 663000 Fax: 01904 663024



A Company Limited by Guarantee  
Without Share Capital Registered  
in England No. 1430801



## YORK ARCHAEOLOGICAL TRUST REPORT

<b>SITE ADDRESS</b>	51 Market Place, Richmond, North Yorkshire		
<b>CLIENT NAME</b>	RBA Moody Bros (Contractors) Ltd		
<b>YAT PROJECT #</b>	5518	<b>YAT REPORT #</b>	2011/48
<b>MUSEUM ACCESSION #</b>	n/a	<b>GRID REFERENCE</b>	NZ 1719 0082
<b>PLANNING REFERENCE #</b>	1/92W/1090Q/FULL	<b>AAI OPS NOTICE #</b>	n/a



*Plate 2 Part of NE foundation trench, looking NE*

<b>COMPLETED BY</b>	M. Johnson	<b>CHECKED BY</b>	M. Stockwell	<b>FINISHED</b>	12/08/11
<b>FINDS</b>	None	<b>SAMPLES</b>	None	<b>PHOTOS</b>	Yes
				<b>PAGE</b>	<b>7 of 7</b>

York Archaeological Trust is a  
Registered Charity  
No. 509060



Registered Office:  
47 Aldwark, York YO1 7BX  
Tel: 01904 663000 Fax: 01904 663024



A Company Limited by Guarantee  
Without Share Capital Registered  
in England No. 1430801