

YORK



ARCHAEOLOGICAL
TRUST



NYCC HER

SNY	19203
E IV	6432
C.NY	
Parish	8014
Rec'd	1998

REPORT ON AN ARCHAEOLOGICAL
WATCHING BRIEF AT THE GREY
HORSE PUBLIC HOUSE, MAIN
STREET, KELFIELD

8/14/50D/PA

**A REPORT ON AN ARCHAEOLOGICAL
WATCHING BRIEF AT THE GREY HORSE PUBLIC HOUSE,
KELFIELD, NORTH YORKSHIRE.**

CONTENTS

- 1 Introduction
- 2 Methodology
- 3 Geology and Topography
- 4 Historical Background
- 5 The Watching Brief
- 6 Conclusions
- 7 List of Sources
- 8 List of Contributors

List of Figures

- Figure 1 Site location
Figure 2 Showing site after excavations
Figure 3 Copy of S M R referring to ditch adjacent to site

1 0 Introduction

Beginning on the 27th January 1998, York Archaeological Trust carried out an archaeological Watching Brief on the land adjacent to the Grey Horse Public house, Kelfield, (National Grid Reference SE 5932 3840) on behalf of the contractors, J M Butler (Joinery & Buildmg) The watching brief was carried out to fulfill a planning condition decision no 8/14/50D/PA, set by Selby District Council,

2 0 Methodology

The machine excavation of foundation trenches and general site reduction was monitored for any evidence of archaeological deposits which may have survived in the vicinity of the development

This watching brief was undertaken in two phases and the work was monitored by Damian Hmd and Russell Marwood on behalf of the York Archaeological Trust Records of this archaeological watching brief are currently stored with the York Archaeological Trust and the Yorkshire Museum under the accession code YORYM 1998 7

The site was reduced by a mechanical excavator using a 5' toothless bucket and trenches excavated with a 2' bucket The deposits revealed in section were recorded following the procedures laid down in the York Archaeological Trust *Context Recording Manual* (1996)

3 0 Geology and Topography

The village of Kelfield is situated c 6½ km to the NNW of Selby and c 10km west of Fulford, York It sits upon the north bank of the River Ouse some 4km down stream from the confluence of the Wharfe and Ouse Its drift geology consists of alluvium deposits with a solid base geology of Keuper Marl of the permo-triassic period

4 0 Historical Background

The village of Kelfield appears in the North Yorkshire Sites & Monuments Record, as number 9711 00000 Kelfield has records dating back to the time of the Norman Conquest, when it was called *Chelchefeld* or *Chelchefelt*, having two carucates and two bovates recorded

Within the village there is a circular moated site, (SMR No 9711 03000), possibly the original manor house, documented as belonging to Henry de Kelfield in 1291 This lies to the north west of the development The manor was presumably superseded by Kelfield Hall, built in 1591 This was a substantial building, documented as having twelve hearths and stood until 1840

To the west of the site are a pair of ditches (SMR No 9711 04100) which may be either part of a moated site or fishponds or alternatively clay workings, either for brick making or *marling*, as the place name Kelfield derives from the Old English form for chalky field (possibly)

Adjacent to the back of the pub was the alleged "village gaol", dating to the 16th century This is also within ten metres of the suggested site of the village smithy, which lies to the west of the Grey Horse Public House Most of the current houses standing in the village date to the 18th Century or later To the north of the village, Moor End, there is a cluster of mainly 19th century dwellings

5 0 The Watching Brief

The first phase of work to be observed consisted of the mechanical removal of deposits to the north and rear of the Public house in an area designated to be the car park This was done mechanically and consisted the stripping of turf and a dark brown fine loam to a depth between 0 20m and 0 25m below the current ground level

During these excavations two concrete structures were uncovered, just below the level of the turf, c 0 10m BGL The more southerly of these, nearest to the Public House, seemed to be the top of a septic tank whilst the other had an unknown function

About 1m from the northern edge of the excavation a disused manhole was encountered This was half excavated to reveal a backfill of topsoil and modern glass, pot fragments and brick fragments The main body of the structure was made up of a single brick thick (c 0 06m) 1 05m square chamber

The second phase of observations began with the excavation of the footings for the raft foundations of the new dwelling house These were located to the west of the Public House, 10m from the street front A series of shallow trenches were machine excavated to depths of between 0 10m and 0 25m, the deepest being for the western external load bearing wall

Much of the excavations towards the south and east of the site were dug through the existing ash and gravel of the car park The northern most trenches were excavated wholly within the topsoil deposit, whilst an area in the south-west corner contained demolition rubble

6 0 Conclusions

The full depth of the topsoil was not reached in the excavations across most of the site and this reflected in the lack of finds and non-recovery of any archaeological features Any which may have remained along the street front would have been removed during the leveling process undertaken during the laying of the car-park The demolition debris recovered from the south-east corner was of fairly modern date

No trace of any archaeological deposits were found during this development. However, the close proximity of the earthworks to the NNW of the site, and the general documentary evidence of Kelfield's history, would suggest that any further excavation work on or in the vicinity of the site would merit archaeological observation.

7 0 List of Sources

Smith A H, 1961 *The Placenames of the East Riding of Yorkshire and York*. pp266

Sites and Monuments Record, County Hall, Northallerton

8 0 List of Contributors

Watching brief Danuan Hind & Russell Marwood

Report production Russell Marwood

Archive Christine Kyrnacou

Editor Martin Stockwell

SHOWING SITE LOCATION

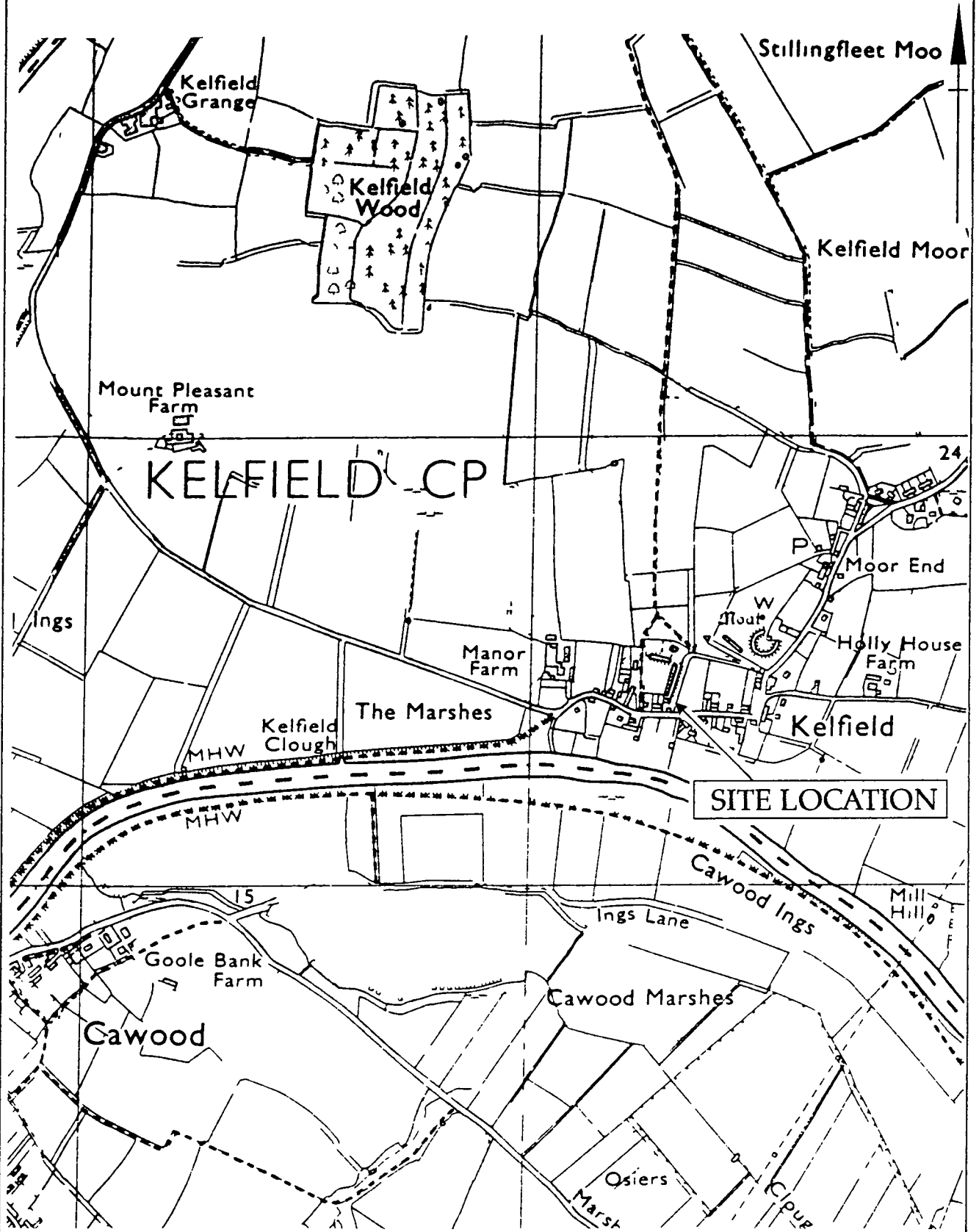

YORK ARCHAEOLOGICAL TRUST

GREY HORSE PUBLIC HOUSE, MAIN STREET, KELHELD

ACCESSION CODE YORYM 1998 7

N G R SE 5930 3839

SCALE 1 12500

Fig 1

SHOWING SITE AFTER EXCAVATIONS

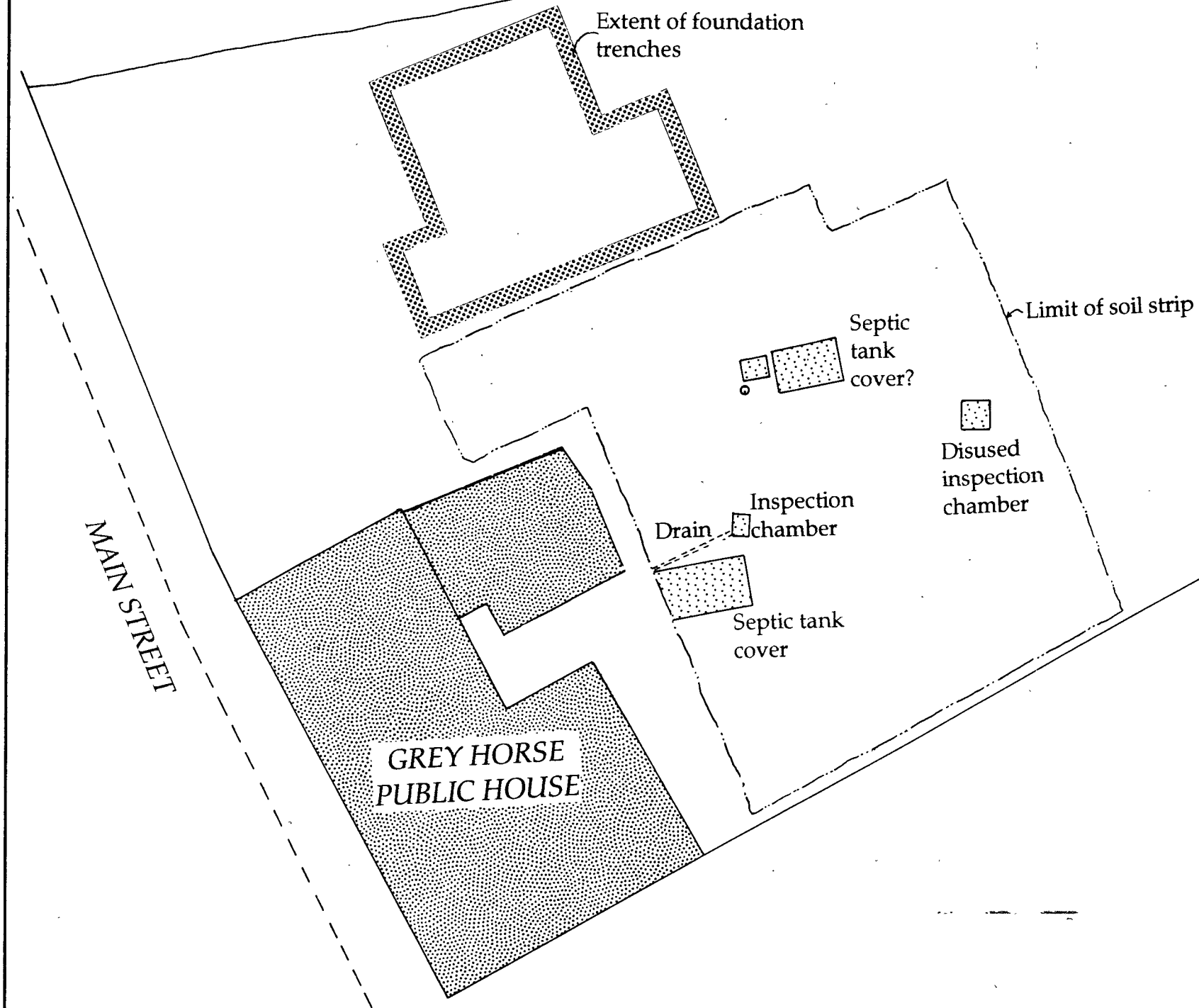
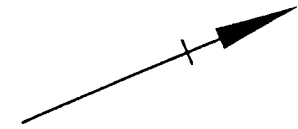

Sites and Monuments Mam Planar Record

SMR Number 9711 04100
Site or Find S
Parish Details KELFIELD
Administrative Area RECORD PARTLY OR TOTALLY IN REST OF COUNTY AREA
Legal Status No legal status/NO RECORD

Scheduled Ancient Monument Number **Listed Building Designation**
Grid Reference C SE 59280 38470 **Number Types** NR

Class MOAT7FISHPONDS?
Site Name

Description TWO LENGTHS OF DITCH FORMING 2 SIDES OF A POSSIBLE RECTANGLE WHICH MAY HAVE BEEN EITHER A MOATEDSITE OR FISHPONDS THERE ARE OTHER PONDS TO THE NO RTH AND ANOTHER NEAR THE EARLY MOATED SITE 03 ATSE59453853

Period	MEDIEVAL		POST MEDIEVAL		?
Type Classification	NR		STRUCTURE		NR
Plan Form	NR				
Material	NR		Decorative Type		NR
Colour	NR				
Form	Extant Structure	/	Condition	Unknown	/
	NO RECORD/ NOT RECORDED	/		NO RECORD/ NOT RECORDED	/
	NO RECORD/ NOT RECORDED	/		NO RECORD/ NOT RECORDED	/

User Notes